



# North Port

FLORIDA

[NorthPortFL.gov](http://NorthPortFL.gov)



# Police Headquarters

History and looking to the future

# Timeline of project

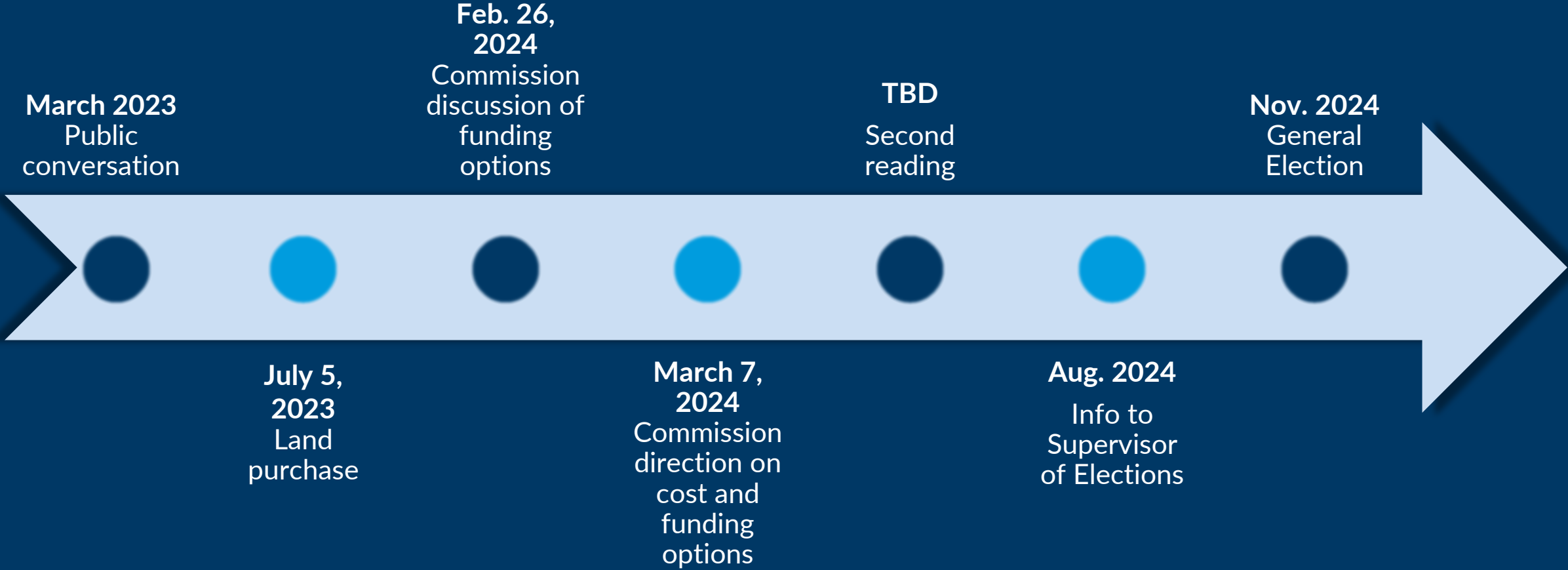

# NPPD Snapshot

- 196 current staff
- Responded to 89,892 calls for service in 2023.
  - 14.58% increase from the previous year
- Crime overall is up 9.35% compared to last year and is up 17.5% over a 3-year average.\*
- Quadruple Excelsior Accreditation
  - One of 18 law enforcement agencies to hold this distinction.

\*Annual Uniform Crime Reporting, Feb. 9, 2024



# History of PDHQ funding

- Funds transferred in 2018.
- Per Commission at the July 21, 2021, Budget Workshop, the project was unfunded, and no fund would be rolled into FY2022.

Project	Date	How	Project Name	Funding Approved	Future Funding
PD18PS	Sep-18	Budget Transfer	Police Station Construction	65,168	0
PD21PE	FY 2021	Budget Approval	Construction of Building for Property/Evidence	1,300,000	0
PD21PE	FY 2022	Budget Approval	Property Evidence-EOC Dispatch Building	550,000	15,700,000
PD21PE	6/13/2023	Budget Amendment	New Police Headquarters and EOC	2,700,000	104,647,800
PD21PE	FY 2024	Budget Approval	New Police Headquarters and EOC	0	101,947,800
			<b>Current funding</b>	<b>4,550,000</b>	

# NORTH PORT PD & EOC

## PROJECT UPDATES

2023823 / 2023824  
March 05, 2024



SCHENKEL  
SHULTZ

# Agenda

## Topics & Times

### 1. WHERE WE WERE

- Staffing Projections
- Original Budget Summary

### 2. EOC

- Site Plan
- Exterior Rendering

### 3. PD HEADQUARTERS

- Prevailing Questions
- Budget
  - Growth Assessment
  - Exterior Rendering
  - Budget Impacts



SCHENKEL  
SHULTZ

# WHERE WE WERE

North Port PD // EOC

01

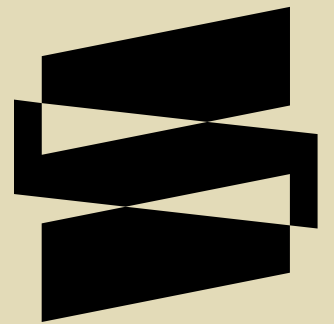





# North Port Police Department Staff Organization & Deployment

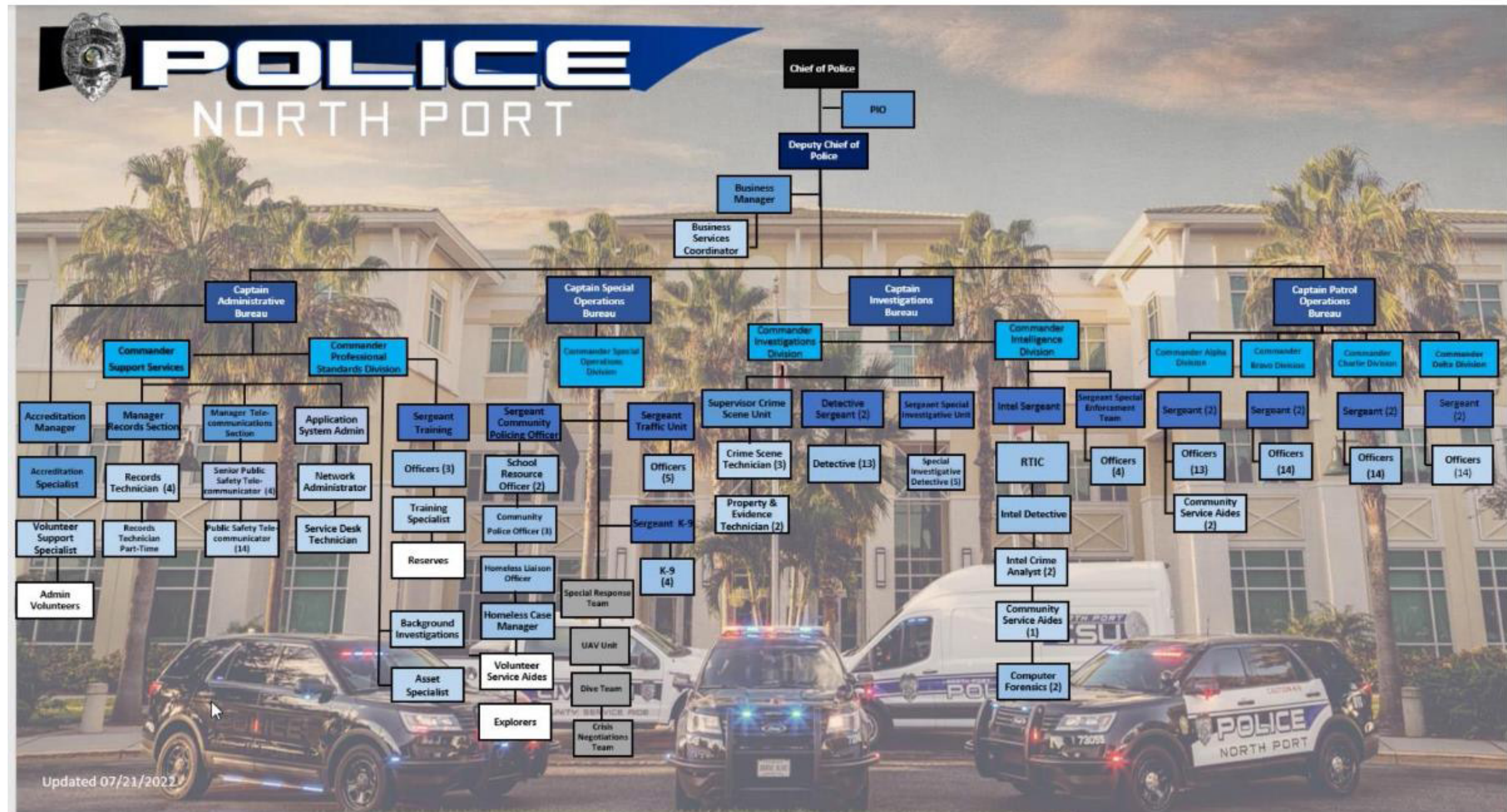

Updated 07/21/2021



# North Port Police Department Current & Future Staff Projections

- **Current Staff Profile (2024)**  
196 Total Staff: 144 Sworn / 52 Civilian
- **Near-term Planning Milestone (2035)**  
371 Total Staff: 265 Sworn / 106 Civilian
- **Mid-term Planning Milestone (2050)**  
561 Total Staff: 401 Sworn / 160 Civilians
- **Long-term Planning Milestone (2070)**  
922 Total Staff: 659 Sworn / 263 Civilians



# North Port Police Department

## Space Needs Assessment Summary

### Facility

### Mid-Term 2050

Police Headquarters Functions	81,325 Sq.Ft.
E911/ Telecommunications Section	8,861 Sq.Ft.
Property & Evidence/ CSU	<u>12,932 Sq.Ft.</u>
<i>Police Area Subtotals:</i>	103,118 Sq.Ft.
Emergency Operations Center	14,971 Sq.Ft.
<i>Building Area Totals:</i>	<u><u>118,089 SqFt.</u></u>



# North Port Police Department Budget Summary

## PROJECT

## Construction 2026

### New Construction

Police Headquarters.....	\$63.56 – 76.84 mil
E911 Telecommunications.....	\$9.48 – 10.44 mil
Property & Evidence/ CSU.....	<u>\$7.07 – 7.75 mil</u>
<i>Sub-total:</i>	\$80.11 – 95.03mil
<u>Emergency Operations Center.....</u>	<u>\$10.23 – 11.21 mil</u>
<i>New Construction Project Budget Total:</i>	\$90.34 – 106.24 mil

**EOC**

North Port

**02**

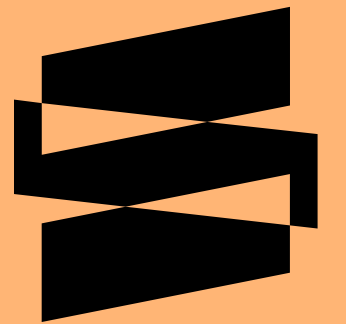

# Site Plan



# Exterior Design



# PD HEADQUARTERS

North Port

03

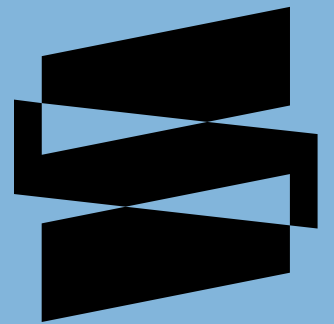





# North Port Police Department New Construction (Prototype Site)

## POLICE BUILDING

New 2-Story Police Building  
New 1-Story Support Garage

Total Police Building Area

97,618 gsf

5,500 gsf

103,118 gsf

## SITE ACCOMMODATION: 10 to 11 Acres

- ✓ Police
- ✓ Secure Parking
- ✓ Public Parking
- ✓ Security Stand-off
- ✓ Service & Mechanical Yards
- ✓ Regulatory Setbacks
- ✓ Stormwater
- ✓ Landscaping / Open-space
- ✓ Hardscape – Civic Plaza
- ✓ Communications Tower

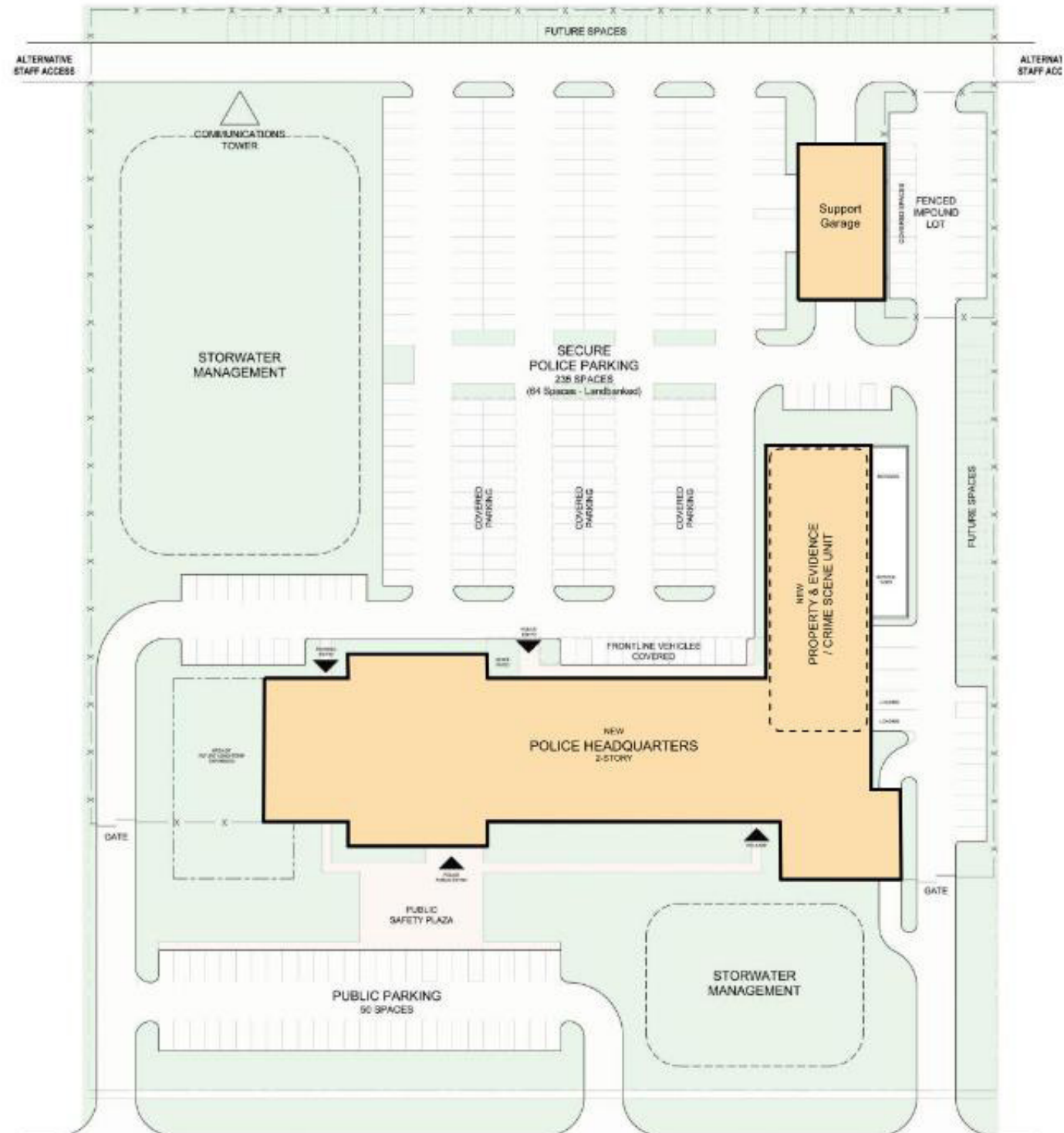



# North Port Police Department Prevailing Questions

- *How can the building fit on the selected Site?*
- *How can we plan for growth beyond year 2050?*
- *Are there other project elements that should be considered?*



# North Port Police Department Additional project elements - Budget

- **Site**

– Wetlands mitigation (area 1)	\$ .94 million
– Extend Utilities to New Site	<u>4.10 million</u>
<b>subtotal</b>	<b>\$ 5.04 million</b>

- **Building**

– Base Building size increase (5.8%)	3.30 million
– Shell Space to accommodate 2065 space needs	10.60 million
– Enlarge Special Ops / SRT garage	1.60 million
– Enlarge Impound Lot	2.80 million
– New Vehicle Upfit garage	1.30 million
– On-site fueling station	2.30 million
– Perimeter Fence / Screen wall	<u>.70 million</u>
<b>subtotal</b>	<b>\$ 22.60 million</b>

original budget	\$ 95.03 million
<b>increased budget</b>	<b>\$ 122.67 million</b>

# Growth to 2065

\$122 M

## KEY ELEMENTS INCLUDED:

Police Headquarters:	109,000 S.F.
SRT Garage:	7,400 S.F.
Vehicle Upfit Garage:	5,200 S.F.
Shell Space:	30,600 S.F.
Cov./ Encl. Impound Lot:	18,200 S.F.
PD Parking:	388 Total
- Paved Stalls:	205
- Covered & Paved Stalls:	85
- Stabilized Grass Overflow:	98
Public Parking:	50 Total
Wetland 1 - Mitigation	
Fuel Station w/ Canopy	

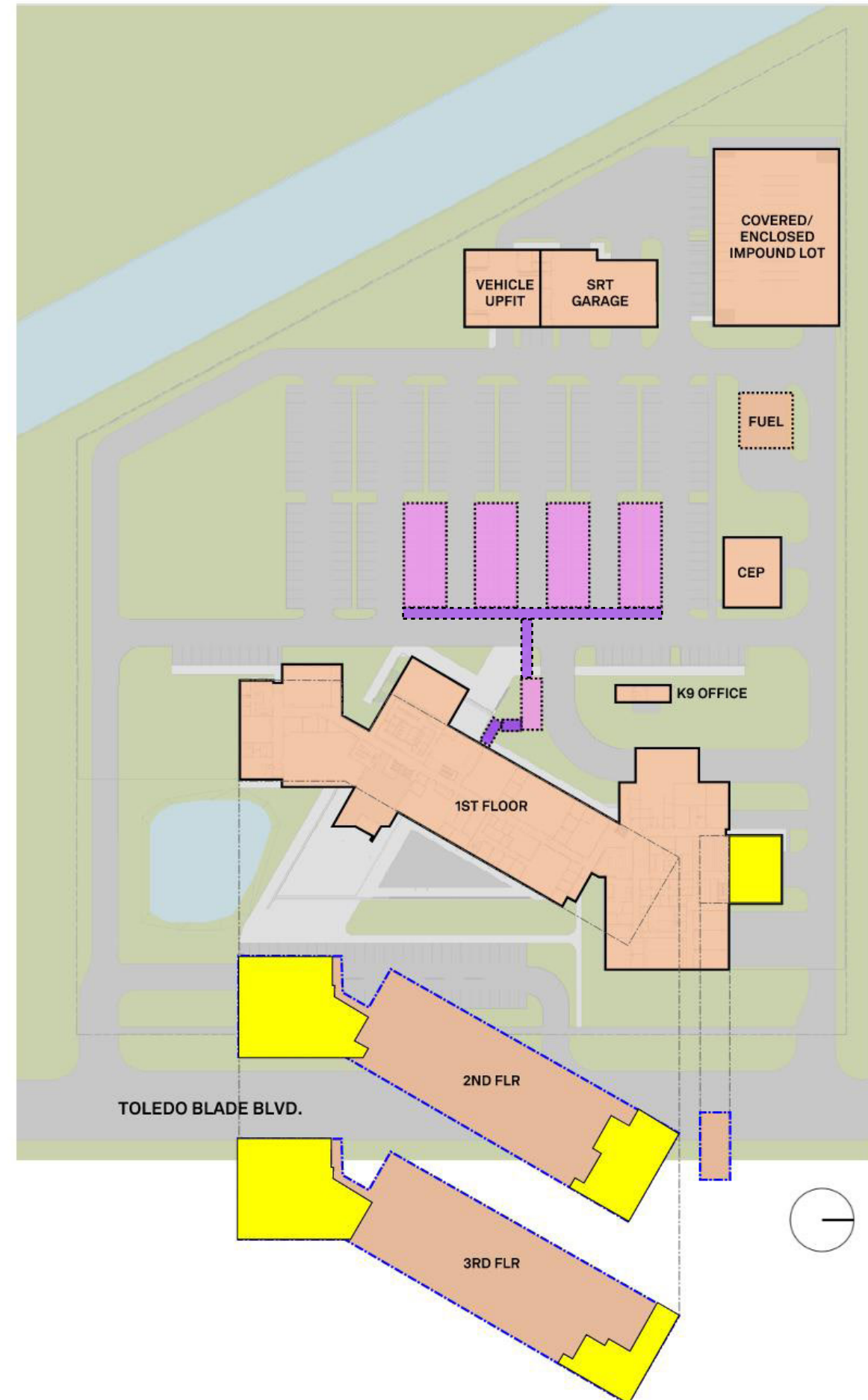

# Exterior Design



# Exterior Design



# Lobby

MOBILE INSPIRATION

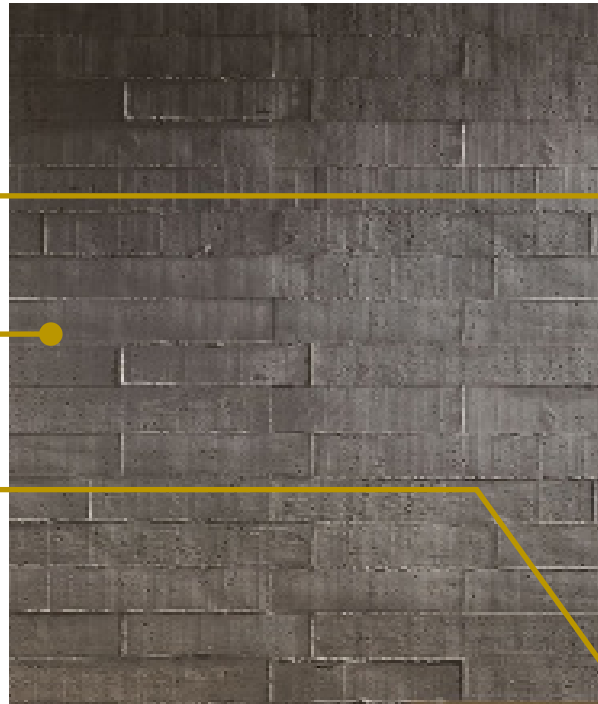

CONCRETE WALL  
TEXTURE IDEA

TILE FLOOR IDEA

PORTAL IDEA

PAINT PALETTE



WOOD CEILING  
COLOR

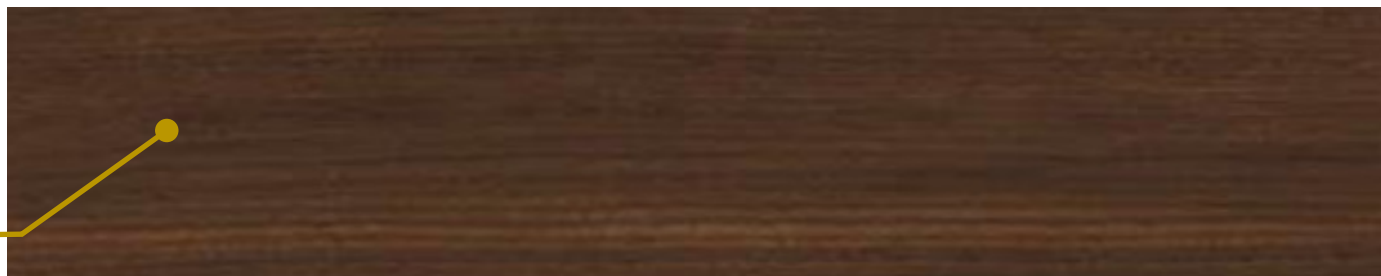

# Growth to 2050

\$100 M

## KEY ELEMENTS INCLUDED:

Police Headquarters:	100,000 S.F.
SRT Garage:	7,400 S.F.
Shell Space:	6,000 S.F.
Cov./ Fenced Impound Lot:	8,000 S.F.
PD Parking:	230 Total
- Paved Stalls:	225
- Covered & Paved Stalls:	05
Public Parking:	50 Total
Wetland 1 - Mitigation	

## NOT INCLUDED:

Police Headquarters Lost:	9,000 S.F.
Vehicle Upfit Garage Lost:	5,200 S.F.
Shell Space Lost:	24,600 S.F.
Reduced Impound Lot & Enclosure:	10,200 S.F.
PD Parking Lost:	158 Total
- Paved Stalls Lost:	60
- Stabilized Grass Parking:	98
Covering at Parking:	80 Stalls
Fuel Station w/ Canopy	

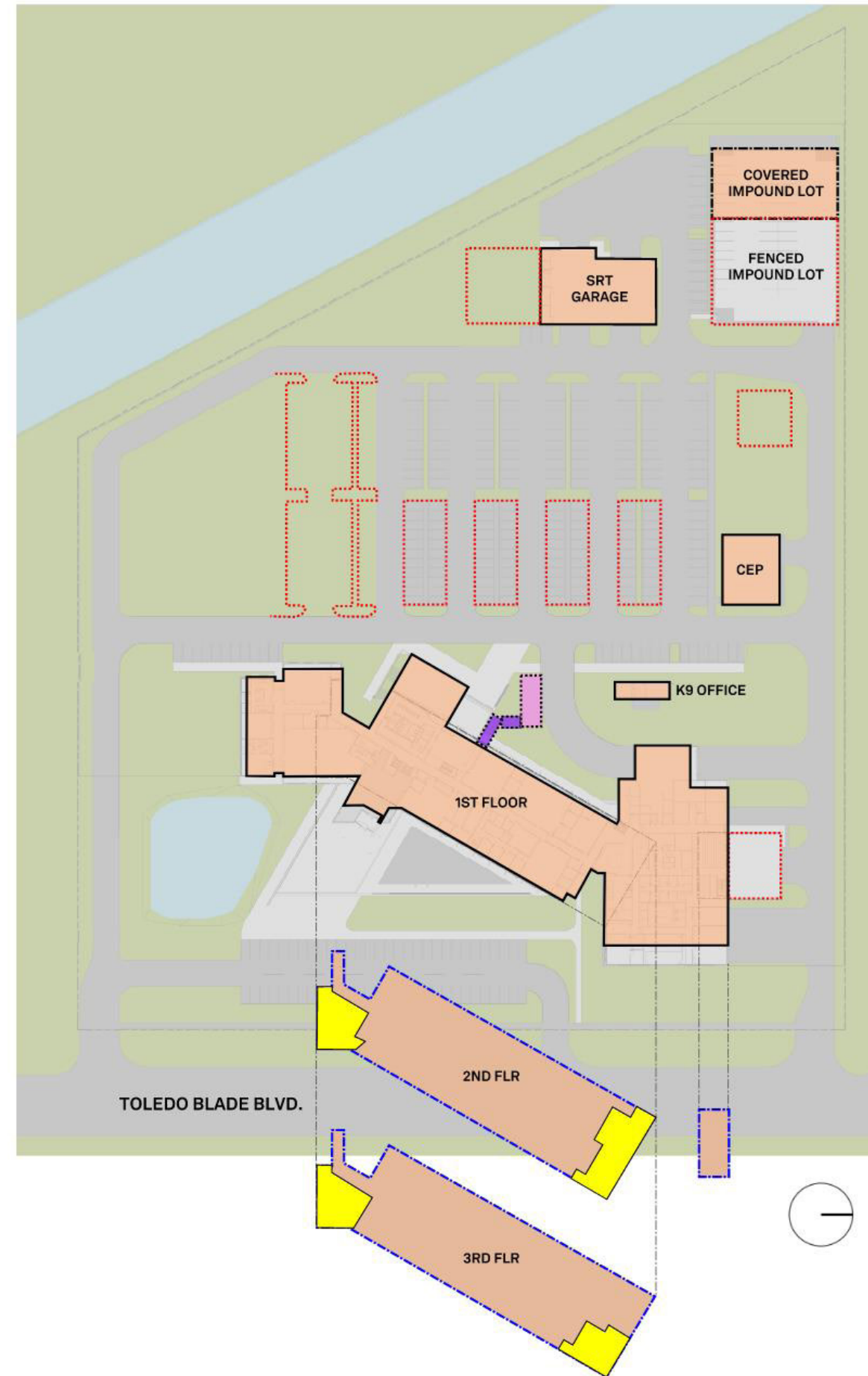



# Exterior Impact



# Growth to 2030

\$78 M

## KEY ELEMENTS INCLUDED:

Police Headquarters:	80,000 S.F.
- Retain Existing Headquarters	
PD Parking:	Code Minimum
Public Parking:	Code Minimum
Wetland 1 - Mitigation	

## NOT INCLUDED:

Police Headquarters Lost:	29,000 S.F.
SRT Garage:	7,400 S.F.
Vehicle Upfit Garage Lost:	5,200 S.F.
Shell Space Lost:	30,600 S.F.
Impound Lot & Enclosure:	18,200 S.F.
Covered Parking Lost:	85 Stalls
No Additional Parking	
Fuel Station w/ Canopy	
Renovate Existing Headquarters	

# Meeting Current Needs

\$50 M

## KEY ELEMENTS INCLUDED:

Police Headquarters:	48,000 S.F.
- Retain Existing Headquarters	
PD Parking:	Code Minimum
Public Parking:	Code Minimum
Wetland 1 - Mitigation	

## NOT INCLUDED:

Police Headquarters Lost:	61,000 S.F.
SRT Garage:	7,400 S.F.
Vehicle Upfit Garage Lost:	5,200 S.F.
Shell Space Lost:	30,600 S.F.
Impound Lot & Enclosure:	18,200 S.F.
Covered Parking Lost:	85 Stalls
No Additional Parking	
Fuel Station w/ Canopy	
Renovate Existing Headquarters	

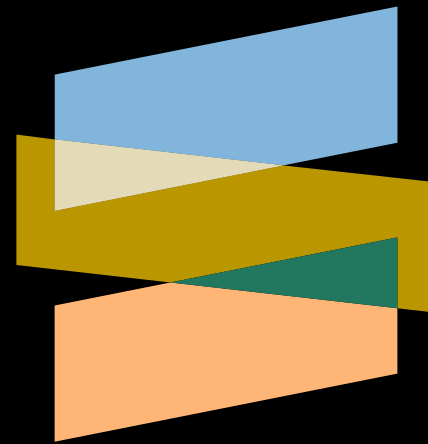

Design. Culture. Values.

# PDHQ comparative data



## Fort Myers

Estimated cost: \$80 million  
 Square feet: Unknown  
 Population: 92,245  
 GF budget: 161.9 million  
 % of GF budget: 49%  
 PD Positions: 310  
 Est. completion: 2026



## Bradenton

Estimated cost: \$30 million  
 Square feet: 46,000  
 Population: 55,905  
 GF budget: \$63.6 million  
 % of GF budget: 47%  
 PD positions: 202  
 Est. completion: 2025



## Fort Lauderdale

Estimated cost: \$129 million  
 Square feet: 191,000  
 Population: 182,760  
 GF budget: \$463.4 million  
 % of GF budget: 28%  
 PD positions: 700  
 Est. completion: 2025



## Hollywood

Estimated cost: \$85.2 million  
 Square feet: 100,000  
 Population: 154,909  
 GF budget: \$361.9 million  
 % of GF budget: 24%  
 PD positions: 509  
 Est. completion: 2026



## St. Petersburg

Cost: \$78.3 million  
 Square feet: 168,780  
 Population: 258,201  
 GF budget: \$263.8 million  
 % of GF budget: 30%  
 PD positions: 782  
 Finished in 2019



# Funding sources

- Sell current \$7 million PD HQ
- Any option chosen under \$80 million would require PD to keep current building plus build a new one



**Questions?**