

CITY OF NORTH PORT TAMIAMI TRAIL LINEAR PARKING IMPROVEMENT PROJECT CITY OF NORTH PORT SARASOTA COUNTY, FLORIDA



UTILITY NOTIFICATION
UTILITY LOCATIONS DEPICTED WITHIN THIS CONSTRUCTION PLAN SET HAVE BEEN COMPILED FROM FIELD MEASUREMENTS AND DOCUMENTS SUPPLIED BY THE VARIOUS UTILITY COMPANIES. THE ENGINEER MAKES NO CLAIM TO THE ACCURACY OF THE UTILITY LOCATIONS SHOWN ON THESE PLANS. THE CONTRACTOR SHALL NOTIFY ALL UTILITIES AND IS RESPONSIBLE FOR VERIFYING THE DEPTHS AND FIELD LOCATIONS OF ALL EXISTING UTILITIES PRIOR TO COMMENCEMENT OF CONSTRUCTION. ACTUAL UTILITY LOCATIONS AND DEPTHS MAY VARY FROM THOSE DEPICTED WITHIN THIS CONSTRUCTION PLAN SET. PROTECTION OF ALL UTILITIES WITHIN THE AREA OF CONSTRUCTION AND ALL COSTS TO REPAIR DAMAGES TO EXISTING UTILITIES AND DISTURBED AREAS SHALL BE BORNE BY THE CONTRACTOR.

UTILITY CONTACTS:

CITY OF NORTH PORT UTILITIES	DARRELL SMITH (941) 240-8021
CITY OF NORTH PORT PUBLIC WORKS	STEVE PLATT (941) 628-8022
COMCAST	GARY HILL (941) 342-3586
TECO: PEOPLES GAS	DANNY SHANAHAN (941) 342-4006
VERIZON FLORIDA, INC.	DENISE HUTTON (941) 906-6722
FLORIDA POWER & LIGHT	DAVID ALVAREZ (941) 423-4909

INDEX OF DRAWINGS

- 1.0 COVER SHEET
- 1.1 GENERAL NOTES, LEGEND, AND ABBREVIATIONS SHEET
- 1.2 PROJECT DETAILS AND TYPICAL SECTION SHEET
- 1.3 BEST MANAGEMENT PRACTICES NOTES AND DETAIL SHEET
- 2.0 KEY MAP AND MASTER IMPROVEMENT PLAN SHEET
- 2.1 PROPOSED PARKING PLAN AND PROFILE SHEET
- 2.2 PROPOSED PARKING PLAN AND PROFILE SHEET
- 2.3 PROPOSED PARKING PLAN AND PROFILE SHEET
- 3.0 PROJECT CROSS SECTION LOCATION SHEET
- 3.1 PROJECT CROSS SECTIONS
- 3.2 PROJECT CROSS SECTIONS

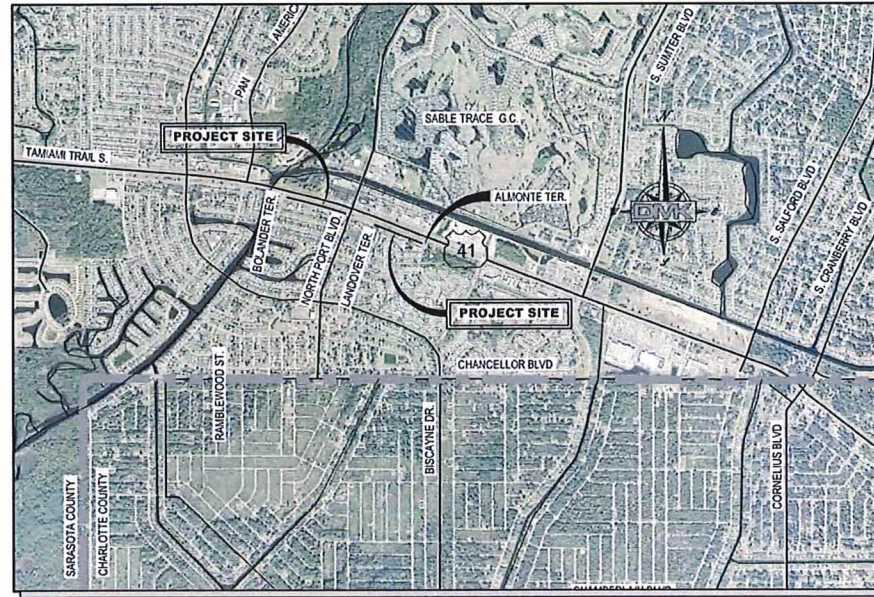
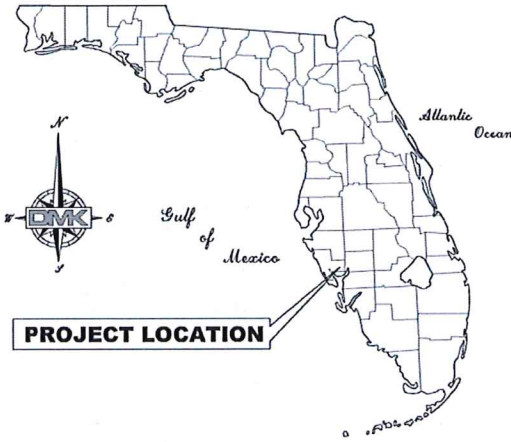

LOCATION MAP
N.T.S.
**BOLANDER TERRACE to NORTH PORT BLVD &
CONISTON TERRACE to ALMONTE TERRACE**
SECTION 32, TOWNSHIP 39S, RANGE 21E

~ **BID SET** ~
MAY 2017

NOTE:

ORIGINAL CONSTRUCTION DRAWINGS PROVIDED BY DMK ASSOCIATES, INC. FOR THE CITY OF NORTH PORT ARE DRAWN TO SCALE AS SHOWN. HOWEVER THE SCALE OF THESE PLANS MAY CHANGE DUE TO REPRODUCTION AND THIS MUST BE CONSIDERED WHEN OBTAINING SCALED DATA.

PROJECT STANDARDS:

THESE PLANS COMPLY WITH ALL APPLICABLE STANDARDS, INCLUDING THE MANUAL OF UNIFORM MINIMUM STANDARDS FOR DESIGN, CONSTRUCTION AND MAINTENANCE FOR STREETS AND HIGHWAYS.

THESE PLANS ARE IN COMPLIANCE WITH THE AMERICANS WITH DISABILITIES ACT (A.D.A.) MANUAL.

THESE PLANS ARE IN COMPLIANCE WITH THE FLORIDA ACCESSIBILITY CODE AT CURBS, GUTTERS, SIDEWALKS, INTERSECTIONS, ETC.

THESE PLANS ARE IN COMPLIANCE WITH THE CITY OF NORTH PORT UNIFIED LAND CODE (ULDC).

GOVERNING STANDARDS AND SPECIFICATIONS:

CITY OF NORTH PORT ULDC. FLORIDA ADA ACCESSIBILITY CODE.

SURVEY HORIZONTAL & VERTICAL CONTROL NOTES:

1. **HORIZONTAL DATUM:** NAD 83 (90), FLORIDA STATE PLANE COORDINATES, WEST ZONE.

2. **VERTICAL DATUM:** NAVD 1988.

CITY COMMISSIONERS:

VANESSA CARUSONE, VICE-MAYOR	SEAT 1
CHRISTOPHER HANKS	SEAT 2
DEBBIE McDOWELL	SEAT 3
JILL JUKE	SEAT 4
LINDA YATES, MAYOR	SEAT 5

CITY MANAGER (INTERIM):

PETER LEAR

ENGINEER & SURVEYOR:



OFFICE

421 COMMERCIAL COURT, SUITE C
VENICE, FLORIDA 34292
P: (941) 412-1293
F: (941) 412-1043
info@dmkassoc.com

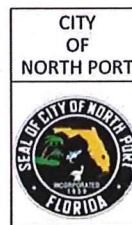

PREPARED FOR:
CITY OF NORTH PORT
DEPARTMENT OF PUBLIC WORKS

1100 NORTH CHAMBERLAIN BOULEVARD
NORTH PORT, FLORIDA. 34286
P: (941) 240-8320
F: (941) 240-8063
BEN NEWMAN, P.E.
PUBLIC WORKS PROJECT MANAGER

ENGINEER OF RECORD
MARY ANN LIND, P.E.
FLORIDA LICENSE No. 58093
C.A. No. 3943

GENERAL NOTES:

- CONTRACTOR SHALL NOTIFY ENGINEER IMMEDIATELY OF ANY AND ALL FIELD CONDITION(S) THAT WILL PREVENT THE CONSTRUCTION OF ANY ELEMENT OF THE PROPOSED PROJECT IN ACCORDANCE WITH THE DESIGN STANDARDS AND APPROVED CONSTRUCTION DOCUMENTS FOR THIS PROJECT. IN ALL INSTANCES, THE CONTRACTOR SHALL NOTIFY THE ENGINEER PRIOR TO ANY INSTALLATION OF WORK. IF CONTRACTOR ELECTS TO INSTALL ANY WORK WHICH DEVIATES FROM THE APPROVED CONSTRUCTION DOCUMENTS WITHOUT PRIOR WRITTEN APPROVAL BY THE ENGINEER, THEN THE COST OF REMOVAL, REPAIR, REDESIGN AND/OR REPLACEMENT WILL BE THE RESPONSIBILITY OF THE CONTRACTOR UNLESS SAID WORK IS ACCEPTED AS AN AS-BUILT DEVIATION BY THE CITY OR THE ENGINEER. IN NO CASE SHALL THE CITY OR ENGINEER BE RESPONSIBLE FOR THE COST OF REMOVAL, REPAIR, REDESIGN AND/OR REPLACEMENT OF ANY WORK THAT DEVIATES FROM THE DESIGN STANDARDS AND APPROVED CONSTRUCTION DOCUMENTS FOR THIS PROJECT.
- ALL NEW STORM DRAIN LINES AND ASSOCIATED COMPONENTS SHALL BE CONSTRUCTED TO ALIGNMENT AND LOCATION AS SHOWN IN THE PLANS UNLESS OTHERWISE DIRECTED BY ENGINEER.
- ALL REINFORCED CONCRETE PIPE (RCP), & ELLIPTICAL REINFORCED CONCRETE PIPE (ERCP) SHALL BE CLASS III PIPE PER FDOT INDEX 205.
- ALL ERCP SHALL BE INSTALLED WITH THE LONGITUDINAL AXIS PLACED HORIZONTALLY UNLESS NOTED OTHERWISE.
- ALL EARTHWORK AND COMPACTION SHALL BE INSPECTED BY THE ENGINEER OR DULY APPOINTED REPRESENTATIVE, PRIOR TO FILLING OR CONSTRUCTION.
- IT IS THE CONTRACTOR'S RESPONSIBILITY, PRIOR TO BIDDING, TO INSPECT THE JOB SITE AND TO BE TOTALLY FAMILIAR WITH THE PLANS AND THEIR INTENT.
- THE CONTRACTOR SHALL PROVIDE CERTIFIED RECORD INFORMATION THAT MEET THE CITY OF NORTH PORT PERMIT REQUIREMENTS TO THE ENGINEER.
- CONTRACTOR SHALL MAINTAIN SLOPES AND SOD UNTIL COMPLETION AND ACCEPTANCE OF TOTAL PROJECT OR GROWTH IS ESTABLISHED. UNTIL ACCEPTANCE, ALL EROSION, SILTATION AND MAINTENANCE OF GRADES SHALL BE THE RESPONSIBILITY OF THE CONTRACTOR.
- IT IS THE INTENT OF THE CITY OF NORTH PORT TO SAVE ALL EXISTING TREES IN THE PROJECT LIMITS WHERE FEASIBLE. CONTRACTOR SHALL PROVIDE THE NECESSARY MEASURES TO ENSURE TREES ARE PROTECTED DURING SIDEWALK CONSTRUCTION.
- WHERE EXCAVATIONS ARE IN CLOSE PROXIMITY OF TREES, THE CONTRACTOR SHALL USE EXTREME CARE IN NOT DAMAGING THE ROOT SYSTEM. NO EQUIPMENT, SUPPLIES, OR VEHICLES SHALL BE STORED OR PARKED WITHIN THE DRIP LINES OF THE TREES TO REMAIN AND BE PRESERVED. IT SHALL BE THE RESPONSIBILITY OF THE CONTRACTOR TO INFORM ALL EMPLOYEES AND SUBCONTRACTORS OF THIS REQUIREMENT AND TO ENFORCE SAME.
- CONTRACTOR SHALL TAKE ALL NECESSARY PRECAUTIONS DURING CONSTRUCTION TO CONTROL EROSION AND PREVENT THE TRANSPORT OF SEDIMENT TO SURFACE WATERS, STORM DRAINS AND/OR ADJACENT PROPERTIES. SILT SCREENS, AND/OR FILTER FABRIC, OR OTHER STANDARD EROSION CONTROL DEVICES SHALL BE PROVIDED IN ACCORDANCE WITH F.D.O.T. STANDARDS. EROSION CONTROL DEVICES (E.G. SILT SCREENS, TURBIDITY CURTAINS) SHALL BE INSTALLED AND MAINTAINED IN LOCATIONS INDICATED ON THE CONSTRUCTION PLANS OR ADDITIONALLY AT LOCATIONS WHERE CONSTRUCTION ACTIVITIES OR UNSTABILIZED SOILS HAVE THE POTENTIAL TO BE TRANSPORTED INTO AND/OR RESULT IN SEDIMENTATION OR TURBIDITY ENTERING WATERWAYS, WATER BODIES, WETLANDS, OR PRIVATE PROPERTIES.
- CONTRACTOR SHALL MAINTAIN TRAFFIC IN ACCORDANCE WITH FDOT INDEX 600 (2012/2013) AND THE CITY OF NORTH PORT STANDARDS.
- CONTRACTOR SHALL SPRINKLE OR OTHERWISE APPLY WATER TO EXPOSED CONSTRUCTION AREAS TO CONTROL SIGNIFICANT EROSION AND FUGITIVE DUST.
- ALL CLEARING, GRUBBING AND CONSTRUCTION DEBRIS TO BE REMOVED FROM SITE AND PROPERLY DISPOSED.
- THE REMOVAL OF ANY EXISTING STRUCTURES OR STORM SEWERS, HEADWALLS ETC., SHALL BE CONSIDERED INCIDENTAL WORK AND NO ADDITIONAL COMPENSATION SHALL BE MADE FOR THESE ITEMS.
- EXISTING SIGNS IN THE SIDEWALK ALIGNMENT ARE TO BE REMOVED AND REPLACED AT AN APPROVED LOCATION. TEMPORARY SIGNAGE MAY BE REQUIRED PRIOR TO PERMANENT SIGN PLACEMENT.
- IF A CITY OF NORTH PORT-OWNED SIGN IS TO BE REMOVED, COORDINATE RETURNING THE CITY OF NORTH PORT PROPERTY WITH THE PUBLIC WORKS DEPARTMENT AT 941-240-8050.
- ALL SIGNS SHALL BE CONSTRUCTED IN ACCORDANCE WITH MUTCD CRITERIA FOR SIGN SIZE, SHAPE, LETTERING DIMENSIONS AND REFLECTIVITY.
- ALL STREET LIGHT SPLICES SHALL BE MADE USING "RAYCHEM GHFC-2" OR APPROVED EQUAL, AND BE LOCATED IN THE FULL BOX.
- THE CONTRACTOR SHALL COORDINATE RELOCATION OF ALL AFFECTED UTILITIES WITH THE APPROPRIATE UTILITY COMPANIES.
- THE LOCATION OF EXISTING UNDERGROUND UTILITIES, SHOWN IN PLANS, HAVE BEEN APPROXIMATED AND HAVE NOT BEEN INDEPENDENTLY VERIFIED. THE CONTRACTOR SHALL DETERMINE THE EXACT LOCATION OF ALL UTILITIES PRIOR TO COMMENCING WORK, AND AGREES TO BE FULLY RESPONSIBLE FOR ALL DAMAGES WHICH MIGHT BE OCCASIONED BY THE CONTRACTORS FAILURE TO EXACTLY LOCATE AND PRESERVE ALL UNDERGROUND UTILITIES. CALL SUNSHINE STATE ONE CALL FLORIDA, INC. @ (PHONE No. 811), 48 HOURS BEFORE YOU DIG.
- IF UTILITY POLES, GUY WIRES, CATV BOXES, COMMUNICATION SPICE BOXES, OR OTHER UTILITY OBSTRUCTIONS LOCATED IN THE AREA WHERE SIDEWALKS ARE TO BE CONSTRUCTED, THEN THE ENGINEER SHALL BE NOTIFIED, IF THEY PRESENT UNUSUAL PROBLEMS. ALL WATER AND SEWER VALVE BOXES, METER BOXES, BACKFLOW PREVENTERS AND AIR RELEASE VALVES ARE TO BE ADJUSTED TO FINISHED GRADE BY THE CONTRACTOR.
- SOD SHALL BE LAID AT BACK OF CURB, PAVEMENT EDGES, SWALES, INLETS, MITERED ENDWALLS, AND DETENTION AREAS AS SHOWN IN DETAILS OR AS DIRECTED BY THE ENGINEER, AND IN ALL AREAS DISTURBED BY THE WORK THAT IS NOT UNDER THE SIDEWALK
- ALL AREAS DISTURBED BY CONSTRUCTION ARE TO BE SODDED WITHIN 7 CALENDAR DAYS TO PREVENT EROSION
- ALL PROPOSED GROUND ELEVATIONS ARE FINISHED SOD ELEVATIONS. FINISH GRADING SHALL BE 0.2 FEET LESS THAN ELEVATIONS SHOWN TO ALLOW FOR THICKNESS OF SOD.
- ALL TYPE B (CONCRETE, BROKEN ASPHALT, ROCKS), TYPE C (VEGETATIVE LAND CLEARING DEBRIS), OR TYPE D (REFUSE, PLASTIC, WOOD, METAL, ETC.) FILLS GENERATED BY THE PROJECT SHALL BE DISPOSED OF AT A PERMITTED LANDFILL OR RECYCLE FACILITY. ALL EXCESS TYPE A (CLEAN EARTHEN MATERIAL) SHALL BE HAULED TO A PERMITTED LANDFILL, CITY OWNED PROPERTY, OR SITE AUTHORIZED UNDER A BUILDING PERMIT, EARTH MOVING PERMIT, OR CONSTRUCTION PLAN APPROVAL TO RECEIVE FILL.
- DURING THE PROJECT, ALL CLEARING AND STOCKPILING OF FILLS SHALL BE CONTAINED WITHIN THE CITY OF NORTH PORT RIGHTS-OF-WAY, OR WITHIN DESIGNATED CONSTRUCTION EASEMENTS. TEMPORARY STOCKPILING OF ANY TYPE A, B, C, OR D FILLS UPON PRIVATE PROPERTIES REQUIRES AUTHORIZATION FROM THE CITY OF NORTH PORT IN THE FORM OF AN EARTH MOVING PERMIT OR TEMPORARY CONSTRUCTION EASEMENT.
- IT IS THE CONTRACTORS RESPONSIBILITY TO BARRICADE AREAS UNDER CONSTRUCTION PURSUANT TO MAINTENANCE OF TRAFFIC PLANS OR AS OTHERWISE APPROVED FOR USE.

GENERAL NOTES (CONTINUED):

- PLEASE NOTE THAT ON PLANS, POSITIVE DRAINAGE SHALL BE PROVIDED FOR ALL ADJACENT PROPERTIES AND MAINTAIN ALL HISTORIC OFFSITE FLOW PATTERNS.
- ALL PARKING STALL PAVEMENT MARKINGS SHALL PER FDOT INDEX 710 "PAINTED PAVEMENT MARKING", SEE DETAIL ON SHEET 1.2.
- A TREE PERMIT WILL BE REQUIRED PRIOR TO ANY CONSTRUCTION, NATIVE VEGETATIVE REMOVAL WITHIN THE DRIPLINE OF A TREE, AND/OR TREE REMOVAL.
- ANY WELLS DISCOVERED DURING EXCAVATION, EARTHMOVING OR CONSTRUCTION MUST BE REPORTED TO THE SARASOTA COUNTY HEALTH DEPARTMENT ENVIRONMENTAL HEALTH WITHIN 24 HOURS OF DISCOVERY.
- ALL WELLS ON SITE SHALL BE PLUGGED BY A LICENSED WELL DRILLING CONTRACTOR IN ACCORDANCE WITH ALL APPLICABLE STATE AND LOCAL REGULATIONS.
- ALL CONCRETE DRAINAGE STRUCTURES AND PIPES SHALL BE CONSTRUCTED WITH 3,000 PSI CONCRETE.
- ALL DRAINAGE PIPE JOINTS SHALL BE WRAPPED PER FDOT INDEX 280.
- CONSTRUCTED SIDEWALK SHALL BE IN COMPLIANCE WITH THE AMERICANS WITH DISABILITIES ACT AND THE FLORIDA ACCESSIBILITY CODE.
- THE CONTRACTOR SHALL BE RESPONSIBLE FOR PROVIDING AREAS FOR STAGING AND STOCKPILING CONSTRUCTION MATERIALS AND WASTE OVERBURDEN INCLUDING APPROPRIATE EROSION AND SEDIMENTATION CONTROL DEVICES AND BEST MANAGEMENT PRACTICES.
- THE CONTRACTOR SHALL BE RESPONSIBLE FOR THE PROPER HANDLING AND DISPOSAL OF CONTAMINATED SOILS IN ACCORDANCE WITH ALL STATE AND FEDERAL LAWS.
- THE ONLY ACCEPTABLE METHODS FOR REMOVAL OF PAVEMENT MARKINGS ARE HYDRO-BLASTING OR GRINDING. EXISTING MARKINGS SHALL NO LONGER BE VISIBLE UPON COMPLETION OF THE REMOVAL, AS DEEMED BY THE ASSIGNED THE CITY OF NORTH PORT PROJECT INSPECTOR / ENGINEER.
- CONTRACTOR SHALL BE RESPONSIBLE FOR OBTAINING DEWATERING PERMIT BY SWFWMD (IF REQUIRED) AND SHALL ALLOW 45 DAYS FOR APPROVAL PROCESS. THE CONTRACTOR SHALL BE RESPONSIBLE FOR FOLLOWING ALL PERMIT REQUIREMENTS RELATED TO DEWATERING. ALL WORK PERFORMED, INCLUDING PERMITTING, WILL BE INCIDENTAL TO THE PAYMENT ITEMS OF STANDARD SPECIFICATIONS, SECTION 120, EXCAVATION, EMBANKMENT AND GRADING.
- IF A COPPER TORTOISE (OR ITS EVIDENCE, SUCH AS BURROWS...) IS OBSERVED DURING CONSTRUCTION, ALL CLEARING AND EARTHMOVING ON-SITE SHALL CEASE. THE CONTRACTOR SHALL CONSULT WITH THE FWC AND/OR US FISH AND WILDLIFE SERVICE REGARDING NECESSARY PROTECTION MEASURES AND PROVIDE EVIDENCE OF SUCH CONSULTATION TO THE CITY PRIOR TO RESUMING WORK.

PERVIOUS PAVEMENT MAINTENANCE:

- ALL POROUS PAVEMENT SHOULD BE INSPECTED ANNUALLY.
- INSPECTIONS SHOULD BE CONDUCTED AFTER LARGE STORM EVENTS. INSPECTIONS SHOULD CHECK FOR SURFACE PONDING THAT MIGHT INDICATE LOCAL OR WIDESPREAD CLOGGING.
- EVERY WEEK LITTER AND LEAF REMOVAL SHOULD BE CARRIED OUT. INDUSTRIAL AND BACKPACK BLOWERS ARE RECOMMENDED EQUIPMENT FOR THIS TASK.
- THE POROUS PAVEMENT SURFACE SHOULD BE VACUUM SWEEP AT LEAST 2 TIMES PER YEAR. HIGH PRESSURE JET HOSEING TO KEEP THE PORES OPEN, SHOULD BE PERFORMED ONE (1) TIME PER YEAR.
- SPOT CLOGGING OF THE POROUS PAVEMENT CAN BE RELIEVED BY DRILLING HALF-INCH HOLES THROUGH THE POROUS PAVEMENT LAYER EVERY FEET. IN CASES WHERE CLOGGING OCCURS IN A LOW SPOT IN THE PAVEMENT, IT MAY BE ADVISABLE TO INSTALL A DROP INLET TO ROOT WATER INTO THE STONE RESERVOIR. POTHOLE AND CRACKS CAN BE REPAIRED USING CONVENTIONAL, NONPOROUS PATCHING MIXES AS LONG AS THE CUMULATIVE AREA REPAIRED DOES NOT EXCEED 10% OF THE PARKING LOT AREA.

THESE CONDITIONS ARE IN ADDITION TO ANY JURISDICTIONAL AGENCY REQUIREMENTS. PLEASE REFER TO THE SPECIFIC AND STANDARD CONDITIONS OF THE SWFWMD PERMIT

HISTORY CENTER NOTES:

- THE FOLLOWING REQUIREMENTS APPLY TO ALL BUILDING CONSTRUCTION OR ALTERATION, OR LAND ALTERATION ACTIVITIES.
- IF EVIDENCE OF THE EXISTENCE OF CULTURAL RESOURCES IS DISCOVERED OR OBSERVED AT DEVELOPMENT SITES OR DURING DEVELOPMENT ACTIVITIES AFTER FINAL APPROVAL, ALL WORK SHALL CEASE IN THE AREA OF EFFECT AS DETERMINED BY THE DIRECTOR, THE DEVELOPER, OWNER, CONTRACTOR, OR AGENT THEREOF SHALL NOTIFY THE DIRECTOR OF HISTORICAL RESOURCES WITHIN TWO WORKING DAYS. EXAMPLES OF SUCH EVIDENCE MAY INCLUDE WHOLE OR FRAGMENTARY STONE TOOLS, SHELL TOOLS, ABORIGINAL OR HISTORIC POTTERY, HISTORIC GLASS, HISTORIC BOTTLES, BONE TOOLS, HISTORIC BUILDING FOUNDATIONS, SHELL MOUNDS, SHELL MIDDEN, OR SAND MOUNDS. THE DIRECTOR SHALL ASSESS THE SIGNIFICANCE OF THE FINDS WITHIN THREE WORKING DAYS OF NOTIFICATION AND TO MITIGATE ANY ADVERSE EFFECTS SO AS TO MINIMIZE DELAYS TO DEVELOPMENT ACTIVITIES.
 - IF ANY HUMAN SKELETAL REMAINS OR ASSOCIATED BURIAL ARTIFACTS ARE DISCOVERED AT DEVELOPMENT SITES OR DURING DEVELOPMENT ACTIVITY, ALL WORK IN THAT PARTICULAR AREA MUST CEASE, AND THE PERMITTEE MUST IMMEDIATELY NOTIFY THE NEAREST LAW ENFORCEMENT OFFICE AND NOTIFY THE DIRECTOR OF HISTORICAL RESOURCES WITHIN TWO WORKING DAYS. ACCORDING TO CHAPTER 872, FLORIDA STATUTES, IT IS UNLAWFUL TO DISTURB, VANDALIZE, OR DAMAGE A HUMAN BURIAL..

WATER RESOURCE NOTES:

- EROSION AND SEDIMENT CONTROL BEST MANAGEMENT PRACTICES (BMPs) IN ADDITION TO THOSE PRESENTED ON THE PLANS AND OUTLINED IN THE EROSION AND SEDIMENT CONTROL PLAN (ECP) AND STORMWATER POLLUTION PREVENTION PLAN (SWPPP) SHALL BE IMPLEMENTED AS NECESSARY TO PREVENT TURBID DISCHARGES FROM FLOWING ONTO ADJACENT PROPERTIES OR ROADWAYS, OFF SITE STORMWATER CONVEYANCES OR RECEIVING WATERS, OR ON SITE WETLANDS AND SURFACE WATERS. BMPs SHALL BE DESIGNED, INSTALLED, AND MAINTAINED BY THE SITE OPERATOR TO ENSURE THAT OFF SITE SURFACE WATER QUALITY REMAINS CONSISTENT WITH STATE AND LOCAL REGULATIONS. [THE OPERATOR IS THE ENTITY THAT OWNS OR OPERATES THE CONSTRUCTION ACTIVITY AND HAS AUTHORITY TO CONTROL THOSE ACTIVITIES AT THE PROJECT NECESSARY TO ENSURE COMPLIANCE.]
- THE OPERATOR SHALL ENSURE THAT ADJACENT PROPERTIES ARE NOT IMPACTED BY WIND EROSION, OR EMISSIONS OF UNCONTAINED PARTICULATE MATTER IN ACCORDANCE WITH RULE 62-296.320(4)(C)1, F.A.C., BY TAKING APPROPRIATE MEASURES TO STABILIZE AFFECTED AREAS.
- FUEL AND OTHER PETROLEUM PRODUCT SPILLS THAT ENTER STORMWATER DRAINS OR WATERBODIES, OR FUEL AND OTHER PETROLEUM PRODUCT SPILLS THAT ARE IN EXCESS OF 25 GALLONS SHALL BE CONTAINED, CLEANED UP, AND IMMEDIATELY REPORTED TO PUBLIC WORKS (941) 240-8050. SMALLER GROUND SURFACE SPILLS SHALL BE CLEANED UP AS SOON AS PRACTICAL.
- IF CONTAMINATED SOIL AND/OR GROUNDWATER IS DISCOVERED DURING DEVELOPMENT OF THE SITE, ALL ACTIVITY IN THE VICINITY OF THE CONTAMINATION SHALL IMMEDIATELY CEASE, AND PUBLIC WORKS SHALL BE CONTACTED (941) 240.8050.

ABBREVIATIONS:

NOTE: THE PERIOD MAY OR MAY NOT BE SHOWN IE. ASOP OR A.S.O.P.

@	=	AT	M-EX	=	MATCH EXISTING
ASOP	=	AS SHOWN ON PLANS	MH	=	MANHOLE
ASTM	=	AMERICAN STD TESTING AND MATERIAL	MIN	=	MINIMUM
BFP	=	BACK FLOW PREVENTION DEVICE	N	=	NORTH
BOSI	=	BACK OF SIDEWALK INLET	No	=	NUMBER
CA	=	CERTIFICATION	NWL	=	NORMAL WATER LINE
C	=	CENTERLINE	NTS	=	NOT TO SCALE
CO	=	CLEANOUT	O/C	=	ON CENTER
CONC	=	CONCRETE	PGL	=	PROFILE GRADE LINE
CONP	=	CITY OF NORTH PORT	PREF	=	PREFERRED
CR	=	COUNTY ROAD	PROJ	=	PROJECT
CY	=	CUBIC YARD	PSI	=	POUNDS PER SQUARE INCH
(C)	=	CALCULATED	PVMT	=	PAVEMENT
DBI	=	DITCH BOTTOM INLET	R	=	RADIUS
DEPT	=	DEPARTMENT	RCP	=	REINFORCED CONCRETE PIPE
DHWL	=	DESIGN HIGH WATER LINE	REQ'D	=	REQUIRED
DIA	=	DIAMETER	R/W	=	RIGHT OF WAY
DR	=	DESIGN RATIO	S	=	SOUTH
EA	=	EACH	SCB	=	SIGNAL CONTROL BOX
ESMT	=	EASEMENT	SDR	=	SIZE DESIGN RATIO
EL	=	ELEVATION	SF	=	SILT FENCE
FF	=	FINISHED FLOOR	SHLDR	=	SHOULDER
FDC	=	FIRE DEPARTMENT CONNECTION	SHWT	=	SEASONAL HIGH WATER TABLE
FDOT	=	FLORIDA DEPARTMENT OF TRANS	SR	=	STATE ROUTE
FLA	=	FLORIDA	STD	=	STANDARD
FS	=	FIRE SERVICE	SQ YD	=	SQUARE YARD
FT	=	FOOT/FEET	S/W	=	SIDEWALK
FW	=	FIRE MAIN	TEMP	=	TEMPORARY
GA	=	GAUGE	TCB	=	TRAFFIC CONTROL BOX
GB	=	GRADE BREAK	TK	=	THICK
HORIZ	=	HORIZONTAL	TRANS	=	TRANSPORTATION
HP	=	HIGH POINT	TRNS	=	TRANSITION
IN	=	INCHES	TRVL	=	TRAVEL
INSTAL	=	INSTALLATION	TYP	=	TYPICAL
INVT	=	INVERT	UNK	=	UNKNOWN
LB	=	LAND SURVEYING BUSINESS	W	=	WEST
LIC	=	LICENSE	WI	=	WITH
LF	=	LINEAR FOOT	WM	=	WATER MAIN
M	=	METER	WWF	=	WELDED WIRE FABRIC
MAX	=	MAXIMUM	VAR	=	VARIES
MES	=	MITERED END SECTION	VERT	=	VERTICAL

SURVEY ABBREVIATIONS AND LEGEND:

Alum.	=	Arc	(P)	=	Plot Data
Bldg.	=	Building	P.C.	=	Point of Curvature
B.M.	=	Bench Mark	P.C.C.	=	Point of Compound Curvature
(C)	=	Calculated data	P.C.P.	=	Permanent Control Point
C.D.	=	Chord dimension	P.I.	=	Point of Intersection
C.B.S.	=	Concrete Block and Stucco	P.K.	=	PARKER-KALON
C.M.	=	Concrete Monument	P.O.B.	=	Point of Beginning
Conc.	=	Concrete	P.O.C.	=	Point of Commencement
(A)	=	Dead data	P.O.L.	=	Point on Line
D.N.R.	=	Department of Natural Resources	P.O.T.	=	Point of Terminus
D.O.T.	=	Department of Transportation	P.R.C.	=	Point of Reverse Curvature
Drain.	=	Drainage	P.R.M.	=	Permanent Reference Monument
Disc.	=	Description data	P.T.	=	Point of Tangency
El.	=	Elevation	R.	=	Radius
Esmt	=	Easement	R/W	=	Right-of-Way
Fin. Fl.	=	Finished Floor	S.F.	=	Square Feet
Fnd.	=	Found	Sta.	=	Station
Inv.	=	Invert	T.B.M.	=	Temporary Bench Mark
I.P.	=	Iron Pipe	Typ.	=	Typical
I.R.	=	Iron Rod	(U)	=	Unrecorded data
L.B.	=	Land Surveying Business	U.S.G.S.	=	United States Geodetic Survey
(M)	=	Measured Data	UR	=	Utility
N.A.V.D.	=	North American Vertical Datum	WTFW	=	Waterway
N.G.V.D.	=	National Geodetic Vertical Datum	Δ	=	Delta
O.R.	=	Official Records	⊕	=	Centerlines
			Ⓜ	=	Property Line

LEGEND:
Legend symbols are not to scale and are for graphic I.D. only.

■	=	Found 4"x4" Concrete Monument (number noted if any)	Ⓜ	=	Sewer Cleanout	⊕	=	Light Pole
●	=	Found No. 5 Rebar (I.D. noted if any)	Ⓢ	=	Water Service	⊠	=	Street Light Box
▲	=	Found P.C. Nail and Disc (I.D. noted if any)	Ⓤ	=	Well/Monitor/Irrigation	⊙	=	Ground Light
△	=	Spot Elevation	Ⓟ	=	Sanitary Sewer Manhole	⊞	=	Backflow Preventer
□	=	Set 4"x4" Concrete Monument with Cap L.B. #3943	Ⓠ	=	Storm Manhole	—/—	=	Overhead Utility Line
○	=	Set No. 5 Rebar with Cap L.B. #3943	Ⓡ	=	Miscellaneous Manhole	—X—	=	Barb Wire or Wire Fence
⊗	=	Set Mag. Nail and Disc L.B. #3943	Ⓢ	=	Electric Service	— —	=	Chain Link Fence
⊕	=	Utility Pole	Ⓣ	=	Electric Hand Hole/Manhole	—WTR—	=	Wooden Fence
⊖	=	Guy Wire Anchor	Ⓤ	=	Telephone Riser/Hand Hole	—TEL—	=	Buried Telephone Line
⊗	=	Water Meter	Ⓟ	=	Cable TV	—SEW—	=	Buried Sanitary Sewer
⊗	=	Water Valve	Ⓠ	=	Mail Box	—ELEC—	=	Buried Electric Line
⊗	=	Sewer Valve	Ⓡ	=	Mail Box	—RW—	=	Buried Reuse Water Line
⊗	=	Sewer Service	Ⓢ	=	Road Sign	—GAS—	=	Buried Gas Line
⊗	=	Fire Hydrant				—SF—	=	Silt Fence

EROSION CONTROL NOTES

1. GENERAL

THE CONTRACTOR SHALL PROVIDE ALL LABOR, EQUIPMENT, TOOLS, MATERIALS AND SERVICES NEEDED TO INSTALL ALL EROSION AND SEDIMENT CONTROL MEASURES. THESE MEASURES SHALL CONFORM TO THE PLANS AND SPECIFICATIONS AND ALL APPLICABLE STATE AND LOCAL REQUIREMENTS.

2. WETLAND PROTECTION

IN AREAS OF CONSTRUCTION ADJACENT TO WETLANDS, THE FOLLOWING SHALL BE PERFORMED:

- a) THE ACTUAL WETLAND AND REQUIRED BUFFERS, AS SHOWN ON THE PLANS, MUST BE ESTABLISHED AND PLOTTED OFF PRIOR TO THE START OF ANY CONSTRUCTION ACTIVITY ADJACENT TO SAID AREAS.
- b) PRIOR TO THE PLACEMENT OF ANY FILL MATERIAL ADJACENT TO WETLANDS OR BUFFER AREAS, A SILTATION BARRIER SHALL BE CONSTRUCTED.
- c) NO FIRM EROSION OF THE WETLANDS SHALL BE PERFORMED. WATER LEVELS IN THE WETLANDS SHALL BE MAINTAINED ACCORDING TO LEVELS EXISTING PRIOR TO SITE DISTURBANCE.
- d) IN AREAS OF WETLANDS IN WHICH WORK IS TO BE PERFORMED, SUCH AREAS MUST BE CLEARLY STAKED AND PLOTTED OFF, ALONG SUCH LIMITS, A SILTATION BARRIER MUST BE CONSTRUCTED.
- e) THE CONTRACTOR SHALL BE RESPONSIBLE FOR THE MAINTENANCE OF BARRIERS. BARRIERS SHALL REMAIN IN PLACE UNTIL ALL AREAS ARE STABILIZED.
- f) THE ENGINEER SHALL BE NOTIFIED IMMEDIATELY UPON DISTURBANCE OF WETLAND AREAS. THE CONTRACTOR IS RESPONSIBLE FOR ANY DAMAGE TO ALL PROTECTED AREAS.
- g) AREAS WHERE IMPACTS WILL BE PERFORMED SHALL BE STRIPPED OF EXISTING MATERIAL AND STOCKPILED FOR USE IN THE RE-CREATION OF THE DISTURBED AREAS OR IN LITTORAL ZONES.

3. EARTH MOVING ACTIVITIES

- a) THE CONTRACTOR SHALL EXERCISE CARE TO PRESERVE THE NATURAL LANDSCAPE AND SHALL PLAN CONSTRUCTION OPERATIONS SO AS TO PREVENT ANY UNNECESSARY DISTURBANCE, SCARPING, OR DESTRUCTION OF THE NATURAL SURROUNDINGS. EXCEPT WHERE CLEARING IS REQUIRED FOR PERMANENT WORK, FOR APPROVED CONSTRUCTION ROADS, OR FOR EXCAVATION OPERATIONS, ALL TREES, NATIVE SHRUBBERY AND VEGETATION SHALL BE PRESERVED AND SHALL BE PROTECTED FROM DAMAGE WHICH MAY BE CAUSED BY THE CONTRACTOR'S CONSTRUCTION OPERATIONS AND EQUIPMENT.
- b) THE FIRST STAGE OF THE EARTH MOVING ACTIVITY SHALL BE CONFINED TO THE EXCAVATION OF THE STORMWATER FACILITY.
- c) TOPSOIL SHOULD BE TAKEN FROM THE CONSTRUCTION AREAS AND SHOULD BE STOCKPILED FOR REUSE IN FINISHED GRADING. STOCKPILES SHOULD BE PLACED SO AS NOT TO ADD ANY ADDITIONAL SEDIMENT TO THE CONSTRUCTION. THE STOCKPILES SHOULD BE MULCHED AND/OR SEEDED WHEN EXPOSED BEYOND THIRTY (30) DAYS.
- d) GRADED AREAS ARE TO BE SEEDED AND/OR SOODED WITHIN THIRTY (30) DAYS FOLLOWING EARTH MOVING PROCEDURES. IF THE TIME OF YEAR IS NOT CONDUCE FOR PERMANENT SEEDING, A TEMPORARY MULCH AND/OR SEEDING SHOULD BE USED.
- e) TEMPORARY DIVERSION BEAMS AND/OR BARRIERS SHALL BE REMOVED ONLY AFTER THE CONSTRUCTION OF THOSE AREAS DIRECTED TO THE BEAMS AND/OR BARRIERS HAVE BEEN COMPLETED.
- f) THE SILT COLLECTION PONDS SHOULD BE REMOVED AND/OR REGRADED FOR PERMANENT USE, AS THE FINAL GRADING AND SEEDING OVERLAP THE AREA USED BY SAME.

4. FILLS

- a) LAND TO BE CUT OR FILLED SHOULD BE CLEARED OF TREES, STUMPS, ROOTS, BRUSH, SOILERS, SOO AND FERNS.
- b) FILL AREAS SHOULD BE SCARFED, KEED AND DRAINED.
- c) FILL MATERIAL SHOULD BE FREE OF SOO, ROOTS, OR OTHER DECOMPOSABLE MATERIAL.
- d) THE PLACING AND SPREADING OF FILL MATERIAL SHOULD BE STARTED AT THE LOWEST POINT.
- e) GENERALLY, A 1:6 SLOPE SHOULD BE USED UNLESS SPECIFIC ENGINEERING DATA SHOWS A STEEPER SLOPE IS STABLE. SLOPES OF 1:4 OR FLATTER ARE DESIRABLE FOR EROSION CONTROL AND MAINTENANCE.
- f) FILLS SHOULD BE SEEDED AND/OR MULCHED IMMEDIATELY UPON COMPLETION OF EARTH PLACEMENT.
- g) WATER MANAGEMENT SYSTEMS SHOULD BE PROVIDED TO PREVENT WATER CONCENTRATION AND ERODING THE FACE OF THE SLOPE. KEEP SURFACE WATER OFF THE FACE OF THE SLOPE.

5. CUTS

- a) DIVERSIONS SHOULD BE CONSTRUCTED AT TOP OF THE SLOPES PRIOR TO CUTTING OPERATIONS TO CONVEY WATER FROM FACE OF SLOPE.
- b) STEEPNESS OF CUTS WILL DEPEND ON SOIL TYPE AND DESIGN; HOWEVER, CUT SLOPES OF 1:4 OR FLATTER ARE DESIRABLE FOR EROSION CONTROL AND STABILITY.
- c) CUT SLOPES SHOULD BE BENCHED TO PROVIDE ACCESS FOR SEEDING AND MULCHING EQUIPMENT.
- d) CUT SLOPES SHOULD BE SEEDED AND/OR MULCHED IMMEDIATELY AFTER REMOVAL OF EARTH.

6. TEMPORARY SEDIMENT BASIN AND PERMANENT STORMWATER BASINS

- a) SITE PREPARATION
AREAS UNDER THE EMBANKMENT AND ANY STRUCTURAL WORKS SHALL BE CLEARED, CRUSHED AND STRIPPED OFF TOPSOIL TO REMOVE TREES, VEGETATION, ROOTS AND OTHER OBSTRUCTIONABLE MATERIALS. IN ORDER TO FACILITATE CLEAN-OUT AND RESTORATION, THE POOL AREA (MEASURED AT THE TOP OF THE SPILLWAY) WILL BE CLEARED OF ALL BRUSH AND TREES.
- b) CUT-OFF TRENCH
A CUT-OFF TRENCH, WHEN POOL DEPTHS ARE IN EXCESS OF THREE FEET, SHALL BE EXCAVATED ALONG THE CENTERLINE OF EARTH FILL EMBANKMENTS. THE MINIMUM DEPTH SHALL BE TWO FEET. THE CUT-OFF TRENCH SHALL EXTEND UP BOTH ADJUTMENTS TO THE RISER CRIST ELEVATION. THE MINIMUM BOTTOM DEPTH SHALL BE FOUR FEET, BUT WIDE ENOUGH TO PERMIT OPERATION OF EXCAVATION AND COMPACTION EQUIPMENT. THE SIDE SLOPES SHALL BE NO STEEPER THAN 1:1. COMPACTION REQUIREMENTS SHALL BE THE SAME AS THOSE FOR THE EMBANKMENT. THE TRENCH SHALL BE DEWATERED DURING THE BACKFILLING-COMPACTION OPERATIONS.
- c) EMBANKMENT
THE FILL MATERIAL SHALL BE TAKEN FROM APPROVED BORROW AREAS. IT SHALL BE CLEAN SOIL FREE OF ROOTS, WOODY WEEDS, OVER-SIZED STONES, ROCKS OR OTHER OBSTRUCTIONABLE MATERIAL. AREAS ON WHICH FILL IS TO BE PLACED SHALL BE SCARFED PRIOR TO PLACEMENT OF FILL. FILL MATERIAL SHALL BE PLACED IN 4 TO EIGHT INCHES THICK CONTINUOUS LAYERS OVER THE ENTIRE LENGTH OF THE FILL. COMPACTION SHALL BE OBTAINED BY ROUTING HAULING EQUIPMENT OVER THE FILL SO THAT THE ENTIRE SURFACE OF EACH LAYER OF THE FILL IS TRAVERSED BY AT LEAST ONE WHEEL OF TREAD TRUCK OF THE EQUIPMENT OR BY THE USE OF A COMPACTOR. THE EMBANKMENT SHALL BE CONSTRUCTED TO AN ELEVATION OF ONE HIGHER THAN THE DESIGN HEIGHT TO ALLOW FOR SETTLEMENT. COMPACTION IS OBTAINED WITH HAULING EQUIPMENT. IF COMPACTORS ARE USED FOR COMPACTION, THE OVERLAP MAY BE REDUCED TO NOT LESS THAN SIX.
- d) PIPE SPILLWAYS
THE RISER SHALL BE SECURELY ATTACHED TO THE BARREL OF THE OUTFALL PIPE. THE BARREL AND RISER SHALL BE PLACED ON A FIRM, SMOOTH SOIL FOUNDATION. THE CONNECTION BETWEEN THE RISER AND RISER BASE SHALL BE WATER TIGHT. THE FILL MATERIAL AROUND THE PIPE SPILLWAY SHALL BE PLACED IN FOUR INCH LAYERS AND COMPACTION SHALL BE OBTAINED AROUND AND AROUND THE PIPE TO AT LEAST THE SAME DENSITY AS THE ADJACENT EMBANKMENT. HAND COMPACTED BACKFILL SHALL BE PLACED OVER THE PIPE SPILLWAY BEFORE CROSSING IT WITH CONSTRUCTION EQUIPMENT.
- e) EROSION POLLUTION CONTROL
CONSTRUCTION OPERATIONS SHALL BE CARRIED OUT IN SUCH A MANNER THAT EROSION AND WATER POLLUTION WILL BE MINIMIZED. STATE AND LOCAL LAWS CONCERNING POLLUTION ABATEMENT SHALL BE COMPLIED WITH.

7. MAINTENANCE

- a) REPAIR ALL DAMAGES CAUSED BY SOIL EROSION OR CONSTRUCTION EQUIPMENT AT OR BEFORE THE END OF EACH WORK DAY.
- b) SEDIMENT SHALL BE REMOVED FROM SWAMP AREAS. THE SEDIMENT SHALL BE PLACED IN SUCH A MANNER THAT IT WILL NOT ESCAPE FROM THE SITE. THE SEDIMENT SHALL NOT BE DEPOSITED DOWNSTREAM FROM THE EMBANKMENT OR IN OR ADJACENT TO A STREAM OR FLOOD PLAIN.
- c) AFTER CONSTRUCTION IS COMPLETED AND AREAS ARE SEEDED AND/OR SOODED, MAINTENANCE IS LIMITED TO VISUAL INSPECTIONS ON A ROUTINE BASIS. ANY DAMAGE TO THE BERM SHALL BE REPAIRED AT ONCE AND RE-SOODED AND/OR RE-SEEDING. IF THE LEVEL OF WATER IS BEING MAINTAINED OVER THE EXPECTED DRAIN DOWN TIME, THE OUTFALL SYSTEM SHALL BE CLEANED AND PREPARED.

8. BEST MANAGEMENT PRACTICES

DEWATERING WILL OCCUR, AS REQUIRED, FOR ALL EXCAVATION ACTIVITY INCLUDING, BUT NOT LIMITED TO STORM SEWERS, SANITARY SEWERS, WATER & SEWER LINES AND STORMWATER PONDS.

ALL DEWATERING EFFLUENT SHALL BE ROUTED TO THE TEMPORARY SEDIMENT SLUMP PRIOR TO DISCHARGE TO THE WETLANDS OR OFFSITE. THE GENERAL PROCESS OF THE DEWATERING SYSTEM SHALL BE ADHERED TO DURING CONSTRUCTION, ALTHOUGH THE ACTUAL LAYOUT OF THE SYSTEM SHALL BE CONSTRUCTED AS DICTATED BY FIELD CONDITIONS.

IF THE DEWATERING SYSTEM USES A PUMP AND PIPING, IT MUST BE LESS THE 6 INCHES IN DIAMETER AND OPERATE LESS THAN A TOTAL SIX MONTHS. ANY DEVIATION FROM THIS REQUIREMENT SHALL REQUIRE A WATER USE PERMIT. THE COST OF A WATER USE PERMIT AND ASSOCIATED MATERIAL SHALL BE BORNE BY THE CONTRACTOR.

ALL SILTATION AND EROSION CONTROL MEASURES SHALL BE INSPECTED AND MAINTAINED AT A MINIMUM OF ONCE PER WEEK OR AFTER ANY 1/2" OR GREATER RAINFALL EVENT. THE CONTRACTOR SHALL MAINTAIN RECORDS OF ALL MAINTENANCE AND INSPECTIONS UNTIL CONSTRUCTION IS COMPLETE.

LAY SOO AROUND ALL INLETS, INTERED END WALLS HEADWALLS, SHOALS, POND SLOPES, AND A THREE FOOT (3') WIDE STRIP ADJACENT TO EDGE OF PAVEMENT OR AS DIRECTED BY THE ENGINEER AS SOON AS PRACTICAL TO PREVENT EROSION. ALL DISTURBED AREAS TO BE SOODED OR SEEDED AS SOON AS PRACTICAL TO PREVENT EROSION.

THE CONTRACTOR SHALL ABIDE BY ALL APPLICABLE REQUIREMENTS AND CONDITIONS OF SOUTHWEST FLORIDA WATER MANAGEMENT DISTRICT (S.W.F.W.M.D.) PERMIT AND HAVE A COPY ON SITE.

SILTATION ACCUMULATIONS GREATER THAN THE LESSER OF 12 INCHES OR ONE-HALF THE DEPTH OF THE SILTATION CONTROL BARRIER SHALL BE IMMEDIATELY REMOVED AND PLACED IN UPLAND AREAS.

CONTRACTOR SHALL SPRINKLE OR OTHERWISE APPLY WATER TO AFFECTED AREAS TO CONTROL BOTH SIGNIFICANT WIND EROSION AND FUOTIVE DUST.

THE CONTRACTOR SHALL DIRECT ON-SITE RUNOFF TO THE STORMWATER SYSTEM DURING CONSTRUCTION.

THE CONTRACTOR SHALL EMPLOY EROSION/SEDIMENT PREVENTION MEASURES, AS STATED WITHIN THE "BEST MANAGEMENT PRACTICES SPECIFICATIONS AND DETAILS", FOR THE DURATION OF CONSTRUCTION.

ALL DISTURBED AREAS SHALL BE SOODED AS SOON AS PRACTICAL TO PREVENT EROSION.

SOODING IS TO BE MAINTAINED, INCLUDING SLOPES, UNTIL COMPLETION AND ACCEPTANCE OF TOTAL PROJECT OR GROWTH IS ESTABLISHED, WHICHEVER COMES LAST. UNTIL THEN, ALL EROSION, SILTATION, AND MAINTENANCE OF GRASSES AND GRASS SHALL BE THE RESPONSIBILITY OF THE CONTRACTOR.

ALL PROVISIONS FOR EROSION CONTROL SHALL BE ADHERED TO.

THE CONTRACTOR SHALL ADJUST OR MODIFY ALL UTILITY COVERS AS REQUIRED BY CONSTRUCTION DEPICTED WITHIN THESE PLANS. THESE SHALL INCLUDE, BUT NOT BE LIMITED TO MAN-HOLE RIMS, HAND HOLES, VALVE BOXES, CT. UTILITY COVERS SHALL BE FLUSH WITH THE FINISHED PAVEMENT GRADE.

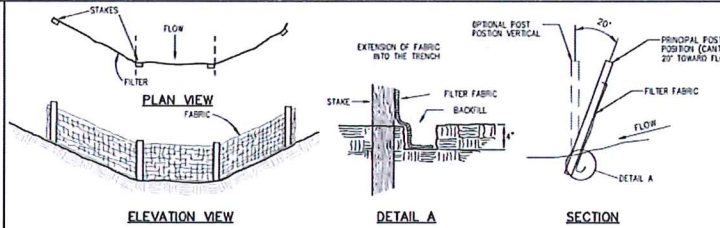

STAKED SILT BARRIER (DURING CONSTRUCTION ONLY) (NTS)

1. FILTER BARRIERS MUST BE INSTALLED, AS INDICATED HEREIN, PRIOR TO CONSTRUCTION.
2. FILTER BARRIERS SHALL NOT BE INSTALLED IN ANY CONFIGURATION THAT BLOCKS THE THROAT OF ANY STORMWATER INLET.
3. INSPECTIONS AND REPAIRS TO BARRIERS SHALL BE MADE DAILY.
4. FILTER BARRIERS SHALL BE REMOVED UNTIL APPROVED BY ENGINEER.

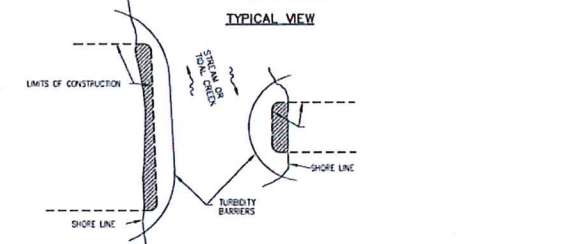
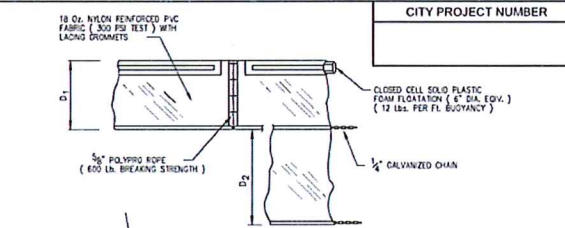
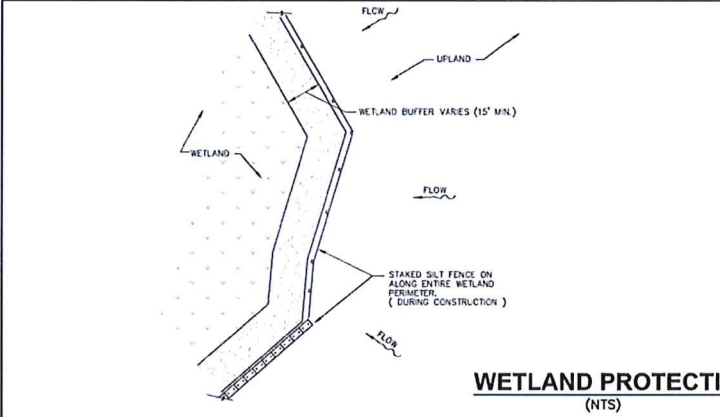
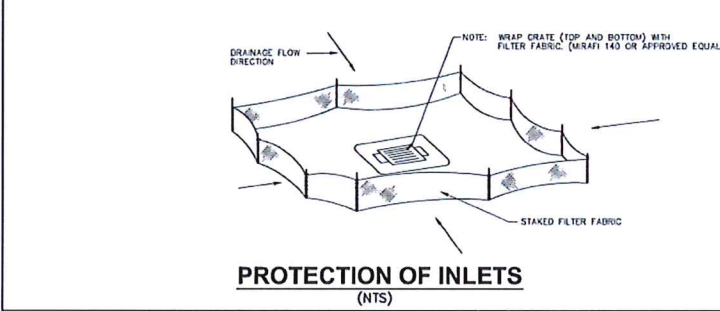
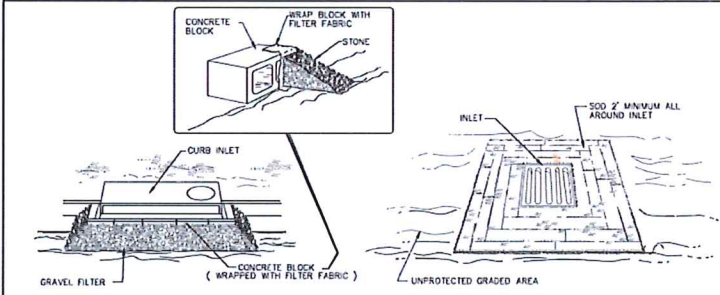

NOTES:

1. D = 1' - 5' STANDARD (SINGLE PANEL FOR DEPTH 4' OR LESS) D = 2' STANDARD (ADDITIONAL PANEL FOR DEPTHS > 5') CURTAIN TO REACH BOTTOM UP TO DEPTHS OF 10 FEET. TWO (2) PANELS TO BE USED FOR DEPTHS GREATER THAN 10 FEET UNLESS SPECIAL DEPTH CURTAINS SPECIFICALLY CALLED FOR IN THE PLANS OR AS DETERMINED BY THE ENGINEER.
2. TURBIDITY BARRIERS ARE TO BE USED IN ALL PERMANENT BODIES OF WATER REGARDLESS OF WATER DEPTH WHEN ADJACENT TO CONSTRUCTION ACTIVITIES.
3. NUMBER AND SPACING OF ANCHORS DEPENDENT ON WATER VELOCITIES.
4. BARRIERS TO REMAIN IN PLACE UNTIL APPROVED FOR REMOVAL BY ENGINEER.

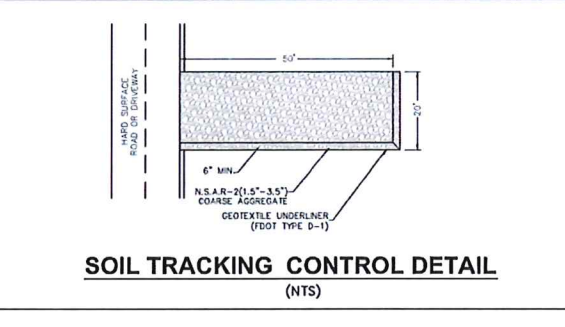
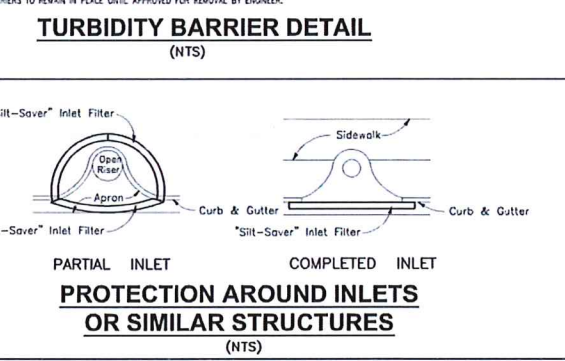

SIGNATURE: _____ Date: _____
 APPLICANT & TITLE: _____
 COMPANY: _____

I understand that I am to be held responsible for having the contractor follow the permit conditions of the federal, state, water management district or local permit agencies. I agree to have adequate erosion and sediment control measures in place in accordance with these best management practices and the Best Management Plan.

Drawing name: F:\Projects\2015\15-03\15-0314-01\15-0314-01-01\15-0314-01-01-01.dwg Date: 05/26/16 10:24 AM User: j... Title: 1.3

DATE	REVISION	BY



DMK ASSOCIATES
 ENGINEERS & SURVEYORS
 421 Commercial Court, Suite C Venice, Florida 34292
 Phone (941)412-1293, Fax (941)412-1043
 Certificate of Authorization No. 3934

DATE	CKD BY	DATE
05/26/16	MAL	05/16
DESIGN MAL	MAL	05/16
SCALE @ 22"x34"	DMK NO.15-0194-06	

CITY OF NORTH PORT - PUBLIC WORKS DIVISION
TAMIAMI TRAIL LINEAR PARKING IMPROVEMENT PROJECT
 BEST MANAGEMENT PRACTICES NOTES AND DETAIL SHEET

ENGINEER OF RECORD
 MARY ANN LIND, P.E.
 STATE OF FLORIDA NO. 58093

1.3

DATE	REVISION	BY



DMK ASSOCIATES
 ENGINEERS & SURVEYORS
 421 Commercial Court, Suite C Venice, Florida 34292
 Phone (941)112-1234, Fax (941)112-1043
 Certificate of Authorization No. 3924

DATE	CHK. BY	DATE
05/28/16		

TAMAMI TRAIL LINEAR PARKING IMPROVEMENT PROJECT
 KEY MAP AND MASTER IMPROVEMENT PLAN SHEET

CITY OF NORTH PORT, FLORIDA, TOURS DIVISION

SHEET NO. **2.0**

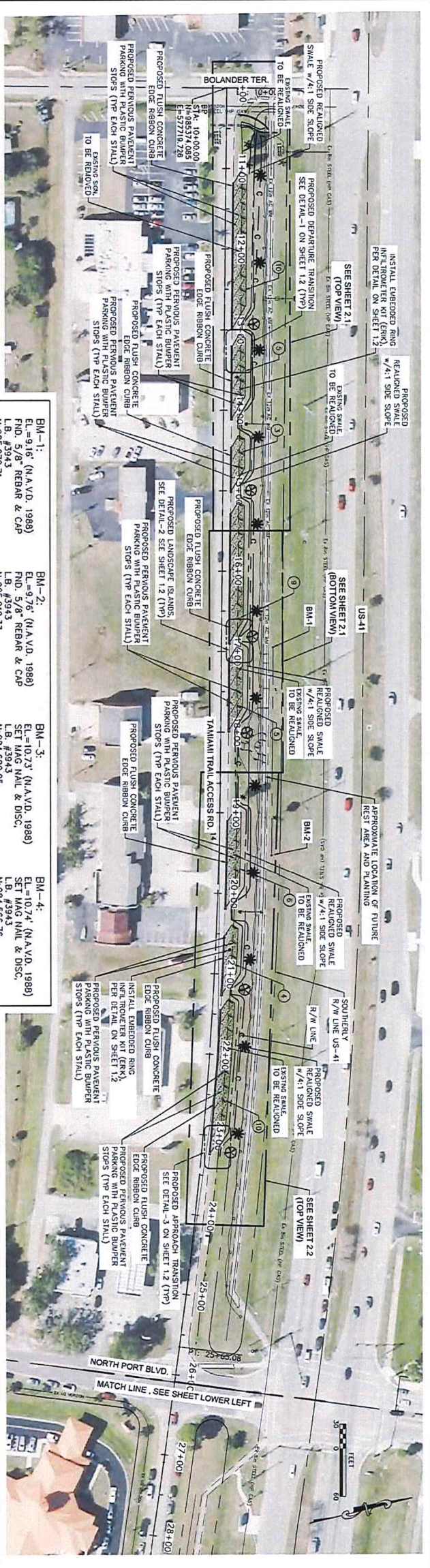
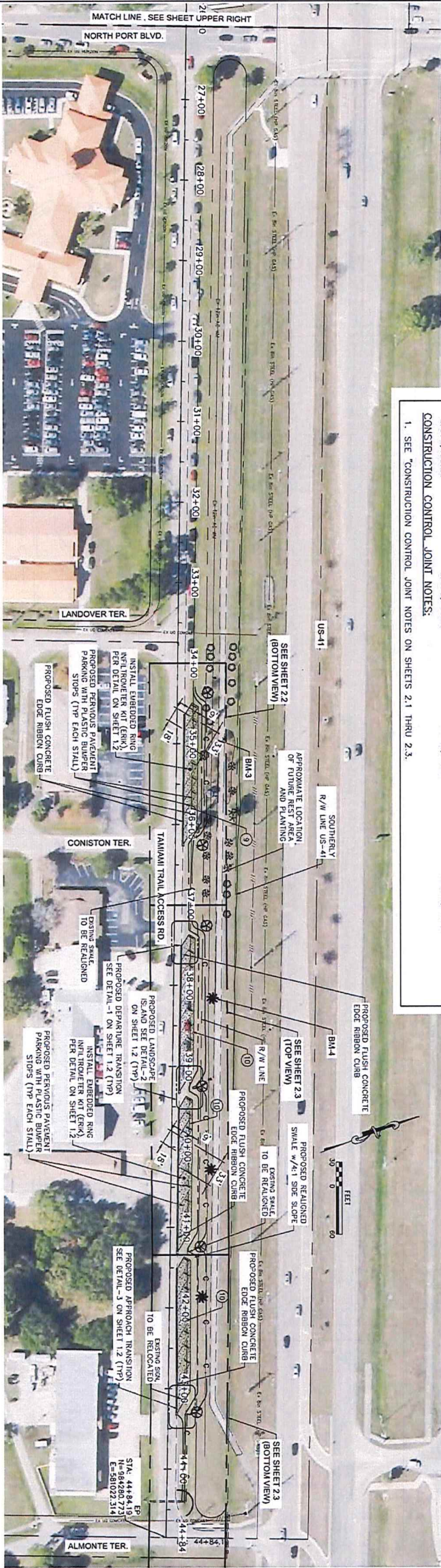

- CONSTRUCTION CONTROL JOINT NOTES:**
 1. SEE "CONSTRUCTION CONTROL JOINT NOTES ON SHEETS 2.1 THRU 2.3.
- | | | | |
|---|---|---|---|
| BM-1:
E.L.=9.16' (N.A.V.D. 1988)
F.L.=5/8" REBAR & CAP
L.B. #3943
N:985,272.71
E:578,409.20 | BM-2:
E.L.=9.76' (N.A.V.D. 1988)
F.L.=5/8" REBAR & CAP
L.B. #3943
N:985,212.33
E:578,660.10 | BM-3:
E.L.=10.73' (N.A.V.D. 1988)
SET MAG NAIL & DISC.
L.B. #3943
N:984,680.85
E:580,116.51 | BM-4:
E.L.=10.74' (N.A.V.D. 1988)
SET MAG NAIL & DISC.
L.B. #3943
N:984,566.76
E:580,415.64 |
|---|---|---|---|

CITY PROJECT NUMBER

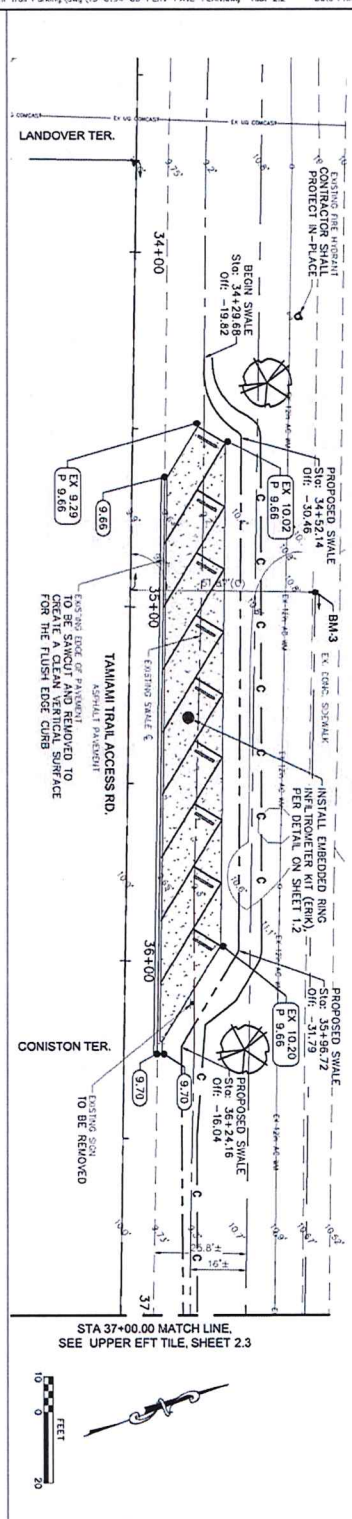
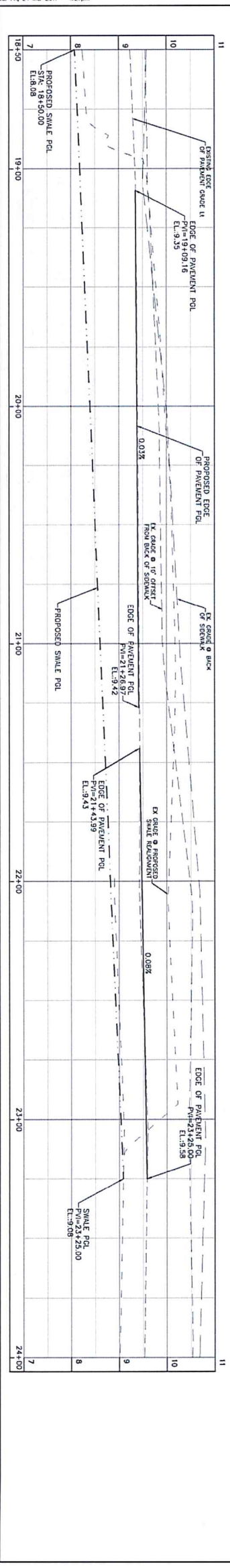
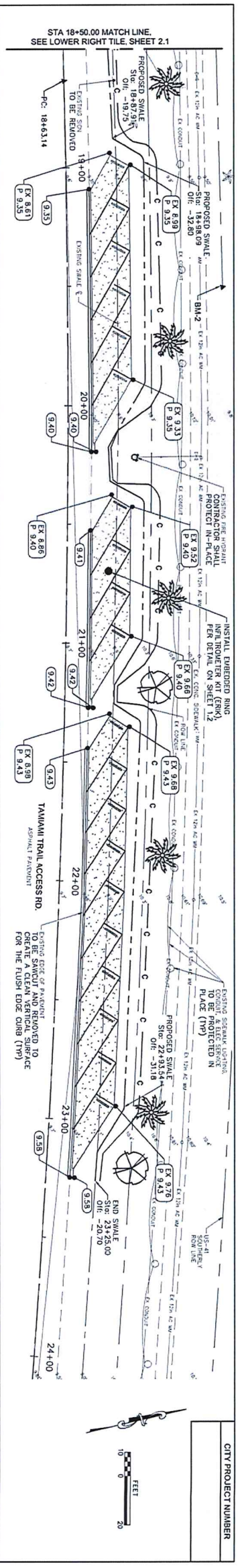

CONSTRUCTION CONTROL JOINT NOTES:

- CONTROL JOINTS WILL BE PLACED IN THE RIBBON CURB EVERY 10' PER FOOT STANDARDS.
- CONTROL JOINTS WILL BE PLACED IN THE PERVIOUS PAVEMENT EVERY 20' PER THE NATIONAL READY MIX CONCRETE ASSOCIATION.

PROTECT IN PLACE NOTE:

- THE CONTRACTOR SHALL PROTECT IN PLACE THE EXISTING SIDEWALK, LIGHT POLES BURIED ELECTRICAL CONDUIT AND ELECTRICAL SERVICE ADJACENT TO THE SIDEWALK.

BM--1:
 EL.=9.16' (N.A.V.D. 1988)
 RUD. 5/8" REBAR & CAP
 L.B. #3943
 N:985,272.71
 E:578,409.20

BM--2:
 EL.=9.76' (N.A.V.D. 1988)
 RUD. 5/8" REBAR & CAP
 L.B. #3943
 N:985,272.33
 E:578,560.10

BM--3:
 EL.=10.73' (N.A.V.D. 1988)
 SET 1/2" MAG NAIL & DISC,
 L.B. #3943
 N:984,580.85
 E:580,116.51

BM--4:
 EL.=10.74' (N.A.V.D. 1988)
 SET 1/2" MAG NAIL & DISC,
 L.B. #3943
 N:984,566.76
 E:580,415.64

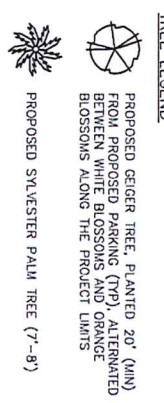

DATE	REVISION	BY
05/28/16	1	DMK
05/16	2	DMK
05/16	3	DMK
05/16	4	DMK
05/16	5	DMK
05/16	6	DMK
05/16	7	DMK
05/16	8	DMK
05/16	9	DMK
05/16	10	DMK
05/16	11	DMK

DMK ASSOCIATES
 ENGINEERS & SURVEYORS
 421 Commercial Court, Suite C Venice, Florida 34292
 Phone (941)412-2933, Fax (941)412-1043
 Certificate of Authorization No. 3934

CITY OF NORTHPORT - PUBLIC WORKS DIVISION
 TAMAMIAMI TRAIL LINEAR PARKING IMPROVEMENT PROJECT
 PROPOSED PARKING PLAN AND PROFILE SHEET

ENGINEER OF RECORD
 STATE OF FLORIDA NO. 5009

SHEET NO. **2.2**

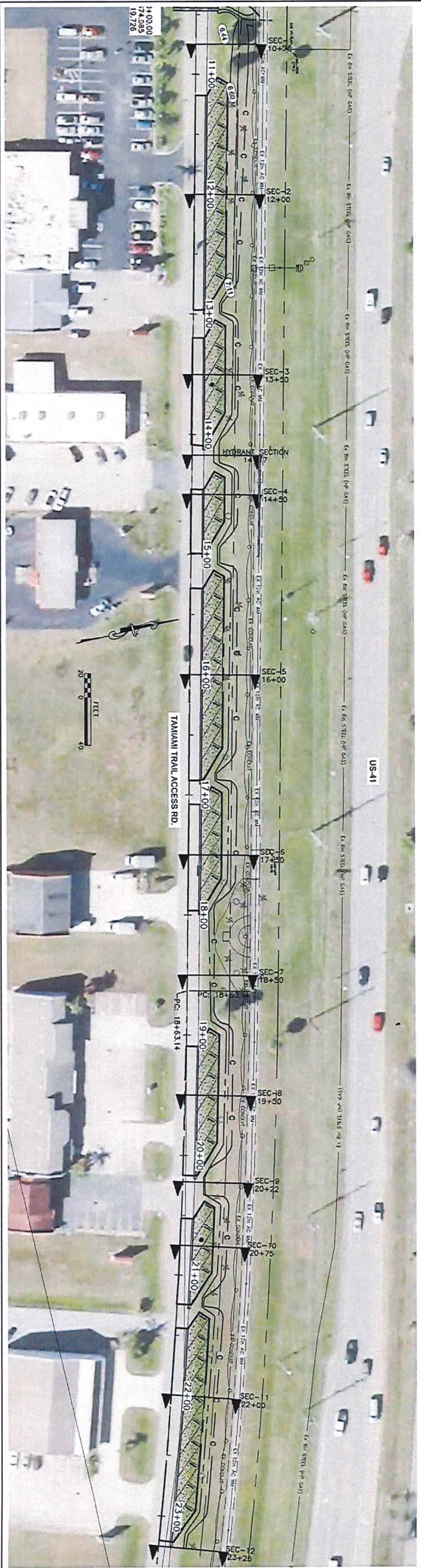

CITY PROJECT NUMBER

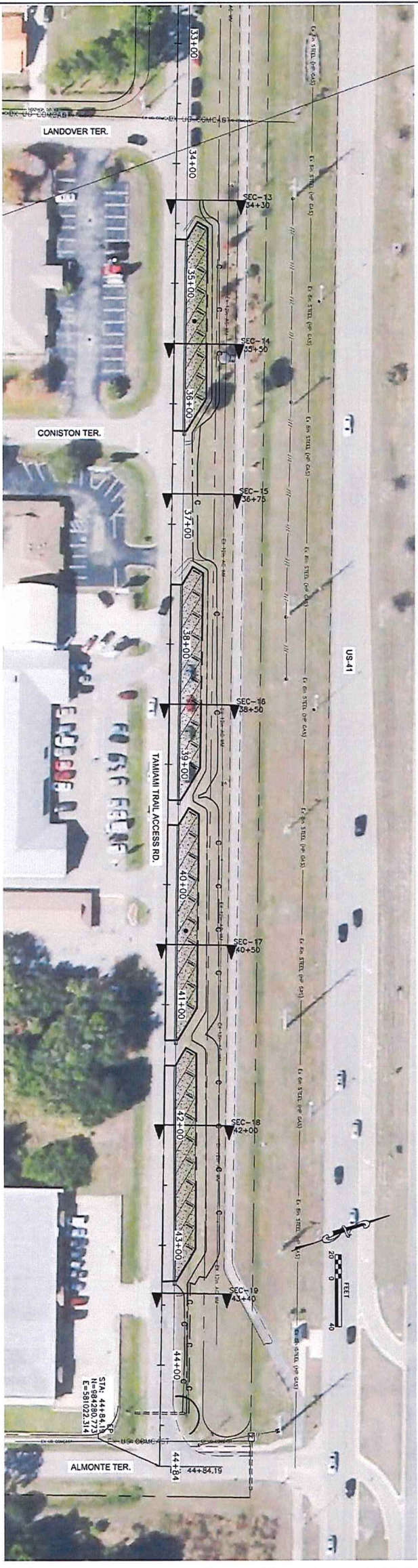

DATE	REVISION	BY

		DMK ASSOCIATES ENGINEERS & SURVEYORS 421 Commercial Court, Suite C Venice, Florida 34292 Phone (941) 412-1233, Fax (941) 12-1043 Certificate of Authorization No. 3934
		DATE: 05/20/16 DRAWN: RNS DESIGN: MML SCALE: @ 22"x34" DMK NO:15/0194/06

CHD. BY: MML DATE: 05/16	CITY OF NORTHPORT - PUBLIC WORKS DIVISION TAMAMI TRAIL LINEAR PARKING IMPROVEMENT PROJECT PROJECT CROSS SECTION LOCATION SHEET
-----------------------------	---

REGISTERED ENGINEER MARY PATRICK, P.E. STATE OF FLORIDA NO. 26063	SHEET NO. 3.0
---	-------------------------

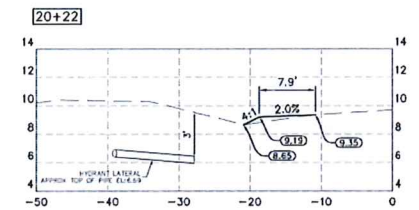
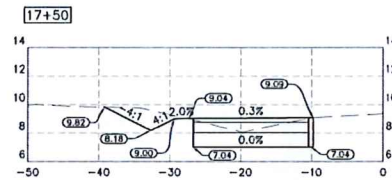
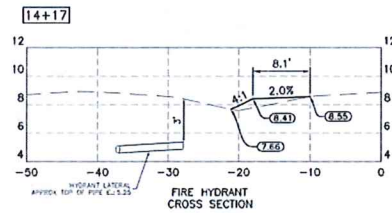
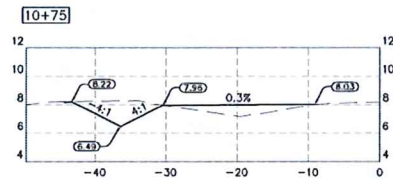
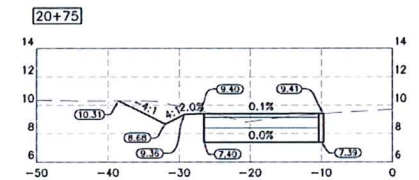
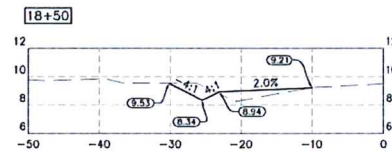
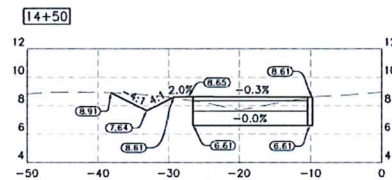
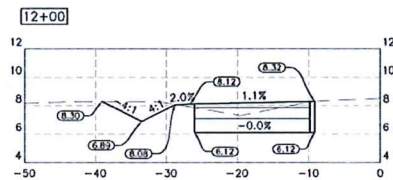
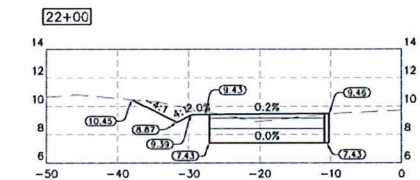
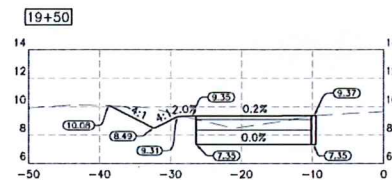
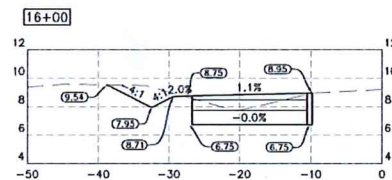
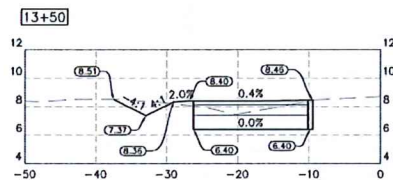

Drawing name: F:\Projects\2015\15-0114-North Port DEP Amend 2015-05-15-15-0114-01 Tamiami Trail Parking\15-0114-01a-SEC2\DWG.dwg Tab: DWG_21 Date Plotted: Fri, 24 Mar 2017 2:11pm

DATE	REVISION	BY



DMK ASSOCIATES
 ENGINEERS & SURVEYORS
 421 Commercial Court, Suite C Venice, Florida 34292
 Phone (941)412-1293, Fax (941)412-1043
 Certificate of Authorization No. 3934

DATE	05/26/16	CKD BY	DATE
DRAWN	RMS	MAL	05/16
DESIGN	MAL	MAL	05/16
SCALE	@ 22"x34"	DMK NO.15-0194-06	

CITY OF NORTH PORT - PUBLIC WORKS DIVISION
TAMIAMI TRAIL LINEAR PARKING IMPROVEMENT PROJECT
 PROJECT CROSS SECTIONS

ENGINEER OF RECORD
 MARY ANN LIND, P.E.
 STATE OF FLORIDA P.O. 58093

SHEET No.
3.1

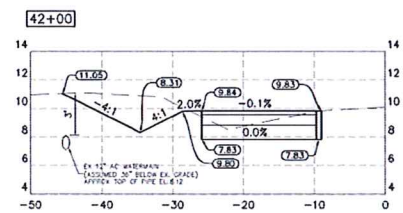
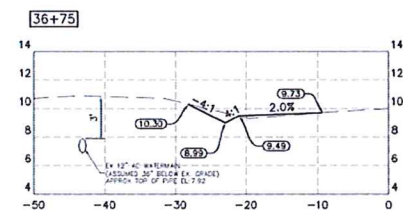
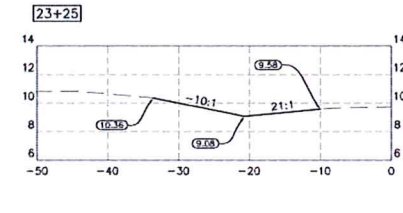
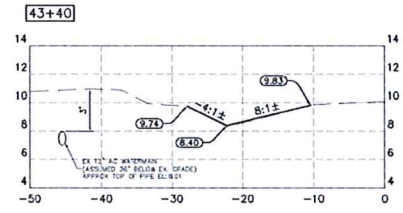
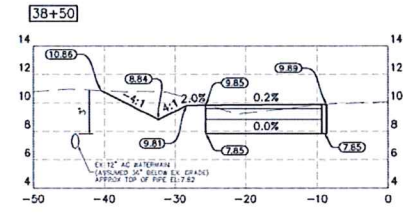
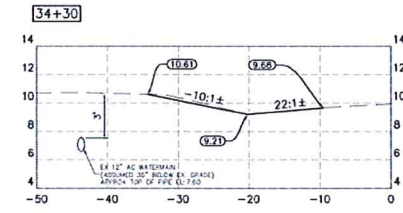
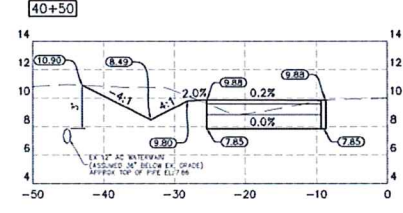
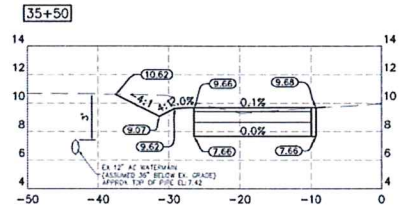

Drawn by: F:\Projects\2015\15-0194-North Port EOP Approval 2015-20\15-0194-03 Tamiami Trail Parking\Drawings\2015-0194-03-SEC0205.dwg Tab: SHT 12 Date Printed: Fri, 24 Mar 2017 11:50pm

DATE	REVISION	BY



DMK ASSOCIATES
ENGINEERS ■ SURVEYORS
421 Commercial Court, Suite C Venice, Florida 34292
Phone (941)412-1293, Fax (941)412-1043
Certificate of Authorization No. 3934

DATE	CKD. BY	DATE
05/26/16	MAL	05/16
DRAWN RNS	MAL	05/16
DESIGN MAL	MAL	05/16
SCALE @ 22"x34"	DMK NO.15-0194-06	

CITY OF NORTH PORT - PUBLIC WORKS DIVISION
TAMIAMI TRAIL LINEAR PARKING IMPROVEMENT PROJECT
PROJECT CROSS SECTIONS

ENGINEER OF RECORD
MARY ANN LIND, P.E.
STATE OF FLORIDA NO. 58093

SHEET No.
3.2

