



Qualifications to Provide
City of North Port
Professional Engineering Services
Continuing Services Contracts
for City of North Port

RFP No. 2024-14



March 4, 2024
Submitted by:



CITY OF NORTH PORT
RFP No. 2024-14
PROFESSIONAL ENGINEERING SERVICES -
CONTINUING SERVICES CONTRACTS FOR
CITY OF NORTH PORT

SUBMITTED BY:

JOHNSON ENGINEERING, INC.
CHRIS BEERS, PE, PSM
17833 MURDOCK CIRCLE
PORT CHARLOTTE, FL 33948
(941) 625-9919
CBEERS@JOHNSONENG.COM

DUE:

MARCH 4, 2024
2:00 P.M.



Professional Engineering Services
Continuing Services Contracts for City of North Port
March 4, 2024



Equal Opportunity/Affirmative Action Employer

TABLE OF CONTENTS

Title Page

Table of Contents

1. Transmittal Letter

2. Qualifications of the Firm

Company Overview	1
Capabilities Summary	2
Professional Service Categories	
SF330 Part I	
SF330 Part II	

3. Key Personnel/Qualifications of the Project Team

Organizational Chart	3
Project Manager Experience	4
Team Licenses	4
SF330 Section E. Resumes	

4. Team's Previous Experience/Proficiency in Similar Projects

Similar Projects	5
SF330 Section F. Example Projects	
SF330 Section G. Key Personnel Participation in Example Projects	

5. Management Approach/Project Control

6

6. References

10

7. Litigation & Insurance

Litigation	11
Insurance Certificates	12

8. Additional Information

SF330 Section H. Additional Information	13
SF330 Section I. Authorized Representative	

9. City Required Forms



1. TRANSMITTAL LETTER

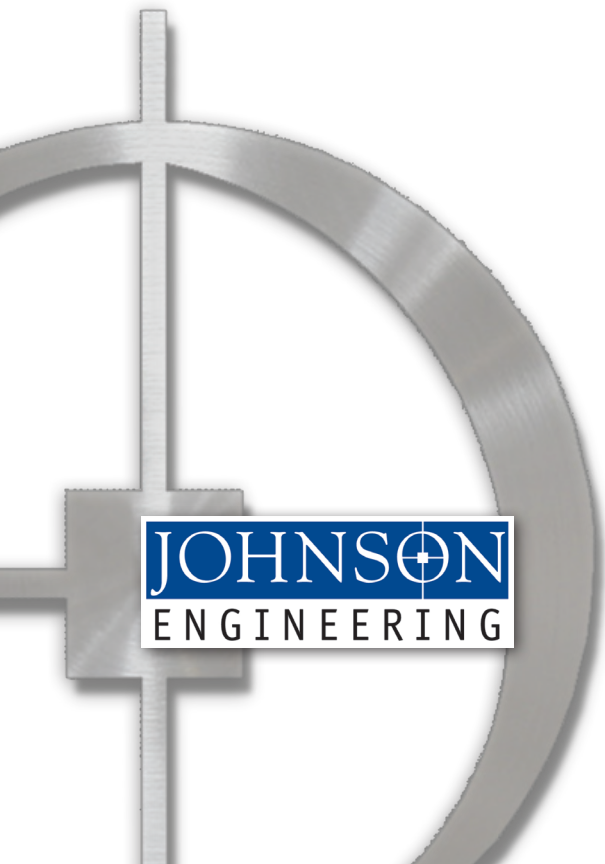

JOHNSON
ENGINEERING



March 4, 2024

City of North Port
4970 City Hall Boulevard, Room 337
North Port, FL 34286

**Re: Professional Engineering Services – Continuing Services Contracts for City of North Port
RFP No. 2024-14**

Dear Selection Advisory Committee,

It is our goal to provide the City of North Port the comfort of having an on-call engineering firm who can perform services with the speed and efficiency, as if your own in-house resource. Your consultant should be capable of providing most of the services you need in-house, and have strong local knowledge and presence. Johnson Engineering possesses these attributes.

As your consultant, we will bring you:

- More than 78 years of local knowledge and expertise
- Strong presence throughout Southwest Florida, with the ability to provide invaluable historical data of the local area
- Multidisciplinary team of professionals with an average tenure of 13 years at Johnson Engineering
- We are geared to perform on general engineering libraries, in addition to the City of North Port, we have also served on libraries for City of Venice, Charlotte County, Pasco County, Lee County, Collier County, City of Punta Gorda, City of Fort Myers, City of Naples, City of Cape Coral, and City of Bonita Springs, to name a few.

We are proud of our tradition of providing dependable, timely work and look forward to continuing this tradition for the City of North Port. When times are tough and you are in a crunch, you need to turn to the people you know you can trust, people who have done this work before, people who have proven their ability and long term commitment to the City of North Port. With Johnson Engineering, you have those people.

Sincerely,
JOHNSON ENGINEERING, INC.

Christopher Beers, PE, PSM
Project Manager

This proposal is made without collusion with any other person or entity submitting a proposal pursuant to this RFP.

2. QUALIFICATIONS OF THE CONSULTANT FIRM



JOHNSON
ENGINEERING

2. QUALIFICATIONS OF THE FIRM

COMPANY OVERVIEW



Contact:

Christopher Beers, PE, PSM
 17833 Murdock Circle
 Port Charlotte, FL 33948
 Phone: (941) 625-9919
 cbeers@johnsoneng.com
 www.johnsonengineering.com

Depth of Experience

Centuries of combined experience has immersed our team of licensed professionals into Florida's geography, giving a rare perspective into development of the area and an appreciation of it's historic value.

Long Term Commitment

Our team's average tenure with Johnson Engineering is 13 years and an unprecedented 20% have been with us for more than 20 years, showing our team's continuity and dedication to the area.

Established in 1946, Johnson Engineering, Inc. has a team of more than 120 professional engineers, certified land planners, landscape architects, ecologists, scientists, geologists, and surveyors & mappers, throughout Florida. Headquartered in Fort Myers, Florida, the company also has offices in Port Charlotte, LaBelle, Clewiston, Naples, and Lutz.

Our extensive list of well-known Florida roads, shopping centers, schools, hospitals, residential communities, resorts and commercial developments show our continued responsibility in developing Florida's communities.

Our firm has provided professional engineering services for 78 years. We have or are currently providing continuing services to the following entities:

- Collier County
- City of Punta Gorda
- Lee Memorial Health Systems
- City of Bonita Springs
- City of Venice
- Miami-Dade County
- City of Clewiston
- Charlotte County
- Miccosukee Tribe of Indians of Florida
- City of Dade City
- DeSoto County
- Okeechobee County
- City of Fort Myers
- Glades County
- Pasco County
- City of Hollywood
- Hendry County
- Polk County
- City of Lakeland
- Highlands County
- Sarasota County
- City of Marco Island
- Lee County
- Village of Estero
- City of Naples
- Lee County Port Authority

myfloridalicense.com/relationList.asp?record_cnt=1&LicId=2700471&LName=&datefrom=&LicNum=&delete=&name=&cate...

Licensee			
Name:	HOWARD, LONNIE V.	License Number:	53167
Rank:	Professional Engineer	License Expiration Date:	02/28/2025
Primary Status:	Current	Original License Date:	08/17/1998
Secondary Status:	Active		

Related License Information					
License Number	Status	Related Party	Relationship Type	Relation Effective Date	Expiration Date
642	Current	JOHNSON ENGINEERING INC	Registry	05/23/2012	Registry

**State of Florida
Department of State**

I certify from the records of this office that JOHNSON ENGINEERING, INC. is a corporation organized under the laws of the State of Florida, filed on November 3, 1967.

The document number of this corporation is 322710.

I further certify that said corporation has paid all fees due this office through December 31, 2023, that its most recent annual report/uniform business report was filed on March 31, 2023, and that its status is active.

I further certify that said corporation has not filed Articles of Dissolution.

Given under my hand and the Great Seal of the State of Florida at Tallahassee, the Capital, this the Thirty-first day of March, 2023



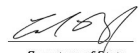

Secretary of State

Tracking Number: 1803220743CC

To authenticate this certificate, visit the following site, enter this number, and then follow the instructions displayed.
<https://services.sunbiz.org/Filings/CertificateOfStatus/CertificateAuthentication>

Florida Department of Agriculture and Consumer Services
 Division of Consumer Services
 Board of Professional Surveyors and Mappers
 3065 Apalachee Pkwy, Tallahassee, Florida 32309-6500

License No: **LB642**
 Expiration Date: February 28, 2025

Professional Surveyor and Mapper Business License
 Under the provisions of Chapter 472, Florida Statutes



JOHNSON ENGINEERING, INC.
 2122 JOHNSON ST
 FORT MYERS, FL 33901-3408



WILTON SIMPSON
 COMMISSIONER OF AGRICULTURE

Professional Engineering Services
 Continuing Services Contracts for City of North Port
 March 4, 2024



Equal Opportunity/Affirmative Action Employer



2. QUALIFICATIONS OF THE FIRM

CAPABILITIES SUMMARY

Johnson Engineering's experienced team of professional civil engineers, ecologists, scientists, geologists, surveyors and mappers, certified land planners, and landscape architects, offer their expertise in a broad spectrum of engineering disciplines.

Transportation



- Roadway Design & MOT
- Resurfacing, Rehabilitation & Restoration
- Access Plans & Permitting
- Traffic Impact Analyses
- Route Studies
- Intersection Studies & Sidewalks
- CEI Services
- Environmental Assessment (Due Diligence)
- Environmental Resource Permitting
- Wetland Assessment
- Mitigation Design & Monitoring
- Threatened & Endangered Species Management

Environmental Consulting



Land Development



- Mixed-Use
- Urban
- Residential
- Commercial & Industrial
- Institutional & Educational
- Medical
- Permitting
- Construction Observation & Administration
- Hydrogeological Investigations
- Consumption Water Use Permitting
- Well & Wellfield Design
- Water Supply Planning
- Deep Injection Well Design & Permitting
- Groundwater Modeling

Groundwater Resources



Surveying & Mapping



- SUE
- Hydrographic Surveying
- Transportation Surveying
- Geographic Information Systems (GIS)
- ALTA & Boundary Surveys
- Construction Layout & Platting
- Geotechnical & Aerial Support
- Surface Water Master Planning
- BMP Selection & Design
- Surface Water Retrofit
- Hydrological, Hydraulic & Water Quality Modeling
- Federal, State, & Local Surface Water Permitting
- Flow & Stage Monitoring

Surface Water Resources



Utilities

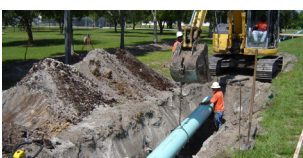

- Utility Master Planning
- Water Distribution Facilities
- Wastewater Collection
- Hydraulic Modeling
- Pumping Facilities
- Irrigation Systems
- Process & Industrial Control
- Systems Integration and Commissioning
- Site and Process Evaluations
- SCADA Architecture, Networking & Telemetry
- PLC/HMI/OIT Programming
- Power Distribution
- Site Lighting

Electrical



Water Quality Studies

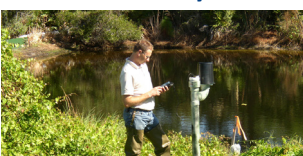

- Storm/Surface Water Quality Studies
- Groundwater Quality Studies
- Estuarine/Coastal Studies
- Subaqueous Sediment Characterization
- NPDES Compliance Monitoring
- Filter Marsh Evaluation
- TMDL Pollutant Loading
- Turbidity Monitoring
- Strategic Planning
- Master Plans & DRI's
- Community Planning
- Comprehensive Planning & Zoning
- Corridor/Facility Planning
- Local Government Assistance
- Environmental Design
- Park Planning
- Community/Streetscape Design
- Construction Observation

Land Planning & Landscape Architecture



ATTACHMENT A - RFP NO. 2024-14 PROFESSIONAL ENGINEERING SERVICES - CONTINUING
SERVICES CONTRACTS FOR THE CITY OF NORTH PORT

Professional Service Categories sought in this RFP include, but not limited to, the following:			
Roadway Design		Construction Engineering Inspection	
X	Pavement Design	X	Roadway Construction Inspection
X	Utility Coordination		Construction Materials Inspection
X	Intersection Improvements		Minor Bridge Inspection
X	Roadway Widening		Major Bridge Inspection
		X	Contract Administration and Management
Drainage & Environmental			
X	Drainage Studies & Modeling	Planning	
X	Drainage Design	X	Policy Planning
X	Environmental Studies	X	System Planning
X	Environmental Permitting	X	Corridor Planning
		X	Transportation Statistics
Structures Design			
	Miscellaneous structures	Landscape Architecture	
X	Water Control Structures	X	Landscape plans
	Bridge Design	X	Irrigation plans
			Others:
Bridge Inspections			
	Bridge Load Ratings	Right of Way/Land Acquisition	
	Conventional Bridge Inspection		Acquisition, Negotiation, Closing
	Underwater Inspections		Order of Taking
	Other:		Business Damage Estimating
			Relocation Assistance
Traffic Studies			
X	Signal Warrant Analysis	Mechanical, Electrical & Plumbing (MEP)	
X	Intersection Control Studies		Building retrofits
X	No-Passing Zone Studies		HVAC Design and plans preparation
X	Signal Timing Studies		HVAC Inspection
X	Traffic Impact Analysis/Studies		MEP Design and plans preparation
X	Speed Studies		
	Others:	Surveying	
		X	Control Surveying
Traffic Operations		X	Design, ROW and Construction Surveying
X	Signing and Pavement Marking Plans	X	Right of Way Mapping
	Lighting Plans	X	As-build preparation
X	Signalization Plans		
		Other Services	
Soil, Material Testing and Foundations		X	Subsurface Utility Exploration
	Soil Exploration	X	Utility Infrastructure
	Soil Lab Testing	X	Environmental Studies
	Material Testing		
	Foundation Studies		

Please indicate with an "x" the services you want to be considered under this RFP

ARCHITECT-ENGINEER QUALIFICATIONS

PART I – CONTRACT-SPECIFIC QUALIFICATIONS

A. CONTRACT INFORMATION

1. TITLE AND LOCATION *(City and State)*

Professional Engineering Services Continuing Services Contracts for City of North Port

2. PUBLIC NOTICE DATE

1/31/24

3. SOLICITATION OF PROJECT NUMBER

2024-14

B. ARCHITECT-ENGINEER POINT OF CONTACT

4. NAME AND TITLE

Chris Beers, PE, PSM, Project Manager

5. NAME OF FIRM

Johnson Engineering, Inc.

6. TELEPHONE NUMBER

(941) 625-9919

7. FAX NUMBER

8. E-MAIL ADDRESS

cbeers@johnsoneng.com

C. PROPOSED TEAM

(Complete this section for the prime contractor and all key subcontractors.)

#	(Check)				9. FIRM NAME	10. ADDRESS	11. ROLE IN THIS CONTRACT
	PRIME	J-V PARTNER	SUBCONTRACTOR	TRACTOR			
a.	<input checked="" type="checkbox"/>				Johnson Engineering, Inc. <input checked="" type="checkbox"/> CHECK IF BRANCH OFFICE	17833 Murdock Circle Port Charlotte, FL 33948	Project Management, Civil, Traffic, Transportation, Utilities, Marine, Public Works
b.	<input checked="" type="checkbox"/>				Johnson Engineering, Inc. <input type="checkbox"/> CHECK IF BRANCH OFFICE	2122 Johnson Street Fort Myers, FL 33901	Environmental, Electrical, Landscape Architecture, Hydrogeological, Hydrographic, Water Distribution, Wastewater Collection
c.					<input type="checkbox"/> CHECK IF BRANCH OFFICE		
d.					<input type="checkbox"/> CHECK IF BRANCH OFFICE		
e.					<input type="checkbox"/> CHECK IF BRANCH OFFICE		
f.					<input type="checkbox"/> CHECK IF BRANCH OFFICE		

D. ORGANIZATIONAL CHART OF PROPOSED TEAM

(Included within proposal)

ARCHITECT-ENGINEER QUALIFICATIONS

1. SOLICITATION Number (if any)

2024-14

PART II – GENERAL QUALIFICATIONS

(If a firm has branch offices, complete for each specific branch office seeking work)

2a. FIRM (OR BRANCH OFFICE) NAME Johnson Engineering, Inc.			3. YEAR ESTABLISHED 1946	4. DUNS NUMBER 048177498
2b. STREET 2122 Johnson Street			5. OWNERSHIP	
2c. CITY Fort Myers			2d. STATE FL	2e. ZIP CODE 33901
6a. POINT OF CONTACT NAME AND TITLE Christopher Beers, PE, PSM, Project Manager			7. NAME OF FIRM (If block 2a is a branch office)	
6b. TELEPHONE NUMBER (941) 625-9919		6c. E-MAIL ADDRESS cbeers@johnsoneng.com		
8a. FORMER FIRM NAME(S) (if any) N/A			8b. YR. ESTABLISHED	8c. DUNS NUMBER

9. EMPLOYEES BY DISCIPLINE				10. PROFILE OF FIRM'S EXPERIENCE AND ANNUAL AVERAGE REVENUE FOR LAST 5 YEARS		
a. Function Code	b. Discipline	c. No. of Employees		a. Profile Code	b. Experience	c. Revenue Index Number (see below)
		(1) FIRM	(2) BRANCH			
02	Administrative	18	15	C15	Construction Management	6
07	Biologist	0	0	D01	Dams (Concrete; Arch)	1
08	CADD Technician	28	24	E09	Environmental Impact Studies	6
12	Civil Engineer	13	7	E10	Environ. & Natural Resource	2
15	Construction Inspector	9	10	G04	Geographic Information System	4
16	Construction Manager	1	1	H07	Highways; Streets; Parking Lots	6
19	Ecologist	8	5	H09	Hospital & Medical Facilities	3
21	Electrical Engineer	1	1	I06	Irrigation; Drainage	6
23	Environmental Engineer	1	1	L02	Land Surveying	7
24	Environmental Scientist	3	3	L03	Landscape Architecture	2
29	GIS Specialist	1	1	P05	Planning (Community; Regional)	6
30	Geologist	3	3	R04	Recreation Facilities	3
33	Hydrographic Surveyor	2	2	R11	Rivers; Canals; Waterway; Flood	2
38	Land Surveyor	18	14	S10	Surveying; Platting; Mapping	7
39	Landscape Architect	2	2	S13	Storm Water Handling & Fac.	2
47	Planner: Urban/Regional	3	2	W02	Water Res.; Hydro; Ground Wat.	2
48	Project Manager	1	1	Z01	Zoning; Land Use Studies	3
58	Technician/Analyst	1	1			
60	Transportation Engineer	3	1			
62	Water Resources Engineer	4	1			
Total		120	95			

11. ANNUAL AVERAGE PROFESSIONAL SERVICES REVENUES OF FIRM FOR LAST 3 YEARS (Insert revenue index number show at right)		PROFESSIONAL SERVICES REVENUE INDEX NUMBER			
a. Federal Work	N/A	1. Less than \$100,000	2. \$100,000 to less than \$250,000	3. \$250,000 to less than \$500,000	4. \$500,000 to less than \$1 million
b. Non-Federal Work	8	5. \$1 million to less than \$2 million	6. \$2 million to less than \$5 million	7. \$5 million to less than \$10 million	8. \$10 million to less than \$25 million
c. Total Work	8			9. \$25 million to less than \$50 million	10. \$50 million or greater

12. AUTHORIZED REPRESENTATIVE

The forgoing is a statement of facts.

a. SIGNATURE 	b. DATE 3/4/24
c. NAME AND TITLE Christopher Beers, PE, PSM, Project Manager	

ARCHITECT-ENGINEER QUALIFICATIONS

1. SOLICITATION Number (if any)

2024-14

PART II – GENERAL QUALIFICATIONS

(If a firm has branch offices, complete for each specific branch office seeking work)

2a. FIRM (OR BRANCH OFFICE) NAME Johnson Engineering, Inc.			3. YEAR ESTABLISHED 1946	4. DUNS NUMBER 048177498
2b. STREET 17833 Murdock Circle			5. OWNERSHIP	
2c. CITY Port Charlotte			2d. STATE FL	2e. ZIP CODE 33948
6a. POINT OF CONTACT NAME AND TITLE Christopher Beers, PE, PSM, Project Manager			7. NAME OF FIRM (If block 2a is a branch office)	
6b. TELEPHONE NUMBER (941) 625-9919		6c. E-MAIL ADDRESS cbeers@johnsoneng.com		
8a. FORMER FIRM NAME(S) (if any) N/A			8b. YR. ESTABLISHED	8c. DUNS NUMBER

9. EMPLOYEES BY DISCIPLINE				10. PROFILE OF FIRM'S EXPERIENCE AND ANNUAL AVERAGE REVENUE FOR LAST 5 YEARS		
a. Function Code	b. Discipline	c. No. of Employees		a. Profile Code	b. Experience	c. Revenue Index Number (see below)
		(1) FIRM	(2) BRANCH			
02	Administrative	18	1	C15	Construction Management	6
07	Biologist	0	0	D01	Dams (Concrete; Arch)	1
08	CADD Technician	28	1	E09	Environmental Impact Studies	6
12	Civil Engineer	13	1	E10	Environ. & Natural Resource	2
15	Construction Inspector	9	0	G04	Geographic Information System	4
16	Construction Manager	1	0	H07	Highways; Streets; Parking Lots	6
19	Ecologist	8	0	H09	Hospital & Medical Facilities	3
21	Electrical Engineer	1	0	I06	Irrigation; Drainage	6
23	Environmental Engineer	1	0	L02	Land Surveying	7
24	Environmental Scientist	3	0	L03	Landscape Architecture	2
29	GIS Specialist	1	0	P05	Planning (Community; Regional)	6
30	Geologist	3	0	R04	Recreation Facilities	3
33	Hydrographic Surveyor	2	0	R11	Rivers; Canals; Waterway; Flood	2
38	Land Surveyor	18	0	S10	Surveying; Platting; Mapping	7
39	Landscape Architect	2	0	S13	Storm Water Handling & Fac.	2
47	Planner: Urban/Regional	3	0	W02	Water Res.; Hydro; Ground Wat.	2
48	Project Manager	1	1	Z01	Zoning; Land Use Studies	3
58	Technician/Analyst	1	0			
60	Transportation Engineer	3	0			
62	Water Resources Engineer	4	1			
Total		120	5			

11. ANNUAL AVERAGE PROFESSIONAL SERVICES REVENUES OF FIRM FOR LAST 3 YEARS (Insert revenue index number show at right)		PROFESSIONAL SERVICES REVENUE INDEX NUMBER			
a. Federal Work	N/A	1. Less than \$100,000	2. \$100,000 to less than \$250,000	3. \$250,000 to less than \$500,000	4. \$500,000 to less than \$1 million
b. Non-Federal Work	8	5. \$1 million to less than \$2 million	6. \$2 million to less than \$5 million	7. \$5 million to less than \$10 million	8. \$10 million to less than \$25 million
c. Total Work	8			9. \$25 million to less than \$50 million	10. \$50 million or greater

12. AUTHORIZED REPRESENTATIVE The forgoing is a statement of facts.	
a. SIGNATURE 	b. DATE 3/4/2024

c. NAME AND TITLE
Christopher Beers, PE, PSM, Project Manager

3. QUALIFICATIONS OF THE PROJECT TEAM/ PROJECT MANAGER EXPERIENCE

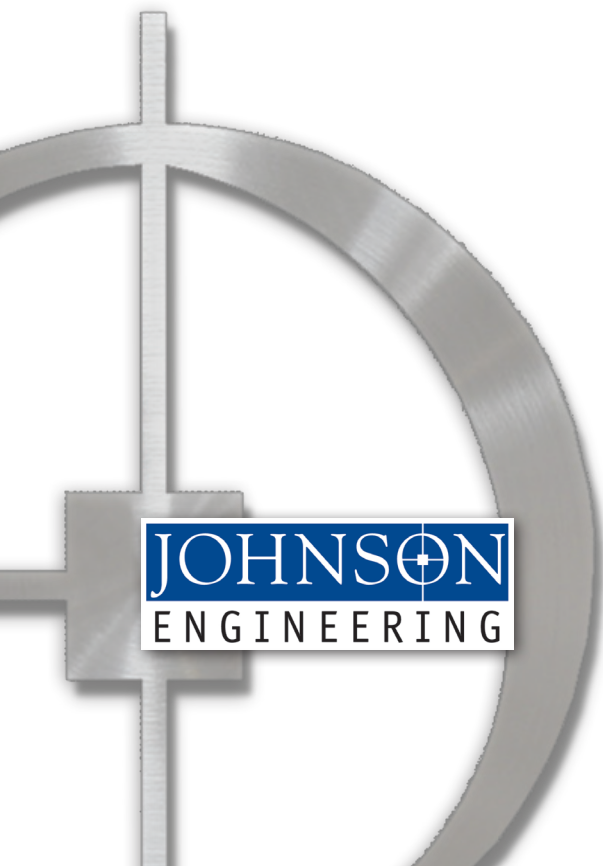

JOHNSON
ENGINEERING

3. QUALIFICATIONS OF THE PROJECT TEAM/PROJECT MANAGER EXPERIENCE

ORGANIZATIONAL STRUCTURE

The organizational chart below shows the key personnel to be utilized on this project and their roles. The Johnson Engineering team has over 120 professional employees in our organization to draw upon to answer the need of any project. Please note this is just the key professionals listed herein and there are literally dozens of additional field technicians, designers, administration staff, ecologists, engineers-in-training and so forth to provide support on your project if need be. All of them are available to support the team and can work under these key team members to make your project a success. We have the necessary capabilities in-house and do not foresee the need to utilize subconsultants at this time.

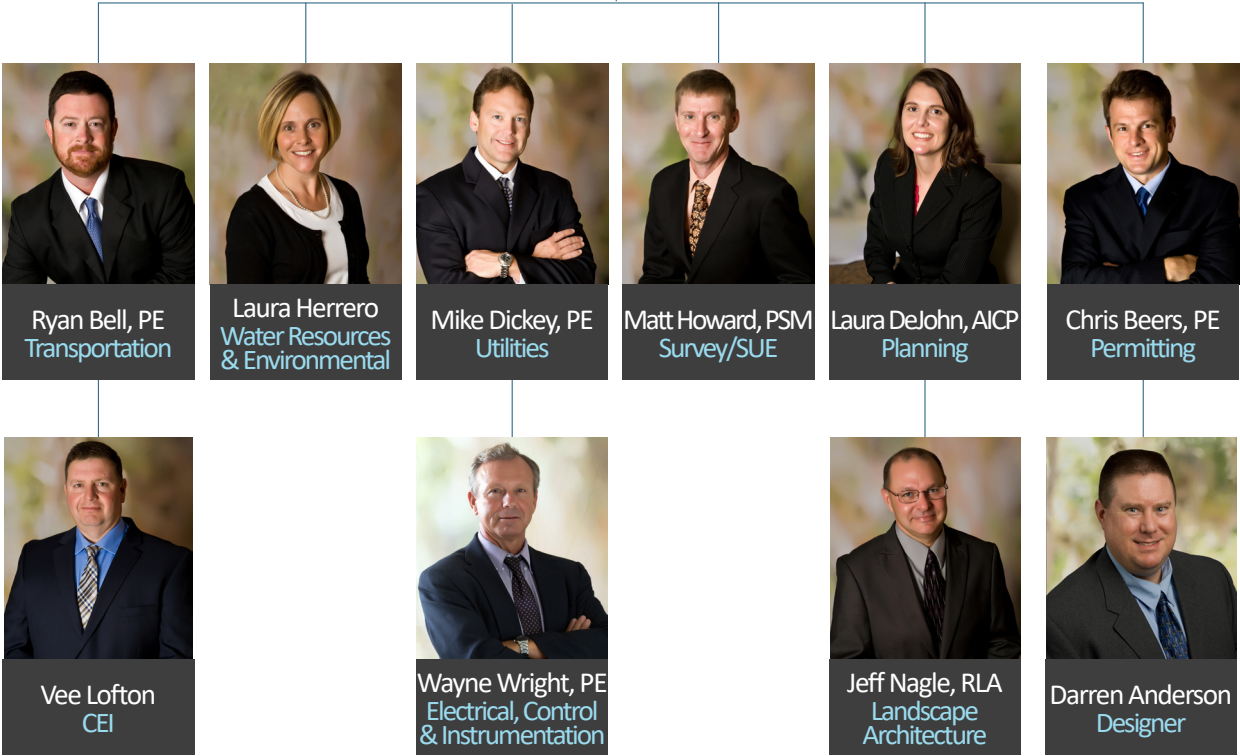

3. QUALIFICATIONS OF THE PROJECT TEAM/PROJECT MANAGER EXPERIENCE

PROJECT MANAGER EXPERIENCE



Chris Beers, PE, PSM - Project Manager

Chris is the branch manager of our Charlotte County office. He has successfully managed and led on many municipal projects including storm structures, sidewalks (paths), regional parks, roadways, bridges and others. He has managed land development projects in Florida, Utah, Kentucky, and Indiana. He is well versed in numerous engineering disciplines, as well as environmental components of the projects he has managed. As the manager of our Charlotte County office, Chris is very familiar with the local stakeholders and issues. He will assist in the coordination with interested parties and local agencies, as well as and permitting compliance correspondence. Additionally, Chris is certified SCUBA diver who's unique skill set helps to provide underwater inspections.

TEAM LICENSES

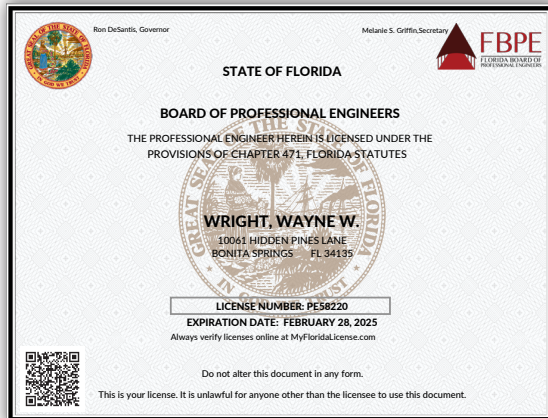
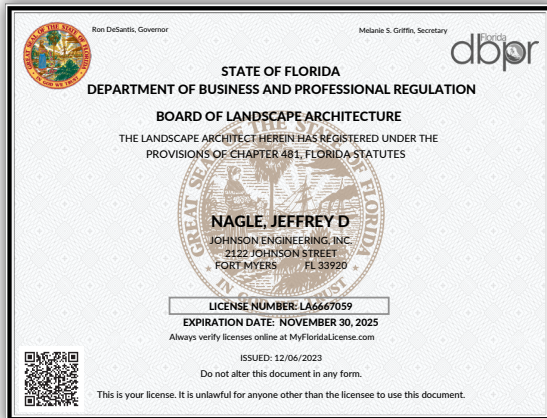
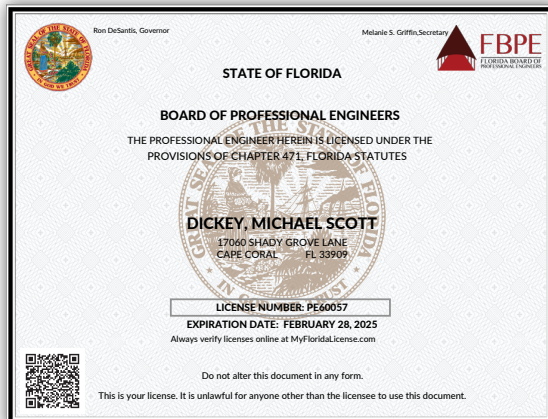
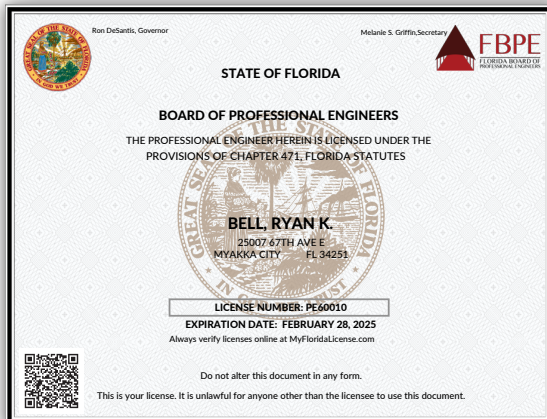
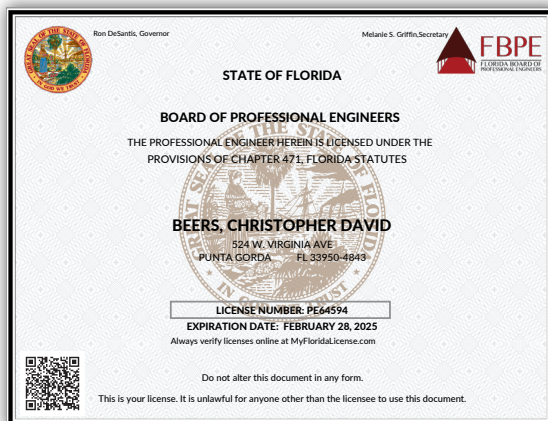
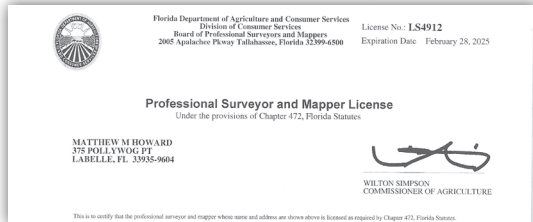
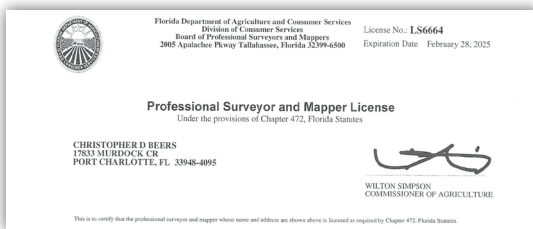

E. RESUMES OF KEY PERSONNEL PROPOSED FOR THIS CONTRACT

(Complete one Section E for each key person.)

12. NAME Christopher Beers, PE, PSM	13. ROLE IN THIS CONTRACT Civil Engineering	14. YEARS EXPERIENCE	
		a. TOTAL 30	b. WITH CURRENT FIRM 18

15. FIRM NAME AND LOCATION <i>(City and State)</i> Johnson Engineering, Port Charlotte, Florida

16. EDUCATION <i>(DEGREE AND SPECIALIZATION)</i> B.S. - Civil Engineering Master of Business Administration (MBA)	17. CURRENT PROFESSIONAL REGISTRATION <i>(STATE AND DISCIPLINE)</i> Florida - PE, PSM Indiana - PE Kentucky - PE, PLS Utah - PE
---	---

18. OTHER PROFESSIONAL QUALIFICATIONS <i>(Publications, Organizations, Training, Awards, etc.)</i> Florida Engineering Society - Myakka Chapter, Peace River Engineering Society, Kentucky Leadership PE, NAUI SCUBA Certified, FDEP Stormwater Management Inspector #20344, Wood Badge SR 907 Alumni, Coral Coast Basketball Officials Association Board of Directors, Economic Development Partners Charlotte County Member

19. RELEVANT PROJECTS

	(1) TITLE AND LOCATION <i>(City and State)</i>	(2) YEAR COMPLETED	
		PROFESSIONAL SERVICES	CONSTRUCTION <i>(If applicable)</i>
	Fire District #10 Charlotte County, Florida	2021	2021
a.	(3) BRIEF DESCRIPTION <i>(Brief scope, size, cost, etc.) AND SPECIFIC ROLE</i> <input checked="" type="checkbox"/> Check if project performed with current firm Johnson Engineering performed the survey, site design, permitting, Charlotte County site plan review, utility design/permitting, environmental, and landscape design for this new fire station on Palm Island. This project was unique as it was on a barrier island and had to abide by the Bridgeless Barrier Island Land Development Zoning code and regulations. Also, the property selection due diligence portion was extensive with the County requiring public meetings and presentation to the Fire Marshal and Board of County Commissioners. The property had gopher tortoises which required extensive environmental studies and gopher tortoise permitting and relocation. The project was completed on time and within budget.		
	West County Regional Park (Oyster Creek Park) Charlotte County, Florida	2006	2007
b.	(3) BRIEF DESCRIPTION <i>(Brief scope, size, cost, etc.) AND SPECIFIC ROLE</i> <input checked="" type="checkbox"/> Check if project performed with current firm This marquee park for the Charlotte County Regional Park system is located in Englewood on San Casa Road. It is a 175-acre park that includes 65+ acres of improvements consisting of three football fields, Cricket field, basketball, tennis, pool facilities, and 18,000 square foot 'state of the art' skate park, along with other amenities. The park has 3,700+ linear feet of nature trails and 3,000+ linear feet of pedestrian trails. Chris served as project manager, field engineer and the engineer of record during the construction phase, completion and agency close-out.		
	MURT Phase 2 & 3 City of Punta Gorda, Florida	2012	
c.	(3) BRIEF DESCRIPTION <i>(Brief scope, size, cost, etc.) AND SPECIFIC ROLE</i> <input checked="" type="checkbox"/> Check if project performed with current firm Johnson Engineering is the engineer of record for Phase 2 and Phase 3 of the City's MURT along U.S. 41. These phases travel U.S. 41 from Airport Road to AQUI ESTA and Monaco Drive to Taylor Road. It will also connect to the current Burnt Store/Jones Loop intersection improvements being constructed. This 10' wide path will help complete the City's master planned "Loop Around the City" and be a great resource for the City's residents. Chris Beers is the engineer of record and project manager and has been coordinating with City officials since the inception of the project. Much coordination with FDOT, FPL Fibernet, Railroad, Lighting and others is necessary for the completion of this project.		
	Eastport Master Planning Charlotte County, Florida	2018	2018
d.	(3) BRIEF DESCRIPTION <i>(Brief scope, size, cost, etc.) AND SPECIFIC ROLE</i> <input checked="" type="checkbox"/> Check if project performed with current firm Johnson Engineering provided professional planning and design services for approximately 691 acres located in the northwest quadrant of Interstate 75 and Harborview Road in Port Charlotte. The goal of this project was to create a long-term plan for future County facilities. We conducted interviews with personnel of five Departments/Divisions to determine anticipated needs and trends over a 20-year horizon to accommodate future growth of: Facilities Construction and Maintenance, Utilities (Loveland Complex, Administration, Warehouse), Community Services Maintenance and Natural Resources, Public Works Administration, Operations and Engineering. The Master Plan provides a framework and vision for the County to ensure adequate access, parking, water management, building space, yard areas, and open space are allocated within the County's government facility campus so they can meet future demands.		

E. RESUMES OF KEY PERSONNEL PROPOSED FOR THIS CONTRACT
(Complete one Section E for each key person.)

12. NAME Ryan Bell, PE, PTOE	13. ROLE IN THIS CONTRACT Transportation	14. YEARS EXPERIENCE	
		a. TOTAL 26	b. WITH CURRENT FIRM 26
15. FIRM NAME AND LOCATION (City and State) Johnson Engineering, Fort Myers, Florida			
16. EDUCATION (DEGREE AND SPECIALIZATION) B.S. - Civil Engineering		17. CURRENT PROFESSIONAL REGISTRATION (STATE AND DISCIPLINE) Florida - P.E. Florida - P.T.O.E.	
18. OTHER PROFESSIONAL QUALIFICATIONS (Publications, Organizations, Training, Awards, etc.) ASCE, FES, FDOT certified in Asphalt I, Asphalt II, Earthwork I, Earthwork II, QC Manager, Advanced MOT and Troxler			

19. RELEVANT PROJECTS

	(1) TITLE AND LOCATION (City and State)	(2) YEAR COMPLETED	
		PROFESSIONAL SERVICES	CONSTRUCTION (If applicable)
a.	NE 34th Avenue Roadway Improvements Okeechobee County, Florida	2018	2018
	(3) BRIEF DESCRIPTION (Brief scope, size, cost, etc.) AND SPECIFIC ROLE <input checked="" type="checkbox"/> Check if project performed with current firm Ryan was responsible for the design services for this half mile resurfacing project. Services include traffic analysis, pavement design, utility coordination and construction plan preparation for roadway milling and resurfacing and minor drainage improvements. This project is funded through FDOT's Small County Outreach Pro-gram (SCOP) and Small County Rural Assistance Program (SCRAP).		
b.	304th Street Box Culvert Remediation Okeechobee County, Florida	2019	2019
	(3) BRIEF DESCRIPTION (Brief scope, size, cost, etc.) AND SPECIFIC ROLE <input checked="" type="checkbox"/> Check if project performed with current firm Ryan was the project manager responsible for the design and construction phase services for this box culvert remediation project in Okeechobee County. The project was funded by FEMA and included repair and reconstruction of facilities damaged in Hurricane Irma. Work included inspection of existing conditions, repair of a roadway washout, channel sedimentation removal, removal of concrete wingwalls and construction of new steel sheet pile wingwalls.		
c.	Helms Road Hendry County, Florida	2013	2019
	(3) BRIEF DESCRIPTION (Brief scope, size, cost, etc.) AND SPECIFIC ROLE <input checked="" type="checkbox"/> Check if project performed with current firm Ryan is the project manager for design and CEI of approximately three miles of new four-lane roadway in Hendry County. Work includes all associated drainage, permitting, signalization and signing and marking. This project is currently under construction.		
d.	Turner Avenue LAP Intersection Improvements DeSoto County, Florida	2018	2018
	(3) BRIEF DESCRIPTION (Brief scope, size, cost, etc.) AND SPECIFIC ROLE <input checked="" type="checkbox"/> Check if project performed with current firm Ryan is the project manager responsible to design intersection improvements at the intersection of NE Turner Avenue and Roan / Gibson Street. This intersection is directly adjacent to DeSoto High School and was experiencing excessive delay during peak traffic hours. Johnson Engineering performed a traffic analysis to optimize intersection timing and determine the required length of the proposed turn lanes. Design services included the addition of left turn lanes, pavement rehabilitation, improvements to existing pedestrian infrastructure as well as compliance with the Statewide School Zone Implementation plan. This project was federally funded through FDOT's LAP program and plans were reviewed through the Electronic Review Comment (ERC) system. The design was completed ahead of schedule in August 2018.		

E. RESUMES OF KEY PERSONNEL PROPOSED FOR THIS CONTRACT

(Complete one Section E for each key person.)

12. NAME Laura B. Herrero	13. ROLE IN THIS CONTRACT Water Resources & Environmental	14. YEARS EXPERIENCE	
		a. TOTAL 30	b. WITH CURRENT FIRM 24

15. FIRM NAME AND LOCATION (City and State)
Johnson Engineering, Fort Myers, Florida

16. EDUCATION (Degree and Specialization) BS - Ecology	17. CURRENT PROFESSIONAL REGISTRATION (State And Discipline) N/A
--	--

18. OTHER PROFESSIONAL QUALIFICATIONS (Publications, Organizations, Training, Awards, etc.)
 FWC Authorized Gopher Tortoise Agent; FWC Burrowing Owl Authorized Agent; FAA Qualified Airport Wildlife Biologist; Certified Ecologist with the Ecological Society of America; Appointed Member City of Fort Myers Planning Board (2009-2018); three year board member of the Southwest Florida Association of Environmental Professionals; presentation/manuscript to Sustainable Water Resources Roundtable at FGCU in December 2016; second author "Fish Community Structure of Streams and Canals at Babcock Ranch," Florida Scientist, April/May 2013 issue.

19. RELEVANT PROJECTS

	(1) TITLE AND LOCATION (City and State)	(2) YEAR COMPLETED	
		PROFESSIONAL SERVICES	CONSTRUCTION (If applicable)
a.	City of Cape Coral SW6/7 Utilities Extension Project (Cape Coral, Florida)	2012	2015
	(3) BRIEF DESCRIPTION (Brief scope, size, cost, etc.) AND SPECIFIC ROLE <input checked="" type="checkbox"/> Check if project performed with current firm The overall project involved approximately 51 miles of new utility lines, including potable water distribution, irrigation/reclaimed water distribution, wastewater gravity collection and transmission, wastewater pumping, irrigation/canal pumping, roadway improvements and storm water improvements. Environmental Director of team that identified a total of 95 burrowing owl burrows, 36 gopher tortoise burrows and five active bald eagle nests within the project vicinity during the protected species surveys. Our environmental team was responsible for obtaining the Environmental Resource Permit (ERP) issued by the Florida Department of Environmental Protection (FDEP), the burrowing owl Incidental Take Permit and gopher tortoise Conservation Permit required by the Florida Fish and Wildlife Conservation Commission (FWC), and preparation of a bald eagle management plan to address the bald eagle nests within the construction area.		
b.	Gasparilla Island Bridge Authority Boca Grande Causeway Swing Bridge Replacement (Boca Grande, Florida)	2013	
	(3) BRIEF DESCRIPTION (Brief scope, size, cost, etc.) AND SPECIFIC ROLE <input checked="" type="checkbox"/> Check if project performed with current firm Environmental Manager overseeing wetland delineations, GPS location of seagrass beds & mangroves, and listed species surveys. Prepared Biological Assessment per NEPA regulations, protection plans for manatee, sea turtles and smalltooth sawfish, and cost estimates. Designed mitigation for seagrass/mangrove impacts. Obtained permits/approvals from USACE, Southwest Florida Water Management District (SWFWMD), U.S. Coast Guard (USCG), NMFS, and West Coast Inland Navigation District (WCIND).		
c.	Gasparilla Island Water Authority (Boca Grande, Florida)	2013	
	(3) BRIEF DESCRIPTION (Brief scope, size, cost, etc.) AND SPECIFIC ROLE <input checked="" type="checkbox"/> Check if project performed with current firm Environmental Manager overseeing wetland delineation, habitat mapping, protected species surveys, environmental permitting, wood stork prey base assessment, and mitigation assessment for the installation of a new 12-inch water main in Gasparilla Sound via subaqueous directional drill to avoid impacts to mangroves and sea grasses. National Marine Fisheries Service (NMFS) coordination was required to ensure the project did not adversely affect smalltooth sawfish critical habitat. The project also affected a federal navigation channel and required Section 408 permitting with the U.S. Army Corps of Engineers (USACE) Jacksonville office.		
d.	Charlotte Harbor Water Association Distribution System Improvements (Punta Gorda, Florida)	ongoing	
	(3) BRIEF DESCRIPTION (Brief scope, size, cost, etc.) AND SPECIFIC ROLE <input checked="" type="checkbox"/> Check if project performed with current firm Environmental Director - overseeing all aspects of environmental surveys/permitting to replace 13+/- miles of aged potable water main pipe in Harbor Heights community adjacent to Whidden Bay and Peace River. Over 650 gopher tortoise burrows were GPS located and over 15 different Florida scrub jay groups were identified. Environmental reports were prepared with listed species management plans per NEPA regulations to secure financial assistance under the USDA Rural Development, Rural Utilities Service's Water and Environmental Program.		

E. RESUMES OF KEY PERSONNEL PROPOSED FOR THIS CONTRACT
(Complete one Section E for each key person.)

12. NAME Michael Dickey, PE	13. ROLE IN THIS CONTRACT Utilities	14. YEARS EXPERIENCE	
		a. TOTAL 27	b. WITH CURRENT FIRM 25
15. FIRM NAME AND LOCATION (City and State) Johnson Engineering, Fort Myers, Florida			
16. EDUCATION (Degree and Specialization) B.S. - Civil Engineering		17. CURRENT PROFESSIONAL REGISTRATION (State And Discipline) Florida - PE	
18. OTHER PROFESSIONAL QUALIFICATIONS (Publications, Organizations, Training, Awards, etc.)			

19. RELEVANT PROJECTS

a.	(1) TITLE AND LOCATION (City and State) Northeast Service Area WWTP, IQ & Potable Booster Pump Stations, Collier County, FL	(2) YEAR COMPLETED	
		PROFESSIONAL SERVICES Ongoing	CONSTRUCTION (If applicable) Ongoing
	(3) BRIEF DESCRIPTION (Brief scope, size, cost, etc.) AND SPECIFIC ROLE <input checked="" type="checkbox"/> Check if project performed with current firm Mike is responsible for providing utility improvements to approximately 1,100 existing residential properties as part of Cape Corals Southwest 6 & 7 utility extension program. Areas 1 and 2 include approximately 53,000 linear feet of gravity sewer main; 56,000 linear feet of potable water main; 58,000 linear feet of irrigation main; two wastewater pump stations; 9,800 linear feet of wastewater force main; and 5,400 linear feet of storm drain improvements. The construction cost for all improvements in these two areas was \$12.5 million. Johnson Engineering is providing the value engineering, plan adoption of previous design, design modifications, pump station design, permitting, bidding assistance and construction phase services. The estimated construction cost is \$12.5 million.		
b.	(1) TITLE AND LOCATION (City and State) Phase III-C Utility Improvements Fort Myers, FL	(2) YEAR COMPLETED	
		PROFESSIONAL SERVICES 2003	CONSTRUCTION (If applicable) Ongoing
	(3) BRIEF DESCRIPTION (Brief scope, size, cost, etc.) AND SPECIFIC ROLE <input checked="" type="checkbox"/> Check if project performed with current firm This project consisted of the design of approximately 60,000 linear feet of gravity sewer main, 40,000 linear feet of potable water main and 21,000 linear feet of storm drain. The project was approximately one square mile in size and involved improvements within existing residential, multi-family, commercial and light industrial properties. Johnson Engineering provided survey, design, permitting, hydraulic modeling, bidding assistance and construction phase services.		
c.	(1) TITLE AND LOCATION (City and State) Priority 1 Water Main Replacement Bonita Springs, FL	(2) YEAR COMPLETED	
		PROFESSIONAL SERVICES 2016	CONSTRUCTION (If applicable) Ongoing
	(3) BRIEF DESCRIPTION (Brief scope, size, cost, etc.) AND SPECIFIC ROLE <input checked="" type="checkbox"/> Check if project performed with current firm This project consisted of the replacement of approximately 24,000 linear feet of 12", 8" and 4" water main in Bonita Springs along various streets located in between Bonita Beach Road and the Imperial River. Key design elements included identifying an alignment within congested rights of way that would accomplish project goals while minimizing impacts to the existing residents and allow the existing asbestos cement and class pipe water mains to remain in service during construction. Design also included several directional drills to cross creeks and other environmentally sensitive areas. Project also required close coordination with the City of Bonita Springs who owned and maintained the road rights of way. Johnson Engineering provided the survey, design, and permitting, bidding service and construction administration for this project.		
d.	(1) TITLE AND LOCATION (City and State) Phase 1A Watermain Replacement and Drainage Improvements, Town of Fort Myers Beach, FL	(2) YEAR COMPLETED	
		PROFESSIONAL SERVICES 2017	CONSTRUCTION (If applicable) 2021
	(3) BRIEF DESCRIPTION (Brief scope, size, cost, etc.) AND SPECIFIC ROLE <input checked="" type="checkbox"/> Check if project performed with current firm This was a design-build project that included watermain replacement and drainage improvements within the Phase 1A residential area on Estero Island. Design included approximately 10,000 linear feet of water-main and 8,000 linear feet of storm sewer. The project consisted of working within a heavily improved residential area with limited right of way. Due to high construction impacts to residents and local businesses, Johnson teamed with Cella Molnar to help with public relations and held town hall meetings and created a website to keep the community informed. Johnson Engineering provided survey, SUE, utility and drainage design, environmental permitting, construction administration and public involvement.		

E. RESUMES OF KEY PERSONNEL PROPOSED FOR THIS CONTRACT
 (Complete one Section E for each key person.)

12. NAME Matthew Howard, PSM	13. ROLE IN THIS CONTRACT Surveying & Mapping	14. YEARS EXPERIENCE	
		a. TOTAL 48	b. WITH CURRENT FIRM 24
15. FIRM NAME AND LOCATION (City and State) Johnson Engineering, Fort Myers, Florida			
16. EDUCATION (DEGREE AND SPECIALIZATION)		17. CURRENT PROFESSIONAL REGISTRATION (STATE AND DISCIPLINE) Florida - P.S.M.	
18. OTHER PROFESSIONAL QUALIFICATIONS (Publications, Organizations, Training, Awards, etc.)			

19. RELEVANT PROJECTS

a.	(1) TITLE AND LOCATION (City and State) Hilliard Brothers of Florida Hendry County, Florida	(2) YEAR COMPLETED	
		PROFESSIONAL SERVICES 2015	CONSTRUCTION (If applicable)
	(3) BRIEF DESCRIPTION (Brief scope, size, cost, etc.) AND SPECIFIC ROLE <input checked="" type="checkbox"/> Check if project performed with current firm Matt was the surveyor in charge for a 7,600 acre parcel of land with future development intents. Surveying efforts included a boundary survey of the entire parcel, horizontal location of existing improvements, and title work.		
b.	(1) TITLE AND LOCATION (City and State) Edison Farms, Lee County Board of County Commissioners Lee County, Florida	(2) YEAR COMPLETED	
		PROFESSIONAL SERVICES 2018	CONSTRUCTION (If applicable)
	(3) BRIEF DESCRIPTION (Brief scope, size, cost, etc.) AND SPECIFIC ROLE <input checked="" type="checkbox"/> Check if project performed with current firm Matt was the surveyor in charge for the boundary survey of an approximately 3,800 acre parcel of land to be included in conservation lands for the county. The survey required out parcels for the Florida Department of Transportation, access easements, and location of existing improvements.		
c.	(1) TITLE AND LOCATION (City and State) Fort Denaud Road, Hendry County Board of County Commissioners Hendry County, Florida	(2) YEAR COMPLETED	
		PROFESSIONAL SERVICES 2018	CONSTRUCTION (If applicable)
	(3) BRIEF DESCRIPTION (Brief scope, size, cost, etc.) AND SPECIFIC ROLE <input checked="" type="checkbox"/> Check if project performed with current firm Matt is the surveyor on charge for providing design surveying services for two and one-half miles of roadway for reconstruction. Efforts included horizontal and vertical location of all improvements and drainage facilities for design purposes. This is a county road and does not have an official right-of-way map and the county has requested that these services also include surveying and preparing a occupied and maintained right-of-way map.		
d.	(1) TITLE AND LOCATION (City and State) United States Sugar Corporation Glades, Hendry, Palm Beach Counties, Florida	(2) YEAR COMPLETED	
		PROFESSIONAL SERVICES 2009	CONSTRUCTION (If applicable)
	(3) BRIEF DESCRIPTION (Brief scope, size, cost, etc.) AND SPECIFIC ROLE <input checked="" type="checkbox"/> Check if project performed with current firm Matt was the project manager for United States Sugar Corporation surveys from July 2008 – February 2009. Management of six field crews and over twenty office personnel, professional and technical. This project included boundary survey and mapping of approximately 85,000 acres in Hendry, Glades and Palm Beach counties. Johnson Engineering prepared boundary surveys and right-of-way mapping for approximately sixty miles of United States Sugar Corporation railroad. Our firm was tasked with vesting deeds mapping, deeds in / deeds out, for +/- 187,000 acres of land owned by United States Sugar Corporation in Hendry, Glades and Palm Beach county. This project included mapping of drainage canals in all of the 298 drainage districts within United States Sugar Corporation lands, by our firm.		

E. RESUMES OF KEY PERSONNEL PROPOSED FOR THIS CONTRACT

(Complete one Section E for each key person.)

12. NAME Laura DeJohn, AICP	13. ROLE IN THIS CONTRACT Planning	14. YEARS EXPERIENCE	
		a. TOTAL 26	b. WITH CURRENT FIRM 20

15. FIRM NAME AND LOCATION <i>(City and State)</i> Johnson Engineering, Fort Myers, Florida
--

16. EDUCATION <i>(Degree and Specialization)</i> Master of Planning - American Urbanism Bachelor of City Planning	17. CURRENT PROFESSIONAL REGISTRATION <i>(State And Discipline)</i> AICP (American Institute of Certified Planners)
---	--

18. OTHER PROFESSIONAL QUALIFICATIONS <i>(Publications, Organizations, Training, Awards, etc.)</i> Member, APA (American Planning Association)

19. RELEVANT PROJECTS

	(1) TITLE AND LOCATION <i>(City and State)</i>	(2) YEAR COMPLETED	
		PROFESSIONAL SERVICES	CONSTRUCTION <i>(If applicable)</i>
a.	Comprehensive Plan, Village of Estero, FL	2019	
	(3) BRIEF DESCRIPTION <i>(Brief scope, size, cost, etc.) AND SPECIFIC ROLE</i> <input checked="" type="checkbox"/> Check if project performed with current firm Laura assisted with the data collection, analysis, public involvement, and drafting of the Village's first Comprehensive Plan and continues in providing similar services in preparation of the Village's first Land Development Code. Laura's focus was the Future Land Use Element and Map, Community Design Sub-Element, formatting of the final comprehensive plan, architectural and landscape standards, and presentations to the Planning and Zoning Board and Village Council.		
b.	Babcock Ranch Community, Lee & Charlotte Counties, FL	2014	
	(3) BRIEF DESCRIPTION <i>(Brief scope, size, cost, etc.) AND SPECIFIC ROLE</i> <input checked="" type="checkbox"/> Check if project performed with current firm Laura and her team are responsible for preparing the Comprehensive Plan Amendments and Land Development regulations, and the Communitywide Pattern Book adopted in the Charlotte County Land Development Code outlining strategies for development while upholding the quality of critical natural areas and systems for the 13,630-acre Babcock Ranch Community. The Community Plan emphasizes connectivity with a network of transportation facility options that include the spectrum from urban scale streets to alleyways, multiuse paths, and autonomous vehicle paths. Laura also provided planning services necessary for local permitting of a 75 Megawatt Solar Facility for the project.		
c.	Southwest Florida International Airport (RSW) - Skyplex Master Planning, Lee County, FL	2019	
	(3) BRIEF DESCRIPTION <i>(Brief scope, size, cost, etc.) AND SPECIFIC ROLE</i> <input checked="" type="checkbox"/> Check if project performed with current firm Laura and her team provided master planning services to determine the build out potential for a 2,520-acre area in Lee County along Daniels Parkway, south of JetBlue Stadium. This included design coordination and phased schematic plans for the layout of access, circulation, green space, surface water management, and parcels for potential development in accordance with market-based tenant site selection criteria. Laura managed the master planning of uses, phasing of permissible development alternatives, and coordination with other engineering and environmental consultants. Laura led efforts to obtain comprehensive plan amendment approval and Planned Development rezoning approval for over 1 million square feet of office, hotel, commercial, and industrial development. Laura serves as project manager for a wide range of environmental and planning services for RSW and FMY Airports, from annual water quality and water level monitoring to more specialized projects involving the evaluation of wildlife hazard risks and airport planning.		
d.	Enterprise Charlotte Airport Park (ECAP), Charlotte County, FL	2018	
	(3) BRIEF DESCRIPTION <i>(Brief scope, size, cost, etc.) AND SPECIFIC ROLE</i> <input checked="" type="checkbox"/> Check if project performed with current firm Laura provided professional planning services to prepare updates and revisions for the Enterprise Charlotte Airport Park (ECAP) zoning district. The district covers 4,380 acres. The district was originally intended for development of a high technology business and commercial park environment with strict guidelines covering 35 different aspects of site development. Our team facilitated public input on issues and visioning that resulted in a re-writing of the code to encourage and promote economic development, make the zoning standards clear and concise, provide a degree of flexibility for development options, and provide standards that maintain quality appearance and consistency in design.		

E. RESUMES OF KEY PERSONNEL PROPOSED FOR THIS CONTRACT
(Complete one Section E for each key person.)

12. NAME James "Vee" Lofton	13. ROLE IN THIS CONTRACT Construction Engineering & Inspection	14. YEARS EXPERIENCE	
		a. TOTAL 36	b. WITH CURRENT FIRM 16

15. FIRM NAME AND LOCATION (City and State)
Johnson Engineering, Fort Myers, Florida

16. EDUCATION (DEGREE AND SPECIALIZATION) Edison Community College	17. CURRENT PROFESSIONAL REGISTRATION (STATE AND DISCIPLINE)
--	--

18. OTHER PROFESSIONAL QUALIFICATIONS (Publications, Organizations, Training, Awards, etc.)
FDOT Advanced Work Zone Traffic Control, Troxler Nuclear Gauge Safety Certification, ACI Concrete Field Testing Technician – Grade I-II (ID #00928086), FDOT Asphalt Paving Technician I & II, FDOT Earthwork Construction Inspection – Level I-II, FDOT Concrete Field Technician – Level I, FDOT Concrete Spec Section 346 / 400, FDOT Drilled Shaft Installation Inspection, FDOT Pile Driving Installation Inspection

19. RELEVANT PROJECTS

a.	(1) TITLE AND LOCATION (City and State) Pelican Marsh CDD Lee County, Florida	(2) YEAR COMPLETED	
		PROFESSIONAL SERVICES Ongoing	CONSTRUCTION (If applicable) Ongoing
	(3) BRIEF DESCRIPTION (Brief scope, size, cost, etc.) AND SPECIFIC ROLE <input checked="" type="checkbox"/> Check if project performed with current firm Last fall, the community began a multi-year roadway paving of the main roads. Vee, along with our transportation group, provided a pavement condition report and construction engineering and inspection services during the completed paving project to monitor the contractors performance and verify invoicing quantities.		
b.	(1) TITLE AND LOCATION (City and State) FDOT Consultant Program Manager, Broadband Class Code: Level (3), Fort Myers, Florida	(2) YEAR COMPLETED	
		PROFESSIONAL SERVICES	CONSTRUCTION (If applicable) 2006-2008
	(3) BRIEF DESCRIPTION (Brief scope, size, cost, etc.) AND SPECIFIC ROLE <input type="checkbox"/> Check if project performed with current firm Vee assists the Fort Myers Operations Center Engineering Manager by overseeing Consultant Construction Engineering and Inspection (CCEI) administration of construction contracts and by administering CCEI contracts. He also monitored, reviewed and evaluated CCEI firms contracted by the Department to administer construction projects to ensure work was performed in accordance with contract requirements, Department policy and procedure, and/or Construction Project Administration Manual, (CPAM). Vee was also responsible for reviewing and making recommendations for approval of changes on project/contract records, supplemental agreements; including time and money issues, monetary claim packages, requests for time extensions, and other contract related documents prepared by the consultant to ensure completeness and conformity to Department procedures and policies. He also served FDOT as CCEI Consultant Program Manger.		
c.	(1) TITLE AND LOCATION (City and State) Helms Roadway Extension Hendry County, Florida	(2) YEAR COMPLETED	
		PROFESSIONAL SERVICES Ongoing	CONSTRUCTION (If applicable)
	(3) BRIEF DESCRIPTION (Brief scope, size, cost, etc.) AND SPECIFIC ROLE <input type="checkbox"/> Check if project performed with current firm Vee is responsible for the construction engineering & inspection for approximately three miles of new four-lane urban roadway improvements. His roles include soil density testing and sampling, concrete testing, review of pay requests, shop drawings and RFI's. This project includes the construction of four box culverts and one box culvert extension.		
d.	(1) TITLE AND LOCATION (City and State) Peace River Bridge Punta Gorda, Florida	(2) YEAR COMPLETED	
		PROFESSIONAL SERVICES	CONSTRUCTION (If applicable) 2001-2003
	(3) BRIEF DESCRIPTION (Brief scope, size, cost, etc.) AND SPECIFIC ROLE <input type="checkbox"/> Check if project performed with current firm The I-75 Peace River Bridge Design- Build Project consisted of the construction of a new bridge structure between the existing bridges, replacement of the existing concrete bridge deck and removal of the Northbound I-75 bridge to its entirety, to widen the existing roadway to a six-lane facility. The project included widening of the existing bridge structure over Riverside Drive and Gulf Seminole Railway. Vee served as Project Administrator for FDOT and FHWA as this project was a pilot design build project with FHWA oversight.		

E. RESUMES OF KEY PERSONNEL PROPOSED FOR THIS CONTRACT

(Complete one Section E for each key person.)

12. NAME Wayne Wright, PE	13. ROLE IN THIS CONTRACT Electrical, Control & Instrumentation	14. YEARS EXPERIENCE	
		a. TOTAL 42	b. WITH CURRENT FIRM 8
15. FIRM NAME AND LOCATION <i>(City and State)</i> Johnson Engineering, Inc., Fort Myers, Florida			
16. EDUCATION <i>(DEGREE AND SPECIALIZATION)</i> B.S. - Engineering		17. CURRENT PROFESSIONAL REGISTRATION <i>(STATE AND DISCIPLINE)</i> Florida - PE	
18. OTHER PROFESSIONAL QUALIFICATIONS <i>(Publications, Organizations, Training, Awards, etc.)</i>			

19. RELEVANT PROJECTS

	(1) TITLE AND LOCATION <i>(City and State)</i>	(2) YEAR COMPLETED	
		PROFESSIONAL SERVICES	CONSTRUCTION <i>(If applicable)</i>
a.	North Lee County Deep Injection Well #2 Electrical Systems North Fort Myers, Florida	2017	
	(3) BRIEF DESCRIPTION <i>(Brief scope, size, cost, etc.) AND SPECIFIC ROLE</i> <input checked="" type="checkbox"/> Check if project performed with current firm Electrical engineering services were provided, which entailed the development of initial electrical plans for client review, including piping and instrumentation diagram/drawing (P&ID), demo drawings of existing equipment, conduit ductbank design and routing, conduit/wiring plans, grounding and bonding plans, single-line diagrams, network diagrams, equipment mounting plans, control panel layouts, control panel wiring schematics and associated details. Johnson Engineering will also be providing ongoing miscellaneous electrical services through final design and construction.		
b.	Loveland Grand Master Lift Station (LGMLS) & 48' Interceptor Port Charlotte, Florida	2017	
	(3) BRIEF DESCRIPTION <i>(Brief scope, size, cost, etc.) AND SPECIFIC ROLE</i> <input checked="" type="checkbox"/> Check if project performed with current firm This project for Charlotte County is currently ongoing and includes the engineering design and permitting for the grand master lift station in the East Port Water Reclamation Facility, approximately 13,500 linear feet (LF) of 48" gravity sewer interceptor pipe and associated improvements. The 48" interceptor primarily connects from Midway Boulevard to Olean Boulevard, along Kings Highway and Loveland Boulevard, then east into the East Port plant. Initial master planning was prepared with a conceptual road extension for access alignments for the 48" interceptor pipes within and around the East Port property. The project also includes other connections with 1,400 LF of 24" gravity sewer to I-75 for Deep Creek, 1,182 LF of 24" gravity sewer south along Loveland to Old Landfill Road, 1,840 LF of 36" gravity sewer to Hemenway for Olean and 2,067 LF of 12" watermain.		
c.	North County Water Reclamation Facility Electrical Services #1 Upgrade, Collier County, FL	2021	
	(3) BRIEF DESCRIPTION <i>(Brief scope, size, cost, etc.) AND SPECIFIC ROLE</i> <input type="checkbox"/> Check if project performed with current firm For this project, Wayne completed design to replace existing 3200a switchgear with a gen-gen-main-tie-main-gen-a-bus/b-bus arrangement. The design allowed for the proposed equipment to be placed in the same location as the existing equipment without any building modifications. Two existing 1250kw generators were to be connected with paralleling controls upgrades. Construction and integration services are ongoing including a switchgear ab plc controller and ab operator interface.		
d.	Northeast Wastewater Service Area WRF, IQ Booster Station & Potable Booster Station, Naples, FL	Ongoing	
	(3) BRIEF DESCRIPTION <i>(Brief scope, size, cost, etc.) AND SPECIFIC ROLE</i> <input type="checkbox"/> Check if project performed with current firm As part of a multi-discipline design/build team, this is an active project to provide all electrical design, construction, and integration services to build a new Wastewater Reclamation Facility and two co-located booster stations. The WRF will consist of two independent 750,000 GPD interconnected units for reliability that will have a total capacity of 1.5 MGD on a Maximum Monthly Average Daily Flow basis and will utilize onsite rapid infiltration basins for effluent disposal. A new electrical room, 3200-amp switchgear, two motor control centers, distribution panelboards, various instrumentation, and six PLC-based control panels. All PLC programming, integration, and commissioning will be provided as well. There will be two 500KW generators configured in parallel for standby power.		

E. RESUMES OF KEY PERSONNEL PROPOSED FOR THIS CONTRACT
(Complete one Section E for each key person.)

12. NAME Jeff Nagle, RLA	13. ROLE IN THIS CONTRACT Landscape Architecture	14. YEARS EXPERIENCE	
		a. TOTAL 40	b. WITH CURRENT FIRM 12

15. FIRM NAME AND LOCATION (City and State) Johnson Engineering, Fort Myers, Florida
--

16. EDUCATION (DEGREE AND SPECIALIZATION) B.S./Landscape Architecture Rutgers University, Cook College, 1986	17. CURRENT PROFESSIONAL REGISTRATION (STATE AND DISCIPLINE) Florida/Landscape Architecture New Jersey/Landscape Architecture
--	---

18. OTHER PROFESSIONAL QUALIFICATIONS (Publications, Organizations, Training, Awards, etc.) Florida Registered Landscape Architect, New Jersey Licensed Landscape Architect, New Jersey Licensed Professional Planner, American Society of Landscape Architects member
--

19. RELEVANT PROJECTS

a.	(1) TITLE AND LOCATION (City and State) South Biscayne Drive Median Landscape Renovations City of North Port, FL	(2) YEAR COMPLETED	
		PROFESSIONAL SERVICES 2014	CONSTRUCTION (if applicable)
	(3) BRIEF DESCRIPTION (Brief scope, size, cost, etc.) AND SPECIFIC ROLE <input checked="" type="checkbox"/> Check if project performed with current firm This landscaping project of 1.5 miles of roadway median renovation is located within the ROW of South Biscayne Drive within in the City of North Port. The outdated landscape medians consisted of mainly of Cabbage Palms that were well beyond their peak of maturity. This renovation was the City's response to the surrounding residential community's desire to improve the neighborhoods main roadway character. The final design will include drought tolerant FL friendly plantings to reflect the character of the community and ensure durability, sustainability, and reduced maintenance requirements. Sustainable practices will include hydrant supplemented low volume irrigation, soil amendments with compost and water absorbing polymers to insure plant health and the removal of all turf areas to reduce maintenance effort and costs.		
b.	(1) TITLE AND LOCATION (City and State) West County Sheriff Station District 1 Charlotte County, FL	(2) YEAR COMPLETED	
		PROFESSIONAL SERVICES 2018	CONSTRUCTION (if applicable)
	(3) BRIEF DESCRIPTION (Brief scope, size, cost, etc.) AND SPECIFIC ROLE <input checked="" type="checkbox"/> Check if project performed with current firm Johnson Engineering's landscape architectural team prepared landscape and irrigation design and construction plans for County permitting, bidding and construction of the new West County Sheriff Station site containing approximately 5.5 acres, located at the intersection of Sunnybrook Boulevard and Wilmington Boulevard in Englewood, Charlotte County. The landscaping design was unique on this project requiring compliance with not only Charlotte County's Land Development Code requirements but also with Homeland Security design requirements and implementing design principles of Crime Prevention Through Environmental Design (CPTED) for the placement of proposed landscaping materials due to the nature of the site use and heightened security requirements. Our team provided landscape architectural services for design, bidding assistance, and construction oversight on this project.		
c.	(1) TITLE AND LOCATION (City and State) Rotonda West Entry Signs Charlotte County, FL	(2) YEAR COMPLETED	
		PROFESSIONAL SERVICES 2014	CONSTRUCTION (if applicable) 2014
	(3) BRIEF DESCRIPTION (Brief scope, size, cost, etc.) AND SPECIFIC ROLE <input checked="" type="checkbox"/> Check if project performed with current firm Jeff was responsible for updating the their existing and deteriorating identity signs at five locations. The scope of this project included the development of a new sign that would embody the character of the community while being sensitive to the budget. Through a series of public meetings and concept development a new sign emerged to reflect this established community and its history.		
d.	(1) TITLE AND LOCATION (City and State) Harbor Trail & Wayfinding Parmely Street Charlotte County, Florida	(2) YEAR COMPLETED	
		PROFESSIONAL SERVICES Ongoing	CONSTRUCTION (if applicable) Ongoing
	(3) BRIEF DESCRIPTION (Brief scope, size, cost, etc.) AND SPECIFIC ROLE <input type="checkbox"/> Check if project performed with current firm This project will both visually and physically enhance the existing corridor connection from the heavily traveled US 41 to the existing and historically significant Bayshore Live Oak Park. Landscape architectural design enhancements include a gateway entry sign at the US Highway 41 entry, way-finding signage for Bayshore Live Oak Park, accessible sidewalk , aesthetically enhanced street intersections, decorative roadway lighting including banners, enhanced and decorative regulatory signage, and visually pleasing Florida Friendly landscaping and low volume irrigation. The landscape architectural improvements were designed to improve both the pedestrian and vehicular experience within this roadway corridor and establish character branding within Charlotte Harbor.		

E. RESUMES OF KEY PERSONNEL PROPOSED FOR THIS CONTRACT
(Complete one Section E for each key person.)

12. NAME Darren Anderson	13. ROLE IN THIS CONTRACT Designer	14. YEARS EXPERIENCE	
		a. TOTAL 34	b. WITH CURRENT FIRM 25
15. FIRM NAME AND LOCATION (City and State) Johnson Engineering, Port Charlotte, Florida			
16. EDUCATION (DEGREE AND SPECIALIZATION) A.A. - Manatee Community College		17. CURRENT PROFESSIONAL REGISTRATION (STATE AND DISCIPLINE)	
18. OTHER PROFESSIONAL QUALIFICATIONS (Publications, Organizations, Training, Awards, etc.) Custom Civil 3D, AutoDesk			

19. RELEVANT PROJECTS

	(1) TITLE AND LOCATION (City and State)	(2) YEAR COMPLETED	
		PROFESSIONAL SERVICES	CONSTRUCTION (If applicable)
	One Cent Sales Tax Sidewalk Projects Charlotte County, Florida	2003	2003
a.	(3) BRIEF DESCRIPTION (Brief scope, size, cost, etc.) AND SPECIFIC ROLE <input checked="" type="checkbox"/> Check if project performed with current firm Darren served as senior designer for sidewalks on Quesada Ave, Orlando Blvd, U.S. 41, Airport Road, Taylor Road and Kingsway Elementary area. He had the responsibility of designing to current codes and specifications with detail focus on ADA compliance, drainage, connectivity, maintenance of traffic and aesthetics of the design. These projects comprise of approximately 8.6+ miles of sidewalk..		
	West County Regional Park (Oyster Creek Park) Englewood, Florida	2006	2007
b.	(3) BRIEF DESCRIPTION (Brief scope, size, cost, etc.) AND SPECIFIC ROLE <input checked="" type="checkbox"/> Check if project performed with current firm This marquee park for the Charlotte County Regional park system is located in Englewood on San Casa Road. It is a 175-acre park that includes 65+ acres of improvements consisting of three football fields, Cricket field, basketball, tennis, pool facilities, and 'state of the art' 18,000 sf skate park; along with other amenities. The park has 3,700+ linear feet of nature trails and 3,000+ linear feet of pedestrian trails. Darren served as sole designer during the engineering, permitting, completion and agency close-out phases.		
	Greater Port Charlotte Group 3 Storm Structures Port Charlotte, FL	Ongoing	Ongoing
c.	(3) BRIEF DESCRIPTION (Brief scope, size, cost, etc.) AND SPECIFIC ROLE <input checked="" type="checkbox"/> Check if project performed with current firm JEI was retained for professional services to survey, model, design, permit and assist in construction with 12 major stormwater control structures in the Greater Port Charlotte area. The original structures were built in the early 60's and in need of upgrade, replacement and modification. The work involved survey, historic data collection, ICPR modeling, design, plan production, regulatory permitting (SWFWMD, FDEP, Charlotte County), utility relocation coordination, traffic control and maintenance plans, and proposed construction implementation/sequencing. This project is on-going with one last structure (Fordham 2.77) to be finished. Darren has served as sole designer for the 12 structures creating the plans from survey data and construction plans for bidding. He had to work out utility relocations, sidewalk connections, grading and drainage and ADA compliant issues during design and permitting.		
	North County Regional Park (O'Donnell Park) Phases I & II Charlotte County, FL	2008	Ongoing
d.	(3) BRIEF DESCRIPTION (Brief scope, size, cost, etc.) AND SPECIFIC ROLE <input checked="" type="checkbox"/> Check if project performed with current firm This 83+ acre Charlotte County Regional park in northern Charlotte County off US 41 in Murdock Village is a facility consisting of softball fields, baseball fields, 5 soccer fields, a disk golf course and storm water management system. Darren was the sole designer for the engineering, permitting, construction and close out phases of this project.		

4. PROFICIENCY WITH SIMILAR SERVICES/PROJECTS



JOHNSON
ENGINEERING

4. PROFICIENCY IN SIMILAR SERVICES/PROJECTS



Johnson Engineering is a firm focused on the public sector market in our 78 years of existence. The project list for Johnson Engineering is too numerous to list herein and our public sector clients range from every government from Sarasota County, City of North Port, City of Venice, City of Punta Gorda, Charlotte County to Marco Island, City of Naples and Collier County on the southwest coast of Florida.

Our project manager for City of North Port will be Chris Beers, PE,PSM, and he has over 30 years of experience in managing public work related projects. For the past 19 years of his career, he has primarily served on public work projects from our Port Charlotte office as Branch Manager. Below are several completed projects in which Chris performed project management duties to demonstrate his experience in similar projects.

#	Government	Year Began	Name	Desc.
1	Charlotte Co	2023	DeSoto Ditch Hurricane Repairs	Engineering along 1.5 miles of ditch, damaged by Hurricane Ian
2	Charlotte Co	2023	Tippecanoe II Walking Paths	Engineering of walking path network in the Tippecanoe II Park
3	Charlotte Co	2023	Conway-Paulson Utilities	~4.8 miles of pathway along N. Beach Rd from Manasota Beach to Sarasota Co line
4	Charlotte Co	2023	N. Beach Road Sidewalk	~1.7 miles of pathway along N. Beach Rd from Manasota Beach to Sarasota Co line
5	Charlotte Co	2022	Melbourne St Pathway	~3,500 lf of pathway
6	Charlotte Co	2022	Parmely St Road & Pathway	~1,600 lf re-design (widened, MUP, utilities, drainage)
7	Charlotte Co	2022	Supervisors of Elections	Civil/site consultant on this facility
8	Charlotte Co	2022	Sheriff Dist 4 Facility	Civil/site consultant on this facility
9	Charlotte Co	2022	Sheriff Admin/HQ Campus	Civil/site consultant on this facility
10	Charlotte Co	2022	Rotonda Bridges	Civil consultant on bridge update/repairs on (6) Rotonda bridges
11	Lake Placid	2022	Lake Placid Septic to Sewer	Approx. 41,000 lf of sewer infrastructure around Lake Placid to convert area to sewer
12	Charlotte Co	2021	Coral Creek Bridge Deck	Research, survey, forensics, analysis of the failing bridge deck on Coral Creek Bridge
13	Charlotte Co	2021	Charlotte Flatwoods Bridge	Civil/site consultant on the renovation/repair project for this bridge in Preserve land
14	WCIND	2021	New Admin Office Project	Civil/site consultant on the new West Coast Inland Navigation District office in Venice
15	Charlotte Co	2020	South Gulf Cove Turn Basin	Dredging project for the harbor side of the turn basin
16	Charlotte Co	2020	Canal Sediment Project	Assisting County in the canal sediment removal and nutrient program
17	Charlotte Co	2019	Main St Improvements	~1,000 lf re-design of Main St for the Sunseeker project (widened, MUP, utilities, drainage)
18	Charlotte Co	2019	Ainger Bridge Updates	Performed the civil site/survey design for the updates to Ainger Bridge
19	Charlotte Co	2023	Barrier Island Access Study	Conduct planning study for the bridgeless barrier islands of Charlotte County
20	Charlotte Co	2022	Edgewater Ph 3	Convert a 2-lane corridor to a 4-lane w/median roadway (approx. 4.5+ miles)
21	Charlotte Co	2022	Garparilla Pines Blvd Pathway	1.2+ Miles of 8 ft concrete pathway
22	Charlotte Co	2022	South Gulf Cove Ph4 Pathway	4,735 LF of 8-ft concrete pathway along Sand Domingo Blvd in SGC
23	Charlotte Co	2021	Gulf Cove Comm. Master Plan	Develop long-range master plan for the Gulf Cove Community MSBU
24	Charlotte Co	2021	Port Charlotte Blvd Pathway	1+ Mile of 8 ft concrete pathway
25	Charlotte Co	2020	Gulf Cove Entry Signs	Entry signs w/in the R/W for Gulf Cove MSBU
26	Charlotte Co	2019	NW Port Charlotte Entry Signs	Entry signs w/in the R/W for Northwest Port Charlotte MSBU
27	Charlotte Co	2021	Hayward Canal Bathymetric	Bathymetric survey of 8,495 LF of waterways for maintenance dredging project
28	Charlotte Co	2020	Lake Betty Park	Renovated Lake Betty Park improvements
29	Charlotte Co	2019	Beach Road Curbing	Approx. 2,200 LF of curbing on Beach Road
30	Charlotte Co	2018	Harbour Heights Bathymetric	Bathymetric survey channels along the Peace River a total of 2,800 LF of surveying
31	Charlotte Co	2019	South County Reg. Park MUP	Multi-use trailway system within South County Regional Park in Punta Gorda
32	Charlotte Co	2019	South Bridge Bathymetric	Bathymetric survey of waterways along the Peace River a total of 8,500 LF of surveying
33	Charlotte Co	2015	Loveland Grand Master Lift Station & 48" Interceptor	3+ miles of 48" Interceptor and master lift station for CCUD
34	Charlotte Co	2017	Parade Circle Interconnect	½+ Mile of 8 ft pathway
35	Charlotte Co	2017	CCPW Storm Structures Crest Plates	Final modeling of the Greater Port Charlotte Storm Structures
36	Charlotte Co	2017	Oceanspray Blvd. Pathway	1.5 Miles-8 ft concrete pathway
37	Charlotte Co	2017	ELK 4.56 Storm Structure	(2)-10x10 Box Culverts w/weir
38	Charlotte Co	2018	Char Co FD #10 (Palm Island)	Civil portion of project
39	Charlotte Co	2018	Gulf Cove Storm Inventory	Set up GIS asset mgmt database
40	Charlotte Co	2016	Harbor Blvd Enhancement	Parkside CRA 4-Lane Roadway
41	Charlotte Co	2018	Haverhill W-way 4.84 Storm Struct.	(2)-10x8 Box Culverts w/weir



F. EXAMPLE PROJECTS WHICH BEST ILLUSTRATE PROPOSED TEAM'S QUALIFICATIONS FOR THIS CONTRACT

(Present as many projects as requested by the agency, or 10 projects, if not specified. Complete one Section F for each project.)

20. EXAMPLE PROJECT KEY NUMBER

2

21. TITLE AND LOCATION (City and State)

Piper Road from Henry Street to North of US 17 (SR 35) (Discipline: Environmental), Punta Gorda, Florida

22. YEARS COMPLETED

PROFESSIONAL SERVICES

2015

CONSTRUCTION (If applicable)

2016

23. PROJECT OWNER'S INFORMATION

a. PROJECT OWNER

Charlotte County

b. POINT OF CONTACT NAME

Mr. Brian Barnes, P.E.

c. POINT OF CONTACT TELEPHONE NUMBER

(941) 575-3612

24. BRIEF DESCRIPTION OF PROJECT AND RELEVANCE TO THIS CONTRACT (Include scope, size, and cost)

In 2002, the Charlotte County Board of County Commissioners realized that with the Municipal Airport, Community College, Emergency Management Services, Sheriff's Office and the fact that the airport is designated as the Disaster Recovery Center, an Airport Overlay District was ideally suited to attract future economic development. To entice future developments and enhance the safety and appearance of the Airport Overlay District, the Board of County Commissioners hired Johnson Engineering to conduct the Piper Road Corridor Study, which evaluated three distinct new roadway segments. In August of 2004, the need for the Piper Road improvements was clearly demonstrated when over 6,000 emergency workers assembled on the airport grounds after Hurricane Charley.



This project represents the third and final segment of new roadway infrastructure from the Piper Road Corridor Study, extending from Henry Street to north of U.S. 17. In 2015/2016, the Johnson Engineering team was responsible for the storm water drainage design and state and federal environmental resource permitting for this roadway segment, which required careful coordination with the Southwest Florida Water Management District (SWFWMD), U.S. Army Corps of Engineers (USACE) and U.S. Fish and Wildlife Service (FWS). Our environmental group conducted threatened and endangered species surveys as well as species specific surveys for the Florida bonneted bat and gopher tortoise. Additionally, our team prepared a wetland functional analysis and conducted negotiations with USACE staff to establish the number of offsite compensatory mitigation credits required to offset impacts to freshwater marsh jurisdictional wetlands within the roadway corridor.

25. FIRMS FROM SECTION C INVOLVED WITH THIS PROJECT

a.	(1) FIRM NAME	(2) FIRM LOCATION (City and State)	(3) ROLE
	Johnson Engineering	Fort Myers, Florida	Environmental, permitting, stormwater, wetland analysis, roadway
b.	(1) FIRM NAME	(2) FIRM LOCATION (City and State)	(3) ROLE
c.	(1) FIRM NAME	(2) FIRM LOCATION (City and State)	(3) ROLE
d.	(1) FIRM NAME	(2) FIRM LOCATION (City and State)	(3) ROLE
e.	(1) FIRM NAME	(2) FIRM LOCATION (City and State)	(3) ROLE

F. EXAMPLE PROJECTS WHICH BEST ILLUSTRATE PROPOSED TEAM'S QUALIFICATIONS FOR THIS CONTRACT <i>(Present as many projects as requested by the agency, or 10 projects, if not specified. Complete one Section F for each project.)</i>	20. EXAMPLE PROJECT KEY NUMBER 3
---	---

21. TITLE AND LOCATION (City and State) Babcock Ranch Community, Phase 1A Town Center (Discipline: Environmental) Babcock Ranch, FL	22. YEARS COMPLETED <table border="1" style="width:100%; border-collapse: collapse;"> <tr> <td style="width: 50%; text-align: center;">PROFESSIONAL SERVICES</td> <td style="width: 50%; text-align: center;">CONSTRUCTION <i>(if applicable)</i></td> </tr> <tr> <td style="text-align: center;">2010</td> <td style="text-align: center;">2015</td> </tr> </table>	PROFESSIONAL SERVICES	CONSTRUCTION <i>(if applicable)</i>	2010	2015
PROFESSIONAL SERVICES	CONSTRUCTION <i>(if applicable)</i>				
2010	2015				

23. PROJECT OWNER'S INFORMATION
--

a. PROJECT OWNER Babcock Property Holdings	b. POINT OF CONTACT NAME Mr. John Broderick	c. POINT OF CONTACT TELEPHONE NUMBER (941) 235-6907
---	--	--

24. BRIEF DESCRIPTION OF PROJECT AND RELEVANCE TO THIS CONTRACT <i>(Include scope, size, and cost)</i>

Having obtained the overall conceptual Environmental Resource Permit (ERP) for the Babcock Ranch Community in 2010, the Johnson Engineering environmental team continues to permit for construction multiple phases of development, along with overseeing the implementation of a specific phase of mitigation for the associated wetland and listed species impacts. Environmental permits for Phase 1A Town Center construction (358 acres) were obtained in September 2015, authorizing 67 acres of wetland impacts. Our ecologists conducted pre-construction listed species surveys, contractor training related to listed species concerns during construction, gopher tortoise permitting and relocation, and oversaw the implementation of approximately 770 acres of mitigation (wetland enhancement and restoration in Mitigation Area C, Phase 3) to offset wetland and listed species impacts. Construction commenced in late 2015/early 2016, with much of the Town Center having already been built and associated housing still under construction. Johnson Engineering ecologists continue to conduct post-restoration monitoring of the mitigation area to document mitigation success for the permitting agencies.



25. FIRMS FROM SECTION C INVOLVED WITH THIS PROJECT
--

a.	(1) FIRM NAME Johnson Engineering	(2) FIRM LOCATION <i>(City and State)</i> Fort Myers, Florida	(3) ROLE Environmental, permitting, mitigation, monitoring
b.	(1) FIRM NAME	(2) FIRM LOCATION <i>(City and State)</i>	(3) ROLE
c.	(1) FIRM NAME	(2) FIRM LOCATION <i>(City and State)</i>	(3) ROLE
d.	(1) FIRM NAME	(2) FIRM LOCATION <i>(City and State)</i>	(3) ROLE
e.	(1) FIRM NAME	(2) FIRM LOCATION <i>(City and State)</i>	(3) ROLE

F. EXAMPLE PROJECTS WHICH BEST ILLUSTRATE PROPOSED TEAM'S QUALIFICATIONS FOR THIS CONTRACT <i>(Present as many projects as requested by the agency, or 10 projects, if not specified. Complete one Section F for each project.)</i>	20. EXAMPLE PROJECT KEY NUMBER 4
---	---

21. TITLE AND LOCATION (City and State) C.R. 771 (Gasparilla Road) Charlotte County, Florida	22. YEARS COMPLETED <table border="1" style="width: 100%; border-collapse: collapse;"> <tr> <td style="width: 50%; text-align: center;">PROFESSIONAL SERVICES</td> <td style="width: 50%; text-align: center;">CONSTRUCTION <i>(if applicable)</i></td> </tr> <tr> <td style="text-align: center;">2013</td> <td></td> </tr> </table>	PROFESSIONAL SERVICES	CONSTRUCTION <i>(if applicable)</i>	2013	
PROFESSIONAL SERVICES	CONSTRUCTION <i>(if applicable)</i>				
2013					

23. PROJECT OWNER'S INFORMATION

a. PROJECT OWNER Port Charlotte	b. POINT OF CONTACT NAME Mr. Brian Barnes, P.E.	c. POINT OF CONTACT TELEPHONE NUMBER (941) 575-3612
--	--	--

24. BRIEF DESCRIPTION OF PROJECT AND RELEVANCE TO THIS CONTRACT *(Include scope, size, and cost)*

The C.R. 771 (Gasparilla Road) widening project was a sales tax funded project to provide additional capacity to the existing roadway from approximately Rotonda Boulevard East to the intersection at S.R. 776 (McCall Road). Johnson Engineering provided design, permitting and project management. Improvements included two miles of new four-lane roadway with associated drainage, lighting, signalization, nearly 12 miles of new utility lines and a new bridge at Butterford Canal with both aerial utility crossings and directional bored crossings. The project is currently being constructed via CM at Risk. Johnson Engineering was retained by the CM firm to provide all construction inspection services.



25. FIRMS FROM SECTION C INVOLVED WITH THIS PROJECT

a.	(1) FIRM NAME Johnson Engineering	(2) FIRM LOCATION <i>(City and State)</i> Fort Myers, Florida	(3) ROLE Design, Permitting, Project Management, CEI
b.	(1) FIRM NAME Johnson Engineering	(2) FIRM LOCATION <i>(City and State)</i> Port Charlotte, Florida	(3) ROLE Local Coordination, Project Liaison
c.	(1) FIRM NAME	(2) FIRM LOCATION <i>(City and State)</i>	(3) ROLE
d.	(1) FIRM NAME	(2) FIRM LOCATION <i>(City and State)</i>	(3) ROLE
e.	(1) FIRM NAME	(2) FIRM LOCATION <i>(City and State)</i>	(3) ROLE

F. EXAMPLE PROJECTS WHICH BEST ILLUSTRATE PROPOSED TEAM'S QUALIFICATIONS FOR THIS CONTRACT

(Present as many projects as requested by the agency, or 10 projects, if not specified. Complete one Section F for each project.)

20. EXAMPLE PROJECT KEY NUMBER

5

21. TITLE AND LOCATION (City and State)

Harbor Boulevard Enhancement Project (Discipline: Project Management)
Charlotte County, Florida

22. YEARS COMPLETED

PROFESSIONAL SERVICES

2015

CONSTRUCTION (If applicable)

23. PROJECT OWNER'S INFORMATION

a. PROJECT OWNER

Charlotte County

b. POINT OF CONTACT NAME

Ms. Kelly Slaughter

c. POINT OF CONTACT TELEPHONE NUMBER

(941) 575-3657

24. BRIEF DESCRIPTION OF PROJECT AND RELEVANCE TO THIS CONTRACT (Include scope, size, and cost)

This is a current and ongoing project for Charlotte County within the Parkside CRA for enhancement and reconstruction of Harbor Boulevard. Harbor Blvd. at U.S. 41 is the main gateway entrance for the Parkside district, the oldest section of Port Charlotte also known as the medical district. Improvements include extensive landscaping with tree shading, addition of 10' multi-use paths on both sides, reconstruction of the roadway, drainage, curbs, gateway signage, upgraded lighting/regulatory signs and comfort stations with a bicycle repair station.



The project also consisted of the reconstruction of utilities including major upgrades for CCU (Charlotte County Utilities). Utilities involved are water mains, gravity sanitary sewer, lift stations, force mains and reclaim water main. FPL has a transmission line that will be relocated underground. Permitting for the project included FDOT, FDEP and SWFWMD.

Location of the enhancement improvements for the 4-lane Harbor Boulevard will be between U.S. 41 (Tamiami Trail) and Olean Boulevard with construction scheduled to start this fall. The Parkside CRA, Parkside sub-committees including Landscape and the public have been very involved as Citizen's input is important. Also important to this project is maintaining access for the road and all the commercial businesses and residential condominium's driveways at all times throughout construction.

25. FIRMS FROM SECTION C INVOLVED WITH THIS PROJECT

a.	(1) FIRM NAME	(2) FIRM LOCATION (City and State)	(3) ROLE
	Johnson Engineering, Inc.	Port Charlotte, Florida	Project Management, Engineering Design, Environmental, Surface Water Management
b.	(1) FIRM NAME	(2) FIRM LOCATION (City and State)	(3) ROLE
	Southwest Engineering & Design	Punta Gorda, Florida	Utilities - Water, Sewer and Force Main Upgrades
c.	(1) FIRM NAME	(2) FIRM LOCATION (City and State)	(3) ROLE
	Banks Engineering	Lake Suzy, Florida	Surveying, Mapping and Additional Easements
d.	(1) FIRM NAME	(2) FIRM LOCATION (City and State)	(3) ROLE
	Kimley-Horn & Associates, Inc.	Sarasota, Florida	Gateway Entry Features and Street Lighting
e.	(1) FIRM NAME	(2) FIRM LOCATION (City and State)	(3) ROLE
	Ardaman & Associates	Sarasota, Florida	Geotechnical

F. EXAMPLE PROJECTS WHICH BEST ILLUSTRATE PROPOSED TEAM'S QUALIFICATIONS FOR THIS CONTRACT

(Present as many projects as requested by the agency, or 10 projects, if not specified. Complete one Section F for each project.)

20. EXAMPLE PROJECT KEY NUMBER

6

21. TITLE AND LOCATION (City and State)

I-75 Gateways at Jones Loop Road & Duncan Road (US 17) (Discipline: Landscape Architecture), Charlotte County, Florida

22. YEARS COMPLETED

PROFESSIONAL SERVICES
2017

CONSTRUCTION (if applicable)

23. PROJECT OWNER'S INFORMATION

a. PROJECT OWNER

Charlotte County

b. POINT OF CONTACT NAME

Ms. Kelly Slaughter

c. POINT OF CONTACT TELEPHONE NUMBER

(941) 575-3657

24. BRIEF DESCRIPTION OF PROJECT AND RELEVANCE TO THIS CONTRACT (Include scope, size, and cost)

Our landscape architecture team recently completed and permitted proposed landscaping, irrigation, and sign design and construction documents for Charlotte County gateway improvements at the interchange of I-75 and Jones Loop Road and Duncan (U.S. 17). Both projects involved a high level of coordination with two FDOT jurisdictions; one for the landscape and irrigation plans and one for the sign permitting. The Jones Loop Road Gateway project extends from Taylor Road to Piper Road while the Duncan Road (U.S. 17) Gateway project extends from Florida Street east to the I-75 overpass. Both projects required the design and permitting of landscape and irrigation plans as well as plans for the community aesthetic feature signage in the form of two stand-alone local ID markers at each gateway. Johnson Engineering design and permitting services for the proposed improvements required performing a location survey for all above-ground elements within the project limits, environmental evaluations and analysis, regulatory compliance analysis on local, state, and federal levels, including communication with local utility providers to coordinate below-ground utility locations. With 100% plans completed 23 days ahead of the scheduled signing of the Memorandum Of Agreement for the Florida Highway Beautification Grant funding, Johnson Engineering is currently in constant communication with FDOT: District Landscape Architect, Darryl Richard and District Permit Engineer, Kevin Morrissey to complete the sign or Community Aesthetic Feature (CAF) permit and project bid documents for solicitation and implementation.

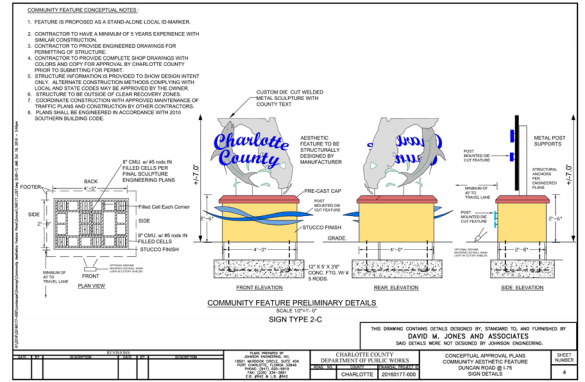

25. FIRMS FROM SECTION C INVOLVED WITH THIS PROJECT

a.	(1) FIRM NAME	(2) FIRM LOCATION (City and State)	(3) ROLE
	Johnson Engineering	Fort Myers, Florida	Landscape Architecture
b.	(1) FIRM NAME	(2) FIRM LOCATION (City and State)	(3) ROLE
	Johnson Engineering	Port Charlotte, Florida	Local Coordination, Project Liaison
c.	(1) FIRM NAME	(2) FIRM LOCATION (City and State)	(3) ROLE
d.	(1) FIRM NAME	(2) FIRM LOCATION (City and State)	(3) ROLE
e.	(1) FIRM NAME	(2) FIRM LOCATION (City and State)	(3) ROLE

F. EXAMPLE PROJECTS WHICH BEST ILLUSTRATE PROPOSED TEAM'S QUALIFICATIONS FOR THIS CONTRACT

(Present as many projects as requested by the agency, or 10 projects, if not specified. Complete one Section F for each project.)

20. EXAMPLE PROJECT KEY NUMBER

7

21. TITLE AND LOCATION (City and State)

**Hayward Canal Maintenance & Dredging (Discipline: Hydrographic)
Punta Gorda, Florida**

22. YEARS COMPLETED

PROFESSIONAL SERVICES

2017

CONSTRUCTION (if applicable)

2018

23. PROJECT OWNER'S INFORMATION

a. PROJECT OWNER

Charlotte County

b. POINT OF CONTACT NAME

Mr. Matt Logan

c. POINT OF CONTACT TELEPHONE NUMBER

(941) 575-3610

24. BRIEF DESCRIPTION OF PROJECT AND RELEVANCE TO THIS CONTRACT (Include scope, size, and cost)

Johnson Engineering performed the bathymetric survey along the length of the Hayward Canal and all of the canals that link to the previously dredged channel. Included in this work was:

- collection of data,
- analyzing the data,
- and calculating dredge volumes to achieve -5 MLW



25. FIRMS FROM SECTION C INVOLVED WITH THIS PROJECT

a.	(1) FIRM NAME	(2) FIRM LOCATION (City and State)	(3) ROLE
	Johnson Engineering	Fort Myers, Florida	Bathymetric Surveying
b.	(1) FIRM NAME	(2) FIRM LOCATION (City and State)	(3) ROLE
	Johnson Engineering	Port Charlotte, Florida	Project Management, Local Coordination
c.	(1) FIRM NAME	(2) FIRM LOCATION (City and State)	(3) ROLE
d.	(1) FIRM NAME	(2) FIRM LOCATION (City and State)	(3) ROLE
e.	(1) FIRM NAME	(2) FIRM LOCATION (City and State)	(3) ROLE

F. EXAMPLE PROJECTS WHICH BEST ILLUSTRATE PROPOSED TEAM'S QUALIFICATIONS FOR THIS CONTRACT <i>(Present as many projects as requested by the agency, or 10 projects, if not specified. Complete one Section F for each project.)</i>	20. EXAMPLE PROJECT KEY NUMBER 8
---	---

21. TITLE AND LOCATION (City and State) Sidewalks - Year 3 (Discipline: Project Management) Charlotte County, Florida	22. YEARS COMPLETED <table border="1" style="width:100%; border-collapse: collapse;"> <tr> <td style="width:50%; text-align: center;">PROFESSIONAL SERVICES</td> <td style="width:50%; text-align: center;">CONSTRUCTION <i>(if applicable)</i></td> </tr> <tr> <td style="text-align: center;">2013</td> <td style="text-align: center;">2019</td> </tr> </table>	PROFESSIONAL SERVICES	CONSTRUCTION <i>(if applicable)</i>	2013	2019
PROFESSIONAL SERVICES	CONSTRUCTION <i>(if applicable)</i>				
2013	2019				

23. PROJECT OWNER'S INFORMATION

a. PROJECT OWNER Charlotte County	b. POINT OF CONTACT NAME Mr. John Elias	c. POINT OF CONTACT TELEPHONE NUMBER (941) 575-3646
--	--	--

24. BRIEF DESCRIPTION OF PROJECT AND RELEVANCE TO THIS CONTRACT (Include scope, size, and cost)

Johnson Engineering has been retained and is currently designing approximately 20 miles of new sidewalk for Charlotte County. This year 3 project really begins to create the connectivity of the master plan for a walkable community in which it connects some the vital links in the system; i.e. Harbor Road, Riverside Drive and Rotonda Boulevard North among others. All sidewalks are within Charlotte County right-of-way and will be ADA compliant including the connections to existing driveways and intersections. All of the projects are closely coordinated with stakeholders of the County and utilities to account for all needs of these various departments and agencies.

Street	Location	Approx Length (Miles)
Harbor Boulevard	Veterans Blvd. to Midway Blvd.	2
Ellicot Circle	U.S. 41 to Midway Blvd.	0.5
Bayshore Road	North close to Public-U.S. 41 to Edgewater Blvd.	0.2
Rio de Janeiro Avenue	Rampart Blvd.-Sanhill Blvd.-Deep Creek Blvd.	1.75
Deep Creek Boulevard	Rio de Janeiro Ave. to Sandhill Blvd.	1.4
Sandhill Boulevard	Rio de Janeiro Ave. to Kinds Hwy.	1.75
Aaron Road (10')	Harbor Blvd. to Gertrude	0.6
Sunnybrook Boulevard	South Access Rd. to Boundary Blvd.	1.2
Oceanspray Boulevard	Sunnybrook Blvd. to Gulfstream Blvd.	1.5
C.R. 74 (Bermont Road)	Westminster Dr. to U.S. 17	1.2
Riverside Drive	Marlympia Way to Cleveland Dr.	3.1
Rotonda Boulevard N.	Rotonda Circle to Parade Circle	1.4
Rotonda Boulevard E.	Rotonda Circle to Parade Circle	1.4
Rotonda Boulevard W.	Boundary Blvd. to Parade Circle	1.4
Total Approximate Length (Miles)		19.4

25. FIRMS FROM SECTION C INVOLVED WITH THIS PROJECT

a.	(1) FIRM NAME Johnson Engineering	(2) FIRM LOCATION <i>(City and State)</i> Port Charlotte, Florida	(3) ROLE Civil Engineering & Design, Utilities, Permitting
b.	(1) FIRM NAME Johnson Engineering	(2) FIRM LOCATION <i>(City and State)</i> Fort Myers, Florida	(3) ROLE Survey, Environmental
c.	(1) FIRM NAME	(2) FIRM LOCATION <i>(City and State)</i>	(3) ROLE
d.	(1) FIRM NAME	(2) FIRM LOCATION <i>(City and State)</i>	(3) ROLE
e.	(1) FIRM NAME	(2) FIRM LOCATION <i>(City and State)</i>	(3) ROLE

F. EXAMPLE PROJECTS WHICH BEST ILLUSTRATE PROPOSED TEAM'S QUALIFICATIONS FOR THIS CONTRACT <i>(Present as many projects as requested by the agency, or 10 projects, if not specified. Complete one Section F for each project.)</i>	20. EXAMPLE PROJECT KEY NUMBER 9
---	---

21. TITLE AND LOCATION (City and State) CR 78 - Resurfacing, Restoration & Rehabilitation (3R) (Discipline: CEI w/o LAP) LaBelle, Florida	22. YEARS COMPLETED	
	PROFESSIONAL SERVICES 2016	CONSTRUCTION (if applicable) 2017

23. PROJECT OWNER'S INFORMATION
--

a. PROJECT OWNER Hendry County	b. POINT OF CONTACT NAME Mr. Shane Parker	c. POINT OF CONTACT TELEPHONE NUMBER (863) 675-5222
---	--	--

24. BRIEF DESCRIPTION OF PROJECT AND RELEVANCE TO THIS CONTRACT (Include scope, size, and cost)

This was a Resurfacing, Restoration and Rehabilitation (3R) project for 1.6 miles of existing two-lane roadway in a residential community in Labelle FL. Improvements included widening and resurfacing of the existing roadway, new shoulders, sidewalk and drainage accommodations. Johnson Engineering provided survey, design and permitting services as well as subsequent construction inspection. All work was designed to fall within the existing ROW. For a certain length the roadway centerline itself served as the county line, requiring coordination with the adjacent Glades County.

As part of the project we performed an initial drainage analysis of the adjacent contributing basins to determine if any conveyance improvements should be made prior to the roadway construction. The analysis revealed the existing box culvert at Pollywog Creek was significantly under sized and another was deteriorating and in need of replacement. In addition, the box culvert replacement design included a sediment sump on the upstream end. By providing a mechanism to remove nutrient laden sediment from the creek, and thereby reducing the phosphorus and nitrogen discharge to the Caloosahatchee River, Hendry County received a grant from the SFWMD providing additional construction funding.

To address water quality issues from the roadway run off we were able to design and permit a series of BMP's including linear roadside retention areas. This allowed the project to be constructed within the ROW without acquiring an offsite pond site.

Another important aspect was the project phasing. Our design incorporated a phasing plan that divided the project into five smaller projects. This additional flexibility allowed the County to construct the drainage improvements first, in the dry season, to address some more pressing flooding concerns while leaving the roadway and sidewalk phases to be constructed as funding becomes available. During the design process the sidewalks were revised to accommodate FDOT requirements and have subsequently qualified for LAP funding.



25. FIRMS FROM SECTION C INVOLVED WITH THIS PROJECT
--

a.	(1) FIRM NAME Johnson Engineering	(2) FIRM LOCATION (City and State) Fort Myers, Florida	(3) ROLE Construction Observation & Inspection
-----------	--	---	---

<p>F. EXAMPLE PROJECTS WHICH BEST ILLUSTRATE PROPOSED TEAM'S QUALIFICATIONS FOR THIS CONTRACT</p> <p><i>(Present as many projects as requested by the agency, or 10 projects, if not specified. Complete one Section F for each project.)</i></p>	<p>20. EXAMPLE PROJECT KEY NUMBER</p> <p>10</p>
--	---

<p>21. TITLE AND LOCATION (City and State)</p> <p>Golden Gate Sidewalks (Discipline: CEI with LAP)</p> <p>Naples, Florida</p>	<p>22. YEARS COMPLETED</p>	
	<p>PROFESSIONAL SERVICES</p> <p>2017</p>	<p>CONSTRUCTION <i>(if applicable)</i></p> <p>2018</p>

23. PROJECT OWNER'S INFORMATION

<p>a. PROJECT OWNER</p> <p>Collier County</p>	<p>b. POINT OF CONTACT NAME</p> <p>Mr. Steve Ritter</p>	<p>c. POINT OF CONTACT TELEPHONE NUMBER</p> <p>(239) 348-1328</p>
--	--	--

24. BRIEF DESCRIPTION OF PROJECT AND RELEVANCE TO THIS CONTRACT *(Include scope, size, and cost)*

Johnson Engineering provided full construction engineering and inspection (CEI) for this LAP funded sidewalk project in Collier County. The sidewalk improvements were provided on both sides of the roadway on 20th Court S.W. (from Sunshine Blvd. to 46th Terrace S.W), on the west side of the roadway on 46th Terrace S.W. (from 23rd Avenue S. W. to Sunset Road) and on the west side of the roadway on 48th Street S.W. (from 23rd Avenue S.W. to 17th Avenue S.W.). Improvements included associated drainage, safety upgrades, signing and pavement marking and roadside restoration.



25. FIRMS FROM SECTION C INVOLVED WITH THIS PROJECT

a.	<p>(1) FIRM NAME</p> <p>Johnson Engineering</p>	<p>(2) FIRM LOCATION <i>(City and State)</i></p> <p>Fort Myers, Florida</p>	<p>(3) ROLE</p> <p>Construction Observation & Inspection</p>
-----------	--	--	---

G. KEY PERSONNEL PARTICIPATION IN EXAMPLE PROJECTS

26. NAMES OF KEY PERSONNEL (From Section E, Block 12)	27. ROLE IN THIS CONTRACT (From Section E, Block 13)	28. EXAMPLE PROJECTS LISTED IN SECTION F (Fill in "Example Project Key" section below before completing table. Place "X" under project key number for participation in same or similar role.)									
		1	2	3	4	5	6	7	8	9	10
Christopher Beers, PE, PSM	Project Manager		X		X		X				
Mike Dickey, PE	Utilities	X	X	X	X		X				
Matt Howard, PSM	Survey & Mapping / SUE	X	X	X	X	X	X		X		X
Jeff Nagle, RLA	Landscape Architecture										
Laura DeJohn, AICP	Planning		X	X							
Laura Herrero	Water Resources & Environmental	X	X	X		X		X			
Ryan Bell, PE, PTOE	Transportation		X			X			X	X	
James "Vee' Lofton	Construction Engineering & Inspection				X				X	X	
Darren Anderson	Designer						X				
Wayne Wright	Electrical										

29. EXAMPLE PROJECTS KEY

NO.	TITLE OF EXAMPLE PROJECT (FROM SECTION F)	NO.	TITLE OF EXAMPLE PROJECT (FROM SECTION F)
1	SW 6 & 7 Utility Extension Project Areas 1 & 2	6	Charlotte County Sidewalks, Year 3
2	Babcock Ranch Community	7	Surface Water Master Plan & 10-Year Water Supply
3	Lee County Sports Complex	8	CR 78
4	Jones Loop Road Force Main	9	Golden Gate Sidewalks
5	Helms Road	10	US Sugar

5. PROJECT CONTROL/APPROACH



JOHNSON
ENGINEERING

5. PROJECT CONTROL/APPROACH

Johnson Engineering relies on communication, effective leadership, and expertise to reach your goal of completing a project on time and within budget. Our team is committed to using tools and resources to ensure the success of the City of North Port projects. Key elements in establishing and maintaining this control will include the following.

>> SINGLE POINT OF CONTACT

Our project manager has established exceptional working relationships with his clients by listening to their needs.

>> SCHEDULING

We will continually monitor the project schedule for accuracy and timeliness.

>> COMMUNICATION

We will make it our goal to effectively keep the City of North Port staff informed of the status of any project we are a part of.

>> BUDGET CONSCIOUS

The City of North Port will be continually updated on the budget and any constraints anticipated with a project's design.

>> EXISTING CONDITIONS

We propose city staff with any knowledge in the components of a given project will be consulted as part of the due diligence and evaluation of current conditions.



SINGLE POINT OF CONTACT FOR CLIENTS

Chris Beers, PE, PSM is a local, easily accessible professional with proven expertise in providing exceptional service and listening to client's needs. Chris has the authority to assign and manage staff within the Port Charlotte office or the other resource center offices which will offer the greatest capabilities and innovations to perform the services you request.

SCHEDULING

Project scheduling is the foundation of our operations. We begin this important duty by utilizing the tools available to document every task. Once specific tasks are identified, prioritization of tasks, with interdependencies, will be reviewed with North Port representatives. This process will result in an initial schedule document identifying the critical path for completion. As the project commences, the schedule will be continually monitored for accuracy and timeliness. Throughout the life of any given project, there will be several checkpoints offering additional review and accountability to scheduling goals and design goals. Typically, conceptual design will include drawings that are 30 percent designed so North Port project managers can confirm the design professionals are proceeding according to their vision and goals. Next, 60 percent and 90 percent drawings are completed to refine project details and prepare the project for permitting. Upon completion of 100 percent design and permit submittal documents, the client will have reviewed the project design in detail. Permitting and final construction can proceed from that point. We can also assist with the bidding and construction oversight processes. This level of professional assistance will offer North Port additional reassurance through the bidding and construction phases of any given project.

COMMUNICATION

Throughout the project life-cycle, internal and external communications will include regular team meetings to assure cross discipline coordination and to address critical or significant issues. North Port staff and other identified stakeholders will be kept informed via emails, letters, informal and formal meetings, and written reports to assure critical decision points are coordinated and any required revisions are approved. We will submit plans, drawings, cost estimates, permit applications and various other documents for comment and approval.



>> MATERIALS CONTROL

By closely monitoring a project's progress we are able to recommend changes, small or large, for the overall improvement of the project.

>> PERMITTING COMPLIANCE

Our team's combined knowledge and local experience will ensure efficient and effective permitting for any City of North Port project, while meeting the set timelines.

>> QA/QC

Quality assurance and quality control are key strategies to our approach to producing quality projects. We commit senior level team members to this review process.

>> COORDINATION

Our team will closely work with both the North Port citizens and the agency stakeholders to find a mutual agreement on projects.



STAYING WITHIN BUDGET

Detailed scopes of work are an important element in the success of any project. Project managers and the principal in charge will be responsible for project cost control and will continually inform North Port staff of the budget and any constraints anticipated with the project design and permitting process. In addition, our ability to assist with oversight of actual construction will bring additional confidence in meeting capital budget estimates and in meeting project quality standards. Specifications, bidding, and invoice review are all processes we developed and perfected in our operations to assure adherence to clients' budgets.

EVALUATING EXISTING CONDITIONS

One of the keys to a successful project is the initial research and analysis. By evaluating this information within our team, we are able to recognize the issues brought on by the existing conditions, and are able to integrate this information into the final solution. This strategy will help to avoid costly plan changes or delays in the permitting process. For example, on the North County (O'Donnell) Regional Park project, our project team was able to analyze, integrate, and plan in accordance with the following components: topographic survey data of the park, existing and pre-development conditions, knowledge and consideration of the Murdock Village master plan; knowledge and consideration of the proposed master drainage facilities, perimeter berm, drainage conveyance systems, and utility infrastructure. Planning and integration of all these components allowed for a seamless incorporation of the future Murdock Village Concept and has already multiplied the immediate benefits to Charlotte County.

From a planning and zoning perspective, due diligence work is imperative to the successful planning, design and ultimate construction of a project. There are extensive federal, state and local regulations that affect this area, and, development standards are unique in every community. A project is a product of many complex interwoven levels of code and jurisdiction. All these constraints must be synthesized and communicated to all team members who will be involved in coordinating various levels of design, permitting and construction.

From a civil engineering perspective, a topographic survey will include existing elevations, buildings, and infrastructure of the project site and surrounding area. A review of the survey assists the design team in understanding where the existing roads and utilities are located. Coupled with research of historical data, the survey also helps us comprehend the existing drainage patterns of both offsite and onsite flows.

5. PROJECT CONTROL/APPROACH

An environmental and ecological survey of the site determines if there are environmental resources that need to be accommodated, featured or mitigated. Our knowledgeable staff of ecologists, biologists, and scientists will offer their recommendations to help address any environmental questions.



A key element of evaluation of existing conditions will be the assembly and analysis of historical and proprietary information that is known to city staff. We propose city staff with any knowledge in the components of a given project will be consulted as part of the due diligence and evaluation of current conditions. This step will consist of initial in-depth interviews with relevant staff and follow-up communications through the life of the project. This “download” of personal experience will allow the city to retain the extensive first-hand knowledge of its staff, and will also serve to engage staff as a contributor to the overall process. This can increase a sense of “ownership” in the project, and will contribute to its overall success. This process will also includes research into city archives and records to gain insight during the planning stage of the project.

MATERIALS CONTROL

With each individual project, the City of North Port is poised to make a substantial investment in amenities and materials. In order to optimize this investment we will coordinate with city staff and personnel to improve resource efficiency and sustainability. Designs and materials shall be chosen to apply to and meet desired intensity and levels of use. Materials integration and control will also extend to considerations of maintenance requirements and expectations. At times on past projects, we have even worked with manufacturers in the development of more efficient and effective products. When an issue arises on the construction site, we are in an optimal position to recommend solutions that may better serve our client, ease the task of the contractor, or create a better product for the users of the facilities and amenities. By keeping close tabs on a project from the smallest detail to the overall site, we are able to recommend changes, small or large, for the overall improvement of the project.

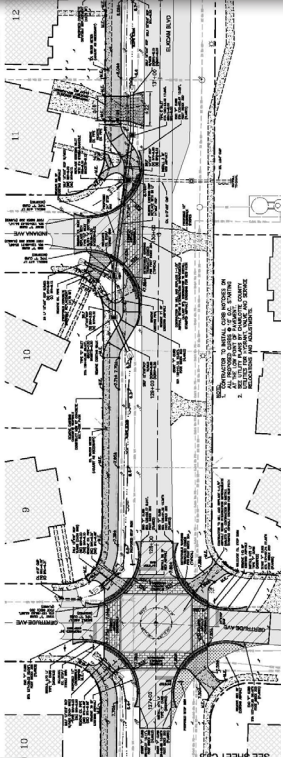
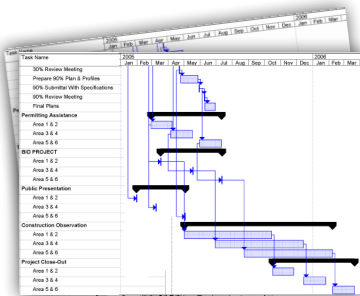

PERMITTING AND COMPLIANCE

Having 7 offices spread from Tampa to Miami, along with decades of projects, our team has obtained permits from almost every governmental agency in Southwest Florida. We know the requirements, we know the processes, and we know the expectations of the agencies. The combined knowledge and local experience of our team members ensures efficient and effective permitting for any project, while meeting the timelines of our clients. Our qualified field personnel also understand the expectations of the agencies, enabling them to monitor contractors and provide oversight in maintaining compliance with permits. This has included reviewing the materials being used and the methods of construction to make sure they meet the standards and specifications of the agency, such as the type of PVC water main pipe being used or the pipe bedding and compaction methods.

Our landscape architects perform site observations of plant material and irrigation system installations, ensuring the landscape material meets not only the government agency requirements, but their vision and the vision of the client. They also review the irrigation system for proper watering of the plant material. Charlotte County hired us to perform the design, engineering, permitting and construction administration for the Regional Parks. This is a prime example of collaborating with the client to develop a plan, organizing and



6. REFERENCES

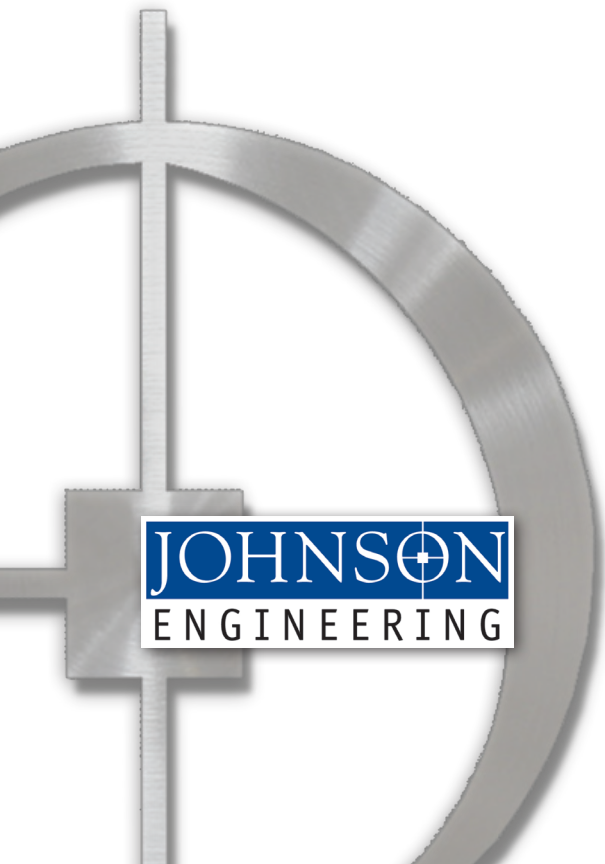

6. REFERENCES

CHARLOTTE COUNTY PUBLIC WORKS | John Elias, Director | 7000 Florida Street, Punta Gorda, FL 33950
 Phone: (941) 575-3646 | Fax: (941) 626-0267 | John.Elias@CharlotteCountyFL.gov

Mr. Elias as CCPW Director has overseen all projects the Johnson Engineering, Inc. team has performed in Charlotte County; including these listed below and in this RFP.

CHARLOTTE COUNTY PUBLIC WORKS | Joanne Vernon, Project Manager | 410 Taylor Road, Unit 104, FL Punta Gorda, FL 33950 | Phone: (941) 575-3661 | Fax: (941) 575-3664 | Joanne.Vernon@CharlotteCountyFL.gov

Mrs. Vernon, PE as Charlotte County Engineering in CCPW has overseen all projects the Johnson Engineering, Inc. team has performed in Charlotte County; including these listed below and in this RFP. She has direct supervisory authority over the CCPW project manager and oversees all Johnson Engineering contracts for CCPW projects.

Projects performed for Raymond Slade of Charlotte County

CHARLOTTE COUNTY PUBLIC WORKS
 Raymond Slade,
 Project Manager
 410 Taylor Road Unit 104
 Punta Gorda, FL 33950
 Phone: (941) 575-3685
 Fax: (941) 575-3664
Raymond.Slade@CharlotteCountyFL.gov

Completed	Name	Construction Cost
2023	Gasparilla Pines Blvd (Design)	\$116,900
2018	Parade Circle Interconnect (½+ M)	\$355,781
2018	Oceanspray Blvd. Pathway (1.5 M)	\$578,900
2019	South Gulf Cove Ph 3 Sidewalks (Design)	\$299,906
2022	Midway Blvd Bridge & Sidewalk (Design)	\$199,845
2017	Cape Haze Drive Sidewalk	\$398,500
2022	Peachland Blvd Pathway (2.5 M) (Design)	\$134,463
2016	South Gulf Cove Pathway (Ph 1)	\$951,104
2018	Elkcam Blvd Lights & Pathway (Design)	\$46,510
2018	Gertrude & Aaron Pathway (Design)	\$76,580
Total		\$3,158,489

Projects performed for Karen Bliss of Charlotte County

CHARLOTTE COUNTY PUBLIC WORKS
 Karen Bliss,
 Project Manager
 410 Taylor Road Unit 104
 Punta Gorda, FL 33950
 Phone: (941) 575-3642
 Fax: (941) 575-3664
Karen.Bliss@CharlotteCountyFL.gov

Completed	Name	Construction Cost
2024	DeSoto Ditch Hurricane Ian Repair (Design)	\$41,280
2021	ELK 4.56 Storm Structure	\$1,750,750
2018	HAV 4.84 Storm Structure	\$1,642,499
2015	Lion Heart 4.03 Storm Structure	\$1,464,183
2016	Lion Heart 4.34 Storm Structure	\$881,951
2020	Greater Port Charlotte Crest Plates (Design)	\$464,805
2015	DOR 4.89 Storm Structure	\$724,183
2017	SUN 4.70 Storm Structure	\$998,112
2016	FOR 5.11 & NIA 5.72 Storm Structure	\$2,196
2017	FOR 4.60 & NIA 5.09 Storm Structure	\$1,555,132
Total		\$9,525,091

Projects performed for Justin Dunn of Charlotte County

CHARLOTTE COUNTY FACILITIES
 Justin Dunn,
 Project Manager
 7000 Florida Street,
 Punta Gorda, FL 33950
 Phone: (941) 743-1273
 Fax: (941) 575-3664
Justin.Dunn@CharlotteCountyfl.gov

Completed	Name	Construction Cost
2023	Charlotte County Sheriff HQ/Admin (Design)	\$71,620
2024	Supervisor's of Elections Facility (Design)	\$60,620
Total		\$132,240



7. LITIGATION & INSURANCE

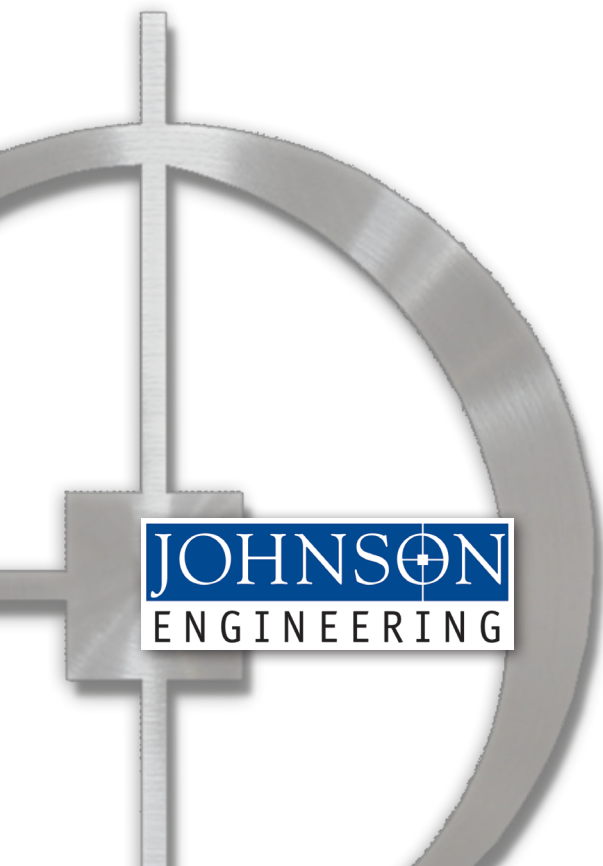

JOHNSON
ENGINEERING

7. LITIGATION AND INSURANCE

LITIGATION CIRCUMSTANCES & OUTCOME

We would like to state, as a result of the litigation listed below; Johnson Engineering has not had any judgments rendered against us.

Active - Pending Successful Settlement

- Mary Ann Eisenreich v. Town of Fort Myers Beach et al (2023)
Case No. 2023-CA-002323

In February 2021, Mary Eisenreich crashed her bicycle in a construction zone of Estero Boulevard. She neglected to use common sense as she intentionally drove her bicycle across uneven terrain. Johnson Engineering did not design the portion of Estero Boulevard where Eisenreich crashed, nor did they have any responsibility over the construction thereof. Johnson Engineering will actively defend itself against this frivolous claim.

- Carmel Koenig v. Lee County Department of Transportation et al (2023)
Case No. 2023-CA-005032

In October 2022, Carmel Koenig was rearended in a construction zone of Corkscrew Road. Johnson Engineering did not design the maintenance of traffic for Corkscrew Road, nor did they have any responsibility for the construction thereof. Johnson Engineering will actively defend itself against this frivolous claim.

Concluded - Successful Settlement

- Celestina (2020) South Gulf Cove Phase 3 Sidewalks
Case Number: 20-CA-004366 - Circuit Court of 20th Judicial Circuit in and for Lee County.

An individual fell off her bicycle on a Charlotte County sidewalk and alleges that the sidewalk was not properly designed. The sidewalk was not designed by Johnson Engineering. This case was settled.



7. LITIGATION AND INSURANCE

INSURANCE CERTIFICATE

Johnson Engineering can meet the insurance requirements. The amount of liability insurance we carry is listed below.

- W/C \$1,000,000
- G/L \$1,000,000
- Auto \$1,000,000
- Umbrella \$5,000,000
- P/L \$2,000,000

ACORD **CERTIFICATE OF LIABILITY INSURANCE** DATE (MM/DD/YYYY) 3/1/2024

THIS CERTIFICATE IS ISSUED AS A MATTER OF INFORMATION ONLY AND CONFERS NO RIGHTS UPON THE CERTIFICATE HOLDER. THIS CERTIFICATE DOES NOT AFFIRMATIVELY OR NEGATIVELY AMEND, EXTEND OR ALTER THE COVERAGE AFFORDED BY THE POLICIES BELOW. THIS CERTIFICATE OF INSURANCE DOES NOT CONSTITUTE A CONTRACT BETWEEN THE ISSUING INSURER(S), AUTHORIZED REPRESENTATIVE OR PRODUCER, AND THE CERTIFICATE HOLDER.

IMPORTANT: If the certificate holder is an ADDITIONAL INSURED, the policy(ies) must have ADDITIONAL INSURED provisions or be endorsed. If SUBROGATION IS WAIVED, subject to the terms and conditions of the policy, certain policies may require an endorsement. A statement on this certificate does not confer rights to the certificate holder in lieu of such endorsements(s).

PRODUCER: Insurance Management Consultancy Group, Inc. 7700 Cambridge Manor Place, Suite B Fort Myers FL 33907
 CONTACT: Anna Evans
 PHONE: Ext. 239-990-2100 FAX: (Ext. No.) 239-990-2410
 EMAIL: info@imcccm.com
 ADDRESS: info@imcccm.com

INSURER(S) AFFORDING COVERAGE NAIC #
 INSURER A: Continental Casualty Company 20443
 INSURER B: American Casualty Company of Reading 20427
 INSURER C: Continental Insurance Company 20508
 INSURER D: Valley Forge
 INSURER E:
 INSURER F:

INSURED: Johnson Engineering, Inc. 2122 Johnson St Fort Myers FL 33901
 License#: L109313 JOHNENG-01

COVERAGES CERTIFICATE NUMBER: 931183331 REVISION NUMBER:

THIS IS TO CERTIFY THAT THE POLICIES OF INSURANCE LISTED BELOW HAVE BEEN ISSUED TO THE INSURED NAMED ABOVE FOR THE POLICY PERIOD INDICATED. NOTWITHSTANDING ANY REQUIREMENT, TERM OR CONDITION OF ANY CONTRACT OR OTHER DOCUMENT WITH RESPECT TO WHICH THIS CERTIFICATE MAY BE ISSUED OR MAY PERTAIN, THE INSURANCE AFFORDED BY THE POLICIES DESCRIBED HEREIN IS SUBJECT TO ALL THE TERMS, EXCLUSIONS AND CONDITIONS OF SUCH POLICIES. LIMITS SHOWN MAY HAVE BEEN REDUCED BY PAID CLAIMS.

LINE	TYPE OF INSURANCE	ADD. INSD	W/OVD	POLICY NUMBER	POLICY EFF. DATE (MM/DD/YYYY)	POLICY EXP. DATE (MM/DD/YYYY)	LIMITS
B	COMMERCIAL GENERAL LIABILITY CLAIMS-MADE <input checked="" type="checkbox"/> OCCUR	Y	Y	7034452897	9/15/2023	9/15/2024	EACH OCCURRENCE \$1,000,000 DAMAGE TO RENTED PREMISES (EA ACCIDENT) \$100,000 MED EXP (Any one person) \$15,000 PERSONAL & ADV INJURY \$1,000,000 GENERAL AGGREGATE \$2,000,000 PRODUCTS - COMP/OP AGG \$2,000,000
A	AUTOMOBILE LIABILITY ANY AUTO <input checked="" type="checkbox"/> OWNED AUTOS ONLY <input checked="" type="checkbox"/> HIRSD AUTOS ONLY <input checked="" type="checkbox"/> NON-OWNED AUTOS ONLY <input checked="" type="checkbox"/>	Y	Y	7034456079	9/15/2023	9/15/2024	COMBINED SINGLE LIMIT (EA ACCIDENT) \$1,000,000 BODILY INJURY (Per person) \$ PROPERTY DAMAGE (Per accident) \$ PIP \$10,000
C	UMBRELLA LIAB EXCESS LIAB <input checked="" type="checkbox"/> RETENTION \$10,000 CLAIMS-MADE	Y	Y	7034458148	9/15/2023	9/15/2024	EACH OCCURRENCE \$5,000,000 AGGREGATE \$5,000,000
D	WORKERS COMPENSATION AND EMPLOYERS LIABILITY ANY PROPRIETOR/PARTNER/EXECUTIVE OFFICER/OWNER EXCLUDED? (Mandatory in FL) Y/N N/A	Y	N/A	WC734452861	9/24/2023	9/24/2024	PER STATUTE <input checked="" type="checkbox"/> OTHER <input type="checkbox"/> E.L. EACH ACCIDENT \$1,000,000 E.L. DISEASE - EA EMPLOYEE \$1,000,000 E.L. DISEASE - POLICY LIMIT \$1,000,000
A	Other Liability	Y	Y	596721465	9/15/2023	9/15/2024	Aggregate Limit 1,000,000

DESCRIPTION OF OPERATIONS (LOCATIONS) (VEHICLES) (ACORD 101, Additional Remarks Schedule, may be attached if more space is required)
 The City of North Port, its Commissioners, officers, agents, employees and volunteers are included in the additional insureds on the general liability policy, if required in a written contract or agreement. Waiver of Subrogation in favor of The City of North Port, its Commissioners, officers, agents, employees and volunteers applies to the General Liability, Auto Liability and Workers Compensation. The Umbrella if follow form to the underlying policies.

CANCELLATION
 SHOULD ANY OF THE ABOVE DESCRIBED POLICIES BE CANCELLED BEFORE THE EXPIRATION DATE THEREOF, NOTICE WILL BE DELIVERED IN ACCORDANCE WITH THE POLICY PROVISIONS.

CERTIFICATE HOLDER: City of North Port 4970 City Hall Boulevard, Suite 337 North Port FL 34286
 AUTHORIZED REPRESENTATIVE: *Charles Spivey*

© 1988-2015 ACORD CORPORATION. All rights reserved.
 ACORD 25 (2016/03) The ACORD name and logo are registered marks of ACORD

ACORD **CERTIFICATE OF LIABILITY INSURANCE** JOHNENG-01 ASOSENTENU DATE (MM/DD/YYYY) 2/29/2024

THIS CERTIFICATE IS ISSUED AS A MATTER OF INFORMATION ONLY AND CONFERS NO RIGHTS UPON THE CERTIFICATE HOLDER. THIS CERTIFICATE DOES NOT AFFIRMATIVELY OR NEGATIVELY AMEND, EXTEND OR ALTER THE COVERAGE AFFORDED BY THE POLICIES REPRESENTATIVE OR PRODUCER, AND THE CERTIFICATE HOLDER.

IMPORTANT: If the certificate holder is an ADDITIONAL INSURED, the policy(ies) must have ADDITIONAL INSURED provisions or be endorsed. If SUBROGATION IS WAIVED, subject to the terms and conditions of the policy, certain policies may require an endorsement. A statement on this certificate does not confer rights to the certificate holder in lieu of such endorsements(s).

PRODUCER: CJJ Insurance Agency, LLC 2208 Hillcrest Street Orlando, FL 32803
 CONTACT: CJJ Insurance Agency, LLC (321) 445-1117 FAX: (321) 445-1076
 EMAIL: corts@cjj-insurance.com

INSURER(S) AFFORDING COVERAGE NAIC #
 INSURER A: Beazley Insurance Company, Inc 37540
 INSURER B:
 INSURER C:
 INSURER D:
 INSURER E:
 INSURER F:

INSURED: Johnson Engineering, Inc. 2122 Johnson St Fort Myers, FL 33901

COVERAGES CERTIFICATE NUMBER: REVISION NUMBER:

THIS IS TO CERTIFY THAT THE POLICIES OF INSURANCE LISTED BELOW HAVE BEEN ISSUED TO THE INSURED NAMED ABOVE FOR THE POLICY PERIOD INDICATED. NOTWITHSTANDING ANY REQUIREMENT, TERM OR CONDITION OF ANY CONTRACT OR OTHER DOCUMENT WITH RESPECT TO WHICH THIS CERTIFICATE MAY BE ISSUED OR MAY PERTAIN, THE INSURANCE AFFORDED BY THE POLICIES DESCRIBED HEREIN IS SUBJECT TO ALL THE TERMS, EXCLUSIONS AND CONDITIONS OF SUCH POLICIES. LIMITS SHOWN MAY HAVE BEEN REDUCED BY PAID CLAIMS.

LINE	TYPE OF INSURANCE	ADD. INSD	W/OVD	POLICY NUMBER	POLICY EFF. DATE (MM/DD/YYYY)	POLICY EXP. DATE (MM/DD/YYYY)	LIMITS
A	COMMERCIAL GENERAL LIABILITY CLAIMS-MADE <input checked="" type="checkbox"/> OCCUR	Y	Y	C35940230101	9/15/2023	9/15/2024	EACH OCCURRENCE \$ DAMAGE TO RENTED PREMISES (EA ACCIDENT) \$ MED EXP (Any one person) \$ PERSONAL & ADV INJURY \$ GENERAL AGGREGATE \$ PRODUCTS - COMP/OP AGG \$
	AUTOMOBILE LIABILITY ANY AUTO <input checked="" type="checkbox"/> OWNED AUTOS ONLY <input checked="" type="checkbox"/> HIRSD AUTOS ONLY <input checked="" type="checkbox"/> NON-OWNED AUTOS ONLY <input checked="" type="checkbox"/>	Y	Y				COMBINED SINGLE LIMIT (EA ACCIDENT) \$ BODILY INJURY (Per person) \$ PROPERTY DAMAGE (Per accident) \$
	UMBRELLA LIAB EXCESS LIAB <input checked="" type="checkbox"/> RETENTION \$10,000 CLAIMS-MADE	Y	Y				EACH OCCURRENCE \$ AGGREGATE \$
	WORKERS COMPENSATION AND EMPLOYERS LIABILITY ANY PROPRIETOR/PARTNER/EXECUTIVE OFFICER/OWNER EXCLUDED? (Mandatory in FL) Y/N N/A	Y	N/A				PER STATUTE <input checked="" type="checkbox"/> OTHER <input type="checkbox"/> E.L. EACH ACCIDENT \$ E.L. DISEASE - EA EMPLOYEE \$ E.L. DISEASE - POLICY LIMIT \$
A	Professional Liab	Y	Y				Per Claim/Aggregate 2,000,000

DESCRIPTION OF OPERATIONS (LOCATIONS) (VEHICLES) (ACORD 101, Additional Remarks Schedule, may be attached if more space is required)
 RE: City of North Port - Professional Engineering Services Continuing Services Contracts, RFP No. 2024-14

CANCELLATION
 SHOULD ANY OF THE ABOVE DESCRIBED POLICIES BE CANCELLED BEFORE THE EXPIRATION DATE THEREOF, NOTICE WILL BE DELIVERED IN ACCORDANCE WITH THE POLICY PROVISIONS.

CERTIFICATE HOLDER: North Port 4970 City Hall Boulevard, Suite 337 North Port, FL 34286
 AUTHORIZED REPRESENTATIVE: *Michael*

© 1988-2015 ACORD CORPORATION. All rights reserved.
 ACORD 25 (2016/03) The ACORD name and logo are registered marks of ACORD



8. ADDITIONAL INFORMATION

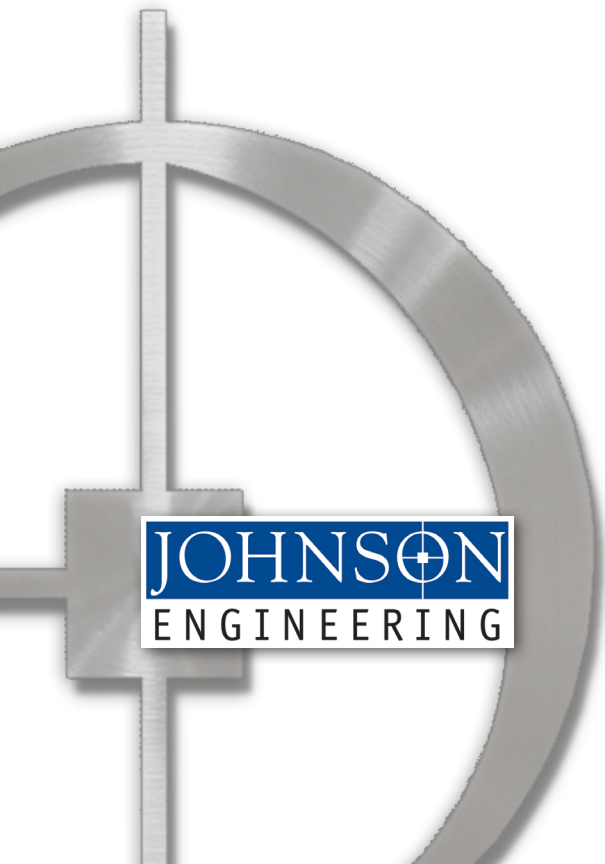

JOHNSON
ENGINEERING

8. ADDITIONAL INFORMATION

AWARD

City of Fort Myers

Downtown Riverfront Basin

Johnson Engineering was the prime civil engineering consultant for the City of Fort Myers Downtown Detention Basin. The primary purpose of the basin is to treat stormwater in the City's historic downtown area, before discharging to the impaired Tidal Caloosahatchee River which ultimately flows to the Gulf of Mexico. The water quality treatment program Johnson Engineering designed improves health, safety and welfare of the public in contact with the river by reducing pollutants entering the river:



The other benefits include creation of valuable waterfront property for new private investment and development opportunities along the basin's edge, resulting in an expected regional economic impact of up to \$67 million and up to 870 permanent jobs to help sustain the local economy. The basin serves as a focal point for public gatherings and events to occur on the public spaces designed around the basin. The pathways surrounding the basin provide public access, giving the public opportunity for connectivity to the waterfront, along with passive recreation and healthy living benefits. Educational components of the project contribute to the community's appreciation for natural resources and education about the human impacts on water quality and strategies to improve the existing conditions and sustain the

environmental benefits over time.

The project redefines general engineering and land planning thinking that intensely developed urban areas are too encumbered and land values too high to accommodate stormwater treatment retrofit projects. This project is proof that water quality improvement projects can be achieved in a downtown location and can be urban design features that promote redevelopment and stimulate the economy.



H. ADDITIONAL INFORMATION

30. PROVIDE ANY ADDITIONAL INFORMATION REQUESTED BY THE AGENCY. ATTACH ADDITIONAL SHEETS AS NEEDED.

When Johnson Engineering was established in 1946, much of Florida was an undisturbed land. More than 78 years later we have seen a boom in development and a tremendous population growth alter the landscape permanently. Johnson Engineering has been helping guide private companies, and city, county, and state governmental institutions through these changes and the challenges they create.

Just as Florida has transformed dramatically over the years, so has Johnson Engineering. What started as one man surveying Florida's west coast has developed into a team of more than 120 professionals throughout Florida, offering their expertise in a broad spectrum of engineering disciplines. Our team provides civil engineering design for land development, planning and landscape architecture, utilities, electrical, transportation design, and construction engineering and inspection. Our surveying and mapping group specializes in utility mapping, transportation surveying, hydrographic surveying, and geographic information systems and our water resource management group provides environmental consulting, surface water management, water quality studies, and water supply services.

Our extensive list of well-known Florida airport facilities, roads, shopping centers, schools, hospitals, residential communities, resorts and commercial developments show our continued responsibility in developing Florida's communities.

The company has offices in Fort Myers, Port Charlotte, LaBelle, Naples, Clewiston, Lutz.

While Johnson Engineering is focused on growing and evolving to continue serving the needs of Florida, it remains true to its past and the values upon which the company was founded.

Depth of Experience

Centuries of combined experience has immersed our team of licensed professionals into Florida's geography, giving a rare perspective into development of the area and an appreciation of the changes.

Full Range of Services

Specialized teams of engineers, planners, landscape architects, surveyors, ecologists, water resources experts, transportation and utility designers provide all aspects needed to complete every project.

Long Term Commitment

Our team's average tenure with Johnson Engineering is 13 years and an unprecedented 20% have been with us for more than 20 years, showing our team's continuity and dedication to the area.

Local Presence

Seventy-eight years of service provides invaluable historical data throughout Florida and conveniently located offices means prompt communication through every step of your project.

I. AUTHORIZED REPRESENTATIVE

The foregoing is a statement of facts.

31. SIGNATURE

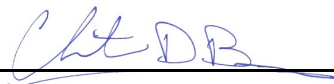

32. DATE

3/4/2024

33. NAME AND TITLE

Chris Beers, PE, PSM, Project Manager

9. CITY REQUIRED FORMS

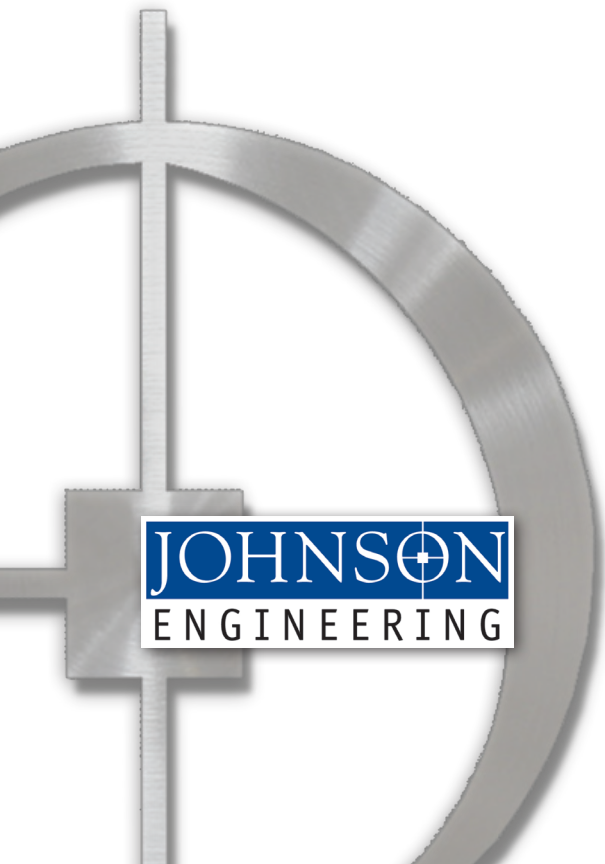

33. Name and Title. Self-explanatory.

REQUIREMENTS AND METHOD OF SUBMITTAL

TAB 9 - CITY REQUIRED FORMS – This checklist is provided to assist each Proposer in the preparation of their response. Included in this *checklist* are important requirements, which is the responsibility of each Proposer to submit with their response in order to make their response fully compliant. It is the responsibility of each Proposer to read and comply with the solicitation in its entirety.

A. REQUIRED SUBMITTAL FORMS: Provide fully executed forms.

- ATTACHMENT 1:** Proposal Submittal Signature Form
- ATTACHMENT 2:** Statement of Organization
- ATTACHMENT 3:** References/Client Listing
- ATTACHMENT 4:** Reference and Performance Questionnaire Verification Form
- ATTACHMENT 5:** Drug-Free Workplace
- ATTACHMENT 6:** Public Entity Crime Information
- ATTACHMENT 7:** Non-Collusive Affidavit
- ATTACHMENT 8:** Lobbying Certification
- ATTACHMENT 9:** Conflict of Interest Form
- ATTACHMENT 10:** Disclosure Form (Consultant/Engineer/Architect)
- ATTACHMENT 11:** Scrutinized Company Certificate
- ATTACHMENT 12:** Vendor’s Certification For E-Verify System
- ATTACHMENT 13:** Certification Regarding Debarment, Suspension, and other Responsibility Matters
- ATTACHMENT 14:** Certification Regarding Lobbying - Federal

SAMPLE INSURANCE CERTIFICATE: Demonstrate your firm’s ability to comply with insurance requirements. Provide a previous certificate or other evidence listing the Insurance Companies names for both Professional Liability and General Liability and the dollar amounts of the coverage.

N/A **DBE/MBE/WBE/VBE:** If claiming either Minority Business Enterprise/Women Business Enterprises/Veteran Business Enterprise, the Prime Firm (not sub-consultant) **shall be** certified as a Minority Business Enterprise by the State of Florida, Department of Management Services, Office of Supplier Diversity pursuant to Section 287.0943, Florida Statutes.

YES, CLAIMING STATUS AS PRIME ONLY

YES, I’VE ATTACHED THE CERTIFICATE OF MBE/WBE STATUS FROM THE STATE OF FLORIDA AS OUTLINED SECTION 1.

NOT CLAIMING DBE/MBE/WBE /VBE

PLEASE INITIAL AND RETURN WITH YOUR PROPOSAL. MD. THIS PAGE MUST BE COMPLETED AND RETURNED WITH PROPOSAL.

B. METHOD OF SUBMITTAL:

1. **NUMBER OF SUBMITTAL PACKAGES:** One (1) original hard-copy **UNBOUND** (marked "**ORIGINAL**") with signature in blue ink. **NUMBER OF COPIES:** three (3) hard copies **BOUND** (marked "**COPY**").
(1 original + 3 copies = 4 total submittals).
2. **NUMBER OF PAGES:** The proposal **shall not exceed** twenty -two (**22**) one-sided pages or eleven (**11**) double-sided pages in length. (*The Title Page, City Required Forms, 330 Form, resumes and tabs do not count towards the TOTAL NUMBER OF PAGES*).
 - 2.1 When compiling a response, sections should be tabbed and labeled; pages should be sequentially numbered at the bottom of the page; proposals should be bound to allow flat stacking for easy storage; **do not use three ring binders of any kind**; and sections should be compiled in the sequence list above.
 - 2.2 Place proposal with all the required items in a sealed envelope clearly marked for specification number, project name, name of proposer, and due date and time.
3. **PAPER/FONT SIZE:** Letter size 8.5"x11"/Font Calibri 11, PDF FORMAT.
4. **USB FLASH DRIVE:** One (1) electronic version in Portable Document Format (PDF) **on a USB Drive only** containing the entire submittal. **CDs will not be accepted.**
5. **SUBMIT SEALED PROPOSAL PACKAGE WITH THE FOLLOWING INFORMATION CLEARLY MARKED ON THE OUTSIDE PACKAGING (FedEx, UPS, USPS, etc.): "RFP NO. 2024-14 PROFESSIONAL ENGINEERING SERVICES – CONTINUING SERVICES CONTRACTS FOR CITY OF NORTH PORT"** to the address below:

City of North Port
Finance Department - Purchasing Division
Ginny Duyn, CPPB, Senior Purchasing Administrator
4970 City Hall, 3 RD Floor, Suite 337
North Port, Florida 34286

Note: Submissions received after the due date and time stated on the Notice of Availability or subsequent Addenda will not be accepted.

**ATTACHMENT 1
PROPOSAL SUBMITTAL SIGNATURE FORM**

The undersigned attests to his/her authority to submit this proposal and to bind the firm herein named to perform as per Agreement if the firm is awarded the Agreement by the City.

The undersigned further certifies that he/she has read the Request for Proposal, Terms and Conditions, Insurance Requirements and any other documentation relating to this request and this proposal is submitted with full knowledge and understanding of the requirements and time constraints noted herein.

As addenda are considered binding as if contained in the original specifications, it is critical that the firm acknowledge receipt of same. The submittal may be considered void if receipt of an addendum is not acknowledged.

Addendum No. 1 Dated 2/1 Addendum No. 4 Dated 2/16
Addendum No. 2 Dated 2/5 Addendum No. 5 Dated 2/26
Addendum No. 3 Dated 2/9 Addendum No. _____ Dated _____

Company Name Johnson Engineering, Inc.

(239) 334-0046 mdickey@johnsoneng.com N/A
Telephone # E-Mail Fax #

2122 Johnson Street
Main Office Address

Fort Myers FL 33901
City State Zip Code

Address of Office Servicing City of North Port, if different than above: SAME AS ABOVE

17833 Murdock Circle
Office Address

Port Charlotte FL 33948
City State Zip Code

(941) 625-9919 cbeers@johnsoneng.com N/A
Telephone # E-mail Fax #

Michael Dickey, PE, Chairman/Vice President
Name & Title of Firm Representative

 3/4/24
Signature Date

Do you accept Visa? YES NO

THIS PAGE MUST BE SUBMITTED WITH PROPOSAL

ATTACHMENT 2
STATEMENT OF ORGANIZATION
(Information Sheet for Transactions and Conveyances Corporation Identification)

The following information will be provided to the City of North Port for incorporation in legal documents. It is, therefore, vital all information is accurate and complete. Please be certain all spelling, and capitalization is exactly as registered with the state or federal government.

Name of Respondent: Johnson Engineering, Inc.

DBA (if any): n/a

Type of Entity (Sole Proprietor, Corporation, LLC, LLP, Partnership, etc): Corporation

Business Address: 2122 Johnson Street, Fort Myers, FL 33901

Phone: (239) 334-0046 Fax: N/A

E-Mail mdickey@johnsoneng.com

Print Name and Title of person authorized to bind: Michael Dickey, PE, Chairman/Vice President

Federal Identification Number: 59-1173834

Signature: 

Respondent shall submit proof that it is authorized to do business in the State of Florida unless registration is not required by law.

Is this a Florida Corporation: Yes or No
(Please Check One)

If not a Florida Corporation,
In what state was it created: _____
Name as spelled in that State: _____

What kind of corporation is it: "For Profit" or "Not for Profit"

Is it in good standing: Yes or No

Authorized to transact business
in Florida: Yes or No

State of Florida Department of State Certificate of Authority Document No.: 322710

Does it use a registered fictitious name: Yes or No

THIS PAGE MUST BE SUBMITTED WITH PROPOSAL

Names of Officers:

President: Lonnie V. Howard, PE Secretary: Laura B. Herrero
Vice President: Michael Dickey, PE Treasurer: Laura B. Herrero
Director: David Trouteaud, PE Director: Ryan Bell, PE
Other: Matt Howard, PSM Other: Laura DeJohn

Name of Corporation (As used in Florida):

Johnson Engineering, Inc.

(Spelled exactly as it is registered with the state or federal government)

Corporate Address:

Post Office Box: _____
City, State Zip: _____
Street Address: 2122 Johnson Street
City, State, Zip: Fort Myers, FL 33901

STATE OF Florida
COUNTY OF Lee

Sworn to and subscribed before me this 4 day of March, 2024, by Michael Dickey who is personally known to me or has produced his/her driver's license as identification.

Jessica W. Goshorn

Notary Public - State of Florida
Print Name: Jessica W. Goshorn
Commission No: HH 482300

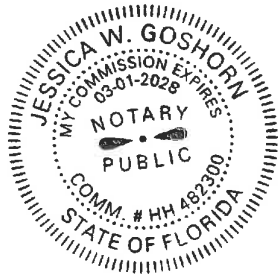

THIS PAGE MUST BE SUBMITTED WITH PROPOSAL

ATTACHMENT 3 - REFERENCES/CLIENT LISTING

Include at least five (5) business related references for which they are currently providing or have provided within the last ten (10) years, services similar to the scope of services required by this RFP. A minimum of three (3) references must be for work performed in Florida.

1. Business/Customer Name: Charlotte County Public Works
Name of Contact Person/Title: Raymond Slade, Project Manager
Telephone# (941) 575-3685 E-mail Raymond.Slade@CharlotteCountyFL.gov
Address 410 Taylor Road, Unit 104, Punta Gorda, FL 33950
Phone Number (941) 575-3685
Duration of Contract or business relationship 10+ years Project completion date: _____
Type of Services Provided Engineering
Cost of Project: Design Varies per project Construction: Varies per project
2. Business/Customer Name: Charlotte County Public Works
Name of Contact Person/Title: Karen Bliss, Project Manager
Telephone# (941) 575-3642 E-mail Karen.Bliss@CharlotteCountyFL.gov
Address 410 Taylor Road, Unit 104, Punta Gorda, FL 33950
Phone Number (941) 575-3642
Duration of Contract or business relationship 10+ years Project completion date: _____
Type of Services Provided Engineering
Cost of Project: Design Varies per project Construction: Varies per project
3. Business/Customer Name: Charlotte County Facilities
Name of Contact Person/Title: Justin Dunn, Project Manager
Telephone# (941) 743-1273 E-mail justin.dunn@CharlotteCountyfl.gov
Address 7000 Florida Street, Punta Gorda, FL 33950
Phone Number (941) 743-1273
Duration of Contract or business relationship 2 years Project completion date: _____
Type of Services Provided Engineering
Cost of Project: Design Varies per project Construction: Varies per project

THIS PAGE MUST BE SUBMITTED WITH PROPOSAL

4. Business/Customer Name: Charlotte County Public Works

Name of Contact Person/Title: John Elias, Director

Telephone# (941) 575-3646 E-mail John.Elias@CharlotteCountyFL.gov

Address 7000 Florida Street, Punta Gorda, FL 33950

Phone Number (941) 575-3646

Duration of Contract or business relationship 10+ years Project completion date: _____

Type of Services Provided Engineering

Cost of Project: Design Varies per project Construction: Varies per project

5. Business/Customer Name: Charlotte County Public Works

Name of Contact Person/Title: Joanne Vernon, Project Manager

Telephone# (941) 575-3661 E-mail Joanne.Vernon@CharlotteCountyFL.gov

Address 410 Taylor Road, Unit 104, Punta Gorda, FL 33950

Phone Number (941) 575-3661

Duration of Contract or business relationship 10+ years Project completion date: _____

Type of Services Provided Engineering

Cost of Project: Design Varies per project Construction: Varies per project

COMPANY NAME: Johnson Engineering, Inc.

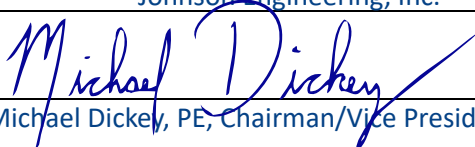
SIGNATURE: 
Michael Dickey, PE, Chairman/Vice President

THIS PAGE MUST BE SUBMITTED WITH PROPOSAL

THIS PAGE MUST BE SUBMITTED WITH PROPOSAL

ATTACHMENT 4
REFERENCE AND PERFORMANCE QUESTIONNAIRE VERIFICATION FORM

RFP 2024-14 Professional Engineering Services – Continuing Services for City of North Port
It is the intent of the City of North Port to request proposals from experienced and qualified firms for professional engineering services for the City of North Port.

1. Contractor Information (Proposer information)	
FIRM NAME:	Johnson Engineering, Inc.
ADDRESS:	17833 Murdock Circle, Port Charlotte, FL 33948
Telephone number#:	(941) 625-9919
E-mail:	cbeers@johnsoneng.com
Point of Contact	Chris Beers, PE
Contact Phone Number	(941) 766-6262
2. Worked Performed as	<input checked="" type="checkbox"/> Prime <input type="checkbox"/> Sub Contractor <input type="checkbox"/> Joint Venture <input type="checkbox"/> Other (Explain)
Percent of project work performed	50 %
If Subcontractor, who was the prime (Name/Phone #)	N/A
3. CONTACT INFORMATION	
Contract Number:	17-126
Contract Type:	X Firm Fixed Price _____ Cost Reimbursement _____ Other (please specify): _____
Contract Title:	South Gulf Cove Pathways, Phase 3, Charlotte County
Contract Location:	Charlotte County
Award Date (mm/dd/yy)	5/4/2017 (Design)
Actual Completion Date:	2/6/2019 (Design 100%)
Original Contract Price (Award Amount):	\$299,906 (Design)
Final Contract Price (to include all modifications, if applicable):	\$299,906 (Design)
Explain the Difference:	No Change Orders

4. PROJECT DESCRIPTION: Complexity of Work HIGH MED ROUTINE

How is this project relevant to project submission?

Johnson Engineering was retained by Charlotte County Public Works to design, permit and completed construction bid documents on this five (5) different roadways comprising 9.25 miles of 8' wide pathway project in South Gulf Cove (see table below). This project had to consider all ADA code considerations in design pertaining to longitudinal/lateral grades and slopes at existing driveways and bridge approaches. Johnson Engineering was responsible for all survey, design, SWFWMD permit exemption, utility coordination and MSBU coordination of 3/5 sidewalks and subcontracted 2/5 to another local engineering firm (SED in Punta Gorda).

5. CLIENT INFORMATION

Name: Raymond Slade **Title:** Project Manager
Name of Entity: Charlotte County Public Works
Phone Number: (941) 575-3685 **E-Mail:** Raymond.Slade@CharlotteCountyFL.gov

PERFORMANCE EVALUATION	(CHECK) "YES" OR "NO"
1. Was the scope of work performed similar in nature?	<input checked="" type="checkbox"/> YES OR <input type="checkbox"/> NO
2. Did this company have the proper resources and personnel by which to get the job done? If no, please describe: _____ _____ _____	<input checked="" type="checkbox"/> YES OR <input type="checkbox"/> NO
3. Were any problems encountered with the company's work performance? If yes, please describe: _____ _____ _____	<input checked="" type="checkbox"/> YES OR <input type="checkbox"/> NO
4. How long did the company/individual work for you?	Years: <u>1</u> Months: _____
5. On a scale of 1 to 10, 10 being best, how would you rate the overall work performance, considering professionalism; final product; personnel; resources. Rate from 1 to 10. (10 being highest)	<u>9</u>
6. If the opportunity were to present itself, would you rehire this company? If no, please state why: _____	<input checked="" type="checkbox"/> YES OR <input type="checkbox"/> NO
7. Date Questionnaire completed	(mm/dd/yy) <u>03/01/24</u>

3. Please provide any additional comments pertinent to this company and the work performed for you (you may use additional pages): Johnson Engineering has a very good working relationship with Charlotte County Public Works and has completed several projects for us.

Slade, Raymond Digitally signed by Slade,
Raymond
Date: 2024.03.01 17:35:12 -05'00'

Signature

INSTRUCTIONS:

PROPOSER WILL SEND THIS FORM TO EACH REFERENCED CLIENT LISTED ON ATTACHMENT 3. THE CLIENT IS TO COMPLETE THIS FORM AND RETURN DIRECTLY BACK TO THE PROPOSER. THE PROPOSER WILL SUBMIT THE COMPLETED FORM WITH THEIR PROPOSAL. IT IS THE PROPOSER’S RESPONSIBILITY TO OBTAIN AND SUBMIT ALL COMPLETED FORMS WITH THEIR PROPOSAL PACKAGE.

IF THERE ARE UNFORESEEN CIRCUMSTANCES AND THE CLIENT CANNOT RETURN COMPLETED FORM DIRECTLY TO THE PROPOSER, COMPLETED FORMS MAY BE DIRECTLY SUBMITTED TO: PURCHASING@NORTHPORTFL.GOV REFERENCING THE RFP #: 2024-14.

THE CITY RESERVES THE RIGHT TO VERIFY ANY AND ALL INFORMATION ON THIS FORM.

NOTE: IF COMPLETED REFERENCES ARE NOT RETURNED TO PURCHASING, IT MAY AFFECT THE EVALUATION RATING.

ATTACHMENT 4
REFERENCE AND PERFORMANCE QUESTIONNAIRE VERIFICATION FORM

RFP 2024-14 Professional Engineering Services – Continuing Services for City of North Port

It is the intent of the City of North Port to request proposals from experienced and qualified firms for professional engineering services for the City of North Port.

1. Contractor Information (Proposer information)

FIRM NAME: Johnson Engineering, Inc.

ADDRESS: 17833 Murdock Circle, Port Charlotte, FL 33948

Telephone number#: (941) 766-6262

E-mail: cbeers@johnsoneng.com

Point of Contact Chris Beers, PE **Contact Phone Number** (941) 766-6262

2. Worked Performed as Prime Sub Contractor Joint Venture Other (Explain)

Percent of project work performed 35 %

If Subcontractor, who was the prime (Name/Phone #) Aaron Jacobson, (941) 404-1579 **Schenkel Shultz Architects**

3. CONTACT INFORMATION

Contract Number: 2021000370 - Design of Sheriff's Admin Support HQ Bldg

Contract Type: Firm Fixed Price XXX Cost Reimbursement Other (please specify): _____

Contract Title:

Charlotte County Sheriff HQ/Admin

Contract Location:

Charlotte County

Award Date (mm/dd/yy) 2/7/2022

Actual Completion Date: 11/27/2023

Original Contract Price (Award Amount): \$71,620

Final Contract Price (to include all modifications, if applicable): \$71,620

Explain the Difference: _____

4. PROJECT DESCRIPTION: Complexity of Work HIGH MED ROUTINE

How is this project relevant to project submission?

Civil/site consultant to Schenkle Schultz Architects on this new facility to house the Charlotte County Sheriff Administration Center and HQ offices within the Eastport County Campus. This included survey, design, permitting of all civil/site related activities. Also, include coordination with the new Supervisor's of Election Warehouse at the same campus.

5. CLIENT INFORMATION

Name: Justin Dunn **Title:** Charlotte County Facilities, Project Manager

Name of Entity: Charlotte County Facilities

Phone Number: (941) 743-1273 **E-Mail:** Justin.Dunn@charlottecountyfl.gov

PERFORMANCE EVALUATION	(CHECK) "YES" OR "NO"
1. Was the scope of work performed similar in nature?	<input checked="" type="checkbox"/> YES OR <input type="checkbox"/> NO
2. Did this company have the proper resources and personnel by which to get the job done? If no, please describe: _____ _____ _____	<input checked="" type="checkbox"/> YES OR <input type="checkbox"/> NO
3. Were any problems encountered with the company's work performance? If yes, please describe: _____ _____ _____	<input type="checkbox"/> YES OR <input checked="" type="checkbox"/> NO
4. How long did the company/individual work for you?	Years: <u>1</u> Months: <u>10</u>
5. On a scale of 1 to 10, 10 being best, how would you rate the overall work performance, considering professionalism; final product; personnel; resources. Rate from 1 to 10. (10 being highest)	<u>9</u>
6. If the opportunity were to present itself, would you rehire this company? If no, please state why: _____	<input checked="" type="checkbox"/> YES OR <input type="checkbox"/> NO
7. Date Questionnaire completed	(mm/dd/yy) <u>03/04/24</u>

3. Please provide any additional comments pertinent to this company and the work performed for you (you may use additional pages): _____

Signature

INSTRUCTIONS:

PROPOSER WILL SEND THIS FORM TO EACH REFERENCED CLIENT LISTED ON ATTACHMENT 3. THE CLIENT IS TO COMPLETE THIS FORM AND RETURN DIRECTLY BACK TO THE PROPOSER. THE PROPOSER WILL SUBMIT THE COMPLETED FORM WITH THEIR PROPOSAL. IT IS THE PROPOSER'S RESPONSIBILITY TO OBTAIN AND SUBMIT ALL COMPLETED FORMS WITH THEIR PROPOSAL PACKAGE.

IF THERE ARE UNFORESEEN CIRCUMSTANCES AND THE CLIENT CANNOT RETURN COMPLETED FORM DIRECTLY TO THE PROPOSER, COMPLETED FORMS MAY BE DIRECTLY SUBMITTED TO: PURCHASING@NORTHPORTFL.GOV REFERENCING THE RFP #: 2024-14.

THE CITY RESERVES THE RIGHT TO VERIFY ANY AND ALL INFORMATION ON THIS FORM.

NOTE: IF COMPLETED REFERENCES ARE NOT RETURNED TO PURCHASING, IT MAY AFFECT THE EVALUATION RATING.

**ATTACHMENT 5
DRUG FREE WORKPLACE FORM**

The undersigned Consultant in accordance with Florida Statute 287.087 hereby certifies that
Johnson Engineering, Inc. does:
(Company Name)

1. Publish a statement notifying employees that the unlawful manufacture, distribution, dispensing, possession, or use of a controlled substance is prohibited in the workplace and specifying the actions that will be taken against employees for violations of such prohibition.
2. Inform employees about the dangers of drug abuse in the workplace, the business's policy of maintaining a drug free workplace, any available drug counseling, rehabilitation, and employee assistance programs, and the penalties that may be imposed upon employees for drug abuse violations.
3. Give each employee engaged in providing the commodities or contractual services that are under bid a copy of the statement specified in subsection (1).
4. In the statement specified in subsection (1), notify the employees that, as a condition of working on the commodities or contractual services that are under bid, the employee will abide by the terms of the statement and will notify the employer of any conviction of, or plea of guilty or nolo contendere to, any violation of Chapter 893 or of any controlled substance law of the United States or any state, for a violation occurring in the workplace no later than five (5) days after such conviction.
5. Impose a sanction on, or require the satisfactory participation in a drug abuse assistance or rehabilitation program if such is available in the employee's community, by any employee who is so convicted.
6. Make a good faith effort to continue to maintain a drug free workplace through implementation of this section.

Check one:

- As the person authorized to sign this statement, I certify that this firm complies fully with above requirements.
- As the person authorized to sign this statement, this firm **does not** comply fully with the above requirements.



Offeror's Signature Michael Dickey, PE, Chairman/Vice President

3/4/24

Date

THIS PAGE MUST BE SUBMITTED WITH PROPOSAL

**ATTACHMENT 6
PUBLIC ENTITY CRIME INFORMATION**

As provided by F.S. §287.133, a person or affiliate who has been placed on the convicted vendor list following a conviction for a public entity crime may not submit a bid on a contract to provide any goods or services to a public entity, may not submit a bid on a contract with a public entity for the construction or repair of a public building or public work, may not submit bids on leases of real property to a public entity, may not be awarded or perform work as a Contractor, Supplier, Subcontractor, or Consultant under a contract with any public entity, and may not transact business with any public entity in excess of the threshold amount provided in Section 287, for CATEGORY TWO for a period of 36 months from the date of being placed on the convicted vendor list.

I, Michael Dickey, PE, being an authorized representative of the Respondent, Johnson Engineering, Inc., located at 2122 Johnson Street
City: Fort Myers State: FL Zip Code: 33901, have read and understand the contents above. I further certify that Respondent is not disqualified from replying to this solicitation because of F.S. §287.133.

Signature:  Date: 3/4/24

Telephone #: (239) 334-0046 Fax #: N/A

Federal ID #: 59-1173834

STATE OF Florida
COUNTY OF Lee

Sworn to and subscribed before me this 4 day of March, 20 24, by Michael Dickey who is personally known to me or has produced his/her driver's license as identification.



Notary Public - State of Florida

Print Name: Jessica W Goshorn

Commission No: HH 482300

THIS PAGE MUST BE SUBMITTED WITH PROPOSAL

**ATTACHMENT 7
NON-COLLUSIVE AFFIDAVIT**

State of Florida }
County of Lee } SS.

Before me, the undersigned authority, personally appeared:
Michael Dickey, PE who, being first duly sworn, deposes and says that:

1. He/She is the Owner/Officer (Owner, Partner, Officer, Representative or Agent) of Johnson Engineering, Inc., the Respondent that has submitted the attached reply;
2. He/She is fully informed respecting the preparation and contents of the attached reply and of all pertinent circumstances respecting such reply;
3. Such reply is genuine and is not a collusive or sham reply;
4. Neither the said Respondent nor any of its officers, partners, owners, agents, representatives, employees or parties in interest, including this affiant, have in any way colluded, conspired, connived or agreed, directly or indirectly, with any other respondent, firm, or person to submit a collusive or sham reply in connection with the work for which the attached reply has been submitted; or have in any manner, directly or indirectly sought by agreement or collusion, or communication or conference with any respondent, firm, or person to fix the price or prices in the attached reply or of any other respondent, or to fix any overhead, profit, or cost elements of the reply price or the reply price of any other respondent, or to secure through any collusion, conspiracy, connivance, or unlawful agreement any advantage against (Recipient), or any person interested in the reply work.

Signed, sealed and delivered this 4 day of March, 2024.

By: 
Michael Dickey, PE
(Printed Name)
Chairman/Vice President
(Title)

STATE OF Florida
COUNTY OF Lee

Sworn to and subscribed before me this 4 day of March, 2024, by Michael Dickey who is personally known to me or has produced his/her driver's license as identification.

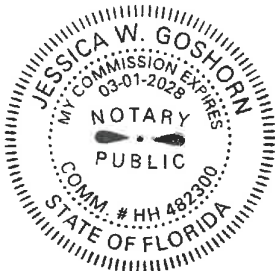

Notary Public - State of Florida
Print Name: Jessica W Goshorn
Commission No: HH482300

THIS PAGE MUST BE SUBMITTED WITH PROPOSAL

**ATTACHMENT 8
LOBBYING CERTIFICATION**

"The undersigned hereby certifies, to the best of his or her knowledge and belief, that":

STATE OF Florida

COUNTY OF Lee

This 4 day March of 2024

Michael Dickey, PE, Chairman/Vice President, being first duly sworn, deposes and says that he or she is the authorized representative of Johnson Engineering, Inc. (Name of the contractor, firm or individual), and that the vendor and any of its agents agree to have no contact or communication with, or discuss any matter related in any way to any active City of North Port solicitation, with any City of North Port elected officials, officers, their appointees or their agents or any other staff or outside individuals working with the city in respect to this request other than the designated Procurement Official Contact and to abide by the restrictions outlined in the General Terms and Conditions of the Solicitation. Technical questions directed to the project manager, is prohibited. These persons shall not be lobbied, either individually or collectively, regarding any questions for bid, proposal, qualification and/or any other solicitations released by the city. To do so is grounds for immediate disqualification from the selection process. The selection process is not considered final until such a time as the Commission has made a final and conclusive determination.

(a) No City appropriated funds have been paid or will be paid, by or on behalf of the undersigned, to any person for influencing or attempting to influence either directly or indirectly an officer or employee of the City, City Commission in connection with the awarding of any City Contract.

(b) If any funds other than City appropriated funds have been paid or will be paid to any person for influencing or attempting to influence a member of City Commission or an officer or employee of the City in connection with this contract, the undersigned shall complete and submit Standard Form-L "Disclosure Form to Report Lobbying", in accordance with its instructions.

Signed, sealed and delivered this 4 day of March, 2024

By: Michael Dickey

Michael Dickey, PE
(Printed Name)
Chairman/Vice President
(Title)

STATE OF Florida

COUNTY OF Lee

Sworn to (or affirmed) and subscribed before me by means of physical presence or online notarization, this 4 day of March 2024 by Michael Dickey.

Jessica Goshorn
Notary Public - State of Florida

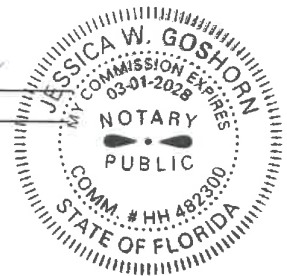

Personally Known OR Produced Identification
Type of Identification Produced _____

THIS PAGE MUST BE COMPLETED AND SUBMITTED WITH PROPOSAL

ATTACHMENT 9
CONFLICT OF INTEREST FORM

F.S. §112.313 places limitations on public officers (including advisory board members) and employees' ability to contract with the City either directly or indirectly. Therefore, please indicate if the following applies:

PART I.

- I am an employee, public officer or advisory board member of the City
_____ (List Position Or Board)
- I am the spouse or child of an employee, public officer or advisory board member of the City
Name: _____
- An employee, public officer or advisory board member of the City, or their spouse or child, is an officer, partner, director, or proprietor of Respondent or has a material interest in Respondent. "Material interest" means direct or indirect ownership of more than 5 percent of the total assets or capital stock of any business entity. For the purposes of [§112.313], indirect ownership does not include ownership by a spouse or minor child.
Name: _____
- Respondent employs or contracts with an employee, public officer or advisory board member of the City
Name: _____
- None Of The Above

PART II:

Are you going to request an advisory board member waiver?

- I will request an advisory board member waiver under §112.313(12)
- I will NOT request an advisory board member waiver under §112.313(12)
- N/A

The City shall review any relationships which may be prohibited under the Florida Ethics Code and will disqualify any vendors whose conflicts are not waived or exempt.

COMPANY: Johnson Engineering, Inc.

SIGNATURE: 
Michael Dickey, PE, Chairman/Vice President

THIS PAGE MUST BE SUBMITTED WITH PROPOSAL

ATTACHMENT 10
DISCLOSURE FORM FOR
CONSULTANT/ENGINEER/ARCHITECT

Please select (only) one of the following three options:

Our firm has no actual, potential, or reasonably perceived, **financial*** or **other interest**** in the outcome of the project.

Our firm has a potential or reasonably perceived **financial*** or **other interest**** in the outcome of the project as described here: _____.

Our firm proposes to mitigate the potential or perceived conflict according to the following plan:
_____.

Our firm has an actual **financial*** or **other interest**** in the outcome of the project as described here:
_____.

***What does "financial interest" mean?**

If your firm, or employee of your firm working on the project (or a member of the employee's household), will/may be perceived to receive or lose private income depending on the government business choices based on your firm's findings and recommendations, this must be listed as a financial interest. An example would be ownership in physical assets affected by the government business choices related to this project. The possibility of contracting for further consulting services is not included in this definition and is not prohibited.

****What does "other interest" mean?**

If your firm, or employee of your firm working on the project (or a member of the employee's household), will/may be perceived to have political, legal or any other interests that will affect what goes into your firm's findings and recommendations, or will be/may be perceived to be affected by the government business choices related to this project, this must be listed as another interest.

BUSINESS NAME: Johnson Engineering, Inc.

NAME (PERSON AUTHORIZED TO BIND THE COMPANY): Michael Dickey, PE, Chairman/Vice President

SIGNATURE:  DATE: 3/4/24

THIS PAGE MUST BE SUBMITTED WITH PROPOSAL

ATTACHMENT 11
SCRUTINIZED COMPANY CERTIFICATION FORM

Contractor Name: Johnson Engineering, Inc.
Authorized Representative Name and Title: Michael Dickey, PE, Chairman/Vice President
Address: 2122 Johnson Street City: Fort Myers State: FL ZIP: 33901
Phone Number: (239) 334-0046 Email Address: mdickey@johnsoneng.com

A company is ineligible to, and may not, bid on, submit a proposal for, or enter into or renew a Contract with the City of North Port for goods or services of any amount if, at the time of bidding on, submitting a proposal for, or entering into or renewing such Contract, the company is on the Scrutinized Companies that Boycott Israel List, created pursuant to Florida Statutes, section 215.4725, or is engaged in a boycott of Israel.

A company is ineligible to, and may not, bid on, submit a proposal for, or enter into or renew a Contract with the City of North Port for goods or services of \$1 million or more if, at the time of bidding on, submitting a proposal for, or entering into or renewing such Contract, the company is on the Scrutinized Companies with Activities in Sudan List, the Scrutinized Companies with Activities in the Iran Petroleum Energy Sector List, created pursuant to Florida Statutes, section 215.473, or with companies engaged in business operations in Cuba or Syria.

CHOOSE ONE OF THE FOLLOWING

This Contract or Contract renewal is for goods or services of less than \$1 million. As the person authorized to sign on behalf of the above-named company, and as required by Florida Statutes Section 287.135(5), I hereby certify that the above-named company is not participating in a boycott of Israel.

This bid, proposal, Contract or Contract renewal is for goods or services of \$1 million or more. As the person authorized to sign on behalf of the above-named company, and as required by Florida Statutes Section 287.135(5), I hereby certify that the above-named company is not participating in a boycott of Israel, is not on the Scrutinized Companies with Activities in Sudan List or the Scrutinized Companies with Activities in the Iran Petroleum Energy Sector List, and it does not have business operations in Cuba or Syria.

I understand that pursuant to Florida Statutes, section 287.135, the submission of a false certification may result in the termination of the Contract if one is entered into, and may subject the above-named company to civil penalties, attorney's fees and costs.

Certified By 
Signature of Contractor's Authorized Representative

Michael Dickey, PE
Name

Chairman/Vice President
Title

3/4/24
Date

THIS PAGE MUST BE SUBMITTED WITH PROPOSAL

**ATTACHMENT 12
VENDOR'S CERTIFICATION FOR E-VERIFY SYSTEM**

The undersigned Vendor/Consultant/Contractor (Vendor), after being duly sworn, states the following:

1. Vendor is a person or entity that has entered into or is attempting to enter into a contract with the City of North Port (City) to provide labor, supplies, or services to the City in exchange for salary, wages or other remuneration.
2. Vendor has registered with and will use the E-Verify System of the United States Department of Homeland Security to verify the employment eligibility of:
 - a. All persons newly hired by the Vendor to perform employment duties within Florida during the term of the contract; and
 - b. All persons, including sub-contractors, sub-vendors or sub-consultants, assigned by the Vendor to perform work pursuant to the contract with the City.
3. If the Vendor becomes the successful Contractor who enters into a contract with the City, then the Vendor will comply with the requirements of Section 448.095, Fla. Stat. "Employment Eligibility", as amended from time to time.
4. Vendor will obtain an affidavit from all subcontractors attesting that the subcontractor does not employ, contract with, or subcontract with, an unauthorized alien as defined in 8 United States Code, Section 1324A(H)(3).
5. Vendor will maintain the original affidavit of all subcontractors for the duration of the contract.
6. Vendor affirms that failure to comply with the state law requirements can result in the City's termination of the contract and other penalties as provided by law.
7. Vendor understands that pursuant to Florida Statutes, section 448.095, the submission of a false certification may result in the termination of the contract if one is entered into, and may subject the Vendor named in this certification to civil penalties, attorney's fees and costs.

VENDOR: Johnson Engineering, Inc. (Vendor's Company Name)

Certified By: 
AUTHORIZED REPRESENTATIVE SIGNATURE

Print Name and Title: Michael Dickey, PE , Chairman/Vice President

Date Certified: 3/4/24

THIS PAGE MUST BE COMPLETED AND SUBMITTED WITH PROPOSAL

ATTACHMENT 14

- CERTIFICATION REGARDING LOBBYING-FEDERAL

The undersigned certifies, to the best of his or her knowledge, that:

1. No Federal appropriated funds have been paid or will be paid, by or on behalf of the undersigned, to any person for influencing or attempting to influence an officer or employee of an agency, a Member of Congress, an officer or employee of Congress, or an employee of a Member of Congress in connection with the awarding of any Federal contract, the making of any Federal grant, the making of any Federal loan, the entering into of any cooperative agreement, and the extension, continuation, renewal, amendment, or modification of any Federal contract, grant, loan, or cooperative agreement.
2. If any funds other than Federal appropriated funds have been paid or will be paid to any person for influencing or attempting to influence an officer or employee of any agency, a Member of Congress, an officer or employee of Congress, or an employee of a Member of Congress in connection with this Federal contract, grant, loan, or cooperative agreement, the undersigned shall complete and submit Standard Form-LLL, "Disclosure Form to Report Lobbying," in accordance with its instructions.
3. The undersigned shall require that the language of this certification be included in the award documents for all subawards at all tiers (including subcontracts, subgrants, and contracts under grants, loans, and cooperative agreements) and that all subrecipients shall certify and disclose accordingly.

This certification is a material representation of fact upon which reliance was placed when this transaction was made or entered into. Submission of this certification is a prerequisite for making or entering into this transaction imposed by 31, U.S.C. § 1352 (as amended by the Lobbying Disclosure Act of 1995). Any person who fails to file the required certification shall be subject to a civil penalty of not less than \$10,000 and not more than \$100,000 for each such failure.

The Contractor certifies or affirms the truthfulness and accuracy of each statement of its certification and disclosure, if any. In addition, the Contractor understands and agrees that the provisions of 31 U.S.C. § 3801 et seq., apply to this certification and disclosure, if any.



Signature of Contractor's Authorized Representative

Michael Dickey, PE
Name

Chairman/Vice President
Title

3/4/24
Date

THIS PAGE MUST BE COMPLETED AND SUBMITTED WITH PROPOSAL

END OF PART IV