



City of North Port

RESOLUTION NO 07 – R 11

A RESOLUTION OF THE CITY COMMISSION OF THE CITY OF NORTH PORT FLORIDA PERTAINING TO THE MYAKKAHATCHEE CREEK CORRIDOR PROJECT APPROVING A MODIFICATION TO THE BOUNDARIES OF THE PROJECT AREA AUTHORIZING AND DIRECTING THE ACQUISITION OF CERTAIN REAL PROPERTY WITHIN THE PROJECT AREA BY PURCHASE EXCHANGE OR DONATION FOR THE PURPOSES OF PRESERVING AND ENHANCING THE MYAKKAHATCHEE CREEK AS A CLASS I POTABLE WATER SUPPLY AND NATURAL RESOURCE AMENITY DIRECTING HOW FUNDS APPROPRIATED FROM THE CITY'S LAND ACQUISITION FUND SHALL BE USED AND FURTHER DIRECTING HOW ANY REIMBURSEMENTS RECEIVED FROM A FLORIDA COMMUNITIES TRUST GRANT FOR THE PROJECT BE CREDITED

RECITALS

WHEREAS the City Commission recognizes that preserving and enhancing the Myakkahatchee Creek as a Class I potable water supply and natural resource amenity serves a public purpose and is in the best interests of the City of North Port and its citizens and

WHEREAS City staff has analyzed the Myakkahatchee Creek Corridor Project Area (the Project Area) and based upon overall project objectives has modified the Project Area by including certain selected lots adjacent to the original Tier Two for the purposes of public safety and Tier One and Tier Two continuity said modified Project Area being described in Exhibit A attached hereto and by reference made a part hereof and

WHEREAS the City Commission has directed staff to move forward with the acquisition of additional lots within the Myakkahatchee Creek Project Area (the Project Area) and

WHEREAS the City Commission has directed staff to submit a grant application to the Florida Communities Trust for the sole purpose of assisting in the acquisition of said lots and

WHEREAS City staff has identified a certain number of lots and tracts to be included in the proposed acquisition phase said lots and tracts being described in Exhibit B attached hereto and by reference made a part hereof and

NOW THEREFORE BE IT RESOLVED by the City Commissioners of the City of North Port Florida

1 The Commission hereby approves the modified Project Area as described in Exhibit A attached hereto and is by reference made a part hereof

2 The Board hereby authorizes and directs the acquisition of platted lots and tracts located in the Project Area by purchase donation or exchange said lots and tracts described in Exhibit B attached hereto and by reference made a part hereof

3 The Commission further directs that any funds appropriated for this project from the Land Acquisition Fund not be expended until the City receives formal approval of its grant application to the Florida Communities Trust for the project

4 The Commission further directs that any reimbursement received from the Florida Community Trust that is part of this project be deposited in the City's Land Acquisition Fund Account

5 The Commission hereby authorizes the City Manager or his designee to perform all actions delegable to him by law that are necessary to negotiate enter into and consummate the proposed purchases exchanges or donations including without limitation the following

- A Authorized to contract for necessary appraisal services survey services title services legal services closing services and any ancillary services necessary for the acquisition of said platted lots
- B Authorized to negotiate enter into and consummate the proposed purchases and donations for the acquisition of all portions of the property
- C Authorized to purchase platted lots and tracts pursuant to Agreements for Purchase and Sale of Real Property executed by the property owner(s) and approved by the City Manager or his designee
- D Authorized to acquire platted lots and tracts by donation subject to the procedures for acceptance of donations of real property as determined by the City Manager with the advice and counsel of the City Attorney
- E Authorized to acquire platted lots and tracts by exchange subject to the procedures for the exchange of real property as determined by the City Manager with the advice and counsel of the City Attorney
- F Authorized to pay for the costs of acquiring such platted lots including the cost of purchase appraisal services survey services title services usual and customary closing costs the City's legal services and any other costs as deemed prudent to the acquisition
- G Authorized to sign all documents on behalf of the City Commission necessary to complete the acquisition of any such lots and tracts

Effective Date This resolution shall become effective immediately upon passage

Passed and adopted on this 23rd day of April 2007

City of North Port Florida

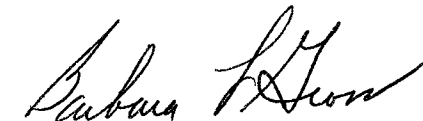

Barbara L. Gross
Chair

Attest

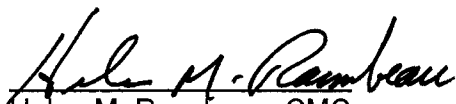

Helen M. Raimbeau CMC
City Clerk

Approved as to Form and Correctness



Robert K. Robinson
City Attorney

EXHIBIT A

***Modified Project Area
Myakkahatchee Creek Corridor Project
April 2007***

Exhibit A
Myakkahatchee Creek Corridor
Proejct Area

No	PID	Street Name	LEGAL1
1	0942 04 1906	Lacey Street	Part Of Tract A
2	0968 05 7454	Battersea Avenue	Lot 54 Block 574 18th Addition Port Charlotte
3	0968 05 7455	Welco Street	Lot 55 Block 574 18th Addition Port Charlotte
4	0968 05 7456	Welco Street	Lot 56 Block 574 18th Addition Port Charlotte
5	0968 05 7457	Welco Street	Lot 57 Block 574 18th Addition Port Charlotte
6	0968 05 7458	Welco Street	Lot 58 Block 574 18th Addition Port Charlotte
7	0968 05 7459	Welco Street	Lot 59 Block 574 18th Addition Port Charlotte
8	0968 05 7460	Welco Street	Lot 60 Block 574 18th Addition Port Charlotte
9	0968 05 7461	Welco Street	Lot 61 Block 574 18th Addition Port Charlotte
10	0968 05 7462	Welco Street	Lot 62 Block 574 18th Addition Port Charlotte
11	0968 05 7463	Welco Street	Lot 63 Block 574 18th Addition Port Charlotte
12	0968 05 7464	Welco Street	Lot 64 Block 574 18th Addition Port Charlotte
13	0968 05 7465	Welco Street	Lot 65 Block 574 18th Addition Port Charlotte
14	0968 05 7466	Welco Street	Lot 66 Block 574 18th Addition Port Charlotte
15	0968 05 7467	Welco Street	Lot 67 Block 574 18th Addition Port Charlotte
16	0968 05 7468	Burwin Avenue	Lot 68 Block 574 18th Addition Port Charlotte
17	0968 05 7801	Battersea Avenue	Lot 1 Block 578 18th Addition Port Charlotte
18	0968 05 7825	Redland Avenue	Lot 25 Block 578 18th Addition Port Charlotte
19	0968 05 7901	Redland Avenue	Lot 1 Block 579 18th Addition Port Charlotte
20	0968 05 7925	Cantor Avenue	Lot 25 Block 579 18th Addition Port Charlotte
21	0968 05 8001	Cantor Avenue	Lot 1 Block 580 18th Addition Port Charlotte
22	0968 05 8025	Burwin Avenue	Lot 25 Block 580 18th Addition Port Charlotte
23	0968 05 8113	Giffen Avenue	Lot 13 Block 581 18th Addition Port Charlotte
24	0968 05 8113	Giffen Avenue	Lot 14 Block 581 18th Addition Port Charlotte
25	0968 05 8115	Cabbage Palm Street	Lot 15 Block 581 18th Addition Port Charlotte
26	0968 05 8116	Cabbage Palm Street	Lot 16 Block 581 18th Addition Port Charlotte
27	0968 05 8117	Cabbage Palm Street	Lot 17 Block 581 18th Addition Port Charlotte
28	0968 05 8118	Cabbage Palm Street	Lot 18 Block 581 18th Addition Port Charlotte
29	0968 05 8119	Cabbage Palm Street	Lot 19 Block 581 18th Addition Port Charlotte
30	0968 05 8120	Cabbage Palm Street	Lot 20 Block 581 18th Addition Port Charlotte
31	0968 05 8121	Cabbage Palm Street	Lot 21 Block 581 18th Addition Port Charlotte
32	0968 05 8122	Cabbage Palm Street	Lot 22 Block 581 18th Addition Port Charlotte
33	0968 05 8123	Cabbage Palm Street	Lot 23 Block 581 18th Addition Port Charlotte
34	0968 05 8124	Cabbage Palm Street	Lot 24 Block 581 18th Addition Port Charlotte
35	0968 05 8125	Cabbage Palm Street	Lot 25 Block 581 18th Addition Port Charlotte
36	0968 05 8126	Cabbage Palm Street	Lot 26 Block 581 18th Addition Port Charlotte
37	0968 05 8127	Cabbage Palm Street	Lot 27 Block 581 18th Addition Port Charlotte
38	0968 05 8128	Cabbage Palm Street	Lot 28 Block 581 18th Addition Port Charlotte
39	0968 05 8129	Cabbage Palm Street	Lot 29 Block 581 18th Addition Port Charlotte
40	0968 05 8130	Cabbage Palm Street	Lot 30 Block 581 18th Addition Port Charlotte
41	0967 05 8131	Silver Palm Street	Lot 31 Block 581 18th Addition Port Charlotte
42	0967 05 8132	Silver Palm Street	Lot 32 Block 581 18th Addition Port Charlotte
43	0967 05 8133	Silver Palm Street	Lot 33 Block 581 18th Addition Port Charlotte
44	0967 05 8134	Silver Palm Street	Lot 34 Block 581 18th Addition Port Charlotte
45	0967 05 8135	Silver Palm Street	Lot 35 Block 581 18th Addition Port Charlotte
46	0967 05 8136	Silver Palm Street	Lot 36 Block 581 18th Addition Port Charlotte
47	0967 05 8137	Silver Palm Street	Lot 37 Block 581 18th Addition Port Charlotte
48	0967 05 8138	Silver Palm Street	Lot 38 Block 581 18th Addition Port Charlotte
49	0967 05 8139	Silver Palm Street	Lot 39 Block 581 18th Addition Port Charlotte
50	0967 05 8140	Silver Palm Street	Lot 40 Block 581 18th Addition Port Charlotte

Exhibit A
Myakkahatchee Creek Corridor
Project Area

No	PID	Street Name	LEGAL1			
51	0967 05 8141	Silver Palm Street	Lot 41 Block 581	18th Addition	Port Charlotte	
52	0967 05 8142	Silver Palm Street	Lot 42 Block 581	18th Addition	Port Charlotte	
53	0967 05 8143	Silver Palm Street	Lot 43 Block 581	18th Addition	Port Charlotte	
54	0967 05 8144	Silver Palm Street	Lot 44 Block 581	18th Addition	Port Charlotte	
55	0967 05 8145	Silver Palm Street	Lot 45 Block 581	18th Addition	Port Charlotte	
56	0967 05 8146	Silver Palm Street	Lot 46 Block 581	18th Addition	Port Charlotte	
57	0967 05 8147	Fling Avenue	Lot 47 Block 581	18th Addition	Port Charlotte	
58	0968 05 8201	Cabbage Palm Street	Lot 1 Block 582	18th Addition	Port Charlotte	
59	0968 05 8202	Cabbage Palm Street	Lot 2 Block 582	18th Addition	Port Charlotte	
60	0968 05 8203	Cabbage Palm Street	Lot 3 Block 582	18th Addition	Port Charlotte	
61	0968 05 8204	Cabbage Palm Street	Lot 4 Block 582	18th Addition	Port Charlotte	
62	0968 05 8205	Cabbage Palm Street	Lot 5 Block 582	18th Addition	Port Charlotte	
63	0968 05 8206	Cabbage Palm Street	Lot 6 Block 582	18th Addition	Port Charlotte	
64	0968 05 8207	Cabbage Palm Street	Lot 7 Block 582	18th Addition	Port Charlotte	
65	0968 05 8208	Cabbage Palm Street	Lot 8 Block 582	18th Addition	Port Charlotte	
66	0968 05 8209	Cabbage Palm Street	Lot 9 Block 582	18th Addition	Port Charlotte	
67	0968 05 8210	Cabbage Palm Street	Lot 10 Block 582	18th Addition	Port Charlotte	
68	0968 05 8211	Cabbage Palm Street	Lot 11 Block 582	18th Addition	Port Charlotte	
69	0968 05 8212	Cabbage Palm Street	Lot 12 Block 582	18th Addition	Port Charlotte	
70	0968 05 8213	Giffen Avenue	Lot 13 Block 582	18th Addition	Port Charlotte	
71	0968 05 8214	Giffen Avenue	Lot 14 Block 582	18th Addition	Port Charlotte	
72	0968 05 8801	Jacaranda Avenue	Lot 1 Block 588	18th Addition	Port Charlotte	
73	0967 05 8832	Sylvania Avenue	Lot 32 Block 588	18th Addition	Port Charlotte	
74	0967 05 8901	Cabbage Palm Street	Lot 1 Block 589	18th Addition	Port Charlotte	
75	0967 05 8935	Jessamine Avenue	Lot 35 Block 589	18th Addition	Port Charlotte	
76	0967 05 8936	Jessamine Avenue	Lot 36 Block 589	18th Addition	Port Charlotte	
77	0967 06 0101	Jessamine Avenue	Lot 1 Block 601	18th Addition	Port Charlotte	
78	0967 06 0117	Cabbage Palm Street	Lot 17 Block 601	18th Addition	Port Charlotte	
79	0967 06 0118	Silver Palm Street	Lot 18 Block 601	18th Addition	Port Charlotte	
80	0967 06 0201	Gimlet Avenue	Lot 1 Block 602	18th Addition	Port Charlotte	
81	0967 06 0222	Fling Avenue	Lot 22 Block 602	18th Addition	Port Charlotte	
82	0967 06 0223	Silver Palm Street	Lot 23 Block 602	18th Addition	Port Charlotte	
83	0967 06 0509	Neham Street	Lot 9 Block 605	18th Addition	Port Charlotte	
84	0967 06 0510	Neham Street	Lot 10 Block 605	18th Addition	Port Charlotte	
85	0967 06 0511	Neham Street	Lot 11 Block 605	18th Addition	Port Charlotte	
86	0967 06 0512	Neham Street	Lot 12 Block 605	18th Addition	Port Charlotte	
87	0967 06 0513	Dorie Street	Lot 13 Block 605	18th Addition	Port Charlotte	
88	0967 06 0514	Neham Street	Lot 14 Block 605	18th Addition	Port Charlotte	
89	0967 06 0515	Neham Street	Lot 15 Block 605	18th Addition	Port Charlotte	
90	0967 06 0516	Neham Street	Lot 16 Block 605	18th Addition	Port Charlotte	
91	0967 06 0517	Neham Street	Lot 17 Block 605	18th Addition	Port Charlotte	
92	0967 06 0645	Shaffer Avenue	Lot 45 Block 606	18th Addition	Port Charlotte	
93	0967 06 0646	Neham Street	Lot 46 Block 606	18th Addition	Port Charlotte	
94	0967 06 0647	Neham Street	Lot 47 Block 606	18th Addition	Port Charlotte	
95	0967 06 0648	Neham Street	Lot 48 Block 606	18th Addition	Port Charlotte	
96	0967 06 0649	Neham Street	Lot 49 Block 606	18th Addition	Port Charlotte	
97	0967 06 0650	Neham Street	Lot 50 Block 606	18th Addition	Port Charlotte	
98	0967 06 0651	Neham Street	Lot 51 Block 606	18th Addition	Port Charlotte	
99	0967 06 0652	Neham Street	Lot 52 Block 606	18th Addition	Port Charlotte	
100	0967 06 0653	Neham Street	Lot 53 Block 606	18th Addition	Port Charlotte	

Exhibit A
Myakkahatchee Creek Corridor
Proejct Area

No	PID	Street Name	LEGAL1	
101	0967 06 0654	Neham Street	Lot 54 Block 606 18th Addition	Port Charlotte
102	0967 06 0655	Neham Street	Lot 55 Block 606 18th Addition	Port Charlotte
103	0967 06 0656	Neham Street	Lot 56 Block 606 18th Addition	Port Charlotte
104	0967 06 0657	Neham Street	Lot 57 Block 606 18th Addition	Port Charlotte
105	0967 06 0658	Neham Street	Lot 58 Block 606 18th Addition	Port Charlotte
106	0967 06 0659	Neham Street	Lot 59 Block 606 18th Addition	Port Charlotte
107	0967 06 0660	Casanova Avenue	Lot 60 Block 606 18th Addition	Port Charlotte
108	0954 06 0742	Sensation Street	Lot 42 Block 607 18th Addition	Port Charlotte
109	0967 06 0743	Sensation Street	Lot 43 Block 607 18th Addition	Port Charlotte
110	0967 06 0744	Kumquat Avenue	Lot 44 Block 607 18th Addition	Port Charlotte
111	0967 06 0947	Kumquat Avenue	Lot 47 Block 609 18th Addition	Port Charlotte
112	0967 06 0948	Kumquat Avenue	Lot 48 Block 609 18th Addition	Port Charlotte
113	0967 06 0949	Sensation Street	Lot 49 Block 609 18th Addition	Port Charlotte
114	0954 06 0950	Sensation Street	Lot 50 Block 609 18th Addition	Port Charlotte
115	0954 06 0951	Sensation Street	Lot 51 Block 609 18th Addition	Port Charlotte
116	0954 06 0952	Sensation Street	Lot 52 Block 609 18th Addition	Port Charlotte
117	0968 06 1014	Broward Avenue	Lot 16 Block 610 14th Addition	Port Charlotte Replat
118	0968 06 1017	Flagler Street	Lot 17 Block 610 14th Addition	Port Charlotte Replat
119	0968 06 1018	Flagler Street	Lot 18 Block 610 14th Addition	Port Charlotte Replat Of A Portion
120	0968 06 1019	Flagler Street	Lot 19 Block 610 14th Addition	Port Charlotte Replat
121	0968 06 1020	Flagler Street	Lot 20 Block 610 14th Addition	Port Charlotte Replat
122	0968 06 1021	Flagler Street	Lot 21 Block 610 14th Addition	Port Charlotte Replat
123	0968 06 1022	Flagler Street	Lot 22 Block 610 14th Addition	Port Charlotte Replat
124	0968 06 1023	Flagler Street	Lot 23 Block 610 14th Addition	Port Charlotte Replat
125	0968 06 1024	Flagler Street	Lot 24 Block 610 14th Addition	Port Charlotte Replat
126	0968 06 1025	Flagler Street	Lot 25 Block 610 14th Addition	Port Charlotte Replat
127	0968 06 1026	Flagler Street	Lot 26 Block 610 14th Addition	Port Charlotte Replat
128	0968 06 1027	Flagler Street	Lot 27 Block 610 14th Addition	Port Charlotte Replat
129	0968 06 1028	Flagler Street	Lot 28 Block 610 14th Addition	Port Charlotte Replat
130	0968 06 1029	Flagler Street	Lot 29 Block 610 14th Addition	Port Charlotte Replat
131	0968 06 1030	Flagler Street	Lot 30 Block 610 14th Addition	Port Charlotte Replat
132	0968 06 1031	Flagler Street	Lot 31 Block 610 14th Addition	Port Charlotte Replat
133	0968 06 1032	Flagler Street	Lot 32 Block 610 14th Addition	Port Charlotte Replat
134	0968 06 1033	Flagler Street	Lot 33 Block 610 14th Addition	Port Charlotte Replat
135	0968 06 1034	Flagler Street	Lot 34 Block 610 14th Addition	Port Charlotte Replat
136	0968 06 1035	Flagler Street	Lot 35 Block 610 14th Addition	Port Charlotte Replat
137	0977 06 1036	Flagler Street	Lot 36 Block 610 14th Addition	Port Charlotte Replat
138	0977 06 1037	Flagler Street	Lot 37 Block 610 14th Addition	Port Charlotte Replat
139	0977 06 1038	Flagler Street	Lot 38 Block 610 14th Addition	Port Charlotte Replat
140	0977 06 1039	Flagler Street	Lot 39 Block 610 14th Addition	Port Charlotte Replat
141	0977 06 1040	Flagler Street	Lot 40 Block 610 14th Addition	Port Charlotte Replat
142	0977 06 1041	Flagler Street	Lot 41 Block 610 14th Addition	Port Charlotte Replat
143	0977 06 1042	Flagler Street	Lot 42 Block 610 14th Addition	Port Charlotte Replat
144	0977 06 1043	Flagler Street	Tract G Block 610 14th Addition	Port Charlotte Replat
145	0977 06 1101	Hermosa Circle	Lot 1 Block 611 14th Addition	Port Charlotte Replat
146	0977 06 1102	Hermosa Circle	Lot 2 Block 611 14th Addition	Port Charlotte Replat
147	0977 06 1148	Constitution Ct	Lot 48 Block 611 14th Addition	Port Charlotte Replat
148	0977 06 1149	Constitution Ct	Lot 49 Block 611 14th Addition	Port Charlotte Replat
149	0977 06 1150	Constitution Ct	Lot 50 Block 611 14th Addition	Port Charlotte Replat
150	0977 06 1201	Cody Circle	Lot 1 Block 612 14th Addition	Port Charlotte 1st Replat

Exhibit A
Myakkahatchee Creek Corridor
Project Area

No	PID	Street Name	LEGAL1
151	0977 06 1202	Cody Circle	Lot 2 Block 612 14th Addition Port Charlotte Replat
152	0977 06 1235	Hermosa Circle	Lot 35 Block 612 14th Addition Port Charlotte Replat
153	0977 06 1235	Hermosa Circle	Lot 36 Block 612 14th Addition Port Charlotte Replat
154	0968 06 1301	Flagler Street	Lot 1 Block 613 14th Addition Port Charlotte Replat
155	0968 06 1302	Flagler Street	Lot 2 Block 613 14th Addition Port Charlotte Replat
156	0968 06 1303	Flagler Street	Lot 3 Block 613 14th Addition Port Charlotte Replat
157	0968 06 1304	Flagler Street	Lot 4 Block 613 14th Addition Port Charlotte Replat
158	0968 06 1305	Flagler Street	Lot 5 Block 613 14th Addition Port Charlotte Replat
159	0968 06 1306	Flagler Street	Lot 6 Block 613 14th Addition Port Charlotte Replat
160	0968 06 1306	Flagler Street	Lot 7 Block 613 14th Addition Port Charlotte Replat
161	0968 06 1308	Flagler Street	Lot 8 Block 613 14th Addition Port Charlotte Replat
162	0968 06 1309	Flagler Street	Lot 9 Block 613 14th Addition Port Charlotte Replat
163	0968 06 1310	Cody Circle	Lot 10 Block 613 14th Addition Port Charlotte Replat
164	0968 06 1322	Alpen Avenue	Tract D Block 613 14th Addition Port Charlotte Replat
165	0968 06 1401	Paso Avenue	Lot 1 Block 614 14th Addition Port Charlotte Replat
166	0968 06 1401	Paso Avenue	Lot 2 Block 614 14th Addition Port Charlotte Replat
167	0968 06 1430	Alpen Avenue	Lot 30 Block 614 14th Addition Port Charlotte Replat
168	0968 06 1431	N/A	Lot 31 Block 614 14th Addition Port Charlotte Replat
169	0968 06 1501	Broward Avenue	Lot 1 Block 615 14th Addition Port Charlotte Replat
170	0968 06 1502	Broward Avenue	Lot 2 Block 615 14th Addition Port Charlotte Replat Of A Portion
171	0968 06 1530	Paso Avenue	Lot 30 Block 615 14th Addition Port Charlotte Replat
172	0968 06 1531	Paso Avenue	Lot 31 Block 615 14th Addition Port Charlotte Replat
173	0968 06 1601	Eureka Avenue	Lot 1 Block 616 14th Addition Port Charlotte Replat
174	0968 06 1602	Eureka Avenue	Lot 2 Block 616 14th Addition Port Charlotte Replat
175	0968 06 1630	Ames Avenue	Lot 30 Block 616 14th Addition Port Charlotte Replat
176	0968 06 1631	Ames Avenue	Lot 31 Block 616 14th Addition Port Charlotte Replat
177	0968 06 1701	Van Ness Avenue	Lot 1 Block 617 14th Addition Port Charlotte Replat
178	0968 06 1701	Van Ness Avenue	Lot 2 Block 617 14th Addition Port Charlotte Replat
179	0968 06 1701	Van Ness Avenue	Lot 3 Block 617 14th Addition Port Charlotte Replat
180	0970 06 1704	Van Ness Avenue	Lot 4 Block 617 14th Addition Port Charlotte Replat
181	0970 06 1704	Van Ness Avenue	Lot 5 Block 617 14th Addition Port Charlotte Replat
182	0970 06 1706	Van Ness Avenue	Lot 6 Block 617 14th Addition Port Charlotte Replat
183	0968 06 1730	Eureka Avenue	Lot 30 Block 617 14th Addition Port Charlotte Replat
184	0968 06 1731	Eureka Avenue	Lot 31 Block 617 14th Addition Port Charlotte Replat
185	0969 06 1801	Lemon Road	Lot 1 Block 618 14th Addition Port Charlotte Replat
186	0969 06 1802	Lemon Road	Lot 2 Block 618 14th Addition Port Charlotte Replat
187	0970 06 1808	Delmar Drive	Lot 8 Block 618 14th Addition Port Charlotte Replat
188	0970 06 1809	Delmar Drive	Lot 9 Block 618 14th Addition Port Charlotte Replat
189	0970 06 1810	Delmar Drive	Lot 10 Block 618 14th Addition Port Charlotte Replat
190	0969 06 1811	Delmar Drive	Lot 11 Block 618 14th Addition Port Charlotte Replat
191	0967 06 1812	Delmar Drive	Lot 12 Block 618 14th Addition Port Charlotte Replat
192	0969 06 1902	Hamer Terrace	Lot 2 Block 619 14th Addition Port Charlotte Replat
193	0969 06 1903	Hamer Terrace	Lot 3 Block 619 14th Addition Port Charlotte Replat
194	0969 06 1920	Lemon Road	Lot 20 Block 619 14th Addition Port Charlotte Replat
195	0969 06 1902	Hamer Terrace	Lot 21 Block 619 14th Addition Port Charlotte Replat
196	0969 06 1902	Hamer Terrace	Lot 22 Block 619 14th Addition Port Charlotte Replat
197	0969 06 2002	Brixton Terrace	Lot 2 Block 620 14th Addition Port Charlotte Replat
198	0969 06 2003	Brixton Terrace	Lot 3 Block 620 14th Addition Port Charlotte Replat
199	0969 06 2031	Hamer Terrace	Lot 31 Block 620 14th Addition Port Charlotte Replat
200	0969 06 2032	Hamer Terrace	Lot 32 Block 620 14th Addition Port Charlotte Replat

Exhibit A
Myakkahatchee Creek Corridor
Proejct Area

No	PID	Street Name	LEGAL1
201	0969 06 2301	Delmar Drive	Lot 1 Block 623 14th Addition Port Charlotte Replat
202	0969 06 2302	Delmar Drive	Lot 2 Block 623 14th Addition Port Charlotte Replat
203	0969 06 2303	Delmar Drive	Lot 3 Block 623 14th Addition Port Charlotte Replat
204	0969 06 2304	Delmar Drive	Lot 4 Block 623 14th Addition Port Charlotte Replat
205	0969 06 2305	Delmar Drive	Lot 5 Block 623 14th Addition Port Charlotte Replat
206	0969 06 2306	Delmar Drive	Lot 6 Block 623 14th Addition Port Charlotte Replat
207	0969 06 2306	Delmar Drive	Lot 7 Block 623 14th Addition Port Charlotte Replat
208	0969 06 2308	Delmar Drive	Lot 8 Block 623 14th Addition Port Charlotte Replat
209	0969 06 2309	Brixton Terrace	Lot 9 Block 623 14th Addition Port Charlotte Replat
210	0969 06 2321	Delmar Drive	Lot 3a Block 623 14th Addition Port Charlotte Replat
211	0969 06 2401	Notre Dame Terrace	Lot 1 Block 624 14th Addition Port Charlotte Replat
212	0969 06 2402	Notre Dame Terrace	Lot 2 Block 624 14th Addition Port Charlotte Replat
213	0969 06 2438	Tilhal Terrace	Lot 38 Block 624 14th Addition Port Charlotte Replat
214	0969 06 2439	Tilhal Terrace	Lot 39 Block 624 14th Addition Port Charlotte Replat
215	0969 06 2501	Delmar Drive	Lot 1 Block 625 14th Addition Port Charlotte Replat
216	0969 06 2502	Delmar Drive	Lot 2 Block 625 14th Addition Port Charlotte Replat
217	0969 06 2503	Delmar Drive	Lot 3 Block 625 14th Addition Port Charlotte Replat
218	0969 06 2504	Delmar Drive	Lot 4 Block 625 14th Addition Port Charlotte Replat
219	0969 06 2505	Delmar Drive	Lot 5 Block 625 14th Addition Port Charlotte Replat
220	0969 06 2506	Delmar Drive	Lot 6 Block 625 14th Addition Port Charlotte Replat
221	0969 06 2507	Delmar Drive	Lot 7 Block 625 14th Addition Port Charlotte Replat
222	0969 06 2508	Delmar Drive	Lot 8 Block 625 14th Addition Port Charlotte Replat
223	0969 06 2509	Delmar Drive	Lot 9 Block 625 14th Addition Port Charlotte Replat
224	0969 06 2510	Delmar Drive	Lot 10 Block 625 14th Addition Port Charlotte Replat
225	0969 06 2511	Delmar Drive	Lot 11 Block 625 14th Addition Port Charlotte Replat
226	0969 06 2512	Delmar Drive	Lot 12 Block 625 14th Addition Port Charlotte Replat
227	0969 06 2513	Delmar Drive	Lot 13 Block 625 14th Addition Port Charlotte Replat
228	0969 06 2514	Delmar Drive	Lot 14 Block 625 14th Addition Port Charlotte Replat
229	0969 06 2515	Delmar Drive	Lot 15 Block 625 14th Addition Port Charlotte Replat
230	0969 06 2516	Delmar Drive	Lot 16 Block 625 14th Addition Port Charlotte Replat
231	0969 06 2517	Delmar Drive	Lot 17 Block 625 14th Addition Port Charlotte Replat
232	0969 06 2518	Delmar Drive	Lot 18 Block 625 14th Addition Port Charlotte Replat
233	0969 06 2519	Delmar Drive	Lot 19 Block 625 14th Addition Port Charlotte Replat
234	0969 06 2520	Delmar Drive	Lot 20 Block 625 14th Addition Port Charlotte Replat
235	0969 06 2521	Delmar Drive	Lot 21 Block 625 14th Addition Port Charlotte Replat
236	0969 06 2522	Delmar Drive	Lot 22 Block 625 14th Addition Port Charlotte Replat
237	0969 06 2523	Delmar Drive	Lot 23 Block 625 14th Addition Port Charlotte Replat
238	0969 06 2524	Delmar Drive	Lot 24 Block 625 14th Addition Port Charlotte Replat
239	0969 06 2525	Delmar Drive	Lot 25 Block 625 14th Addition Port Charlotte Replat
240	0969 06 2526	Delmar Drive	Lot 26 Block 625 14th Addition Port Charlotte Replat
241	0969 06 2527	Delmar Drive	Lot 27 Block 625 14th Addition Port Charlotte Replat
242	0967 06 2528	Delmar Drive	Lot 28 Block 625 14th Addition Port Charlotte Replat
243	0967 06 2529	Delmar Drive	Lot 29 Block 625 14th Addition Port Charlotte Replat
244	0967 06 2530	Delmar Drive	Lot 30 Block 625 14th Addition Port Charlotte Replat
245	0967 06 2531	Delmar Drive	Lot 31 Block 625 14th Addition Port Charlotte Replat
246	0967 06 2532	Delmar Drive	Lot 32 Block 625 14th Addition Port Charlotte Replat
247	0968 06 2533	Nelson Avenue	Lot 33 Block 625 14th Addition Port Charlotte Replat
248	0968 06 2534	Nelson Avenue	Lot 34 Block 625 14th Addition Port Charlotte Replat
249	0968 06 2535	Nelson Avenue	Lot 35 Block 625 14th Addition Port Charlotte Replat
250	0968 06 2536	Nelson Avenue	Lot 36 Block 625 14th Addition Port Charlotte Replat

Exhibit A
Myakkahatchee Creek Corridor
Proejct Area

No	PID	Street Name	LEGAL1
251	0968 06 2537	Nelson Avenue	Lot 37 Block 625 14th Addition Port Charlotte Replat
252	0968 06 2538	Nelson Avenue	Lot 38 Block 625 14th Addition Port Charlotte Replat
253	0968 06 2539	Nelson Avenue	Lot 39 Block 625 14th Addition Port Charlotte Replat
254	0968 06 2540	Nelson Avenue	Lot 40 Block 625 14th Addition Port Charlotte Replat
255	0968 06 2541	Ames Avenue	Lot 41 Block 625 14th Addition Port Charlotte Replat
256	0968 06 2558	Delmar Drive	Tract F Block 625 14th Addition Port Charlotte Replat
257	0969 06 2601	Balboa Terrace	Lot 1 Block 626 14th Addition Port Charlotte Replat
258	0969 06 2602	Balboa Terrace	Lot 2 Block 626 14th Addition Port Charlotte Replat
259	0969 06 2616	Notre Dame Terrace	Lot 16 Block 626 14th Addition Port Charlotte Replat
260	0969 06 2617	Notre Dame Terrace	Lot 17 Block 626 14th Addition Port Charlotte Replat
261	0969 06 2618	Notre Dame Terrace	Lot 18 Block 626 14th Addition Port Charlotte Replat
262	0977 06 2901	Constitution Ct	Lot 1 Block 629 14th Addition Port Charlotte Replat
263	0977 06 2989	Constitution Ct	Lot 1a Block 629 14th Addition Port Charlotte Replat
264	0977 06 2992	Flagler Street	Tract E Block 629 14th Addition Port Charlotte Replat
265	0969 12 4912	Balboa Terrace	Lot 12 Block 1249 27th Addition Port Charlotte
266	0969 12 4913	Balboa Terrace	Lot 13 Block 1249 27th Addition Port Charlotte
267	0969 12 4914	Balboa Terrace	Lot 14 Block 1249 27th Addition Port Charlotte
268	0969 12 4915	Towhlen Road	Lot 15 Block 1249 27th Addition Port Charlotte
269	0969 12 4916	Towhlen Road	Lot 16 Block 1249 27th Addition Port Charlotte
270	0969 12 5107	Ponce De Leon Blvd	Lot 7 Less Wly 20 Block 1251 27th Addition Port Charlotte
271	0952 12 5108	April Lane	Lot 8 Block 1251 27th Addition Port Charlotte
272	0952 12 5207	April Lane	Lot 7 Block 1252 27th Addition Port Charlotte
273	0954 12 5208	Delmar Drive	Lot 8 Block 1252 27th Addition Port Charlotte
274	0954 12 5209	Simca Lane	Lot 9 Block 1252 27th Addition Port Charlotte
275	0954 12 5210	Simca Lane	Lot 10 Block 1252 27th Addition Port Charlotte
276	0954 12 5309	Simca Lane	Lot 9 Block 1253 27th Addition Port Charlotte
277	0954 12 5310	Delmar Drive	Lot 10 Block 1253 27th Addition Port Charlotte
278	0954 12 5311	Pagado Lane	Lot 11 Block 1253 27th Addition Port Charlotte
279	0954 12 5312	Pagado Lane	Lot 12 Block 1253 27th Addition Port Charlotte
280	0967 12 5401	Delmar Drive	Lot 1 Block 1254 27th Addition Port Charlotte
281	0967 12 5401	Delmar Drive	Lot 2 Block 1254 27th Addition Port Charlotte
282	0967 12 5401	Delmar Drive	Lot 3 Block 1254 27th Addition Port Charlotte
283	0954 12 5404	Delmar Drive	Lot 4 Block 1254 27th Addition Port Charlotte
284	0954 12 5405	Delmar Drive	Lot 5 Block 1254 27th Addition Port Charlotte
285	0954 12 5406	Delmar Drive	Lot 6 Block 1254 27th Addition Port Charlotte
286	0954 12 5407	Delmar Drive	Lot 7 Block 1254 27th Addition Port Charlotte
287	0954 12 5408	Delmar Drive	Lot 9 Block 1254 27th Addition Port Charlotte
288	0954 12 5410	Delmar Drive	Lot 10 Block 1254 27th Addition Port Charlotte
289	0954 12 5411	Delmar Drive	Lot 11 Block 1254 27th Addition Port Charlotte
290	0954 12 5412	Delmar Drive	Lot 12 Block 1254 27th Addition Port Charlotte
291	0954 12 5518	Delmar Drive	Lot 18 Block 1255 27th Addition Port Charlotte
292	0954 12 5519	Laratonda Road	Lot 19 Block 1255 27th Addition Port Charlotte
293	0954 12 6106	Laratonda Road	Lot 6 Block 1261 27th Addition Port Charlotte
294	0954 12 6107	Laratonda Road	Lot 7 Block 1261 27th Addition Port Charlotte
295	0954 12 6108	Delmar Drive	Lot 8 Block 1261 27th Addition Port Charlotte
296	0954 12 6109	Delmar Drive	Lot 9 Block 1261 27th Addition Port Charlotte
297	0954 12 6110	Laratonda Road	Lot 10 Block 1261 27th Addition Port Charlotte
298	0954 12 6111	Delmar Drive	Lot 11 Block 1261 27th Addition Port Charlotte
299	0954 12 6112	Delmar Drive	Lot 12 Block 1261 27th Addition Port Charlotte
300	0954 12 6113	Delmar Drive	Lot 13 Block 1261 27th Addition Port Charlotte

Exhibit A
Myakkahatchee Creek Corridor
Proejct Area

No	PID	Street Name	LEGAL1
301	0954 12 6114	Delmar Drive	Lot 14 Block 1261 27th Addition Port Charlotte
302	0954 12 6115	Delmar Drive	Lot 15 Block 1261 27th Addition Port Charlotte
303	0954 12 6116	Simberg Street	Lot 16 Block 1261 27th Addition Port Charlotte
304	0954 12 6124	Laratonda Road	Lot 24 Block 1261 27th Addition Port Charlotte
305	0954 12 6201	Delmar Drive	Lot 1 Block 1262 27th Addition Port Charlotte
306	0954 12 6202	Delmar Drive	Lot 2 Block 1262 27th Addition Port Charlotte
307	0954 12 6203	Delmar Drive	Lot 3 Block 1262 27th Addition Port Charlotte
308	0954 12 6204	Delmar Drive	Lot 4 Block 1262 27th Addition Port Charlotte
309	0954 12 6205	Delmar Drive	Lot 5 Block 1262 27th Addition Port Charlotte
310	0954 12 6206	Delmar Drive	Lot 6 Block 1262 27th Addition Port Charlotte
311	0954 12 6207	Delmar Drive	Lot 7 Block 1262 27th Addition Port Charlotte
312	0954 12 6208	Delmar Drive	Lot 8 Block 1262 27th Addition Port Charlotte
313	0954 12 6209	Delmar Drive	Lot 9 Block 1262 27th Addition Port Charlotte
314	0954 12 6210	Delmar Drive	Lot 10 Block 1262 27th Addition Port Charlotte
315	0954 12 6211	Delmar Drive	Lot 11 Block 1262 27th Addition Port Charlotte
316	0954 12 6212	Delmar Drive	Lot 12 Block 1262 27th Addition Port Charlotte
317	0954 12 6213	Delmar Drive	Lot 13 Block 1262 27th Addition Port Charlotte
318	0954 12 6214	Delmar Drive	Lot 14 Block 1262 27th Addition Port Charlotte
319	0954 12 6215	Delmar Drive	Lot 15 Block 1262 27th Addition Port Charlotte
320	0954 12 6216	Delmar Drive	Lot 16 Block 1262 27th Addition Port Charlotte
321	0954 12 6217	Delmar Drive	Lot 17 Block 1262 27th Addition Port Charlotte
322	0954 12 6218	Delmar Drive	Lot 18 Block 1262 27th Addition Port Charlotte
323	0954 12 6219	Delmar Drive	Lot 19 Block 1262 27th Addition Port Charlotte
324	0954 12 6220	Delmar Drive	Lot 20 Block 1262 27th Addition Port Charlotte
325	0954 12 6221	Delmar Drive	Lot 21 Block 1262 27th Addition Port Charlotte
326	0954 12 6222	Delmar Drive	Lot 22 Block 1262 27th Addition Port Charlotte
327	0954 12 6223	Delmar Drive	Lot 23 Block 1262 27th Addition Port Charlotte
328	0954 12 6224	Delmar Drive	Lot 24 Block 1262 27th Addition Port Charlotte
329	0954 12 6225	Delmar Drive	Lot 25 Block 1262 27th Addition Port Charlotte
330	0954 12 6226	Delmar Drive	Lot 26 Block 1262 27th Addition Port Charlotte
331	0954 12 6227	Delmar Drive	Lot 27 Block 1262 27th Addition Port Charlotte
332	0954 12 6228	Delmar Drive	Lot 28 Block 1262 27th Addition Port Charlotte
333	0954 12 6412	Delmar Drive	Lot 12 Block 1264 27th Addition Port Charlotte
334	0954 12 6413	Almanac Street	Lot 13 Block 1264 27th Addition Port Charlotte
335	0954 12 6624	Mandrake Terrace	Oaks Park Desc As Tract A 27thadd Port Charlotte
336	0954 12 6710	Delmar Drive	Lot 10 Block 1267 27th Addition Port Charlotte
337	0954 12 6711	Delmar Drive	Lot 11 Block 1267 27th Addition Port Charlotte
338	0954 12 6712	Delmar Drive	Lot 12 Block 1267 27th Addition Port Charlotte
339	0954 12 6713	Delmar Drive	Lot 13 Block 1267 27th Addition Port Charlotte
340	0954 12 6714	Alpaca Street	Lot 14 Block 1267 27th Addition Port Charlotte
341	0954 12 6807	Delmar Drive	Lot 7 Block 1268 27th Addition To Portcharlott
342	0954 12 6808	Delmar Drive	Lot 8 Block 1268 27th Addition Port Charlotte
343	0954 12 6809	Shelly Street	Lot 9 Block 1268 27th Addition Port Charlotte
344	0954 12 6903	Delmar Drive	Lot 3 Block 1269 27th Addition Port Charlotte
345	0954 12 6904	Delmar Drive	Lot 4 Block 1269 27th Addition Port Charlotte
346	0954 12 6905	Delmar Drive	Lot 5 Block 1269 27th Addition Port Charlotte
347	0954 12 6906	Averette Avenue	Lot 6 Block 1269 27th Addition Port Charlotte
348	0954 14 1701	Sensation Street	Lot 1 Block 1417 29th Addition Port Charlotte
349	0954 14 1702	Sensation Street	Lot 2 Block 1417 29th Addition Port Charlotte
350	0954 14 1703	Sensation Street	Lot 3 Block 1417 29th Addition Port Charlotte

Exhibit A
Myakkahatchee Creek Corridor
Proejct Area

No	PID	Street Name	LEGAL1	
351	0954 14 1704	Sensation Street	Lot 4 Block 1417 29th Addition	Port Charlotte
352	0954 14 1705	Sensation Street	Lot 5 Block 1417 29th Addition	Port Charlotte
353	0954 14 1706	Sensation Street	Lot 6 Block 1417 29th Addition	Port Charlotte
354	0954 14 1707	Sensation Street	Lot 7 Block 1417 29th Addition	Port Charlotte
355	0954 14 1708	Sensation Street	Lot 8 Block 1417 29th Addition	Port Charlotte
356	0954 14 1709	Sensation Street	Lot 9 Block 1417 29th Addition	Port Charlotte
357	0954 14 1710	Sensation Street	Lot 10 Block 1417 29th Addition	Port Charlotte
358	0954 14 1711	Sensation Street	Lot 11 Block 1417 29th Addition	Port Charlotte
359	0954 14 1712	Sensation Street	Lot 12 Block 1417 29th Addition	Port Charlotte
360	0954 14 1713	Sensation Street	Lot 13 Block 1417 29th Addition	Port Charlotte
361	0954 14 1714	Sensation Street	Lot 14 Block 1417 29th Addition	Port Charlotte
362	0954 14 1715	Sensation Street	Lot 15 Block 1417 29th Addition	Port Charlotte
363	0954 14 1716	Sensation Street	Lot 16 Block 1417 29th Addition	Port Charlotte
364	0954 14 1717	Sensation Street	Lot 17 Block 1417 29th Addition	Port Charlotte
365	0954 14 1718	Sensation Street	Lot 18 Block 1417 29th Addition	Port Charlotte
366	0954 14 1719	Sensation Street	Lot 19 Block 1417 29th Addition	Port Charlotte
367	0954 14 1720	Sensation Street	Lot 20 Block 1417 29th Addition	Port Charlotte
368	0954 14 1721	Abascal Street	Lot 21 Block 1417 29th Addition	Port Charlotte
369	0954 14 1722	Abascal Street	Lot 22 Block 1417 29th Addition	Port Charlotte
370	0954 14 1801	Bachmeyere Street	Lot 1 Block 1418 29th Addition	Port Charlotte
371	0954 14 1810	Banana Avenue	Lot 10 Block 1418 29th Addition	Port Charlotte
372	0954 14 1810	Banana Avenue	Lot 11 Block 1418 29th Addition	Port Charlotte
373	0954 14 1812	Sensation Street	Tract R 29th Addition	Port Charlotte
374	0954 14 1901	Sensation Street	Lot 1 Block 1419 29th Addition	Port Charlotte
375	0954 14 1916	Neon Avenue	Lot 16 Block 1419 29th Addition	Port Charlotte
376	0954 14 1917	Sensation Street	Lot 17 Block 1419 29th Addition	Port Charlotte
377	0954 14 2001	Kravitz Street	Lot 1 Block 1420 29th Addition	Port Charlotte
378	0954 14 2023	Sensation Street	Lot 23 Block 1420 29th Addition	Port Charlotte
379	0954 14 2101	Abascal Street	Lot 1 Block 1421 29th Addition	Port Charlotte
380	0954 14 2102	Abascal Street	Lot 2 Block 1421 29th Addition	Port Charlotte
381	0954 14 2127	Sensation Street	Lot 27 Block 1421 29th Addition	Port Charlotte
382	0954 14 2406	Vernell Street	Lot 6 Block 1424 29th Addition	Port Charlotte
383	0954 14 2407	Vernell Street	Lot 7 Block 1424 29th Addition	Port Charlotte
384	0954 14 2408	Vernell Street	Lot 8 Block 1424 29th Addition	Port Charlotte
385	0954 12 6624	Vernell Street	Lot 9 Block 1424 29th Addition	Port Charlotte
386	0954 12 6624	Vernell Street	Lot 10 Block 1424 29th Addition	Port Charlotte
387	0954 12 6624	Vernell Street	Lot 11 Block 1424 29th Addition	Port Charlotte
388	0954 12 6624	Vernell Street	Lot 12 Block 1424 29th Addition	Port Charlotte
389	0954 12 6624	Vernell Street	Lot 13 Block 1424 29th Addition	Port Charlotte
390	0954 12 6624	Vernell Street	Lot 14 Block 1424 29th Addition	Port Charlotte
391	0954 12 6624	Vernell Street	Lot 15 Block 1424 29th Addition	Port Charlotte
392	0954 12 6624	Vernell Street	Lot 16 Block 1424 29th Addition	Port Charlotte
393	0954 12 6624	Vernell Street	Lot 17 Block 1424 29th Addition	Port Charlotte
394	0954 12 6624	Vernell Street	Lot 18 Block 1424 29th Addition	Port Charlotte
395	0954 12 6624	Vernell Street	Lot 19 Block 1424 29th Addition	Port Charlotte
396	0954 12 6624	Vernell Street	Lot 20 Block 1424 29th Addition	Port Charlotte
397	0954 12 6624	Vernell Street	Lot 21 Block 1424 29th Addition	Port Charlotte
398	0954 12 6624	Vernell Street	Lot 22 Block 1424 29th Addition	Port Charlotte
399	0954 12 6624	Vernell Street	Lot 23 Block 1424 29th Addition	Port Charlotte
400	0954 14 2424	Mandrake Terrace	Oaks Park Lot 24 Block 1424 29th Addition	Port Charlotte

Exhibit A
Myakkahatchee Creek Corridor
Proejct Area

No	PID	Street Name	LEGAL1
401	0954 14 2425	Mandrake Terrace	Oaks Park Lot 25 Block 1424 29th Addition Port Charlotte
402	0954 14 2426	Mandrake Terrace	Oaks Park Lot 26 Block 1424 29th Addition Port Charlotte
403	0954 14 2427	Mandrake Terrace	Oaks Park Lot 27 Block 1424 29th Addition Port Charlotte
404	0954 14 2428	Mandrake Terrace	Oaks Park Lot 28 Block 1424 29th Addition Port Charlotte
405	0954 14 2429	Mandrake Terrace	Oaks Park Lot 29 Block 1424 29th Addition Port Charlotte
406	0954 14 2430	Mandrake Terrace	Oaks Park Lot 30 Block 1424 29th Addition Port Charlotte
407	0954 14 2431	Mandrake Terrace	Oaks Park Lot 31 Block 1424 29th Addition Port Charlotte
408	0954 14 2432	Mandrake Terrace	Oaks Park Lot 32 Block 1424 29th Addition Port Charlotte
409	0954 14 2433	Mandrake Terrace	Lot 33 Block 1424 29th Addition Port Charlotte
410	0954 14 2434	Mandrake Terrace	Oaks Park Lot 34 Block 1424 29th Addition Port Charlotte
411	0954 14 2435	Mandrake Terrace	Oaks Park Lot 35 Block 1424 29th Addition Port Charlotte
412	0954 14 2436	Mandrake Terrace	Oaks Park Lot 36 Block 1424 29th Addition Port Charlotte
413	0954 14 2437	Backensto Street	Lot 37 Block 1424 29th Addition Port Charlotte
414	0954 14 2812	Balsam Street	Lot 12 Block 1428 29th Addition Port Charlotte
415	0954 14 2813	Mandrake Terrace	Lot 13 Block 1428 29th Addition Port Charlotte
416	0954 14 2814	Mandrake Terrace	Lot 14 Block 1428 29th Addition Port Charlotte
417	0954 14 2815	Mandrake Terrace	Lot 15 Block 1428 29th Addition Port Charlotte
418	0954 14 2816	Mandrake Terrace	Lot 16 Block 1428 29th Addition Port Charlotte
419	0954 14 2817	Mandrake Terrace	Lot 17 Block 1428 29th Addition Port Charlotte
420	0954 14 2818	Mandrake Terrace	Lot 18 Block 1428 29th Addition Port Charlotte
421	0954 14 2819	Mandrake Terrace	Lot 19 Block 1428 29th Addition Port Charlotte
422	0954 14 2820	Mandrake Terrace	Lot 20 Block 1428 29th Addition Port Charlotte
423	0954 14 2821	Mandrake Terrace	Lot 21 Block 1428 29th Addition Port Charlotte
424	0954 14 2822	Mandrake Terrace	Lot 22 Block 1428 29th Addition Port Charlotte
425	0954 14 2901	Balsam Street	Lot 1 Block 1429 29th Addition Port Charlotte
426	0954 14 2922	Vernell Street	Lot 22 Block 1429 29th Addition Port Charlotte
427	0954 14 2923	Mandrake Terrace	Lot 23 Block 1429 29th Addition Port Charlotte
428	0954 14 2924	Mandrake Terrace	Lot 24 Block 1429 29th Addition Port Charlotte
429	0954 14 2925	Mandrake Terrace	Lot 25 Block 1429 29th Addition Port Charlotte
430	0954 14 2926	Mandrake Terrace	Lot 26 Block 1429 29th Addition Port Charlotte
431	0954 14 2927	Mandrake Terrace	Lot 27 Block 1429 29th Addition Port Charlotte
432	0954 14 2928	Mandrake Terrace	Lot 28 Block 1429 29th Addition Port Charlotte
433	0954 14 2929	Mandrake Terrace	Lot 29 Block 1429 29th Addition Port Charlotte
434	0954 14 2930	Mandrake Terrace	Lot 30 Block 1429 29th Addition Port Charlotte
435	0954 14 2931	Mandrake Terrace	Lot 31 Block 1429 29th Addition Port Charlotte
436	0954 14 2932	Mandrake Terrace	Lot 32 Block 1429 29th Addition Port Charlotte
437	0953 15 1641	Henrietta Avenue	Lot 41 Block 1516 30th Addition Port Charlotte
438	0953 15 1642	Hennessy Street	Lot 42 Block 1516 30th Addition Port Charlotte
439	0953 15 1643	Hennessy Street	Lot 43 Block 1516 30th Addition Port Charlotte
440	0953 15 1644	Hennessy Street	Lot 44 Block 1516 30th Addition Port Charlotte
441	0953 15 1645	Hennessy Street	Lot 45 Block 1516 30th Addition Port Charlotte
442	0953 15 1646	Hennessy Street	Lot 46 Block 1516 30th Addition Port Charlotte
443	0953 15 1647	Hennessy Street	Lot 47 Block 1516 30th Addition Port Charlotte
444	0953 15 1648	Hennessy Street	Lot 48 Block 1516 30th Addition Port Charlotte
445	0953 15 1649	Hennessy Street	Lot 49 Block 1516 30th Addition Port Charlotte
446	0953 15 1650	Hennessy Street	Lot 50 Block 1516 30th Addition Port Charlotte
447	0953 15 1651	Hennessy Street	Lot 51 Block 1516 30th Addition Port Charlotte
448	0953 15 1652	Hennessy Street	Lot 52 Block 1516 30th Addition Port Charlotte
449	0953 15 1653	Hennessy Street	Lot 53 Block 1516 30th Addition Port Charlotte
450	0953 15 1654	Hennessy Street	Lot 54 Block 1516 30th Addition Port Charlotte

Exhibit A
Myakkahatchee Creek Corridor
Proejct Area

No	PID	Street Name	LEGAL1
451	0953 15 1655	Hennessy Street	Lot 55 Block 1516 30th Addition Port Charlotte
452	0953 15 1656	Hennessy Street	Lot 56 Block 1516 30th Addition Port Charlotte
453	0953 15 1657	Hennessy Street	Lot 57 Block 1516 30th Addition Port Charlotte
454	0953 15 1658	Hennessy Street	Lot 58 Block 1516 30th Addition Port Charlotte
455	0953 15 1659	Hennessy Street	Lot 59 Block 1516 30th Addition Port Charlotte
456	0953 15 1660	Hennessy Street	Lot 60 Block 1516 30th Addition Port Charlotte
457	0953 15 1661	Hennessy Street	Lot 61 Block 1516 30th Addition Port Charlotte
458	0953 15 1662	Hennessy Street	Lot 62 Block 1516 30th Addition Port Charlotte
459	0953 15 1663	Hennessy Street	Lot 63 Block 1516 30th Addition Port Charlotte
460	0953 15 2008	Henrietta Avenue	Lot 8 Block 1520 30th Addition Port Charlotte
461	0953 15 2009	Henrietta Avenue	Lot 9 Block 1520 30th Addition Port Charlotte
462	0953 15 2010	Hennessy Street	Lot 10 Block 1520 30th Addition Port Charlotte
463	0953 15 2011	Haddaway Avenue	Lot 11 Block 1520 30th Addition Port Charlotte
464	0953 15 2012	Haddaway Avenue	Lot 12 Block 1520 30th Addition Port Charlotte
465	0953 15 2108	Hackley Road	Lot 8 Block 1521 30th Addition Port Charlotte
466	0953 15 2109	Hackley Road	Lot 9 Block 1521 30th Addition Port Charlotte
467	0953 15 2110	Hennessy Street	Lot 10 Block 1521 30th Addition Port Charlotte
468	0953 15 2111	Hennessy Street	Lot 11 Block 1521 30th Addition Port Charlotte
469	0953 15 2112	Haddaway Avenue	Lot 12 Block 1521 30th Addition Port Charlotte
470	0953 15 2210	Haas Avenue	Lot 10 Block 1522 30th Addition Port Charlotte
471	0953 15 2211	Hennessy Street	Lot 11 Block 1522 30th Addition Port Charlotte
472	0953 15 2212	Hennessy Street	Lot 12 Block 1522 30th Addition Port Charlotte
473	0953 15 2213	Hackley Road	Lot 13 Block 1522 30th Addition Port Charlotte
474	0953 15 2312	Griggs Avenue	Lot 12 Block 1523 30th Addition Port Charlotte
475	0953 15 2313	Hennessy Street	Lot 13 Block 1523 30th Addition Port Charlotte
476	0953 15 2314	Hennessy Street	Lot 14 Block 1523 30th Addition Port Charlotte
477	0953 15 2315	Haas Avenue	Lot 15 Block 1523 30th Addition Port Charlotte
478	0953 15 2414	Hennessy Street	Lot 14 Block 1524 30th Addition Port Charlotte
479	0953 15 2415	Griggs Avenue	Lot 15 Block 1524 30th Addition Port Charlotte
480	0953 15 2415	Griggs Avenue	Lot 16 Block 1524 30th Addition Port Charlotte
481	0953 15 2627	Hennessy Street	Lot 27 Block 1526 30th Addition Port Charlotte
482	0953 15 2711	Kalish Avenue	Lot 11 Block 1527 31st Addition Port Charlotte
483	0953 15 2712	Kalish Avenue	Lot 12 Block 1527 31st Addition Port Charlotte
484	0953 15 2713	Lacey Street	Lot 13 Block 1527 31st Addition Port Charlotte
485	0953 15 2714	Lacey Street	Lot 14 Block 1527 31st Addition Port Charlotte
486	0953 15 2715	Lacey Street	Lot 15 Block 1527 31st Addition Port Charlotte
487	0953 15 2716	Lacey Street	Lot 16 Block 1527 31st Addition Port Charlotte
488	0953 15 2717	Lacey Street	Lot 17 Block 1527 31st Addition Port Charlotte
489	0953 15 2718	Lacey Street	Lot 18 Block 1527 31st Addition Port Charlotte
490	0953 15 2719	Lacey Street	Lot 19 Block 1527 31st Addition Port Charlotte
491	0953 15 2720	Lacey Street	Lot 20 Block 1527 31st Addition Port Charlotte
492	0953 15 2721	Lacey Street	Lot 21 Block 1527 31st Addition Port Charlotte
493	0953 15 2722	Lacey Street	Lot 22 Block 1527 31st Addition Port Charlotte
494	0953 15 2723	Lacey Street	Lot 23 Block 1527 31st Addition Port Charlotte
495	0953 15 2724	Lacey Street	Lot 24 Block 1527 31st Addition Port Charlotte
496	0953 15 2725	Lacey Street	Lot 25 Block 1527 31st Addition Port Charlotte
497	0953 15 2726	Lacey Street	Lot 26 Block 1527 31st Addition Port Charlotte
498	0944 15 2727	Lacey Street	Lot 27 Block 1527 31st Addition Port Charlotte
499	0944 15 2728	Lacey Street	Lot 28 Block 1527 31st Addition Port Charlotte
500	0944 15 2728	Lacey Street	Lot 29 Block 1527 31st Addition Port Charlotte

Exhibit A
Myakkahatchee Creek Corridor
Proejct Area

No	PID	Street Name	LEGAL1
501	0942 15 2730	Lacey Street	Lot 30 Block 1527 31st Addition Port Charlotte
502	0942 15 2731	Lacey Street	Lot 31 Block 1527 31st Addition Port Charlotte
503	0942 15 2732	Lacey Street	Lot 32 Block 1527 31st Addition Port Charlotte
504	0942 15 2733	Lacey Street	Lot 33 Block 1527 31st Addition Port Charlotte
505	0942 15 2734	Lacey Street	Lot 34 Block 1527 31st Addition Port Charlotte
506	0942 15 2735	Lacey Street	Lot 35 Block 1527 31st Addition Port Charlotte
507	0942 15 2736	Lacey Street	Lot 36 Block 1527 31st Addition Port Charlotte
508	0953 15 2801	Lacey Street	Lot 1 Block 1528 31st Addition Port Charlotte
509	0953 15 2820	Kalish Avenue	Lot 20 Block 1528 31st Addition Port Charlotte
510	0953 15 2821	Lacey Street	Lot 21 Block 1528 31st Addition Port Charlotte
511	0953 15 2901	Lacey Street	Lot 1 Block 1529 31st Addition Port Charlotte
512	0953 15 2924	Nutmeg Avenue	Lot 24 Block 1529 31st Addition Port Charlotte
513	0953 15 3001	Lacey Street	Lot 1 Block 1530 31st Addition Port Charlotte
514	0953 15 3017	Jeming Road	Lot 17 Block 1530 31st Addition Port Charlotte
515	0953 15 3018	Lacey Street	Lot 18 Block 1530 31st Addition Port Charlotte
516	0953 15 3101	Lacey Street	Lot 1 Block 1531 31st Addition Port Charlotte
517	0955 15 3102	Lacey Street	Lot 2 Block 1531 31st Addition Port Charlotte
518	0955 15 3103	Lacey Street	Lot 3 Block 1531 31st Addition Port Charlotte
519	0955 15 3104	Ibson Lane	Lot 4 Block 1531 31st Addition Port Charlotte
520	0942 15 3201	Lacey Street	Lot 1 Block 1532 31st Addition Port Charlotte
521	0942 15 3226	Ibson Lane	Lot 26 Block 1532 31st Addition Port Charlotte
522	0942 15 3301	Inks Lane	Lot 1 Block 1533 31st Addition Port Charlotte
523	0942 15 3329	Inks Lane	Lot 29 Block 1533 31st Addition Port Charlotte

City of North Port



Myakkahatchee Creek Corridor Project Area

GARRISON AVE

REISTERSTOWN RD

REISTERSTOWN RD

HENNESSY ST

GADBOYS AVE

GRIGGS AVE

HAAS AVE

HAFTEL ST

HACKLEY RD

HADDAWAY AVE

HENRIETTA AVE

JENSLEY AVE

JEMING RD

NUTMEG AVE

KALISH AVE

TRACT A

HABLOW LN

350N LN

N SUMTER BLVD

N 175



175 RAMP

TRACT A

Legend
Myakkahatchee Creek Corridor Project Area

E h b t A
M p P g 1 f 3

S 175

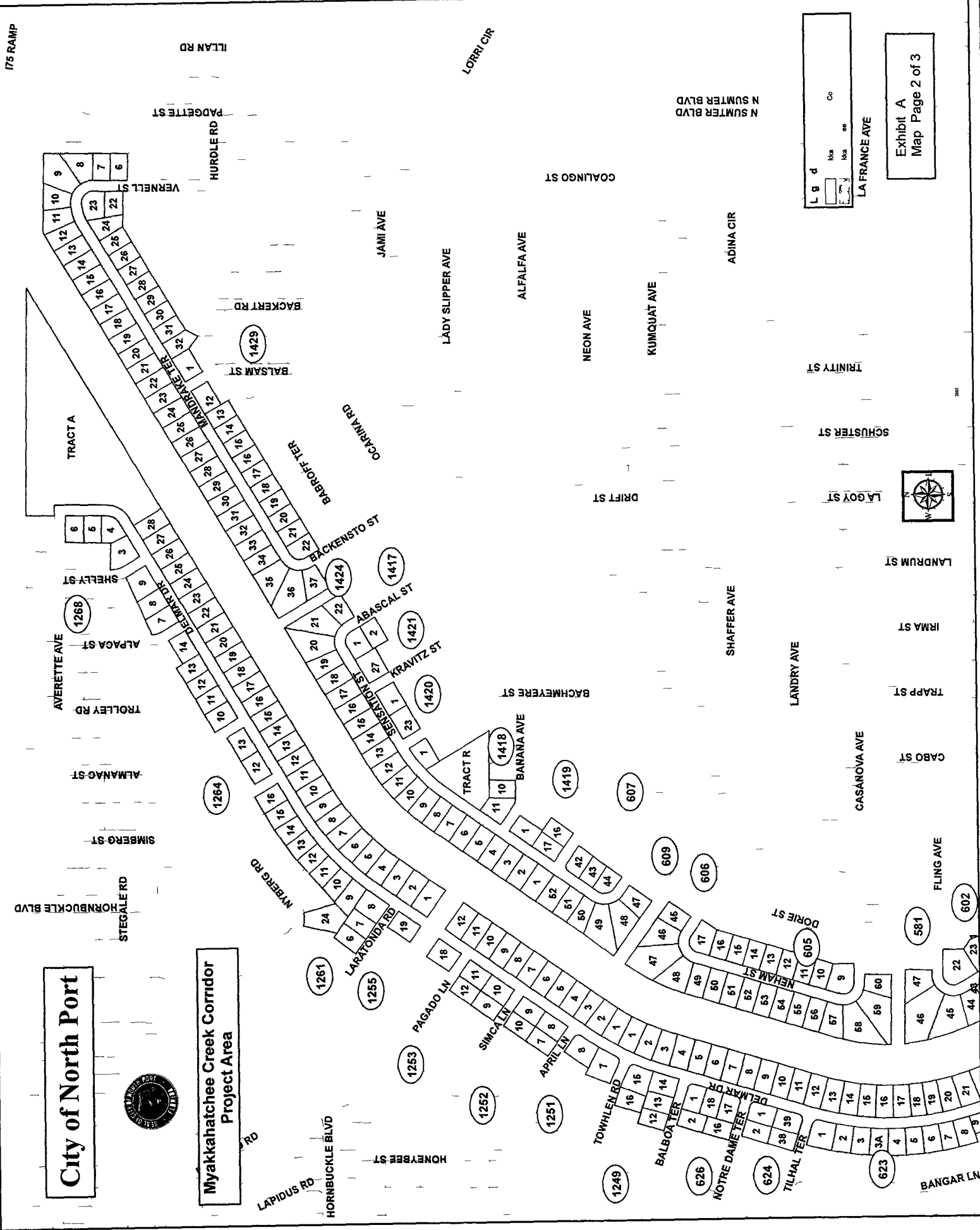

City of North Port

My k k h t o h C r e k C r i d
P J c t A r e a



E h b A
M p p 3 13



City Hall Blvd

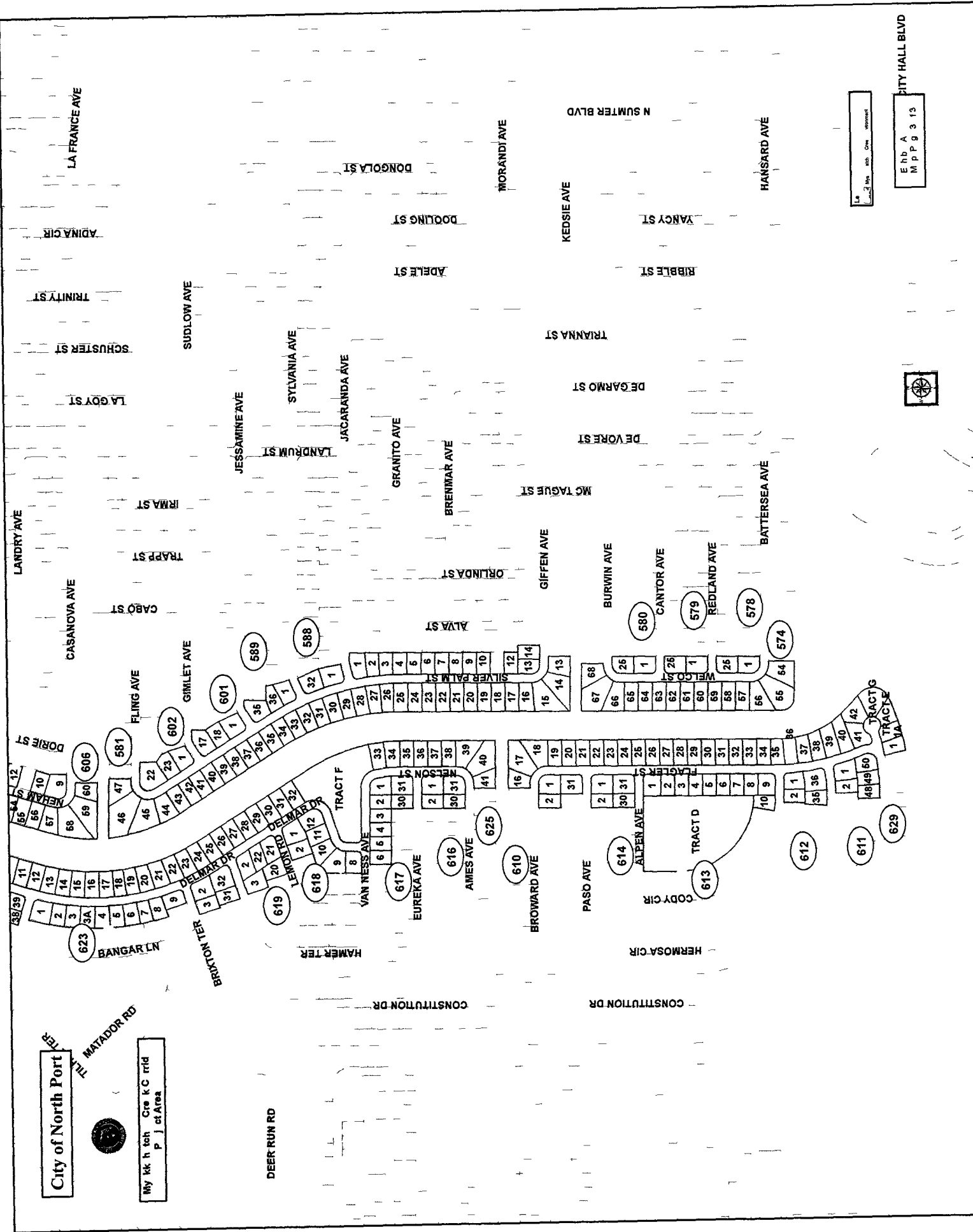

EXHIBIT B

**Lots and Tracts to be Acquired
Myakkahatchee Creek Corridor Project Area
April 2007**

Exhibit B
Myakkahatchee Creek Corridor Project Area
Acquisition Lots and Tracts

No	PID	Street Address	Short Legal Description
1	0968 05 7468	Burwin Avenue	Lot 68 Block 574 18th Addition Port Charlotte
2	0968 05 7801	Battersea Avenue	Lot 1 Block 578 18th Addition Port Charlotte
3	0968 05 7825	Redland Avenue	Lot 25 Block 578 18th Addition Port Charlotte
4	0968 05 7901	Redland Avenue	Lot 1 Block 579 18th Addition Port Charlotte
5	0968 05 7925	Cantor Avenue	Lot 25 Block 579 18th Addition Port Charlotte
6	0968 05 8001	Cantor Avenue	Lot 1 Block 580 18th Addition Port Charlotte
7	0968 05 8025	Burwin Avenue	Lot 25 Block 580 18th Addition Port Charlotte
8	0967 05 8147	Fling Avenue	Lot 47 Block 581 18th Addition Port Charlotte
9	0968 05 8201	Cabbage Palm Street	Lot 1 Block 582 18th Addition Port Charlotte
10	0968 05 8202	Cabbage Palm Street	Lot 2 Block 582 18th Addition Port Charlotte
11	0968 05 8203	Cabbage Palm Street	Lot 3 Block 582 18th Addition Port Charlotte
12	0968 05 8204	Cabbage Palm Street	Lot 4 Block 582 18th Addition Port Charlotte
13	0968 05 8205	Cabbage Palm Street	Lot 5 Block 582 18th Addition Port Charlotte
14	0968 05 8206	Cabbage Palm Street	Lot 6 Block 582 18th Addition Port Charlotte
15	0968 05 8207	Cabbage Palm Street	Lot 7 Block 582 18th Addition Port Charlotte
16	0968 05 8208	Cabbage Palm Street	Lot 8 Block 582 18th Addition Port Charlotte
17	0968 05 8209	Cabbage Palm Street	Lot 9 Block 582 18th Addition Port Charlotte
18	0968 05 8210	Cabbage Palm Street	Lot 10 Block 582 18th Addition Port Charlotte
19	0968 05 8211	Cabbage Palm Street	Lot 11 Block 582 18th Addition Port Charlotte
20	0968 05 8212	Cabbage Palm Street	Lot 12 Block 582 18th Addition Port Charlotte
21	0968 05 8213	Giffen Avenue	Lot 13 Block 582 18th Addition Port Charlotte
22	0968 05 8214	Giffen Avenue	Lot 14 Block 582 18th Addition Port Charlotte
23	0968 05 8801	Jacaranda Avenue	Lot 1 Block 588 18th Addition Port Charlotte
24	0967 05 8832	Sylvania Avenue	Lot 32 Block 588 18th Addition Port Charlotte
25	0967 05 8901	Silver Palm Street	Lot 1 Block 589 18th Addition Port Charlotte
26	0967 05 8936	Silver Palm Street	Lot 36 Block 589 18th Addition Port Charlotte
27	0967 06 0101	Jessamine Avenue	Lot 1 Block 601 18th Addition Port Charlotte
28	0967 06 0118	Silver Palm Street	Lot 18 Block 601 18th Addition Port Charlotte
29	0967 06 0201	Gimlet Avenue	Lot 1 Block 602 18th Addition Port Charlotte
30	0967 06 0222	Fling Avenue	Lot 22 Block 602 18th Addition Port Charlotte
31	0967 06 0223	Silver Palm Street	Lot 23 Block 602 18th Addition Port Charlotte
32	0967 06 0509	Neham Street	Lot 9 Block 605 18th Addition Port Charlotte
33	0967 06 0510	Neham Street	Lot 10 Block 605 18th Addition Port Charlotte
34	0967 06 0513	Dorie Street	Lot 13 Block 605 18th Addition Port Charlotte
35	0967 06 0514	Neham Street	Lot 14 Block 605 18th Addition Port Charlotte
36	0967 06 0515	Neham Street	Lot 15 Block 605 18th Addition Port Charlotte
37	0967 06 0516	Neham Street	Lot 16 Block 605 18th Addition Port Charlotte
38	0967 06 0517	Neham Street	Lot 17 Block 605 18th Addition Port Charlotte
39	0967 06 0645	Shaffer Avenue	Lot 45 Block 606 18th Addition Port Charlotte
40	0967 06 0660	Casanova Avenue	Lot 60 Block 606 18th Addition Port Charlotte
41	0954 06 0742	Sensation Street	Lot 42 Block 607 18th Addition Port Charlotte
42	0967 06 0743	Sensation Street	Lot 43 Block 607 18th Addition Port Charlotte
43	0967 06 0744	Kumquat Avenue	Lot 44 Block 607 18th Addition Port Charlotte
44	0967 06 0947	Kumquat Avenue	Lot 47 Block 609 18th Addition Port Charlotte
45	0968 06 1014	Broward Avenue	Lot 16 Block 610 14th Addition Port Charlotte Replat
46	0977 06 1041	Flagler Street	Lot 41 Block 610 14th Addition Port Charlotte Replat
47	0977 06 1101	Hermosa Circle	Lot 1 Block 611 14th Addition Port Charlotte Replat
48	0977 06 1102	Hermosa Circle	Lot 2 Block 611 14th Addition Port Charlotte Replat
49	0977 06 1148	Constitution Court	Lot 48 Block 611 14th Addition Port Charlotte Replat
50	0977 06 1149	Constitution Court	Lot 49 Block 611 14th Addition Port Charlotte Replat

Exhibit B
Myakkahatchee Creek Corridor Project Area
Acquisition Lots and Tracts

No	PID	Street Address	Short Legal Description
51	0977 06 1150	Constitution Court	Lot 50 Block 611 14th Addition Port Charlotte Replat
52	0977 06 1201	Cody Circle	Lot 1 Block 612 14th Addition Port Charlotte 1st Replat
53	0977 06 1202	Cody Circle	Lot 2 Block 612 14th Addition Port Charlotte Replat
54	0977 06 1235	Hermosa Circle	Lot 35 Block 612 14th Addition Port Charlotte Replat
55	0977 06 1235	Hermosa Circle	Lot 36 Block 612 14th Addition Port Charlotte Replat
56	0968 06 1301	Flagler Street	Lot 1 Block 613 14th Addition Port Charlotte Replat
57	0968 06 1302	Flagler Street	Lot 2 Block 613 14th Addition Port Charlotte Replat
58	0968 06 1303	Flagler Street	Lot 3 Block 613 14th Addition Port Charlotte Replat
59	0968 06 1304	Flagler Street	Lot 4 Block 613 14th Addition Port Charlotte Replat
60	0968 06 1305	Flagler Street	Lot 5 Block 613 14th Addition Port Charlotte Replat
61	0968 06 1306	Flagler Street	Lot 6 Block 613 14th Addition Port Charlotte Replat
62	0968 06 1306	Flagler Street	Lot 7 Block 613 14th Addition Port Charlotte Replat
63	0968 06 1308	Flagler Street	Lot 8 Block 613 14th Addition Port Charlotte Replat
64	0968 06 1309	Flagler Street	Lot 9 Block 613 14th Addition Port Charlotte Replat
65	0968 06 1310	Cody Circle	Lot 10 Block 613 14th Addition Port Charlotte Replat
66	0968 06 1322	Alpen Avenue	Tract D Block 613 14th Addition Port Charlotte Replat
67	0968 06 1401	Paso Avenue	Lot 1 Block 614 14th Addition Toport Charlotte Replat
68	0968 06 1401	Paso Avenue	Lot 2 Block 614 14th Addition Toport Charlotte Replat
69	0968 06 1430	Alpen Avenue	Lot 30 Block 614 14th Addition Port Charlotte Replat
70	0968 06 1431	N/A	Lot 31 Block 614 14th Addition Port Charlotte Replat
71	0968 06 1501	Broward Avenue	Lot 1 Block 615 14th Addition Port Charlotte Replat
72	0968 06 1502	Broward Avenue	Lot 2 Block 615 14th Addition Port Charlotte Replat Of A Portion
73	0968 06 1531	Paso Avenue	Lot 31 Block 615 14th Addition Port Charlotte Replat
74	0968 06 1601	Eureka Avenue	Lot 1 Block 616 14th Addition Port Charlotte Replat
75	0968 06 1602	Eureka Avenue	Lot 2 Block 616 14th Addition Port Charlotte Replat
76	0968 06 1630	Ames Avenue	Lot 30 Block 616 14th Addition Port Charlotte Replat
77	0968 06 1631	Ames Avenue	Lot 31 Block 616 14th Addition Port Charlotte Replat
78	0968 06 1701	Van Ness Avenue	Lot 1 Block 617 14th Addition Port Charlotte Replat
79	0968 06 1701	Van Ness Avenue	Lot 2 Block 617 14th Addition Port Charlotte Replat
80	0968 06 1701	Van Ness Avenue	Lot 3 Block 617 14th Addition Port Charlotte Replat
81	0970 06 1704	Van Ness Avenue	Lot 4 Block 617 14th Addition Port Charlotte Replat
82	0970 06 1704	Van Ness Avenue	Lot 5 Block 617 14th Addition Port Charlotte Replat
83	0970 06 1706	Van Ness Avenue	Lot 6 Block 617 14th Addition Port Charlotte Replat
84	0968 06 1730	Eureka Avenue	Lot 30 Block 617 14th Addition Port Charlotte Replat
85	0968 06 1731	Eureka Avenue	Lot 31 Block 617 14th Addition Port Charlotte Replat
86	0969 06 1801	Lemon Road	Lot 1 Block 618 14th Addition Port Charlotte Replat
87	0969 06 1802	Lemon Road	Lot 2 Block 618 14th Addition Port Charlotte Replat
88	0970 06 1808	Delmar Drive	Lot 8 Block 618 14th Addition Port Charlotte Replat
89	0970 06 1809	Delmar Drive	Lot 9 Block 618 14th Addition Port Charlotte Replat
90	0970 06 1810	Delmar Drive	Lot 10 Block 618 14th Addition Port Charlotte Replat
91	0969 06 1811	Delmar Drive	Lot 11 Block 618 14th Addition Port Charlotte Replat
92	0967 06 1812	Delmar Drive	Lot 12 Block 618 14th Addition Port Charlotte Replat
93	0969 06 1902	Hamer Terrace	Lot 2 Block 619 14th Addition Port Charlotte Replat
94	0969 06 1903	Hamer Terrace	Lot 3 Block 619 14th Addition Port Charlotte Replat
95	0969 06 1920	Lemon Road	Lot 20 Block 619 14th Addition Port Charlotte Replat
96	0969 06 1902	Hamer Terrace	Lot 21 Block 619 14th Addition Port Charlotte Replat
97	0969 06 1902	Hamer Terrace	Lot 22 Block 619 14th Addition Port Charlotte Replat
98	0969 06 2002	Brixton Terrace	Lot 2 Block 620 14th Addition Port Charlotte Replat
99	0969 06 2003	Brixton Terrace	Lot 3 Block 620 14th Addition Port Charlotte Replat
100	0969 06 2031	Hamer Terrace	Lot 31 Block 620 14th Addition Port Charlotte Replat

Exhibit B
Myakkahatchee Creek Corridor Project Area
Acquisition Lots and Tracts

No	PID	Street Address	Short Legal Description
101	0969 06 2032	Hamer Terrace	Lot 32 Block 620 14th Addition Port Charlotte Replat
102	0969 06 2301	Delmar Drive	Lot 1 Block 623 14th Addition Port Charlotte Replat
103	0969 06 2302	Delmar Drive	Lot 2 Block 623 14th Addition Port Charlotte Replat
104	0969 06 2303	Delmar Drive	Lot 3 Block 623 14th Addition Port Charlotte Replat
105	0969 06 2304	Delmar Drive	Lot 4 Block 623 14th Addition Port Charlotte Replat
106	0969 06 2305	Delmar Drive	Lot 5 Block 623 14th Addition Port Charlotte Replat
107	0969 06 2306	Delmar Drive	Lot 6 Block 623 14th Addition Port Charlotte Replat
108	0969 06 2306	Delmar Drive	Lot 7 Block 623 14th Addition Port Charlotte Replat
109	0969 06 2308	Delmar Drive	Lot 8 Block 623 14th Addition Port Charlotte Replat
110	0969 06 2309	Brixton Terrace	Lot 9 Block 623 14th Addition Port Charlotte Replat
111	0969 06 2321	Delmar Drive	Lot 3a Block 623 14th Addition Port Charlotte Replat
112	0969 06 2401	Notre Dame Terrace	Lot 1 Block 624 14th Addition Port Charlotte Replat
113	0969 06 2402	Notre Dame Terrace	Lot 2 Block 624 14th Addition Port Charlotte Replat
114	0969 06 2438	Tilhal Terrace	Lot 38 Block 624 14th Addition Port Charlotte Replat
115	0969 06 2439	Tilhal Terrace	Lot 39 Block 624 14th Addition Port Charlotte Replat
116	0968 06 2541	Ames Avenue	Lot 41 Block 625 14th Addition Port Charlotte Replat
117	0969 06 2601	Balboa Terrace	Lot 1 Block 626 14th Addition Port Charlotte Replat
118	0969 06 2602	Balboa Terrace	Lot 2 Block 626 14th Addition Port Charlotte Replat
119	0969 06 2616	Notre Dame Terrace	Lot 16 Block 626 14th Addition Port Charlotte Replat
120	0969 06 2617	Notre Dame Terrace	Lot 17 Block 626 14th Addition Port Charlotte Replat
121	0969 06 2618	Notre Dame Terrace	Lot 18 Block 626 14th Addition Port Charlotte Replat
122	0969 12 4912	Balboa Terrace	Lot 12 Block 1249 27th Addition Port Charlotte
123	0969 12 4913	Balboa Terrace	Lot 13 Block 1249 27th Addition Port Charlotte
124	0969 12 4914	Balboa Terrace	Lot 14 Block 1249 27th Addition Port Charlotte
125	0969 12 4915	Towhlen Road	Lot 15 Block 1249 27th Addition Port Charlotte
126	0969 12 4916	Towhlen Road	Lot 16 Block 1249 27th Addition Port Charlotte
127	0969 12 5107	Ponce De Leon Blvd	Lot 7 Less Wly 20 Block 1251 27th Addition Port Charlotte
128	0952 12 5108	April Lane	Lot 8 Block 1251 27th Addition Port Charlotte
129	0952 12 5207	April Lane	Lot 7 Block 1252 27th Addition Port Charlotte
130	0954 12 5208	Delmar Drive	Lot 8 Block 1252 27th Addition Port Charlotte
131	0954 12 5209	Simca Lane	Lot 9 Block 1252 27th Addition Port Charlotte
132	0954 12 5210	Simca Lane	Lot 10 Block 1252 27th Addition Port Charlotte
133	0954 12 5309	Simca Lane	Lot 9 Block 1253 27th Addition Port Charlotte
134	0954 12 5310	Delmar Drive	Lot 10 Block 1253 27th Addition Port Charlotte
135	0954 12 5311	Pagado Lane	Lot 11 Block 1253 27th Addition Port Charlotte
136	0954 12 5312	Pagado Lane	Lot 12 Block 1253 27th Addition Port Charlotte
137	0954 12 5518	Delmar Drive	Lot 18 Block 1255 27th Addition Port Charlotte
138	0954 12 5519	Laratonda Road	Lot 19 Block 1255 27th Addition Port Charlotte
139	0954 12 6106	Laratonda Road	Lot 6 Block 1261 27th Addition Port Charlotte
140	0954 12 6107	Laratonda Road	Lot 7 Block 1261 27th Addition Port Charlotte
141	0954 12 6108	Delmar Drive	Lot 8 Block 1261 27th Addition Port Charlotte
142	0954 12 6111	Delmar Drive	Lot 11 Block 1261 27th Addition Port Charlotte
143	0954 12 6112	Delmar Drive	Lot 12 Block 1261 27th Addition Port Charlotte
144	0954 12 6113	Delmar Drive	Lot 13 Block 1261 27th Addition Port Charlotte
145	0954 12 6114	Delmar Drive	Lot 14 Block 1261 27th Addition Port Charlotte
146	0954 12 6115	Delmar Drive	Lot 15 Block 1261 27th Addition Port Charlotte
147	0954 12 6116	Simberg Street	Lot 16 Block 1261 27th Addition Port Charlotte
148	0954 12 6124	Laratonda Road	Lot 24 Block 1261 27th Addition Port Charlotte
149	0954 12 6412	Delmar Drive	Lot 12 Block 1264 27th Addition Port Charlotte
150	0954 12 6413	Almanac Street	Lot 13 Block 1264 27th Addition Port Charlotte

Exhibit B
Myakkahatchee Creek Corridor Project Area
Acquisition Lots and Tracts

No	PID	Street Address	Short Legal Description
151	0954 12 6711	Delmar Drive	Lot 11 Block 1267 27th Addition Port Charlotte
152	0954 12 6712	Delmar Drive	Lot 12 Block 1267 27th Addition Port Charlotte
153	0954 12 6713	Delmar Drive	Lot 13 Block 1267 27th Addition Port Charlotte
154	0954 12 6714	Alpaca Street	Lot 14 Block 1267 27th Addition Port Charlotte
155	0954 12 6808	Delmar Drive	Lot 8 Block 1268 27th Addition Port Charlotte
156	0954 12 6905	Delmar Drive	Lot 5 Block 1269 27th Addition Port Charlotte
157	0954 12 6906	Averette Avenue	Lot 6 Block 1269 27th Addition Port Charlotte
158	0954 14 1801	Bachmeyere Street	Lot 1 Block 1418 29th Addition Port Charlotte
159	0954 14 1812	Sensation Street	Tract R 29th Addition Port Charlotte
160	0954 14 1901	Sensation Street	Lot 1 Block 1419 29th Addition Port Charlotte
161	0954 14 2001	Kravitz Street	Lot 1 Block 1420 29th Addition Port Charlotte
162	0954 14 2023	Sensation Street	Lot 23 Block 1420 29th Addition Port Charlotte
163	0954 14 2127	Sensation Street	Lot 27 Block 1421 29th Addition Port Charlotte
164	0954 14 2406	Vernell Street	Lot 6 Block 1424 29th Addition Port Charlotte
165	0954 14 2407	Vernell Street	Lot 7 Block 1424 29th Addition Port Charlotte
166	0954 14 2408	Vernell Street	Lot 8 Block 1424 29th Addition Port Charlotte
167	0954 14 2433	Mandrake Terrace	Lot 33 Block 1424 29th Addition Port Charlotte
168	0954 14 2437	Backensto Street	Lot 37 Block 1424 29th Addition Port Charlotte
169	0954 14 2812	Balsam Street	Lot 12 Block 1428 29th Addition Port Charlotte
170	0954 14 2814	Mandrake Terrace	Lot 14 Block 1428 29th Addition Port Charlotte
171	0954 14 2815	Mandrake Terrace	Lot 15 Block 1428 29th Addition Port Charlotte
172	0954 14 2816	Mandrake Terrace	Lot 16 Block 1428 29th Addition Port Charlotte
173	0954 14 2817	Mandrake Terrace	Lot 17 Block 1428 29th Addition Port Charlotte
174	0954 14 2818	Mandrake Terrace	Lot 18 Block 1428 29th Addition Port Charlotte
175	0954 14 2819	Mandrake Terrace	Lot 19 Block 1428 29th Addition Port Charlotte
176	0954 14 2820	Mandrake Terrace	Lot 20 Block 1428 29th Addition Port Charlotte
177	0954 14 2821	Mandrake Terrace	Lot 21 Block 1428 29th Addition Port Charlotte
178	0954 14 2822	Mandrake Terrace	Lot 22 Block 1428 29th Addition Port Charlotte
179	0954 14 2901	Balsam Street	Lot 1 Block 1429 29th Addition Port Charlotte
180	0954 14 2922	Vernell Street	Lot 22 Block 1429 29th Addition Port Charlotte
181	0954 14 2923	Mandrake Terrace	Lot 23 Block 1429 29th Addition Port Charlotte
182	0954 14 2924	Mandrake Terrace	Lot 24 Block 1429 29th Addition Port Charlotte
183	0954 14 2927	Mandrake Terrace	Lot 27 Block 1429 29th Addition Port Charlotte
184	0954 14 2931	Mandrake Terrace	Lot 31 Block 1429 29th Addition Port Charlotte
185	0954 14 2932	Mandrake Terrace	Lot 32 Block 1429 29th Addition Port Charlotte
186	0953 15 1641	Henrietta Avenue	Lot 41 Block 1516 30th Addition Port Charlotte
187	0953 15 2008	Henrietta Avenue	Lot 8 Block 1520 30th Addition Port Charlotte
188	0953 15 2009	Henrietta Avenue	Lot 9 Block 1520 30th Addition Port Charlotte
189	0953 15 2010	Hennessy Street	Lot 10 Block 1520 30th Addition Port Charlotte
190	0953 15 2011	Haddaway Avenue	Lot 11 Block 1520 30th Addition Port Charlotte
191	0953 15 2012	Haddaway Avenue	Lot 12 Block 1520 30th Addition Port Charlotte
192	0953 15 2108	Hackley Road	Lot 8 Block 1521 30th Addition Port Charlotte
193	0953 15 2109	Hackley Road	Lot 9 Block 1521 30th Addition Port Charlotte
194	0953 15 2112	Haddaway Avenue	Lot 12 Block 1521 30th Addition Port Charlotte
195	0953 15 2210	Haas Avenue	Lot 10 Block 1522 30th Addition Port Charlotte
196	0953 15 2213	Hackley Road	Lot 13 Block 1522 30th Addition Port Charlotte
197	0953 15 2312	Griggs Avenue	Lot 12 Block 1523 30th Addition Port Charlotte
198	0953 15 2313	Hennessy Street	Lot 13 Block 1523 30th Addition Port Charlotte
199	0953 15 2314	Hennessy Street	Lot 14 Block 1523 30th Addition Port Charlotte
200	0953 15 2315	Haas Avenue	Lot 15 Block 1523 30th Addition Port Charlotte

Exhibit B
Myakkahatchee Creek Corridor Project Area
Acquisition Lots and Tracts

No	PID	Street Address	Short Legal Description
201	0953 15 2415	Griggs Avenue	Lot 15 Block 1524 30th Addition Port Charlotte
202	0953 15 2415	Griggs Avenue	Lot 16 Block 1524 30th Addition Port Charlotte
203	0953 15 2711	Kalish Avenue	Lot 11 Block 1527 31st Addition Port Charlotte
204	0953 15 2712	Kalish Avenue	Lot 12 Block 1527 31st Addition Port Charlotte
205	0953 15 2801	Lacey Street	Lot 1 Block 1528 31st Addition Port Charlotte
206	0953 15 2820	Kalish Avenue	Lot 20 Block 1528 31st Addition Port Charlotte
207	0953 15 2821	Lacey Street	Lot 21 Block 1528 31st Addition Port Charlotte
208	0953 15 2901	Lacey Street	Lot 1 Block 1529 31st Addition Port Charlotte
209	0953 15 2924	Nutmeg Avenue	Lot 24 Block 1529 31st Addition Port Charlotte
210	0953 15 3001	Lacey Street	Lot 1 Block 1530 31st Addition Port Charlotte
211	0953 15 3017	Jeming Road	Lot 17 Block 1530 31st Addition Port Charlotte
212	0953 15 3018	Lacey Street	Lot 18 Block 1530 31st Addition Port Charlotte
213	0953 15 3101	Lacey Street	Lot 1 Block 1531 31st Addition Port Charlotte
214	0955 15 3102	Lacey Street	Lot 2 Block 1531 31st Addition Port Charlotte
215	0955 15 3103	Lacey Street	Lot 3 Block 1531 31st Addition Port Charlotte
216	0955 15 3104	Ibson Lane	Lot 4 Block 1531 31st Addition Port Charlotte
217	0942 15 3201	Lacey Street	Lot 1 Block 1532 31st Addition Port Charlotte
218	0942 15 3226	Ibson Lane	Lot 26 Block 1532 31st Addition Port Charlotte
219	0942 15 3329	Inks Lane	Lot 29 Block 1533 31st Addition Port Charlotte

City of North Port



Myakkahatchee Creek Corridor Acquisition Project Area

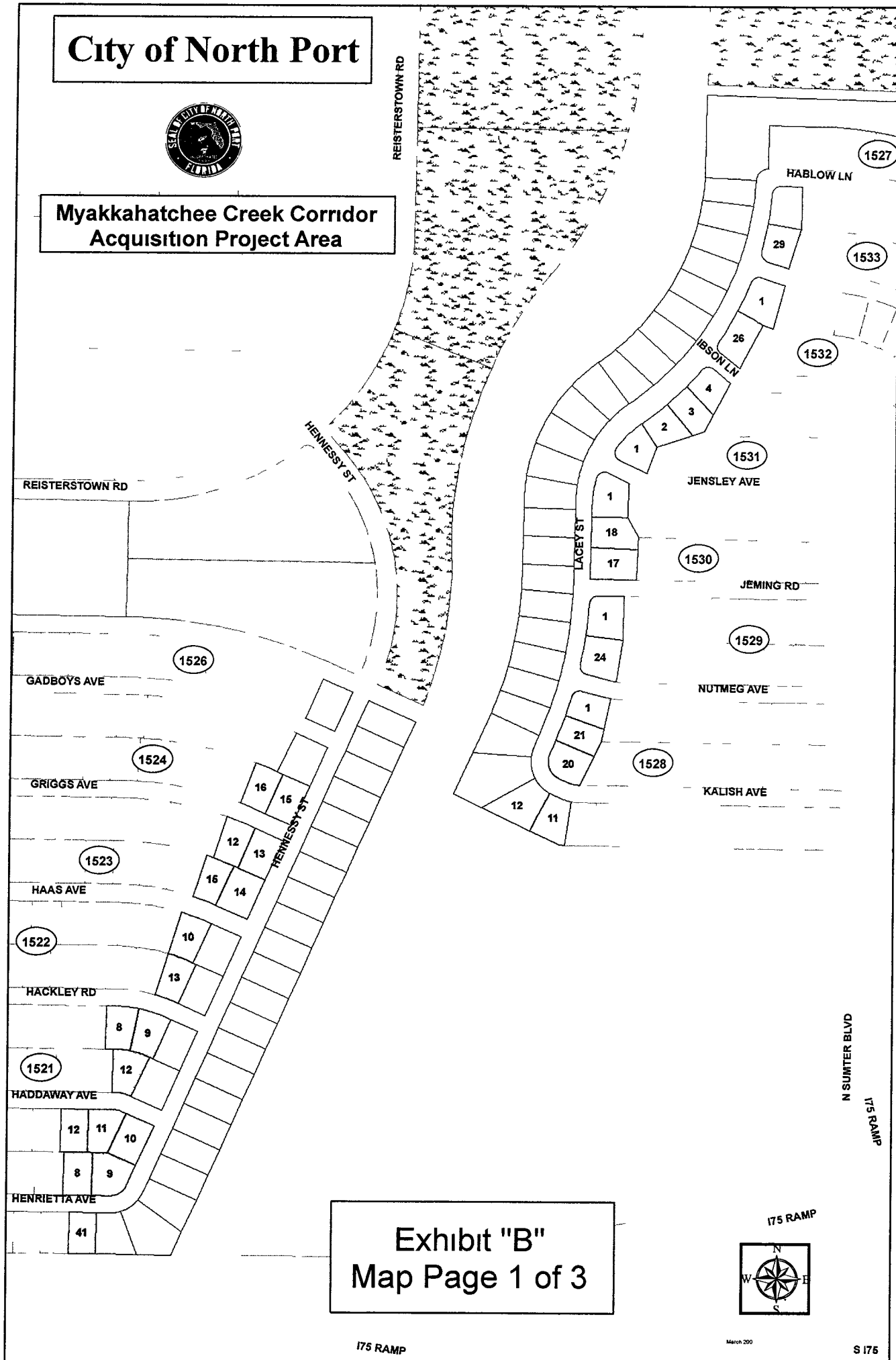

Exhibit "B"
Map Page 1 of 3

City of North Port

Myakkahatchee Creek Corridor Acquisition Project Area



N 175

175 RAMP

Exhibit "B"
Map Page 2 of 3



Page

City of North Port

Myakkahtatchee Creek Corridor
Acquisition Project Area

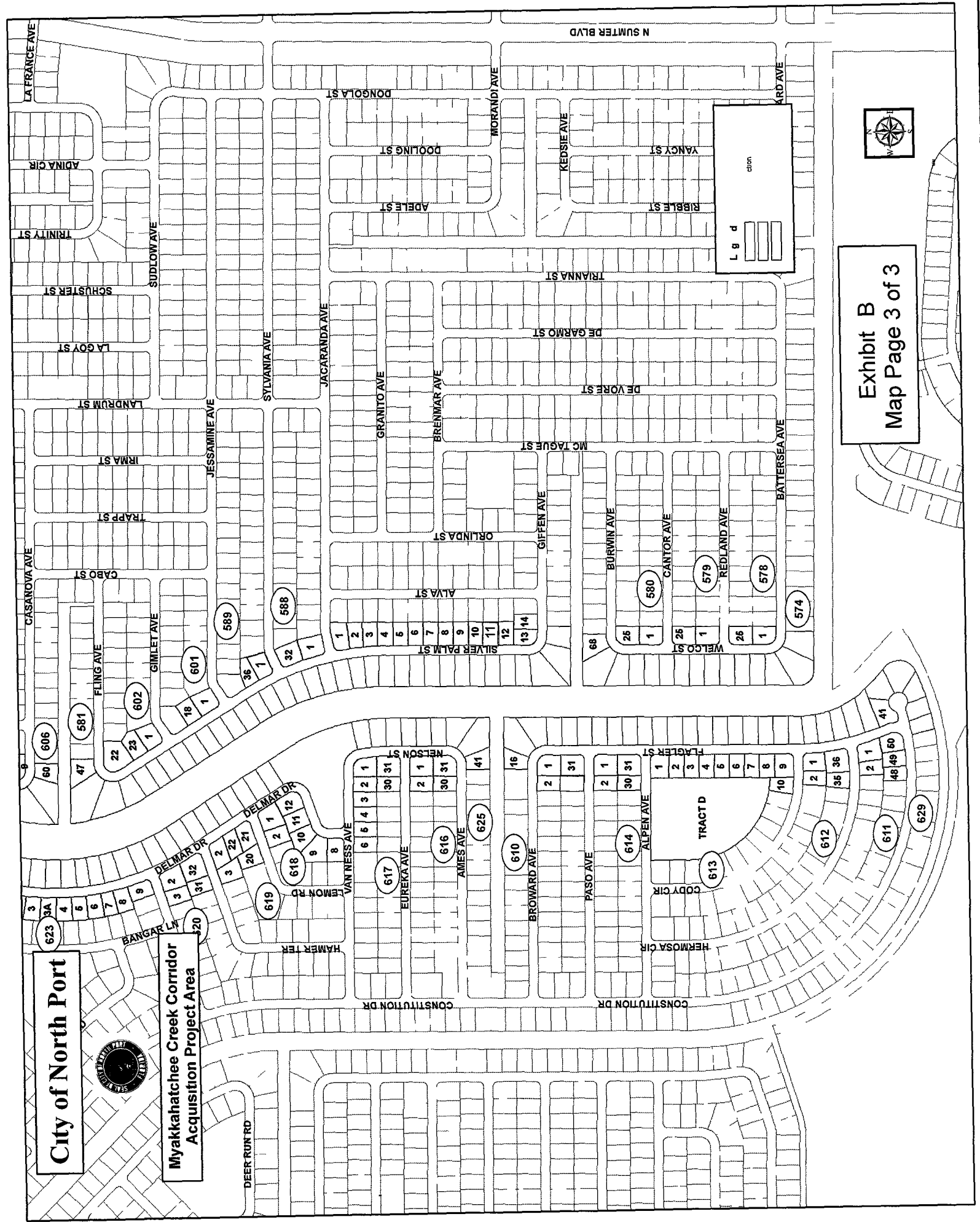

Exhibit B
Map Page 3 of 3