

Attachment

H

**CITY OF NORTH PORT
COMMISSION AGENDA ITEM**

Item No. 7 B
(City Clerk's Use Only)

MEETING TYPE: Regular <input checked="" type="checkbox"/> Fire Rescue District <input type="checkbox"/> Road & Drainage District <input type="checkbox"/> Solid Waste District <input type="checkbox"/> Other: <input type="checkbox"/>	Meeting Date: September 12, 2011 Department: General Services / Parks & Recreation Division Prepared by: Sherry Borgsdorf Date Prepared: August 30, 2011 Department Director's Initials: <i>SB</i> Date: 9/2/11 City Manager's Initials: <i>gd</i> Date: 9/2/11
Exhibits: 1. Opinion of Probable Cost for Construction 2. Summary of Revenue/Expense and corresponding Millage Rate 3. Draft Design Concepts (4): Base and Options A, B & C	
SUBJECT: Conceptual plans for the 50-meter pool facility to be located at Butler Park.	
RECOMMENDED ACTION: Commission direction on the base pool design and alternatives that would be put out for competitive bid.	
BACKGROUND INFORMATION: On June 13, 2011 the City Commission authorized the City Manager to enter into Agreement #2011-08 with Kimley-Horn and Associates for Professional Architectural/Engineering Services in the amount of \$400,000 for the Butler Park 50-meter pool/aquatic facility. Further, Commission directed the consultant and staff to develop and bring back multiple design concepts and costs associated with the construction and operation of each type of facility. To date several meetings and teleconferences have been held between City staff, and professionals from Kimley-Horn, Counsilman-Hunsaker, and Wannamacher Jensen Architects, along with representatives from the North Port High School swim team and Sarasota Family YMCA. Attached for your review and discussion are four design concepts, an opinion of probable cost for each, an analysis of estimated revenues/expenses for the first year along with a corresponding millage rate as a reference point. Representatives from Kimley-Horn and Counsilman-Hunsaker will attend the September 12th regular meeting to present more detail and respond to questions.	
FINANCIAL IMPACT: (if applicable) Budgeted funds: \$4, 300,000 (primarily surtax monies) Estimated construction costs: \$3,650,000 to \$5,600,000 depending on options Estimated operating cashflow (Revenues – Expenses): (\$178,036) to (\$135,847) depending on options	
PROCUREMENT: (if applicable) <input type="checkbox"/> Amendment <input type="checkbox"/> Assignments <input type="checkbox"/> New Contract <input type="checkbox"/> Renewal Contract <input type="checkbox"/> Other	
Vendor Information:	
Contract Amount: \$ Contingency: \$ Total Contract Amount: \$	

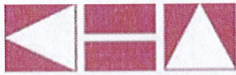

Butler Park 50 Meter Pool
North Port, Florida

Basic Pool w/ Options A, B, and C - Opinion of Probable Cost

8/25/2011

BASE BID

Item	Unit	Quantity	Cost	Item Cost
50 Meter x 25 Yard Competition Pool w/ Bulkhead	SF	12,625	\$135.00	\$1,704,375.00
Gas Pool Heaters	LS	1	\$50,000.00	\$50,000.00
20' Diameter Cool Brellas	EA	2	\$6,000.00	\$12,000.00
Grading, Site Preparation, Dewatering	LS	1	\$75,000.00	\$75,000.00
Bath House Building (w/ Large Overhangs/Pavilion)	SF	3,800	\$200.00	\$760,000.00
Filtration Building	LS	1,200	\$125.00	\$150,000.00
Onsite Utilities and Drainage Allowance	LS	1	\$50,000.00	\$50,000.00
Site Lighting/Electrical Allowance	LS	1	\$75,000.00	\$75,000.00
5" Concrete Pool Deck	SF	17,900	\$7.00	\$125,300.00
4" Concrete Sidewalk	SF	3,300	\$5.00	\$16,500.00
Perimeter Fencing (96" Tubular Steel)	LF	615	\$80.00	\$49,200.00
Bleachers and Shade Canopies	EA	2	\$10,000.00	\$20,000.00
Landscape and Irrigation Allowance	LS	1	\$50,000.00	\$50,000.00
Site Furnishings Allowance	LS	1	\$10,000.00	\$10,000.00
Contingency Allowance	LS	1	\$80,000.00	\$80,000.00
Subtotal				\$3,227,375.00
Indirect Costs (Topo, Geo-tech, Engineering)	LS	1	\$400,000.00	\$400,000.00
Total				\$3,627,375.00
Total Basic 50M Pool Costs				\$3,650,000.00
Water Sprayground w/ Additional Deck, Fence, Etc.	LS	1	\$250,000.00	\$250,000.00
Total 50M Pool Costs w/ Water Sprayground -Option A				\$3,900,000.00
Leisure Pool w/Additional Deck, Fence, Shade, Etc.	LS	1	\$750,000.00	\$750,000.00
Waterslide for Leisure Pool	LS	1	\$150,000.00	\$150,000.00
Total 50M Pool Costs w/ Water Sprayground & Leisure Pool -Option B				\$4,800,000.00
AA#1 Play Structure for Leisure Pool Add Cost	LS	1	\$250,000.00	\$250,000.00
AA#2 Geo-thermal Add Cost	LS	1	\$140,000.00	\$140,000.00
AA#3 Regenerative Media Filtration System Add Cost	LS	1	\$90,000.00	\$90,000.00
AA #4 Stainless Steel Pool System Add Cost	LS	1	\$320,000.00	\$320,000.00
Total 50M Pool Costs w/ Water Sprayground & Leisure Pool & Alternates-Option C				\$5,600,000.00

Estimated Annual Expense

	<u>Amount</u>	<u>Millage Rate Needed</u>
Basic 50M Pool		
Construction Cost	\$3,650,000	
Attendance	33,808	
Revenue	\$280,665	
Expense	\$458,701	0.2049
Operating Cashflow	(\$178,036)	0.0795
Recapture Rate	61%	
Capital Replacement Fund	\$18,300	
Total Annual Expense	<u>(\$196,336)</u>	0.0877
A: 50M Pool w/Sprayground		
Construction Cost	\$3,900,000	
Attendance	35,499	
Revenue	\$288,849	
Expense	\$464,216	0.2073
Operating Cashflow	(\$175,367)	0.0783
Recapture Rate	62%	
Capital Replacement Fund	\$19,500	
Total Annual Expense	<u>(\$194,867)</u>	0.0870
B: 50M Pool w/Leisure Pool		
Construction Cost	\$4,800,000	
Attendance	55,023	
Revenue	\$391,592	
Expense	\$548,776	0.2451
Operating Cashflow	(\$157,183)	0.0702
Recapture Rate	71%	
Capital Replacement Fund	\$24,000	
Total Annual Expense	<u>(\$181,183)</u>	0.0809
C: 50M Pool w/Leisure Pool & Alternates		
Construction Cost	\$5,600,000	
Attendance	55,023	
Revenue	\$391,592	
Expense	\$527,440	0.2356
Operating Cashflow	(\$135,847)	0.0606
Recapture Rate	74%	
Capital Replacement Fund	\$21,000	
Total Annual Expense	<u>(\$156,847)</u>	0.0700

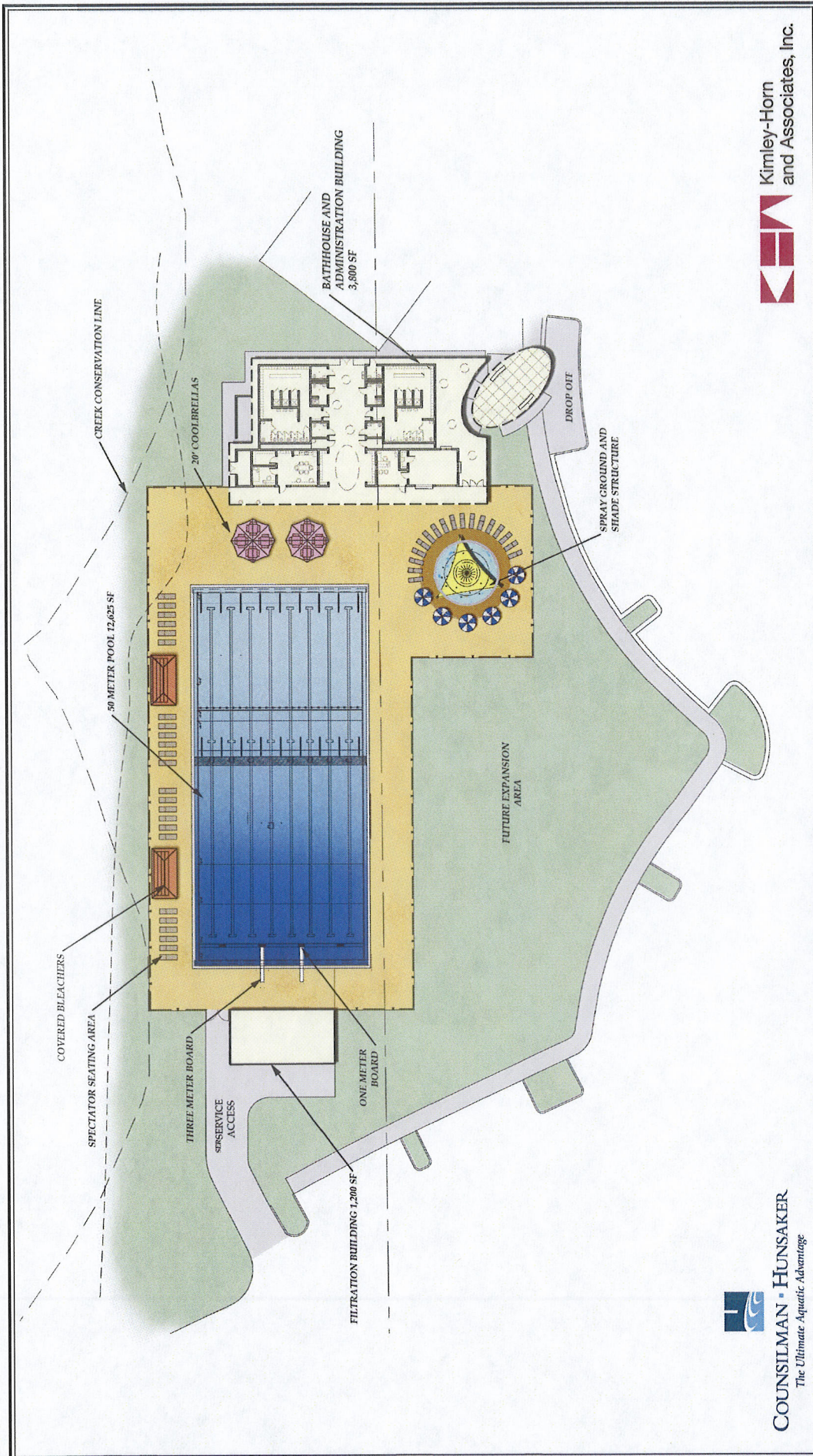

Kimley-Horn and Associates, Inc.

COUNSILMAN • HUNSAKER
The Ultimate Aquatic Advantage

SCALE: IN FEET
0 10 20 40
N

Butler Park - 50 Meter Pool

50 M Pool w/ Water Sprayground - Option A



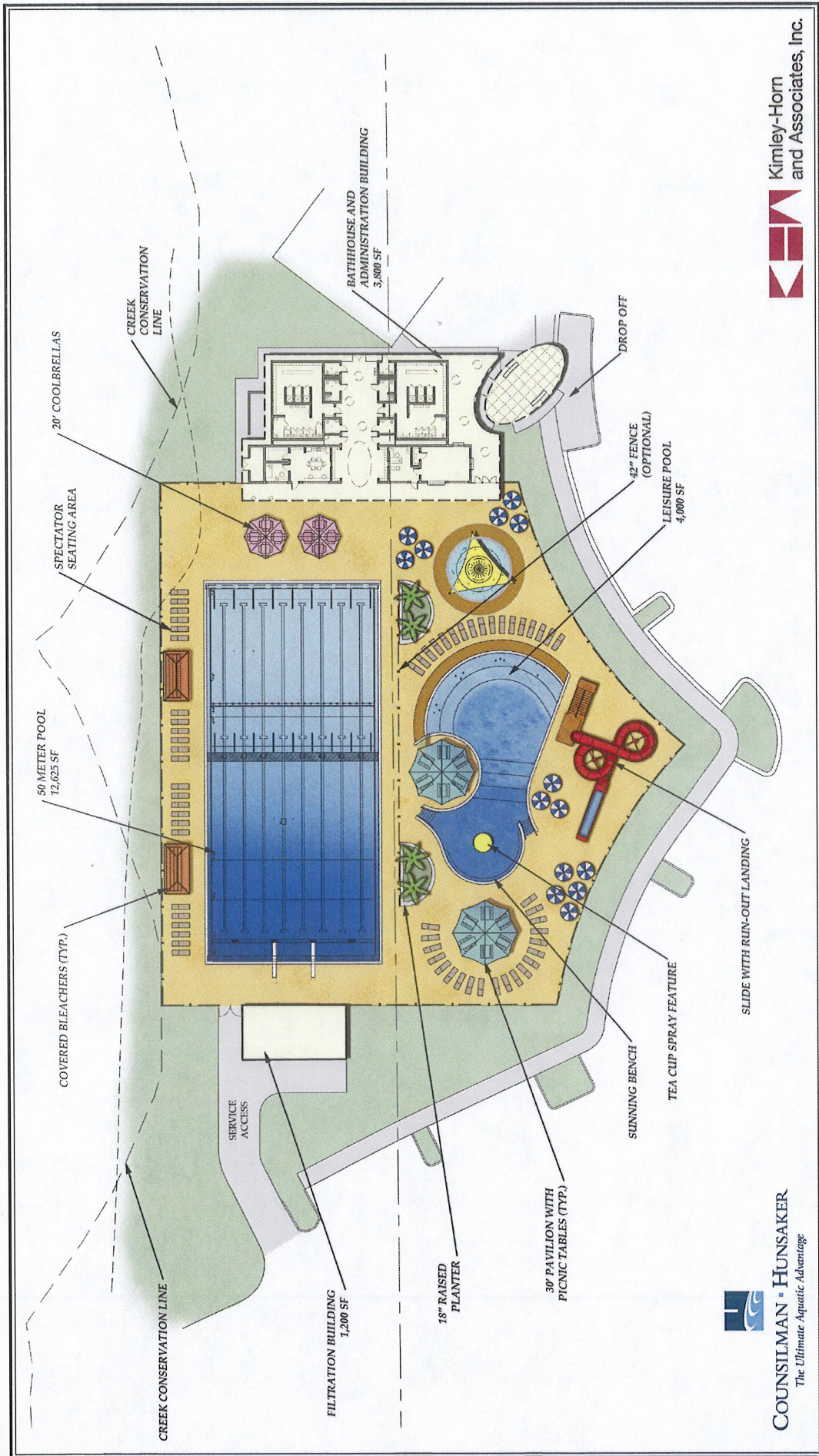

Kimley-Horn and Associates, Inc.

COUNSILMAN • HUNSAKER
The Ultimate Aquatic Advantage

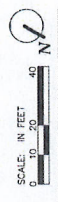

Butler Park - 50 Meter Pool

50 M Pool w/ Sprayground & Leisure Pool - Option B



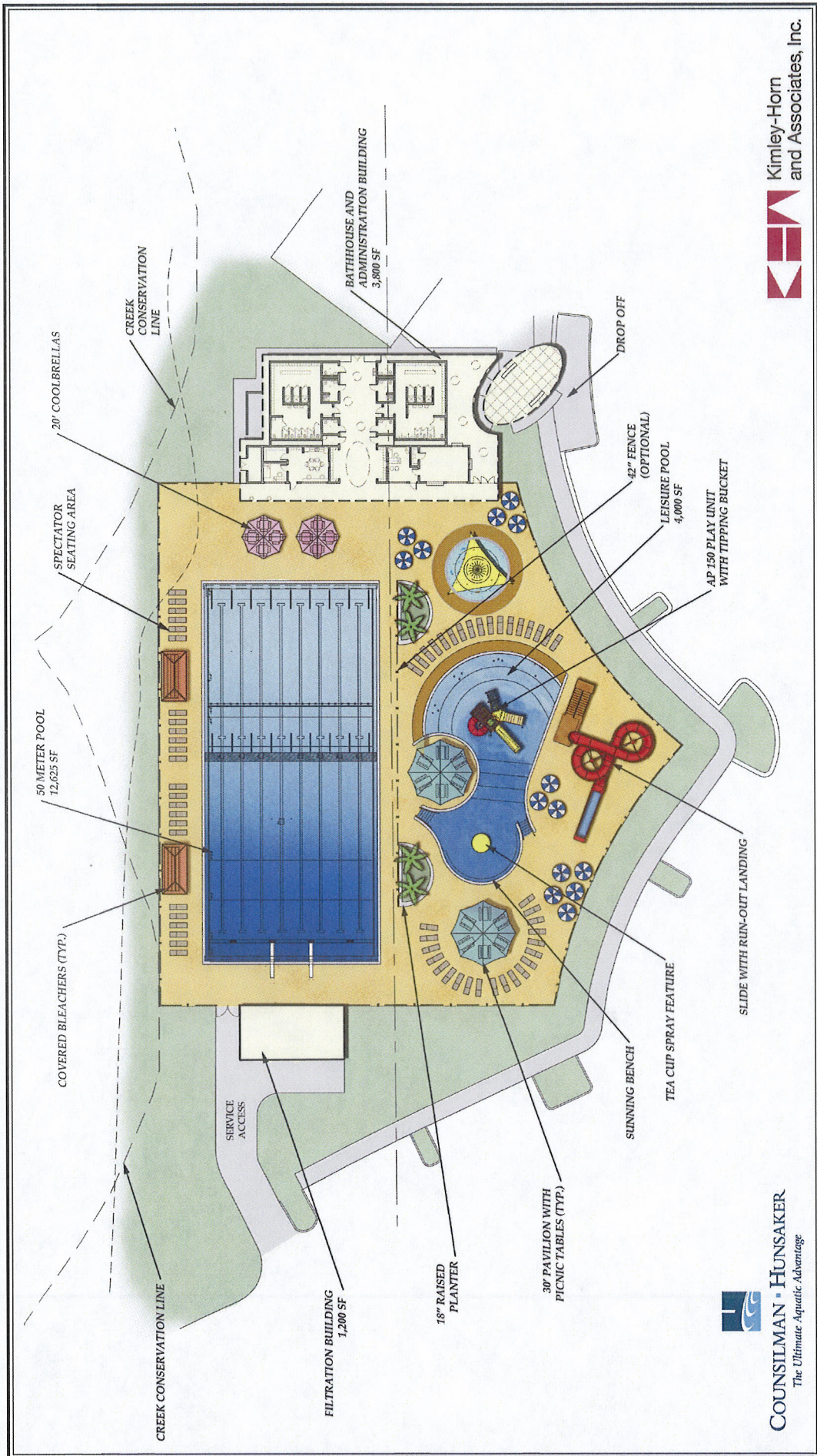

Kimley-Horn and Associates, Inc.

COUNSILMAN • HUNSAKER
The Ultimate Aquatic Advantage

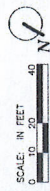

Butler Park - 50 Meter Pool

50 M Pool w/ Sprayground, Leisure Pool, & Alternates - Option C



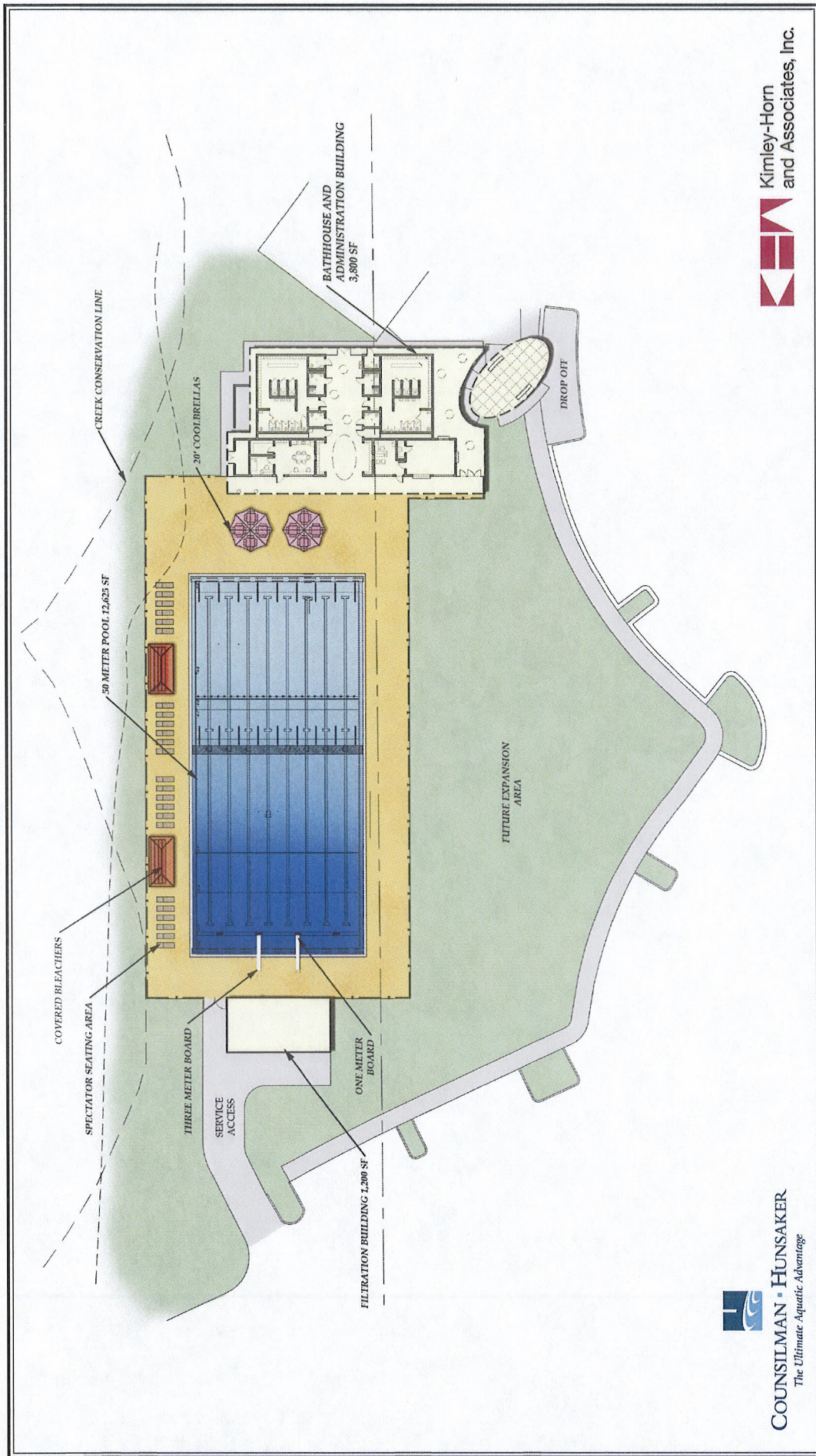

COUNSILMAN • HUNSAKER
The Ultimate Aquatic Advantage

Kimley-Horn and Associates, Inc.



Butler Park - 50 Meter Pool

Basic 50 M Pool

