

Architectural & Engineering Services

Public Safety Training Complex City of North Port, Florida

Request for Proposal No. 2024-17

February 13, 2024

Due 2:00 p.m.



j12 Architecture, LLC

Johnnie Lohrum Jr, President
407.340.2879
jlohrum@j12architecture.com

"COPY"

Architectural & Engineering Services

Public Safety Training Complex City of North Port, Florida

Request for Proposal No. 2024-17

February 13, 2024

Due 2:00 p.m.



j|2 Architecture, LLC

Johnnie Lohrum Jr, President

407.340.2879

jlohrum@j|2architecture.com

PROTECT & SERVE

TABLE OF CONTENTS



TAB 1 TRANSMITTAL LETTER

TAB 2 DOCUMENTS

- a. Licenses and Certifications
- b. Resumes
- c. Project Approach
- d. Schedule Timeline
- e. Additional Information

TAB 3 TEAM'S PREVIOUS EXPERIENCE/ PROFICIENCY IN SIMILAR PROJECTS

- a. Example Projects

TAB 4 REFERENCES / CLIENT LISTING

- a. Attachment C
- b. Attachment D

TAB 5 LITIGATION AND INSURANCE

TAB 6 CITY REQUIRED FORMS

- a. Required Forms Checklist
- b. Attachment A
- c. Attachment B
- d. Attachment C--See Tab 4
- e. Attachment D--See Tab 4
- f. Attachment E
- g. Attachment F
- h. Attachment G
- i. Attachment H
- j. Attachment I
- k. Attachment J
- l. Attachment K
- m. Attachment L
- n. Sample Insurance Certificate
- o. MBE/WBE/VBE



PROTECT & SERVE

TRANSMITTAL LETTER

1



TRANSMITTAL LETTER

Subject: Public Safety Training Complex - RFP 2024-17

February 13, 2024
City of North Port
Finance Department
4970 City Hall Boulevard
North Port, FL 34286

Dear Members of the Selection Committee,

We are grateful for the opportunity to submit our qualifications for your Public Safety Training Complex. **The j12 Architecture Team approach is to bring an unparalleled strong partnership of the most qualified Public Safety Architects and local Engineers with a longstanding legacy of design excellence in the City of North Port.**

Our team's project experience has informed the way we think about Law Enforcement projects. We view Law Enforcement planning and design through an Operations-based, function-focused "lens". We believe efficient and effective operations can best be planned for and achieved when we understand the duties and related tasks that each unit of the Police and Fire Departments will perform on a daily basis. Our "day in the life" method of communicating with Police and Fire staff who will be using the facility, has allowed us to design more efficient and mission-oriented facilities. This approach allows the client to get more 'value for money' than any other approach. When we provide a facility design for the Public Safety Complex, we believe it will enable the staff to be more efficient and effective in carrying out their assigned duties. **The j12 Architecture Team of designers & engineers have completed more than 400 public safety facilities including 40+ Police Training and 15+ Fire Training Facilities.** We are passionate about public safety work and have a strong desire to continue our relationship with the City of North Port. We are uniquely qualified for your Public Safety Training Complex project and have the passion to help you bring your vision to life by offering:

UNDERSTANDING OF YOUR NEEDS

What truly separates the **j12 Architecture Team** from the others is our understanding of the City's needs. We have participated in the growth of the community and have been a part of the ideas and solutions that make this City what it is today. At the same time, we have also experienced the pains of growth, politics, and aging infrastructure. As these challenges have appeared, we have been proud to be a part of the solutions for many of them. Public Safety is arguably the highest priority of the government. North Port's police, fire and emergency operations are some of the very best in the state. However, the facilities that are needed

to maintain this high level of service must be improved. We are keenly aware of the City's needs as a result of our prior work on the new Police and Fire Facilities. **We propose to use this information as a baseline to initiate your new Public Safety Training Complex Project. See the additional information section of this proposal for a draft conceptual facility program.**

LAW ENFORCEMENT EXPERTISE

The j12 Architecture Team has included MWL as a design partner for the pursuit of this project. MWL is a nationally recognized design firm with a substantial amount of public safety experience. **Both Mr. Johnnie Lohrum (President of j12 Architecture) and MWL worked as a partner to the City of North Port, to help bring to life, your planning and design vision for the new North Port Police Facilities.**

With planning work in 42 states and Canada and a resume of hundreds of law enforcement projects, MWL is defining the leading edge of law enforcement planning and is dedicated to addressing constantly changing technologies and always evolving operational models. Johnnie Lohrum Jr. (j12 Architecture), Project Manager / President has been working with MWL for over a decade and will use his passion to guide & manage the day to day requirements of the project, ensuring your goals are met. The combination of j12, MWL & the rest of our consultants will ensure you get the dedicated design & engineering staff required to properly complete your project.

DEDICATED & EXPERIENCED LOCAL TEAM

Further enhancing the team we have included a myriad of local designers & engineers who are intimately familiar with the City of North Port such as our dedicated Civil Engineer, AM Engineering, who is currently working on your main Police Facility. Your new facility will also require highly technical security, MEP and systems requirements so we have included OCI & associates, also currently working on your main Police Facility and have completed millions of sf of public safety & municipal projects all over the state of Florida. Our team also includes BBM Structural Engineers whose experience with essential facilities is unparalleled in the state of Florida. **This very same team has worked together on recent local projects such as the University of Florida Public Safety Complex, City of DeLand Fire Station 81 & Police Evidence Building, Cape Coral's new Police Training Facility, Charlotte County Sheriff Training Facility, City of Ocoee Police Training Facility, and the Daytona Beach Fire Administration Headquarters.**

PROTECT & SERVE

TRANSMITTAL LETTER

Subject: Public Safety Training Complex - RFP 2024-17

MASTER PLANNING

Our team has a significant amount of experience master planning Law Enforcement facilities. We will work closely with the City and our Civil Engineer utilizing CPTED and CALEA standards to develop a site layout that responds to the surrounding community and helps to set up the appropriate public & private zones that a project of this nature requires. **In fact, as previously mentioned, AM engineering has an intimate knowledge of your site.**

FISCAL RESPONSIBILITY

We recognize the importance of doing right by the taxpayers and know how to design quality facilities that are efficient, functional and cost effective. We will utilize our in-house cost database, work closely with your selected Construction Manager as well as our estimator (KMI) to check the project's budget status at every milestone and ensure your vision is met while staying on or under budget. **Our team also includes an experienced Grant Writer who is familiar with specific grant opportunities for your project and will be dedicated to off-setting your design/construction costs.**

Our team understands your goals and mission for the project. Our goal is to provide a team that "partners" with the City of North Port to create a facility that meets your vision and goals and helps you continue leading the state as examples of how to protect and serve our community. **We know you are working with some great firms on your large, time and resource exhausting Police Facility. We greatly appreciate and thank you for considering our proposal for this important project and respectfully ask that you select a firm that is going to give you that personal touch and dedicated attention that this project deserves.**

Sincerely,

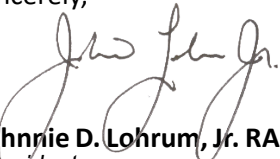

Johnnie D. Lohrum, Jr. RA, LEED® AP (Contact Person)
President

1678 Kingston Road, Longwood FL, 32750
407.340.2879 | jlohrum@jl2architecture.com



PROTECT & SERVE

DOCUMENTS

2

9

10

11

DOCUMENTS

Licenses and Certifications



[Department of State](#) / [Division of Corporations](#) / [Search Records](#) / [Search by Entity Name](#) /

Detail by Entity Name

Florida Limited Liability Company
JL2 ARCHITECTURE, LLC

Filing Information

Document Number L22000495247
FE/EIN Number NONE
Date Filed 11/21/2022
State FL
Status ACTIVE

Principal Address

1678 KINGSTON ROAD
LONGWOOD, FL 32750

Mailing Address

1678 KINGSTON ROAD
LONGWOOD, FL 32750

Registered Agent Name & Address

LOHRUM, JOHNNIE D, JR.
1678 KINGSTON ROAD
LONGWOOD, FL 32750

Authorized Person(s) Detail

Name & Address

Title MR.

LOHRUM, JOHNNIE D, JR.
1678 KINGSTON ROAD
LONGWOOD, FL 32750

Annual Reports

No Annual Reports Filed

Electronic Articles of Organization For Florida Limited Liability Company

L22000495247
FILED 8:00 AM
November 21, 2022
Sec. Of State
jafason

Article I

The name of the Limited Liability Company is:
JL2 ARCHITECTURE, LLC

Article II

The street address of the principal office of the Limited Liability Company is:
1678 KINGSTON ROAD
LONGWOOD, FL, US 32750

The mailing address of the Limited Liability Company is:
1678 KINGSTON ROAD
LONGWOOD, FL, US 32750

Article III

The name and Florida street address of the registered agent is:
JOHNNIE D LOHRUM JR.
1678 KINGSTON ROAD
LONGWOOD, FL. 32750

Having been named as registered agent and to accept service of process for the above stated limited liability company at the place designated in this certificate, I hereby accept the appointment as registered agent and agree to act in this capacity. I further agree to comply with the provisions of all statutes relating to the proper and complete performance of my duties, and I am familiar with and accept the obligations of my position as registered agent.

Registered Agent Signature: JOHNNIE D LOHRUM JR.

State of Florida Department of State

I certify the attached is a true and correct copy of the Articles of Organization of JL2 ARCHITECTURE, LLC, a limited liability company organized under the laws of the state of Florida, filed electronically on November 21, 2022, as shown by the records of this office.

I further certify that this is an electronically transmitted certificate authorized by section 15.16, Florida Statutes, and authenticated by the code noted below.

The document number of this limited liability company is L22000495247.

Authentication Code: 221128112716-600397970426#1

Given under my hand and the
Great Seal of the State of Florida
at Tallahassee, the Capital, this the
Twenty Eighth day of November, 2022



Cord Byrd
Secretary of State

PROTECT & SERVE

DOCUMENTS

Licenses and Certifications

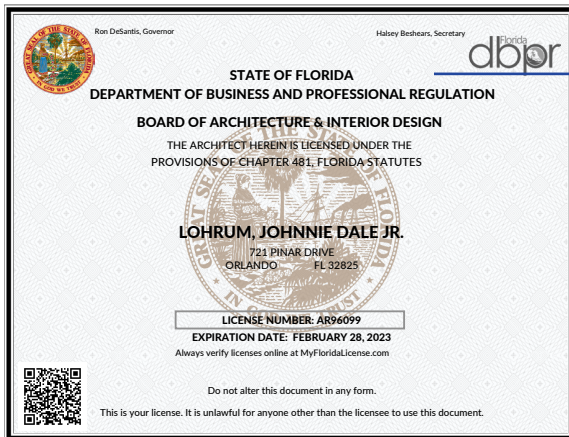

Johnnie Lohrum Jr., RA, LEED AP
President / Project Manager
j|2Architecture

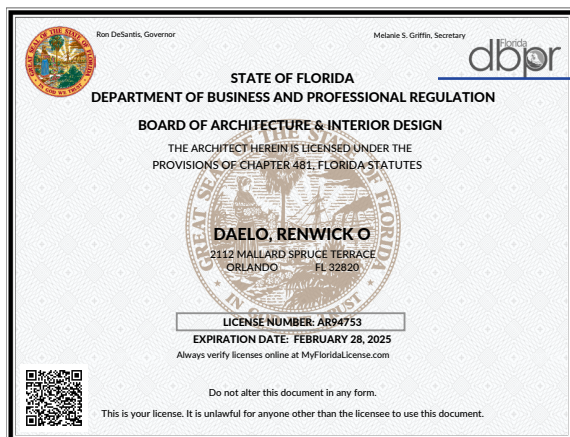

Renwick Daelo
Project Architect
j|2 Architecture



Jim McClaren, AIA
Public Safety Architect
MWL

PROTECT & SERVE

DOCUMENTS

Licenses and Certifications

ARIZONA
STATE BOARD OF TECHNICAL REGISTRATION

Home / 66006 / 21197

21197

First Name DAVID
Last Name WILSON

License Status
Active

Discipline
ARCHITECT

Initial Registration Date 28 Aug 1987
Expiration Date 31 Dec 2025

Address Line 1
8705 N Central Avenue

City Phoenix
State Arizona

Dave Wilson, AIA
Public Safety Architect
MWL

Illinois Department of Financial and Professional Regulation

Contact Information

Name	City/State/Zip	DBA / AKA
DEAN SCOTT ROBERTS	Yorkville, IL 60560	

License Information

License Number	Description	Status	First Effective Date	Effective Date	Expiration Date	Ever Disciplined
001018287	LICENSED ARCHITECT	ACTIVE	07/29/2002	12/31/2022	11/30/2024	N

Dean Roberts, AIA
Project Architect
MWL

Ron DeSantis, Governor
Melanie S. Griffin, Secretary

FBPE
FLORIDA BOARD OF PROFESSIONAL ENGINEERS

STATE OF FLORIDA

BOARD OF PROFESSIONAL ENGINEERS
THE PROFESSIONAL ENGINEER HEREIN IS LICENSED UNDER THE PROVISIONS OF CHAPTER 471, FLORIDA STATUTES

CLAYBROOKE, BOBBI RAWLS
13900 MULHOLLAND ROAD
PARRISH FL 34219

LICENSE NUMBER: PE90804
EXPIRATION DATE: FEBRUARY 28, 2025
Always verify licenses online at MyFloridaLicense.com

Do not alter this document in any form.
This is your license. It is unlawful for anyone other than the licensee to use this document.

Bobbi Claybooke, P.E., AIA
Civil Engineer
AM Engineering

PROTECT & SERVE

DOCUMENTS

Licenses and Certifications

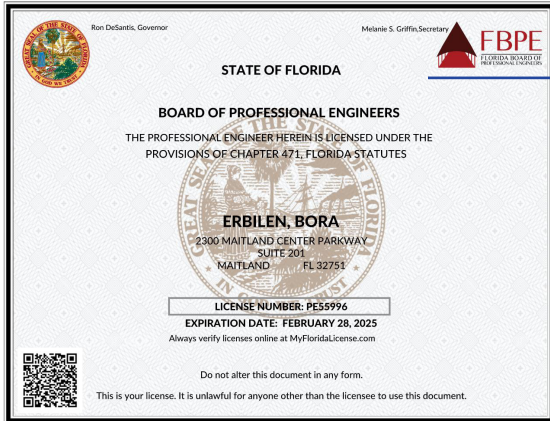

Bora Erbilin, PE
Structural Engineer
BBM Structural

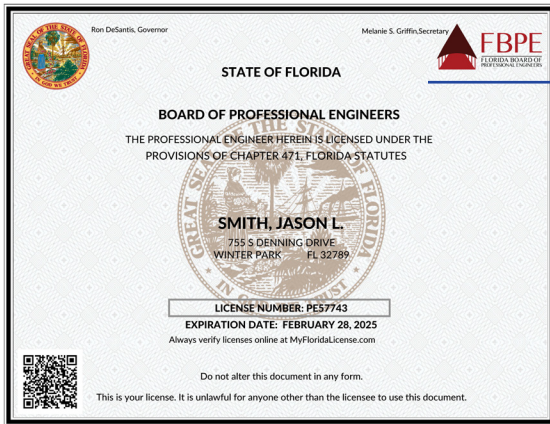

Jason Smith, PE, LEED AP
Mechanical Engineer
OCI & Associates

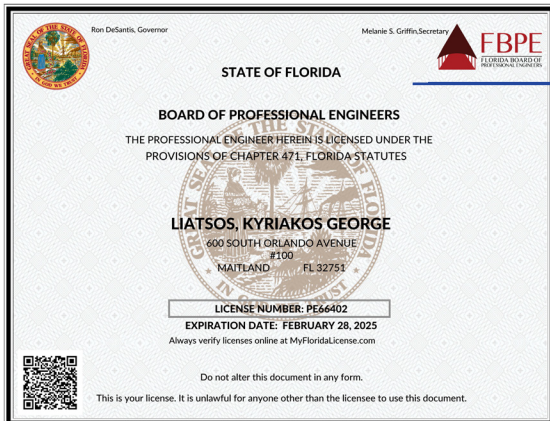

Keith Liatsos, PE
Electrical Engineer
OCI & Associates

PROTECT & SERVE

DOCUMENTS

Licenses and Certifications

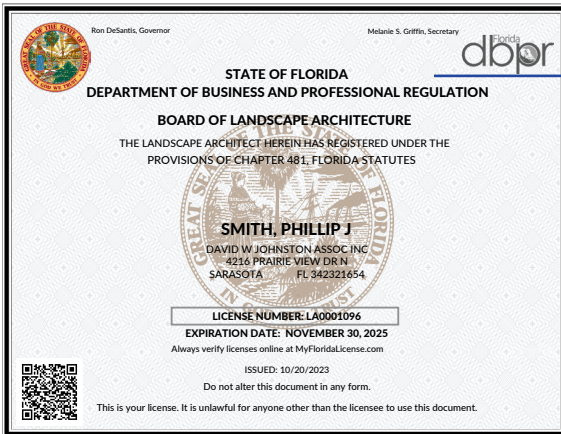

Phil Smith, PE
Landscape Architect
DWJA



PROTECT & SERVE

DOCUMENTS

Resumes



Johnnie D. Lohrum Jr., RA, LEED® AP President

Johnnie has 22 years of experience and has managed more than 5 million square feet of public safety projects. He is a licensed architect and LEED accredited professional with a diverse portfolio of project types, including public safety, educational, community, commercial and aviation design. He has spent the last 15 years focusing on growing a public safety market that improves the community environment. **A particular passion for Johnnie is the design of operationally efficient healthy law enforcement facilities.** He also brings a significant amount of experience designing & detailing hardened, survivable and essential facilities such as the Columbia County EOC, Sarasota County EMS Headquarters, Charlotte County Sheriff's Headquarters, Brevard County EOC and the Volusia County EOC. Johnnie remains focused on providing personally dedicated and focused attention at every level to all of his clients.

EDUCATION

Bachelor of Design, 2001
University of Florida

Master of Architecture, 2003,
University of Florida

CREDENTIALS

FL, Registered Architect #AR96099
LEED® Accredited Professional

AFFILIATIONS

Florida Police Chief's Association
(FPCA)
Florida Sheriff's Association (FSA)
Florida Fire Chief's Association
(FFCA)
Fl. Emergency Preparedness Assoc.
(FEPA)

EXPERIENCE

22 Years

FIRM INFORMATION

1678 Kingston Road
Longwood, Florida 32750

jlohrum@jl2architecture.com
407.340.2879

*projects represent individual experience for Mr.
Lohrum



RELEVANT EXPERIENCE:

Fire Headquarters, Daytona Beach Fire Department - *City of Daytona Beach, FL*
Project Manager, Completion Date: TBD / 28,000SF / \$22 million / 2-story /
community room / 5 drive thru bays / EOC / history museum / administration offices
/ training rooms / classrooms / crew quarters / day room / commercial kitchen / work
shop / decontamination room.

Police Training Facility, Ocoee Police Department - *Ocoee, FL*
Principal In Charge, Completion Date: 2024 / 25,000SF / \$12 million / indoor 16 lane
gun range / firearm simulators / defensive tactics / locker rooms / armory / ammo
storage / weapons cleaning / training classrooms.

***Police Headquarters**, North Port Police Department - *City of North Port, FL*
Project Manager, Completion Date: 2026 / 151,000SF / \$100 million / administration
offices / patrol / EOC / evidence processing / interview rooms / community room /
media room / quarter master / emergency management / locker rooms / forensics lab
/ armory / training / gun range / real time crime center.

***Fire Headquarters**, Sarasota County Fire Department - *Sarasota County, FL*
Principal In Charge, Completion Date: Est. 2024 / 23,000SF / \$12 million / 2-story /
essential facility / administration offices / training rooms / inspections / fire marshal
offices / multi-use conference rooms / EOC / history room / secured public lobby.

***Fire Admin. Headquarters**, North Port Fire Department - *North Port, FL*
Principal In Charge, Completion Date: Est. 2024 / 19,275SF / \$4 million / addition / fire
experience / admin. offices / fire marshal offices / conference rooms / flight support
/ 3 apparatus bays / dayroom / kitchen / crew quarters / 2 community rooms / fitness.

***Police Training Facility**, Cape Coral Police Department - *Cape Coral, FL*
Principal In Charge, Completion Date: 2023 / 30,000SF / \$12 million / indoor 25 lane
gun range / firearm simulators / defensive tactics / k9 training / locker rooms / armory
/ ammo storage / weapons cleaning / training classrooms.

***Sheriff's Training Facility**, Osceola Sheriff - *Osceola County, FL*
Principal In Charge, Completion Date: 2021 / 16,400SF / \$3.9 million / defensive
tactics / simulation training / firearm training / administration offices / conference
space / storage / multi-agency.

***Sheriff's District 4 Training Facility**, Charlotte County Sheriff - *Charlotte County, FL*
Project Manager, Completion Date: 2024 / 20,200SF / \$7 million / meeting rooms /
training classrooms / physical training / administration offices / k-9 training / kennels /
lockers / fitness room / evidence storage / detectives suite / break room

PROTECT & SERVE

DOCUMENTS

Resumes

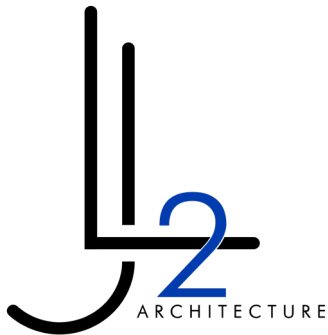

EDUCATION

Bachelor of Design, 2001
University of Florida

Master of Architecture, 2003,
University of Florida

CREDENTIALS

FL, Registered Architect #AR96099
LEED® Accredited Professional

AFFILIATIONS

Florida Police Chief's Association
(FPCA)
Florida Sheriff's Association (FSA)
Florida Fire Chief's Association
(FFCA)
Fl. Emergency Preparedness Assoc.
(FEPA)

EXPERIENCE

22 Years

FIRM INFORMATION

1678 Kingston Road
Longwood, Florida 32750

jlohurm@j12architecture.com
407.340.2879

RELEVANCE

Law Enforcement
Public Safety Admin Buildings
Coordination with CMs
New Construction
150+ MPH Hardened Facilities
LEED® Design Standards

***District 7 Medical Examiner Facility**, Volusia County Government - *Daytona, FL*
Principal In Charge, Completion Date: est. 2023 / 20,000 SF / \$18 million / contains public spaces / N.A.M.E. / offices / reception & lobby / morgue / laboratories / evidence storage / break areas and enclosed sally port.

***Douglas M. Anderson EOC**, St. Lucie County Government - *Ft. Pierce, FL*
Project Manager, Completion Date: 2009 / 27,000SF / \$9 million / contains secure lobby / 911 dispatch / dorms / admin. offices / media room / kitchen.

***Emergency Operations Center**, Palm Beach Gardens - *Palm Beach Gardens, FL*
Project Architect, Completion Date: 2012 / 12,500SF / \$3.1 million / police dispatch / multi-purpose rooms / operations center / classrooms / training rooms / kitchen / FEMA 361 / LEED Silver.

***Emergency Operations & Sheriff's Operations**, Citrus County - *Lecanto, FL*
Project Architect, Completion Date: 2008 / 40,500SF / \$16.5 million / 911 call center / operations room / crime analysis / investigations / offices / kitchen / dorms / fitness room / media.

***Emergency Operations & Sheriff's Comms.**, Volusia County - *Daytona, FL*
Project Manager, Completion Date: 2013 / 42,600SF / \$10,700,000 / command center / 911 dispatch / Green Globes / LEED Silver / 2 commercial kitchens / bunk rooms / classrooms / training rooms / media room / administration offices / rumor control.

***Emergency Operations Center**, Columbia County - *Lake City, FL*
Principal In Charge, Completion Date: Est. 2023 / 20,000SF / \$14 million / 911 dispatch center / ICC 500 essential facility / media room / kitchen / code enforcement.

***Brevard County EOC**, Brevard County Government - *Rockledge, FL*
Principal-In-Charge/Project Manager, Completion Date: est. 2023 / 50,000 SF / \$28.5 million / contains secure lobby / locker rooms / bunk rooms / training rooms / multiple departments / commercial kitchen / 911 dispatch / operations room / media room / essential ICC 500 resisting 200mph winds / grant funded / 24-7 fully redundant systems for 7 days.

***Sheriff's Evidence Storage**, Volusia County Government - *Daytona, FL*
Project Manager, Completion Date: est. 2021 / 40,000 SF / \$11.3 million / contains public spaces / offices / secure vehicular sally ports / bio hazard storage / storage warehouse with mobile storage system / secure drug storage / essential facility resisting 200mph winds / LEED Silver.

***University of Florida Public Safety Complex**, Univ. of Florida - *Gainesville, FL*
Principal-In-Charge, Completion Date: 2022 / 48,713SF / \$28.5 million / police headquarters / emergency management headquarters / 911 dispatch / community rooms / administration offices / interview rooms / physical fitness / locker rooms / evidence processing / defensive tactics / armory / media room / logistics / quarter master.

***Sheriff's Headquarters Assessment**, Sarasota Sheriff - *Sarasota County, FL*
Project Manager, Completion Date: 2018 / 192,000SF / \$130 million / forensics lab / separate training facility / five-story parking garage / CEP / evidence storage / training classrooms / community room / K9 training

***Sheriff's Headquarters/911/Comms.**, Charlotte Sheriff - *Charlotte County, FL*
Project Manager, Completion Date: 2025 / 65,000SF / \$30 million / 2- story community room / administration offices / fleet maintenance / real time crime center / 911 dispatch / crime analysis.

***Police Evidence Storage**, City of DeLand Police Department - *DeLand, FL*
Project Manager, Completion Date: 2022 / 5,500 SF / \$1.9 million / public ballistic rated lobby / evidence intake / short term storage / long term storage / evidence processing lab / vehicle processing bay / bicycle storage / interior vehicle storage bays / on-site impound.

DOCUMENTS

Resumes



Dean Roberts, AIA, OAA, NCARB Sr. Principal / Public Safety Architect

With a passionate focus on public safety projects for the majority of his architecture career, Dean has developed a deep understanding of the everyday responsibilities, culture and challenges unique to public safety professionals. **His legacy of innovative planning and thoughtful design is built on more than 120 successfully completed projects located across the United States and Canada.** Always learning, yet visioning for the future, his projects are known for the ingenious way they effectively facilitate everyday operations, bring people together and reinforce the professionalism and culture of their occupants. He seamlessly weaves elements of safety and security into the DNA of every project. Whether addressing common issues or unique challenges, Dean approaches each project with a fresh perspective and a rigorous application of his knowledge. His work endeavors to raise the bar of excellence through operationally effective facilities and timeless enduring civic design.

EDUCATION

Bachelor of Architecture, 1980
Kansas State University

CREDENTIALS

Ill, KS, MS, Registered Architect
NCARB Certification

AFFILIATIONS

American Institute of Architects
Academy of Architecture for Justice
IACP--Associate Member

EXPERIENCE

42 Years

FIRM INFORMATION

330 S Naperville Road
Wheaton, IL 60187

roberts@mwlarchitects.com
630.864.7675

RELEVANCE

Law Enforcement
Public Safety Admin Buildings
Coordination with CMs
New Construction
150+ MPH Hardened Facilities
LEED® Design Standards
Public Safety Training Centers
Fire Facilities



RELEVANT EXPERIENCE:

Police Headquarters, City of North Port - North Port, FL

Lead Principal, 151,000SF / \$100 million / 3-story / community room / service oriented public lobby / training room / patrol / traffic / fitness / property & evidence / real time information center / interview room / quarter master / emergency management / forensics lab / armory / **with Mr. Lohrum.**

Law Enforcement Training Center, City of Raleigh - Raleigh, NC

Lead Principal, Completion Date: 2021 / 59,760SF / \$17 million / 2-story / outdoor training / classrooms / simulators / immersive training / scenario training / multi-agency / driving track / firing range.

Law Enforcement Training Center, University of Kansas - Hutchinson, KS

Lead Principal, Completion Date: 2020 / 458,000SF / outdoor training / classrooms / simulators / immersive training / scenario training / multi-agency / driving track / firing range / crisis intervention / force utilization.

Public Safety Training Center, Fox Valley - Appleton, WI

Lead Principal, Completion Date: 2014 / 78,888SF / \$32.5 million / 76 acre site /

Police Headquarters, Village of Oswego - Oswego, IL

Lead Principal, Completion Date: 2018 / 71,935SF / \$26.2 million / administration offices / patrol / EOC / evidence processing / interview rooms / community room / media room / quarter master / emergency management / locker rooms / forensics lab / armory / training / gun range / training wing.

ADDITIONAL PUBLIC SAFETY EXPERIENCE:

Police Training Facility - Lee's Summit, Missouri

College of DuPage, IL Homeland Security Training Center

Elgin Community College (ECC), IL Public Safety Training and Sustainability

University of Illinois Public Safety Building - Champaign, Illinois

Public Safety Building - Blue Springs, Missouri

Police Station & Government Center - Fairfax County/Mclean Virginia

University of Wisconsin Campus Police Facility - Lacrosse

Regional Police Headquarters - Niagara, Ontario, Canada

PROTECT & SERVE

DOCUMENTS

Resumes



David Wilson, RA, OAA, NCARB Sr. Principal / Public Safety Architect

Dave has established a reputation for creativity and innovation in public safety facility planning and design for clients and projects of all sizes and complexity.

His public safety training centers incorporate creativity, emphasizing training effectiveness, with flexibility and durability for single agency and multi-agency training. His campus solutions incorporate specialized training opportunities, planned and designed for intense and repeated use. Training components incorporate technology and seek the safety of instructors and trainees while mimicking realistic, repeatable, and changeable scenarios. His training centers seek to maximize the training opportunities and scenario development available to instructors, allowing the training centers to respond to current and emerging public safety training issues.

EDUCATION

Bachelor of Architecture, 1983
Washington State University

CREDENTIALS

AZ, CA, HI, ID, MD, ND OK, TX, UT
Registered Architect
NCARB Certification

AFFILIATIONS

American Institute of Architects
National Exhibition of Justice
ICMA

EXPERIENCE

40 Years

FIRM INFORMATION

8705 N Central Ave
Phoenix, AZ 85020

wilson@mwlarchitects.com
602.331.4141

RELEVANCE

Law Enforcement
Public Safety Admin Buildings
Coordination with CMs
EMS
Forensic Laboratory Facilities
New Construction
150+ MPH Hardened Facilities
LEED® Design Standards
Public Safety Training Centers
Fire Facilities



RELEVANT EXPERIENCE:

Police Training Facility, Ocoee Police Department - *Ocoee, FL*
Principal In Charge, Completion Date: 2024 / 25,000SF / \$12 million / indoor 16 lane gun range / firearm simulators / defensive tactics / locker rooms / armory / ammo storage / weapons cleaning / training classrooms / **with j12 Architecture.**

Police Training Facility, Cape Coral Police Department - *Cape Coral, FL*
Principal In Charge, Completion Date: 2023 / 30,000SF / \$12 million / indoor 25 lane gun range / firearm simulators / defensive tactics / k9 training / locker rooms / armory / ammo storage / weapons cleaning / training classrooms / **with Mr. Lohrum.**

Public Safety Training Center, City of Atlanta - *Atlanta, GA*
Lead Principal, Completion Date: 2023 / 26,016SF / \$90 million / police / fire / ems / firing range / classrooms / offices / ems laboratory classroom / tactical streets / user / evoc skills pad.

Police & Fire Training, City of Scottsdale - *Scottsdale, AZ*
Lead Principal, Completion Date: Active / 59,785SF / \$27 million / outdoor training / classrooms / firing range / weapons simulation rooms / simunitions shoothouse.

Public Safety Training Center, City of Chandler - *Chandler, AZ*
Lead Principal, Completion Date: 2020 / 68,097SF / \$17.7 million / indoor firing range / police and fire admin. offices / classrooms / auditorium / police simulation training room / simunitions training room / live fire round capabilities.

ADDITIONAL PUBLIC SAFETY EXPERIENCE:

Sarasota Fire Training Center – Sarasota, FL / with Mr. Lohrum.

Police Training Center – VA State Police Academy, Richmond, VA

Police and Fire Training Facility - Prince William County, VA

Police and Fire Training Center – Atlanta, GA

Police Training Center - Thornton, CO

Wyoming Law Enforcement Academy – Douglas, WY

Alamance CC Public Safety Training Center – Graham, NC

Law Enforcement Training Center – Thornton, CO

Kansas Law Enforcement Academy – Hutchinson, KS

PROTECT & SERVE

DOCUMENTS

Resumes



James McClaren, AIA, OAA, NCARB Sr. Principal / Public Safety Architect

Jim McClaren is an internationally recognized planner of law enforcement facilities, city halls, and forensic science laboratories. Prior to founding McClaren, Wilson and Lawrie, Inc. in 1995, he served as a principal of Ruth and Going Architects and Engineers in San Jose, California. **Jim has led programming, planning, design, and program management efforts for over one hundred fifty public safety facilities and forensic science laboratories throughout North America.**

For two decades, Jim has served as the only licensed architect on the adjunct faculty of the International Association of Chiefs of Police, Center for Advanced Police Studies. He is the only licensed architect to receive their Distinguished Faculty Award for his course entitled "Design, Planning and Construction of Police Facilities". In 2003 he co-authored Chapter 16 of the current ICMA textbook, Local Government Police Management.

EDUCATION

Bachelor of Architecture, 1983
Washington State University

CREDENTIALS

AL, AK, AZ, CA, CO, IL, LA, MD, MN
FL, Registered Architect AR97628
NCARB Certification

AFFILIATIONS

American Institute of Architects
American Audubon Society
AIA National Exhibition of Justice
ICMA
US Marshals Service
AGC

EXPERIENCE

40 Years

FIRM INFORMATION

8705 N Central Ave
Phoenix, AZ 85020

mclaren@mwlarchitects.com
602.331.4141

RELEVANCE

Law Enforcement
Public Safety Admin Buildings
Forensic Laboratory Facilities
New Construction
LEED® Design Standards
Public Safety Training Centers
Fire Facilities



RELEVANT EXPERIENCE:

Regional Law Enforcement Training Center, Kane County - Geneva, IL

Lead Principal, Completion Date: 2014 / 5,700SF / \$1.8 million / 10 point tactical firearms range / shoot and move training / vehicle props / ammo storage / weapons cleaning / armory.

Police Service Headquarters, City of Salina - Salinas, California

Lead Principal, Completion Date: 2020 / 69,230SF / \$35 million / new training building / 10 firing positions / shoot and move / vehicle props / armorer / range ready room / swat / weapons maintenance.

Police Department Training Center, City of Denver - Denver, CO

Lead Principal, Completion Date: 2010 / 31,790SF / \$12.3 million / classrooms / traffic support / tactical firearms range / shoot and move / safe lateral team training / vehicle props / virtual live fire range / self-healing linatex screen / judgement training / armorer / ready room / swat / weapons maintenance.

Police Training Facility, City of Aurora - Aurora, IL

Lead Principal, Completion Date: 2010 / 195,000SF / \$64.3 million / outdoor training / classrooms / firing range / weapons simulation rooms / simunitions shoothouse.

ADDITIONAL PUBLIC SAFETY EXPERIENCE:

Police Headquarters, Firearms Proficiency Range - Anchorage, Alaska

Police Headquarters, Firearms Proficiency Range - Chula Vista, Calif.

Firearms Proficiency Range - Culver City, California

Public Safety Center, Firearms Proficiency Range - El Cajon, California

Firearms Proficiency Range - Fontana, California

Post Earthquake Firearms Range Repairs - Glendale, California

Police Academy Training Center, Firearms Proficiency Range Complex -

Police Firearms Proficiency Center - Pleasanton, California

Tactical and Firearms Proficiency Range - Honolulu, Hawaii

Firearms Proficiency Range - Grand Prairie, Texas

Public Safety Headquarters (Police & Fire) - Salt Lake City, Utah

DOCUMENTS

Resumes



Bobbi claybrooke, PE Vice President / Civil Engineer

Mrs. Claybrooke experience includes preparing construction cost estimates, engineering studies/reports, state and local permitting, contract documents, as well as construction plans for water, wastewater, utility extensions/relocations, drainage, roadway improvements and paving improvements in residential and commercial developments located in Sarasota, Manatee, Hillsborough, Pinellas, Pasco and Collier Counties as well as in the Turks and Caicos Island (Caribbean). Mrs. Claybrooke's experience includes new construction, and existing system/design improvements/retrofits. Mrs. Claybrooke works closely with the AM Engineering in-house design team as well as other project team discipline professionals to uphold the tradition of design and engineering excellence established by current management. She strives to provide her clients with quality design service and timely responsiveness. **Her goal is to deliver quality, cost effective solutions that are the foundation of a good engineer/client relationship.**

RELEVANT EXPERIENCE:

EDUCATION

Bachelor of Science,
Civil Engineering, 2003
University of South Florida

CREDENTIALS

FL Professional Engineer No. 90804

AFFILIATIONS

Florida engineering Society
National Society of Prof. Engineers
NSPE

EXPERIENCE

20 Years

FIRM INFORMATION

8340 Consumer Court
Sarasota, FL 34240

bclaybrooke@amengfl.com
941.377.9178

RELEVANCE

Law Enforcement
Public Safety Admin Buildings
New Construction
LEED® Design Standards
Fire Facilities

Police Headquarters, City of North Port - North Port, FL

Lead Principal, 151,000SF / \$100 million / 3-story / community room / service oriented public lobby / training room / patrol / traffic / fitness / property & evidence / real time information center / interview room / quarter master / emergency management / forensics lab / armory.

Fire Station #86 & Police Substation, City of North Port – North Port, FL

Design Engineer, Completion Date: 2022 / 8.23 ac site & 24,000 sf building / multi-use stormwater management facility / site utilities / site grading / visitor parking / secure police parking

Fire Station #81, City of North Port – North Port, FL

Engineer of Record, Est. Completion Date: 2026 / 2.5 ac site & 36,000 sf building / multi-use stormwater management facility / site utilities / site grading / joint parking with future EOC

Fleet Services, Sarasota County – Nokomis, FL

Engineer of Record, Completion Date: 2026 / 30 ac site & 74,000 sf Ph1 Building & 30,000 sf Ph2 Building / stormwater management facility / significant adjacent natural areas (wetlands, uplands & park) / site utilities / site grading / visitor and fleet parking / fueling station / planning for future phase

Emergency Operation Center, City of North Port – North Port, FL

Engineer of Record, Completion Date: Est. 2026 / 1.2 ac site & 16,000 sf building / multi-use stormwater management facility / site utilities / site grading / joint parking with re-built Fire Station #81

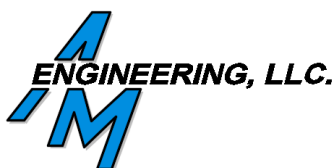

DOCUMENTS

Resumes



Phillip Smith Landscape Architect

Phillip Smith is a Landscape Architect/Certified Arborist and Project Manager with a broad-based background in Planning and Landscape Architecture projects. Along with his experience in Project Design and Construction Implementation, Mr. Smith is experienced in Design Permitting of Landscape Improvements for State and Local roads, School Projects, and Emergency Operation Facilities.

EDUCATION

Bachelor of Landscape Architecture
Michigan State School
of Landscape Architecture

CREDENTIALS

FL Professional FL#1096
Certified Arborist, FL #0410

EXPERIENCE

42 Years

FIRM INFORMATION

1717 Second
Sarasota, FL 34236

phil@dwja.net
941.780.4274

RELEVANCE

Law Enforcement
Public Safety Admin Buildings
New Construction
LEED® Design Standards
Fire Facilities
North Port Experience

RELEVANT EXPERIENCE:

Police Headquarters, City of North Port - North Port, FL

Lead Principal, 151,000SF / \$100 million / 3-story / community room / service oriented public lobby / training room / patrol / traffic / fitness / property & evidence / real time information center / interview room / quarter master / emergency management / forensics lab / armory.

Fire Station #81, City of North Port – North Port, FL

Engineer of Record, Est. Completion Date: 2026 / 2.5 ac site & 36,000 sf building / multi-use stormwater management facility / site utilities / site grading / joint parking with future EOC

Emergency Operation Center, City of North Port – North Port, FL

Engineer of Record, Completion Date: Est. 2026 / 1.2 ac site & 16,000 sf building / multi-use stormwater management facility / site utilities / site grading / joint parking with re-built Fire Station #81

Ringling Campus South Museum, Sarasota, FL

Exterior / \$.7 million / Exterior Renovations to Sarasota High School Historic Campus / Responsible for Exterior Improvements to existing High school campus converting to Museum / landscape, Irrigation, and hardscape design/construction Administration.

Sarasota Technical School, Client – Sarasota, FL

Exterior / \$2 million / Master Planned Campus / Responsible for landscape development of campus/Tree preservation, landscape, hardscape, irrigation sports field design/ Construction Administration for multi-year phased construction.

Venice High School, Client – Venice, FL

Exterior/ \$.5 million / Master Planned Campus / Responsible for landscape development of campus/ Tree preservation, landscape, hardscape, irrigation, and sports field design/ Construction Administration.

Sarasota Technical Library, Client – Sarasota, FL

Exterior/ \$.1 million / Master Planned Campus / Responsible for landscape development of campus/ Tree preservation, landscape, hardscape, and irrigation design/ Construction Administration for multi- year phased construction.

Riverview High School, Client – Riverview, FL

Exterior/ \$2.4 million / Master Planned Campus / Responsible for landscape development of campus/ Tree preservation, landscape, hardscape, irrigation, and sports field design/ Construction Administration for multi- year construction.



DOCUMENTS

Resumes



Bora Erbilien, PE, SE, MStructE, LEED Principal-in-Charge / Project Manager

Bora is President of BBM. During his career, he has developed a strong background in design and modeling of structural elements by computer analysis, allowing many different combinations to be investigated until the optimal solution is attained. He is well-versed in all types of building systems and has worked on numerous building types with varying degrees of structural design complexity. He is well respected in the design community for his efficient designs and exceptional project management capabilities.

Relevant to your proposed project, Bora has completed or is currently working 30+ law enforcement related projects in the public / municipal sector. These projects represent over 400,000 sf of relevant project experience over the span of 28 years.

EDUCATION

Bachelor of Science, 1989
Florida Institute of Technology

Master of Business
Business Administration, 1991
Florida Institute of Technology

CREDENTIALS

FL PE License No. 55996
NCEES Special Inspector-30264

AFFILIATIONS

American Inst. of Steel Construction
American Society of Civil Engineers
Florida Structural Engineers Assn.
Nat'l. Council of Structural Eng.
Assn.

FIRM LOCATION

2300 Maitland Center Pkwy
Maitland, FL 32751
berbilien@bbmstructural.com

EXPERIENCE

32 Total Years, 28 Years with BBM
20 Years w/ Johnnie Lohrum

RELEVANCE

Law Enforcement
Public Safety Admin Buildings
Coordination with CMs
New Construction
150+ MPH Hardened Facilities
LEED® Design Standards

RELEVANT EXPERIENCE:

Police Headquarters, North Port Police Department - *City of North Port, FL*
Project Manager, Completion Date: 2026 / 120,000SF / \$82 million / administration offices / patrol / EOC / evidence processing / interview rooms / community room / media room / quarter master / emergency management / locker rooms / forensics lab / armory / training / gun range/ real time crime center

Charlotte County, Sheriff's Dist. 4 Office Training Facility – *Pt. Charlotte, FL*
PIC / Sr. PM, Completion Date: est. 2024 / 20,200 sf / \$7M / contains Meeting Rooms / Training Classrooms / Physical Training / Offices / K-9 Training & Kennels / Lockers / Fitness Room / Evidence Storage / Detectives Suite / Breakroom.

Daytona State College, Indoor Firing Range – *DeLand, FL*
PIC / Sr. PM, Completion Date: est. 2024 / 25,500 sf / \$6M / contains Offices / Indoor Firing Range / Shop Area / Gun Cleaning Area / Armory & Ammo Area / Multi-Purpose Classroom.

Port St. Lucie Public Safety Complex Training Facility – *Port St. Lucie, FL*
PIC / Sr. PM, Completion Date: est. 2025 / 41,620 sf / \$16.6M / contains first floor Police Training & Support Areas / 20-Lane Indoor Firing Range / 60-Person Auditorium-Style Multi-Purpose Room / 2 additional Multi-Purpose Rooms / Offices / Support Spaces.

City of Orlando, Police Headquarters – *Orlando, FL*
PIC / Sr. PM, Completion Date: 2016 / 103,300 sf / \$40M / contains 400-Seat Community Room / 5,000 sf first floor Training (Multi-Purpose) Area.

City of Boynton Beach, Police Department – *Boynton Beach, FL*
PIC / Sr. PM, Completion Date: 2020 / 55,409 sf / \$15.5M / contains Classroom & Training Rooms / Booking & Intake Areas / Community room / Sallyport / Holding Cells / Record Room / Storage / Laundry.

Sumterville Sheriff's Office Training & Fire Training Center – *Sumter County, FL*
PIC / Sr. PM, Completion Date: est. 2025 / 5,000 sf / \$31M / contains Training Facilities.

City of St. Cloud, Fire Rescue Training Complex – *St. Cloud, FL*
PIC / Sr. PM, Completion Date: 2023 / 6,000 sf / \$1.4M / contains Fire Station and Training Facilities.



DOCUMENTS

Resumes



Jason Smith, PE, LEED® AP BD+C, CEM Principal/Director of Mechanical Engineering

Jason is a seasoned expert in mechanical design as OCI's Mechanical Engineer of Record, leading his expertise in energy efficient HVAC design and applying his knowledge as and a Certified Energy Manager and LEED Accredited Professional. **His portfolio features over 200 public safety buildings for Police/Sheriff's Departments, Fire Rescue & EMS Stations, Emergency Operations Centers, and Training facilities. These buildings have housed spaces including offices, classrooms, indoor gun ranges, storage/vehicle storage, EMS training labs, and on-site simulation shoot house, driving pad, urban search, rescue props, and burn towers.** He applies his LEED® and CEM® expertise to engineer energy saving systems and meet the Owner's goals.

EDUCATION

Bachelor of Science, Electrical Engineering, University of Central Florida

CREDENTIALS

FL, Registered Engineer:
PE #55743

LEED® Accredited Professional:
10197282-AP-BD+C

Certified Energy Manager®:
CEM19073

AFFILIATIONS

American Society of Heating, Refrigerating and Air-Conditioning Engineers (ASHRAE)

U.S. Green Building Council (USGBC)

EXPERIENCE

35 Years

FIRM INFORMATION

600 S. Orlando Ave
Maitland, FL 32751

jsmith@ociassociates.com
407.332.5110



RELEVANT EXPERIENCE:

Fire Headquarters Building, Daytona Beach Fire Department - *Daytona Beach, FL*
MEOR / 25,000 SF / \$18 million / MEP/FP / Hardened to Cat. 4 / 150 mph wind speeds / New Construction / 2-story building / 4 double-length apparatus bays / 75 person community room / museum space / admin offices / conference rooms / individual dorm rooms / commercial style kitchen with commercial natural gas appliances / secure lobby / showers / restrooms / lockers / storage / utility room / communication room / workout room / parking / emergency generator / traffic signal / SCBA cascade / gear storage/ extractor / decontamination room / training tower
with JL2 Architecture

Police Headquarters, North Port Police Department - *City of North Port, FL*
Project Manager, Completion Date: 2026 / 151,000SF / \$100 million / administration offices / patrol / EOC / evidence processing / interview rooms / community room / media room / quarter master / emergency management / locker rooms / forensics lab / armory / training / gun range/ real time crime center / **with Mr. Lohrum.**

Public Safety Training Center, Palm Beach State College - *Lake Worth, FL*
MEOR / 143,000 SF / \$34.9 million / MEP/FP / USGBC LEED® Gold / 3-phase New Construction / Public Safety Training / Firing Range Facility / Driving Course / Fire Academy Training Tower / Driving Course / academic building / tactical gymnasium / lecture hall / 24 firing lanes / tactical driving course

Public Safety Operations Complex, Hillsborough County - *Tampa, FL*
MEOR / 92,400 SF / \$36.1 million / LEED® Certified / Hardened Cat. 5 / ME/FP / New Construction / Design-Build / Administration & Emergency Operations Center building / Fleet Maintenance building / Fire Training Burn Building / Warehouse / 250-person incident command room / 94 work stations / dispatch center / 6 breakout rooms / offices for fire rescue staff / training center / call center / information technology center / Office of Emergency Management

Treasure Coast Public Safety Training Complex, Indian River State College - *Fort Pierce, FL*
MEOR / 101,000 SF / \$28 million / MEP/FP / Public Safety Training / New Construction / Defensive Tactics Training lab for SWAT training / replicated fire station to include classrooms / 7-story fire training tower / 5-story burn building gas-fed burn field / indoor firearms training range / forensics laboratory

Sheriff's District 4 Office, Training Center & K-9, Charlotte County Sheriff's Office - *Englewood, FL*
MEOR / Est. 16,000 SF / \$9.3 million / Hardened Cat. 5 / MEP/FP/LV / New Construction / Headquarters office / 80-person training room / training offices for 9 staff / 30-person physical training gym with showers / lockers & storage / break room / secure entrance/reception / climate controlled K-9 kennels for short-term care / 60-vehicle parking with SWAT & trailer space / emergency generator

PROTECT & SERVE

DOCUMENTS

Resumes



Keith Liatsos, PE

Principal/Director of Electrical Engineering - OCI

Since 2014, Keith has led OCI's Electrical Department providing QA/QC at major milestones and looking for innovative solutions to improve building performance and reduce energy consumption for Owners and Clients. His principal areas of design include lighting, power distribution (low voltage and medium voltage), emergency systems, and fire alarm systems. He has served as the Electrical Engineer of Record (EEOR) for over 130 government projects including Fire Rescue & EMS Stations, Emergency Operations Centers, Police & Sheriff's Buildings, and Public Safety Training Complexes with classroom space, driving courses, firing ranges with real world simulation, and burn towers. In addition, Keith will be leading the electrical design efforts for **the City of North Port's new 140,000 SF Police Headquarters Building**.

EDUCATION

Bachelor of Science, Electrical Engineering, University of Central Florida

CREDENTIALS

FL, Registered Engineer:
PE #66402

AFFILIATIONS

Institute of Electrical and Electronics Engineers (IEEE)

EXPERIENCE

22 Years

FIRM INFORMATION

600 S. Orlando Ave
Maitland, FL 32751

kliatsos@ociassociates.com
407.332.5110

RELEVANT EXPERIENCE:

Fire Headquarters Building, Daytona Beach Fire Department - *Daytona Beach, FL*
EEOR / 25,000 SF / \$18 million / MEP/FP / Hardened to Cat. 4 / 150 mph wind speeds / New Construction / 2-story building / 4 double-length apparatus bays / 75 person community room / museum space / admin offices / conference rooms / individual dorm rooms / commercial style kitchen with commercial natural gas appliances / secure lobby / showers / restrooms / storage / utility room / communication room / workout room / parking / emergency generator / traffic signal / SCBA cascade / gear storage / extractor / decontamination room / training tower / **with JL2 Architecture**

Police Headquarters, North Port Police Department - *City of North Port, FL*
Project Manager, Completion Date: 2026 / 151,000SF / \$100 million / administration offices / patrol / EOC / evidence processing / interview rooms / community room / media room / quarter master / emergency management / locker rooms / forensics lab / armory / training / gun range / real time crime center / **with Mr. Lohrum**.

Police Headquarters, City of Hollywood - *Hollywood, FL*
EEOR / 120,000 SF / \$72.5 million / Pursuing LEED® / Hardened Cat. 5 / MEP/FP/LV / New Construction / 4-story building / property & evidence room / offices / internal affairs / records storage & intake / quartermaster / patrol / K-9 / traffic, beach, marine divisions / holding cells / detective units / recruitment / administration & public information / community room / public lobby / 350-space parking garage / large vehicle storage / 3-vehicle sally port / 3-vehicle CSI exam space / armory with an 11-lane indoor firing range with moving targets & simulations.

Fire Rescue Training Facility, St. Cloud Fire Department - *St. Cloud, FL*
EEOR / 6,000 SF / \$1.5 million / MEP/FP/LV / New Construction / fire rescue training classroom building / training classroom with the option to be partitioned into three separate spaces / offices / cubicles / breakroom / seating area / conference room /

Public Safety Operations Complex, Hillsborough County - *Tampa, FL*
EEOR / 92,400 SF / \$36.1 million / LEED® Certified / Hardened Cat. 5 / ME/FP / New Construction / Design-Build / Administration & Emergency Operations Center building / Fleet Maintenance building / Fire Training Burn Building / Warehouse / 250-person incident command room / 94 work stations / dispatch center / 6 breakout rooms / offices for fire rescue staff / training center / call center / information technology center / Office of Emergency Management

Public Safety Complex, University of Florida Police Department - *Gainesville, FL*
EEOR / 36,000 SF / \$21.6 million / Pursuing LEED® / MEP/FP/LV / New Construction / campus' main Shelter-in-Place facilities in the event of emergency / law enforcement patrol operations / criminal investigations / employee training / equipment quartermaster / public safety dispatch & alarm monitoring / video surveillance monitoring / Emergency Operations Center / police records / administration & finance / victim advocacy / accreditation & internal affairs / evidence storage & processing / public safety rolling asset storage.



DOCUMENTS

Resumes



Kaz Kazemnia, NICET

Principal/Dir. of Plumbing & Fire Protection - OCI

Kaz's expertise includes automatic fire protection suppression systems per NFPA 13, sanitary sewer waste, domestic water distribution, hot water/hot water return, storm system, medical gas, compressed air, and vacuum. Kaz has overseen the plumbing and fire protection on more than 200 public safety projects, many consisting of offices, classrooms, firing ranges, driving courses, vehicle storage, burn towers, and more. **In addition, Kaz will lead the P/FP design on the City of North Port's new 140,000 SF Police Headquarters Building.**

EDUCATION

American University in Washington DC

CREDENTIALS

National Institute for Certification in Engineering Technologies (NICET):

- Fire Alarm Systems
- Inspection & Testing of Fire Alarm Systems
- Water-Based Systems Layout Inspection & Testing of Water-Based Systems
- Special Hazards Systems

EXPERIENCE

27 Years

FIRM INFORMATION

600 S. Orlando Ave
Maitland, FL 32751

kaz@ociassociates.com
407.332.5110

RELEVANT EXPERIENCE:

Fire Headquarters Building, Daytona Beach Fire Department - *Daytona Beach, FL*
Sr. P/FP / 25,000 SF / \$18 million / MEP/FP / Hardened to Cat. 4 / 150 mph wind speeds / New Construction / 2-story building / 4 double-length apparatus bays / community room / museum / admin offices / conference rooms / individual dorm rooms / commercial kitchen / secure lobby / lockers / storage / communication room / workout room / parking / emergency generator / traffic signal / SCBA cascade / gear storage / extractor / decontamination room / training tower / **with JL2 Architecture.**

Police Headquarters, North Port Police Department - *City of North Port, FL*
Project Manager, Completion Date: 2026 / 151,000SF / \$100 million / administration offices / patrol / EOC / evidence processing / interview rooms / community room / media room / quarter master / emergency management / locker rooms / forensics lab / armory / training / gun range / real time crime center / **with Mr. Lohrum.**

Police Headquarters, City of Hollywood - *Hollywood, FL*
Sr. P/FP / 120,000 SF / \$72.5 million / Pursuing LEED® / Hardened Cat. 5 / MEP/FP / LV / New Construction / 4-story building / offices / detective units / recruitment / administration & public information / community room / public lobby / 350-space parking garage / large vehicle storage / 3-vehicle sally port / 3-vehicle CSI exam space / armory with an 11-lane indoor firing range with moving targets & simulations /

Public Safety Training Center, Palm Beach State College - *Lake Worth, FL*
Sr. P/FP / 143,000 SF / \$34.9 million / MEP/FP / USGBC LEED® Gold / 3-phase New Construction / Public Safety Training / Firing Range Facility / Driving Course / Fire Academy Training Tower / Driving Course / academic building / tactical gymnasium / lecture hall / 24 firing lanes / tactical driving course

Public Safety Operations Complex, Hillsborough County - *Tampa, FL*
Sr. P/FP / 92,400 SF / \$36.1 million / LEED® Certified / Hardened Cat. 5 / ME/FP / New Construction / Design-Build / Administration & Emergency Operations Center building / Fleet Maintenance building / Fire Training Burn Building / Warehouse / 250-person incident command room / 94 work stations / dispatch center / 6 breakout rooms / offices for fire rescue staff / training center / call center / information

Treasure Coast Public Safety Training, Indian River State College - *Fort Pierce, FL*
Sr. P/FP / 101,000 SF / \$28 million / MEP/FP / Public Safety Training / New Construction / Defensive Tactics Training lab for SWAT training / replicated fire station to include classrooms / 7-story fire training tower / 5-story burn building gas-fed burn field / indoor firearms training range / forensics laboratory

Sheriff's District 4, Training Center & K-9, Charlotte County Sheriff's - *Englewood, FL*
Sr. P/FP / Est. 16,000 SF / \$9.3 million / Hardened Cat. 5 / MEP/FP/LV / New Construction / Headquarters office / 80-person training room / training offices for 9 staff / 30-person physical training gym with showers / lockers & storage / break room / secure entrance/reception / climate controlled K-9 kennels for short-term care.



PROTECT & SERVE

DOCUMENTS

Resumes



Mark Kramer, El Principal/Division Director - Sarasota - OCI

Mark leads OCI's Sarasota region and is experienced in the design of education, multifamily, commercial, aviation, government, public safety, healthcare, recreation and industrial facilities. His principal areas of design include interior/exterior lighting, power distribution (low voltage and medium voltage), fire alarm, information technology, security, and lightning protection systems. He has managed the electrical design for more than 30 similar public safety projects in the last 10 years. Mark recently completed the design of Charlotte County Sheriff's Office's new District 3 Administration Headquarters & 911 Facility and their District 4 Office, Training & K-9 facility with training rooms, vehicle storage, and emergency operations centers.

EDUCATION

Bachelor of Science, Electrical Engineering, Pennsylvania State University

EXPERIENCE

40 Years

FIRM INFORMATION

19503 South West Village Parkway
Suite A5
Venice, FL 34293

markkramer@ociassociates.com
941.957.2230

RELEVANT EXPERIENCE:

Fleet Maintenance Complex, Manatee County Sheriff's Office - Palmetto, FL
Sr. Project Engineer, Completion Date: Est. 2028 / 27,500 SF / \$10 million / MEP/FP/LV / New Construction / closed apparatus service bays / vehicle lifts / hazardous & equipment storage / separate Vehicle Speed Calibrator in a dedicated building for safety precautions / staff offices / lobby / breakrooms / restrooms & lockers / supported by a 625 kW Generac back-up emergency generator

Public Safety Operations Complex, Hillsborough County - Tampa, FL
Sr. Project Engineer / 92,400 SF / \$36.1 million / LEED® Certified / Hardened Cat. 5 / ME/FP / New Construction / Design-Build / Administration & Emergency Operations Center building / Fleet Maintenance building / Fire Training Burn Building / Warehouse / 250-person incident command room / 94 work stations / dispatch center / 6 breakout rooms / offices for fire rescue staff / training center / call center / information technology center / Office of Emergency Management

Sheriff's District 4 Office, Training Center & K-9, Charlotte County Sheriff's Office - Englewood, FL
Sr. Project Engineer / Est. 16,000 SF / \$9.3 million / Hardened Cat. 5 / MEP/FP/LV / New Construction / Headquarters office / 80-person training room / training offices for 9 staff / 30-person physical training gym with showers / lockers & storage / break room / secure entrance/reception / climate controlled K-9 kennels for short-term care / 60-vehicle parking with SWAT & trailer space / emergency generator

Sheriff's District 3 Administration HQ & 911 Facility, Charlotte County Sheriff's Office - Punta Gorda, FL
Sr. Project Engineer / 40,000 SF / \$19 million / Hardened / MEP/FP/LV / New Construction / 2-stories / multiple sheriff's divisions / 2-bay fleet maintenance space / parts storage & workshop / secure reception / offices / communications/dispatch center / data center / 911 radio / real time information center analysis / operational support / investigations / intelligence, interview rooms / records storage / supply/receiving / 247-person community room / conference rooms / breakroom with kitchen / emergency generator & central energy plant

Fire Station #32 & Logistics Building, Immokalee Fire Control District - Ave Maria, FL
Sr. Project Engineer / 22,000 SF / \$10 million / Cat. 3 / MEP/FP/LV / New Construction / Joint-Use Facility / 3-bay fire station / logistics building to operate during emergencies

Fire Station #30, Immokalee Fire Control District - Immokalee, FL
Sr. Project Engineer / 2-Bays / 10,000 SF / MEP/FP / Cat. 4 / New Construction / Prototype Station / apparatus bays / emergency generator / board room & training space / lobby & reception / offices / decontamination room / gear storage / maintenance & repair & air room / watch office / storage space / public bathroom / living & sleeping quarters / kitchen / dining space / fitness room



PROTECT & SERVE

DOCUMENTS

Resumes



Gary Wydock, EI

Principal/Division Director - Fort Myers - OCI

Gary leads OCI's Fort Myers region and is responsible for the office operations, client relations, project management, and design. His principal areas of design include HVAC, plumbing and fire protection systems for new construction, renovations, replacements, and upgrades, plus he is extremely knowledgeable in the design of correctional, federal, municipal, institutional and educational facilities. He has lead the mechanical designs for more than 35 public safety facilities, including 5 coastal Fire Stations for Captiva Island Fire District, Bonita Springs Fire Control & Rescue, and Immokalee Fire Control District and will serve in the same capacity for the City of North Port.

EDUCATION

Bachelor of Science, Mechanical Engineering, Pennsylvania State University

EXPERIENCE

41 Years

FIRM INFORMATION

9728 Commerce Center Court
Fort Myers, FL 33908

gary@ociassociates.com
239-454-5117

RELEVANT EXPERIENCE:

Sheriff's District 4 Office, Training Center & K-9, Charlotte County Sheriff's Office - Englewood, FL

Sr. Project Engineer / Est. 16,000 SF / \$9.3 million / Hardened Cat. 5 / MEP/FP/LV / New Construction / Headquarters office / 80-person training room / training offices for 9 staff / 30-person physical training gym with showers / lockers & storage / break room / secure entrance/reception / climate controlled K-9 kennels for short-term care / 60-vehicle parking with SWAT & trailer space / emergency generator

Sheriff's District 3 Administration HQ & 911 Facility, Charlotte County Sheriff's Office - Punta Gorda, FL

Sr. Project Engineer / 40,000 SF / \$19 million / Hardened / MEP/FP/LV / New Construction / 2-stories / multiple sheriff's divisions / 2-bay fleet maintenance space / parts storage & workshop / secure reception / offices / communications/dispatch center / data center / 911 radio / real time information center analysis / operational support / investigations / intelligence, interview rooms / records storage / supply/receiving / 247-person community room / conference rooms / breakroom with kitchen / emergency generator & central energy plant

Fire Station #32 & Logistics Building, Immokalee Fire Control District - Ave Maria, FL

Sr. Project Engineer / 22,000 SF / \$10 million / Cat. 3 / MEP/FP/LV / New Construction / Joint-Use Facility / 3-bay fire station / logistics building to operate during emergencies

Fire Station #30, Immokalee Fire Control District - Immokalee, FL

Sr. Project Engineer / 2-Bays / 10,000 SF / MEP/FP / Cat. 4 / New Construction / Prototype Station / apparatus bays / emergency generator / board room & training space / lobby & reception / offices / decontamination room / gear storage / maintenance & repair & air room / watch office / storage space / public bathroom / living & sleeping quarters / kitchen / dining space / fitness room

Fire Station #181, Captiva Island Fire District, Captiva Island, FL

Project Manager / 9,800 SF / \$3.5 million / Cat. 5 / MEP/FP / New Construction / 2-stories / Fire Station / 3 back-in Apparatus Bays / living quarters with bunk rooms that accommodate 6 fire fighters / fitness room / day room / report writing / kitchen / dining area / emergency generator / underground stormwater & septic tank with lift station

Public Safety Complex, University of Florida Police Department - Gainesville, FL

Sr. Project Engineer / 36,000 SF / \$21.6 million / Pursuing LEED® / MEP/FP / LV / New Construction / campus' main Shelter-in-Place facilities in the event of emergency / law enforcement patrol operations / criminal investigations / employee training / equipment quartermaster / public safety dispatch & alarm monitoring / video surveillance monitoring / Emergency Operations Center / police records / administration & finance / victim advocacy / accreditation & internal affairs / evidence storage & processing / public safety rolling asset storage



PROTECT & SERVE

DOCUMENTS

Resumes



Matthew Knight Estimator II

Matthew Knight has over 16 years of Construction Management experience. He has completed work on 32,000 square feet and almost 33 acres of municipal projects. Mr. Knight's capabilities include managing and coordinating multi-million-dollar construction projects beginning with the design phase through the handover and closeout phase. He is skilled in Budgeting, Analytical Skills, Operations Management, and Production Management. Mr. Knight has directed contractors in organization, scheduling, and implementation throughout projects.

EDUCATION

Associates of Science in Construction Management, 2016, Valencia College

Associates of Science in Civil/Surveying Engineering, 2016, Valencia College

REGISTRATION

Building Construction Specialist
Drafting w/ Specializations in
Architectural Drafting
Drafting in AutoCAD
OSHA 10 Hour

FIRM INFORMATION

7335 Lake Ellenor Drive
Orlando, FL 32809
P:321.299.3791
mknight@kmiintl.com

EXPERIENCE

16 Years

RELEVANT EXPERIENCE:

Cape Coral Police Training Facility - Cape Coral, FL

Cost Estimator, Completion Date: 2022 / 36,855 SF / \$16.3 million / Cost Estimator for the Cape Coral Police Training Facility. / Developed concept estimates based on program provided by Architect and Owner. Developed Program and Cost at Design Development Drawing Level to ensure project was on budget throughout the Construction Drawing Development process / **with Mr. Lohrum.**

Collier County EMS 74 - Collier County, FL

Cost Estimator, Completion Date: 2022 / 17,882 SF / \$6.3 million / Cost Estimator for an Emergency Medical Services station. / Developed concept estimates based on program provided by Architect and Owner. Developed Program and Cost to continue design through development of Construction Documents. Assisted in Value Engineering to keep project in budget throughout design.

Seminole County Fire Station No. 25- Seminole County, FL

Cost Estimator, Completion Date: 2022 / 65,340 SF / \$8 million / Cost Estimator for a Fire Station. / Responsible for providing estimates for schematic design documents, design development documents, and 90 percent construction documents.

Columbia County EOC - Columbia County, FL

Cost Estimator, Completion Date: 2022 / 36,885 SF / \$8 million / Cost Estimator / Responsible for developing an Estimate of Probable Costs based on the drawings prepared by the client.

Osceola County Traffic Offices- Osceola County, FL

Cost Estimator, Completion Date: 2022 / 40,000 SF / \$13 million / Cost Estimator / Responsible for developing two Concept Estimates at 50 percent Concept, one of which was selected at 100 percent Concept.

Lake County Public Safety Logistics- Osceola County, FL

Cost Estimator, Completion Date: 2022 / 1,045,440 SF / \$5 million / Cost Estimator / Responsible for developing concept estimate based on program provided by Architect and Owner. Developed Program and Cost to continue design and development for project.



DOCUMENTS

Project Approach

To ensure that your vision is realized, our design team begins each project with a Synergetic Design Process that incorporates input from all project stakeholders. “We do our homework before showing up on site,” prior to the start of the project. This includes reviewing existing documentation and requesting additional information that may be critical to the project. Questionnaires are created and distributed in a logical order (each questionnaire will target the level of information desired). An overview of long-term issues, goals from upper-level staff, and other agency requirements.

Tours of similar facilities have proven to be beneficial. Much can be learned regarding the needs and desires of a staff while touring recently completed facilities and dialoguing with peers. While we realize there are a number of issues in common for Police & Fire Facilities across North America, we also recognize that each agency and its facility needs are unique and that the most appropriate solution for one agency is often very different for the next. **Each agency has very specific requirements and constraints that relate directly to its operational structure, training needs and objectives.**

LAW ENFORCEMENT PLANNING

We use successful processes to develop proof-of-concept and final design solutions for law enforcement planning and practice. Below is a list of the main items we will consider when planning your new facility:

- Program operational understanding
- Planning for the future
- Detailed work plans and project schedules;
forecast projects with long lead times and aging of safety and technology
- Basic system design requirements
- Appropriate citizenship/aesthetics – assessing the
- Adequacy of existing facility identity
- Phased refurbishment/new facility to maintain a safe and efficient work environment
- MEPSS planned for the future – capacity, redundancy, flexibility (24/7 rooms and non-24/7 rooms, separation of potentially hazardous rooms such as evidence or laboratories)
- Suitable, durable surface, especially suitable for 24/7 use.
- Efficient use of space - modules for use with existing structural grids; or efficient planning modules for new uses
- Emergency/generator power and UPS; continuous communication/connectivity
- Include sustainability – assess goals early
- Safe and welcoming location and architecture; includes discrete safety components
- Active functional safety
- Effectiveness of communication towers
- Contains natural light

FACILITY SECURITY

An act of terrorism directed toward a Public Safety Facility

can be multi-faceted, including chemical, biological or dynamic, such as the use of explosions or the use of traditionally benign “carriers” in unique applications (airplanes, vehicles, etc.). One major criterion for the creation of a facility security system is to think in terms of an integrated system that creates an envelope or perimeter that is supported by layers of systems. Singular systems can be overcome much easier than those systems which are multi-faceted and interconnected. It is critical to maintain a zone of “controlled approach” relative to vehicles or transported elements that can pose a threat. Video monitoring of the site at its perimeter, security fencing, and intrusion alarm systems are just a few ways in which to provide levels of security.

Typically, most essential buildings should have limited points of access, generally a singular public entry and a separate point of staff access into the facility. Entry to your facilities must be controlled with a variety of systems including: CCTV monitoring, electronic locking devices at doors, and voice communication (push-to-call) capability.

These systems are generally “discrete” in that they are non-obtrusive while providing the necessary security functions. Similarly, all items brought into the building by a visitor can be screened and state-of-the-art technology to accomplish these tasks is readily available. Deliveries of products, supplies, and mail pose unique threats to a facility. Some entities have elected to locate separate facilities to accommodate these functions in order to protect against total building failure from contaminants such as Anthrax or introduced air borne pathogens. CPTED (Crime Prevention Through Environmental Design) principles will be utilized throughout the design of your new Police Facility. There is a clear need to provide separation between public accessible spaces and those functions which are more secure.



IMPORTANCE OF TRAINING

Today’s Police & Firefighters are well-trained professionals. The consistent emphasis on preparation for emergency response and building skill sets to be prepared for a diverse variety of safety, rescue, hazmat and other skills is

DOCUMENTS

Project Approach

vitaly important to coming home safe. Our team always recommends a design that integrates “built-in” training features that can best be achieved through experience with public safety design and by engaging highly with folks who will use the facility to understand and provide for their diverse training needs.

Our team will work to understand your specific emergency response requirements, along with on-going maintenance needs. We will seek to creatively address each technical design challenge that will make the Training Complex easy to use and durable for the long term. We take pride in using our creativity to respond to the correct Measures of Success for your project and will do these things in the context of understanding that prudent use of budget dollars is always a central concern.

COST CONTROL

Cost control and keeping your project under budget is an important aspect of providing quality control for your project. Controlling your costs will be about understanding the complete scope and all design components being implemented. During design, getting consensus on all materials and building systems as early as possible will help keep the project on budget. Our team tracks detailed costing numbers for past projects and current projects which will give the City an insight into past and current market trends. Our systems engineers, OCI will look at the life cycle costs for systems can help make sure the City has all options available when making important project decisions. Our cost estimator, KMI in concert with the Construction Manager, will also perform an estimate at every milestone. This is an open book process to be discuss and reviewed with the City & your selected Construction Manager to help maintain the budget. **KMI is an international Construction Manager with their finger on the pulse of 100’s of currently bidding projects around the state. Therefore their estimates are incredibly accurate and can be relied on.**

SCHEDULE / MANAGEMENT

Our team takes your schedule very seriously and has an excellent track record for maintaining even fast-tracked schedules with changes typically only coming at the request of our clients. Mr. Lohrum has spent the last 22 years developing a unique process for maintaining project schedules. At the onset of the project Mr. Lohrum will issue two types of schedules. The first schedule is developed in concert with all parties that will be involved in the project and is a simple gantt chart denoting all major milestone elements from design thru construction. Our team prefers to have owner/design workshops every two weeks for the duration of the project. This give us enough time to bring updates to the table that are productive and we have found that this is enough time for you to digest and make decisions. The second schedule is a detailed schedule that lists every single meeting we will have for the entirety of the project, including every task we want to accomplish during each of those meetings. Mr.

Lohrum will issue a project agenda 1 week in advance of each of those meetings which allows the City to alert the appropriate people that need to attend. Meeting minutes are issued within 3 days of that meeting to document everything including a spreadsheet with a task lists of all items that need to be completed. This schedule is a “living” document that is constantly updated based status and scope of the project.

To help avoid a lag in reviews of each milestone submittal, we recommend a “page turn” of every single document being submitted, as a group, which allows one concerted and efficient effort for owner quality control of the project. We have found that this process has helped us and our clients maintain projects of all size and types of projects.

LEED® / SUSTAINABILITY

Sustainability is an important issue that our team takes seriously. Our team has been involved in hundreds of sustainable projects certified under programs such as LEED, Green Globes and WELL. **We believe that the most important aspect of sustainability is reducing your energy usage and in turn reducing your costs.** We will work to provide a sustainable project that is certified (if required), energy efficient, cost effective, utilizes appropriate materials but most importantly utilizes “common sense” sustainable strategies.



CRITICAL CONSIDERATIONS/ESSENTIAL FACILITIES

While your training facility does not necessarily need to be designed as an essential facility per the Florida Building code, we will often recommend allowing our team to investigate and prepare options for hardening some or all of the administrative components within the facility. This gives the City flexibility in having additional back-up systems, bunking and operational space to operate during an activation, if desired. Our team has extensive experience designing similar facilities and understands the importance and critical use nature of Law Enforcement Facilities, due to their fundamental mission to support the community during events or deteriorated service conditions. Our Team’s approach is based on a comprehensive evaluation of anticipated needs including:

DOCUMENTS

Project Approach

enhanced structural capacity, emergency or redundant power supply, redundant communication and data distribution, back up HVAC, as well as potable water and sanitary conveyance to support the facility occupants for extended periods.

Our team has also been successful in securing grants (FEMA/AARA) including state and federal sources to subsidize enhanced protection or Communication Center functions. In addition, our team's experience includes protection of facilities' from potential terrorist activities including application of FEMA 426 – Reference Manual to Mitigate Potential Terrorist Attacks. This standard addresses critical design features including:

1. *Vulnerability Checklist Assessment*
2. *Security systems*
3. *Standoff distances for blast protection including adherence to UFC-4-010-02 DoD Minimum Anti-Terrorism Standoff Distances*
4. *CPTED – Crime Prev. Through Environmental Design*
5. *HVAC design considerations, including integration of Centers for Disease Control (CDC) and Prevention, NIOSH*
 - a. *Elevation of fresh air intakes*
 - b. *Isolate HVAC zones*
 - c. *HVAC system quick shutoff features*
 - d. *Ducted air returns*
6. *Electrical design considerations including:*
 - a. *Separate and isolated emergency and normal electrical panels and conduits*
 - b. *Secure emergency generators and fuel storage*
 - c. *Accommodations for back-up generator connection and manual transfer switch*
 - d. *Coordination of site lighting for CCTV*
 - e. *Illumination of building access points*
7. *Fire Protection features include:*
 - a. *Protection from single point of failure*
 - b. *Separate dual pump arrangement (electric and diesel)*
8. *Communication systems to include:*
 - a. *Redundant communication systems*
 - b. *Separate conduit for communication and alarm systems*
 - c. *Mass notification system*
 - d. *Telecommunications equipment*
9. *Space must be allocated for communications and information processing equipment.*

COMMUNICATIONS / APPROACH WITH THE CITY

j12 Architecture is located in Longwood, FL and this is where Mr. Lohrum will manage the team from. The consultants are a group of local consultants that will perform a majority of the production scope from their local North Port area office locations. These consultant are the **SAME CONSULTANTS** that have been working on your new Police Headquarters, Emergency Operations Center and Fire Headquarters. Having these consultants

right down the road will be invaluable to the success of the projects. Mr. Lohrum was successful for nearly 2 years operating and managing those same three projects with the same organizational model. **We encourage you to discuss those projects with current Police, Fire & Emergency Management staff as we are confident they will report that the city was Mr. Lohrum's priority and the City would not have known the difference of whether or not the project was being managed from a distance or right up the road. j12 Architecture prides itself in putting clients first.**

While we prefer in-person meetings we do have technology capabilities to assist our team in addressing your needs throughout the design and construction of the project. Some of the tools we successfully use to enhance our process are: Teams, iPhones & iPads, remote document access, BIM software, BlueBeam and Plan Grid. We are also proficient at using owner, architect, contractor user interfaces such as E-Builder & Procore.



PHASE ONE

PROJECT KICK OFF

An initial project meeting will be held and we believe its important for all stakeholders including the Police Department, Fire Department, elected officials, IT, Facilities, Maintenance and Engineering. It will also be important for a CORE group of users to be established as the decision makers. **This ensures that our team works as a partner and establishes a process allowing decisions to be made during critical meetings keeping the project on schedule.** This initial meeting covers topics such as project management, lines of communication (and other resources access), project milestones schedule, key staff availability for interviews/meetings, review of the work plan, and identification of key issues and goals of the project team representatives. Deliverables are defined in the project work plan and formalized with client input.

This work plan and associated project schedule are used to guide the process and gauge progress. It will also establish appropriate milestones and important presentations to other stakeholders and decision makers such as the City Commissioners. The work plan is important to both the

DOCUMENTS

Project Approach

client and the consultant team as a communication and accountability tool to aid in keeping the project on track. With numerous project participants and stakeholders it is paramount to keep all parties informed and assure understanding along the way. Meetings will be established on the basis of the entire team’s availability but usually occur weekly or bi-weekly throughout the design period.

Our project manager, Johnnie Lohrum Jr., will be your primary point-of-contact from your project’s inception through construction. Mr. Lohrum has two decades of experience working with municipal clients and has been the Principal-In-Charge on projects throughout the state of Florida including recent Law Enforcement such as DeLand Police Evidence & Fire Station 81, Daytona Beach Fire Headquarters, Ocoee Law Enforcement Facility and the Cape Coral Police Training Facility. He has also worked in the surrounding communities on multiple public safety projects over the past several years and will bring this knowledge of your local standards and expectations to your new project.

Milestones	2025	2025	Remarks
Program Phase	Facility Staff	Facility SF	
Spaces			
PD 1.00 Public Spaces	0	1,202	
PD 2.00 Training and Support	0	10,065	
PD 3.00 Administration	2	220	
PD 4.00 Shared Staff Areas	0	1,582	
PD 5.0 Main Building Support Spaces	0	335	
Total Net Assignable Square Feet		13,404	
Total Staff (Sworn + Professional)	2		
PD Program			
Sub-Total Net Assignable Square Footage		13,404	
Sub-Total Net Square Footage		13,404	
Grossing Factor	0.15	2,011	
Total Gross Square Footage		15,415	

PROGRAMMING / NEEDS ASSESSMENT

Following the kickoff meeting, seminars are held to provide a context for the requirements of the new facility and subsequent staff interviews gaining in-depth knowledge of the project. The j12 Architecture team will use a series of presentations and charrettes to communicate that the user groups support and direction are incorporated into the project. The previously developed questionnaires will be used to assist in gathering important project planning details about the function of every aspect of the facility. The City has provided a list of required spaces for your new facility. Even though you have provided this comprehensive list of spaces we feel it will be important to go through our process listed below to help better understand your operations and needs before finalizing a design for your new facility. Our initial space needs analysis will provide square footage protections at multiple milestones such as 10, 20, and 30 years allowing the City to determine the appropriate sized facilities while determining an appropriate budget. This information will be assimilated into a draft space program document to be presented to staff. **Our synergetic design process focuses on the understanding of your day-to-day operations as**

this will inform and help to set up the basis for a design that enhances your operational efficiency and workflow.

DATA GATHERING

Stakeholder Meetings

In preparation for stakeholder meetings / travel, our team will analyze City/stakeholder information received and prepare questions for effective dialogue with participants of each public safety group, and invite representatives of all groups to provide input in separate focus group meetings regarding a variety of topics (security, fitness, technology, shared support spaces, etc.). We will meet with each group to gather information and discuss project goals and concepts relative to developing appropriate space needs. The process is interactive, utilizing marker boards, power point presentations (spreadsheets, photos, and graphics) to assure effective communication.

Preliminary Findings

We will develop preliminary findings that identify decisions made and potential issues requiring additional discussion and clarification. We can discuss preliminary findings to help us prepare for an effective data synthesis, making the best use of stakeholder time.

Data Synthesis

Our team anticipates meetings on site with the various stakeholder groups, with an ability to present information developed since the initial site visit, and modifying content as new information is received and decisions are made. We want to ensure clear communication and a common understanding.

These meetings involve an introduction to the preliminary space needs, adjacencies and circulation, inclusion or deletion of additional spaces, as we gain a more complete understanding of the proposed new public safety building.

We will again anticipate using a large markerboard and projection screen or video display, to accommodate updated information being presented back to stakeholders during each meeting, along with the ability to sketch new or updated ideas. **Our meetings will address the constraints and opportunities anticipated by bringing all police, communications, Fire, EOC, and information technology together in a public safety building. We will address functional effectiveness of staff adjacencies and workflow, to accommodation of the various public visitor types, and how each should be accommodated.** This process will yield a realistic understanding of what support space can be shared, and what must be dedicated.

Staffing Evaluation / Benchmarking Analysis

We anticipate working with City staff to identify current and future staffing needs, and evaluate against similar public safety agencies for comparison. This analysis will utilize UCR data regarding full time sworn and civilian staffing, staffing factors such as crime data, population,

DOCUMENTS

Project Approach

geographical size, etc. This study will seek to account for new programs and changes to departmental organization.

Room Criteria Sheets Development

This task develops more detail regarding the architectural, structural, mechanical, electrical, plumbing, and special systems requirements on a room by room basis, and can provide greater confidence in a needs assessment level cost estimate. The input is also helpful in memorializing unique and specialized stakeholder requirements, and provide direction to the subsequent design team. The process can be done virtually, and can be time consuming to get the various input from public safety building stakeholders. We will start the process by developing an initial set of criteria sheets so we have something to refer to and modify. Once we receive your input, regarding the building overall and individual spaces, we will review and schedule other meetings to review and update the initial criteria sheets. We will develop an updated draft document and issue for final comments, and then the final document.

PROGRAM VALIDATION

Our team will review and validate the program to confirm there are no desired client revisions through a series of interviews. Following the first round of interviews, we will present its our preliminary findings. This provides the team with the opportunity to share with the City of North Port the new ideas and concepts that have been generated thus far and will ultimately reveal the direction of the project. The validation process also aids in the understanding of vital project information, leading to confident decision-making. Additionally, the validation interviews allow the consultant team to make certain it has accurately heard the client and for both consultant and client to test the information developed. Once this process has been completed, the basis for initial and future space needs, demands on infrastructure, along with the operational requirements, and spatial adjacencies allow for reasonable project costing. **We will work closely with your selected Construction Manager at this point, to coordinate project sizing, materials, schedule and budget.**

MULTI-USE SPACES

As we develop an appropriate program and needs for your new facility there may be needed spaces that won't be in use 100% of the time on a day-to-day basis. Some of those spaces may be training rooms, media room, classrooms, break rooms and conference spaces. For example, many departments have the need for a large training classroom but their budgets can not afford the cost of the additional square footage for a space that may sit empty 90% of the time. At the new Ocoee Training Facility, we designed several smaller classrooms separated by operable partitions that when opened allow for one larger training classroom. We will work closely with you to understand how this kind of multi-use space strategy can work for your new facility.



SITE ANALYSIS / MASTER PLANNING

Our team will help management to evaluate potential sites by evaluating surveys, environmental, utilities, traffic, geotechnical and storm water requirements. Site recommendations, rankings, evaluations and selection will depend on user input and community engagement.

At this point in the process we will work with AM Engineering, to develop a master plan with secure and unsecured zones for public and private use. Facility entry, along with CPTED design solutions around the building, will bring the necessary site security together with the Space Needs Assessment square footages to develop the actual building area.



SCHEMATIC DESIGN

Our Civil engineer AM Engineering with whom the City is currently working with on your new main PD campus, will work closely with the design team to study all aspects of potential sites including environmental, utilities and permitting requirements. Early permitting applications and conversations will begin now to help expedite the site development process. **Using this site information will assist in developing a master plan with secure and unsecured zones for public and private use.** During this phase we now have enough technical information to

DOCUMENTS

Project Approach

begin visualizing your goals through 3-D imagery, sketches and models. This is a hands on collaborative process done through workshops and charrettes. At the end of this phase we will have developed a master plan, floor plans and building imagery for approval by all necessary parties. **Our consultant KMI will also develop the first of several cost estimates in coordination with the City's selected Construction Manager to help establish a cost base line helping the City to develop an appropriate cost estimate for the phase two portion of the project.**

At this point in the project our team would help the City prepare all documentation and presentation materials for presentations to Council in determining the strategic planning for moving forward. Our team will remain fully staffed and will be at the ready to kick-off Phase Two.

PHASE TWO

DESIGN DEVELOPMENT

When the design concept is finalized we will begin to develop a more detailed set of drawings and specifications. All building systems such as electrical, mechanical, fire and structural will be integrated into the drawings at this point. At this point we will also take the opportunity to meet with the AHJ to collaborate on a courtesy review of the documents. **This initial review will allow the AHJ to issue any major concerns early in the project so it can be addressed without affecting the budget or schedule later on.** A Public Safety Training Complex operates with long hours and will require materials that accommodate this. All materials selected must be cost effective, maintenance friendly and must last a long time. **Our interior designer, will work closely with the design team and City staff utilizing their extensive law enforcement, training and fire experience to create an accurate environment for your facility.**

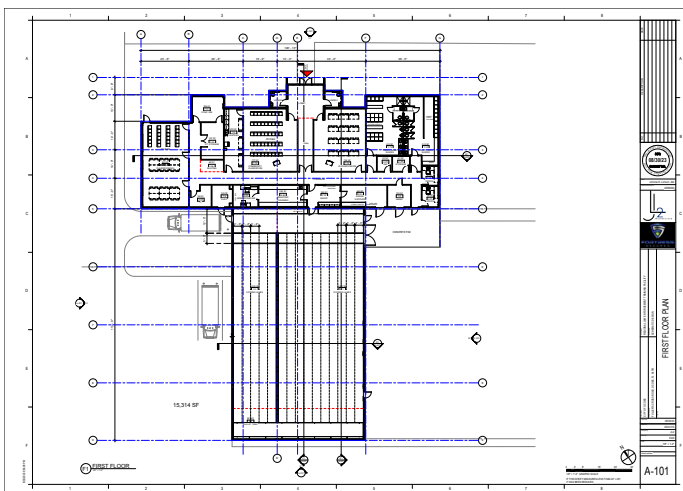

It also at this point in the project where our Civil and Environmental engineers will begin submitting all documents required for early permitting of all site related

items. This will expedite the project's permitting process and reduce the overall project schedule.

CONSTRUCTION DOCUMENTS / BIDDING

Once we reach this phase, the project design should be finalized and the design team is focused on the development of construction details and coordination with the specifications. Many times a 90% construction document set is submitted to allow the City a final opportunity to make any necessary changes. **An estimate from our consultant or the selected construction manager will be utilized at this point to verify the project is still on budget while maintaining your vision and goals.** The project will not move into bidding without approval from the owner and other required agencies. Our entire team will participate in the bidding process, acting as an owner's representative by reviewing advertising, pre-bid rfis, addenda and attending any required pre-bid conferences.

CONSTRUCTION ADMINISTRATION

The design team will remain involved with every aspect of the project throughout construction. **At this point, the same design team you worked with during design will serve as your Construction Administrators with boots on the ground and accessibility whenever needed.** While we have the capability for off-site electronic meetings, we feel meetings in person are more effective. We will attend construction meetings as necessary to appropriately complete the project. **Our tasks during construction administration typically involve: shop drawing reviews, submittal reviews, RFI reviews, construction quality evaluation, site safety evaluation, payment application reviews, change order reviews and all required close out documents.**

Our entire team has spent decades specifically working with Law enforcement, municipal and public safety clients. Through this experience we have developed specific protocols for handling critical secure documents. For example, while managing the Sheriff's evidence facility for the County of Volusia, Johnnie used several methods for controlling sensitive security information (SSI). Volusia County utilizes their own secure document transfer program called VCBizcom. Mr. Lohrum, had his own secure VCBizcom account in which SSI were transferred electronically. We will also never e-mail SSI documents as attachments.

Our team also utilizes our own internal secure document transfer program called "share file". The program is an encrypted, completely secure transfer system that allows both the design team and the owner to assign password encrypted files. These file transfers are also typically assigned a short time period for the person receiving the files to download before they are automatically deleted. On occasion, a client may have hard copies of important existing documents that can not be scanned or leave the owner's property. When that happens Mr. Lohrum will

PROTECT & SERVE

DOCUMENTS

Project Approach

coordinate with the owner's project manager to schedule properly monitored meetings for design team members to review the documents on site.

ADDITIONAL CAPABILITIES

Our entire team utilizes BIM software in the development of our design construction documents and specifications. We will establish a BIM execution plan with the City, at the start of the project to ensure the City, selected contractor and entire team is all on the same page on the level of detailed construction documents that will be prepared.

The type of drawings prepared utilizing BIM are superior in that they are more coordinated, thorough, efficient, contain more information and generally help to save schedule time since drawings can be completed and coordinated faster. This model can be issued to the contractor at every project milestone helping to increase project productivity and accuracy.

During construction the model can be used for "clash detection" eliminating in the field unforeseen errors which decreases change orders and save tax payer dollars. Other technology that helps us produce efficient, accurate & detailed documents is: I-phones, I-pads, portable laptops, Revit (BIM), AutoCad, Sketchup, 3-D Virtual software, Adobe Photoshop, In-Design, Excel & Microsoft Office. While we prefer in-person project meetings, on occasion it may be necessary to utilize other Web based communication platforms such as Microsoft Teams. For project reviews and coordination, we will issue a team wide invite to a Bluebeam review session allowing efficient, accurate & real time reviews of the construction documents. **Our knowledge and technical abilities will allow the project to be developed at an increased pace while still maintaining accuracy, quality and the City's vision.**

QUALITY CONTROL

We look at quality control through a lens of "assurance" to the City that the documents and product we deliver will be reliable and exceed your expectations. To do this we have developed a very detailed check list document for every project design phase. This checklist helps to:

- keep the project in budget
- cost effective detailing
- clear and precise specifications
- consistent internal design team coordination meetings
- early courtesy code reviews with AHJ
- appropriate testing requirements within documents
- utilize our long-standing knowledge of City standards
- establish clear & early permitting schedule

Our process is centered around a 4 step proces:

1. **Written Quality Assurance Plan**
 - Roles
 - Communications
 - Work Breakdown
 - Deliverables
 - Detailed Project Schedule

2. **Real Time Approach**
 - Labor-hour budgets
 - Quality Staff
 - Accountability
 - Continual Testing
3. **Q/A Checklist Per Milestone**
 - Senior Level Reviews
 - Page Turns w/ Clients
 - Coordination w/ Contractor
4. **BIM Delivery Methods**
 - Improved Visualization
 - Multi-Disciplinie Coordination
 - 3rd Party Validation
 - Discrepancy & Collision Reports

The bottom line is, nothing will be issued to the City until it has been verified and checked multiple times on our end first.

j12 Architecture is excited about the opportunity to utilize our successful synergetic design approach, developed specially for Law Enforcment projects, on your new Training Complex.



PROTECT & SERVE

DOCUMENTS

Organizational Chart-Personnel



Dean Roberts, AIA
Public Safety Architect

MWL



Johnnie D. Lohrum Jr., RA LEED® AP
President / Project Manager
(Day-to-Day Contact)

j|2 Architecture



Design

Jacek Flejsierowicz, AIA
Design Architect

j|2Architecture



Renwick Daelo, AIA
Project Architect / Production Support

j|2Architecture



Dave Willson, RA
Public Safety Architect

MWL



Jim McClaren, AIA
Public Safety Architect / Quality Control

MWL



Subconsultants



Civil, Environmental, Surveying



Landscape Architectur



Structural Engineers



Mechanical, Electrical, Plumbing, Security, Fire rotection



Grant Opportunity Coordination



Estimating / Construction Administration

PROTECT & SERVE

DOCUMENTS

Organizational Chart-Corporate Management

jl2 Architecture, LLC is an Architectural firm that brings together over 20 years of strong relationships and experience throughout the entire state of Florida. Our focus is on public safety, municipal and civic oriented projects that enhance the environments of our local community. **Johnnie Lohrum Jr., President, has actively managed nearly 5 million sf of municipal, community and public safety projects such as the University of Florida Public Safety Facility, Cape Coral Police Training Facility, Ocoee Law Enforcement Training Facility and the Charlotte County Sheriff's Training Facility.**

jl2 Architecture is the entity responsible for execution on behalf of the proposal team.

A brief profile of the firm, including:

1. A brief history of the business
Located in Longwood, Florida our focus is on municipal and civic oriented projects that enhance the environments of our local community.

2. Business Structure, Type of Ownership
Limited Liability Corporation

jl2 Architecture is an Limited Liability Company with majority ownership held by Johnnie Lohrum Jr.

3. Length of Companies Existence
Mr. Lohrum has been providing public safety design and management throughout the state of Florida for over 20 years. jl2 Architecture's main office is located in Longwood, Florida and was established in 2022.

4. Total number of personnel
jl2 Architecture is comprised of four partners, a 35 year design Architect, a marketing specialist, accountant, construction manager and supported by production staff and multiple engineering firms (Civil, Landscape, Structural, MEP) that have had professional working relationships with Mr. Lohrum for over 20 years.

jl2 Architecture is a full service architectural and interior design firm in good solid financial and personnel standing. Our continued focus will be on municipal, community and public safety projects located in Florida with a strategic intense focus on strong, real relationships.

Johnnie D. Lohrum Jr., RA LEED® AP
President

Renwick Daelo, AIA
Director of Operations

Eugene Damaso, AIA
Director of Design

Carrie Schultz, PA
Director of Finance

Elizabeth Lohrum
Director of Marketing



PROTECT & SERVE

DOCUMENTS

Schedule / Timeline

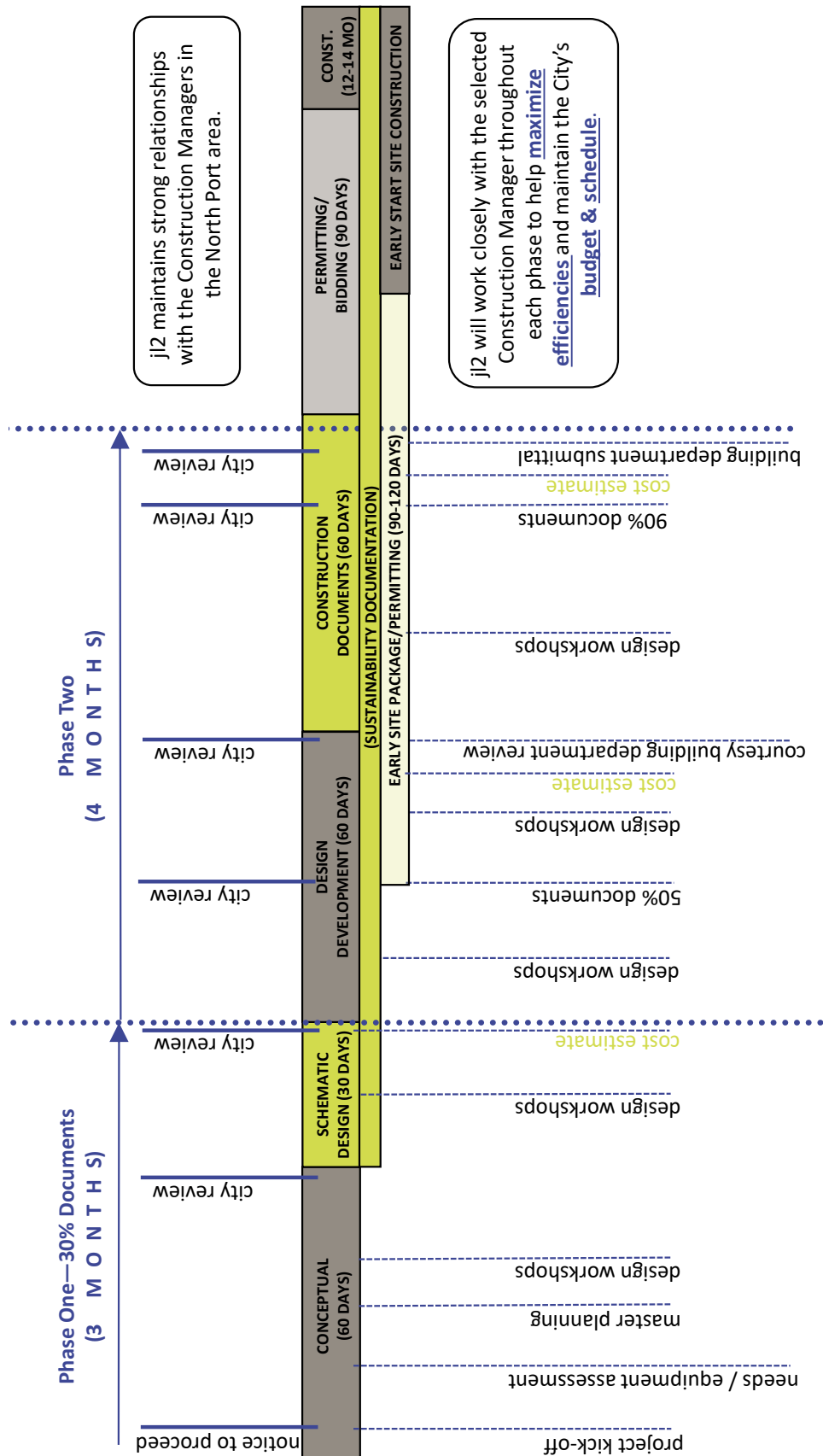

PROTECT & SERVE

DOCUMENTS

Additional Information-Project Planning

The **j12 Architecture Team** would be incredibly grateful for the opportunity to design your new Training Complex. As described in our detailed approach for your project, the design phase is very collaborative relying on the City's vision for what this project wants to be. This is your project and vision, not our teams. Therefore, while we would welcome the opportunity to provide a draft conceptual design with this proposal, we just don't think that is prudent as we would be designing in a vacuum without the most important ingredient, which is you.

We have however done a lot of research, analyzing your stats, demographics, agency size and knowledge gained from currently working with you on your main Police Department campus, to help prepare a draft building program. **Note that this is just a draft and we still need to collaborate with you to determine your actual needs and vision.** This draft program, however, gives our team a head start on your project and would allow us to hit the ground running, **saving you significant time & money.** We understand the following about your vision & a few of your goals:

1. Complex may also be used by outside agencies for revenue opportunities.
2. Minimum of 16 PD firing lanes.
3. Minimum of additional 10 Public firing lanes, completely separate from PD functions.
4. PD/Fire will share space wherever possible.
5. Entire facility to be considered a hardened essential facility.
6. The indoor ranges will be air conditioned.
7. An outdoor vendor may be utilized for range maintenance.
8. Health and safety of all users is imperative.
9. City job classifications & functions are to be evaluated/reviewed to assist in developing a fully functional and efficient facility

	Parking				Unit Counts		Area		Comments
	Public		Staff		2054	Area Factor	2054		
	Now	2054	Now	2054					
Public Access Areas									
Main Lobby		20		30					
Secondary Public Lobby									
Seating					6	10	60	Ballistic level 5, kiosk, counter for evidence pass-thru, welcoming to public, logos/displays/pride	
Main Lobby Restrooms					2	90	180	Seating for 5-6 people	
Public Restroom- Unisex					2	90	180		
Unit Subtotal	0	20	0	30				Staff parking to be secure	
Total Parking					50				
Subtotals								920	
Circulation/Walls/Structure								30%	
Unit Gross Area (SF)								1156	
Public Range									
Lanes					10	420	4200	square footage includes stations and bullet trap area.	
Ready Room					1	180	180		
Range Supplies					1	200	200		
Support Spaces					1	200	200		
Police Range									
Lanes					25	420	10500	square footage includes stations and bullet trap area, large double or overhead doors to allow tactical vehicles access to range.	
Ready Room					1	200	200		
Armory/Repair					1	200	200		
Weapon's Cleaning					1	300	300	10 stations	
Range Supplies / Storage					1	300	300	door to exterior	
Ammo Storage					1	180	180	door to exterior	
Police Administration									
Training Classrooms					3	600	1800	15-40 people per classroom, arrange with operable walls in between to allow for one larger training classroom	
Breakout Rooms					2	200	400		
Defensive Tactics (Dedicated)					1	600	600		
Storage (Logistics)					1	400	400	Furniture for classrooms, DT equipment, adjacent to classrooms & DT storage.	
Offices					6	120	720		
Offices (Officer)					2	180	360		
Canteen					1	350	350	10-15 people, small kitchen	
Restrooms / Showers (Unisex)					8	90	720	individual restrooms w/ showers	
Lockers					1	200	200	adjacent to restrooms & showers	
Storage (Admin. Supplies)					1	100	100		
Fire Department									
Offices					5	120	600	800-1000 items stored	
Office (Captain)					1	180	180		
Classrooms					3	450	1350	25-30 people	
Storage					1	200	200	classroom equipment & furniture	
Lab					1	400	400	simulation room	
Restrooms / Showers (Unisex)					6	90	540		
Lockers					1	200	200	adjacent to restrooms & showers	
Breakroom					1	250	250	kitchen	
Apparatus Bay					4	1100	4400	double stacked, drive thru if possible, internal mezzanine for training	
Storage					1	200	200		
Subtotals								30430	
Circulation								20%	
Unit Gross Area (SF)								6080	
Building Support									
Main Electrical Room					1	200	200		
Janitorial					1	40	40		
IT Room					1	100	100		
Mechanical					1	400	400	Range equipment will be located on roof	
Subtotals								740	
Circulation								20%	
Unit Gross Area (SF)								148	
Public Access Areas	0	20	0	30				1156	
Public Range	0	0	0	0				36514	
Building Support	0	0	0	0				888	
Subtotals	0	20	0	30				1196	
Circulation								20%	
Unit Gross Area (SF)								239	
Combined Gross Area Total								38600	

PROTECT & SERVE

DOCUMENTS

Additional Information-Grant Funding

The **j|2 Architecture Team** has a significant amount of experience in helping our clients utilize grant funding and includes our grant opportunity team member, **Hale Innovation**. Hale is an industry leader in procuring grant funding for municipal capital projects. Our unique service combines grant pursuit strategy and effective writing with the professional insight of an engineer, a service founder Lee Hale, PE, has been supplying for more than 13 years. We approach capital project funding with a distinctive eye for project/grant compatibility, and our experience makes us expert consultants for project modification and phasing recommendations to increase the likelihood of successful grant pursuit.

Through participating in grant program training, reviewing previous winning submittals, speaking with grant program administrators, and tracking political initiatives, Hale Innovation’s team offers a deep understanding of each grant program’s intent. Clear and concise communication skills and a robust grant monitoring system pair with technical expertise to give Hale Innovation a proven track record of winning money for clients.

Hale Innovation understands that the City of North Port requires funding for the design and construction of a new Police Department. Public facilities like police departments can be difficult to fund through traditional grant programs. Creative solutions and framing funding needs to meet program intent can allow for less obvious funding mechanisms, such as disaster recovery, hardening, and resilience. Funding

such as FDEO’s Community Development Block Grant – Disaster Recovery (CDBG-DR) and FDEM’s Hazard Mitigation Grant Program (HMGP) have historically been used to fund public facilities and/or specific elements of construction. Minor modifications to the projects can render them eligible for these types of funding. It should be noted that these categories of grants are only available in response to federally declared disasters, but when available, they are excellent means of funding. Similarly, projects that reduce the community’s carbon footprint could be eligible for funding through programs like USEPA’s Climate Pollution Reduction Grant. Hale Innovation would also suggest discussing funding with the USDA through their Rural Development Community Facilities Direct Loan & Grant Program. Additionally, Florida Highway Safety Grant Program may provide money for construction of police stations. Hale Innovation will leave no stone unturned when it comes to obtaining grant funding for the City’s construction needs.

Hale Innovation takes a “Concept through Construction” approach to grant funding. We are a full-service funding support team. If and when a grant is awarded, Hale Innovation will also provide grant administration services to the City. Hale Innovation facilitates administrative compliance from execution of grant agreements and commencement documentation, to regularly required reporting and reimbursement requests, all the way through grant closeout. We will work closely with the City and the recipient agency to ensure each grant is managed appropriately and systematically.



PROTECT & SERVE

DOCUMENTS

Additional Information-Relevant Work History

Public safety design is our passion and is the core work that our team does. Our experience includes the planning and design of shared public safety facilities, including Police, sheriff's offices, EOCs, 911 dispatch call centers, evidence storage facilities, gun ranges, fire stations, and law enforcement training centers. We have included examples of our entire team's relevant Public Safety Experience.

DESIGN

Below we have included a matrix showcasing some of our entire team's experience designing shared and/or Law Enforcement and Public Safety facilities that include the same scope elements as your new Complex.

Project and Client Name

Project and Client Name	State of Florida Project	Training	Multi-Divisional Facility	Law Enforcement	EOC / 911 Dispatch Center	Planning and/or Programming	BIM Utilization	Stakeholder Collaboration	Fire Facility
ARFF Facility at Daytona Beach International Airport, Volusia County, FL	●	●	●		●	●	●	●	●
University of Florida Public Safety Headquarters, Gainesville, FL	●	●	●	●	●	●	●	●	
North Port Police Department, North Port, FL	●	●	●	●	●	●	●	●	●
Cape Coral Police Training Facility, Cape Coral, FL	●	●		●		●	●	●	
Ocoee Police Training Facility, Ocoee, FL	●	●		●		●	●	●	●
EOC and Communication Center, City of Palm Beach Gardens, FL	●		●		●	●	●	●	
Fox Valley Public Safety Training Center, Appleton, WI		●	●	●		●		●	●
Homeland Security Training Facility, Glen Elly, IL		●	●	●		●		●	
Police Training Center, Lee's Summit, MO		●	●	●		●	●	●	●
Elgin Public Safety Training & Sustainability Center, Burlington, IL		●	●	●		●		●	
Victor Valley Training Center, Apple Valley, CA		●	●	●		●	●	●	●
Police Headquarters, City of San Francisco, CA		●		●	●	●		●	
Fire Administration Headquarters, Sarasota, FL	●		●		●	●	●	●	●
Fire Administration Headquarters, Daytona Beach, FL	●	●			●	●	●	●	●
Orange City Police Headquarters, Orange City FL	●	●	●	●	●	●	●	●	●
Orange City Fire Station, Orange City FL	●				●	●	●	●	●
Brevard County EOC, Rockledge, FL	●		●	●	●	●	●	●	
Havert L. Fenn Special Needs Shelter, St. Lucie County, FL	●				●	●	●	●	
Columbia County EOC and 911 Dispatch, Columbia County, FL	●					●	●	●	
Police Evidence Facility and Fire Station #81, City of Deland, FL	●	●	●	●	●	●	●	●	●
Marion County Sheriff's Headquarters, Marion County, FL	●		●	●		●	●	●	
Sheriff's Administration Office and EOC, Citrus County, FL	●		●	●	●	●	●	●	
Volusia EOC and 911 Dispatch, Volusia County, FL	●		●	●	●	●	●	●	
Sheriff's EOC and 911 Dispatch, Brevard County, FL	●		●	●	●	●	●	●	
Sheriff's Evidence Storage Facility, Volusia County, FL	●			●		●	●	●	
Douglas M. Anderson EOC, St. Lucie County, FL	●		●	●	●	●	●	●	
Osceola Sheriff's West Side Command Center, Kissimmee, FL	●		●	●		●	●	●	
Charlotte County Sheriff's Headquarters / 911, Charlotte County, FL	●		●	●	●	●	●	●	
Sheriff's Public Safety Complex Needs Assessment, Sarasota County, FL	●			●		●	●	●	
Sheriff's Training Building, Osceola County, FL	●	●		●		●	●	●	●

DOCUMENTS

Additional Information-Relevant Work History

Project and Client Name	State of Florida Project	Training	Multi-Divisional Facility	Law Enforcement	EOC / 911 Dispatch Center	Planning and/or Programming	BIM Utilization	Stakeholder Collaboration	Fire Facility
Winter Park Public Safety Complex, Winter Park, FL	●	●		●	●	●	●	●	
Sanford Public Safety Complex, Sanford, FL	●	●	●	●	●	●	●	●	●
Orlando Police Headquarters, Orlando, FL	●	●		●	●	●	●	●	
Boyton Beach Police Department, Boyton Beach, FL	●			●		●	●	●	
Windermere Police Department, Windermere, FL	●			●		●	●	●	
Port St. Lucie Public Safety Complex, St. Lucie FL	●	●	●	●		●	●	●	
Sumpter County Public Safety Buildings, Bushnell, FL	●	●	●	●	●	●	●	●	
Osceola County Fire Training Facility, Osceola County, FL	●	●		●		●	●	●	●
Seminole State College Public Safety, Seminole County, FL	●	●	●	●		●	●	●	●
City of Casselberry Police Department, Casselberry, FL	●					●	●	●	
Hillsborough Public Safety Complex, Tampa, FL	●	●	●	●	●	●	●	●	●
Palm Beach County EOC, Palm Beach, FL	●				●	●	●	●	
Treasure Coast Public Safety Training Complex, Fort Pierce, FL	●	●	●	●	●	●	●	●	●
City of Hollywood Police Headquarters, Hollywood, FL	●	●		●	●	●	●	●	
Okeechobee Police Department, Okeechobee, FL	●	●	●	●	●	●	●	●	
Auburndale Police Station, Auburndale, FL	●			●	●	●	●	●	
Palm Coast Fire Station 25 & 26, Palm Coast, FL	●					●	●	●	●



PROTECT & SERVE



TEAM'S PREVIOUS
EXPERIENCE

3

TEAM'S EXPERIENCE

EXPERIENCE OF MR. LOHRUM & MWL ARCHITECTS

Example Projects

1. Police Training Facility -- Cape Coral, Florida



*Individual Experience of Mr. Lohrum. Image Courtesy of MWL Architects.

DESCRIPTION OF PROJECT / FEATURES:

The new Law Enforcement Training Center will allow the police department to train efficiently and effectively, using state of the art instructional and tactical training environments. **This new facility features a 16 lane, tactical 50 yard indoor firing range with two target systems, to accommodate pistol and rifle training that is acoustically separated from adjacent training spaces, and will safely accommodate lead and non-lead rounds.** Workshop and armory space is incorporated to maintain firearms and build and maintain props for use in the firing range. Secure ammunition storage is provided for pallet and ammunition shelving, with easy vehicle access via an overhead door. Training offices are planned to accommodate staff growth, and have direct access to the lobby/break area as well as direct access to the workshop and to respond to deliveries.

Cape Coral law enforcement trainees will access the facility through a secure vestibule and lobby/break area, with immediate access to toilet and shower facilities, and various specialized training environments. The classroom is subdividable and will accommodate 36 trainees per side, with A/V technology and writing surfaces, significant classroom storage, and a break station to support longer training sessions. A defensive tactics room provides continuous floor mats and wall pads to assure safe and effective officer training. A significant simulation/simuntion training environment is also provided for safe tactical training using simunitions weapons and accommodating A/V simulator technology and reconfigurable tactical wall/door/window panels suspended from an overhead grid. **Trainees will learn from real-life hands-on use-of-force and challenging training scenarios for enhanced decision-making.**

SIZE:

31,000 SF

COST:

Original-\$15 million
Final-\$15 million

YEAR COMPLETED:

Est. 2024

OWNER & CONTACT INFORMATION:

City of Cape Coral
Robert Creighton Jr.
239.249.3637
rcreighton@capecoral.gov

RELEVANCY TO THESE SCOPE OF SERVICES:

- Administration
- Essential Facility
- Health & Safety Principles
- Meeting / Training Areas
- Integrated Training Components
- Public / Private Site Organization
- High Profile / Civic Presence
- Armory
- Indoor Tactical Firearms Proficiency Range
- Firearms Use of Force Simulators
- Simulation Training Environment
- **CM at Risk Delivery Method**

PROTECT & SERVE

TEAM'S EXPERIENCE

EXPERIENCE OF j12 ARCHITECTURE & MWL ARCHITECTS

Example Projects

2. Law Enforcement Training Facility -- City of Ocoee, Florida



DESCRIPTION OF PROJECT / FEATURES:

The City of Ocoee contracted with Fortress Secured to procure the project via a **Public Private Partnership**. The facility main users will be the City of Ocoee Police and Fire Departments but will be opened up to outside agencies to help serve as a revenue stream for the City.

The new Law Enforcement Training Center will allow the police and fire departments to train efficiently and effectively, using state of the art instructional and tactical training environments. **This new facility features a 16 lane, tactical 50 yard indoor firing range with two target systems, to accommodate pistol and rifle training that is acoustically separated from adjacent training spaces, and will safely accommodate lead and non-lead rounds.** Workshop and armory space is incorporated to maintain firearms and build and maintain props for use in the firing range. Secure ammunition storage is provided for pallet and ammunition shelving, with easy vehicle access via an overhead door. Training offices are planned to accommodate staff growth, and have direct access to the lobby/break area as well as direct access to the workshop and to respond to deliveries.

Project includes a 5-story fire training tower located within the secured site logistics area.

Flexible training classrooms, canteen and locker facilities are separated from the rest of the secured facility allowing the City to utilize spaces for other City needs.

The facility is designed so that the classrooms, administration areas, lobby and firing range can be easily expanded as need grow in the future.

SIZE:

15,000 SF

COST:

Original-\$11 million

Final-\$11 million

YEAR COMPLETED:

Est. 2024 (Currently in Design)

OWNER & CONTACT INFORMATION:

City of Cape Coral

Chris McKinstry-Deputy Chief of Police

407.276.0943

cmckinstry@ocoee.org

Fortress Secured

John O'Grady-Design Build Partner

407.227.4392

john@fortressesecured.com

RELEVANCY TO THESE SCOPE OF SERVICES:

- Administration
- Essential Facility
- Health & Safety Principles
- Meeting / Training Areas
- Integrated Training Components
- Public / Private Site Organization
- High Profile / Civic Presence
- Fire Training Tower
- Indoor Tactical Firearms Proficiency Range
- Firearms Use of Force Simulators
- Simulation Training Environment

PROTECT & SERVE

TEAM'S EXPERIENCE

EXPERIENCE OF MR. LOHRUM & MWL ARCHITECTS

Example Projects

3. North Port Police Department -- City of North Port, Florida

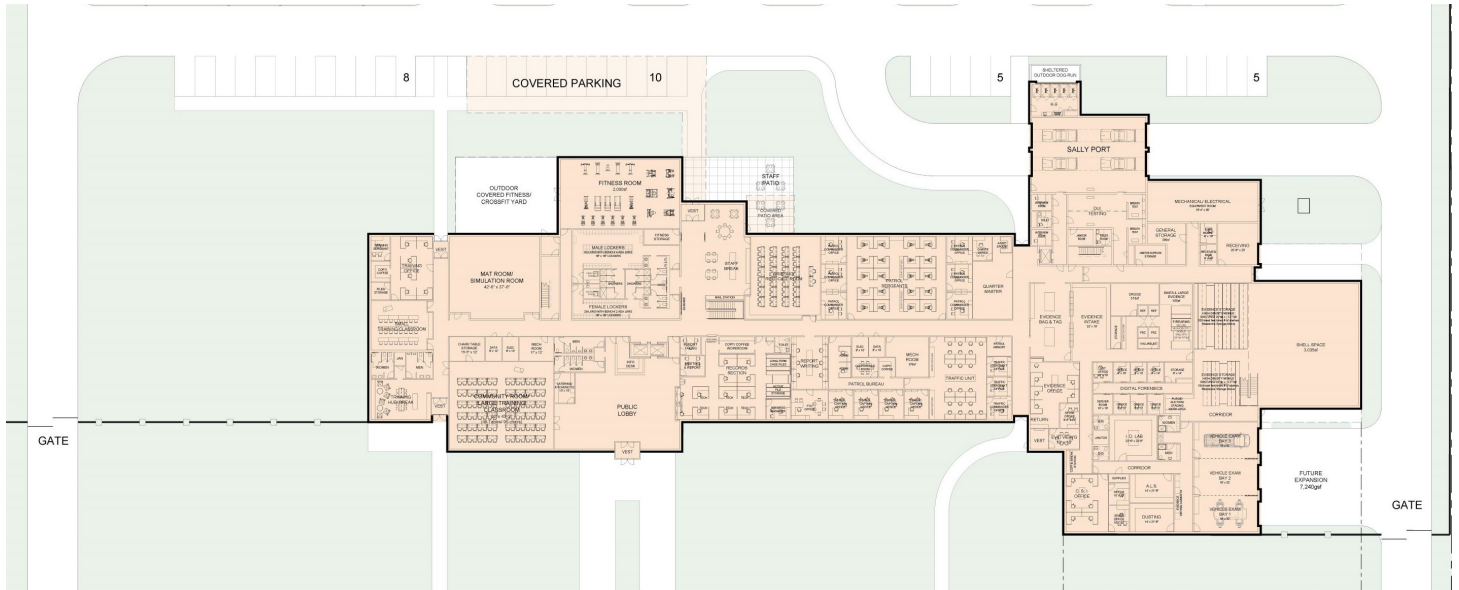

*Individual experience of Mr. Lohrum. Image Courtesy of MWL Architects.

DESCRIPTION OF PROJECT / FEATURES:

The building is a three-story design with a public lobby with Information desk, records and a multi-purpose community meeting/training room adjacent to the lobby, on the first floor. The first floor also accommodates the needs of patrol and traffic, with locker and fitness and training functions. Property and evidence intake, processing, and storage occupies a wing of the first floor along with arrestee processing. The second floor accommodates investigations with a real time information center (RTIC). The third floor includes 911 communications and police administration.

North Port is a city poised for steady, on-going growth. With a land area of 104 square miles that is now 30% built out, it is anticipated that the city will grow and the resulting calls for service will call for the police department to grow as the city grows. The current city population of 85,000 and police department staff of 180 are both anticipated to increase steadily, with the need for up to 540 police staff in 25 years. The building is planned to accommodate staff growth over the next 25 years, and the site has capacity to accommodate additional growth for up to 40 years.

The site, a special ops and emergency response building, an impound lot, a vehicle upfit building and a fueling station, and secure staff and fleet vehicle parking, all with the capacity to expand when needed. The site location is centrally located in the footprint of the built out city

SIZE:

151,000 SF

COST:

Original-\$100 million
Final-\$100 million

YEAR COMPLETED:

(Schematic Design-Currently Completed)

OWNER & CONTACT INFORMATION:

City of North Port
Kimberly Humphrey, LEED
Facilities Manager
941.240.8093
khumphrey@northportfl.gov

RELEVANCY TO THESE SCOPE OF SERVICES:

- Administration
- Essential Facility
- Meeting / Training Areas
- Integrated Training Components
- Public / Private Site Organization
- High Profile / Civic Presence
- Experience with the City of North Port
- Indoor Tactical Firearms Proficiency Range
- Firearms Simulators
- **CM at Risk Delivery Method**

PROTECT & SERVE

TEAM'S EXPERIENCE

EXPERIENCE OF j|2 ARCHITECTURE

Example Projects

4. Fire Administration & Station 1 -- City of Daytona Beach, Florida



DESCRIPTION OF PROJECT / FEATURES:

The City of Daytona Beach contracted with j|2 Architecture in July of 2023 for the design of their new Fire Administration & Station No. 1. **The design team has utilized a fast-tracked project schedule and management techniques and has already completed 100% Design Development Drawings with 100% Construction documents scheduled to be completed and permitted in May of 2024.**

The entire first floor of the facility is dedicated to station operations with a 4-bay, 90 foot deep, drive thru apparatus bay. The dayroom, kitchen and dining are located in the heart of the first floor with direct access to the apparatus bay. Fourteen bunk rooms are divided into two separate wings helping for flexibility in alerting of different parts of the station. A dedicated 3-story training tower with drone platform as been designed for integrated training and services as a beacon as you drive past the facility.

The public enter into a two story civic lobby space with grand stairs wrapping the elevator to a second floor look out. Visibility of the North East corner from the street is imperative as the station includes a museum space called the "Rosie Bay" showcasing a 1940's fire truck that used to serve the Daytona Beach community.

The entire second floor is dedicated to the administrative functions of the facility including offices, conference rooms, break room and open collaborative work station which serve as built-in space for future station growth. **Incorporating health and safety practices such as decontamination areas, air locks, separate HVAC zones, smart alerting and a full roof solar array, was a non-negotiable goal of the City and Design team.**

SIZE:

27,500 SF

COST:

Original-\$22 million
Final-\$22 million

YEAR COMPLETED:

Est. 2025 (Currently in Design)

OWNER & CONTACT INFORMATION:

City of Daytona Beach
Dru Driscoll-Fire Chief
386.451.4506
driscoll@dru@codb.us

RELEVANCY TO THESE SCOPE OF SERVICES:

- Administration
- Essential Facility
- Health & Safety Principles
- Meeting / Training Areas
- Integrated Training Components
- Public / Private Site Organization
- High Profile / Civic Presence
- Fire Experience
- **CM at Risk Delivery Method**

PROTECT & SERVE

TEAM'S EXPERIENCE

EXPERIENCE OF MWL ARCHITECTS

Example Projects

5. Public Safety Training Center -- Chandler, Arizona



DESCRIPTION OF PROJECT / FEATURES:

MWL led the development of a 2014 police facilities master plan effort for the City of Chandler, which identified a police department training center as a top priority. MWL's team was again selected to design the comprehensive Public Safety Training Center (PSTC). **This project fulfilled the needs for police and fire departments by utilizing a five-acre undeveloped parcel of land adjacent to the existing fire training center.** The project provided synergy between the police and fire training departments and MWL's site master plan and design concept was enthusiastically received.

The fire department had been operating from this site for a long time and had identified significant shortcomings with regard to office space, large meeting space, classroom space, recruit academy spaces, logistical and vehicle storage needs. The police department was seeking to consolidate training offices and training space, along with the need to significantly enhance current training capabilities, which include indoor tactical firing ranges (25 & 50 yard) and dedicated support spaces, a simulation shoothouse. The resulting public safety campus allows for a shared administrative, classroom and support building that has become the focal point of regional police and fire training activity.

The main campus complex provides an enhanced civic identity, with durable and cost-effective materials. A separate building provides the fire department with a large enhanced indoor training space and dedicated space for fire recruit classes. **The final design supported the City's desire to accommodate community and citizen program involvement, while maintaining a safe separation for secure public safety**

SIZE:

68,097 SF

COST:

Original-\$21.1 million
Final-\$17.7 million

YEAR COMPLETED:

2020

OWNER & CONTACT INFORMATION:

City of Chandler
Sean Duggan, Chief of Police
480.782.4101
sean.duggan@chandleraz.gov

RELEVANCY TO THESE SCOPE OF SERVICES:

- Administration
- Essential Facility
- Health & Safety Principles
- Meeting / Training Areas
- Integrated Training Components
- Public / Private Site Organization
- High Profile / Civic Presence
- **CM at Risk Delivery Method**
- Indoor Tactical Firearms Proficiency Range
- Firearms Use of Force Simulators
- Simulation Training Environment

PROTECT & SERVE

nder Aid
al Protective
ent
id/CPR
FD



Emotional Control
-Clear Commands and Warnings
-Breathing

Levels of Resistance
-Control
-Passive Resistance
-Active Resistance
-Aggressive Active Resistance

Levels of Force
-Low
-Intermediate
-Deadly

REFERENCES / CLIENT LISTING

4



REFERENCES

Attachment C

ATTACHMENT C REFERENCES/CLIENT LISTING

Include at least two (2) References and no more than five (5) References within the last 10 years of projects with similar scope as listed in this RFP.

The Project Manager and the key project members in the proposed project team must show relevant experience in five (5) referenced similar projects.

- Business/Customer Name: Police Training Facility / City of Cape Coral, Florida(Reference for MWL & Mr. Lohrum)
Name of Contact Person/Title: Robert Creighton Jr., PE
Telephone# 239.249.3639 E-mail rcreighton@capecoral.gov
Address PO Box 150027
Phone Number 239.249.3639
Duration of Contract or business relationship 4 Years Project completion date: Est. 2023
Type of Services Provided Architectural & Engineering Design Services
Cost of Project: Design \$400,000.00 Construction: \$15,000,000.00
- Business/Customer Name: Law Enforcement Training Facility / City of Ocoee, Florida (Reference for j12 Architecture)
Name of Contact Person/Title: John O'Grady
Telephone# 407.227.4392 E-mail john@fortressesecured.com
Address 421 S Summerlin Ave, Orlando, FL 32801
Phone Number 407.227.4392
Duration of Contract or business relationship 1 Year (Ongoing) Project completion date: _____
Type of Services Provided Architectural & Engineering Design Services
Cost of Project: Design \$642,260.00 Construction: @11,000,000.00
- Business/Customer Name: Police Headquarters / City of North Port (Reference for MWL & Mr. Lohrum)
Name of Contact Person/Title: Kimberly Humphry
Telephone# 941.240.8093 E-mail khumphrey@northportfl.gov
Address 100 N. Chamberlain Blvd., North Port, Florida 34286
Phone Number 941.240.8093
Duration of Contract or business relationship 3 Years Project completion date: Est. 2025
Type of Services Provided Architectural & Engineering Design Services
Cost of Project: Design \$1,600,000.00 Construction: \$100,000,000.00

REFERENCES

Attachment C

4. Business/Customer Name: Fire Administration / Daytona Beach (Reference for jI2 Architecture)
Name of Contact Person/Title: Dru Driscoll / Fire Chief
Telephone# 386.451.4506 E-mail driscoll dru@codb.us
Address 301 S Beach St, Daytona Beach, FL 32114
Phone Number 386.451.4506
Duration of Contract or business relationship 7 months Project completion date: Ongoing
Type of Services Provided Architectural and Engineering Design Services
Cost of Project: Design \$1,790,000.00 Construction: \$22 Million (Ongoing)
5. Business/Customer Name: Public Safety Training Center / City of Chandler(Reference for MWL)
Name of Contact Person/Title: Sean Duggan / Chief of Police
Telephone# 480.782.4101 E-mail sean.duggan@chandleraz.gov
Address 250 E Chicago St. Chandler, Arizona 85225
Phone Number 480.782.4101
Duration of Contract or business relationship 10 years Project completion date: 2020
Type of Services Provided Architectural & Engineering Design Services
Cost of Project: Design 2,706,405.00 Construction: 23,000,000.00

COMPANY NAME: jI2 Architecture

SIGNATURE: _____



PROTECT & SERVE

REFERENCES

Attachment D--1. Scottsdale Police & Fire Training Facility (REFERENCE IS FOR MWL)

ATTACHMENT D REFERENCE AND PERFORMANCE QUESTIONNAIRE VERIFICATION FORM

RFP 2024-17 Professional and Engineering Services for the City of North Port Public Safety Training Complex

It is the intent of the City of North Port to request proposals from experienced and qualified firms for professional architectural design and engineering services for the City of North Port Public Safety Training Complex.

1. Contractor Information (Proposer information)	
FIRM NAME: McClaren, Wilson & Lawrie, Inc. - MWL	
ADDRESS: 8705 N Central Ave. Phoenix, AZ 85020	
Telephone number#: 602-331-4141	
E-mail: wilson@mwlarchitects.com	
Point of Contact	Contact Phone Number
Dave Wilson	602-331-4141
2. Worked Performed as <input type="checkbox"/> Prime <input type="checkbox"/> Sub Contractor <input type="checkbox"/> Joint Venture <input type="checkbox"/> Other (Explain) Percent of project work performed <u>30</u> % If Subcontractor, who was the prime (Name/Phone #) <u>Fucello Architects/Steve Fucello 480-216-2070</u>	
3. CONTACT INFORMATION	
Contract Number: <u>20SQ016 PO #P00334883</u>	
Contract Type: <input type="checkbox"/> Firm Fixed Price <input checked="" type="checkbox"/> Cost Reimbursement <input type="checkbox"/> Other (please specify): _____	
Contract Title: <u>Design Services</u>	
Contract Location: <u>Scottsdale Arizona</u>	
Award Date (mm/dd/yy) <u>09/25/2020</u>	
Actual Completion Date: <u>under construction</u>	
Original Contract Price (Award Amount): <u>see below</u>	
Final Contract Price (to include all modifications, if applicable): <u>\$3,001,740</u>	
Explain the Difference: <u>this is a complicated design project with multiple buildings and phases- please call me at 480-232-2527</u>	
4. PROJECT DESCRIPTION: Complexity of Work <input checked="" type="checkbox"/> HIGH <input type="checkbox"/> MED <input type="checkbox"/> ROUTINE How is this project relevant to project submission? _____ _____ _____	
5. CLIENT INFORMATION	
Name: <u>Nathan Crowell</u>	Title: <u>Project Manager-Capital Projects</u>
Name of Entity: <u>City of Scottsdale</u>	
Phone Number: <u>480-232-2527 cell</u>	E-Mail: <u>ncrowell@scottsdaleaz.gov</u>

PROTECT & SERVE

REFERENCES

Attachment D--1. Scottsdale Police & Fire Training Facility (REFERENCE IS FOR MWL)

PERFORMANCE EVALUATION	(CHECK) "YES" OR "NO"
1. Was the scope of work performed similar in nature?	<input checked="" type="checkbox"/> YES OR <input type="checkbox"/> NO
2. Did this company have the proper resources and personnel by which to get the job done? If no, please describe: _____ _____	<input checked="" type="checkbox"/> YES OR <input type="checkbox"/> NO
3. Were any problems encountered with the company's work performance? If yes, please describe: _____ _____	<input type="checkbox"/> YES OR <input checked="" type="checkbox"/> NO
4. How long did the company/individual work for you?	Years: ³ ____ Months: ⁶ ____
5. On a scale of 1 to 10, 10 being best, how would you rate the overall work performance, considering professionalism; final product; personnel; resources. Rate from 1 to 10. (10 being highest)	10 _____
6. If the opportunity were to present itself, would you rehire this company? If no, please state why: _____	<input checked="" type="checkbox"/> YES OR <input type="checkbox"/> NO
7. Date Questionnaire completed	(mm/dd/yy) 2/8/2024

8. Please provide any additional comments pertinent to this company and the work performed for you (you may use additional pages): These guys are great, very responsive, very available. we have Police and Fire training facilities on the same property. They were selected through a request for qualifications process.
the whole contract amount is complicated because we started out with a pre-design feasibility/programming contract then issued a change order for design development
Then we changed the scope substantially on the Police Training facility and issued a change order for the increased scope and then issued a final change order for Construction Administration.
We have a budget of about \$55M for both projects and this may be one of the best set of documents I have see in a long time. I have about 30 years of experience on the
construction side and 11 years on the owners side



Signature

Date this was completed: 2/8/24

NOTE: REQUESTS THAT THE CLIENT COMPLETES THIS FORM AND SUBMITS DIRECTLY BACK TO THE PROPOSER. THE PROPOSER WILL SUBMIT THE COMPLETED FORM WITH THEIR PROPOSAL. CLIENTS ARE HIGHLY ENCOURAGED TO SUBMIT THE FORM DIRECTLY TO THE PROPOSER. HOWEVER, MAY BE DIRECTLY SUBMITTED TO: PURCHASING@NORTHPORTFL.GOV REFERENCING THE RFP #: 2024-17.

THE CITY RESERVES THE RIGHT TO VERIFY ANY AND ALL INFORMATION ON THIS FORM.

PROTECT & SERVE

REFERENCES

Attachment D--2. Ocoee Law Enforcement Training Facility (REFERENCE IS FOR JL2 ARCHITECTURE & MWL)

ATTACHMENT D
REFERENCE AND PERFORMANCE QUESTIONNAIRE VERIFICATION FORM

RFP 2024-17 Professional and Engineering Services for the City of North Port Public Safety Training Complex

It is the intent of the City of North Port to request proposals from experienced and qualified firms for professional architectural design and engineering services for the City of North Port Public Safety Training Complex.

1. Contractor Information (Proposer information)	
FIRM NAME: j 2 Architecture	
ADDRESS: 1678 Kingston Road, Longwood, FL 32750	
Telephone number#: 407.340.2879	
E-mail: johrum@j 2architecture.com	
Point of Contact <u>Johnnie Lohrum Jr.</u> Contact Phone Number <u>407.340.2879</u>	
2. Worked Performed as <input type="checkbox"/> Prime <input checked="" type="checkbox"/> Sub Contractor <input type="checkbox"/> Joint Venture <input type="checkbox"/> Other (Explain) Percent of project work performed <u>65</u> % If Subcontractor, who was the prime (Name/Phone #) <u>Fortress Secured / John O'Grady / 407.227.4392</u>	
3. CONTACT INFORMATION	
Contract Number: <u>No Contract Number</u>	
Contract Type: <input checked="" type="checkbox"/> Firm Fixed Price <input type="checkbox"/> Cost Reimbursement <input type="checkbox"/> Other (please specify): _____	
Contract Title: <u>City of Ocoee Law Enforcement Training Facility and Fire Training Tower</u>	
Contract Location: <u>City of Ocoee, FL</u>	
Award Date (mm/dd/yy) <u>04/01/2023</u>	
Actual Completion Date: <u>Still Under Design</u>	
Original Contract Price (Award Amount): <u>\$ 642,260.00</u>	
Final Contract Price (to include all modifications, if applicable): <u>Non-applicable</u>	
Explain the Difference: <u>Project is still currently in design</u>	
4. PROJECT DESCRIPTION: Complexity of Work <input checked="" type="checkbox"/> HIGH <input type="checkbox"/> MED <input type="checkbox"/> ROUTINE How is this project relevant to project submission?	
5. CLIENT INFORMATION	
Name: <u>John O-Grady</u> Title: <u>Public Safety Advisor</u>	
Name of Entity: <u>Fortress Secured</u>	
Phone Number: <u>407.227.4392</u> E-Mail: <u>john@fortresssecured.com</u>	

PROTECT & SERVE

REFERENCES

Attachment D--2. Ocoee Law Enforcement Training Facility (REFERENCE IS FOR JL2 ARCHITECTURE & MWL)

PERFORMANCE EVALUATION	(CHECK) "YES" OR "NO"
1. Was the scope of work performed similar in nature? This project is a 15k sq.ft. Training complex with gun range and fire tower	<input checked="" type="checkbox"/> YES OR <input type="checkbox"/> NO
2. Did this company have the proper resources and personnel by which to get the job done? If no, please describe: _____ _____	<input checked="" type="checkbox"/> YES OR <input type="checkbox"/> NO
3. Were any problems encountered with the company's work performance? If yes, please describe: _____ _____	<input type="checkbox"/> YES OR <input checked="" type="checkbox"/> NO
4. How long did the company/individual work for you?	Years: <u>1</u> ____ Months: _____
5. On a scale of 1 to 10, 10 being best, how would you rate the overall work performance, considering professionalism; final product; personnel; resources. Rate from 1 to 10. (10 being highest)	<u>10</u> _____
6. If the opportunity were to present itself, would you rehire this company? If no, please state why: _____	<input checked="" type="checkbox"/> YES OR <input type="checkbox"/> NO
7. Date Questionnaire completed	(mm/dd/yy) <u>02/05/2024</u> _____

8. Please provide any additional comments pertinent to this company and the work performed for you (you may use additional pages): JL2 and in particular Mr. Lohrum has brought a wealth of knowledge and experience of this type of project, (Public Safety Training Facility) to the "table". He is sensitive to his clients wants and needs. He is sensitive to the budget. He understands how the government works and goes beyond what is necessary to get the right product for the client.

John O-Grady _____

Signature

Date this was completed: 02/08/2024 _____

NOTE: REQUESTS THAT THE CLIENT COMPLETES THIS FORM AND SUBMITS DIRECTLY BACK TO THE PROPOSER. THE PROPOSER WILL SUBMIT THE COMPLETED FORM WITH THEIR PROPOSAL. CLIENTS ARE HIGHLY ENCOURAGED TO SUBMIT THE FORM DIRECTLY TO THE PROPOSER. HOWEVER, MAY BE DIRECTLY SUBMITTED TO: PURCHASING@NORTHPORTFL.GOV REFERENCING THE RFP #: 2024-17.

THE CITY RESERVES THE RIGHT TO VERIFY ANY AND ALL INFORMATION ON THIS FORM.

PROTECT & SERVE

REFERENCES

Attachment D--3. DeLand Fire 81, Training & Police Evidence Facility (REFERENCE IS FOR MR. LOHRUM & MWL)

ATTACHMENT D REFERENCE AND PERFORMANCE QUESTIONNAIRE VERIFICATION FORM

RFP 2024-17 Professional and Engineering Services for the City of North Port Public Safety Training Complex

It is the intent of the City of North Port to request proposals from experienced and qualified firms for professional architectural design and engineering services for the City of North Port Public Safety Training Complex.

1. Contractor Information (Proposer information)
FIRM NAME: j 2 Architecture (Reference is for the individual Johnnie Lohrum Jr. who was the Architect of Record)
ADDRESS: 1678 Kingston Road, Orlando, FL 32750
Telephone number#: 407.340.2879
E-mail: jlohrum@j 2architecture.com
Point of Contact <u>Johnnie Lohrum Jr.</u> Contact Phone Number <u>407.340.2879</u>
2. Worked Performed as <input checked="" type="checkbox"/> Prime <input type="checkbox"/> Sub Contractor <input type="checkbox"/> Joint Venture <input type="checkbox"/> Other (Explain) Percent of project work performed <u>65</u> % If Subcontractor, who was the prime (Name/Phone #) _____
3. CONTACT INFORMATION Contract Number: <u>No Contract Number</u> Contract Type: <input checked="" type="checkbox"/> Firm Fixed Price <input type="checkbox"/> Cost Reimbursement <input type="checkbox"/> Other (please specify): _____ Contract Title: <u>City of DeLand Fire Station 81 & Police Evidence Building</u> Contract Location: <u>City of DeLand, FL</u> Award Date (mm/dd/yy) <u>12/03/2018</u> Actual Completion Date: <u>October 2022</u> Original Contract Price (Award Amount): <u>\$ 440,000.00</u> Final Contract Price (to include all modifications, if applicable): <u>\$ 440,000.00</u> Explain the Difference: _____
4. PROJECT DESCRIPTION: Complexity of Work <input checked="" type="checkbox"/> HIGH <input type="checkbox"/> MED <input type="checkbox"/> ROUTINE How is this project relevant to project submission?
5. CLIENT INFORMATION Name: <u>Todd Allen</u> Title: <u>Fire Chief</u> Name of Entity: <u>City of DeLand</u> Phone Number: <u>309.721.1783</u> E-Mail: <u>allent@deland.org</u>

PROTECT & SERVE

REFERENCES

Attachment D--3. DeLand Fire 81, Training & Police Evidence Facility (REFERENCE IS FOR MR. LOHRUM & MWL)

PERFORMANCE EVALUATION	(CHECK) "YES" OR "NO"
1. Was the scope of work performed similar in nature?	<input checked="" type="checkbox"/> YES OR <input type="checkbox"/> NO
2. Did this company have the proper resources and personnel by which to get the job done? If no, please describe: _____ _____	<input checked="" type="checkbox"/> YES OR <input type="checkbox"/> NO
3. Were any problems encountered with the company's work performance? If yes, please describe: _____ _____	<input type="checkbox"/> YES OR <input checked="" type="checkbox"/> NO
4. How long did the company/individual work for you?	Years: _____ Months: <u>7</u>
5. On a scale of 1 to 10, 10 being best, how would you rate the overall work performance, considering professionalism; final product; personnel; resources. Rate from 1 to 10. (10 being highest)	<u>10</u>
6. If the opportunity were to present itself, would you rehire this company? If no, please state why: _____	<input checked="" type="checkbox"/> YES OR <input type="checkbox"/> NO
7. Date Questionnaire completed	(mm/dd/yy) <u>02/05/2024</u>

8. Please provide any additional comments pertinent to this company and the work performed for you (you may use additional pages): For several years prior to the start of the City's project, Johnnie served as a valuable source of information even with the understanding the project would have to be competitively bid. I mention as it goes to his character of being a trusted professional whom you can count on. Though we are months away from going vertical, the process from programming through schematic design has been efficient, thoughtful, and on schedule. I proudly offer my recommendation to JL2 Architecture.



Signature

Date this was completed: 2/5/24

NOTE: REQUESTS THAT THE CLIENT COMPLETES THIS FORM AND SUBMITS DIRECTLY BACK TO THE PROPOSER. THE PROPOSER WILL SUBMIT THE COMPLETED FORM WITH THEIR PROPOSAL. CLIENTS ARE HIGHLY ENCOURAGED TO SUBMIT THE FORM DIRECTLY TO THE PROPOSER. HOWEVER, MAY BE DIRECTLY SUBMITTED TO: PURCHASING@NORTHPORTFL.GOV REFERENCING THE RFP #: 2024-17.

THE CITY RESERVES THE RIGHT TO VERIFY ANY AND ALL INFORMATION ON THIS FORM.

PROTECT & SERVE

REFERENCES

Attachment D--4. City of Daytona Fire Administration (REFERENCE IS FOR JL2 ARCHITECTURE)

ATTACHMENT D REFERENCE AND PERFORMANCE QUESTIONNAIRE VERIFICATION FORM

RFP 2024-17 Professional and Engineering Services for the City of North Port Public Safety Training Complex

It is the intent of the City of North Port to request proposals from experienced and qualified firms for professional architectural design and engineering services for the City of North Port Public Safety Training Complex.

1. Contractor Information (Proposer information)
FIRM NAME: jl2 Architecture
ADDRESS: 1678 Kingston Road, Orlando, FL 32750
Telephone number#: 407.340.2879
E-mail: jlohrum@jl2architecture.com
Point of Contact <u>Johnnie Lohrum Jr.</u> Contact Phone Number <u>407.340.2879</u>
2. Worked Performed as <input checked="" type="checkbox"/> Prime <input type="checkbox"/> Sub Contractor <input type="checkbox"/> Joint Venture <input type="checkbox"/> Other (Explain) Percent of project work performed <u>65</u> % If Subcontractor, who was the prime (Name/Phone #) _____
3. CONTACT INFORMATION Contract Number: <u>2336</u> Contract Type: <input checked="" type="checkbox"/> Firm Fixed Price <input type="checkbox"/> Cost Reimbursement <input type="checkbox"/> Other (please specify): _____ Contract Title: <u>City of Daytona Beach Fire Administration Building</u> Contract Location: <u>City of Daytona Beach, FL</u> Award Date (mm/dd/yy) <u>08.07.2023</u> Actual Completion Date: <u>Still Under Design</u> Original Contract Price (Award Amount): <u>\$1,790,000.00</u> Final Contract Price (to include all modifications, if applicable): <u>\$1,790,000.00</u> Explain the Difference: <u>Project is still currently in design</u>
4. PROJECT DESCRIPTION: Complexity of Work <input checked="" type="checkbox"/> HIGH <input type="checkbox"/> MED <input type="checkbox"/> ROUTINE How is this project relevant to project submission?
5. CLIENT INFORMATION Name: <u>Dru Driscoll</u> Title: <u>Deputy City Manager/Fire Chief</u> Name of Entity: <u>City of Daytona Beach</u> Phone Number: <u>386.451.4506</u> E-Mail: <u>driscoll@dru@dbfd.us</u>

PROTECT & SERVE

REFERENCES

Attachment D--4. City of Daytona Fire Administration (REFERENCE IS FOR JL2 ARCHITECTURE)

PERFORMANCE EVALUATION	(CHECK) "YES" OR "NO"
1. Was the scope of work performed similar in nature?	<input checked="" type="checkbox"/> YES OR <input type="checkbox"/> NO
2. Did this company have the proper resources and personnel by which to get the job done? If no, please describe: _____ _____	<input checked="" type="checkbox"/> YES OR <input type="checkbox"/> NO
3. Were any problems encountered with the company's work performance? If yes, please describe: _____ _____	<input type="checkbox"/> YES OR <input checked="" type="checkbox"/> NO
4. How long did the company/individual work for you?	Years: _____ Months: <u>7</u>
5. On a scale of 1 to 10, 10 being best, how would you rate the overall work performance, considering professionalism; final product; personnel; resources. Rate from 1 to 10. (10 being highest)	<u>10</u>
6. If the opportunity were to present itself, would you rehire this company? If no, please state why: _____	<input checked="" type="checkbox"/> YES OR <input type="checkbox"/> NO
7. Date Questionnaire completed	(mm/dd/yy) <u>02/05/2024</u>

8. Please provide any additional comments pertinent to this company and the work performed for you (you may use additional pages): For several years prior to the start of the City's project, Johnnie served as a valuable source of information even with the understanding the project would have to be competitively bid. I mention as it goes to his character of being a trusted professional whom you can count on. Though we are months away from going vertical, the process from programming through schematic design has been efficient, thoughtful, and on schedule. I proudly offer my recommendation to JL2 Architecture.



Signature

Date this was completed: 2/5/24

NOTE: REQUESTS THAT THE CLIENT COMPLETES THIS FORM AND SUBMITS DIRECTLY BACK TO THE PROPOSER. THE PROPOSER WILL SUBMIT THE COMPLETED FORM WITH THEIR PROPOSAL. CLIENTS ARE HIGHLY ENCOURAGED TO SUBMIT THE FORM DIRECTLY TO THE PROPOSER. HOWEVER, MAY BE DIRECTLY SUBMITTED TO: PURCHASING@NORTHPORTFL.GOV REFERENCING THE RFP #: 2024-17.

THE CITY RESERVES THE RIGHT TO VERIFY ANY AND ALL INFORMATION ON THIS FORM.

PROTECT & SERVE

REFERENCES

Attachment D--1. Atlanta Public Safety Training Center (REFERENCE IS FOR MWL)

ATTACHMENT D REFERENCE AND PERFORMANCE QUESTIONNAIRE VERIFICATION FORM

RFP 2024-17 Professional and Engineering Services for the City of North Port Public Safety Training Complex

It is the intent of the City of North Port to request proposals from experienced and qualified firms for professional architectural design and engineering services for the City of North Port Public Safety Training Complex.

1. Contractor Information (Proposer Information)

FIRM NAME: M^{CLAREN, WILSON & LAWRIE ARCHITECTS}
 ADDRESS: 8705 NORTH CENTRAL AVE. PHOENIX, ARIZONA, 85020
 Telephone number#: 602-331-4141
 E-mail: WILSON@MWLARCHITECTS.COM
 Point of Contact DAVE WILSON Contact Phone Number 602-331-4141

2. Worked Performed as Prime Sub Contractor Joint Venture Other (Explain)

Percent of project work performed 30%
 If Subcontractor, who was the prime (Name/Phone #) LS3P ARCHITECTS MARK LEVINE 404-268-6702

3. CONTACT INFORMATION

Contract Number: PSTC 1350
 Contract Type: Firm Fixed Price Cost Reimbursement Other (please specify):
 Contract Title: ATLANTA PUBLIC TRAINING CENTER DESIGN SERVICES
 Contract Location: ATLANTA, GA.
 Award Date (mm/dd/yy): JUNE 1, 2021
 Actual Completion Date: IN PROGRESS, ESTIMATED DEC. 2024 COMPLETION
 Original Contract Price (Award Amount): CONSTRUCTION COST: \$105 MILLION
 Final Contract Price (to include all modifications, if applicable): \$107 million
 Explain the Difference: PROJECT SCOPE ADDITION: GYMNASIUM

4. PROJECT DESCRIPTION: Complexity of Work HIGH MED ROUTINE

How is this project relevant to project submission?

PUBLIC SAFETY TRAINING CENTER CONSISTING OF ALL TRAINING ASPECTS FOR ATLANTA POLICE AND ATLANTA FIRE RESCUE.

5. CLIENT INFORMATION

Name: ALAN WILLIAMS Title: DEVELOPMENT MANAGER
 Name of Entity: ATLANTA POLICE FOUNDATION
 Phone Number: 770-354-3392 E-Mail: AWILLIAMS@ATLANTAPOLICEFOUNDATION.ORG

PROTECT & SERVE

REFERENCES

Attachment D--1. Atlanta Public Safety Training Center (REFERENCE IS FOR MWL)

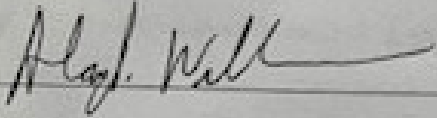
PERFORMANCE EVALUATION	(CHECK) "YES" OR "NO"
1. Was the scope of work performed similar in nature?	<input checked="" type="checkbox"/> YES OR <input type="checkbox"/> NO
2. Did this company have the proper resources and personnel by which to get the job done? If no, please describe: _____	<input checked="" type="checkbox"/> YES OR <input type="checkbox"/> NO
3. Were any problems encountered with the company's work performance? If yes, please describe: _____	<input type="checkbox"/> YES OR <input checked="" type="checkbox"/> NO
4. How long did the company/individual work for you?	Years: <u>2</u> Months: <u>6</u>
5. On a scale of 1 to 10, 10 being best, how would you rate the overall work performance, considering professionalism; final product; personnel; resources. Rate from 1 to 10. (10 being highest)	<u>10</u>
6. If the opportunity were to present itself, would you rehire this company? If no, please state why: _____	<input checked="" type="checkbox"/> YES OR <input type="checkbox"/> NO
7. Date Questionnaire completed	(mm/dd/yy) <u>02/09/24</u>
8. Please provide any additional comments pertinent to this company and the work performed for you (you may use additional pages): <u>MCCLEAREN, WILSON & LAWRIE ARCHITECTS (MWL) PROVIDED OUTSTANDING ARCHITECTURAL AND DESIGN SERVICES. MWL HAS A COMPLETE KNOWLEDGE AND UNDERSTANDING FOR ALL COMPONENTS OF A PUBLIC SAFETY TRAINING CENTER. MWL HAS DETAILLED EXPERIENCE IN DESIGNING BOTH THE TRAINING TACTICAL SIDE COUPLED WITH THE CLASSROOM / ADMINISTRATIVE COMPONENT. MWL IS VERY SERVICE ORIENTED AND ALWAYS PUTS THE CUSTOMER FIRST.</u>	
 _____ Signature	
Date this was completed: <u>02/09/2024</u> _____	
NOTE: REQUESTS THAT THE CLIENT COMPLETES THIS FORM AND SUBMITS DIRECTLY BACK TO THE PROPOSER. THE PROPOSER WILL SUBMIT THE COMPLETED FORM WITH THEIR PROPOSAL. CLIENTS ARE HIGHLY ENCOURAGED TO SUBMIT THE FORM DIRECTLY TO THE PROPOSER. HOWEVER, MAY BE DIRECTLY SUBMITTED TO: PURCHASING@NORTHPORTFL.GOV REFERENCING THE RFP #: 2024-17.	
THE CITY RESERVES THE RIGHT TO VERIFY ANY AND ALL INFORMATION ON THIS FORM.	

PROTECT & SERVE

E12

LITIGATION & INSURANCE

5

FBI



LITIGATION & INSURANCE

Litigation

jl2 Architecture (Prime Consultant)
Dun & Bradstreet No: 12-201-2716

JL2 Architecture certifies that the firm is financially stable and has the necessary resources, human and financial, to provide the services at the level required by the County of Volusia.

jl2 Architecture has no past or current litigation.

jl2 Architecture nor any of its listed sub-consultants have failed to complete any contractor work in the last five years.

Insurance Certificate



CERTIFICATE OF LIABILITY INSURANCE

JL2ARCH-01

KMCINTOSH

DATE (MM/DD/YYYY)
2/1/2024

THIS CERTIFICATE IS ISSUED AS A MATTER OF INFORMATION ONLY AND CONFERS NO RIGHTS UPON THE CERTIFICATE HOLDER. THIS CERTIFICATE DOES NOT AFFIRMATIVELY OR NEGATIVELY AMEND, EXTEND OR ALTER THE COVERAGE AFFORDED BY THE POLICIES BELOW. THIS CERTIFICATE OF INSURANCE DOES NOT CONSTITUTE A CONTRACT BETWEEN THE ISSUING INSURER(S), AUTHORIZED REPRESENTATIVE OR PRODUCER, AND THE CERTIFICATE HOLDER.

IMPORTANT: If the certificate holder is an ADDITIONAL INSURED, the policy(ies) must have ADDITIONAL INSURED provisions or be endorsed. If SUBROGATION IS WAIVED, subject to the terms and conditions of the policy, certain policies may require an endorsement. A statement on this certificate does not confer rights to the certificate holder in lieu of such endorsement(s).

PRODUCER JCJ Insurance Agency, LLC 2208 Hillcrest Street Orlando, FL 32803	CONTACT NAME: PHONE (A/C, No, Ext): (321) 445-1117	FAX (A/C, No): (321) 445-1076
	E-MAIL ADDRESS: certs@jcj-insurance.com	
INSURER(S) AFFORDING COVERAGE		NAIC #
INSURER A : Phoenix Insurance Co. (Travelers)		25623
INSURER B : Beazley Insurance Company, Inc		37540
INSURER C :		
INSURER D :		
INSURER E :		
INSURER F :		

INSURED

Jl2architecture
1678 Kingston Rd
Longwood, FL 32750

INSR LTR	TYPE OF INSURANCE	ADDITIONAL SUBROGATION WAIVED	POLICY NUMBER	POLICY EFF (MM/DD/YYYY)	POLICY EXP (MM/DD/YYYY)	LIMITS
A	<input checked="" type="checkbox"/> COMMERCIAL GENERAL LIABILITY <input type="checkbox"/> CLAIMS-MADE <input checked="" type="checkbox"/> OCCUR	X X	6602W553362	12/21/2023	12/21/2024	EACH OCCURRENCE \$ 1,000,000 DAMAGE TO RENTED PREMISES (Ea occurrence) \$ 1,000,000 MED EXP (Any one person) \$ 5,000 PERSONAL & ADV INJURY \$ 1,000,000 GENERAL AGGREGATE \$ 2,000,000 PRODUCTS - COM/POP AGG \$ 2,000,000
	GEN'L AGGREGATE LIMIT APPLIES PER: <input type="checkbox"/> POLICY <input checked="" type="checkbox"/> PROJECT <input type="checkbox"/> LOC OTHER:					
A	<input type="checkbox"/> AUTOMOBILE LIABILITY <input type="checkbox"/> ANY AUTO OWNED AUTOS ONLY <input checked="" type="checkbox"/> HIRED AUTOS ONLY	X X	6602W553362	12/21/2023	12/21/2024	COMBINED SINGLE LIMIT (Ea accident) \$ 1,000,000 BODILY INJURY (Per person) \$ BODILY INJURY (Per accident) \$ PROPERTY DAMAGE (Per accident) \$
	<input type="checkbox"/> SCHEDULED AUTOS <input checked="" type="checkbox"/> NON-OWNED AUTOS ONLY					
	<input type="checkbox"/> UMBRELLA LIAB <input type="checkbox"/> EXCESS LIAB <input type="checkbox"/> DED <input type="checkbox"/> RETENTION \$	<input type="checkbox"/> OCCUR <input type="checkbox"/> CLAIMS-MADE				EACH OCCURRENCE \$ AGGREGATE \$
	WORKERS COMPENSATION AND EMPLOYERS' LIABILITY ANY PROPRIETOR/PARTNER/EXECUTIVE OFFICER/MEMBER EXCLUDED? (Mandatory in NH) If yes, describe under DESCRIPTION OF OPERATIONS below	<input type="checkbox"/> Y <input checked="" type="checkbox"/> N/A				PER STATUTE <input type="checkbox"/> OTH-ER <input type="checkbox"/> E.L. EACH ACCIDENT \$ E.L. DISEASE - EA EMPLOYEE \$ E.L. DISEASE - POLICY LIMIT \$
B	Professional Liab		C341C2230201	12/21/2023	12/21/2025	Per Claim/Aggregate \$ 2,000,000

DESCRIPTION OF OPERATIONS / LOCATIONS / VEHICLES (ACORD 101, Additional Remarks Schedule, may be attached if more space is required)
 Contract NO. 2024-17 - PROFESSIONAL ARCHITECTURAL AND ENGINEERING SERVICES
 City of North Port, its officers, officials, and employees are an Additional Insureds with regards to General & Auto Liability when required by written contract. Waiver of subrogation applies in favor of the additional insureds when required by written contract. 30 Day Notice of Cancellation, except for 10 days for non-payment.

CERTIFICATE HOLDER City of North Port Alla V. Skipper, CPPB, Senior Contract Administrator Finance Department 4970 City Hall Blvd, Suite 337 North Port, FL 34286	CANCELLATION SHOULD ANY OF THE ABOVE DESCRIBED POLICIES BE CANCELLED BEFORE THE EXPIRATION DATE THEREOF, NOTICE WILL BE DELIVERED IN ACCORDANCE WITH THE POLICY PROVISIONS. AUTHORIZED REPRESENTATIVE
---	--

ACORD 25 (2016/03)

© 1988-2015 ACORD CORPORATION. All rights reserved.

The ACORD name and logo are registered marks of ACORD

PROTECT & SERVE



CITY REQUIRED FORMS

6

CITY REQUIRED FORMS

Forms Checklist

REQUEST FOR PROPOSAL NO. 2024-17 - PROFESSIONAL ARCHITECTURAL AND ENGINEERING SERVICES FOR THE CITY OF NORTH PORT PUBLIC SAFETY TRAINING COMPLEX

TAB 6 CITY REQUIRED FORMS - This checklist is provided to assist each Proposer in the preparation of their response. Included in this checklist are important requirements, which are the responsibility of each Proposer to submit in order to make their response fully compliant. It is the responsibility of each Proposer to read and comply with the solicitation in its entirety.

REQUIRED SUBMITTAL FORMS: Provide fully executed forms.

- ATTACHMENT A:** Proposal Submittal Signature Form
- ATTACHMENT B:** Statement of Organization
- ATTACHMENT C:** Reference/Client Listing Form
- ATTACHMENT D:** Reference Form
- ATTACHMENT E:** Disclosure Form (Consultant/Engineer/Architect)
- ATTACHMENT F:** Lobbying Certification
- ATTACHMENT G:** Non-Collusive Affidavit
- ATTACHMENT H:** Conflict of Interest Form
- ATTACHMENT I:** Public Entity Crime Information
- ATTACHMENT J:** Drug-Free Workplace
- ATTACHMENT K:** Scrutinized Company Certificate
- ATTACHMENT L:** E-Verify System

***Note: See City Insurance Requirements (see levels of coverage) and Indemnification in the Contract**

SAMPLE INSURANCE CERTIFICATE: Demonstrate your firm's ability to comply with insurance requirements. Provide a previous certificate or other evidence listing the Insurance Companies names for both Professional Liability and General Liability and the dollar amounts of the coverage.

MBE/WBE/VBE: If claiming either Minority Business Enterprise/Women Business Enterprises/Veteran Business Enterprise, the Prime Firm (not sub-consultant) **shall be** certified as a Minority Business Enterprise by the State of Florida, Department of Management Services, Office of Supplier Diversity pursuant to Section 287.0943, Florida Statutes (pick one):

1. **YES, CLAIMING STATUS AS PRIME ONLY (MBE/WBE/VBE)**

YES, I'VE ATTACHED THE CERTIFICATE OF MBE/WBE STATUS FROM STATE OF FLORIDA AS OUTLINED SECTION 1.

2. **NOT CLAIMING MBE/WBE /VBE**

PLEASE INITIAL AND RETURN WITH YOUR PROPOSAL.

INITIALS

THIS PAGE MUST BE COMPLETED AND SUBMITTED

CITY REQUIRED FORMS

Attachment A

ATTACHMENT A: PROPOSAL SUBMITTAL SIGNATURE FORM

The undersigned attests to his/her authority to submit this proposal and to bind the firm herein named to perform as per Agreement, if the firm is awarded the Agreement by the City.

The undersigned further certifies that he/she has read the Request for Proposal, Terms and Conditions, Insurance Requirements and any other documentation relating to this request and this proposal is submitted with full knowledge and understanding of the requirements and time constraints noted herein.

As addenda are considered binding as if contained in the original specifications, it is critical that the firm acknowledge receipt of same. The submittal may be considered void if receipt of an addendum is not acknowledged.

Addendum No. <u>1</u>	Dated <u>1.22.24</u>	Addendum No. <u>4</u>	Dated <u>2.5.24</u>
Addendum No. <u>2</u>	Dated <u>2.1.24</u>	Addendum No. _____	Dated _____
Addendum No. <u>3</u>	Dated <u>2.2.24</u>	Addendum No. _____	Dated _____

Company Name jl2 Architecture

407.340.2879

jlohrum@jl2architecture.com

Telephone #

E-Mail

Fax #

1678 Kingston Road

Main Office Address

Longwood

FL

32750

City

State

Zip Code

Address of Office Servicing City of North Port, if different than above: **SAME AS ABOVE**

Office Address

City

State

Zip Code

Telephone #

E-mail

Fax #

Johnnie Lohrum Jr., President

Name & Title of Firm Representative

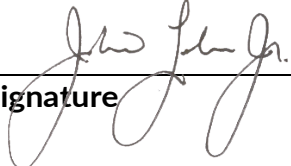
Signature

February 13, 2024

Date

THIS PAGE MUST BE SUBMITTED WITH PROPOSAL

CITY REQUIRED FORMS

Attachment B

ATTACHMENT B:

STATEMENT OF ORGANIZATION (Information Sheet for Transactions and Conveyances Corporation Identification)

The following information will be provided to the City of North Port for incorporation in legal documents. It is, therefore, vital all information is accurate and complete. Please be certain all spelling, and capitalization is exactly as registered with the state or federal government.

Name of Respondent: jl2 Architecture, LLC

DBA (if any): _____

Type of Entity (Sole Proprietor, Corporation, LLC, LLP, Partnership, etc): LLC

Business Address: 1678 Kingston Road, Longwood, FL 32750

Phone: 407.340.2879 Fax: _____

E-Mail jlohrum@jl2architecture.com

Federal Identification Number: 92-1168022

Respondent shall submit proof that it is authorized to do business in the State of Florida unless registration is not required by law.

(Please Check One)

Is this a Florida Corporation: Yes or No

If not a Florida Corporation,

In what state was it created: _____

Name as spelled in that State: _____

What kind of corporation is it: "For Profit" or "Not for Profit"

Is it in good standing: Yes or No

Authorized to transact business in Florida: Yes or No

State of Florida Department of State Certificate of Authority Document No.: L22000495247

Does it use a registered fictitious name: Yes or No

Specify Name: _____

THIS PAGE MUST BE SUBMITTED WITH PROPOSAL

CITY REQUIRED FORMS



Attachment B

Names of Officers:

President: Johnnie Lohrum Jr. Secretary: _____

Vice President: _____ Treasurer: _____

Director: _____ Director: _____

Other: _____ Other: _____

Name of Corporation (As used in Florida):

jl2 Architecture, LLC

(Spelled exactly as it is registered with the state or federal government)

Corporate Address:

Post Office Box: _____
City, State Zip: _____
Street Address: 1678 Kingston Road
City, State, Zip: Longwood, FL, 32750

Print Name and Title of person authorized to bind the company (provide list):

Johnnie Lohrum Jr., President

THIS PAGE MUST BE SUBMITTED WITH PROPOSAL

PROTECT & SERVE

CITY REQUIRED FORMS

Attachment E-jl2 Architecture

ATTACHMENT E DISCLOSURE FORM FOR CONSULTANT/ENGINEER/ARCHITECT

Please select (only) one of the following three options:

Our firm has no actual, potential, or reasonably perceived, **financial*** or **other interest**** in the outcome of the project.

Our firm has a potential or reasonably perceived **financial*** or **other interest**** in the outcome of the project as described here: _____.

Our firm proposes to mitigate the potential or perceived conflict according to the following plan: _____.

Our firm has an actual **financial*** or **other interest**** in the outcome of the project as described here: _____.

*What does "financial interest" mean?

If your firm, or employee of your firm working on the project (or a member of the employee's household), will/may be perceived to receive or lose private income depending on the government business choices based on your firm's findings and recommendations, this must be listed as a financial interest. An example would be ownership in physical assets affected by the government business choices related to this project. The possibility of contracting for further consulting services is not included in this definition and is not prohibited.

**What does "other interest" mean?

If your firm, or employee of your firm working on the project (or a member of the employee's household), will/may be perceived to have political, legal or any other interests that will affect what goes into your firm's findings and recommendations, or will be/may be perceived to be affected by the government business choices related to this project, this must be listed as another interest.

COMPANY NAME: jl2 Architecture

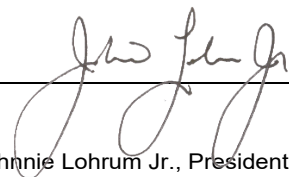

NAME (PERSON AUTHORIZED TO BIND THE COMPANY): Johnnie Lohrum Jr., President

THIS PAGE MUST BE SUBMITTED WITH PROPOSAL

PROTECT & SERVE

CITY REQUIRED FORMS

Attachment E-MWL

ATTACHMENT E DISCLOSURE FORM FOR CONSULTANT/ENGINEER/ARCHITECT

Please select (only) one of the following three options:

Our firm has no actual, potential, or reasonably perceived, **financial*** or **other interest**** in the outcome of the project.

Our firm has a potential or reasonably perceived **financial*** or **other interest**** in the outcome of the project as described here: _____.

Our firm proposes to mitigate the potential or perceived conflict according to the following plan: _____.

Our firm has an actual **financial*** or **other interest**** in the outcome of the project as described here: _____.

*What does "financial interest" mean?

If your firm, or employee of your firm working on the project (or a member of the employee's household), will/may be perceived to receive or lose private income depending on the government business choices based on your firm's findings and recommendations, this must be listed as a financial interest. An example would be ownership in physical assets affected by the government business choices related to this project. The possibility of contracting for further consulting services is not included in this definition and is not prohibited.

**What does "other interest" mean?

If your firm, or employee of your firm working on the project (or a member of the employee's household), will/may be perceived to have political, legal or any other interests that will affect what goes into your firm's findings and recommendations, or will be/may be perceived to be affected by the government business choices related to this project, this must be listed as another interest.

COMPANY NAME: McCLAREN, WILSON & LAWRIE INC.

NAME (PERSON AUTHORIZED TO BIND THE COMPANY): [Signature]

THIS PAGE MUST BE SUBMITTED WITH PROPOSAL

PROTECT & SERVE

CITY REQUIRED FORMS

Attachment E-AM Engineering

ATTACHMENT E DISCLOSURE FORM FOR CONSULTANT/ENGINEER/ARCHITECT

Please select (only) one of the following three options:

Our firm has no actual, potential, or reasonably perceived, **financial*** or **other interest**** in the outcome of the project.

Our firm has a potential or reasonably perceived **financial*** or **other interest**** in the outcome of the project as described here: _____.

Our firm proposes to mitigate the potential or perceived conflict according to the following plan: _____.

Our firm has an actual **financial*** or **other interest**** in the outcome of the project as described here: _____.

*What does “financial interest” mean?

If your firm, or employee of your firm working on the project (or a member of the employee’s household), will/may be perceived to receive or lose private income depending on the government business choices based on your firm’s findings and recommendations, this must be listed as a financial interest. An example would be ownership in physical assets affected by the government business choices related to this project. The possibility of contracting for further consulting services is not included in this definition and is not prohibited.

**What does “other interest” mean?

If your firm, or employee of your firm working on the project (or a member of the employee’s household), will/may be perceived to have political, legal or any other interests that will affect what goes into your firm’s findings and recommendations, or will be/may be perceived to be affected by the government business choices related to this project, this must be listed as another interest.

COMPANY NAME: AM Engineering, LLC

NAME (PERSON AUTHORIZED TO BIND THE COMPANY): Bobbi R. Claybrooke, PE

THIS PAGE MUST BE SUBMITTED WITH PROPOSAL

CITY REQUIRED FORMS

Attachment E-BBM

ATTACHMENT E DISCLOSURE FORM FOR CONSULTANT/ENGINEER/ARCHITECT

Please select (only) one of the following three options:

Our firm has no actual, potential, or reasonably perceived, **financial*** or **other interest**** in the outcome of the project.

Our firm has a potential or reasonably perceived **financial*** or **other interest**** in the outcome of the project as described here: _____.

Our firm proposes to mitigate the potential or perceived conflict according to the following plan: _____.

Our firm has an actual **financial*** or **other interest**** in the outcome of the project as described here: _____.

*What does “financial interest” mean?

If your firm, or employee of your firm working on the project (or a member of the employee’s household), will/may be perceived to receive or lose private income depending on the government business choices based on your firm’s findings and recommendations, this must be listed as a financial interest. An example would be ownership in physical assets affected by the government business choices related to this project. The possibility of contracting for further consulting services is not included in this definition and is not prohibited.

**What does “other interest” mean?

If your firm, or employee of your firm working on the project (or a member of the employee’s household), will/may be perceived to have political, legal or any other interests that will affect what goes into your firm’s findings and recommendations, or will be/may be perceived to be affected by the government business choices related to this project, this must be listed as another interest.

COMPANY NAME: BBM Structural Engineers, Inc.

NAME (PERSON AUTHORIZED TO BIND THE COMPANY): Bora Erbilin, PE, SE / President

THIS PAGE MUST BE SUBMITTED WITH PROPOSAL

CITY REQUIRED FORMS

Attachment E-OCI

ATTACHMENT E DISCLOSURE FORM FOR CONSULTANT/ENGINEER/ARCHITECT

Please select (only) one of the following three options:

Our firm has no actual, potential, or reasonably perceived, **financial*** or **other interest**** in the outcome of the project.

Our firm has a potential or reasonably perceived **financial*** or **other interest**** in the outcome of the project as described here: _____.

Our firm proposes to mitigate the potential or perceived conflict according to the following plan: _____.

Our firm has an actual **financial*** or **other interest**** in the outcome of the project as described here: _____.

*What does “financial interest” mean?

If your firm, or employee of your firm working on the project (or a member of the employee’s household), will/may be perceived to receive or lose private income depending on the government business choices based on your firm’s findings and recommendations, this must be listed as a financial interest. An example would be ownership in physical assets affected by the government business choices related to this project. The possibility of contracting for further consulting services is not included in this definition and is not prohibited.

**What does “other interest” mean?

If your firm, or employee of your firm working on the project (or a member of the employee’s household), will/may be perceived to have political, legal or any other interests that will affect what goes into your firm’s findings and recommendations, or will be/may be perceived to be affected by the government business choices related to this project, this must be listed as another interest.

COMPANY NAME: OCI Associates, LLC

NAME (PERSON AUTHORIZED TO BIND THE COMPANY): Amir Kazeminia, PE, President

THIS PAGE MUST BE SUBMITTED WITH PROPOSAL

CITY REQUIRED FORMS

Attachment E-KMI

ATTACHMENT E DISCLOSURE FORM FOR CONSULTANT/ENGINEER/ARCHITECT

Please select (only) one of the following three options:

Our firm has no actual, potential, or reasonably perceived, **financial*** or **other interest**** in the outcome of the project.

Our firm has a potential or reasonably perceived **financial*** or **other interest**** in the outcome of the project as described here: _____.

Our firm proposes to mitigate the potential or perceived conflict according to the following plan: _____.

Our firm has an actual **financial*** or **other interest**** in the outcome of the project as described here: _____.

*What does “financial interest” mean?

If your firm, or employee of your firm working on the project (or a member of the employee’s household), will/may be perceived to receive or lose private income depending on the government business choices based on your firm’s findings and recommendations, this must be listed as a financial interest. An example would be ownership in physical assets affected by the government business choices related to this project. The possibility of contracting for further consulting services is not included in this definition and is not prohibited.

**What does “other interest” mean?

If your firm, or employee of your firm working on the project (or a member of the employee’s household), will/may be perceived to have political, legal or any other interests that will affect what goes into your firm’s findings and recommendations, or will be/may be perceived to be affected by the government business choices related to this project, this must be listed as another interest.

COMPANY NAME: Kraus-Manning Inc. dba KMI International

NAME (PERSON AUTHORIZED TO BIND THE COMPANY): Drew Horn, VP of Operations

THIS PAGE MUST BE SUBMITTED WITH PROPOSAL

CITY REQUIRED FORMS

Attachment E-DWJA

ATTACHMENT E DISCLOSURE FORM FOR CONSULTANT/ENGINEER/ARCHITECT

Please select (only) one of the following three options:

Our firm has no actual, potential, or reasonably perceived, **financial*** or **other interest**** in the outcome of the project.

Our firm has a potential or reasonably perceived **financial*** or **other interest**** in the outcome of the project as described here: _____.

Our firm proposes to mitigate the potential or perceived conflict according to the following plan: _____.

Our firm has an actual **financial*** or **other interest**** in the outcome of the project as described here: _____.

*What does “financial interest” mean?

If your firm, or employee of your firm working on the project (or a member of the employee’s household), will/may be perceived to receive or lose private income depending on the government business choices based on your firm’s findings and recommendations, this must be listed as a financial interest. An example would be ownership in physical assets affected by the government business choices related to this project. The possibility of contracting for further consulting services is not included in this definition and is not prohibited.

**What does “other interest” mean?

If your firm, or employee of your firm working on the project (or a member of the employee’s household), will/may be perceived to have political, legal or any other interests that will affect what goes into your firm’s findings and recommendations, or will be/may be perceived to be affected by the government business choices related to this project, this must be listed as another interest.

COMPANY NAME: David W. Johnston Associates, Inc.

NAME (PERSON AUTHORIZED TO BIND THE COMPANY): Phillip J. Smith, President

THIS PAGE MUST BE SUBMITTED WITH PROPOSAL

CITY REQUIRED FORMS

Attachment F

Contract No. 2024-17

Attachment F

CERTIFICATION REGARDING LOBBYING

The undersigned certifies, to the best of his or her knowledge, that:

1. No Federal appropriated funds have been paid or will be paid, by or on behalf of the undersigned, to any person for influencing or attempting to influence an officer or employee of an agency, a Member of Congress, an officer or employee of Congress, or an employee of a Member of Congress in connection with the awarding of any Federal contract, the making of any Federal grant, the making of any Federal loan, the entering into of any cooperative agreement, and the extension, continuation, renewal, amendment, or modification of any Federal contract, grant, loan, or cooperative agreement.
2. If any funds other than Federal appropriated funds have been paid or will be paid to any person for influencing or attempting to influence an officer or employee of any agency, a Member of Congress, an officer or employee of Congress, or an employee of a Member of Congress in connection with this Federal contract, grant, loan, or cooperative agreement, the undersigned shall complete and submit Standard Form-LLL, "Disclosure Form to Report Lobbying," in accordance with its instructions.
3. The undersigned shall require that the language of this certification be included in the award documents for all subawards at all tiers (including subcontracts, subgrants, and contracts under grants, loans, and cooperative agreements) and that all subrecipients shall certify and disclose accordingly.

This certification is a material representation of fact upon which reliance was placed when this transaction was made or entered into. Submission of this certification is a prerequisite for making or entering into this transaction imposed by 31, U.S.C. § 1352 (as amended by the Lobbying Disclosure Act of 1995). Any person who fails to file the required certification shall be subject to a civil penalty of not less than \$10,000 and not more than \$100,000 for each such failure.

The Contractor certifies or affirms the truthfulness and accuracy of each statement of its certification and disclosure, if any. In addition, the Contractor understands and agrees that the provisions of 31 U.S.C. § 3801 et seq., apply to this certification and disclosure, if any.

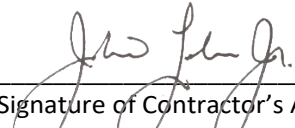

 Signature of Contractor's Authorized Representative
Johnnie Lohrum Jr.

 Name
President

 Title
February 13, 2024

 Date

Solo Page

CITY REQUIRED FORMS

Attachment G

Attachment G

NON-COLLUSIVE AFFIDAVIT

Before me, the undersigned authority ("Affiant"), personally appeared:

Johnnie Lohrum Jr. who, being first duly sworn, deposes and says that:

- Affiant is the President [insert Owner, Partner, Officer, Representative or Agent] of j12 Architecture, LLC, [insert name of Contractor] the Respondent that has submitted the attached reply;
- Affiant is fully informed respecting the preparation and contents of the attached reply and of all pertinent circumstances respecting such reply;
- Such reply is genuine and is not a collusive or sham reply;
- Neither the said Respondent nor any of its officers, partners, owners, agents, representatives, employees or parties in interest, including this affiant, have in any way colluded, conspired, connived or agreed, directly or indirectly, with any other respondent, firm, or person to submit a collusive or sham reply in connection with the work for which the attached reply has been submitted: or have in any manner, directly or indirectly sought by agreement or collusion, or communication or conference with any respondent, firm, or person to fix the price or prices in the attached reply or of any other respondent, or to fix any overhead, profit, or cost elements of the reply price or the reply price of any other respondent, or to secure through any collusion, conspiracy, connivance, or unlawful agreement any advantage against (Recipient), or any person interested in the reply work.

Signed, sealed, and delivered on Feb. 9 2024

 Signature
 Johnnie Lohrum Jr.
 Printed Name
 President
 Title

SWORN ACKNOWLEDGMENT

STATE OF FLORIDA
COUNTY OF SEMINOLE

Sworn to (or affirmed) and subscribed before me by means of physical presence or online notarization, this 9th day of February 2024, by Johnnie Lohrum Jr.

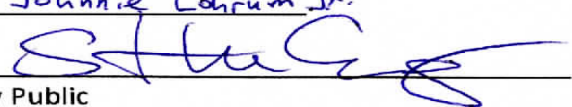
Notary Public

Personally Known OR Produced Identification
Type of Identification Produced _____

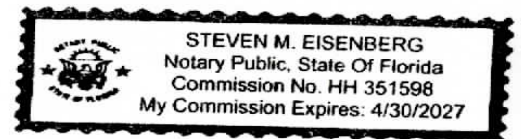

Solo Page

PROTECT & SERVE

CITY REQUIRED FORMS

Attachment H

Attachment H CONFLICT OF INTEREST FORM

Florida Statutes Section 112.313 places limitations on public officers (including advisory board members) and employees' ability to contract with the City of North Port, Florida ("City") either directly or indirectly.

PART I. [Select and complete all that apply]:

I am an employee, public officer, or advisory board member of the City.

Identify the position and/or board: _____

I am the spouse or child of an employee, public officer, or advisory board member of the City.

Identify the name of the spouse or child: _____

I am an employee, public officer or advisory board member of the City, or my spouse or child, is an officer, partner, director, or proprietor of Respondent/Contractor or has a material interest in Contractor. "Material interest" means direct or indirect ownership of more than 5 percent of the total assets or capital stock of any business entity. For the purposes of Florida Statutes Section 112.313, indirect ownership does not include ownership by a spouse or minor child.

Identify the name of the person and the entity _____

Bidder/Contractor employs or contracts with an employee, public officer, or advisory board member of the City.

Identify the name of the employee, public officer, or advisory board member _____

None of the Above

PART II: Will you request an advisory board member waiver?

I WILL request an advisory board member waiver under §112.313(12)

I WILL NOT request an advisory board member waiver under §112.313(12)

N/A

The City will review any relationships which may be prohibited under the Florida Ethics Code and will disqualify any Contractor whose conflicts are not waived or exempt.

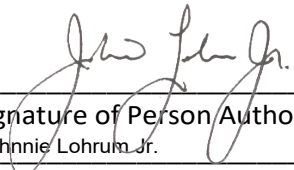

Signature of Person Authorized to Bind the Contractor
Johnnie Lohrum Jr.

Printed Name
President

Title
February 13, 2024

Date

PROTECT & SERVE

CITY REQUIRED FORMS

Attachment I

Attachment I

PUBLIC ENTITY CRIME INFORMATION

As provided by F.S. §287.133, a person or affiliate who has been placed on the convicted vendor list following a conviction for a public entity crime may not submit a bid on a Contract to provide any goods or services to a public entity, may not submit a bid on a Contract with a public entity for the construction or repair of a public building or public work, may not submit bids on leases of real property to a public entity, may not be awarded or perform work as a Contractor, supplier, Subcontractor, or Consultant under a Contract with any public entity, and may not transact business with any public entity in excess of the threshold amount provided in Section 287, for CATEGORY TWO for a period of 36 months from the date of being placed on the convicted vendor list.

I, Johnnie Lohrum Jr., being an authorized representative of the Contractor, have read and understand the contents above.

I certify that the Contractor is not disqualified from replying to this solicitation/contracting because of Florida Statutes Section 287.133.

Telephone #: 407.340.2879 Fax #: _____

Federal ID #: 92-1168022 Email: jlohrum@jl2architecture.com

[Signature]
Signature of Contractor's Authorized Representative

Johnnie Lohrum Jr., President
Name and Title of Contractor's Authorized Representative

2/9/2024
Date

SWORN ACKNOWLEDGMENT

STATE OF FLORIDA
COUNTY OF Seville

Sworn to (or affirmed) and subscribed before me by means of physical presence or online notarization, this 9th day of February 2024, by Johnnie Lohrum Jr.

[Signature]
Notary Public – State of Florida

Personally Known OR Produced Identification
Type of Identification Produced _____

Solo Page

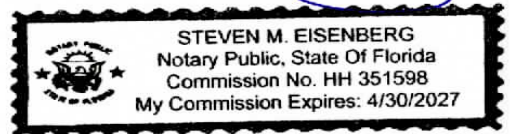

PROTECT & SERVE

CITY REQUIRED FORMS

Attachment J

Attachment J DRUG FREE WORKPLACE FORM

The undersigned, in accordance with Florida Statutes Section 287.087, hereby certifies that the Contractor, jl2 Architecture, LLC (Company Name):

1. Publishes a statement notifying employees that the unlawful manufacture, distribution, dispensing, possession, or use of a controlled substance is prohibited in the workplace and specifying the actions that will be taken against employees for violations of such prohibition.
2. Informs employees about the dangers of drug abuse in the workplace, the business’s policy of maintaining a drug free workplace, any available drug counseling, rehabilitation, and employee assistance programs, and the penalties that may be imposed upon employees for drug abuse violations.
3. Gives each employee engaged in providing the commodities or Contractual services that are under bid a copy of the statement specified in subsection (1).
4. In the statement specified in subsection (1), notifies employees that, as a condition of working on the commodities or Contractual services that are under bid, the employee will abide by the terms of the statement and will notify the employer of any conviction of, or plea of guilty or nolo contendere to, any violation of Chapter 893 or of any controlled substance law of the United States or any state, for a violation occurring in the workplace no later than five (5) days after such conviction.
5. Imposes a sanction on or require the satisfactory participation in a drug abuse assistance or rehabilitation program if such is available in the employee’s community, by any employee who is so convicted.
6. Makes a good faith effort to continue to maintain a drug free workplace through implementation of this section.

Check one:

As the person authorized to sign this statement, I certify that this firm complies fully with above requirements.

As the person authorized to sign this statement, this firm **does not** comply fully with the above requirements.

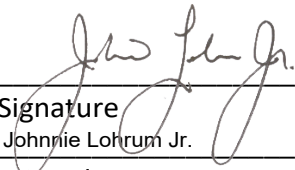

 Signature
 Johnnie Lohrum Jr.

 Printed Name
 President

 Title
 February 13, 2024

 Date

PROTECT & SERVE

CITY REQUIRED FORMS

Attachment K

Attachment K

SCRUTINIZED COMPANY CERTIFICATION FORM

Contractor Name: j12 Architecture, LLC
Authorized Representative Name and Title: Johnnie Lohrum Jr., President
Address: 1678 Kingston Road City: Longwood State: FL ZIP: 32750
Phone Number: 407.340.2879 Email Address: jlohrum@j12architecture.com

A company is ineligible to, and may not, bid on, submit a proposal for, or enter into or renew a Contract with the City of North Port for goods or services of any amount if, at the time of bidding on, submitting a proposal for, or entering into or renewing such Contract, the company is on the Scrutinized Companies that Boycott Israel List, created pursuant to Florida Statutes, section 215.4725, or is engaged in a boycott of Israel.

A company is ineligible to, and may not, bid on, submit a proposal for, or enter into or renew a Contract with the City of North Port for goods or services of \$1 million or more if, at the time of bidding on, submitting a proposal for, or entering into or renewing such Contract, the company is on the Scrutinized Companies with Activities in Sudan List, the Scrutinized Companies with Activities in the Iran Petroleum Energy Sector List, created pursuant to Florida Statutes, section 215.473, or with companies engaged in business operations in Cuba or Syria.

CHOOSE ONE OF THE FOLLOWING

This Contract or Contract renewal is for goods or services of less than \$1 million. As the person authorized to sign on behalf of the above-named company, and as required by Florida Statutes Section 287.135(5), I hereby certify that the above-named company is not participating in a boycott of Israel.

This bid, proposal, Contract or Contract renewal is for goods or services of \$1 million or more. As the person authorized to sign on behalf of the above-named company, and as required by Florida Statutes Section 287.135(5), I hereby certify that the above-named company is not participating in a boycott of Israel, is not on the Scrutinized Companies with Activities in Sudan List or the Scrutinized Companies with Activities in the Iran Petroleum Energy Sector List, and it does not have business operations in Cuba or Syria.

I understand that pursuant to Florida Statutes, section 287.135, the submission of a false certification may result in the termination of the Contract if one is entered into, and may subject the above-named company to civil penalties, attorney's fees and costs.

Certified By:



Signature of Contractor's Authorized Representative

Johnnie Lohrum Jr.

Name

President

Title

February 13, 2024

Date

PROTECT & SERVE

CITY REQUIRED FORMS

Attachment L

Attachment L

VENDOR'S CERTIFICATION FOR E-VERIFY SYSTEM

The undersigned Vendor/Consultant/Contractor (Vendor), after being duly sworn, states the following:

1. Vendor is a person or entity that has entered into or is attempting to enter into a contract with the City of North Port (City) to provide labor, supplies, or services to the City in exchange for salary, wages or other remuneration.
2. Vendor has registered with and will use the E-Verify System of the United States Department of Homeland Security to verify the employment eligibility of:
 - a. All persons newly hired by the Vendor to perform employment duties within Florida during the term of the contract; and
 - b. All persons, including sub-contractors, sub-vendors or sub-consultants, assigned by the Vendor to perform work pursuant to the contract with the City.
3. If the Vendor becomes the successful Contractor who enters into a contract with the City, then the Vendor will comply with the requirements of Section 448.095, Fla. Stat. "Employment Eligibility", as amended from time to time.
4. Vendor will obtain an affidavit from all subcontractors attesting that the subcontractor does not employ, contract with, or subcontract with, an unauthorized alien as defined in 8 United States Code, Section 1324A(H)(3).
5. Vendor will maintain the original affidavit of all subcontractors for the duration of the contract.
6. Vendor affirms that failure to comply with the state law requirements can result in the City's termination of the contract and other penalties as provided by law.
7. Vendor understands that pursuant to Florida Statutes, section 448.095, the submission of a false certification may result in the termination of the contract if one is entered into, and may subject the Vendor named in this certification to civil penalties, attorney's fees and costs.

VENDOR: jl2 Architecture, LLC (Vendor's Company Name)

Certified By: 
AUTHORIZED REPRESENTATIVE SIGNATURE

Print Name and Title: Johnnie Lohrum Jr., President

Date Certified: February 13, 2024

PROTECT & SERVE

CITY REQUIRED FORMS

Insurance Certificate



JL2ARCH-01

KMCINTOSH

CERTIFICATE OF LIABILITY INSURANCE

DATE (MM/DD/YYYY)
2/1/2024

THIS CERTIFICATE IS ISSUED AS A MATTER OF INFORMATION ONLY AND CONFERS NO RIGHTS UPON THE CERTIFICATE HOLDER. THIS CERTIFICATE DOES NOT AFFIRMATIVELY OR NEGATIVELY AMEND, EXTEND OR ALTER THE COVERAGE AFFORDED BY THE POLICIES BELOW. THIS CERTIFICATE OF INSURANCE DOES NOT CONSTITUTE A CONTRACT BETWEEN THE ISSUING INSURER(S), AUTHORIZED REPRESENTATIVE OR PRODUCER, AND THE CERTIFICATE HOLDER.

IMPORTANT: If the certificate holder is an ADDITIONAL INSURED, the policy(ies) must have ADDITIONAL INSURED provisions or be endorsed. If SUBROGATION IS WAIVED, subject to the terms and conditions of the policy, certain policies may require an endorsement. A statement on this certificate does not confer rights to the certificate holder in lieu of such endorsement(s).

PRODUCER JCJ Insurance Agency, LLC 2208 Hillcrest Street Orlando, FL 32803	CONTACT NAME: PHONE (A/C, No, Ext): (321) 445-1117 FAX (A/C, No): (321) 445-1076 E-MAIL ADDRESS: certs@jcj-insurance.com	
	INSURER(S) AFFORDING COVERAGE NAIC #	
INSURED JI2architecture 1678 Kingston Rd Longwood, FL 32750	INSURER A : Phoenix Insurance Co. (Travelers) 25623	
	INSURER B : Beazley Insurance Company, Inc 37540	
	INSURER C :	
	INSURER D :	
	INSURER E :	

COVERAGES **CERTIFICATE NUMBER:** **REVISION NUMBER:**

THIS IS TO CERTIFY THAT THE POLICIES OF INSURANCE LISTED BELOW HAVE BEEN ISSUED TO THE INSURED NAMED ABOVE FOR THE POLICY PERIOD INDICATED. NOTWITHSTANDING ANY REQUIREMENT, TERM OR CONDITION OF ANY CONTRACT OR OTHER DOCUMENT WITH RESPECT TO WHICH THIS CERTIFICATE MAY BE ISSUED OR MAY PERTAIN, THE INSURANCE AFFORDED BY THE POLICIES DESCRIBED HEREIN IS SUBJECT TO ALL THE TERMS, EXCLUSIONS AND CONDITIONS OF SUCH POLICIES. LIMITS SHOWN MAY HAVE BEEN REDUCED BY PAID CLAIMS.

INSR LTR	TYPE OF INSURANCE	ADDL INSD	SUBR WVD	POLICY NUMBER	POLICY EFF (MM/DD/YYYY)	POLICY EXP (MM/DD/YYYY)	LIMITS
A	<input checked="" type="checkbox"/> COMMERCIAL GENERAL LIABILITY <input type="checkbox"/> CLAIMS-MADE <input checked="" type="checkbox"/> OCCUR GEN'L AGGREGATE LIMIT APPLIES PER: <input type="checkbox"/> POLICY <input checked="" type="checkbox"/> PRO-JECT <input type="checkbox"/> LOC OTHER:	X	X	6602W553362	12/21/2023	12/21/2024	EACH OCCURRENCE \$ 1,000,000 DAMAGE TO RENTED PREMISES (Ea occurrence) \$ 1,000,000 MED EXP (Any one person) \$ 5,000 PERSONAL & ADV INJURY \$ 1,000,000 GENERAL AGGREGATE \$ 2,000,000 PRODUCTS - COMP/OP AGG \$ 2,000,000 \$
A	AUTOMOBILE LIABILITY <input type="checkbox"/> ANY AUTO OWNED AUTOS ONLY <input type="checkbox"/> SCHEDULED AUTOS <input checked="" type="checkbox"/> HIRED AUTOS ONLY <input checked="" type="checkbox"/> NON-OWNED AUTOS ONLY	X	X	6602W553362	12/21/2023	12/21/2024	COMBINED SINGLE LIMIT (Ea accident) \$ 1,000,000 BODILY INJURY (Per person) \$ BODILY INJURY (Per accident) \$ PROPERTY DAMAGE (Per accident) \$ \$
	<input type="checkbox"/> UMBRELLA LIAB <input type="checkbox"/> OCCUR <input type="checkbox"/> EXCESS LIAB <input type="checkbox"/> CLAIMS-MADE DED RETENTION \$						EACH OCCURRENCE \$ AGGREGATE \$ \$
	WORKERS COMPENSATION AND EMPLOYERS' LIABILITY ANY PROPRIETOR/PARTNER/EXECUTIVE OFFICER/MEMBER EXCLUDED? (Mandatory in NH) Y/N N/A If yes, describe under DESCRIPTION OF OPERATIONS below						<input type="checkbox"/> PER STATUTE <input type="checkbox"/> OTH-ER E.L. EACH ACCIDENT \$ E.L. DISEASE - EA EMPLOYEE \$ E.L. DISEASE - POLICY LIMIT \$
B	Professional Liab			C341C2230201	12/21/2023	12/21/2025	Per Claim/Aggregate 2,000,000

DESCRIPTION OF OPERATIONS / LOCATIONS / VEHICLES (ACORD 101, Additional Remarks Schedule, may be attached if more space is required)
 Contract NO. 2024-17 - PROFESSIONAL ARCHITECTURAL AND ENGINEERING SERVICES
 City of North Port, its officers, officials, and employees are an Additional Insureds with regards to General & Auto Liability when required by written contract. Waiver of subroagtion applies in favor of the additional insureds when required by written contract. 30 Day Notice of Cancellation, except for 10 days for non-payment.

CERTIFICATE HOLDER City of North Port Alla V. Skipper, CPPB, Senior Contract Adminstrator Finance Department 4970 City Hall Blvd, Suite 337 North Port, FL 34286	CANCELLATION SHOULD ANY OF THE ABOVE DESCRIBED POLICIES BE CANCELLED BEFORE THE EXPIRATION DATE THEREOF, NOTICE WILL BE DELIVERED IN ACCORDANCE WITH THE POLICY PROVISIONS. AUTHORIZED REPRESENTATIVE
--	--

ACORD 25 (2016/03) © 1988-2015 ACORD CORPORATION. All rights reserved.
 The ACORD name and logo are registered marks of ACORD

PROTECT & SERVE

CITY REQUIRED FORMS

MBE / WBE / VBE

jl2 Architecture is not a minority business enterprise, however, the firm does operate as small businesses.

We also take minority business requirements seriously and have included minority companies as a part of this proposal.



X **MBE/WBE/VBE:** If claiming either Minority Business Enterprise/Women Business Enterprises/Veteran Business Enterprise, the Prime Firm (not sub-consultant) **shall be** certified as a Minority Business Enterprise by the State of Florida, Department of Management Services, Office of Supplier Diversity pursuant to Section 287.0943, Florida Statutes (pick one):

1. ___ **YES**, CLAIMING STATUS AS PRIME ONLY (**MBE/WBE/VBE**)

___ **YES**, I'VE ATTACHED THE CERTIFICATE OF MBE/WBE STATUS FROM STATE OF FLORIDA AS OUTLINED SECTION 1.

2. **X** **NOT CLAIMING MBE/WBE /VBE**

PLEASE INITIAL AND RETURN WITH YOUR PROPOSAL.

John Lee Jr.

INITIALS

THIS PAGE MUST BE COMPLETED AND SUBMITTED

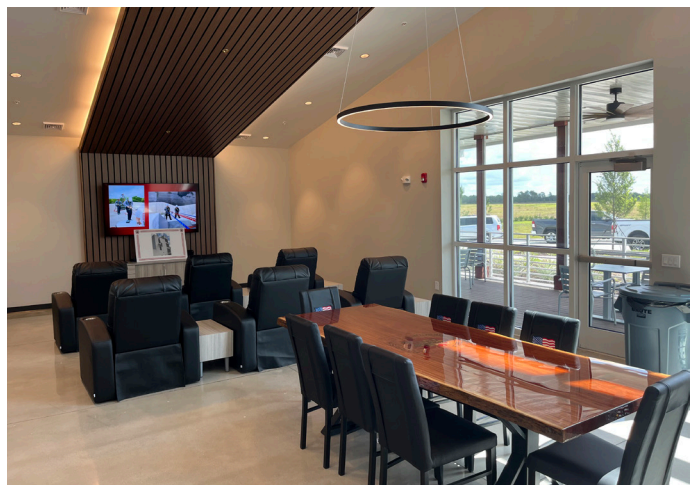

PROTECT & SERVE

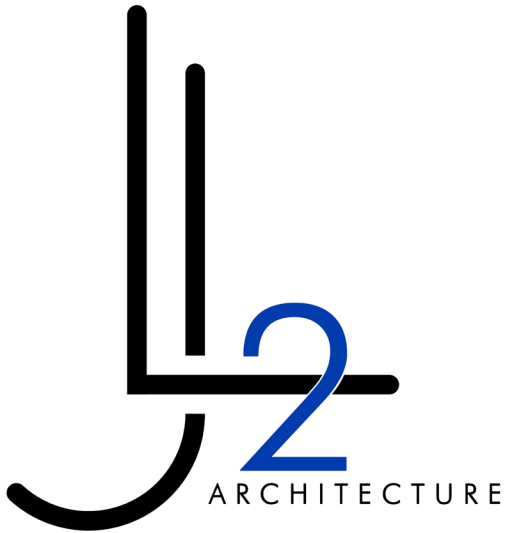

1678 KINGSTON ROAD
LONGWOOD, FLORIDA 32750
D: 407.340.2879

J2 Architecture