

CITY OF NORTH PORT

RFP #2022-28

**PROFESSIONAL ARCHITECTURAL AND ENGINEERING SERVICES
FOR PUBLIC SERVICES FACILITY PHASE II**



SWEETSPARKMAN
ARCHITECTURE & INTERIORS

SWEET SPARKMAN ARCHITECTS, INC.
TODD M. SWEET, AIA, LEED AP
1819 MAIN STREET, SUITE 400,
SARASOTA, FL 34236
T: 941.952.0084
E: TSWEET@SWEETSPARKMAN.COM



Table of Contents

TAB 1: TRANSMITTAL LETTER

Transmittal Letter	2
--------------------	---

TAB 2: QUALIFICATIONS OF THE FIRM

Firm Overview	3
SF330 Part I	5
SF330 Part II	6

TAB 3: KEY PERSONNEL

Organizational Chart	16
SF330 Part I - Section E	17

TAB 4: TEAM'S PREVIOUS EXPERIENCE / SIMILAR PROJECTS

SF330 Part I - Section F	37
SF330 Part I - Section G	42

TAB 5: MANAGEMENT APPROACH / PROJECT CONTROL

Management Approach	43
Project Controls	43
Technical Capabilities	44
Workload	44

TAB 6: REFERENCES

Attachment 3 - References / Client Listing	45
--	----

TAB 7: LITIGATION AND INSURANCE

Litigation Statement	47
Insurance Certificate	48

TAB 8: ADDITIONAL INFORMATION

Additional Information	49
SF330 Part I - Section H	50

TAB 9: CITY REQUIRED FORMS

Requirements Checklist	51
Proposal Submittal Signature Form	52
Statement of Organization	53
Drug Free Workplace	55
Public Entity Crime Information	56
Non-Collusive Affidavit	57
Lobbying Certification	58
Conflict of Interest Form	59
Disclosure Form	60
Scrutinized Company Certificate	61
Vendor's Certification for E-Verify System	62



Sarasota County
South County Courthouse

SWEETSPARKMAN
ARCHITECTURE & INTERIORS



TAB 1

TRANSMITTAL LETTER



September 1, 2022

Ginny Duyn, CPPB, Senior Purchasing Administrator
City of North Port
Finance Department - Purchasing Division
4970 City Hall, 3 RD Floor, Suite 337
North Port, Florida 34286

Re: RFP #2022-28 - Professional Architectural and Engineering Services for Public Services Facility Phase II

Dear Ms. Duyn and Members of the Selection Committee,

The design of the Public Services Facility will require a team of professionals committed to the goals and objectives of the City of North Port. Sweet Sparkman Architecture and Interiors (SSAI) understands the importance of completing this project as an integrated success; thorough investigation and documentation, client partnership, and timely completion. We have combined our talents to create a team with the experience and communication skills to provide a successful project for our community.

SIGNIFICANT TRACK RECORD IN THE DESIGN OF GOVERNMENT FACILITIES

Our team can boast extensive experience in the programming, analysis, and design of Administration Facilities as well as Fleet Maintenance Facilities for the Government sector. Specifically, SSAI staff has planned and designed over a dozen government buildings over the last 20 years. These include facilities for Sarasota County, Charlotte County, Manatee County, the City of Venice, the City of Cape Coral, and the City of St. Petersburg. Additional projects include R.L. Anderson South County Courts Renovation and Addition, Venice City Hall Expansion, Charlotte County Justice Center, School District of Manatee County Professional Support Center, Cape Coral Fire Administration Facility, Manatee County Utilities and Public Works Administration Building, St. Petersburg Sanitation Department Building, and North Port Fire Station #85. SSAI is currently designing Fleet Maintenance Facilities for Pinellas County Schools and the City of Cape Coral.

PROVEN FIRM WITH A QUALIFIED WORKFORCE

Sweet Sparkman is an architectural, planning, and interior design firm specializing in government sector projects. Our staff of thirty-five (35) is well-versed in creating administration facilities, emphasizing operational efficiency and sustainable practices. This team offers the following:

- Seasoned and experienced staff with a successful track record of designing administration facilities
- Expertise in the planning and design of facilities to deliver overall cost savings
- Excellence in client service - 80% of our projects are for repeat clients
- The ability to listen and bring together various groups and stakeholders into a collective whole
- Recognized excellence in government building design with (3) APWA service awards

We have assembled a LOCAL team that works exceptionally well together and comes to this project familiar with both the project and site. We have partnered with Weston & Sampson for civil engineering, site design, and specialty fleet facility experience. ME3 is our mechanical, electrical, and plumbing engineer. Karins Engineer Group will provide structural engineering. T2 Utility Engineers will provide survey, mapping and SUE services. Landesco will provide environmental consulting. Ardaman & Associates will provide geotechnical engineering. We have extensive experience with these consultants. There is no learning curve with this team.

DESIGN EXCELLENCE AND PRINCIPAL-LED PROJECT MANAGEMENT

Design excellence is the cornerstone of our practice. We are committed to high quality and top performance. Success is measured by client satisfaction. As Principal-in-Charge, I will serve as the City's direct point of contact for this agreement. I will lead the design team and provide the overall leadership, assurances of resources for the project, and management of the project's business matters. My ongoing experience with government projects has given me a keen perspective of the projects' needs and the importance of these agreements and timelines.

COMMITTED TO YOUR SUCCESS

We believe in what we do and are committed to seeing you succeed. We maintain an unwavering commitment to design excellence and client service. We devote our experienced team members to working with the City of North Port. Our team has a very personal commitment to providing a facility that enhances the experience for City of North Port staff.

Respectfully Submitted,
Sweet Sparkman Architecture and Interiors

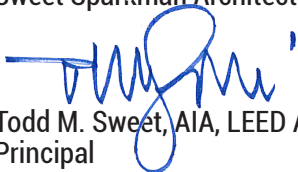

Todd M. Sweet, AIA, LEED AP
Principal



SWEETSPARKMAN
ARCHITECTURE & INTERIORS



TAB 2

QUALIFICATIONS OF THE FIRM

Qualifications

Firm Overview



Sweet Sparkman Architecture and Interiors is a multi-disciplinary architecture and interiors firm specializing in community oriented projects. The firm believes design excellence is achieved by carefully analyzing every parameter affecting the development of the project. This scrutiny includes financial, physical, social, and environmental factors. Our firm is interested in projects, not measured by size, but by their relevance to the owner, community, and environment. Planning and design are collaborative, action-oriented processes that identify problems and create solutions to meet the client's goals. Understanding these elements inspires site-specific design solutions for truly distinctive, environmentally sensitive architecture and interior design. In addition to solving real estate and functional spaces issues, our design process and solutions address the overall end user experience.

The firm was established in 2002. Principals, Todd Sweet, AIA, LEED AP; Jerry Sparkman, AIA, NCARB; and John Bryant, AIA, LEED AP; bring a combined 75 years experience in architecture and planning, including residential, civic, and community projects. Sweet Sparkman has 35 full time employees, 12 of which are registered architects. Sweet Sparkman's expertise in design along with total team commitment and a high level of client communication is the combination that provides exceptional results.

Sweet Sparkman has provided professional architectural services to other government agencies and includes City of North Port, Manatee County, Sarasota County, Charlotte County, Highlands County, City of Sarasota, City of St. Petersburg, City of St. Pete Beach, Pinellas County, and Lee County. We consistently provide the highest level of service to our clients, regardless of the size or complexity of the project.

EXPERIENCE AND SERVICES

Sweet Sparkman is located in Downtown Sarasota, FL within 35 miles of the City of North Port. Our office is 4,579 SF with industry standard and advanced equipment, tools, and resources to provide the best service. Our team will be on-site for design team meetings as well as construction meetings at project milestone dates or as often as needed. In addition to on-site representation our team regularly uses Zoom and GoToMeeting for convenience and when physical attendance is not possible.

Sweet Sparkman has a unique service offering that stems from our extensive and varied project experience and qualifications. We have the ability to work as a cohesive team with a significant track record working on large government projects, and commitment to design excellence and customer service.

Our firm has completed a wide range of projects including government administration buildings, fire stations and public safety facilities, libraries, and public parks. Our office is well versed on providing professional services to government agencies and has served over 20 municipalities and educational organizations over the past 20 years. Our team can boast extensive experience in the programming, analysis, and design of Administration Facilities for the Government sector. We consistently provide the highest level of service to our clients, regardless of the size or complexity of the project.

Sweet Sparkman has the capacity to serve the City of North Port with the following services:

- Space Needs Analysis
- Development of Design Criteria
- Programming
- Master Planning and Conceptual Design
- Architectural Engineering and Design
- Project Permitting Services
- Development of Construction Cost Opinions
- Development of Construction Plans and Specifications
- Professional Services During Construction
- Construction Administration Services
- Preparation of Project Record Drawings
- Sustainable (LEED) Design
- Value Engineering

FIRM'S YEARS OF EXPERIENCE

20 years in business

BUSINESS STRUCTURE

Corporation

CORPORATION INFORMATION

Sweet Sparkman Architects, Inc. dba Sweet Sparkman Architecture and Interiors was incorporated in the state of Florida on October 18, 2002 under a former name, TOTeMs Architecture, Inc.

CONTACT INFORMATION

Address: 1819 Main Street, Suite 400, Sarasota, FL 34236

Phone: 941-952-0084

Email: tsweet@sweetsparkman.com

Website: www.sweetsparkman.com

Contact Person: Todd M. Sweet, AIA, LEED AP - Principal

SIZE OF FIRM

Full Time Employees: 35

Management: 4

Technical: 27

Support Staff: 4

LICENSES

Todd M. Sweet, AIA, LEED AP: AR0015832

John Bryant, AIA, LEED AP: AR95599

Arturo Lopez, AIA: AR100162

ARCHITECT - ENGINEER QUALIFICATIONS

PART I - CONTRACT-SPECIFIC QUALIFICATIONS

A. CONTRACT INFORMATION

1. TITLE AND LOCATION (City and State) Professional Architectural and Engineering Services for Public Services Facility Phase II - North Port, FL		
2. PUBLIC NOTICE DATE August 1, 2022	3. SOLICITATION OR PROJECT NUMBER 2022-28	

B. ARCHITECT-ENGINEER POINT OF CONTACT

4. NAME AND TITLE Todd M. Sweet, AIA, LEED AP - Principal		
5. NAME OF FIRM Sweet Sparkman Architects, Inc. dba Sweet Sparkman Architecture and Interiors		
6. TELEPHONE NUMBER 941-952-0084	7. FAX NUMBER N/A	8. E-MAIL ADDRESS tsweet@sweetsparkman.com

C. PROPOSED TEAM

(Complete this section for the prime contractor and all key subcontractors.)

	(Check)			9. FIRM NAME	10. ADDRESS	11. ROLE IN THIS CONTRACT
	PRIME	JOINT PARTNER	SUB-CONTRACTOR			
a.	<input checked="" type="checkbox"/>			Sweet Sparkman Architects, Inc. dba Sweet Sparkman Architecture and Interiors <input type="checkbox"/> CHECK IF BRANCH OFFICE	1819 Main Street Suite 400 Sarasota, FL 34236	Architecture
b.			<input checked="" type="checkbox"/>	Weston & Sampson Engineers, Inc. <input checked="" type="checkbox"/> CHECK IF BRANCH OFFICE	1520 Royal Palm Square Blvd Suite 260 Fort Myers, FL 33919	Civil Engineering
c.			<input checked="" type="checkbox"/>	Karins Engineering Group <input type="checkbox"/> CHECK IF BRANCH OFFICE	1626 Ringling Blvd Unit 400 Sarasota, FL 34236	Structural Engineering
d.			<input checked="" type="checkbox"/>	ME3 Consulting Engineers, LLC. <input type="checkbox"/> CHECK IF BRANCH OFFICE	5300 Paylor Lane Sarasota, FL 34240	Mechanical, Electrical, Plumbing, Fire Protection Engineering
e.			<input checked="" type="checkbox"/>	Landesco, PLLC <input type="checkbox"/> CHECK IF BRANCH OFFICE	18197 Sandy Pines Circle North Fort Myers, FL 33917	Environmental Consultant
f.			<input checked="" type="checkbox"/>	Ardaman & Associates, Inc. <input checked="" type="checkbox"/> CHECK IF BRANCH OFFICE	1724 Barber Road Sarasota, FL 34240	Geotechnical Engineering
g.			<input checked="" type="checkbox"/>	T2 UES, Inc. dba T2 Utility Engineers <input checked="" type="checkbox"/> CHECK IF BRANCH OFFICE	5670 Zip Drive Fort Myers, FL 33905	Survey and Subsurface Utility Engineering (SUE)

D. ORGANIZATIONAL CHART OF PROPOSED TEAM

(Attached)

ARCHITECT-ENGINEER QUALIFICATIONS

1. SOLICITATION NUMBER (If any)

2022-28

PART II - GENERAL QUALIFICATIONS

(If a firm has branch offices, complete for each specific branch office seeking work.)

2a. FIRM (or Branch Office) NAME Weston & Sampson Engineers, Inc.			Weston & Sampson		3. YEAR ESTABLISHED 2008	4. UNIQUE ENTITY IDENTIFIER UERUKNFQN3D5
2b. STREET 1520 Royal Palm Square Blvd, Suite 260					5. OWNERSHIP	
2c. CITY Fort Myers			2d. STATE FL	2e. ZIP CODE 33919		
6a. POINT OF CONTACT NAME AND TITLE Joseph Zongol, PE, NICET III, Regional Manager					a. TYPE Privately Held Corporation	
6b. TELEPHONE NUMBER 518-463-4400 x. 6504					6c. EMAIL ADDRESS zongolj@wseinc.com	
6a. POINT OF CONTACT NAME AND TITLE Joseph Zongol, PE, NICET III, Regional Manager					b. SMALL BUSINESS STATUS Not Applicable	
6b. TELEPHONE NUMBER 518-463-4400 x. 6504					6c. EMAIL ADDRESS zongolj@wseinc.com	
8a. FORMER FIRM NAME(S) (If any)			8b. YEAR ESTABLISHED		8c. UNIQUE ENTITY IDENTIFIER	
Robert Spurr Weston			1899		Not Applicable	
Weston & Sampson (partnership)			1916		Not Applicable	
Weston & Sampson Engineers, Inc.			1976		049433352	

9. EMPLOYEES BY DISCIPLINE

10. PROFILE OF FIRM'S EXPERIENCE AND ANNUAL AVERAGE REVENUE FOR LAST 5 YEARS

a. Function Code	b. Discipline	c. Number of Employees		a. Profile Code	b. Experience	c. Revenue Index Number (see below)
		(1) FIRM	(2) BRANCH			
02	Administrative	95		A02	Aerial Photogrammetry	1
06	Architect	19		B02	Bridges	4
08	CADD Technician	5		C14	Conservation & Resource Management	4
10	Chemical Engineer	5		C15	Construction Management	6
12	Civil Engineer	57	2	C16	Construction Surveying	7
14	Computer Programmer	4		C18	Cost Estimating; Cost Engineering and Analysis; Parametric Costing; Forecasting	2
15	Construction Inspector	19		D02	Dams (Earth; Rock); Dikes; Levees	4
16	Construction Manager	4		E01	Ecological & Archeological Investigations	1
18	Cost Engineer/Estimator	1		E08	Engineering Economics	1
21	Electrical Engineer	6		E09	Environmental Impact Studies; Assessments or Statements	5
23	Environmental Engineer	57	2	E12	Environmental Remediation	8
24	Environmental Scientist	20		H07	Highways; Streets; Airfield Paving	7
27	Geotechnical Engineer	12		H12	Hydraulics	4
29	GIS Specialist	9		G04	Geographic Information System Services	3
30	Geologist	19		G05	Geospatial Data Conversion, Scanning, Digitizing	2
32	Hydraulic Engineer	2		G06	Graphic Design	1
34	Hydrologist	8		I02	Industrial Processes; Quality Control	2
38	Land Surveyor	1		I03	Industrial Waste Treatment	2
39	Landscape Architect	27		I06	Irrigation; Drainage	7
42	Mechanical Engineer	13	2	L02	Land Surveying	5
47	Planner: Urban/Regional	8		L03	Landscape Architecture	8
48	Project Manager	38		P02	Petroleum and Fuel (Storage and Distribution)	4

50	Risk Assessor	1		P04	Pipelines (Cross-Country- Liquid and Gas)	8
51	Safety/Occupational Health Engineer	1		P06	Planning (Site, Installation, and Project)	5
52	Sanitary Engineer	70	1	R04	Recreation Facilities (Parks, Marinas, Etc.)	7
53	Scheduler	1		R11	Rivers; Canals; Waterways; Flood Control	5
56	Specification Writer	1		S04	Sewage Collection, Treatment, and Disposal	10
57	Structural Engineer	13	1	S05	Soils & Geologic Studies; Foundations	5
58	Technician/Analyst	33		S07	Solid Wastes; Incineration; Landfill	5
60	Transportation Engineer	31	2	S09	Structural Design; Special Structures	5
62	Water Resources Engineer	43	4	S10	Surveying; Platting; Mapping; Flood Plain Studies	5
63	Electrician	9		S12	Swimming Pools	7
64	Mechanic	27		S13	Storm Water Handling & Facilities	7
65	Foreman	4		T02	Testing and Inspection Services	3
66	Laborer	7		T03	Traffic & Transportation Engineering	7
67	General Manager	8		T04	Topographic Surveying and Mapping	3
68	Waterworks Operator	16		U02	Urban Renewals; Community Development	6
69	Wastewater Operator	29		U03	Utilities (Water and Sewer)	10
70	Aquatics Engineer	4		W02	Water Resources; Hydrology; Ground Water	9
71	UAS Specialist	3		W03	Water Supply; Treatment and Distribution	9
72	Visualization	1				
73	Natural Resources	1				
Total		732	14			

11. ANNUAL AVERAGE PROFESSIONAL SERVICES REVENUES OF FIRM FOR LAST 3 YEARS

(Insert revenue index number shown at right)

a. Federal Work	5
b. Non-Federal Work	10
c. Total Work	10

PROFESSIONAL SERVICES REVENUE INDEX NUMBER

- | | |
|---|---|
| 1. Less Than \$100,000 | 6. \$2 million to less than \$5 million |
| 2. \$100,000 to less than \$250,000 | 7. \$5 million to less than \$10 million |
| 3. \$250,000 to less than \$500,000 | 8. \$10 million to less than \$25 million |
| 4. \$500,000 to less than \$1 million | 9. \$25 million to less than \$50 million |
| 5. \$1 million to less than \$2 million | 10. \$50 million or greater |

12. AUTHORIZED REPRESENTATIVE

The foregoing is a statement of facts.

a. SIGNATURE



b. DATE

March 28, 2022

c. NAME AND TITLE

Joseph Zongol, PE, NICET III, Regional Manager

ARCHITECT- ENGINEER QUALIFICATIONS

1. SOLICITATION NUMBER (If any)
2022-28

PART II - GENERAL QUALIFICATIONS

(If a firm has branch offices, complete for each specific branch office seeking work.)

2a. FIRM (or Branch Office) NAME Ardaman & Associates, Inc.			3. YEAR ESTABLISHED 1960	4. UNIQUE ENTITY IDENTIFIER 070875166
2b. STREET 1724 Barber Road			5. OWNERSHIP	
2c. CITY Sarasota			2d. STATE FL	2e. ZIP CODE 34240
6a. POINT OF CONTACT NAME AND TITLE Virginia A. Goff, P.E., Asst. Vice President			a. TYPE Corporation	
6b. TELEPHONE NUMBER (941) 922-3526		6c. E-MAIL ADDRESS ggoff@ardaman.com		
7. NAME OF FIRM (If Block 2a is a Branch Office) Ardaman & Associates, Inc. 8008 S. Orange Avenue Orlando, FL 32809			b. SMALL BUSINESS STATUS	

8a. FORMER FIRM NAME(S) (If any)	8b. YEAR ESTABLISHED	8c. UNIQUE ENTITY IDENTIFIER
----------------------------------	----------------------	------------------------------

9. EMPLOYEES BY DISCIPLINE				10. PROFILE OF FIRM'S EXPERIENCE AND ANNUAL AVERAGE REVENUE FOR LAST 5 YEARS		
a. Function Code	b. Discipline	c. Number of Employees		a. Profile Code	b. Experience	c. Revenue Index Number (see below)
		(1) FIRM	(2) BRANCH			
02	ADMINISTRATIVE	51	1	D02	Dams (Earth; Rock); Dikes; Levees	1
08	CADD TECHNICIAN	15		E02	Educational Facilities; Classrooms	1
14	COMPUTER PROGRAMMER	2		E09	Environmental Impact Studies, Assessments or Statements	3
15	CONSTRUCTION INSPECTOR	41	2	H07	Highways; Streets; Airfield Paving; Parking Lots	3
23	ENVIRONMENTAL ENGINEER	2	1	S05	Soils & Geologic Studies; Foundations	3
24	ENVIRONMENTAL SCIENTIST	5		S07	Solid Wastes; Incineration; Landfill	1
27	FOUNDATION / GEOTECHNICAL ENGINEER	89	3	T02	Testing & Inspection Services	3
29	GIS SPECIALIST	1		W02	Water Resources; Hydrology; Ground Water	1
30	GEOLOGIST	10				
40	MATERIALS ENGINEER	3				
58	TECHNICIAN / ANALYST	104	4			
62	WATER RESOURCES ENGINEER	2				
	DRILLERS	44	2			
	Other Employees					
Total		369	13			

11. ANNUAL AVERAGE PROFESSIONAL SERVICES REVENUES OF FIRM FOR LAST 3 YEARS (Insert revenue index number shown at right)		PROFESSIONAL SERVICES REVENUE INDEX NUMBER			
a. Federal Work	0	1. Less than \$100,000	6. \$2 million to less than \$5 million	7. \$5 million to less than \$10 million	8. \$10 million to less than \$25 million
b. Non-Federal Work	5	2. \$100,000 to less than \$250,000	9. \$25 million to less than \$50 million	10. \$50 million or greater	
c. Total Work	5	3. \$250,000 to less than \$500,000			
		4. \$500,000 to less than \$1 million			
		5. \$1 million to less than \$2 million			

12. AUTHORIZED REPRESENTATIVE

The foregoing is a statement of facts.

a. SIGNATURE 	b. DATE June 15, 2022
---	---------------------------------

c. NAME AND TITLE
Virginia A. Goff, P.E., Asst. Vice President



SWEETSPARKMAN
ARCHITECTURE & INTERIORS



TAB 3

KEY PERSONNEL



Organizational Chart

CLIENT / OWNER



PRIME ARCHITECT

SWEETSPARKMAN ARCHITECTURE & INTERIORS

TODD SWEET, AIA, LEED AP
PRINCIPAL IN CHARGE / ARCHITECT OF RECORD

ARTURO LOPEZ, AIA
PROJECT ARCHITECT

JOHN BRYANT, AIA, LEED AP
PROJECT MANAGER

SHIRLEY QUINLAN
INTERIOR DESIGNER

CONSULTANTS

CIVIL / SITE / FLEET SPECIALTY

WESTON & SAMPSON

JEFFREY WILSON, PE, PWLF
JOSEPH ZONGOL, PE, NICET III
MICHAEL RICHARD, PE
DANIEL TENNEY, III, AIA
GARY FERRANTE, PE
JEAN-PIERRE PARNAS, RA
JAMES FAIR, PE

MEP ENGINEERING

ME3 CONSULTING ENGINEERS

SIDNEY PRITCHARD, LEED AP
KAY C. CLEM, PE, LEED AP
BRYAN ZAPP, PE, LEED AP

STRUCTURAL ENGINEERING

KARINS ENGINEERING GROUP

DAVID G. KARINS, PE, SI
JEROME DIMERCURIO, PE

SURVEY / SUE

T2 UTILITY ENGINEERS

SCOTT URQUHART, PSM
ANTHONY RAVENNA

GEOTECHNICAL ENGINEERING

ARDAMAN & ASSOCIATES

JERRY H. KUEHN, PE

ENVIRONMENTAL / LANDSCAPE ARCH.

LANDESCO

CHRISTINE KULSVEEN

E. RESUMES OF KEY PERSONNEL PROPOSED FOR THIS CONTRACT
(Complete one Section E for each key person.)

12. NAME Todd M. Sweet, AIA, LEED AP	13. ROLE IN THIS CONTRACT Principal in Charge / Architect of Record	14. YEARS EXPERIENCE	
		a. TOTAL 31	b. WITH CURRENT FIRM 20

15. FIRM NAME AND LOCATION (City and State)
Sweet Sparkman Architecture and Interiors - Sarasota, FL

16. EDUCATION (DEGREE AND SPECIALIZATION) Roger Williams University, B.Arch, 1991 Rensselaer Polytechnic Institute, 1985	17. CURRENT PROFESSIONAL REGISTRATION (STATE AND DISCIPLINE) Registered Architect FL #AR-0015832 LEED Accredited Professional
--	---

18. OTHER PROFESSIONAL QUALIFICATIONS (Publications, Organizations, Training, Awards, etc.)
**American Institute of Architects Member
AIA Florida - 2018 Firm of the Year**

19. RELEVANT PROJECTS

(1) TITLE AND LOCATION (City and State)	(2) YEAR COMPLETED	
	PROFESSIONAL SERVICES	CONSTRUCTION (If applicable)
a. St. Petersburg Sanitation Department Building St. Petersburg, FL	Ongoing	Ongoing
(3) BRIEF DESCRIPTION (Brief scope, size, cost, etc.) AND SPECIFIC ROLE <input checked="" type="checkbox"/> Check if project performed with current firm The scope of work includes a new 18,528 SF administration and operations building for the Sanitation Department with a new parking lot to accommodate 193 total parking spaces. The program includes administration offices, conference rooms, restrooms, fitness room, and locker room / shower facilities. The site will be divided into a building area, fleet parking, storage area, and container storage. The project features a 2,000 SF green roof. This project is expected to be a LEED certified Net-Zero building. ROLE: Principal in Charge / Architect of Record SIZE: 18,528 SF COST: \$9 million		
b. School District of Manatee County Professional Support Center Bradenton, FL	2020	2020
(3) BRIEF DESCRIPTION (Brief scope, size, cost, etc.) AND SPECIFIC ROLE <input checked="" type="checkbox"/> Check if project performed with current firm The School District of Manatee County contracted Sweet Sparkman to complete renovations to their 150,000 SF Professional Support Center. The scope of work included upgrades to the HVAC system, replacing chillers, airside equipment and controls systems and repair / replacement of the building envelope, including the roof. The project occurred on an occupied ancillary site and required close coordination with District Staff, the Department of Construction Services, and Maintenance & Operations. Due to the continuous operation of the building, the project was phased to accommodate staff. ROLE: Principal in Charge / Architect of Record SIZE: 150,000 SF COST: x		
c. R.L. Anderson South County Courts Remodel and Addition Venice, FL	2021	2021
(3) BRIEF DESCRIPTION (Brief scope, size, cost, etc.) AND SPECIFIC ROLE <input checked="" type="checkbox"/> Check if project performed with current firm SCOPE: The new R.L. Anderson South County Courts Building Remodel and Addition includes construction of a new, two-story, four-court, courthouse and ancillary spaces to serve the 12th Judicial Circuit Court, the Clerk of the Circuit Court and County Comptroller, and Court Administration. The new 40,000 SF building will be located on the campus of the existing building. The project includes extensive site work including expanded parking, new stormwater treatment facilities, and landscaping improvements. Renovations to the existing buildings will include modernization of lighting, elevators, mechanical equipment and interiors. Sweet Sparkman served as the Local Architect in collaboration with the Architect of Record, DLR Group. ROLE: Principal in Charge SIZE: 40,000 SF COST: \$25.6 million		
d. Pinellas County Schools Coachman Service Center Clearwater, FL	Ongoing	Ongoing
(3) BRIEF DESCRIPTION (Brief scope, size, cost, etc.) AND SPECIFIC ROLE <input checked="" type="checkbox"/> Check if project performed with current firm SCOPE: Sweet Sparkman was contracted by Pinellas County Schools to design a new bus service garage to hold and maintain the buses servicing the district's mid county schools. The scope includes demolition of an existing structure, new construction of a 9,600 SF 5-bay bus service garage with associated work spaces, a renovation of 5 offices, lounge, and workspaces, and a conversion of the existing transportation command center back into a kitchen to serve the school. Site work will include a revised parking lot layout and drive access. ROLE: Principal in Charge / Architect of Record SIZE: 9,600 SF New Construction and 2,500 SF Renovation COST: \$5.7 Million		
e. Cape Coral Fleet Maintenance Facility Cape Coral, FL	Ongoing	N/A
(3) BRIEF DESCRIPTION (Brief scope, size, cost, etc.) AND SPECIFIC ROLE <input checked="" type="checkbox"/> Check if project performed with current firm Scope: Development of a feasibility study & conceptual design plan for a new Public Works Fleet Maintenance Facility. Project includes building programming, operational analysis, and review / development of future staff projections to determine appropriate building size. ROLE: Principal in Charge / Architect of Record		

E. RESUMES OF KEY PERSONNEL PROPOSED FOR THIS CONTRACT
(Complete one Section E for each key person.)

12. NAME John Bryant, AIA, LEED AP	13. ROLE IN THIS CONTRACT Principal Project Manager	14. YEARS EXPERIENCE	
		a. TOTAL 15	b. WITH CURRENT FIRM 11

15. FIRM NAME AND LOCATION (City and State)
Sweet Sparkman Architecture and Interiors - Sarasota, FL

16. EDUCATION (DEGREE AND SPECIALIZATION) University of Maryland, M.Arch, 2007 Grinnell College, BA - Music, 2000	17. CURRENT PROFESSIONAL REGISTRATION (STATE AND DISCIPLINE) Registered Architect FL #AR-95599 LEED Accredited Professional
---	---

18. OTHER PROFESSIONAL QUALIFICATIONS (Publications, Organizations, Training, Awards, etc.)
**American Institute of Architects Member, Gulf Coast Chapter Past President 2014
AIA Florida - 2018 Firm of the Year**

19. RELEVANT PROJECTS

(1) TITLE AND LOCATION (City and State)	(2) YEAR COMPLETED	
	PROFESSIONAL SERVICES	CONSTRUCTION (If applicable)
a. (1) TITLE AND LOCATION (City and State) Manatee County Utilities / Public Works Administration Building Bradenton, FL	2020	N/A
(3) BRIEF DESCRIPTION (Brief scope, size, cost, etc.) AND SPECIFIC ROLE <input checked="" type="checkbox"/> Check if project performed with current firm SCOPE: Sweet Sparkman Architecture and Interiors as a consultant to Kimley-Horn has been contracted for professional design services for the Manatee County Utilities Administration Building to be located in Manatee County. Sweet Sparkman will be providing a preliminary site plan and conceptual building design for (2) three-story buildings with a shared parking garage for the County's 200 FTE staff in their Utilities and Public Works Departments with a projected growth of 258 FTE staff over a 25 year period. ROLE: Principal in Charge		
b. (1) TITLE AND LOCATION (City and State) Pinellas County Schools Coachman Service Center Clearwater, FL	Ongoing	Ongoing
(3) BRIEF DESCRIPTION (Brief scope, size, cost, etc.) AND SPECIFIC ROLE <input checked="" type="checkbox"/> Check if project performed with current firm SCOPE: Sweet Sparkman was contracted by Pinellas County Schools to design a new bus service garage to hold and maintain the buses servicing the district's mid county schools. The scope includes demolition of an existing structure, new construction of a 9,600 SF 5-bay bus service garage with associated work spaces, a renovation of 5 offices, lounge, and workspaces, and a conversion of the existing transportation command center back into a kitchen to serve the school. Site work will include a revised parking lot layout and drive access. ROLE: Quality Assurance / Quality Control SIZE: 9,600 SF New Construction and 2,500 SF Renovation COST: \$5.7 Million		
c. (1) TITLE AND LOCATION (City and State) Sarasota County Parks & Recreation Natural Resources Department Building Sarasota, FL	Ongoing	Ongoing
(3) BRIEF DESCRIPTION (Brief scope, size, cost, etc.) AND SPECIFIC ROLE <input checked="" type="checkbox"/> Check if project performed with current firm SCOPE: Sweet Sparkman was contracted by Sarasota County to design the new Parks & Recreation and Natural Resources Department Building. The scope includes site evaluations, user needs programming, design through construction documents, bidding/permitting, and construction administration. This project is intended to be LEED certified. ROLE: Project Manager SIZE: 12,000 SF COST: TBD		
d. (1) TITLE AND LOCATION (City and State) Venice Public Works Renovation Venice, FL	2021	2021
(3) BRIEF DESCRIPTION (Brief scope, size, cost, etc.) AND SPECIFIC ROLE <input checked="" type="checkbox"/> Check if project performed with current firm SCOPE: The City of Venice contracted Sweet Sparkman to re-purpose the existing Police Station into office space for the City of Venice Public Works to include Maintenance & Parks, Administration, and Fleet Services. The project scope includes renovations to select areas of the 18,000 SF building. ROLE: Quality Assurance / Quality Control SIZE: 18,000 SF COST: \$750,000		
e. (1) TITLE AND LOCATION (City and State) Cape Coral Fleet Maintenance Facility Cape Coral, FL	Ongoing	N/A
(3) BRIEF DESCRIPTION (Brief scope, size, cost, etc.) AND SPECIFIC ROLE <input checked="" type="checkbox"/> Check if project performed with current firm Scope: Development of a feasibility study & conceptual design plan for a new Public Works Fleet Maintenance Facility. Project includes building programming, operational analysis, and review / development of future staff projections to determine appropriate building size. ROLE: Project Manager		

E. RESUMES OF KEY PERSONNEL PROPOSED FOR THIS CONTRACT
(Complete one Section E for each key person.)

12. NAME Arturo Lopez, AIA	13. ROLE IN THIS CONTRACT Project Architect	14. YEARS EXPERIENCE	
		a. TOTAL 16	b. WITH CURRENT FIRM 3

15. FIRM NAME AND LOCATION (City and State)
Sweet Sparkman Architecture and Interiors - Sarasota, FL

16. EDUCATION (DEGREE AND SPECIALIZATION) Boston Architectural College, M.Arch, 2015 Westwood College, BS. Interior Design, 2006	17. CURRENT PROFESSIONAL REGISTRATION (STATE AND DISCIPLINE) Registered Architect FL #AR-100162 General Contractor MA #CS-109247
--	--

18. OTHER PROFESSIONAL QUALIFICATIONS (Publications, Organizations, Training, Awards, etc.)
**American Institute of Architects Member
AIA Florida - 2018 Firm of the Year**

19. RELEVANT PROJECTS

(1) TITLE AND LOCATION (City and State)	(2) YEAR COMPLETED	
	PROFESSIONAL SERVICES	CONSTRUCTION (If applicable)
Manatee County Utilities / Public Works Administration Building Bradenton, FL	2020	N/A
a. (3) BRIEF DESCRIPTION (Brief scope, size, cost, etc.) AND SPECIFIC ROLE <input checked="" type="checkbox"/> Check if project performed with current firm SSAI was contracted for professional design services for the Manatee County Utilities Administration Building to be located in Manatee County. Sweet Sparkman provided a preliminary site plan and conceptual building design for (2) three-story buildings with a shared parking garage for the County's 200 full time employees in their Utilities and Public Works Departments with a projected growth of 258 full time employees over a 25 year period. ROLE: Project Manager		
R.L. Anderson South County Courts Remodel and Addition Venice, FL	2021	2021
b. (3) BRIEF DESCRIPTION (Brief scope, size, cost, etc.) AND SPECIFIC ROLE <input checked="" type="checkbox"/> Check if project performed with current firm SCOPE: The new R.L. Anderson South County Courts Building Remodel and Addition includes construction of a new, two-story, four-court, courthouse and ancillary spaces to serve the 12th Judicial Circuit Court, the Clerk of the Circuit Court and County Comptroller, and Court Administration. The new 40,000 SF building will be located on the campus of the existing building. The project includes extensive site work including expanded parking, new stormwater treatment facilities, and landscaping improvements. Renovations to the existing buildings will include modernization of lighting, elevators, mechanical equipment and interiors. Sweet Sparkman served as the Local Architect in collaboration with the Architect of Record, DLR Group. ROLE: Project Manager SIZE: 40,000 SF COST: \$25.6 million		
Pinellas County Schools Coachman Service Center Clearwater, FL	Ongoing	Ongoing
c. (3) BRIEF DESCRIPTION (Brief scope, size, cost, etc.) AND SPECIFIC ROLE <input checked="" type="checkbox"/> Check if project performed with current firm SCOPE: Sweet Sparkman was contracted by Pinellas County Schools to design a new bus service garage to hold and maintain the buses servicing the district's mid county schools. The scope includes demolition of an existing structure, new construction of a 9,600 SF 5-bay bus service garage with associated work spaces, a renovation of 5 offices, lounge, and workspaces, and a conversion of the existing transportation command center back into a kitchen to serve the school. Site work will include a revised parking lot layout and drive access. ROLE: Project Architect SIZE: 9,600 SF New Construction and 2,500 SF Renovation COST: \$5.7 Million		
Venice Public Works Renovation Venice, FL	2021	2021
d. (3) BRIEF DESCRIPTION (Brief scope, size, cost, etc.) AND SPECIFIC ROLE <input checked="" type="checkbox"/> Check if project performed with current firm SCOPE: The City of Venice contracted Sweet Sparkman to re-purpose the existing Police Station into office space for the City of Venice Public Works to include Maintenance & Parks, Administration, and Fleet Services. The project scope includes renovations to select areas of the 18,000 SF building. ROLE: Project Architect SIZE: 18,000 SF COST: \$750,000		
Manatee County Public Works Renovation Bradenton, FL	2022	2022
e. (3) BRIEF DESCRIPTION (Brief scope, size, cost, etc.) AND SPECIFIC ROLE <input checked="" type="checkbox"/> Check if project performed with current firm SCOPE: The scope of work is a renovation to the Public Works facility. The area of renovation is approximately 3,200 SF and pre-engineered. ROLE: Project Manager SIZE: 3,200 SF COST: TBD		

E. RESUMES OF KEY PERSONNEL PROPOSED FOR THIS CONTRACT
(Complete one Section E for each key person.)

12. NAME Shirley Quinlan	13. ROLE IN THIS CONTRACT Interior Designer	14. YEARS EXPERIENCE	
		a. TOTAL 10	b. WITH CURRENT FIRM 3

15. FIRM NAME AND LOCATION (City and State)
Sweet Sparkman Architecture and Interiors - Sarasota, FL

16. EDUCATION (DEGREE AND SPECIALIZATION) Fashion Institute of Technology, BA, 2011	17. CURRENT PROFESSIONAL REGISTRATION (STATE AND DISCIPLINE)
---	--

18. OTHER PROFESSIONAL QUALIFICATIONS (Publications, Organizations, Training, Awards, etc.)
**American Institute of Architects Member
AIA Florida - 2018 Firm of the Year**

19. RELEVANT PROJECTS

(1) TITLE AND LOCATION (City and State)	(2) YEAR COMPLETED	
	PROFESSIONAL SERVICES	CONSTRUCTION (If applicable)
a. (3) BRIEF DESCRIPTION (Brief scope, size, cost, etc.) AND SPECIFIC ROLE St. Petersburg Sanitation Department St. Petersburg, FL	<input checked="" type="checkbox"/> Check if project performed with current firm	
SCOPE: The scope of work includes new administration and operations buildings for the Sanitation Department with a new parking lot to accommodate 193 total parking spaces. The program includes administration offices, conference rooms, restrooms, fitness room, and locker room / shower facilities. The site will be divided into a building area, fleet parking and storage area, and a container storage area. The project features a 2,000 SF green roof. This project is expected to be a LEED certified Net-Zero building. ROLE: Interior Designer SIZE: 18,628 SF under roof with 2,000 SF green space COST: \$6.6 million	Ongoing	Ongoing
b. (3) BRIEF DESCRIPTION (Brief scope, size, cost, etc.) AND SPECIFIC ROLE R.L. Anderson South County Courts Remodel and Addition Venice, FL	<input checked="" type="checkbox"/> Check if project performed with current firm	
SCOPE: The new R.L. Anderson South County Courts Building Remodel and Addition includes construction of a new, two-story, four-court, courthouse and ancillary spaces to serve the 12th Judicial Circuit Court, the Clerk of the Circuit Court and County Comptroller, and Court Administration. The new 40,000 SF building will be located on the campus of the existing building. The project includes extensive site work including expanded parking, new stormwater treatment facilities, and landscaping improvements. Renovations to the existing buildings will include modernization of lighting, elevators, mechanical equipment and interiors. Sweet Sparkman served as the Local Architect in collaboration with the Architect of Record, DLR Group. ROLE: Interior Designer SIZE: 40,000 SF COST: \$25.6 million	2021	2021
c. (3) BRIEF DESCRIPTION (Brief scope, size, cost, etc.) AND SPECIFIC ROLE Manatee Schools Professional Support Center Renovations Bradenton, FL	<input checked="" type="checkbox"/> Check if project performed with current firm	
SCOPE: Renovations to the Professional Support Center include upgrades to the HVAC system and repair / replacement of the building envelope, including the roof. This project includes HVAC components such as replacing chillers, airside equipment and controls systems, as well as repairing the building envelope. The project occurs on an occupied ancillary site and will require close coordination with District Staff, the Department of Construction Services and Maintenance & Operations. Due to the continuous operation of the building, the project is phased to accommodate staff. ROLE: Interior Designer SIZE: 150,000 SF COST: \$5.1 million	2020	2020
d. (3) BRIEF DESCRIPTION (Brief scope, size, cost, etc.) AND SPECIFIC ROLE Venice Public Works Renovation Venice, FL	<input checked="" type="checkbox"/> Check if project performed with current firm	
SCOPE: The City of Venice contracted Sweet Sparkman to re-purpose the existing Police Station into office space for the City of Venice Public Works to include Maintenance & Parks, Administration, and Fleet Services. The project scope includes renovations to select areas of the 18,000 SF building. ROLE: Interior Designer SIZE: 18,000 SF COST: \$750,000	2021	2021
e. (3) BRIEF DESCRIPTION (Brief scope, size, cost, etc.) AND SPECIFIC ROLE Venice Fire Station #1 and City Hall Renovation and Expansion Venice, FL	<input checked="" type="checkbox"/> Check if project performed with current firm	
SCOPE: The City of Venice contracted Sweet Sparkman to provide a master concept plan and associated budget pricing for the replacement of Fire Station #1. The project scope of work included analyzing the organizational configuration and function of the existing Venice Fire Station #1 as well as design and construction administration to the overall project. The firm created a total of (3) master plan options. After the study was conducted, the City of Venice chose Sweet Sparkman to renovate this Fire Station and bring it up to the standard a modern-day Fire Station in terms of space, layout, equipment and hurricane hardening. ROLE: Interior Designer SIZE: 18,695 SF COST: \$9.8 million	2022	2022

E. RESUMES OF KEY PERSONNEL PROPOSED FOR THIS CONTRACT

(Complete one Section E for each key person.)

12. NAME Jeffrey Wilson, PE, PWLF		13. ROLE IN THIS CONTRACT Principal-in-Charge		14. YEARS EXPERIENCE	
				a. TOTAL 37	b. WITH CURRENT FIRM 12
15. FIRM NAME AND LOCATION (City and State) Weston & Sampson, Fort Myers, Florida					
16. EDUCATION (Degree and Specialization) Bachelor of Science, Civil Engineering Ohio University			17. CURRENT PROFESSIONAL REGISTRATION (State and Discipline) Professional Engineer: Florida No. 41792; Georgia No. PE032530; Alabama No. 28980; Louisiana No. PE.0033666; Mississippi No. 17931		
18. OTHER PROFESSIONAL QUALIFICATIONS (Publications, Organizations, Training, Awards, etc.) Certificate Holder - National Council of Examiners for Engineering & Surveying					
19. RELEVANT PROJECTS					
a.	(1) TITLE AND LOCATION (City and State) Fleet Maintenance Facility Cape Coral, Florida		(2) YEAR COMPLETED		
			PROFESSIONAL SERVICES Ongoing	CONSTRUCTION (If applicable) N/A	
(3) BRIEF DESCRIPTION (Brief scope, size, cost, etc.) AND SPECIFIC ROLE Principal-in-Charge for development of a feasibility study & conceptual design plan for a new Public Works Fleet Maintenance Facility. Project includes building programming, operational analysis, and review / development of future staff projections to determine appropriate building size.			<input checked="" type="checkbox"/> Check if project performed with current firm		
b.	(1) TITLE AND LOCATION (City and State) Detar Utilities Warehouse Evaluation Lee County, Fort Myers, Florida		(2) YEAR COMPLETED		
			PROFESSIONAL SERVICES 2020	CONSTRUCTION (If applicable) N/A	
(3) BRIEF DESCRIPTION (Brief scope, size, cost, etc.) AND SPECIFIC ROLE Client service manager/project executive for project for engineering services that included review of existing documents, site observations to measure and gather existing condition information, and structural analysis to evaluate the primary structural components including the influence of significant foundation settlement.			<input checked="" type="checkbox"/> Check if project performed with current firm		
c.	(1) TITLE AND LOCATION (City and State) Justice Center Parking Garage Evaluation Lee County, Fort Myers, Florida		(2) YEAR COMPLETED		
			PROFESSIONAL SERVICES 2020	CONSTRUCTION (If applicable) N/A	
(3) BRIEF DESCRIPTION (Brief scope, size, cost, etc.) AND SPECIFIC ROLE Client service manager/project executive for project for engineering services that included site observations to gather and record existing condition information including the layout of structural framework, the creation of structural framing drawings, not previously available, including references to photographs documenting previous repairs and other notable findings.			<input checked="" type="checkbox"/> Check if project performed with current firm		
d.	(1) TITLE AND LOCATION (City and State) Fiddlesticks Water Main Replacement Lee County, Florida		(2) YEAR COMPLETED		
			PROFESSIONAL SERVICES 2021	CONSTRUCTION (If applicable) 2022	
(3) BRIEF DESCRIPTION (Brief scope, size, cost, etc.) AND SPECIFIC ROLE Project director for the replacement of approximately 60,000 feet of potable water main by Lee County Utilities for the Fiddlesticks Country Club Community. The project is to be phased over a five-year period, with an anticipated project cost exceeding \$10 million. Responsibilities include determining the direction, schedule and execution of all tasks, including program management, survey, subsurface utility investigation, environmental, geotechnical, design, bidding, engineering services during construction, and stakeholder engagement.			<input checked="" type="checkbox"/> Check if project performed with current firm		
e.	(1) TITLE AND LOCATION (City and State) Feasibility Study for Solid Waste Resource Recovery Facility Access Road Lee County, Fort Myers, Florida		(2) YEAR COMPLETED		
			PROFESSIONAL SERVICES 2020	CONSTRUCTION (If applicable) N/A	
(3) BRIEF DESCRIPTION (Brief scope, size, cost, etc.) AND SPECIFIC ROLE Client service manager for development of a feasibility study to address emergency vehicle and employee access to the county's solid waste resource recovery facility. Project included the development of two alternative access alignments to address existing concerns; analysis of potential impacts on natural resources, wildlife habitat, Florida Power and Light easements, etc.; and production of a technical memorandum/report that addressed environmental permitting considerations, preliminary opinion of probable costs, and other factors.			<input checked="" type="checkbox"/> Check if project performed with current firm		

E. RESUMES OF KEY PERSONNEL PROPOSED FOR THIS CONTRACT

(Complete one Section E for each key person.)

12. NAME Joseph Zongol, PE, NICET III		13. ROLE IN THIS CONTRACT Project Manager		14. YEARS EXPERIENCE	
		a. TOTAL 13	b. WITH CURRENT FIRM 13		
15. FIRM NAME AND LOCATION (City and State) Weston & Sampson, Albany, New York					
16. EDUCATION (Degree and Specialization) Bachelor of Science, Civil Engineering Rensselaer Polytechnic Institute			17. CURRENT PROFESSIONAL REGISTRATION (State and Discipline) Professional Engineer: NY (#086584), NJ		
18. OTHER PROFESSIONAL QUALIFICATIONS (Publications, Organizations, Training, Awards, etc.) NICET Level III; OSHA 10- and 40-hour training					
19. RELEVANT PROJECTS					
a.	(1) TITLE AND LOCATION (City and State)		(2) YEAR COMPLETED		
	Fleet Maintenance Facility Cape Coral, Florida		PROFESSIONAL SERVICES	CONSTRUCTION (If applicable)	
Ongoing			N/A		
		<input checked="" type="checkbox"/> Check if project performed with current firm			
(3) BRIEF DESCRIPTION (Brief scope, size, cost, etc.) AND SPECIFIC ROLE Project manager for development of a feasibility study & conceptual design plan for a new Public Works Fleet Maintenance Facility. Project includes building programming, operational analysis, and review / development of future staff projections to determine appropriate building size.					
b.	(1) TITLE AND LOCATION (City and State)		(2) YEAR COMPLETED		
	Edison Park Drainage Fort Myers, Florida		PROFESSIONAL SERVICES	CONSTRUCTION (If applicable)	
2021			Anticipated 2022		
		<input checked="" type="checkbox"/> Check if project performed with current firm			
(3) BRIEF DESCRIPTION (Brief scope, size, cost, etc.) AND SPECIFIC ROLE Project manager for professional consulting and surveying services to the City of Fort Myers with regards to the current drainage issues in the Edison Park area. The project area is approximately 37 acres and is predominantly composed of single-family residences. The project area is presently served by City of Fort Myers water and sewer utilities. Weston & Sampson performed an analysis of the existing storm drainage system serving the Edison Park area and provided recommendations to improve the storm drainage functioning in the project area.					
c.	(1) TITLE AND LOCATION (City and State)		(2) YEAR COMPLETED		
	Ardsley Public Works Maintenance Facility Ardsley Village, New York		PROFESSIONAL SERVICES	CONSTRUCTION (If applicable)	
Ongoing			Ongoing		
		<input checked="" type="checkbox"/> Check if project performed with current firm			
(3) BRIEF DESCRIPTION (Brief scope, size, cost, etc.) AND SPECIFIC ROLE Utilities design and permitting, including wastewater and oversight of stormwater modeling, for full design, bidding, and construction administration services for the Village of Ardsley's new public works maintenance facility, comprised of vehicle storage, vehicle maintenance, equipment storage, wash bay, and administration. Site amenities include bulk storage of materials, fuel storage and dispensing, and salt storage.					
d.	(1) TITLE AND LOCATION (City and State)		(2) YEAR COMPLETED		
	Rye Brook Public Works and Parks Building Rye Brook, New York		PROFESSIONAL SERVICES	CONSTRUCTION (If applicable)	
Ongoing			Ongoing		
		<input checked="" type="checkbox"/> Check if project performed with current firm			
(3) BRIEF DESCRIPTION (Brief scope, size, cost, etc.) AND SPECIFIC ROLE Utilities design and permitting, including wastewater and oversight of stormwater modeling, for a feasibility study for a new Public Works Facility. Work included interviewing DPW staff, developing a space needs program, developing conceptual alternatives, and preparing a conceptual design and cost estimate for funding purposes. Based on the results of the feasibility study, the village funded the project and design services are currently underway. The project consists of a +/- 38,000-square-foot facility including offices, employee facilities (locker/shower/toilet, lunch/break/training facilities), trade shops, vehicle maintenance, vehicle wash, and vehicle/equipment storage.					
e.	(1) TITLE AND LOCATION (City and State)		(2) YEAR COMPLETED		
	Pure Waters Department Operations & Maintenance Building Colonie, New York		PROFESSIONAL SERVICES	CONSTRUCTION (If applicable)	
2020			Anticipated 2022-2023		
		<input checked="" type="checkbox"/> Check if project performed with current firm			
(3) BRIEF DESCRIPTION (Brief scope, size, cost, etc.) AND SPECIFIC ROLE Utilities design for the Town of Colonie's new Pure Waters Operations Facility to help the division meet its administrative and equipment space needs. Initial design phase services included survey, geotechnical investigations, and site access considerations.					

E. RESUMES OF KEY PERSONNEL PROPOSED FOR THIS CONTRACT

(Complete one Section E for each key person.)

12. NAME Michael Richard, PE		13. ROLE IN THIS CONTRACT Technical Review		14. YEARS EXPERIENCE	
		a. TOTAL 24	b. WITH CURRENT FIRM 17		
15. FIRM NAME AND LOCATION (City and State) Weston & Sampson, Reading, Massachusetts					
Bachelor of Science Civil & Environmental Engineering			17. CURRENT PROFESSIONAL REGISTRATION (State and Discipline) PE; MA/45686		
18. OTHER PROFESSIONAL QUALIFICATIONS (Publications, Organizations, Training, Awards, etc.) SWANA Certified Transportation Systems Manager, DEP Qualified Soil Evaluator, OSHA Training					
19. RELEVANT PROJECTS					
a.	(1) TITLE AND LOCATION (City and State) Fleet Maintenance Facility Cape Coral, Florida		(2) YEAR COMPLETED		
			PROFESSIONAL SERVICES Ongoing	CONSTRUCTION (If applicable) N/A	
		(3) BRIEF DESCRIPTION (Brief scope, size, cost, etc.) AND SPECIFIC ROLE <input checked="" type="checkbox"/> Check if project performed with current firm Technical reviewer for development of a feasibility study & conceptual design plan for a new Public Works Fleet Maintenance Facility. Project includes building programming, operational analysis, and review / development of future staff projections to determine appropriate building size.			
b.	(1) TITLE AND LOCATION (City and State) Ardley Public Works Maintenance Facility Ardley Village, New York		(2) YEAR COMPLETED		
			PROFESSIONAL SERVICES Ongoing	CONSTRUCTION (If applicable) Ongoing	
		(3) BRIEF DESCRIPTION (Brief scope, size, cost, etc.) AND SPECIFIC ROLE <input checked="" type="checkbox"/> Check if project performed with current firm Technical reviewer for full design, bidding, and construction administration services for the Village of Ardsley's new public works maintenance facility, comprised of vehicle storage, vehicle maintenance, equipment storage, wash bay, and administration. Site amenities include bulk storage of materials, fuel storage and dispensing, and salt storage.			
c.	(1) TITLE AND LOCATION (City and State) Rye Brook Public Works and Parks Building Rye Brook, New York		(2) YEAR COMPLETED		
			PROFESSIONAL SERVICES Ongoing	CONSTRUCTION (If applicable) Ongoing	
		(3) BRIEF DESCRIPTION (Brief scope, size, cost, etc.) AND SPECIFIC ROLE <input checked="" type="checkbox"/> Check if project performed with current firm Technical reviewer for a feasibility study for a new Public Works Facility for the Village of Rye Brook. Work included interviewing DPW staff, developing a space needs program, developing conceptual alternatives, and preparing a conceptual design and cost estimate for funding purposes. Based on the results of the feasibility study, the village funded the project and design services are currently underway. The project consists of a +/- 38,000-square-foot facility including offices, employee facilities (locker/shower/toilet, lunch/break/training facilities), trade shops, vehicle maintenance, vehicle wash, and vehicle/equipment storage. The project also includes a new salt storage structure and fueling system. The project will include sustainable design features including natural daylighting, solar ready roof, heat recovery, and high efficiency lighting.			
d.	(1) TITLE AND LOCATION (City and State) New DPW Fuel Island Marshfield, Massachusetts		(2) YEAR COMPLETED		
			PROFESSIONAL SERVICES 2016	CONSTRUCTION (If applicable) N/A	
		(3) BRIEF DESCRIPTION (Brief scope, size, cost, etc.) AND SPECIFIC ROLE <input checked="" type="checkbox"/> Check if project performed with current firm Project manager for the permitting, design, and preparation of bid documents for a new fuel island, which involves evaluation of subsurface conditions, and coordination to minimize disruption to the existing fueling operations			
e.	(1) TITLE AND LOCATION (City and State) New Department of Public Works and Parks & Recreation Facilities Burlington, Massachusetts		(2) YEAR COMPLETED		
			PROFESSIONAL SERVICES Ongoing	CONSTRUCTION (If applicable) Ongoing	
		(3) BRIEF DESCRIPTION (Brief scope, size, cost, etc.) AND SPECIFIC ROLE <input checked="" type="checkbox"/> Check if project performed with current firm Assisted with programming and design of a new facility for consolidated services.			
f.	(1) TITLE AND LOCATION (City and State) New DPW Facility Yarmouth, Massachusetts		(2) YEAR COMPLETED		
			PROFESSIONAL SERVICES Ongoing	CONSTRUCTION (If applicable) Ongoing	
		(3) BRIEF DESCRIPTION (Brief scope, size, cost, etc.) AND SPECIFIC ROLE <input checked="" type="checkbox"/> Check if project performed with current firm Assisted with feasibility study for a new DPW facility.			

E. RESUMES OF KEY PERSONNEL PROPOSED FOR THIS CONTRACT

(Complete one Section E for each key person.)

12. NAME Daniel Tenney III, AIA		13. ROLE IN THIS CONTRACT Technical Review		14. YEARS EXPERIENCE	
		a. TOTAL 37	b. WITH CURRENT FIRM 6		
15. FIRM NAME AND LOCATION (City and State) Weston & Sampson, Boston, Massachusetts					
16. EDUCATION (Degree and Specialization) Masters of Architecture, MIT Bachelor of Arts, Architecture, Yale University			17. CURRENT PROFESSIONAL REGISTRATION (State and Discipline) Professional Architect: MA/6688, CT/0012264, NH/4375, TX/6688		
18. OTHER PROFESSIONAL QUALIFICATIONS (Publications, Organizations, Training, Awards, etc.) American Institute of Architects, Boston Society of Architects, American Council of Engineering Companies, U.S. Green Building Council (LEED GA)					
19. RELEVANT PROJECTS					
a.	(1) TITLE AND LOCATION (City and State)		(2) YEAR COMPLETED		
	Fleet Maintenance Facility Cape Coral, Florida		PROFESSIONAL SERVICES	CONSTRUCTION (If applicable)	
Ongoing			N/A		
(3) BRIEF DESCRIPTION (Brief scope, size, cost, etc.) AND SPECIFIC ROLE <input checked="" type="checkbox"/> Check if project performed with current firm Technical reviewer for development of a feasibility study & conceptual design plan for a new Public Works Fleet Maintenance Facility. Project includes building programming, operational analysis, and review / development of future staff projections to determine appropriate building size.					
b.	(1) TITLE AND LOCATION (City and State)		(2) YEAR COMPLETED		
	Ardsley Public Works Maintenance Facility Ardsley Village, New York		PROFESSIONAL SERVICES	CONSTRUCTION (If applicable)	
Ongoing			Ongoing		
(3) BRIEF DESCRIPTION (Brief scope, size, cost, etc.) AND SPECIFIC ROLE <input checked="" type="checkbox"/> Check if project performed with current firm Senior project manager for full design, bidding, and construction administration services for the Village of Ardsley's new public works maintenance facility, comprised of vehicle storage, vehicle maintenance, equipment storage, wash bay, and administration. Site amenities include bulk storage of materials, fuel storage and dispensing, and salt storage.					
c.	(1) TITLE AND LOCATION (City and State)		(2) YEAR COMPLETED		
	Rye Brook Public Works and Parks Building Rye Brook, New York		PROFESSIONAL SERVICES	CONSTRUCTION (If applicable)	
Ongoing			Ongoing		
(3) BRIEF DESCRIPTION (Brief scope, size, cost, etc.) AND SPECIFIC ROLE <input checked="" type="checkbox"/> Check if project performed with current firm Project manager for a feasibility study for a new Public Works Facility for the Village of Rye Brook. Work included interviewing DPW staff, developing a space needs program, developing conceptual alternatives, and preparing a conceptual design and cost estimate for funding purposes. Based on the results of the feasibility study, the village funded the project and design services are currently underway. The project consists of a +/- 38,000-square-foot facility including offices, employee facilities (locker/shower/toilet, lunch/break/training facilities), trade shops, vehicle maintenance, vehicle wash, and vehicle/equipment storage. The project also includes a new salt storage structure and fueling system. The project will include sustainable design features including natural daylighting, solar ready roof, heat recovery, and high efficiency lighting.					
d.	(1) TITLE AND LOCATION (City and State)		(2) YEAR COMPLETED		
	New Public Works Facility Hopkinton, Massachusetts		PROFESSIONAL SERVICES	CONSTRUCTION (If applicable)	
2018			2018		
(3) BRIEF DESCRIPTION (Brief scope, size, cost, etc.) AND SPECIFIC ROLE <input checked="" type="checkbox"/> Check if project performed with current firm Architect for comprehensive planning, design, and construction administration services for a new Department of Public Works Facility. Engineering Cost: \$1,380,000; Construction Cost: \$12,228,173					
e.	(1) TITLE AND LOCATION (City and State)		(2) YEAR COMPLETED		
	DPW Facility Feasibility Study Middleborough, Massachusetts		PROFESSIONAL SERVICES	CONSTRUCTION (If applicable)	
Ongoing			ongoing		
(3) BRIEF DESCRIPTION (Brief scope, size, cost, etc.) AND SPECIFIC ROLE <input checked="" type="checkbox"/> Check if project performed with current firm Lead architect for Feasibility Study for new Public Works Facility. Engineering Cost: \$1,150,000 Construction Cost: \$15,400,000					
f.	(1) TITLE AND LOCATION (City and State)		(2) YEAR COMPLETED		
	Public Works Facility Code and Safety Improvements Bloomfield, Connecticut		PROFESSIONAL SERVICES	CONSTRUCTION (If applicable)	
2021			2021		
(3) BRIEF DESCRIPTION (Brief scope, size, cost, etc.) AND SPECIFIC ROLE <input checked="" type="checkbox"/> Check if project performed with current firm Senior project architect responsible for overseeing the study and design of improvements/additions at the Public Works Facility, in addition to code-related safety improvements and updated mechanical systems. Engineering Cost: \$835,000; Construction Cost: \$10,213,000					

E. RESUMES OF KEY PERSONNEL PROPOSED FOR THIS CONTRACT

(Complete one Section E for each key person.)

12. NAME Gary Ferrante, PE	13. ROLE IN THIS CONTRACT Civil/Site Engineering	14. YEARS EXPERIENCE	
		a. TOTAL 28	b. WITH CURRENT FIRM 4
15. FIRM NAME AND LOCATION (City and State) Weston & Sampson, Fort Myers, Florida			
16. EDUCATION (Degree and Specialization) Master of Science: Civil Engineering Bachelor of Science: Engineering		17. CURRENT PROFESSIONAL REGISTRATION (State and Discipline) Professional Engineer: FL (No. 65011), OH, IL	
18. OTHER PROFESSIONAL QUALIFICATIONS (Publications, Organizations, Training, Awards, etc.)			

19. RELEVANT PROJECTS				
	(1) TITLE AND LOCATION (City and State)	(2) YEAR COMPLETED		
a.	Fleet Maintenance Facility Cape Coral, Florida	<table border="1" style="width:100%; border-collapse: collapse;"> <tr> <td style="width:50%; text-align: center;">PROFESSIONAL SERVICES Ongoing</td> <td style="width:50%; text-align: center;">CONSTRUCTION (If applicable) N/A</td> </tr> </table>	PROFESSIONAL SERVICES Ongoing	CONSTRUCTION (If applicable) N/A
PROFESSIONAL SERVICES Ongoing	CONSTRUCTION (If applicable) N/A			
(3) BRIEF DESCRIPTION (Brief scope, size, cost, etc.) AND SPECIFIC ROLE Senior project engineer for development of a feasibility study & conceptual design plan for a new Public Works Fleet Maintenance Facility. Project includes building programming, operational analysis, and review / development of future staff projections to determine appropriate building size.		<input checked="" type="checkbox"/> Check if project performed with current firm		
b.	Fiddlesticks Water Main Replacement Lee County, Florida	<table border="1" style="width:100%; border-collapse: collapse;"> <tr> <td style="width:50%; text-align: center;">PROFESSIONAL SERVICES 2021</td> <td style="width:50%; text-align: center;">CONSTRUCTION (If applicable) 2022</td> </tr> </table>	PROFESSIONAL SERVICES 2021	CONSTRUCTION (If applicable) 2022
PROFESSIONAL SERVICES 2021	CONSTRUCTION (If applicable) 2022			
(3) BRIEF DESCRIPTION (Brief scope, size, cost, etc.) AND SPECIFIC ROLE Team leader for the replacement of approximately 60,000 linear feet of potable water mains ranging in size from 6" through 30" by Lee County Utilities for the upscale residential development, which is anticipated to be phased over a five-year period, with a project cost exceeding \$10 million. Responsibilities include design, permitting, bidding assistance and construction phase services.		<input checked="" type="checkbox"/> Check if project performed with current firm		
c.	Edison Park Drainage Improvements Fort Myers, Florida	<table border="1" style="width:100%; border-collapse: collapse;"> <tr> <td style="width:50%; text-align: center;">PROFESSIONAL SERVICES 2021</td> <td style="width:50%; text-align: center;">CONSTRUCTION (If applicable) Anticipated 2022</td> </tr> </table>	PROFESSIONAL SERVICES 2021	CONSTRUCTION (If applicable) Anticipated 2022
PROFESSIONAL SERVICES 2021	CONSTRUCTION (If applicable) Anticipated 2022			
(3) BRIEF DESCRIPTION (Brief scope, size, cost, etc.) AND SPECIFIC ROLE Senior project engineer for professional consulting and surveying services to the City of Fort Myers with regards to the current drainage issues in the Edison Park area. The project area is approximately 37 acres and is predominantly composed of single-family residences. The project area is presently served by City of Fort Myers water and sewer utilities. Weston & Sampson performed an analysis of the existing storm drainage system serving the Edison Park area and provided recommendations to improve the storm drainage functioning in the project area.		<input checked="" type="checkbox"/> Check if project performed with current firm		
d.	Page Park Water Main Improvements Lee County Utilities, Florida	<table border="1" style="width:100%; border-collapse: collapse;"> <tr> <td style="width:50%; text-align: center;">PROFESSIONAL SERVICES 2017</td> <td style="width:50%; text-align: center;">CONSTRUCTION (If applicable) 2018</td> </tr> </table>	PROFESSIONAL SERVICES 2017	CONSTRUCTION (If applicable) 2018
PROFESSIONAL SERVICES 2017	CONSTRUCTION (If applicable) 2018			
(3) BRIEF DESCRIPTION (Brief scope, size, cost, etc.) AND SPECIFIC ROLE Project manager for the replacement of aging and undersized water mains throughout Page Park in Fort Myers. Responsibilities included design, permitting through the Lee County Health Department, bidding assistance, and construction phase services. Work included the design of approximately 23,700 linear feet of water mains ranging from 4 through 16 inches.		<input checked="" type="checkbox"/> Check if project performed with current firm		
e.	Albany-Shaker Road Sanitary Sewer Rehabilitation Colonie, New York	<table border="1" style="width:100%; border-collapse: collapse;"> <tr> <td style="width:50%; text-align: center;">PROFESSIONAL SERVICES 2021</td> <td style="width:50%; text-align: center;">CONSTRUCTION (If applicable) 2021</td> </tr> </table>	PROFESSIONAL SERVICES 2021	CONSTRUCTION (If applicable) 2021
PROFESSIONAL SERVICES 2021	CONSTRUCTION (If applicable) 2021			
(3) BRIEF DESCRIPTION (Brief scope, size, cost, etc.) AND SPECIFIC ROLE Project manager for the rehabilitation of an 8- to 16-inch ACP, 9,500-linear-foot trunk sewer and associated manholes by replacement and/or relining technology. Work includes clearing and grubbing to access the sewer along the wooded easements; showing proper existing easement boundaries on the plans; assessing the need for new construction easements; evaluating the condition of the sewer pipe and manholes based on the CCTV work performed by the town; developing rehabilitation plans for the manholes and sewer pipes; and specifying the required bypassing operations to maintain system flow from adjacent developments. Also coordinated permitting with Albany County. Assisted with the preparation of contract documents and bidding services and will oversee construction phase services including construction administration and inspection.		<input checked="" type="checkbox"/> Check if project performed with current firm		

E. RESUMES OF KEY PERSONNEL PROPOSED FOR THIS CONTRACT

(Complete one Section E for each key person.)

12. NAME Jean-Pierre Parnas, RA	13. ROLE IN THIS CONTRACT Programming	14. YEARS EXPERIENCE	
		a. TOTAL 27	b. WITH CURRENT FIRM 8
15. FIRM NAME AND LOCATION (City and State) Weston & Sampson, Foxborough, Massachusetts			
16. EDUCATION (Degree and Specialization) Master of Architecture Massachusetts Institute of Technology		17. CURRENT PROFESSIONAL REGISTRATION (State and Discipline) Architecture License: MA #20264	
18. OTHER PROFESSIONAL QUALIFICATIONS (Publications, Organizations, Training, Awards, etc.)			

19. RELEVANT PROJECTS			
a.	(1) TITLE AND LOCATION (City and State)	(2) YEAR COMPLETED	
		PROFESSIONAL SERVICES	CONSTRUCTION (If applicable)
	Fleet Maintenance Facility Cape Coral, Florida	Ongoing	N/A
	(3) BRIEF DESCRIPTION (Brief scope, size, cost, etc.) AND SPECIFIC ROLE <input checked="" type="checkbox"/> Check if project performed with current firm Project Architect for the programming and conceptual design of a new Public Works Fleet Maintenance Facility. Project includes operational analysis and review / development of future staff projections to determine appropriate building size.		
	Ardsley Public Works Maintenance Facility Ardsley Village, New York	Ongoing	Ongoing
	(3) BRIEF DESCRIPTION (Brief scope, size, cost, etc.) AND SPECIFIC ROLE <input checked="" type="checkbox"/> Check if project performed with current firm Project Architect for full design, bidding, and construction administration services for the Village of Ardsley's new public works maintenance facility, comprised of vehicle storage, vehicle maintenance, equipment storage, wash bay, and administration. Site amenities include bulk storage of materials, fuel storage and dispensing, and salt storage.		
	Rye Brook Public Works and Parks Building Rye Brook, New York	Ongoing	Ongoing
	(3) BRIEF DESCRIPTION (Brief scope, size, cost, etc.) AND SPECIFIC ROLE <input checked="" type="checkbox"/> Check if project performed with current firm Architect for a feasibility study for a new Public Works Facility for the Village of Rye Brook. Work included interviewing DPW staff, developing a space needs program, developing conceptual alternatives, and preparing a conceptual design and cost estimate for funding purposes. Based on the results of the feasibility study, the village funded the project and design services are currently underway. The project consists of a +/- 38,000-square-foot facility including offices, employee facilities (locker/shower/toilet, lunch/break/training facilities), trade shops, vehicle maintenance, vehicle wash, and vehicle/equipment storage. The project also includes a new salt storage structure and fueling system. The project will include sustainable design features including natural daylighting, solar ready roof, heat recovery, and high efficiency lighting.		
	New Public Works Facility Rochester, New Hampshire	2020	2020
	(3) BRIEF DESCRIPTION (Brief scope, size, cost, etc.) AND SPECIFIC ROLE <input checked="" type="checkbox"/> Check if project performed with current firm Project Manager/Architect for the programming, design, and construction administration of a new 56,000-square-foot Public Works Facility. The project includes office areas, employee facilities, trade shops, vehicle maintenance, wash bay, and vehicle/equipment storage. The facility was designed/constructed with energy-efficient design features including building envelope super-insulation, photovoltaic ready roof, and natural daylighting.		
	Master Planning Feasibility Study for a New Public Safety Facility Charlton, Massachusetts	2018	N/A
	(3) BRIEF DESCRIPTION (Brief scope, size, cost, etc.) AND SPECIFIC ROLE <input checked="" type="checkbox"/> Check if project performed with current firm Project Architect responsible for the development of a master plan program and site plan for a new Public Safety Facility. Work included documenting existing conditions, interviewing key department staff, developing a space needs assessment for fire and police operations, and developing conceptual site plans and renderings. Work also included assisting the town with developing presentation material to assist in securing funding for the next phase of the project.		

E. RESUMES OF KEY PERSONNEL PROPOSED FOR THIS CONTRACT

(Complete one Section E for each key person.)

12. NAME James Fair, PE	13. ROLE IN THIS CONTRACT Industrial Equipment Engineering	14. YEARS EXPERIENCE	
		a. TOTAL 26	b. WITH CURRENT FIRM 20
15. FIRM NAME AND LOCATION (City and State) Weston & Sampson, Reading, Massachusetts			
16. EDUCATION (Degree and Specialization) MS Civil Engineering, Clarkson University BS Civil/Environmental Engineering, Clarkson U		17. CURRENT PROFESSIONAL REGISTRATION (State and Discipline) Professional Engineer: MA/46434, MD/13439	
18. OTHER PROFESSIONAL QUALIFICATIONS (Publications, Organizations, Training, Awards, etc.)			

19. RELEVANT PROJECTS

a.	(1) TITLE AND LOCATION (City and State)	(2) YEAR COMPLETED	
		PROFESSIONAL SERVICES	CONSTRUCTION (If applicable)
	Fleet Maintenance Facility Cape Coral, Florida	Ongoing	N/A
	(3) BRIEF DESCRIPTION (Brief scope, size, cost, etc.) AND SPECIFIC ROLE <input checked="" type="checkbox"/> Check if project performed with current firm Industrial equipment engineer for development of a feasibility study & conceptual design plan for a new Public Works Fleet Maintenance Facility. Project includes building programming, operational analysis, and review / development of future staff projections to determine appropriate building size.		
	Public Works Facility Bloomfield, Connecticut	2021	2021
	(3) BRIEF DESCRIPTION (Brief scope, size, cost, etc.) AND SPECIFIC ROLE <input checked="" type="checkbox"/> Check if project performed with current firm Responsible for the design of the DPW vehicle fueling systems, vehicle maintenance systems, and the vehicle wash systems. The work included removal of the existing underground fuel system tanks along with the design and installation of a new above ground tank system.		
	New Consolidated DPW Facility Waterbury, Connecticut	2019	2019
	(3) BRIEF DESCRIPTION (Brief scope, size, cost, etc.) AND SPECIFIC ROLE <input checked="" type="checkbox"/> Check if project performed with current firm Assistant project manager for programming study and preliminary design for overall DPW operations. Responsible for designing industrial fleet maintenance equipment including vehicle lifts, lubrication distribution systems, automatic vehicle wash, overhead crane systems, vehicle fueling operations and salt storage facilities. Work also included the design of the welding shop, carpentry shop, and several other workshop and warehouse areas with pallet racks and heavy-duty storage shelves/systems. Engineering Cost: \$2.8 M; Construction Cost: \$33 M		
	New Department of Public Works Facility Hopkinton, Massachusetts	2018	2018
	(3) BRIEF DESCRIPTION (Brief scope, size, cost, etc.) AND SPECIFIC ROLE <input checked="" type="checkbox"/> Check if project performed with current firm Industrial engineer for design and construction administration services for fleet maintenance, wash bay, and trade shop equipment. Services included meeting with DPW staff to identify equipment options, review of contractor shop drawings during construction, and final inspection of installed equipment. Equipment included, but was not limited to, vehicle lifts, tailpipe exhaust removal systems, fluid storage and distribution systems, trade shop equipment (drill presses, grinder, table saws, etc.), vehicle wash system, vehicle fueling system, and overhead bridge cranes.		
	New Department of Public Works Facility Norwood, Massachusetts	Ongoing	Ongoing
	(3) BRIEF DESCRIPTION (Brief scope, size, cost, etc.) AND SPECIFIC ROLE <input checked="" type="checkbox"/> Check if project performed with current firm Industrial engineer for design and construction administration services for fleet maintenance, wash bay, and trade shop equipment. Services included meeting with DPW staff to identify equipment options, review of contractor shop drawings during construction, and final inspection of installed equipment. Equipment included, but was not limited to, vehicle lifts, tailpipe exhaust removal systems, fluid storage and distribution systems, trade shop equipment (drill presses, grinder, table saws, etc.), manual vehicle wash system, and overhead bridge cranes.		

E. RESUMES OF KEY PERSONNEL PROPOSED FOR THIS CONTRACT

(Complete one Section E for each key person.)

12. NAME David G. Karins, PE, SI	13. ROLE IN THIS CONTRACT Principal-in-Charge	14. YEARS EXPERIENCE	
		a. TOTAL 26 years	b. WITH CURRENT FIRM 6 years

15. FIRM NAME AND LOCATION <i>(City and State)</i> Karins Engineering, Sarasota, FL

16. EDUCATION <i>(DEGREE AND SPECIALIZATION)</i> B.S.C.E. Curriculum Emphasis on Structural & Environmental Engineering, The Florida State University	17. CURRENT PROFESSIONAL REGISTRATION <i>(STATE AND DISCIPLINE)</i> Professional Engineer - Florida #0052677
--	---

18. OTHER PROFESSIONAL QUALIFICATIONS <i>(Publications, Organizations, Training, Awards, etc.)</i> GCBX Board Member – 2019 Chairman, International Concrete Repair Institute 2012-2017 Board Member, 1996-2015 Chapter Founding Board Member, 2000, 2004, 2010 Chapter President, American Society of Civil Engineers #294549, American Concrete Institute #042899
--

19. RELEVANT PROJECTS

a. (1) TITLE AND LOCATION <i>(City and State)</i> Palmetto Police Headquarters- Palmetto, FL	(2) YEAR COMPLETED	
	PROFESSIONAL SERVICES 2021	CONSTRUCTION (If Applicable) Under Construction

b. (3) BRIEF DESCRIPTION <i>(Brief scope, size, cost, etc.)</i> AND SPECIFIC ROLE The new PPD headquarters is being designed to withstand tidal surge and windspeeds of 162 miles per hour and will enhance impact protection of glazing and openings in the building envelope. The building's footprint will be lifted 36" above the existing site elevation to provide protection from projected storm surge resulting from up to a Category 3 hurricane. The raised facility also provides protection from man-made risks including ramming vehicles and site lines from the street to the interior of the building's secure areas. Also included are secured outdoor spaces for gathering / training which and the use of natural lighting for the building occupants while providing security and avoiding line of sight issues. Principal In Charge \$10 Million	<input checked="" type="checkbox"/> Check if project performed with current firm	
---	--	--

b. (1) TITLE AND LOCATION <i>(City and State)</i> Lealman Fire Station #19- St. Petersburg, FL	(2) YEAR COMPLETED	
	PROFESSIONAL SERVICES 2021	CONSTRUCTION (If Applicable) Under Construction

b. (3) BRIEF DESCRIPTION <i>(Brief scope, size, cost, etc.)</i> AND SPECIFIC ROLE New building replaces old Station 19. Secondary EOC hardening includes power generator, all new electrical and mechanical rooms, impact bay doors, windows/doors...etc. The building structure has pre-engineered metal roof trusses with a metal roof deck and masonry bearing walls. The masonry walls are shear walls for lateral wind loads. The building foundation is a stem wall footing. Providing schematic design, design development services, construction documents, and construction administration. Principal In Charge. Approximate budget \$2.8 Million.	<input checked="" type="checkbox"/> Check if project performed with current firm	
--	--	--

c. (1) TITLE AND LOCATION <i>(City and State)</i> Highlands County Fire Station #36 – Lake Placid, FL	(2) YEAR COMPLETED	
	PROFESSIONAL SERVICES 2020	CONSTRUCTION (If Applicable) Under Construction

c. (3) BRIEF DESCRIPTION <i>(Brief scope, size, cost, etc.)</i> AND SPECIFIC ROLE A new 1-level, 4-bay Fire Station with approximately 10,600 SF of space. The building structure is a pre-engineered metal building with masonry exterior walls. The building foundations are a monolithic slab and thickened footing system. The walls are shear walls for the lateral wind loads. Services include structural engineering design and construction administration. Principal In Charge Approximate budget \$2.1 million	<input checked="" type="checkbox"/> Check if project performed with current firm	
--	--	--

d. (1) TITLE AND LOCATION <i>(City and State)</i> North Port Fire Station #45 - North Port, FL	(2) YEAR COMPLETED	
	PROFESSIONAL SERVICES 2015	CONSTRUCTION (If Applicable) 2016

d. (3) BRIEF DESCRIPTION <i>(Brief scope, size, cost, etc.)</i> AND SPECIFIC ROLE This fire station replaced a temporary facility. 8,600 square foot station with three bays. Hardened structure with emergency generators. Built to last 40-50 years. Provided structural engineering design and construction phase services. Principal In Charge \$3.36 million	<input checked="" type="checkbox"/> Check if project performed with current firm	
--	--	--

e. (1) TITLE AND LOCATION <i>(City and State)</i> Manatee County Historic Courthouse - Manatee County, FL	(2) YEAR COMPLETED	
	PROFESSIONAL SERVICES 2018	CONSTRUCTION (If Applicable) 2018

e. (3) BRIEF DESCRIPTION <i>(Brief scope, size, cost, etc.)</i> AND SPECIFIC ROLE Through Manatee County continuing services agreement three work orders were performed for the Manatee County Courthouse, providing structural restoration including repairs resulting from water intrusion, repair of exterior concrete and repair of the courthouse stairs.	<input checked="" type="checkbox"/> Check if project performed with current firm	
---	--	--

E. RESUMES OF KEY PERSONNEL PROPOSED FOR THIS CONTRACT

(Complete one Section E for each key person.)

12. NAME Jerome DiMercurio	13. ROLE IN THIS CONTRACT Engineer	14. YEARS EXPERIENCE	
		a. TOTAL 40	b. WITH CURRENT FIRM 4
15. FIRM NAME AND LOCATION <i>(City and State)</i> Karins Engineering Group, Inc.			
16. EDUCATION <i>(Degree and Specialization)</i> Tufts College of Engineering- Boston, MA B.S.C.E.		17. CURRENT PROFESSIONAL REGISTRATION <i>(State and Discipline)</i> Florida PE #54446 Florida SI #2021	
18. OTHER PROFESSIONAL QUALIFICATIONS <i>(Publications, Organizations, Training, Awards, etc.)</i> American Society of Engineers, N.C.E.E.S.			

19. RELEVANT PROJECTS

(1) TITLE AND LOCATION <i>(City and State)</i> Lealman Fire Station #19- St. Petersburg, FL	(2) YEAR COMPLETED	
	PROFESSIONAL SERVICES 2021	CONSTRUCTION <i>(If applicable)</i> Under Construction
a. (3) BRIEF DESCRIPTION <i>(Brief scope, size, cost, etc.)</i> AND SPECIFIC ROLE <input checked="" type="checkbox"/> Check if project performed with current firm New building replaces old Station 19. Secondary EOC hardening includes power generator, all new electrical and mechanical rooms, impact bay doors, windows/doors...etc. The building structure has pre-engineered metal roof trusses with a metal roof deck and masonry bearing walls. The masonry walls are shear walls for lateral wind loads. The building foundation is a stem wall footing. Providing schematic design, design development services, construction documents, and construction administration. Approximate budget \$2.8 Million.		
b. (1) TITLE AND LOCATION <i>(City and State)</i> Sarasota County Emergency Operations Center Complex - Sarasota, FL	(2) YEAR COMPLETED	
	PROFESSIONAL SERVICES 2014	CONSTRUCTION <i>(If applicable)</i> 2015
b. (3) BRIEF DESCRIPTION <i>(Brief scope, size, cost, etc.)</i> AND SPECIFIC ROLE Check if project performed with current firm Provided structural engineering design for the LEED certified, state-of-the art building designed to FEMA 361 standards that can withstand Category 5 Hurricane Force Winds. The facility has redundant utilities, two 1250 KW generators, and a 250' communication tower. \$15.3 Million project		
c. (1) TITLE AND LOCATION <i>(City and State)</i> Highlands County Fire Station #36 – Lake Placid, FL	(2) YEAR COMPLETED	
	PROFESSIONAL SERVICES 2020	CONSTRUCTION <i>(If applicable)</i> Under Construction
c. (3) BRIEF DESCRIPTION <i>(Brief scope, size, cost, etc.)</i> AND SPECIFIC ROLE <input checked="" type="checkbox"/> Check if project performed with current firm A new 1-level, 4-bay Fire Station with approximately 10,600 SF of space. The building structure is a pre-engineered metal building with masonry exterior walls. The building foundations are a monolithic slab and thickened footing system. The walls are shear walls for the lateral wind loads. Services include structural engineering design and construction administration Approximate budget \$2.1 million		
d. (1) TITLE AND LOCATION <i>(City and State)</i> Sarasota County Fire Station #16	(2) YEAR COMPLETED	
	PROFESSIONAL SERVICES 2014	CONSTRUCTION <i>(If applicable)</i> 2015
d. (3) BRIEF DESCRIPTION <i>(Brief scope, size, cost, etc.)</i> AND SPECIFIC ROLE <input type="checkbox"/> Check if project performed with current firm New 12,800 sf fire station that includes a new Sarasota County Sheriff's Office Operations within one wing. It is structurally designed to withstand a category 4 hurricane. Key components include masonry bearing walls, metal trusses and cementitious siding. This Silver LEED building includes daylight harvesting, sustainable & recycled materials, draught tolerant landscaping. The metal roofing uses a high albedo roof to reflect the sun so as not to create excessive heat. Tankless water heaters are augmented by passive solar hot water tanks. The building is built to be maintenance free. Engineer of Record. \$3.8 million		
e. (1) TITLE AND LOCATION <i>(City and State)</i> City of Sarasota Police Department – Sarasota, FL	(2) YEAR COMPLETED	
	PROFESSIONAL SERVICES 2006	CONSTRUCTION <i>(If applicable)</i> 2006
e. (3) BRIEF DESCRIPTION <i>(Brief scope, size, cost, etc.)</i> AND SPECIFIC ROLE <input type="checkbox"/> Check if project performed with current firm 175,000sf facility on 69,184 sq ft of property. Four levels house operations with an added 2 levels of parking for 200 vehicles. Provided structural engineering design, contract administration and threshold inspection services. \$40 Million		

E. RESUMES OF KEY PERSONNEL PROPOSED FOR THIS CONTRACT

(Complete one Section E for each key person.)

12. NAME Sidney Pritchard	13. ROLE IN THIS CONTRACT HVAC design	14. YEARS EXPERIENCE	
		a. TOTAL 29	b. WITH CURRENT FIRM 15
15. FIRM NAME AND LOCATION <i>(City and State)</i> ME3 Consulting Engineers LLC			
16. EDUCATION <i>(Degree and Specialization)</i> Bachelors Degree in Mechanical Engineering Technology		17. CURRENT PROFESSIONAL REGISTRATION <i>(State and Discipline)</i>	
18. OTHER PROFESSIONAL QUALIFICATIONS <i>(Publications, Organizations, Training, Awards, etc.)</i> ASHRAE, LEED AP.			

19. RELEVANT PROJECTS

(1) TITLE AND LOCATION <i>(City and State)</i> Manatee County Utilities and Admin Building. Manatee County, FL	(2) YEAR COMPLETED	
	PROFESSIONAL SERVICES 2012	CONSTRUCTION <i>(If applicable)</i> 2013
a. (3) BRIEF DESCRIPTION <i>(Brief scope, size, cost, etc.)</i> AND SPECIFIC ROLE <input checked="" type="checkbox"/> Check if project performed with current firm Demolition of the existing Fleet Maintenance and adjoining buildings and the construction of a new ± 15,000 sqft building in the same location, and a new ± 5,000 sqft warehouse building. The new warehouse included a small conditioned office with restroom. Project included a rain harvest system as well as an emergency back-up generator.		
(1) TITLE AND LOCATION <i>(City and State)</i> Manatee County Fleet Services Building	(2) YEAR COMPLETED	
	PROFESSIONAL SERVICES 2009	CONSTRUCTION <i>(If applicable)</i> 2010
b. (3) BRIEF DESCRIPTION <i>(Brief scope, size, cost, etc.)</i> AND SPECIFIC ROLE <input checked="" type="checkbox"/> Check if project performed with current firm New 12 bay fleet Service Facility with support offices, storage areas, Break room, Library for records, Rest room Facilities, Mezzanine area. Virgin Fluids distribution to each bay and containment of recovered fluids. Emergency back-up generator, lightning protection and hotsy wash bay system. Exterior landscaping & irrigation, retention pond etc.		
(1) TITLE AND LOCATION <i>(City and State)</i> SBSC South County Bus Depot and Parking. North Port, FL	(2) YEAR COMPLETED	
	PROFESSIONAL SERVICES 2013	CONSTRUCTION <i>(If applicable)</i> 2014
c. (3) BRIEF DESCRIPTION <i>(Brief scope, size, cost, etc.)</i> AND SPECIFIC ROLE <input checked="" type="checkbox"/> Check if project performed with current firm A new 10,900 sq.ft bus maintenance building located in North Port Florida. The site includes parking for 140 buses and 100 cars and included a fuel dispensing island. Site lighting and security cameras were included in the design.		
(1) TITLE AND LOCATION <i>(City and State)</i> Manatee County - Downtown Bus Transit Depot	(2) YEAR COMPLETED	
	PROFESSIONAL SERVICES 2011	CONSTRUCTION <i>(If applicable)</i> 2012
d. (3) BRIEF DESCRIPTION <i>(Brief scope, size, cost, etc.)</i> AND SPECIFIC ROLE <input checked="" type="checkbox"/> Check if project performed with current firm A new Downtown Transit bus facility for Manatee County located on 13th Street West in Bradenton. A continuous canopy was constructed along the east side of 13th St West. There is a small office, kiosk, ticket counter. Kiosk includes areas for vending machines.		
(1) TITLE AND LOCATION <i>(City and State)</i> City of Venice Fire Station #1 Replacement and City Hall Addition.	(2) YEAR COMPLETED	
	PROFESSIONAL SERVICES 2021	CONSTRUCTION <i>(If applicable)</i> 2022
e. (3) BRIEF DESCRIPTION <i>(Brief scope, size, cost, etc.)</i> AND SPECIFIC ROLE <input checked="" type="checkbox"/> Check if project performed with current firm A new 11,733 sq. ft. two story fire station to replace the existing fire station. The station will consist of office areas, living areas, and three apparatus bays. In addition there will approximately 4,500 sq. ft. of renovation within the existing City Hall building. A new high efficiency chilled water central energy plant with thermal ice storage was designed.		

E. RESUMES OF KEY PERSONNEL PROPOSED FOR THIS CONTRACT

(Complete one Section E for each key person.)

12. NAME Kay C Clem		13. ROLE IN THIS CONTRACT Mech Eng of Record & Plumbing design		14. YEARS EXPERIENCE	
				a. TOTAL 30	b. WITH CURRENT FIRM 15
15. FIRM NAME AND LOCATION <i>(City and State)</i> ME3 Consulting Engineers LLC					
16. EDUCATION <i>(Degree and Specialization)</i> BS Mechanical Engineering			17. CURRENT PROFESSIONAL REGISTRATION <i>(State and Discipline)</i> Professional Engineer. State of Florida		
18. OTHER PROFESSIONAL QUALIFICATIONS <i>(Publications, Organizations, Training, Awards, etc.)</i> LEED AP					

19. RELEVANT PROJECTS

(1) TITLE AND LOCATION <i>(City and State)</i> Manatee County Utilities and Admin Building. Manatee County, FL		(2) YEAR COMPLETED	
		PROFESSIONAL SERVICES 2012	CONSTRUCTION <i>(If applicable)</i> 2013
a.	(3) BRIEF DESCRIPTION <i>(Brief scope, size, cost, etc.)</i> AND SPECIFIC ROLE <input checked="" type="checkbox"/> Check if project performed with current firm Demolition of the existing Fleet Maintenance and adjoining buildings and the construction of a new ± 15,000 sqft building in the same location, and a new ± 5,000 sqft warehouse building. The new warehouse included a small conditioned office with restroom. Project included a rain harvest system as well as an emergency back-up generator.		
(1) TITLE AND LOCATION <i>(City and State)</i> Manatee County Fleet Services Building		(2) YEAR COMPLETED	
		PROFESSIONAL SERVICES 2009	CONSTRUCTION <i>(If applicable)</i> 2010
b.	(3) BRIEF DESCRIPTION <i>(Brief scope, size, cost, etc.)</i> AND SPECIFIC ROLE <input checked="" type="checkbox"/> Check if project performed with current firm New 12 bay fleet Service Facility with support offices, storage areas, Break room, Library for records, Rest room Facilities, Mezzanine area. Virgin Fluids distribution to each bay and containment of recovered fluids. Emergency back-up generator, lightning protection and hotsy wash bay system. Exterior landscaping & irrigation, retention pond etc.		
(1) TITLE AND LOCATION <i>(City and State)</i> SBSC South County Bus Depot and Parking. North Port, FL		(2) YEAR COMPLETED	
		PROFESSIONAL SERVICES 2013	CONSTRUCTION <i>(If applicable)</i> 2014
c.	(3) BRIEF DESCRIPTION <i>(Brief scope, size, cost, etc.)</i> AND SPECIFIC ROLE <input checked="" type="checkbox"/> Check if project performed with current firm A new 10,900 sq.ft bus maintenance building located in North Port Florida. The site includes parking for 140 buses and 100 cars and included a fuel dispensing island. Site lighting and security cameras were included in the design.		
(1) TITLE AND LOCATION <i>(City and State)</i> Manatee County - Downtown Bus Transit Depot		(2) YEAR COMPLETED	
		PROFESSIONAL SERVICES 2011	CONSTRUCTION <i>(If applicable)</i> 2012
d.	(3) BRIEF DESCRIPTION <i>(Brief scope, size, cost, etc.)</i> AND SPECIFIC ROLE <input checked="" type="checkbox"/> Check if project performed with current firm A new Downtown Transit bus facility for Manatee County located on 13th Street West in Bradenton. A continuous canopy was constructed along the east side of 13th St West. There is a small office, kiosk, ticket counter. Kiosk includes areas for vending machines.		
(1) TITLE AND LOCATION <i>(City and State)</i> City of Venice Fire Station #1 Replacement and City Hall Addition.		(2) YEAR COMPLETED	
		PROFESSIONAL SERVICES 2021	CONSTRUCTION <i>(If applicable)</i> 2022
e.	(3) BRIEF DESCRIPTION <i>(Brief scope, size, cost, etc.)</i> AND SPECIFIC ROLE <input checked="" type="checkbox"/> Check if project performed with current firm A new 11,733 sq. ft. two story fire station to replace the existing fire station. The station will consist of office areas, living areas, and three apparatus bays. In addition there will approximately 4,500 sq. ft. of renovation within the existing City Hall building. A new high efficiency chilled water central energy plant with thermal ice storage was designed.		

E. RESUMES OF KEY PERSONNEL PROPOSED FOR THIS CONTRACT

(Complete one Section E for each key person.)

12. NAME Bryan Zapf	13. ROLE IN THIS CONTRACT Electrical Eng of Record & Elec design	14. YEARS EXPERIENCE	
		a. TOTAL 32	b. WITH CURRENT FIRM 15
15. FIRM NAME AND LOCATION <i>(City and State)</i> ME3 Consulting Engineers LLC			
16. EDUCATION <i>(Degree and Specialization)</i> BE Electrical Engineering		17. CURRENT PROFESSIONAL REGISTRATION <i>(State and Discipline)</i> Professional Engineer. State of Florida	
18. OTHER PROFESSIONAL QUALIFICATIONS <i>(Publications, Organizations, Training, Awards, etc.)</i> LEED AP			

19. RELEVANT PROJECTS

(1) TITLE AND LOCATION <i>(City and State)</i>	(2) YEAR COMPLETED	
	PROFESSIONAL SERVICES	CONSTRUCTION <i>(If applicable)</i>
Manatee County Utilities and Admin Building. Manatee County, FL	2012	2013
a. (3) BRIEF DESCRIPTION <i>(Brief scope, size, cost, etc.)</i> AND SPECIFIC ROLE <input checked="" type="checkbox"/> Check if project performed with current firm Demolition of the existing Fleet Maintenance and adjoining buildings and the construction of a new ± 15,000 sqft building in the same location, and a new ± 5,000 sqft warehouse building. The new warehouse included a small conditioned office with restroom. Project included a rain harvest system as well as an emergency back-up generator.		
Manatee County Fleet Services Building	2009	2010
b. (3) BRIEF DESCRIPTION <i>(Brief scope, size, cost, etc.)</i> AND SPECIFIC ROLE <input checked="" type="checkbox"/> Check if project performed with current firm New 12 bay fleet Service Facility with support offices, storage areas, Break room, Library for records, Rest room Facilities, Mezzanine area. Virgin Fluids distribution to each bay and containment of recovered fluids. Emergency back-up generator, lightning protection and hotsy wash bay system. Exterior landscaping & irrigation, retention pond etc.		
SBSC South County Bus Depot and Parking. North Port, FL	2013	2014
c. (3) BRIEF DESCRIPTION <i>(Brief scope, size, cost, etc.)</i> AND SPECIFIC ROLE <input checked="" type="checkbox"/> Check if project performed with current firm A new 10,900 sq.ft bus maintenance building located in North Port Florida. The site includes parking for 140 buses and 100 cars and included a fuel dispensing island. Site lighting and security cameras were included in the design.		
Manatee County - Downtown Bus Transit Depot	2011	2012
d. (3) BRIEF DESCRIPTION <i>(Brief scope, size, cost, etc.)</i> AND SPECIFIC ROLE <input checked="" type="checkbox"/> Check if project performed with current firm A new Downtown Transit bus facility for Manatee County located on 13th Street West in Bradenton. A continuous canopy was constructed along the east side of 13th St West. There is a small office, kiosk, ticket counter. Kiosk includes areas for vending machines.		
City of Venice Fire Station #1 Replacement and City Hall Addition.	2021	2022
e. (3) BRIEF DESCRIPTION <i>(Brief scope, size, cost, etc.)</i> AND SPECIFIC ROLE <input checked="" type="checkbox"/> Check if project performed with current firm A new 11,733 sq. ft. two story fire station to replace the existing fire station. The station will consist of office areas, living areas, and three apparatus bays. In addition there will approximately 4,500 sq. ft. of renovation within the existing City Hall building. A new high efficiency chilled water central energy plant with thermal ice storage was designed.		

E. RESUMES OF KEY PERSONNEL PROPOSED FOR THE CONTRACT
(Complete one Section E for each key person.)

12. NAME	13. ROLE IN THIS PROJECT	14. YEARS EXPERIENCE	
SCOTT URQUHART PSM	CONTRACT MANAGER / SENIOR SURVEYOR	a. TOTAL	b. WITH CURRENT FIRM
		28	14
15. FIRM NAME AND LOCATION (City and State)			
T2 UES, Inc. d/b/a T2 Utility Engineers (Fort Myers, FL)			
16. EDUCATION (DEGREE AND SPECIALIZATION)		17. CURRENT PROFESSIONAL REGISTRATION (STATE AND DISCIPLINE)	
BS / Geomatics / University of Florida / 1999		PSM / FL / #6524 / 2004	
18. OTHER PROFESSIONAL QUALIFICATIONS (Publications, Organizations, Training, Awards, etc.)			
Florida Surveying and Mapping Society, American Congress of Surveying and Mapping			

19. RELEVANT PROJECTS			
	(1) TITLE AND LOCATION (City and State)	(2) YEAR COMPLETED	
		PROFESSIONAL SERVICES	CONSTRUCTION (if applicable)
a.	Charlotte County Vertical Control Densification, Phases I, II and III Charlotte County, FL	2018	
	(3) BRIEF DESCRIPTION (Brief scope, size, cost, etc.) AND SPECIFIC ROLE		
	Project Manager. The project purpose was to densify the National Geodetic Survey (NGS) Vertical Control Network specifically in those areas subject to FEMA flood zones within Charlotte's jurisdiction. FEMA stipulates that benchmarks set must meet NGS standards for 2nd Order, Class II accuracy standards. The County planned a network of approximately 270 marks throughout Charlotte County. The complete project was planned in 3 phases over a 3-year budget period. Phase I - \$118,656; Phase II - \$107,874; Phase III - \$128,115		
b.	Estero Boulevard Improvements Design Survey/Laser Scan, Lee County, FL	2022	
	(3) BRIEF DESCRIPTION (Brief scope, size, cost, etc.) AND SPECIFIC ROLE		
	Sr. Project Manager. A phased reconstruction of a County roadway (Segments 2 through 6) over 5 miles within the Town of Fort Myers Beach. Project components include adding trolley stops, bike lanes and sidewalks on both sides of the corridor and replacement of City water lines and County sewer lines. T2ue's professional surveying consultant responsibilities include: recovering or re-establishing project alignment; setting targets for scanning; locating all above ground features and improvements; collecting required data for the purpose of creating a DTM; obtaining roadway cross-sections/profiles and side street surveys (up to 75' down each intersecting street); right-of-way staking and sketches and descriptions for parcel acquisitions. T2ue also provided SUE including 2-dimensional collection of existing utilities and selected 3-dimensional verification as necessary for designation. Multi-channel ground-penetrating radar (MCGPR) was utilized in areas requiring additional detail due to the existence of very congested utilities. Fee: \$1,160,176		
c.	Naples Hotel and Beach Club, Naples, FL	2020	
	(3) BRIEF DESCRIPTION (Brief scope, size, cost, etc.) AND SPECIFIC ROLE		
	Sr. Project Manager. T2ue performed a SUE investigation in general accordance with ASCE Standard 38-02. The project located along Gulf Shore Boulevard was approximately 1,500 feet in length and extended 25 feet outside the right-of-way. Tasks included records research, standard subsurface investigation, surveying of designated data and mapping of final data. Due to the lack of utility records in the area, multi-channel ground penetrating radar (MCGPR) was utilized to assist in identifying the existence of undocumented utilities. Fee: \$19,720		
d.	Fiddlesticks Water Main Replacement, Lee County, FL	2019	
	(3) BRIEF DESCRIPTION (Brief scope, size, cost, etc.) AND SPECIFIC ROLE		
	Sr. Project Manager. T2ue provided the design survey, three-dimensional surface and SUE for this project that encompassed 60,000 linear feet of laser scanning data collection within the rights-of-way and 200 +/- test holes and utility designation. Additionally, T2ue re-established rights-of-way and established horizontal and vertical project control. Five field crews were utilized to meet project deadlines. Fee: \$ 632,012		
e.	Southwest Florida International Airport (RSW) Airside Rehabilitation Lee County Port Authority, Lee County, FL	2018	
	(3) BRIEF DESCRIPTION (Brief scope, size, cost, etc.) AND SPECIFIC ROLE		
	Sr. Project Manager. T2ue provided a topographical survey for engineering design consisting of several taxiways, ramp and cargo areas. All data was collected utilizing multiple laser scanners. In addition, T2ue provided SUE services within the same project limits. This work required both day and night work schedules and utilized five field crews to meet project deadlines. Fee: \$ 365,785		

E. RESUMES OF KEY PERSONNEL PROPOSED FOR THE CONTRACT
(Complete one Section E for each key person.)

12. NAME		13. ROLE IN THIS PROJECT		14. YEARS EXPERIENCE		
ANTHONY RAVENNA		SUE MANAGER		a. TOTAL	b. WITH CURRENT FIRM	
				17	17	
15. FIRM NAME AND LOCATION (City and State)						
T2 UES, Inc. d/b/a T2 Utility Engineers (Riverview, FL)						
16. EDUCATION (DEGREE AND SPECIALIZATION)			17. CURRENT PROFESSIONAL REGISTRATION (STATE AND DISCIPLINE)			
18. OTHER PROFESSIONAL QUALIFICATIONS (Publications, Organizations, Training, Awards, etc.)						
FDOT Temporary Traffic Control (TTC) Intermediate Course; FDOT Temporary Traffic Control (TTC) Advanced Course						
19. RELEVANT PROJECTS						
a.	(1) TITLE AND LOCATION (City and State)			(2) YEAR COMPLETED		
	District-Wide Minor Design – Signalized Intersection LED Lighting Enhancements, FDOT District Seven, Hillsborough and Pinellas Counties, FL			PROFESSIONAL SERVICES	CONSTRUCTION (if applicable)	
				2018		
	(3) BRIEF DESCRIPTION (Brief scope, size, cost, etc.) AND SPECIFIC ROLE			<input checked="" type="checkbox"/> Check if project performed with current firm		
SUE. This project involved three federally funded task work order authorizations to upgrade lighting at signalized intersections along select high crash corridors in Hillsborough and Pinellas Counties. Prime's design efforts included the development of LED lighting plans, specifications and estimates for over 200 signalized intersections. T2ue provided Quality Level A Designating services to support signal pole foundations at miscellaneous locations throughout the county. In the event the proposed signal pole foundation was in conflict with utilities, another conflict free location within feet of the original location was marked. Test holes were performed to a depth of eight feet at the center of the proposed pole location to ensure the location was free of utilities. Each cleared signal pole foundation was marked with an iron rod and cap. Two Hillsborough Project Fees: \$531,638 (lighting design) / \$675,404 (total design). Pinellas County Project Fee: \$648,804 (lighting design) / \$685,156 (total design).						
b.	(1) TITLE AND LOCATION (City and State)			(2) YEAR COMPLETED		
	Estero Boulevard Improvements Design Survey/Laser Scan, Lee County, FL			PROFESSIONAL SERVICES	CONSTRUCTION (if applicable)	
				2022		
	(3) BRIEF DESCRIPTION (Brief scope, size, cost, etc.) AND SPECIFIC ROLE			<input checked="" type="checkbox"/> Check if project performed with current firm		
SUE. A phased reconstruction of a County roadway (Segments 2 through 6) over 5 miles within the Town of Fort Myers Beach. Project components include adding trolley stops, bike lanes and sidewalks on both sides of the corridor and replacement of City water lines and County sewer lines. T2ue's responsibilities include: recovering or re-establishing project alignment; setting targets for scanning; locating all above ground features and improvements; collecting required data for the purpose of creating a DTM; obtaining roadway cross-sections/ profiles and side street surveys (up to 75' down each intersecting street); right-of-way staking and sketches and descriptions for parcel acquisitions. T2ue also provided SUE including 2D collection of existing utilities and selected 3D verification as necessary for designation. MCGPR was utilized in areas requiring additional detail due to the existence of very congested utilities. Fee: \$1,160,176						
c.	(1) TITLE AND LOCATION (City and State)			(2) YEAR COMPLETED		
	Allen and Barcola Roadways, Hillsborough and Pok Counties, FL			PROFESSIONAL SERVICES	CONSTRUCTION (if applicable)	
				2019		
	(3) BRIEF DESCRIPTION (Brief scope, size, cost, etc.) AND SPECIFIC ROLE			<input checked="" type="checkbox"/> Check if project performed with current firm		
SUE. T2ue performed SUE investigation and location along several roadways for engineering design purposes. Fee: \$8,000						
d.	(1) TITLE AND LOCATION (City and State)			(2) YEAR COMPLETED		
	Southwest Florida International Airport (RSW) Airside Rehabilitation Lee County Port Authority, Lee County, FL			PROFESSIONAL SERVICES	CONSTRUCTION (if applicable)	
				2018		
	(3) BRIEF DESCRIPTION (Brief scope, size, cost, etc.) AND SPECIFIC ROLE			<input checked="" type="checkbox"/> Check if project performed with current firm		
SUE Supervisor. T2ue provided a topographical survey for engineering design consisting of several taxiways, ramp and cargo areas. All data was collected utilizing multiple laser scanners. In addition, T2ue provided SUE services within the same project limits. This work required both day and night work schedules and utilized five field crews to meet project deadlines. Fee: \$365,785						
e.	(1) TITLE AND LOCATION (City and State)			(2) YEAR COMPLETED		
	SR 710 (Beeline Highway) from Northlake Boulevard to SR 708 (Blue Heron Boulevard), FDOT District Four, Palm Beach County, FL			PROFESSIONAL SERVICES	CONSTRUCTION (if applicable)	
				2019		
	(3) BRIEF DESCRIPTION (Brief scope, size, cost, etc.) AND SPECIFIC ROLE			<input checked="" type="checkbox"/> Check if project performed with current firm		
SUE Manager to support the EOR's design efforts for this roadway expansion design project. T2ue provided SUE, design survey and utility coordination services. Fee: \$949,356						

E. RESUMES OF KEY PERSONNEL PROPOSED FOR THIS CONTRACT
(Complete one Section E for each key person.)

12. NAME Jerry H. Kuehn, P.E.	13. ROLE IN THIS CONTRACT Senior Geotechnical Engineer	14. YEARS EXPERIENCE	
		a. TOTAL 41	b. WITH CURRENT FIRM 41
15. FIRM NAME AND LOCATION <i>(City and State)</i> Ardaman & Associates, Inc., Sarasota, Florida			
16. EDUCATION <i>(DEGREE AND SPECIALIZATION)</i> M.S. Civil Engineering, Purdue University, 1981 B.S. Civil Engineering, Purdue University, 1980		17. CURRENT PROFESSIONAL REGISTRATION <i>(STATE AND DISCIPLINE)</i> Florida Professional Engineer, No. 35557	
18. OTHER PROFESSIONAL QUALIFICATIONS <i>(Publications, Organizations, Training, Awards, etc.)</i> ASCE			

19. RELEVANT PROJECTS

	(1) TITLE AND LOCATION <i>(City and State)</i>	(2) YEAR COMPLETED	
		PROFESSIONAL SERVICES	CONSTRUCTION <i>(If Applicable)</i>
a.	Country Club Shores Water Main Replacement, Phases 1 and 2 Longboat Key, Florida	2020	
	(3) BRIEF DESCRIPTION <i>(Brief scope, size, cost, etc.)</i> AND SPECIFIC ROLE Senior Project Engineer - Conducted a subsurface exploration and provided geotechnical recommendations for replacement of existing water mains throughout the Country Club Shores neighborhood. Activities included SPT borings, pavement coring, and laboratory testing of selected samples.	<input checked="" type="checkbox"/> Check if project performed with current firm	
b.	South Sumter Boulevard North Port, Florida	2016	
	(3) BRIEF DESCRIPTION <i>(Brief scope, size, cost, etc.)</i> AND SPECIFIC ROLE Senior Project Engineer – Conducted an investigation related to pavement failure on approximately 1,600 feet of Sumter Boulevard. Pavement cores were cut with hand auger borings conducted in the core holes to obtain soil samples of the subgrade. Laboratory testing for organic content was performed, and the report of findings prepared for the City. Piezometers were subsequently installed to measure groundwater fluctuations.	<input checked="" type="checkbox"/> Check if project performed with current firm	
c.	Water Control Structure #113 North Port, Florida	2022	
	(3) BRIEF DESCRIPTION <i>(Brief scope, size, cost, etc.)</i> AND SPECIFIC ROLE Senior Project Engineer - Provided geotechnical services for replacement of the existing structure on the Snover Waterway. Activities included SPT borings, laboratory testing, plus seepage and stability analyses for proposed sheet pile water control structure.	<input checked="" type="checkbox"/> Check if project performed with current firm	
d.	South Sumter Stormwater Pond North Port, Florida	2017	
	(3) BRIEF DESCRIPTION <i>(Brief scope, size, cost, etc.)</i> AND SPECIFIC ROLE Senior Project Engineer – Conducted soil and groundwater investigations, including SPT and hand auger borings, plus permeability testing to prepare design recommendations for the stormwater pond at the Sumter Boulevard Park & Ride site.	<input checked="" type="checkbox"/> Check if project performed with current firm	
e.	Lift Station 815 Rotonda West, Florida	2018	
	(3) BRIEF DESCRIPTION <i>(Brief scope, size, cost, etc.)</i> AND SPECIFIC ROLE Senior Project Engineer – Conducted a subsurface investigation adjacent to two wet wells to investigate possible causes of slab settlement and downward movement of the wet wells. SPT borings were conducted, and laboratory samples were collected and analyzed for silt and clay content. Findings were presented to the Design Engineer with recommendations for additional investigation to verify cause of the distress.	<input checked="" type="checkbox"/> Check if project performed with current firm	

STANDARD FORM 330 (7/2021)

E. RESUMES OF KEY PERSONNEL PROPOSED FOR THIS CONTRACT

(Complete one Section E for each key person.)

12. NAME CHRISTINE KULSVEEN	13. ROLE IN THIS CONTRACT ENVIRONMENTAL CONSULTANT	14. YEARS EXPERIENCE	
		a. TOTAL 6	b. WITH CURRENT FIRM 6

15. FIRM NAME AND LOCATION *(City and State)*
LANDESCO PLLC (NORTH FORT MYERS, FLORIDA)

16. EDUCATION <i>(Degree and Specialization)</i> BACHELORS OF SCIENCE ASSOCIATES IN AGRICULTURAL ECONOMICS UNIVERSITY OF KENTUCKY - LEXINGTON, KENTUCKY	17. CURRENT PROFESSIONAL REGISTRATION <i>(State and Discipline)</i> N/A
---	---

18. OTHER PROFESSIONAL QUALIFICATIONS *(Publications, Organizations, Training, Awards, etc.)*
**FWCC GOPHER TORTOISE AUTHORIZED AGENT
FWCC BURROWING OWL TRAINING (CERTIFICATION PENDING)**

19. RELEVANT PROJECTS

(1) TITLE AND LOCATION <i>(City and State)</i> CITY OF CAPE CORAL FIRE TRAINING FACILITY - CAPE CORAL, FLORIDA	(2) YEAR COMPLETED	
	PROFESSIONAL SERVICES CURRENT/ACTIVE	CONSTRUCTION <i>(If applicable)</i>
(3) BRIEF DESCRIPTION <i>(Brief scope, size, cost, etc.)</i> AND SPECIFIC ROLE <input type="checkbox"/> Check if project performed with current firm a. ALL ENVIRONMENTAL CONSULTING SERVICES INCLUDING ENVIRONMENTAL ASSESSMENTS, PROTECTED SPECIES SURVEYS, TREE SURVEYS, WETLAND PERMITTING WITH SFWMD & FDEP, FLORIDA BONNETED BAT SURVEY, GOPHER TORTOISE SURVEY, ETC..., 11 acre project, 8 million budget		
(1) TITLE AND LOCATION <i>(City and State)</i> CITY OF CAPE CORAL FLEET FACILITY - CAPE CORAL, FLORIDA	(2) YEAR COMPLETED	
	PROFESSIONAL SERVICES CURRENT/ACTIVE	CONSTRUCTION <i>(If applicable)</i>
(3) BRIEF DESCRIPTION <i>(Brief scope, size, cost, etc.)</i> AND SPECIFIC ROLE <input type="checkbox"/> Check if project performed with current firm b. ALL ENVIRONMENTAL CONSULTING SERVICES INCLUDING ENVIRONMENTAL ASSESSMENTS, PROTECTED SPECIES SURVEYS, TREE SURVEYS, WETLAND PERMITTING WITH SFWMD & FDEP, FLORIDA BONNETED BAT SURVEY, GOPHER TORTOISE SURVEY, ETC..., 15-30 acre parcel, \$350K		
(1) TITLE AND LOCATION <i>(City and State)</i> THE PALMS OF CAPE CORAL - CAPE CORAL, FLORIDA	(2) YEAR COMPLETED	
	PROFESSIONAL SERVICES 2020/2021	CONSTRUCTION <i>(If applicable)</i> IN CONSTRUCTION
(3) BRIEF DESCRIPTION <i>(Brief scope, size, cost, etc.)</i> AND SPECIFIC ROLE <input type="checkbox"/> Check if project performed with current firm c. ENVIRONMENTAL ASSESSMENT, PROTECTED SPECIES SURVEY, FLORIDA BONNETED BAT SURVEY, WETLAND DELINIATION & PERMITTING WITH SWFMWD & FDEP, HERITAGE TREE SURVEY, GOPHER TORTOISE SURVEY, FWCC GOPHER TOROISE PERMITTING AND RELOCATION (20 MILLION MULTI-FAMILY)		
(1) TITLE AND LOCATION <i>(City and State)</i> EDISON OIL - PINE ISLAND, FLORIDA	(2) YEAR COMPLETED	
	PROFESSIONAL SERVICES 2019-2020	CONSTRUCTION <i>(If applicable)</i>
(3) BRIEF DESCRIPTION <i>(Brief scope, size, cost, etc.)</i> AND SPECIFIC ROLE <input type="checkbox"/> Check if project performed with current firm d. BALD EAGLE MANAGEMENT PLAN. WE WORKED CLOSELY WITH THE LEE COUNTY EAGLE TECHINCAL ADVISORY COMMITTEE ON THIS. THIS FACILITY IS PLANNED TO BE BUILT WITH 330' OF THE YEAR ROUND ACTIVE BALD EAGLE NEST.		
(1) TITLE AND LOCATION <i>(City and State)</i>	(2) YEAR COMPLETED	
	PROFESSIONAL SERVICES	CONSTRUCTION <i>(If applicable)</i>
(3) BRIEF DESCRIPTION <i>(Brief scope, size, cost, etc.)</i> AND SPECIFIC ROLE <input type="checkbox"/> Check if project performed with current firm e.		



SWEETSPARKMAN
ARCHITECTURE & INTERIORS



TAB 4

TEAM'S PREVIOUS EXPERIENCE

F. EXAMPLE PROJECTS WHICH BEST ILLUSTRATE PROPOSED TEAM'S QUALIFICATIONS FOR THIS CONTRACT
(Present as many projects as requested by the agency, or 10 projects, if not specified. Complete one Section F for each project.)

20. EXAMPLE PROJECT KEY NUMBER

1

21. TITLE AND LOCATION *(City and State)*

St. Petersburg Sanitation Department Building
St. Petersburg, FL

22. YEARS COMPLETED

PROFESSIONAL SERVICES

Ongoing

CONSTRUCTION *(If applicable)*

Ongoing

23. PROJECT OWNER'S INFORMATION

a. PROJECT OWNER

City of St. Petersburg

b. POINT OF CONTACT NAME

Patrick Green, Project Manager

c. POINT OF CONTACT TELEPHONE NUMBER

727-893-7111

24. BRIEF DESCRIPTION OF PROJECT AND RELEVANCE TO THIS CONTRACT *(Include scope, size, and cost)*

SCOPE: The scope of work includes new administration and operations buildings for the Sanitation Department with a new parking lot to accommodate 193 total parking spaces. The program includes administration offices, conference rooms, restrooms, fitness room, and locker room / shower facilities. The site will be divided into a building area, fleet parking and storage area, and a container storage area. The project features a 2,000 SF green roof. This project is expected to be a LEED certified Net-Zero building.

SIZE: 18,628 SF under roof with 2,000 SF green space

COST: \$6.6 million



25. FIRMS FROM SECTION C INVOLVED WITH THIS PROJECT

(1) FIRM NAME	(2) FIRM LOCATION <i>(City and State)</i>	(3) ROLE
a. Sweet Sparkman Architecture and Interiors	Sarasota, FL	Architect

F. EXAMPLE PROJECTS WHICH BEST ILLUSTRATE PROPOSED TEAM'S QUALIFICATIONS FOR THIS CONTRACT <i>(Present as many projects as requested by the agency, or 10 projects, if not specified. Complete one Section F for each project.)</i>		20. EXAMPLE PROJECT KEY NUMBER 2
21. TITLE AND LOCATION (City and State) Pinellas County Schools Coachman Service Center Clearwater, FL	22. YEARS COMPLETED	
	PROFESSIONAL SERVICES Ongoing	CONSTRUCTION (If applicable) Ongoing

23. PROJECT OWNER'S INFORMATION

a. PROJECT OWNER Pinellas County Schools	b. POINT OF CONTACT NAME Bruce Stott, Projects Coordinator	c. POINT OF CONTACT TELEPHONE NUMBER 727-638-1116
--	--	---

24. BRIEF DESCRIPTION OF PROJECT AND RELEVANCE TO THIS CONTRACT *(Include scope, size, and cost)*

SCOPE: Sweet Sparkman was contracted by Pinellas County Schools to design a new bus service garage to hold and maintain the buses servicing the district's mid county schools. The scope includes demolition of an existing structure, new construction of a 9,600 SF 5-bay bus service garage with associated work spaces, a renovation of 5 offices, lounge, and workspaces, and a conversion of the existing transportation command center back into a kitchen to serve the school. Site work will include a revised parking lot layout and drive access. Todd M. Sweet, AIA, LEED AP serves as the Principal in Charge / Architect of Record. Arturo Lopez, AIA and Jenna Albers, AIA, NCARB serve as the Project Architects. Greg Bowen, PE, LEED AP BD+C and Josh Wides, PE of Engineering Matrix serve as our MEP Engineers.

SIZE: 9,600 SF New Construction and 2,500 SF Renovation

COST: \$5.7 Million



25. FIRMS FROM SECTION C INVOLVED WITH THIS PROJECT

a.	(1) FIRM NAME Sweet Sparkman Architecture and Interiors	(2) FIRM LOCATION (City and State) Sarasota, FL	(3) ROLE Architect
----	---	---	------------------------------

F. EXAMPLE PROJECTS WHICH BEST ILLUSTRATE PROPOSED TEAM'S QUALIFICATIONS FOR THIS CONTRACT <i>(Present as many projects as requested by the agency, or 10 projects, if not specified. Complete one Section F for each project.)</i>		20. EXAMPLE PROJECT KEY NUMBER 3
21. TITLE AND LOCATION <i>(City and State)</i> Venice Public Works Renovation Venice, FL	22. YEARS COMPLETED	
	PROFESSIONAL SERVICES 2021	CONSTRUCTION <i>(if applicable)</i> 2021

23. PROJECT OWNER'S INFORMATION

a. PROJECT OWNER City of Venice	b. POINT OF CONTACT NAME James Clinch, Director of Public Works	c. POINT OF CONTACT TELEPHONE NUMBER 941-486-2422
---	---	---

24. BRIEF DESCRIPTION OF PROJECT AND RELEVANCE TO THIS CONTRACT *(Include scope, size, and cost)*

SCOPE: The City of Venice contracted Sweet Sparkman to re-purpose the existing Police Station into office space for the City of Venice Public Works to include Maintenance & Parks, Administration, and Fleet Services. The project scope includes renovations to select areas of the 18,000 SF building.

SIZE: 18,000 SF

COST: \$750,000



25. FIRMS FROM SECTION C INVOLVED WITH THIS PROJECT

a.	(1) FIRM NAME Sweet Sparkman Architecture and Interiors	(2) FIRM LOCATION <i>(City and State)</i> Sarasota, FL	(3) ROLE Architect
----	---	--	------------------------------

F. EXAMPLE PROJECTS WHICH BEST ILLUSTRATE PROPOSED TEAM'S QUALIFICATIONS FOR THIS CONTRACT <i>(Present as many projects as requested by the agency, or 10 projects, if not specified. Complete one Section F for each project.)</i>		20. EXAMPLE PROJECT KEY NUMBER 4
21. TITLE AND LOCATION (City and State) Cape Coral Fleet Maintenance Facility - Cape Coral, FL	22. YEARS COMPLETED	
	PROFESSIONAL SERVICES Ongoing	CONSTRUCTION (if applicable) N/A

23. PROJECT OWNER'S INFORMATION

a. PROJECT OWNER City of Cape Coral	b. POINT OF CONTACT NAME Gino Notarianni - Senior Project Manager	c. POINT OF CONTACT TELEPHONE NUMBER 239-242-3225
---	---	---

24. BRIEF DESCRIPTION OF PROJECT AND RELEVANCE TO THIS CONTRACT *(Include scope, size, and cost)*

SCOPE: Sweet Sparkman, teaming with Weston & Sampson, is working with the City of Cape Coral to develop a feasibility study and conceptual design plan for a new Public Works Fleet Maintenance Facility. The team is providing building programming services, involving staff interviews, operational analysis, and review and development of future staff projections to determine the appropriate building size for the new fleet facility for today's current needs and the city's future build-out plan. We are also researching and determining the appropriate site for the new fleet facility location using an in-depth site selection matrix considering cost, permitting, public impact, and many other key parameters. Once the building is programmed and the site is selected, we will provide a conceptual master plan layout design for the selected site and identify future facility outparcels. The project is currently underway and upon completion, the city has the ability to opt to use Sweet Sparkman and Weston & Sampson for final design of the Fleet Facility which includes architectural, planning, engineering, design, permitting and construction management. This work is scheduled to be completed by the end of 2022, with design beginning 2023.

25. FIRMS FROM SECTION C INVOLVED WITH THIS PROJECT

a.	(1) FIRM NAME Sweet Sparkman Architecture and Interiors	(2) FIRM LOCATION (City and State) Sarasota, FL	(3) ROLE Architect
b.	(1) FIRM NAME Weston & Sampson	(2) FIRM LOCATION (City and State) Fort Myers, FL	(3) ROLE Civil Engineering

F. EXAMPLE PROJECTS WHICH BEST ILLUSTRATE PROPOSED TEAM'S QUALIFICATIONS FOR THIS CONTRACT
 (Present as many projects as requested by the agency, or 10 projects, if not specified.
 Complete one Section F for each project.)

20. EXAMPLE PROJECT KEY NUMBER

5

21. TITLE AND LOCATION (City and State)

**Public Works Operations and Maintenance Facility
 Village of Ardsley, New York**

22. YEARS COMPLETED

PROFESSIONAL SERVICES

Ongoing

CONSTRUCTION (If applicable)

Ongoing

23. PROJECT OWNER'S INFORMATION

a. PROJECT OWNER

Village of Ardsley, New York

b. POINT OF CONTACT NAME

Meredith S. Robson - Village Manager

c. POINT OF CONTACT TELEPHONE NUMBER

914-381-7810

24. BRIEF DESCRIPTION OF PROJECT AND RELEVANCE TO THIS CONTRACT (Include scope, size, and cost)

SCOPE: Weston & Sampson is providing full design, bidding, and construction administration services for the Village of Ardsley's new public works maintenance facility, comprised of vehicle storage, vehicle maintenance, equipment storage, wash bay, and administration. Site amenities include bulk storage of materials, fuel storage and dispensing, and salt storage.

COST: \$16 Million (anticipated)

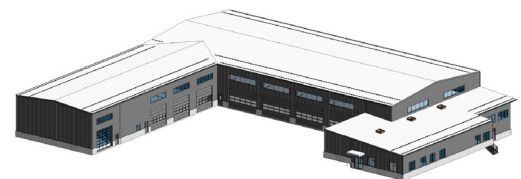
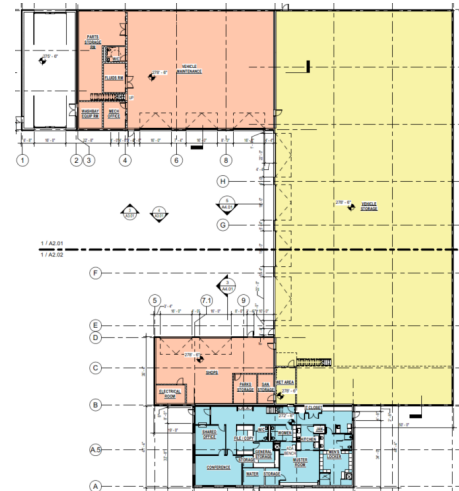

25. FIRMS FROM SECTION C INVOLVED WITH THIS PROJECT

(1) FIRM NAME	(2) FIRM LOCATION (City and State)	(3) ROLE
a. Weston & Sampson	Albany, NY	Prime

G. KEY PERSONNEL PARTICIPATION IN EXAMPLE PROJECTS

26. NAMES OF KEY PERSONNEL (From Section E, Block 12)	27. ROLE IN THIS CONTRACT (From Section E, Block 13)	28. EXAMPLE PROJECTS LISTED IN SECTION F (Fill in "Example Projects Key" section below before completing table. Place "X" under project key number for participation in same or similar role.)									
		1	2	3	4	5	6	7	8	9	10
TODD M. SWEET, AIA, LEED AP	PRINCIPAL IN CHARGE / ARCHITECT OF RECORD	X	X	X	X						
JOHN BRYANT, AIA, LEED AP	PROJECT MANAGER	X	X	X							
ARTURO LOPEZ, AIA	PROJECT ARCHITECT		X	X							
SHIRLEY QUINLAN	INTERIOR DESIGNER	X	X	X							
JEFFREY WILSON, PE, PWLF	CIVIL ENGINEER PRINCIPAL IN CHARGE				X						
JOSEPH ZONGOL, PE, NICET III	CIVIL ENGINEER PROJECT MANAGER				X	X					
MICHAEL RICHARD, PE	CIVIL ENGINEER TECHNICAL REVIEW				X	X					
DANIEL TENNEY, III, AIA	CIVIL ENGINEER TECHNICAL REVIEW				X	X					
GARY FERRANTE, PE	CIVIL / SITE ENGINEERING				X						
JEAN-PIERRE PARNAS, RA	PROGRAMMING				X	X					
JAMES FAIR, PE	INDUSTRIAL EQUIPMENT				X	X					
DAVID G. KARINS, PE, SI	STRUCTURAL ENGINEER PRINCIPAL IN CHARGE										
JEROME DIMERCURIO, PE	STRUCTURAL ENGINEER										
SIDNEY PRITCHARD, LEED AP	HVAC DESIGN										
KAY C. CLEM, PE, LEED AP	MECHANICAL ENGINEER OF RECORD / PLUMBING DESIGN										
BRYAN ZAPF, PE, LEED AP	ELECTRICAL ENGINEER OF RECORD										
SCOTT URQUHART, PSM	SURVEY / MAPPING CONTRACT MANAGER										
ANTHONY RAVENNA	SUE MANAGER										
JERRY H. KUEHN, PE	SENIOR GEOTECHNICAL ENGINEER										
CHRISTINE KULSVEEN	ENVIRONMENTAL CONSULTANT / LANDSCAPE				X						

29. EXAMPLE PROJECTS KEY

NUMBER	TITLE OF EXAMPLE PROJECT (FROM SECTION F)	NUMBER	TITLE OF EXAMPLE PROJECT (FROM SECTION F)
1	ST. PETERSBURG SANITATION DEPARTMENT BUILDING	6	
2	PINELLAS COUNTY SCHOOLS COACHMAN SERVICE	7	
3	VENICE PUBLIC WORKS RENOVATION	8	
4	CAPE CORAL FLEET MAINTENANCE FACILITY	9	
5	PUBLIC WORKS OPERATIONS / MAINTENANCE FACILITY	10	



SWEETSPARKMAN
ARCHITECTURE & INTERIORS



TAB 5

MANAGEMENT APPROACH / PROJECT CONTROL

Management Approach

Project Management

Sweet Sparkman will implement a management approach that has proven highly effective in meeting contract compliance while ensuring the delivery of a quality project. Our team has the technical ability and experience to produce this project and meet the high standards required by the City of North Port. We effectively communicate with affected stakeholders through our strong project management team.

THE COMPONENTS NECESSARY TO DELIVER THIS PROJECT ARE AS FOLLOWS:

- Provide a framework that provides clear lines of communication and responsibility
- Provide highly qualified personnel directed by a proven Project Manager
- Maintain the project schedule that tracks milestones and identifies any performance issues
- Track financial progress with our project schedule to contain costs
- Implement a quality assurance and quality control program to ensure the project is produced correctly the first time



Schedule Management

The Sweet Sparkman team will develop a schedule for the project cooperatively with the City of North Port Project Manager. The schedule will consist of the various work components with start and finish dates. The critical path will be monitored through the life of the project. Milestone events, such as progress meetings and deliverables will be identified on the schedule. From design to construction, Sweet Sparkman values the importance placed on effectively managing project tasks and deliverables.

John Bryant, AIA, LEED AP will oversee the Project Schedule during design, and will update the schedule monthly with distribution to all team members. This approach requires the use of a comprehensive management process that will ensure effective communication and follow through by all team members. The use of Microsoft Project will allow the team to monitor and track the status of deliverables, questions, potential changes, project design, construction costs, contracts, and many other aspects. John will work with the City of North Port Project Manager to establish the overall project. Every team member will have access to project information, status, and any outstanding issues that must be resolved to keep the project moving.



PROJECT SCHEDULE WILL BE DEFINED AND MET USING THE FOLLOWING METHODS:

- Early clarification of the Scope of Work
- Early establishment of communication channels
- Regular team meetings established
- Identification of critical path benchmarks
- Identification of Project team member responsibilities
- Documentation and distribution of minutes after each meeting
- Thorough follow up on documented progress

Budget Management

Meeting budgets for the public/governmental sector is crucial to maintaining accountability and responsible stewardship of capital revenues. Our team has consistently delivered projects under initial budget due to accurate initial estimating and responsible design. We have held projects on budget using Owner contingency funds only as needed.

SWEET SPARKMAN WILL CONTROL PROJECT COST UTILIZING THE FOLLOWING TECHNIQUES:

- Cost analysis at each design deliverable phase will go to all on the project team.
 - Use of FTP site for shared critical information, reports, progress drawings, testing, specifications
 - Arturo will work carefully with the City of Bradenton, construction manager, and consultants to select systems and cost effective materials.
 - Evaluation of energy-saving systems readily available
- and performance-proven locally
 - Early stages of cost analysis will account for recent cost trends and shall include a contingency as determined by the construction manager.
 - Detailed cost estimates will lower contractor contingency amounts and allow for Owner contingency funds to be allocated for the Project.
 - Owner review and comment of cost analysis and reports shall be integral as the design progresses.
 - Thorough QA/QC reviews of our architectural, mechanical, electrical, plumbing, and structural documents to help avoid construction issues. This type of diligence has resulted in non-Owner generated changes averaging less than 0.5% on recent projects. During construction our team stays involved to help evaluate and resolve issues and ensure the Owner receives the proper value.

Technological Capabilities

Sweet Sparkman will use Revit for internal communication. Revit is used as a coordination tool throughout the design process, as well as during construction, to develop and manage budgets, timelines, and sequencing. Revit enables our design teams to integrate architectural, mechanical, and structural systems into a virtual model that can identify conflicts between building systems and resolve them during design. Sweet Sparkman uses BIM to create building documentation, generate schedules, calculate material quantities, and simulate “real world” conditions. In addition, Revit facilitates efficient production of construction documents by leveraging linked views of the 3D model to generate building plans, sections, and elevations.

The Building Information Modeling plan outlines team member responsibilities for storing and transferring digital information, allowing the process to be efficient and timely. The plan outlines the clash detection process (determining what building objects occupy the same space at the same time), focusing on clash detection resolution.

Workload

Sweet Sparkman currently has a workload distributed among 35 full time employees. The proposed team has an average of 40% availability to accommodate this project at this time. With several projects nearing completion or entering Construction Administration phase, our team will be prepared to start a new project.





SWEETSPARKMAN
ARCHITECTURE & INTERIORS



TAB 6

REFERENCES

ATTACHMENT 3
REFERENCES/CLIENT LISTING

(The firm shall provide at least two (2) business related references for which they are currently providing or have provided within the last ten (10) years, services similar to the scope of services required by this RFP). Attach additional sheets if necessary. The Project Manager and the key design engineer(s) in the proposed project team must show relevant experience in two (2) referenced similar projects.

1. Business/Customer Name: City of St. Petersburg

Name of Contact Person/Title: Patrick Green - Project Manager

Telephone# 727-893-7111 Fax N/A E-mail patrick.green@stpete.org

Address Po Box 2842, St. Petersburg, FL 33731

Phone Number 727-893-7111

Duration of Contract or business relationship 3 years, 2 months Project completion date: est. 8/2023

Type of Services Provided Architecture - new construction for 18,628 SF building

Cost of Project: Design \$731,588 Construction: \$9 million

2. Business/Customer Name: Pinellas County Schools

Name of Contact Person/Title: Bruce Stofff - Projects Coordinator

Telephone# 727-638-1116 Fax N/A E-mail StottB@pcsb.org

Address 301 4th Street SW, Largo, FL 33770

Phone Number 727-638-1116

Duration of Contract or business relationship 2.5 years Project completion date: est. 10/2022

Type of Services Provided Architecture - new construction 9,600 SF and 2,500 SF renovation

Cost of Project: Design \$411,750 Construction: \$5.7 million

3. Business/Customer Name: City of Venice

Name of Contact Person/Title: James Clinch - Director of Public Works

Telephone# 941-486-2422 Fax N/A E-mail jclinch@venicegov.com

Address 401 W. Venice Avenue, Venice, FL 34285

Phone Number 941-486-2422

Duration of Contract or business relationship 2 years Project completion date: est. 10/2022

Type of Services Provided Architecture - 18,000 SF renovation

Cost of Project: Design \$46,000 Construction: \$750,000

4. Business/Customer Name: Sarasota County
Name of Contact Person/Title: Kimberly Humphrey - Former Project Manager for Sarasota County
Telephone# 941-549-4549 Fax N/A E-mail khumphrey@cityofnorthport.com
Address 4970 City Hall Blvd. North Port, FL 34286
Phone Number 941-549-4549
Duration of Contract or business relationship 14 years Project completion date: multiple projects
Type of Services Provided Architecture for approx. 19 projects
Cost of Project: Design multiple projects Construction: multiple projects

5. Business/Customer Name: Manatee County
Name of Contact Person/Title: Heather Dilldine - Utilities Operations Manager
Telephone# 941-798-6756 Fax N/A E-mail heather.dilldine@mymanatee.org
Address 1112 Manatee Avenue West, Bradenton, FL 34205
Phone Number 941-798-6756
Duration of Contract or business relationship 3 years Project completion date: Est. 2024
Type of Services Provided Architecture - Conceptual Design for a 2-Story, 40,000 SF building
Cost of Project: Design \$59,770 Construction: TBD

Date: September 1, 2022
Signed (Person authorized to bind the company): 
Name (printed): Todd M. Sweet, AIA, LEED AP Title: Principal

THIS FORM (pages 36 & 37) MUST BE COMPLETED AND SUBMITTED WITH PROPOSAL



SWEETSPARKMAN
ARCHITECTURE & INTERIORS



TAB 7

LITIGATION AND INSURANCE

Litigation and Insurance

Sweet Sparkman Architects, Inc. has not been involved in litigation in the last five (5) years.





SWEETSPARKMAN
ARCHITECTURE & INTERIORS



FIRE RISER

TAB 8

ADDITIONAL INFORMATION

Additional Information

Selected List of Government Projects

MANATEE COUNTY

- Manatee County Lincoln Park Pool
- Manatee County Utilities / Public Works Administration Building
- Manatee County GT Bray Pickleball Complex
- Manatee County Public Works Building Renovation
- Manatee County Quattlebaum House Renovation
- Manatee County EMS Station #10
- Manatee County Pedestrian Bridge Replacement
- Manatee County Admin 9th Floor Renovation
- Manatee County Admin 2nd Floor Renovation
- Manatee County EMS Station at Moccasin Wallow
- Historic Manatee County Courthouse ADA Modifications
- Southern Manatee Fire Rescue Stations #2 and #5 Renovations



SARASOTA COUNTY

- RL Anderson South County Courts Renovation and Addition
- Sarasota County Fire Stations #1, #8, #12, #13, #14, #16, #17
- Sarasota County Terrace Building
- Sheriff Administration Building Air Handler ReRoof
- Gun Range Expansion
- Fruitville Library Restroom Renovation
- Caspersen Beach Pavilion
- South Lido Beach Pavilion
- Manasota Beach Pavilion
- Siesta Key Beach Pavilions
- Dearborn Bandshell
- Snook Haven ADA Bathroom Upgrade
- Bee Ridge Household Hazardous Waste Facility
- Venice Public Library
- North Jetty Beach Pavilion
- Fruitville Park Play Ball Pavilion
- Blind Pass Park
- Venice Police Department Renovation



CITY OF VENICE

- Venice Fire Station #1 and City Hall Expansion

CHARLOTTE COUNTY

- Charlotte County Justice Center

H. ADDITIONAL INFORMATION

30. PROVIDE ANY ADDITIONAL INFORMATION REQUESTED BY THE AGENCY. ATTACH ADDITIONAL SHEETS AS NEEDED.

SELECTED LIST OF AWARDS

2021

- Excellence in Construction Award: Eagle Award - Charlotte County Justice Center Renovation
- Excellence in Construction Award: Eagle Award - City of Cape Coral Fire Station #2

2020

- Gulf Coast Chapter AIA Award of Excellence for New Work | Merit Award of Excellence: Brentwood Elementary Addition and Renovation
- Gulf Coast Chapter AIA Award of Excellence for Unbuilt Work | Merit Award of Excellence: The Bay Park Project
- Project of the Year (Structures \$5m - \$25m category) for the Florida Chapter of the American Public Works Association (APWA) - William H. Jervy, Jr., Venice Public Library

2019

- AIA Florida Design Awards - Award of Excellence for New Work | Honor Award of Excellence - Alfred R. Goldstein Library, Ringling College of Art + Design with Shepley Bulfinch
- AIA Florida Design Awards - Award of Excellence for Historic Preservation & Restoration | Honor Award of Excellence - BOTA Center with Hive Architects

2018

- **AIA Florida Firm of the Year**
- Gulf Coast Chapter - AIA Award of Excellence for Architecture for Sustainable Design: Sarasota County Fire Stations #12, #14, #16, #17
- Gulf Coast Chapter - AIA Award of Merit for Architecture for New Work - Commercial and Public: Siesta Key New Public Pavilion: East Concessions
- Gulf Coast Chapter - AIA Award of Merit for Architecture for New Work - Commercial and Public: Fruitville Elementary School Classroom Addition
- Gulf Coast Chapter - AIA Award of Honor for New Work - Alfred R. Goldstein Library, Ringling College of Art and Design (in association with Shepley Bulfinch)
- ALA / IIDA Library Interior Design Award - Alfred R. Goldstein Library, Ringling College of Art and Design (in association with Shepley Bulfinch)
- Florida West Coast Branch American Public Works Association - Project of the Year for structures under \$5 million - Buildings and Grounds for Largo Fire Station #43
- American Public Works Association - Projects of the Year Award for structures \$5-\$25 million - Sarasota County Fire Stations #12, #14, #16, #17

2017

- SRQ Magazine Best of the Year: Alfred R. Goldstein Library, Ringling College of Art and Design (in association with Shepley Bulfinch)
- Florida Association of AIA: Merit Award for the Use of Masonry in Design for the Fruitville Elementary School Building Addition
- Brick in Architecture (BIA) Awards: K-12 education category, Best in Class, Fruitville Elementary School Building Addition

2016

- La Architettura Biennale di Venezia: Venice, Italy: Exhibitor
- Florida Association of AIA: Honor Award of Excellence for Renovations / Additions for the Siesta Key Beach Pavilion
- Gulf Coast Chapter - AIA Award of Excellence for Architecture for New Commercial and Public Work: Siesta Key Picnic Shelters
- Gulf Coast Chapter - AIA Award of Merit for Architecture for Unbuilt Work: Ringling College of Art and Design Visual Art Center
- Gulf Coast Chapter - AIA Award of Merit for Architecture for Historic Preservation and Restoration: Siesta Key Beach Pavilion

2015

- Florida Association of AIA: Merit Award for an Object for the Siesta Key Beach Pavilion's Picnic Shelter
- Florida Association of AIA: Honor Award of Merit for New Work for Fruitville Park's Play Ball Pavilion

I. AUTHORIZED REPRESENTATIVE

The foregoing is a statement of facts.

31. SIGNATURE

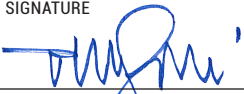

32. DATE

9/01/2022

33. NAME AND TITLE

Todd M. Sweet, AIA, LEED AP - Principal



SWEETSPARKMAN
ARCHITECTURE & INTERIORS



TAB 9

CITY REQUIRED FORMS

REQUIREMENTS AND METHOD OF SUBMITTAL

TAB 9 - CITY REQUIRED FORMS – This checklist is provided to assist each Proposer in the preparation of their response. Included in this *checklist* are important requirements, which is the responsibility of each Proposer to submit with their response in order to make their response fully compliant. It is the responsibility of each Proposer to read and comply with the solicitation in its entirety.

A. REQUIRED SUBMITTAL FORMS: Provide fully executed forms.

- ATTACHMENT 1:** Proposal Submittal Signature Form
- ATTACHMENT 2:** Statement of Organization
- ATTACHMENT 3:** References – Consultant is to contact the references and advise his/her references that the City will be sending an e-mail and reference form which needs to be completed and e-mailed back to the City in a timely fashion.
- ATTACHMENT 4:** Drug-Free Workplace
- ATTACHMENT 5:** Public Entity Crime Information
- ATTACHMENT 6:** Non-Collusive Affidavit
- ATTACHMENT 7:** Lobbying Certification
- ATTACHMENT 8:** Conflict of Interest Form
- ATTACHMENT 9:** Disclosure Form (Consultant/Engineer/Architect)
- ATTACHMENT 10:** Scrutinized Company Certificate
- ATTACHMENT 11:** Vendor’s Certification For E-Verify System

SAMPLE INSURANCE CERTIFICATE: Demonstrate your firm’s ability to comply with insurance requirements. Provide a previous certificate or other evidence listing the Insurance Companies names for both Professional Liability and General Liability and the dollar amounts of the coverage.

MBE/WBE/VBE: If claiming either Minority Business Enterprise/Women Business Enterprises/Veteran Business Enterprise, the Prime Firm (not sub-consultant) **shall be** certified as a Minority Business Enterprise by the State of Florida, Department of Management Services, Office of Supplier Diversity pursuant to Section 287.0943, Florida Statutes.

YES, CLAIMING STATUS AS PRIME ONLY

YES, I’VE ATTACHED THE CERTIFICATE OF MBE/WBE STATUS FROM THE STATE OF FLORIDA AS OUTLINED SECTION 1.

NOT CLAIMING MBE/WBE /VBE

PLEASE INITIAL AND RETURN WITH YOUR PROPOSAL.

THIS PAGE MUST BE COMPLETED AND SUBMITT

INITIALS

ATTACHMENT 1
PROPOSAL SUBMITTAL SIGNATURE FORM

The undersigned attests to his/her authority to submit this proposal and to bind the firm herein named to perform as per Agreement, if the firm is awarded the Agreement by the City.

The undersigned further certifies that he/she has read the Request for Proposal, Terms and Conditions, Insurance Requirements and any other documentation relating to this request and this proposal is submitted with full knowledge and understanding of the requirements and time constraints noted herein.

As addenda are considered binding as if contained in the original specifications, it is critical that the firm acknowledge receipt of same. The submittal may be considered void if receipt of an addendum is not acknowledged.

Addendum No. 1 Dated 8/26/22 Addendum No. _____ Dated _____
Addendum No. _____ Dated _____ Addendum No. _____ Dated _____
Addendum No. _____ Dated _____ Addendum No. _____ Dated _____

Company Name Sweet Sparkman Architecture and Interiors

941-952-0084 Telephone # tsweet@sweetsparkman.com E-Mail N/A Fax #

1819 Main Street, Suite 400
Main Office Address

Sarasota City FL State 34236 Zip Code

Address of Office Servicing City of North Port, if different than above: X SAME AS ABOVE

Office Address

City State Zip Code

Telephone # E-mail Fax #

Todd M. Sweet, AIA, LEED AP - Principal
Name & Title of Firm Representative

 Signature September 1, 2022 Date

Do you accept Visa? ___ YES X NO

THIS PAGE MUST BE COMPLETED AND SUBMITTED WITH PROPOSAL

ATTACHMENT 2

STATEMENT OF ORGANIZATION
(Information Sheet for Transactions and Conveyances Corporation Identification)

The following information will be provided to the City of North Port for incorporation in legal documents. It is, therefore, vital all information is accurate and complete. Please be certain all spelling, and capitalization is exactly as registered with the state or federal government.

Name of Respondent: Sweet Sparkman Architects, Inc.

DBA (if any): Sweet Sparkman Architecture and Interiors

Type of Entity (Sole Proprietor, Corporation, LLC, LLP, Partnership, etc.): Corporation

Business Address: 1819 Main Street, Suite 400, Sarasota, FL 34236

Phone: 941-952-0084 Fax: N/A

E-Mail tsweet@sweetsparkman.com

Print Name and Title of person authorized to bind: Todd M. Sweet, AIA, LEED AP

Federal Identification Number: 54-2081005

Signature: [Handwritten Signature]

Respondent shall submit proof that it is authorized to do business in the State of Florida unless registration is not required by law.

(Please Check One)

Is this a Florida Corporation: [X] Yes or ___ No

If not a Florida Corporation,

In what state was it created: _____

Name as spelled in that State: _____

What kind of corporation is it: [X] "For Profit" or ___ "Not for Profit"

Is it in good standing: [X] Yes or ___ No

Authorized to transact business in Florida: [X] Yes or ___ No

State of Florida Department of State Certificate of Authority Document No.: P02000112789

Does it use a registered fictitious name: [X] Yes or ___ No

THIS PAGE MUST BE COMPLETED AND SUBMITTED WITH PROPOSAL.

Names of Officers:

President: Todd M. Sweet, AIA, LEED AP Secretary: _____

Vice President: Jerry Sparkman, AIA, NCARB Treasurer: _____

Director: John Bryant, AIA, LEED AP Director: Michele Demperio

Other: _____ Other: _____

Name of Corporation (As used in Florida):

Sweet Sparkman Architects, Inc.

(Spelled exactly as it is registered with the state or federal government)

Corporate Address:

Post Office Box: N/A

City, State Zip: _____

Street Address: 1819 Main Street, Suite 400

City, State, Zip: Sarasota, FL 34236

STATE OF FLORIDA
COUNTY OF Sarasota

Sworn to (or affirmed) and subscribed before me by means of X physical presence or _____ online notarization, this 1st day of September 2022, by _____.

Michele Demperio

Notary Public – State of Florida

Personally Known X OR Produced Identification _____
Type of Identification Produced _____

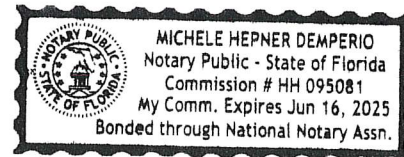

Date: September 1, 2022

Signed (Person authorized to bind the company): _____

Name (printed): Todd M. Sweet, AIA, LEED AP Title: Principal

THIS PAGE MUST BE COMPLETED AND SUBMITTED WITH PROPOSAL.

**ATTACHMENT 4
DRUG FREE WORKPLACE FORM**

The undersigned Consultant in accordance with Florida Statute 287.087 hereby certifies that Sweet Sparkman Architecture and Interiors does:
(Company Name)

1. Publish a statement notifying employees that the unlawful manufacture, distribution, dispensing, possession, or use of a controlled substance is prohibited in the workplace and specifying the actions that will be taken against employees for violations of such prohibition.
2. Inform employees about the dangers of drug abuse in the workplace, the business's policy of maintaining a drug free workplace, any available drug counseling, rehabilitation, and employee assistance programs, and the penalties that may be imposed upon employees for drug abuse violations.
3. Give each employee engaged in providing the commodities or contractual services that are under bid a copy of the statement specified in subsection (1).
4. In the statement specified in subsection (1), notify the employees that, as a condition of working on the commodities or contractual services that are under bid, the employee will abide by the terms of the statement and will notify the employer of any conviction of, or plea of guilty or nolo contendere to, any violation of Chapter 893 or of any controlled substance law of the United States or any state, for a violation occurring in the workplace no later than five (5) days after such conviction.
5. Impose a sanction on, or require the satisfactory participation in a drug abuse assistance or rehabilitation program if such is available in the employee's community, by any employee who is so convicted.
6. Make a good faith effort to continue to maintain a drug free workplace through implementation of this section.

Check one:

- X As the person authorized to sign this statement, I certify that this firm complies fully with above requirements.
- As the person authorized to sign this statement, this firm **does not** comply fully with the above requirements.



Offeror's Signature

September 1, 2022

Date

THIS PAGE MUST BE COMPLETED AND SUBMITTED WITH PROPOSAL

ATTACHMENT 5
PUBLIC ENTITY CRIME INFORMATION

As provided by F.S. §287.133, a person or affiliate who has been placed on the convicted vendor list following a conviction for a public entity crime may not submit a bid on a contract to provide any goods or services to a public entity, may not submit a bid on a contract with a public entity for the construction or repair of a public building or public work, may not submit bids on leases of real property to a public entity, may not be awarded or perform work as a Contractor, Supplier, Subcontractor, or Consultant under a contract with any public entity, and may not transact business with any public entity in excess of the threshold amount provided in Section 287, for CATEGORY TWO for a period of 36 months from the date of being placed on the convicted vendor list.

I, Todd M. Sweet, AIA, LEED AP, being an authorized representative of the Respondent, Sweet Sparkman Architects, Inc., located at 1819 Main Street, Suite 400

City: Sarasota State: FL Zip Code: 34236, have read and understand the contents above. I further certify that Respondent is not disqualified from replying to this solicitation because of F.S. §287.133.

Signature: [Handwritten Signature] Date: 9/01/2022

Telephone #: 941-952-0084 Fax #: N/A

Federal ID #: 54-2081005

STATE OF FLORIDA
COUNTY OF Sarasota

Sworn to (or affirmed) and subscribed before me by means of X physical presence or online notarization, this 1st day of September 2022, by Todd M. Sweet, AIA, LEED AP

[Handwritten Signature]
Notary Public – State of Florida

Personally Known X OR Produced Identification
Type of Identification Produced

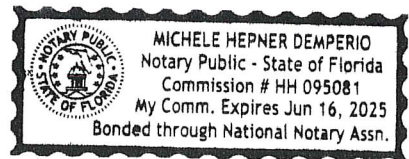

Date: September 1, 2022

Signed (Person authorized to bind the company): [Handwritten Signature]

Name (printed): Todd M. Sweet, AIA, LEED AP Title: Principal

THIS PAGE MUST BE COMPLETED AND SUBMITTED WITH PROPOSAL.

ATTACHMENT 6
NON-COLLUSIVE AFFIDAVIT

State of Florida

County of Sarasota

Before me, the undersigned authority, personally appeared:
Todd M. Sweet, AIA, LEED AP who, being first duly sworn, deposes and says that:

1. He/She is the Partner (Owner, Partner, Officer, Representative or Agent) of Sweet Sparkman Architects, Inc., the Respondent that has submitted the attached reply;
2. He/She is fully informed respecting the preparation and contents of the attached reply and of all pertinent circumstances respecting such reply;
3. Such reply is genuine and is not a collusive or sham reply;
4. Neither the said Respondent nor any of its officers, partners, owners, agents, representatives, employees or parties in interest, including this affiant, have in any way colluded, conspired, connived or agreed, directly or indirectly, with any other respondent, firm, or person to submit a collusive or sham reply in connection with the work for which the attached reply has been submitted; or have in any manner, directly or indirectly sought by agreement or collusion, or communication or conference with any respondent, firm, or person to fix the price or prices in the attached reply or of any other respondent, or to fix any overhead, profit, or cost elements of the reply price or the reply price of any other respondent, or to secure through any collusion, conspiracy, connivance, or unlawful agreement any advantage against (Recipient), or any person interested in the reply work.

Signed, sealed and delivered this 1st day of September, 2022.

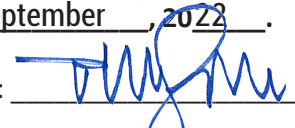
By: 
Todd M. Sweet, AIA, LEED AP
 (Printed Name)
Partner
 (Title)

STATE OF FLORIDA
COUNTY OF Sarasota

Sworn to (or affirmed) and subscribed before me by means of X physical presence or ___ online notarization, this 1st day of September 2022, by Todd M. Sweet, AIA, LEED AP

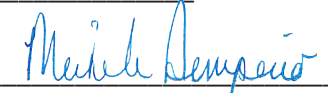
 Notary Public – State of Florida

Personally Known X OR Produced Identification _____
Type of Identification Produced _____

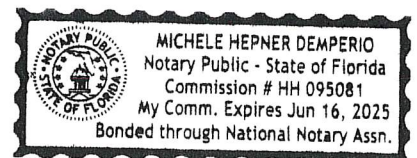

THIS PAGE MUST BE COMPLETED AND SUBMITTED WITH PROPOSAL

ATTACHMENT 7
LOBBYING CERTIFICATION

"The undersigned hereby certifies, to the best of his or her knowledge and belief, that":

STATE OF Florida

COUNTY OF Sarasota

This 1st day of September of 2022

Todd M. Sweet, AIA, LEED AP, being first duly sworn, deposes and says that he or she is the authorized representative of Sweet Sparkman Architects, Inc. (Name of the contractor, firm or individual), and that the vendor and any of its agents agree to have no contact or communication with, or discuss any matter related in any way to any active City of North Port solicitation, with any City of North Port elected officials, officers, their appointees or their agents or any other staff or outside individuals working with the city in respect to this request other than the designated Procurement Official Contact and to abide by the restrictions outlined in the General Terms and Conditions of the Solicitation. Technical questions directed to the project manager, is prohibited. These persons shall not be lobbied, either individually or collectively, regarding any questions for bid, proposal, qualification and/or any other solicitations released by the city. To do so is grounds for immediate disqualification from the selection process. The selection process is not considered final until such a time as the Commission has made a final and conclusive determination.

(a) No City appropriated funds have been paid or will be paid, by or on behalf of the undersigned, to any person for influencing or attempting to influence either directly or indirectly an officer or employee of the City, City Commission in connection with the awarding of any City Contract.

(b) If any funds other than City appropriated funds have been paid or will be paid to any person for influencing or attempting to influence a member of City Commission or an officer or employee of the City in connection with this contract, the undersigned shall complete and submit Standard Form-L "Disclosure Form to Report Lobbying", in accordance with its instructions.

Signed, sealed and delivered this 1st day of September, 2022

Partner

By:

[Handwritten signature]

Todd M. Sweet, AIA, LEED AP

(Printed Name)

Partner

(Title)

STATE OF FLORIDA
COUNTY OF Sarasota

Sworn to (or affirmed) and subscribed before me by means of X physical presence or online notarization, this 1st day of September 2022, by Todd M. Sweet, AIA, LEED AP

[Handwritten signature]

Notary Public - State of Florida

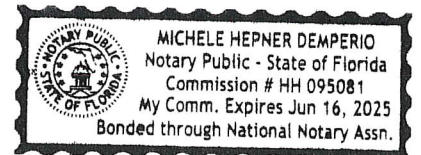

Personally Known X OR Produced Identification
Type of Identification Produced

THIS PAGE MUST BE COMPLETED AND SUBMITTED WITH PROPOSAL

**ATTACHMENT 8
CONFLICT OF INTEREST FORM**

F.S. §112.313 places limitations on public officers (including advisory board members) and employees' ability to contract with the City either directly or indirectly. Therefore, please indicate if the following applies:

PART I.

I am an employee, public officer or advisory board member of the City
_____ (List Position Or Board)

I am the spouse or child of an employee, public officer or advisory board member of the City
Name: _____

An employee, public officer or advisory board member of the City, or their spouse or child, is an officer, partner, director, or proprietor of Respondent or has a material interest in Respondent. "Material interest" means direct or indirect ownership of more than 5 percent of the total assets or capital stock of any business entity. For the purposes of [§112.313], indirect ownership does not include ownership by a spouse or minor child.
Name: _____

Respondent employs or contracts with an employee, public officer or advisory board member of the City
Name: _____

None Of The Above

PART II:

Are you going to request an advisory board member waiver?

I will request an advisory board member waiver under §112.313(12)

I will NOT request an advisory board member waiver under §112.313(12)

N/A

The City shall review any relationships which may be prohibited under the Florida Ethics Code and will disqualify any vendors whose conflicts are not waived or exempt.

BUSINESS NAME: Sweet Sparkman Architects, Inc.

NAME (PERSON AUTHORIZED TO BIND THE COMPANY): Todd M. Sweet, AIA, LEED AP

SIGNATURE:  DATE: September 1, 2022

THIS PAGE MUST BE COMPLETED AND SUBMITTED WITH PROPOSAL

ATTACHMENT 9
DISCLOSURE FORM FOR
CONSULTANT/ENGINEER/ARCHITECT

Please select (only) one of the following three options:

Our firm has no actual, potential, or reasonably perceived, **financial*** or **other interest**** in the outcome of the project.

Our firm has a potential or reasonably perceived **financial*** or **other interest**** in the outcome of the project as described here: _____.

Our firm proposes to mitigate the potential or perceived conflict according to the following plan:
_____.

Our firm has an actual **financial*** or **other interest**** in the outcome of the project as described here:
_____.

***What does "financial interest" mean?**

If your firm, or employee of your firm working on the project (or a member of the employee's household), will/may be perceived to receive or lose private income depending on the government business choices based on your firm's findings and recommendations, this must be listed as a financial interest. An example would be ownership in physical assets affected by the government business choices related to this project. The possibility of contracting for further consulting services is not included in this definition and is not prohibited.

****What does "other interest" mean?**

If your firm, or employee of your firm working on the project (or a member of the employee's household), will/may be perceived to have political, legal or any other interests that will affect what goes into your firm's findings and recommendations, or will be/may be perceived to be affected by the government business choices related to this project, this must be listed as another interest.

BUSINESS NAME: Sweet Sparkman Architects, Inc.

NAME (PERSON AUTHORIZED TO BIND THE COMPANY): Todd M. Sweet, AIA, LEED AP

SIGNATURE:  **DATE:** September 1, 2022

THIS PAGE MUST BE COMPLETED AND SUBMITTED WITH PROPOSAL

ATTACHMENT 10
Scrutinized Company Certification Form

Company Name: Sweet Sparkman Architects, Inc.

Authorized Representative Name and Title: Todd M. Sweet, AIA, LEED AP - Principal

Address: 1819 Main Street, Suite 400 City: Sarasota State: FL ZIP: 34236

Phone Number: 941-952-0084 Email Address: tsweet@sweetsparkman.com

A company is ineligible to, and may not, bid on, submit a proposal for, or enter into or renew a contract with the City of North Port for goods or services of any amount if, at the time of bidding on, submitting a proposal for, or entering into or renewing such contract, the company is on the Scrutinized Companies that Boycott Israel List, created pursuant to Florida Statutes, section 215.4725, or is engaged in a boycott of Israel.

A company is ineligible to, and may not, bid on, submit a proposal for, or enter into or renew a contract with the City of North Port for goods or services of \$1 million or more if, at the time of bidding on, submitting a proposal for, or entering into or renewing such contract, the company is on the Scrutinized Companies with Activities in Sudan List, the Scrutinized Companies with Activities in the Iran Petroleum Energy Sector List, created pursuant to Florida Statutes, section 215.473, or with companies engaged in business operations in Cuba or Syria.

CHOOSE ONE OF THE FOLLOWING

This bid, proposal, contract or contract renewal is for goods or services of less than \$1 million. As the person authorized to sign on behalf of the above-named company, and as required by Florida Statutes, section 287.135(5), I hereby certify that the above-named company is not participating in a boycott of Israel.

This bid, proposal, contract or contract renewal is for goods or services of \$1 million or more. As the person authorized to sign on behalf of the above-named company, and as required by Florida Statutes, section 287.135(5), I hereby certify that the above-named company is not participating in a boycott of Israel, is not on the Scrutinized Companies with Activities in Sudan List or the Scrutinized Companies with Activities in the Iran Petroleum Energy Sector List, and it does not have business operations in Cuba or Syria.

I understand that pursuant to Florida Statutes, section 287.135, the submission of a false certification may result in the termination of the contract if one is entered into, and may subject the above-named company to civil penalties, attorney's fees and costs.

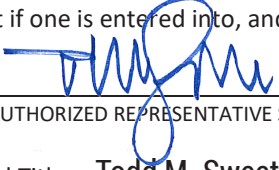
Certified By: 
AUTHORIZED REPRESENTATIVE SIGNATURE

Print Name and Title: Todd M. Sweet, AIA, LEED AP

Date Certified: September 1, 2022

Solicitation/Contract/PO Number (Completed by Purchasing): 2022-28

THIS PAGE MUST BE COMPLETED AND SUBMITTED WITH PROPOSAL.

ATTACHMENT 11
VENDOR'S CERTIFICATION FOR E-VERIFY SYSTEM

STATE OF Florida
COUNTY OF Sarasota

The undersigned Vendor/Consultant/Contractor (Vendor), after being duly sworn, states the following:

- 1. Vendor is a person or entity that has entered into or is attempting to enter into a contract with the City of North Port (City) to provide labor, supplies, or services to the City in exchange for salary, wages or other remuneration.
2. Vendor has registered with and will use the E-Verify System of the United States Department of Homeland Security to verify the employment eligibility of:
a. All persons newly hired by the Vendor to perform employment duties within Florida during the term of the contract; and
b. All persons, including sub-contractors, sub-vendors or sub-consultants, assigned by the Vendor to perform work pursuant to the contract with the City.
3. If the Vendor becomes the successful Contractor who enters into a contract with the City, then the Vendor will comply with the requirements of Section 448.095, Fla. Stat. "Employment Eligibility", as amended from time to time.
4. Vendor will obtain an affidavit from all subcontractors attesting that the subcontractor does not employ, contract with, or subcontract with, an unauthorized alien as defined in 8 United States Code, Section 1324A(H)(3).
5. Vendor will maintain the original affidavit of all subcontractors for the duration of the contract.
6. Vendor affirms that failure to comply with the state law requirements can result in the City's termination of the contract and other penalties as provided by law.

VENDOR: Sweet Sparkman Architects, Inc. (Vendor's Company Name)

[Signature] (Vendor signature)
Todd M. Sweet, AIA, LEED AP (Vendor's name printed)
Partner (Title)

Sarasota

Sworn to and subscribed before me by means of X physical presence or ___online notarization, this 1st day of September, 2022, by Todd M. Sweet, AIA, LEED AP, as Partner

[Signature]
Notary Public

Personally Known X OR Produced Identification ___
Type of Identification Produced ___

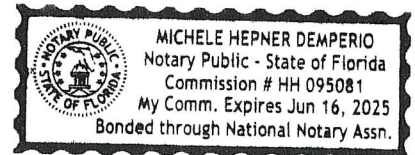

THIS PAGE MUST BE COMPLETED AND SUBMITTED WITH PROPOSAL

END OF PART IV

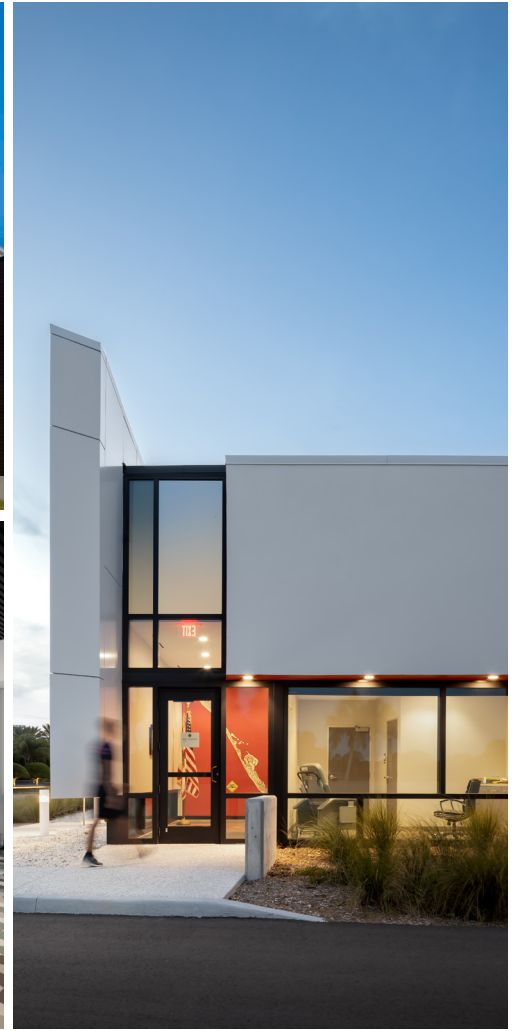

THANK YOU!

SWEETSPARKMAN
ARCHITECTURE & INTERIORS

TODD M. SWEET, AIA, LEED AP
1819 MAIN STREET, SUITE 400, SARASOTA, FL 34236
941.952.0084 | TSWEET@SWEETSPARKMAN.COM