

**Request for Proposal
RFP NO. 2020-58**

**Professional
Engineering Services
Continuing Services Contract
for
City of North Port Utilities**

Submitted to:

**Ginny Duyn, CPPB
Senior Purchasing Administrator**

City of North Port
4970 City Hall Boulevard, Suite 337
North Port, Florida 34286

Submitted by:

Giffels-Webster Engineers, Inc.

900 Pine Street, Suite 225
Englewood, Florida 34223

Ph. 941-475-7981

Fax. 941-474-4285

Contact: Jonathan H. Cole, P.E.

Email: jcole@gwefl.com

Cell: 941-270-2493

July 20, 2020

GWE: 2020.34

**CITY OF NORTH PORT - RFP NO. 2020-58
PROFESSIONAL ENGINEERING SERVICES-CONTINUING SERVICES CONTRACT FOR
CITY OF NORTH PORT UTILITIES DEPARTMENT**

TABLE OF CONTENTS

TAB 1. TRANSMITTAL LETTER..... Page 1-2

TAB 2. QUALIFICATIONS OF THE FIRM..... Pages 3-7

TAB 3. KEY PERSONNEL/QUALIFICATIONS OF THE PROJECT TEAM..... Pages 8-16

TAB 4. TEAM’S PREVIOUS EXPERIENCE/PROFICIENCY IN SIMILAR PROJECTS..... Pages 17-20

TAB 5. MANAGEMENT APPROACH/PROJECT CONTROL..... Pages 21-23

TAB 6. REFERENCES..... Pages 24-27

TAB 7. LITIGATION AND INSURANCE..... Page 28

TAB 8. ADDITIONAL INFORMATION..... Pages 29-31

TAB 9. SUBMISSION REQUIREMENTS AND REQUIRED SUBMITTAL FORMS

TAB 1

TRANSMITTAL LETTER

July 20, 2020

REF: 2020.34

City of North Port
Ginny Duyn, CPPB, Sr. Purchasing Administrator
4970 City Hall Boulevard, Suite 337
North Port, FL 34286

**RE: RFP NO. 2020-58 - PROFESSIONAL ENGINEERING SERVICES – CONTINUING SERVICES
CONTRACTS FOR CITY OF NORTH PORT UTILITIES DEPARTMENT**

Dear Ms. Duyn:

Giffels-Webster Engineers, Inc. (GWE) is most interested in contracting with the City of North Port for Professional Engineering Services as a qualified consultant to the City's Utilities Department. We believe we have the requisite experience and are requesting acceptance in the following two categories:

Category 2 – Water, Wastewater, and Reclaimed Water Conveyance Systems.

Category 3 – Water, Wastewater, and Reclaimed Water Planning.

Giffels-Webster has been in business for over 30 years in Englewood, focusing on utility planning and design. From large scale master planning, the design of septic to sewer expansion projects to the planning and design of individual water and sewer mains, GWE has done it all when it comes to utility planning and design.

Our public utility clients include the Englewood Water District, Sarasota County, Charlotte County, Martin County, the City of Port St Lucie as well as the City of North Port. Many of our key staff has been with GWE for decades, providing seasoned utility planning and design experience.

We are familiar with the City's procedures, as we have completed projects for the City of North Port in the past. We have the staff available to commit to your projects in order to complete it in a timely and cost effective manner.

As reflected throughout our submittal package, GWE has the experience necessary for the required services that will provide the City with an engineering partner in this process from beginning to successful completion.

In addition to the specific experience, the close proximity and the resources to respond, GWE has a history of "going the extra mile" to get the job done right, on time and without claims for extras.

As called for in the RFP, this is to confirm that I, as an authorized officer of Giffels-Webster, am allowed to make representations on behalf of the firm.

The following information is being provided to support this information:

Jonathan H. Cole, President
900 Pine Street, Suite 225, Englewood, Florida 34223
Phone: 941-475-7981 Fax: 941-474-4285

I certify that this proposal was made without collusion with any other person or entity submitting a proposal. Additionally, I certify that compliance with all insurance requirements will be adhered to and GWE maintains all necessary state licenses to perform engineering services, and the applicable County occupancy licenses.

I believe our Project Team can offer the services the City of North Port desires and we welcome the opportunity to provide the services necessary to complete any utility project issued under the above two categories.

Per the RFP, we are enclosing one (1) original hard-copy UNBOUND, marked "ORIGINAL", signed in blue ink; five (5) hard-copies BOUND, marked "COPY"; and one USB Flash Drive in PDF format containing the entire submittal.

Sincerely,

GIFFELS-WEBSTER ENGINEERS, INC.



Jonathan H. Cole, P.E., President

JHC:Imb
Enclosures

TAB 2

QUALIFICATIONS OF THE FIRM

**CITY OF NORTH PORT - RFP NO. 2020-58
PROFESSIONAL ENGINEERING SERVICES-CONTINUING SERVICES CONTRACT FOR
CITY OF NORTH PORT UTILITIES DEPARTMENT**

TAB 2: QUALIFICATIONS OF THE FIRM

Giffels-Webster Engineers, Inc. (GWE) has operated a successful engineering business serving municipalities and utility providers throughout the state of Florida for over 30 years. GWE provides civil engineering, focusing on *utility projects* from the initial concept and master planning, to the final design including financial assistance and construction management (CEI) services. We bring vast experience and a solid working knowledge of city, county, state and federal requirements as it relates to utility projects.

GWE's 5,000 plus square foot home office is located at 900 Pine Street, Suite 225, Englewood, Florida, within a 20 minute travel time to the City offices.

The following information summarizes pertinent information on the corporation and individual registered and/or certified staff:

Corporate Name/Address:

Giffels-Webster Engineers, Inc.
900 Pine Street, Suite 225
Englewood, FL 34223
Phone: 941-475-7981
Fax: 941-474-4285
President: Jonathan H. Cole, P.E.
E-mail: jcole@gwefl.com



GWE has been authorized to do business in the State of Florida since 1982.

Registered as a Florida "C" Corporation:	September 9, 1987
Florida Secretary of State's Charter Number:	J91612
FEIN No:	38-2749086
Current number of Employees:	10

The utility design staff are well qualified to conduct engineering feasibility studies; develop design alternatives; prepare final plans and specifications, costs estimates, bid documents, contract documents, permit applications; coordinate other (non-City) utility system adjustments; and provide CEI (Construction Engineering and Inspection) services for construction.

GWE is qualified to assist with Public input/involvement for assessment hearings, oversee all project design phases, sign and seal plans for submission to the City, FDOT and jurisdictional permitting agencies; develop project specific public involvement programs, design M.O.T. plans and have in-house certified Traffic Control Supervisors and Work Zone Traffic Control (Advanced) staff.

GWE has been providing the planning and design of large scale *utility* projects (water, sewer and reuse line installations) throughout the state of Florida over the past two decades. We have also been retained as an expert witness for several utility cases. Some specific larger examples of the Firms Capabilities and Qualifications are highlighted below.

GWE designed nine (9) large utility expansion areas for the **Englewood Water District** in Englewood, serving over 9,000 customers in residential and commercial areas.

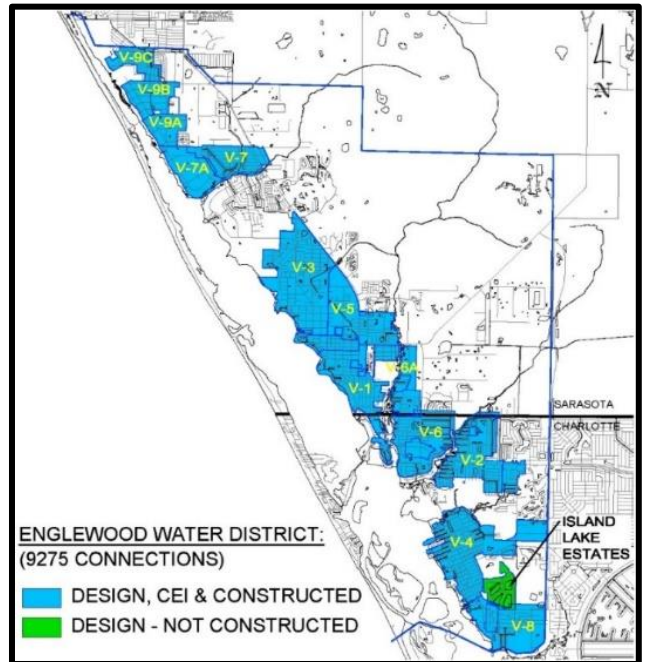
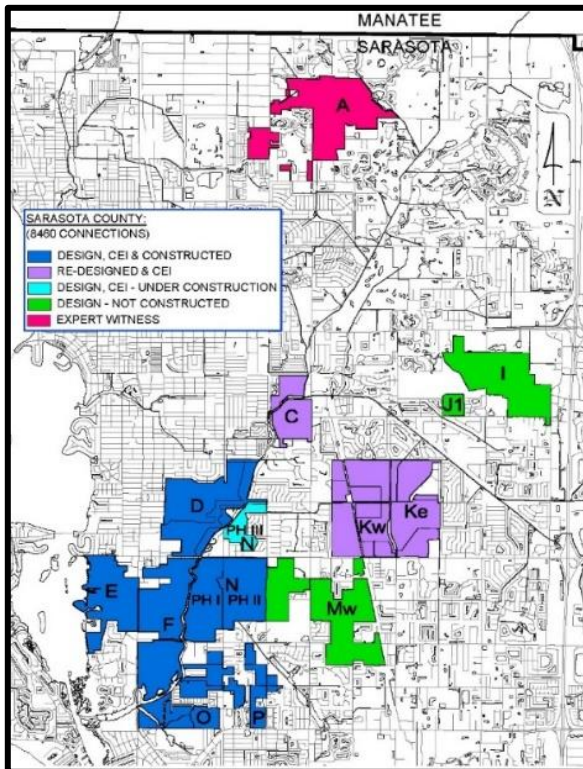

The same GWE personnel also designed and managed much of the large Phillippi Creek Septic System Replacement Program, which was a utility expansion project in **Sarasota County**. The sum total of all served by those projects were over 8,400 connections.

Similarly, GWE designed many pipelines for **Charlotte County**, including some of the largest expansion programs, serving almost 2,500 customers at the East/West Spring Lake subdivision, which is operational.

In addition, the Wastewater Expansion Project Phase II known as Ackerman Countryman, which is in the final design phase, will serve about 2,000 customers.

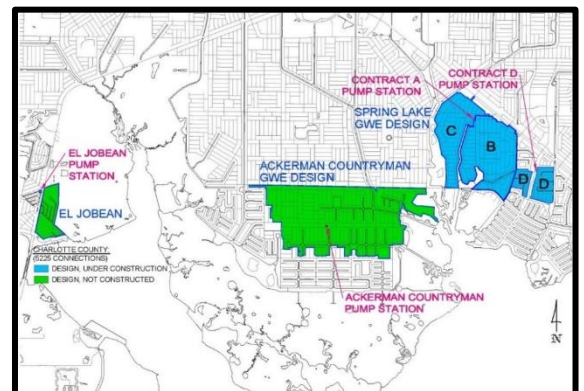

We also designed several utility expansion projects for **Martin County** on the east coast of Florida that will serve over 3,250 connections when complete.

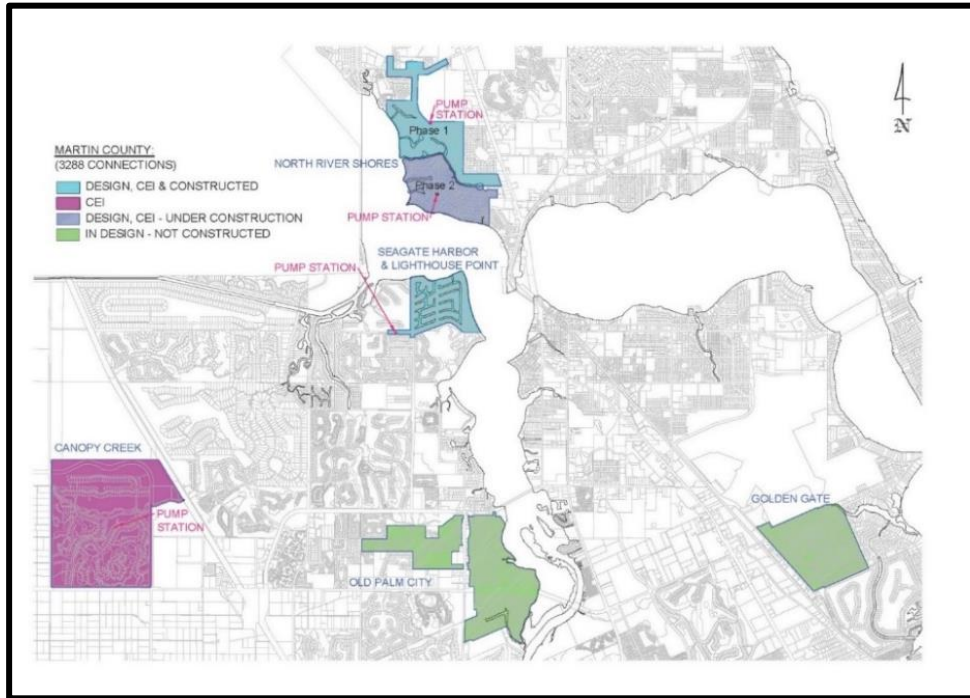

Additional details of some of the projects that GWE staff designed in the last 10 years is elaborated on in Tab 4, Previous Experience.

The SF 330 forms PART 1 A, B and C as well as PART II for GWE as well as our primary sub consultant RWA follows.

RICK SCOTT, GOVERNOR JONATHAN ZACHEM, SECRETARY Florida dbpr

STATE OF FLORIDA
DEPARTMENT OF BUSINESS AND PROFESSIONAL REGULATION
BOARD OF PROFESSIONAL ENGINEERS
THE ENGINEERING PROFESSION IS LICENSED UNDER THE
PROVISIONS OF CHAPTER 474, FLORIDA STATUTES
GIFRELS-WEBSTER ENGINEERS, INC.

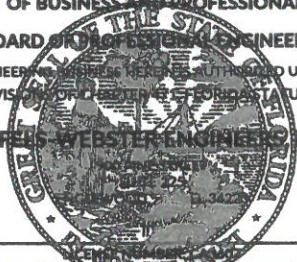

EXPIRATION DATE: FEBRUARY 28, 2021
Always verify licenses online at MyFloridaLicense.com



Do not alter this document in any form.
This is your license. It is unlawful for anyone other than the licensee to use this document.

RICK SCOTT, GOVERNOR JONATHAN ZACHEM, SECRETARY Florida dbpr

STATE OF FLORIDA
DEPARTMENT OF BUSINESS AND PROFESSIONAL REGULATION
BOARD OF PROFESSIONAL ENGINEERS
THE PROFESSIONAL ENGINEERS ARE LICENSED UNDER THE
PROVISIONS OF CHAPTER 474, FLORIDA STATUTES
GOLF JONATHAN B.



EXPIRATION DATE: FEBRUARY 28, 2021
Always verify licenses online at MyFloridaLicense.com



Do not alter this document in any form.
This is your license. It is unlawful for anyone other than the licensee to use this document.

RICK SCOTT, GOVERNOR JONATHAN ZACHEM, SECRETARY Florida dbpr

STATE OF FLORIDA
DEPARTMENT OF BUSINESS AND PROFESSIONAL REGULATION
BOARD OF PROFESSIONAL ENGINEERS
THE PROFESSIONAL ENGINEERS ARE LICENSED UNDER THE
PROVISIONS OF CHAPTER 474, FLORIDA STATUTES
FRYMAN BENNIS, P.A.

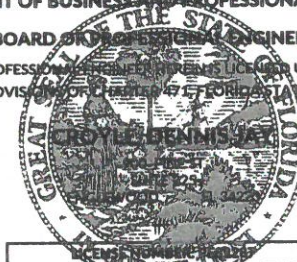

EXPIRATION DATE: FEBRUARY 28, 2021
Always verify licenses online at MyFloridaLicense.com



Do not alter this document in any form.
This is your license. It is unlawful for anyone other than the licensee to use this document.

RICK SCOTT, GOVERNOR JONATHAN ZACHEM, SECRETARY Florida dbpr

STATE OF FLORIDA
DEPARTMENT OF BUSINESS AND PROFESSIONAL REGULATION
BOARD OF PROFESSIONAL ENGINEERS
THE PROFESSIONAL ENGINEERS ARE LICENSED UNDER THE
PROVISIONS OF CHAPTER 474, FLORIDA STATUTES
KIMBERLY ANN BROWN

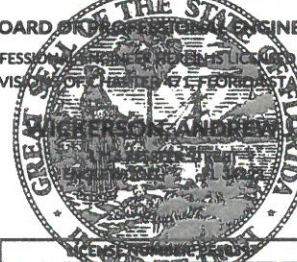

EXPIRATION DATE: FEBRUARY 28, 2021
Always verify licenses online at MyFloridaLicense.com



Do not alter this document in any form.
This is your license. It is unlawful for anyone other than the licensee to use this document.

**2018 / 2019 CHARLOTTE COUNTY
LOCAL BUSINESS TAX RECEIPT**

MUST BE DISPLAYED IN A CONSPICUOUS PLACE

ACCOUNT 2232
EXPIRES SEPTEMBER 30, 2019
RENEWAL

TYPE OF BUSINESS 648 ENGINEERING SERVICES (ENGINEERING SERVICES)

BUSINESS 900 PINE ST
ADDRESS ENGLEWOOD, FL 34223

BUSINESS GIFFELS WEBSTER ENGINEERS INC
NAME

OWNER GIFFELS WEBSTER ENGINEERS INC

MAILING 900 PINE STREET UNIT 225
ADDRESS ENGLEWOOD, FL 34223

AMOUNT 35.00
PENALTY 0.00
TOTAL 35.00

THIS FORM BECOMES A RECEIPT ONLY WHEN VALIDATED

Paid 07/05/2018 Receipt # INT-00031780 35.00

**2018 / 2019 CHARLOTTE COUNTY
LOCAL BUSINESS TAX RECEIPT**

MUST BE DISPLAYED IN A CONSPICUOUS PLACE

ACCOUNT 2232
EXPIRES SEPTEMBER 30, 2019
RENEWAL

TYPE OF BUSINESS 648 ENGINEERING SERVICES (ENGINEERING SERVICES)

BUSINESS 900 PINE ST
ADDRESS ENGLEWOOD, FL 34223

BUSINESS GIFFELS WEBSTER ENGINEERS INC
NAME

OWNER GIFFELS WEBSTER ENGINEERS INC

MAILING 900 PINE STREET UNIT 225
ADDRESS ENGLEWOOD, FL 34223

AMOUNT 35.00
PENALTY 0.00
TOTAL 35.00

THIS FORM BECOMES A RECEIPT ONLY WHEN VALIDATED

Paid 07/05/2018 Receipt # INT-00031780 35.00

Dear Business Owner:

Your 2018 - 2019 Charlotte County Local Business Tax Receipt is attached above. Please detach the receipt and display it in a place that is visible to the public and available for inspection.

The Charlotte County Local Business Tax Receipt is in addition to any other license or certificate that may be required by law and does not signify compliance with zoning, health, or regulatory requirements. The Charlotte County Local Business Tax Receipt is non-regulatory and is not an endorsement of work quality.

Your 2018 - 2019 Local Business Tax Receipt is valid from October 01, 2018 through September 30, 2019. Annual account notices are mailed in June to the address of record at that time. Any Changes to your Local Business Tax Account due to change of Business Name, Ownership, Physical Address or you are Closing your Business please contact our office at 941-743-1350.

VICKIE L. POTTS

Charlotte County Tax Collector

ARCHITECT - ENGINEER QUALIFICATIONS

PART I - CONTRACT-SPECIFIC QUALIFICATIONS

A. CONTRACT INFORMATION

1. TITLE AND LOCATION *(City and State)*

2. PUBLIC NOTICE DATE

3. SOLICITATION OR PROJECT NUMBER

B. ARCHITECT-ENGINEER POINT OF CONTACT

4. NAME AND TITLE

5. NAME OF FIRM

6. TELEPHONE NUMBER

7. FAX NUMBER

8. E-MAIL ADDRESS

C. PROPOSED TEAM

(Complete this section for the prime contractor and all key subcontractors.)

	(Check)			9. FIRM NAME	10. ADDRESS	11. ROLE IN THIS CONTRACT
	PRIME	J-V PARTNER	SUBCONTRACTOR			
a.				<input type="checkbox"/> CHECK IF BRANCH OFFICE		
b.				<input type="checkbox"/> CHECK IF BRANCH OFFICE		
c.				<input type="checkbox"/> CHECK IF BRANCH OFFICE		
d.				<input type="checkbox"/> CHECK IF BRANCH OFFICE		
e.				<input type="checkbox"/> CHECK IF BRANCH OFFICE		
f.				<input type="checkbox"/> CHECK IF BRANCH OFFICE		

D. ORGANIZATIONAL CHART OF PROPOSED TEAM

(Attached)

TAB 3

**KEY PERSONNEL/QUALIFICATIONS
OF THE PROJECT TEAM**

**CITY OF NORTH PORT - RFP NO. 2020-58
PROFESSIONAL ENGINEERING SERVICES-CONTINUING SERVICES CONTRACT FOR
CITY OF NORTH PORT UTILITIES DEPARTMENT**

TAB 3: KEY PERSONNEL/QUALIFICATIONS OF THE PROJECT TEAM

Our key staff at GIFFELS-WEBSTER ENGINEERS, INC. (GWE) will provide the pipeline design (Category 2) as well as the Master planning efforts (Category 3). Our primary sub consultant for surveying services is RWA, Inc. (RWA). GWE specializes in providing large-scale master planning and the design of utility systems in highly developed areas for cities and counties throughout the state for over the last two decades. With the large utility expansion projects we designed for the Englewood Water District and Sarasota County now complete, our seasoned team of utility design and management experts are immediately available to assist the City of North Port with your projects.

The Principal-in-Charge will be **Mr. Jonathan H. Cole, P.E.**; he has over 30 years of municipal design experience of large septic to sewer projects throughout Florida.

Mr. Cole is a Professional Engineer registered in the States of Florida, Connecticut, New Hampshire, Kansas and Nebraska. He graduated from the University of Connecticut in 1979 with a Bachelor of Science (B.S.) Degree in Civil Engineering and was formerly the County Engineer of Charlotte County, Florida. Mr. Cole is President of Giffels-Webster Engineers, Inc., a Florida corporation.

He offers specialized knowledge, experience and proven ability in:

- Master planning and Design/contract administration for large-scale utility projects. Public Involvement for projects
- Utility infrastructure design/FDOT utility JPA plans for utility replacement for road widening projects
- Engineering design of water systems; sewer collection, transmission, reclaimed water systems
- SRF financial support for large scale utility projects
- Expert witness for private or municipal civil, utility system, and construction projects

Mr. Cole has been the Principal-in-Charge on all the utility projects summarized in the following chart:

Project Name / System Type	Program Management	Pump Station Design	Survey and Design Services	Permitting	Public Hearings	Bid Invoicement Program	Construction Services / Inspection	Customer Assistance	Small (<150 ERCs)	Medium (150-400 ERCs)	Large (400-1000 ERCs)	Over 1000 ERCs	Project Type	Project Status
EWD Centralized Sewer Master Plan - Sewer	G	G	G	G	G	G	G	G	*	*	*	*	I	*
EWD Unit V-1 WW Expansion - Sewer & Water	G	G	G	G	G	G	G	G		X			R	O
EWD Unit V-2 WW Expansion - Sewer & Water	G	G	G	G	G	G	G	G			X		R	O
EWD Unit V-3 / V-5 WW Expansion - Sewer & Water	G	G	G	G	G	G	G	G		X			R	O
EWD Unit V-4 / V-8 WW Expansion - Sewer & Water	G	G	G	G	G	G	G	G		X			R	O
EWD Unit V-6 WW Expansion - Sewer & Water	G	G	G	G	G	G	G	G		X			R	O
EWD Unit V-7 / V-9 WW Expansion - Sewer & Water	G	G	G	G	G	G	G	G		X			R	O
EWD V9-A WW Expansion - Sewer	G	G	G	G	G	G	G	G	X				R	O
EWD V9-B WW Expansion - Sewer	G	G	G	G	G	G	G	G	X				R	O
EWD V9-C WW Expansion - Sewer & Water	G	G	G	G	G	G	G	G	X				R	O
Philippi Creek SSRP Area C - Sewer & Water - Sarasota County Utilities	B	B	B	B	B	B	B	B			X		R	O
Philippi Creek SSRP Area D - Sewer & Water - Sarasota County Utilities	B	B	B	B	B	B	B	B		X			R	O
Philippi Creek SSRP Area E - Sewer & Water - Sarasota County Utilities	B	B	B	B	B	B	B	B		X			R	O
Philippi Creek SSRP Area F - Sewer - Sarasota County Utilities	B	B	B	B	B	B	B	B		X			R	O
Philippi Creek SSRP Area I & J - Sewer & Water - Sarasota County Utilities	G	G	G	G	G	G	G	G		X			R	D
Philippi Creek SSRP Area K East - Sewer & Water - Sarasota County Utilities	B	B	B	B	B	B	B	B			X		R	O
Philippi Creek SSRP Area K West - Sewer & Water - Sarasota County Utilities	B	B	B	B	B	B	B	B			X		R	O
Philippi Creek SSRP Area M-West - Sewer - Sarasota County Utilities	G	G	G	G	G	G	G	G		X			R	D
Philippi Creek SSRP Area N, Phase 1 - Sewer & Water - Sarasota County Utilities	G	G	G	G	G	G	G	G		X			R	O
Philippi Creek SSRP Area N, Phase 2 - Sewer & Water - Sarasota County Utilities	G	G	G	G	G	G	G	G		X			R	O
Philippi Creek SSRP Area N, Phase 3 - Gravity Sewer - Sarasota County Utilities	G	G	G	G	G	G	G	G		X			R	O
Philippi Creek SSRP Area O & P - Sewer & Water - Sarasota County Utilities	G	G	G	G	G	G	G	G		X			R	O
Martin County - Seagate Harbor/Lighthouse Point WW - Sewer	G	G	G	G	G	G	G	G		X			R	O
Martin County - North River Shores - Phase 1 - Sewer	G	G	G	G	G	G	G	G		X			R	O
Martin County - North River Shores - Phase 2 - Sewer	G	G	G	G	G	G	G	G		X			R	O
Martin County - Golden Gate - Sewer	B	B	B	B	B	B	B	B		X			R	D
City of Tarpon Springs WW - Sewer	B	B	B	B	B	B	B	B		X			R	O
JEA City of Jacksonville - Sewer	B	B	B	B	B	B	B	B		X			R	O
Charlotte County Utilities - East/West Spring Lake WW - Sewer & Water	G	G	G	B	G	B	G	B			X		R	O
Charlotte County Utilities - East/West Spring Lake WW, Contract D - Sewer & Water	G	G	G	G	G	B	B	B		X			R	O
Charlotte County Utilities - Wastewater Expansion, Phase 2 - Sewer & Water	G	G	G	G	G	G	B	B			X		R	D
Charlotte County Utilities - El Jobean Wastewater Program - Sewer	G	G	G	G	G	B	B	B		X			R	C
City of Port St. Lucie - Southport, Unit 5 - Sewer	*	*	G	*	G	G	G	G	*	X			R	C

Legend System Type: G = By GWE B = By Others
 Project Type: R = Retrofit (Developed Area)
 Project Status: O = Operating D = Design Phase C = Under Construction
 * = Not Applicable

Mr. Dennis J. Croyle, P.E., will be the Senior Utility Engineer (EOR) for most design projects.

Mr. Croyle is the project engineer on several large utility expansion projects similar to the City's project including the Charlotte County Ackerman/Countryman Expansion, Phase 2 project (over 2,000 customers), the Martin County Golden Gate CRA project, and the Old Palm City septic to sewer project.

In addition, he is the Project Engineer for the Sarasota County Shamrock Boulevard Force Main Extension; the Midnight Pass Water Main Replacement project; and the City of Port St. Lucie Utility sewer retrofit project currently under construction.

Both will be supported by the following staff with all design work in house in our Englewood Office:

Andrew J. Wickerson, P.E., Senior Design Engineer
Kevin E. Furniss, Senior Utility Designer
Randy Blackwell, Construction Administrator
Thomas Shaw, Senior Structural Designer (pump station buildings)
Christopher Orren, Utility Designer
Lisa Burleson, Administrative/Contract Documents/Permits
LuAnn Overby, Administrative

Please refer to the resumes following this section for additional information.

Sub-consultants:

GWE provides all civil engineering for our utility projects including the master planning, structural design, public meetings, and project management in-house. However, we plan to use RWA, Inc., for all surveying services.

Our team has been through the process from conception to construction many times. Our team will be organized in accordance with the following organizational chart of key personnel:

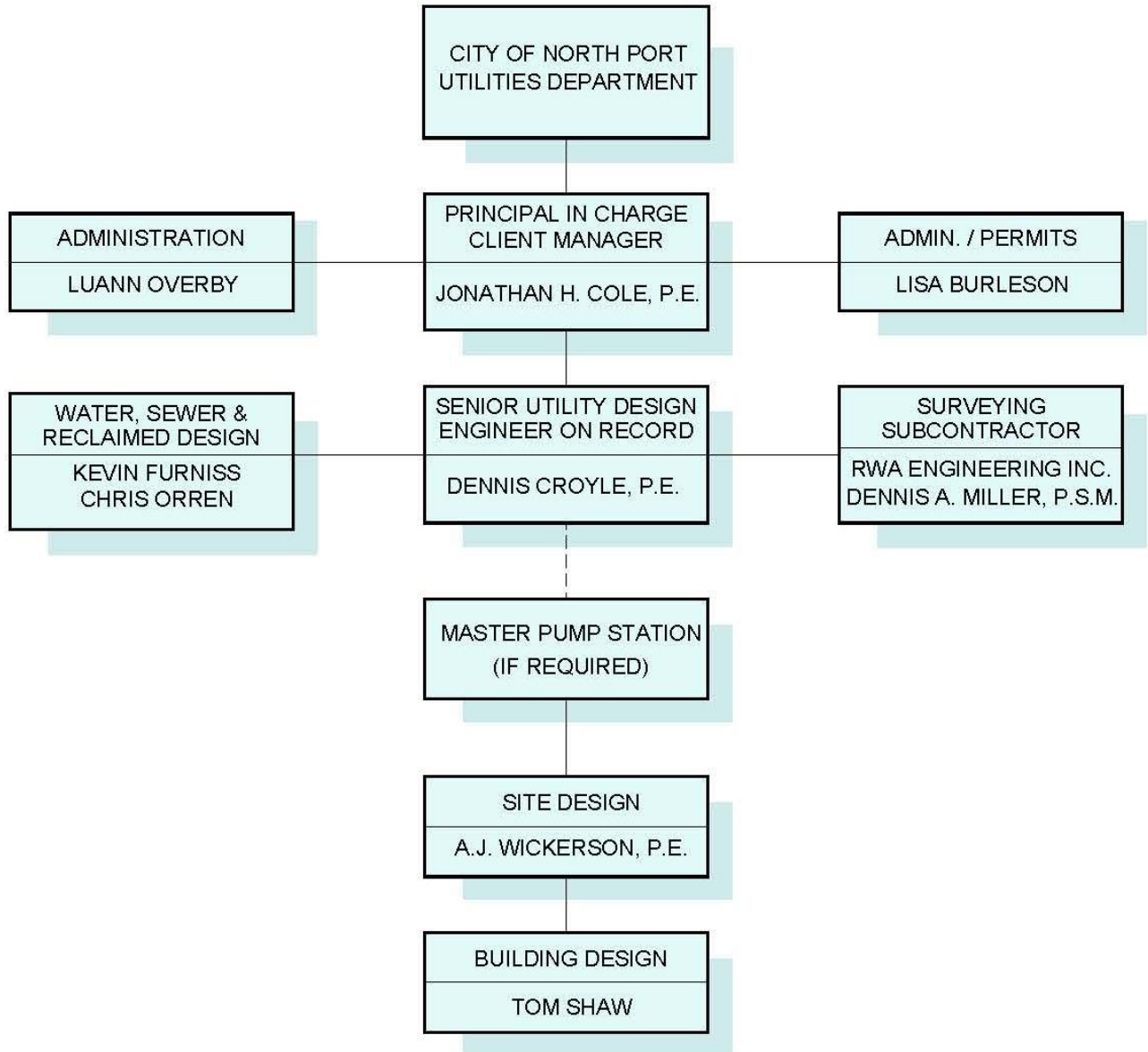



POSITION:

President/Principal-In-Charge

EDUCATION:

University of Connecticut

Storrs, CT

B.S., Civil Engineering (1979)

YEARS OF EXPERIENCE: 34

LICENSURE/CERTIFICATIONS:

- ◆ P.E. #36384, Florida
- ◆ P.E. #0013198, Connecticut
- ◆ P.E. #06872, New Hampshire
- ◆ P.E. #E-17024, Nebraska
- ◆ P.E. #27320, Kansas
- ◆ FL Advanced Traffic Control
- ◆ FDEP Stormwater Erosion & Sediment Inspector



900 Pine Street, Suite 225

Englewood, FL 34223

Phone: 941-475-7981

Fax: 941-474-4285

Email: jcole@gwefl.com

Mr. Cole is a Professional Engineer registered in the States of Florida, Connecticut, New Hampshire and Nebraska. Mr. Cole is President of Giffels-Webster Engineers, Inc., a Florida corporation and was formerly the County Engineer of Charlotte County, FL.

He has 34 years of experience in various types of civil engineering and construction projects, 30 of which were conducted in the Charlotte/Sarasota County area. He offers specialized knowledge, experience and proven ability in:

- Contract administration & construction services
- Entire utility infrastructure design/FDOT utility JPA plans for utility replacement/relocation in conjunction with major road widening projects
- Engineering design/permitting of water distribution systems; sewer collection, transmission, treatment; reclaimed water distribution systems; and package plants for private and municipal projects
- Expert witness testimony for private or municipal civil, utility system, and construction projects
- Sub-surface utility locates using ground penetrating radar

Mr. Cole has also been the Principal-in-Charge/Engineer for over two dozen large utility projects in highly developed areas for Charlotte County Utilities, the East/West Spring Lake Wastewater Expansion Project; Englewood Water District, Sewer Collection System; Sarasota County's Phillippi Creek Septic System Replacement Program and the Martin County Sewer Expansion Program. Mr. Cole is also certified by AIRVAC/Aqseptance, Inc., to design vacuum sewer systems. A few of these projects are listed below:

Englewood Water District:

- Nine Large Sewer Collection System areas (V-1 through V-9) and water distribution projects

City of Punta Gorda:

- Burnt Store Road Phase I Utility Relocation
- Piper Road Improvements – including 16" pressure mains

Sarasota County:

- Phillippi Creek Septic System Replacement Program, Area E; Area F; Area C; Area K, East & West; Area N, Phases I & II; Area M-West; Area I & J; Area O & P
- Phillippi Creek Septic System Replacement Program, Area N-3

Marin County:

- Seagate Harbor/Lighthouse Point sewer expansion area
- North River Shores, Phase 1 and 2 sewer expansion area

Due to Mr. Cole's extensive experience in civil engineering, he is qualified to provide expert witness testimony in court cases on behalf of governmental and private sector clients.

PREVIOUS EXPERT WITNESS TESTIMONY EXPERIENCE:

For private, municipal, civil, utility projects, including:

- Case No. 2006-CA-4911-NC –Plaintiff, Water Equipment Services, Inc., a Florida corp. vs. Defendants, Baskerville-Donovan, Inc. a Florida Corp., Kurt Jensen, P.E., and Sarasota County, a political subdivision of the State of Florida – “Sarasota County Area A” Project (Mr. Cole provided expert witness testimony on behalf of Defendant, Sarasota)
- Case No. 07-4374-CA- Plaintiff, Rotonda Project, LLC, a Florida Limited Liability Company vs. Defendant, Charlotte County, a political subdivision of the State of Florida (Mr. Cole provided expert witness testimony on behalf of Plaintiff, Rotonda Project LLC.)
- Case No. 2007-CA-873 – Plaintiff, Islamorada, Village of Islands vs. WPC Industrial Contractors, et al. (Mr. Cole provided expert witness testimony on behalf of Plaintiff, Islamorada.)
- Case No. 2012-CA-9-M – Plaintiff, Globetec Construction LLC vs. Defendants, City of Marathon, et.al. (Mr. Cole provided expert witness testimony on behalf of Plaintiff)
- Case No. 51-2008-CA-006644 WS – Plaintiff/Counter-Defendant, Astaldi Construction Corporation vs. Defendants/Counter-Plaintiff, Pasco County, Florida and King Engineering Associates, Inc, a Florida Corporation (Mr. Cole provided expert witness testimony on behalf of Plaintiff)
- Case No. 10-CA-21956 Hillsborough County Expert Opinion in Dayley vs. Coulthart. (Mr. Cole provided expert witness testimony on behalf of Defendant)
- DOAH Case No. 13-4764 Lawrence Pointe Condominium vs. Erika and Anchim Ginsberg-Klemmt et al. Mr. Cole provided analysis and opinion with regard to a proposed mooring facility and dock. (Mr. Cole provided expert input on behalf of Defendant)
- Case No. 14-2009-CA-000086 – Plaintiff, Astaldi Construction Corporation vs. Defendant/Third-Party Plaintiff, Desoto County, Florida vs. Third-Party Defendant, Hartman & Associates, Inc. (Mr. Cole providing expert input on behalf of Plaintiff)





POSITION:

Project Engineer

EDUCATION:

University of Florida
Gainesville, FL
B.S., Civil Engineering (2011)

YEARS OF EXPERIENCE: 10

LICENSURE/CERTIFICATIONS:

- ◆ P.E. #82287, Florida
- ◆ FL Advanced Traffic Control
- ◆ FDEP Stormwater Erosion & Sediment Inspector



900 Pine Street, Suite 225
Englewood, FL 34223
Phone: 941-475-7981
Fax: 941-474-4285
Email: dcroyle@gwefl.com

Mr. Dennis J. Croyle is a Professional Engineer registered in the State of Florida. Mr. Croyle worked in the construction industry where he gained valuable knowledge through work experience in civil construction. He earned a Bachelor's of Science in Civil Engineering (2011) from University of Florida. Mr. Croyle has been a Project Manager for GWE since early 2014 specializing in the planning, design and construction of utility infrastructure projects throughout the State of Florida.

As a Project Engineer, Dennis Croyle manages and designs water and wastewater projects, including but not limited to wastewater collection and water supply. Mr. Croyle has over 10 years of engineering and project management experience encompassing hydraulics, water and wastewater facilities, design, permitting, and construction services.

Sarasota County:

- Hillview (Shamrock Boulevard) Force Main Extension
- Midnight Pass Water Main Replacement
- Phillippi Creek Septic System Replacement Program: Area I & J; Area N-3; Area O & P; Area M-West

Charlotte County Utilities:

- Wastewater Expansion Vacuum Sewer, Phase 2
- Myakka Booster and El Jobean Vacuum Pump Station
- East/West Spring Lake Vacuum Sewer Expansion Program
- Utility Adjustment/Relocation Design, Midway Boulevard Widening, Phase 2

Englewood Water District:

- V9-B & V9-C Vacuum Sewer Design

Martin County Utilities:

- North River Shores, Phase 2: Vacuum Sewer Collection System
- Golden Gate: Vacuum Sewer Collection System
- Old Palm City: Vacuum Sewer Collection System

City of Port St. Lucie:

- Southport Unit 5: Vacuum Sewer Collection System

Kevin E. Furniss



POSITION:

Senior Designer

YEARS OF EXPERIENCE: 31

LICENSURE/CERTIFICATIONS:

- ◆ Certified Technician Level III

GWE
Giffels-Webster
Engineers, Inc.

900 Pine Street, Suite 225
Englewood, FL 34223
Phone: 941-475-7981
Fax: 941-474-4285
Email: kfurniss@gwefl.com

Mr. Furniss has been with Giffels-Webster Engineers, Inc. (GWE) since 1989. He is a 1986 graduate from Lemon Bay High School in Englewood with years of drafting experience, including mechanical and architectural drawings. His background education includes various computer courses, blueprint reading and architectural drawings through Manatee Community College (State College of Florida) and Charlotte Vocational-Technical School.

Mr. Furniss has held the position of senior designer and AutoCAD® Technician with GWE. His background, training and experience include AutoCAD® drafting, engineering project designs, and assisting in the capacity of construction inspector.

He is directly responsible for the accuracy and deliverables of the record/as-built drawings for virtually all of GWE construction projects, and in particular, Sarasota County and Englewood Water District Expansion Projects. Below are some of the projects he has worked on.

Charlotte County:

- Burnt Store Road Improvements, Army Corp of Engineers permitting assistance
- Midway Blvd., Phase II-Roadway Design and Drainage Project, Port Charlotte
- East/West Spring Lake Wastewater Expansion Project, Port Charlotte

Sarasota County:

- Phillippi Creek Septic System Replacement Program, Vacuum Sewers: Area A; Area C; Area D; Area E, Area F; Area K, East and West; Area N-Phases I & II; Area O & P
- Center Road Utility Relocation, as-built drawings, Venice
- U.S. 41 & Pump Station 25 – including both 16” and 18” Force Mains

City of Punta Gorda:

- ◆ Burnt Store Road Utility Improvements, Phase I
- Piper Road Improvements – including 16” pressure mains

Englewood Water District:

- All EWD Vacuum Sewer projects
- EWD/FDOT JPA Water Main Relocation Projects along S.R. 776, Sarasota/Charlotte Counties
- EWD Force Main Interconnect, Sarasota County
- Manasota Key Sanitary Sewer Collection Systems, Charlotte County
- Lemon Bay Reuse Force Main, Charlotte County
- Winchester Boulevard Force Mains, Charlotte County
- EWD’s On-Going Phased Vacuum Sewer Expansion Project



EDUCATION:

ITT Technical Institute | Architectural Engineering | 1971
St Joseph's College Undergraduate Coursework | Mathematics and Computer Training | 1976
Lamson Business College | Under-Graduate Course-Work | Land Surveying | 1983

REGISTRATION AND LICENSES:

Professional Land Surveyor | FL
LS 5626 | 1996

PROFESSIONAL AFFILIATIONS:

Florida Surveying and Mapping Society | Charlotte Harbor Chapter | 1996 - Present

National Society of Professional Surveyors

EXPERIENCE SUMMARY

Mr. Dennis Miller, P.S.M. has 36 years of land surveying, development, and engineering experience. Mr. Miller attended ITT Technical Institute for architectural engineering; St. Joseph's College for undergraduate coursework in mathematics and computer programming; and Lamson Business College for undergraduate coursework in land surveying. Mr. Miller is FDOT Maintenance of Traffic certified.

Mr. Miller's industry experience includes survey project management, professional surveyor duties, survey party chief duties, survey instrument operation, and civil design. Specific areas of expertise include ALTA/ACSM land title surveys, boundary and topographic surveys, right-of-way and land acquisition surveys, volume studies, mean high water line and wetland delineation surveys, legal sketches and descriptions, subdivision platting, condominium documents and exhibits, various specialty surveys, and miscellaneous engineering support services.

REPRESENTATIVE PROJECTS

Hanson Street Extension | Sub Consultant to PBS&J | Fort Myers, FL | Project Surveyor for the professional surveying services associated with the design of Hanson Street Extension from the west terminus to State Road 82 in accordance with FDOT and other regulatory agency requirements. The project included the design of a bridge over I-75; as well as the design of water, sewer, drainage, reclaimed water and associated utilities located along the project corridor. RWA provided surveying services including a control survey and a topographic survey of the 6.5-mile urban roadway through the City of Fort Myers.

Vanderbilt Beach Road | 10-mile New Roadway | Collier County Government, Collier County, FL | Project Surveyor responsible for the preparation of the right-of-way maps for the 10-mile extension of Vanderbilt Beach Road. The project included the creation of 540 legal descriptions for the easements and fee simple takings along the project corridor, and included the boundary and topographic surveys of the eight major pond sites required for the project.

Golden Gate Parkway | 5-mile Roadway Widening | Collier County Government, Collier County, FL | Project Surveyor responsible for the preparation of the right-of-way maps for the proposed 5-mile widening of Golden Gate Parkway. The project included the creation of 480 legal descriptions for the easements and fee simple takings along the project corridor, and included the boundary and topographic surveys of the five major pond sites required for the project.

Sanibel Causeway | Ajax Paving, Inc. and Lee County Department of Transportation | Lee County, FL | Project Surveyor responsible for management of construction staking of highway infrastructure and paving; the project consisted of the construction of new roadway on two islands and the construction of three causeway bridges. RWA coordinated with the bridge contractor throughout the bridge and roadway construction.

NTP Turkey Point | Florida Power and Light Company | Florida City, FL | Project Manager / Lead Surveyor responsible for the coordination, oversight, technical and professional support associated to the professional surveying services at Florida Power and Light Company's Turkey Point Fossil and Nuclear Power Plant. The project involved the establishment of horizontal and vertical control for the entire plant based field locations of the existing plant structural members and then combining and interpreting the as-built data to correspond with the original 40 year old plant grid system, construction layout and field support for Fossil Plant improvements and FPL EPU project facilities

E. RESUMES OF KEY PERSONNEL PROPOSED FOR THIS CONTRACT

(Complete one Section E for each key person.)

12. NAME Jonathan H. Cole, P.E.	13. ROLE IN THIS CONTRACT Principal-in-Charge	14. YEARS EXPERIENCE	
		a. TOTAL 34	b. WITH CURRENT FIRM 28
15. FIRM NAME AND LOCATION <i>(City and State)</i> Giffels-Webster Enginners, Inc., Englewood, FL			
16. EDUCATION <i>(Degree and Specialization)</i> BS/1979/Civil Engineering – University of Connecticut		17. CURRENT PROFESSIONAL REGISTRATION <i>(State and Discipline)</i> 1985/Florida Professional Engineer 1987/New Hampshire Professional Engineer 1984/Connecticut Professional Engineer 2019/Kansas Professional Engineer	
18. OTHER PROFESSIONAL QUALIFICATIONS <i>(Publications, Organizations, Training, Awards, etc.)</i> Co-authored "Defying Gravity", ASCE Civil Engineering, Feb. 1998; "Lemon Bay's Water Quality Will Benefit From Centralized Sewer System Project", Focus: Lemon Bay & Watershed, Charlotte Harbor National Estuary Program.			

19. RELEVANT PROJECTS

(1) TITLE AND LOCATION <i>(City and State)</i>	(2) YEAR COMPLETED	
	PROFESSIONAL SERVICES	CONSTRUCTION <i>(If applicable)</i>
a. Olean Boulevard - Charlotte County Utilities, Port Charlotte, Florida (3) BRIEF DESCRIPTION <i>(Brief scope, size, cost, etc.)</i> AND SPECIFIC ROLE GWE provided a complete utility design including 2,315 LF 8" WM, 7,140 LF 12" WM, 2,315 LF 6" WM, 1,653 LF 16" WM, 2,920 LF 8" RCW, 1,120 LF 16" RCW, 4,560 LF 24" FM, 6,330 LF 8" Gravity, 1,260 LF 10" Gravity, 1,535 12" Gravity and 36 Manholes. Specific Role: Principal-in-Charge/EOR. Total Construction Cost \$3.7M <input checked="" type="checkbox"/> Check if project performed with current firm	2020	2021
b. North River Shores Vacuum Sewer Design, Phase 2, Stuart, Florida (3) BRIEF DESCRIPTION <i>(Brief scope, size, cost, etc.)</i> AND SPECIFIC ROLE Design a vacuum collection system into a highly developed neighborhood including 5,000 feet of force main of which 300 feet was with FDOT limited access right-of-way. Specific Role: Principal-in-Charge/EOR. Total Construction Cost: \$6M <input checked="" type="checkbox"/> Check if project performed with current firm	2019	2019
c. Charlotte County Utilities - East/West Spring Lake Vacuum Sewer Station, Port Charlotte, Florida (3) BRIEF DESCRIPTION <i>(Brief scope, size, cost, etc.)</i> AND SPECIFIC ROLE GWE was retained by Charlotte County Utilities to design and permit a new centralized vacuum sewer station which included water main upgrades in existing developed neighborhoods. There are approximately 2,200 sewer connections. Specific Role: Principal-in-Charge/EOR. Cost: \$1.5M <input checked="" type="checkbox"/> Check if project performed with current firm	2018	2018
d. Sarasota County Public Works – Phillippi Creek Septic System Replacement Program – Area N-3, Sarasota, Florida (3) BRIEF DESCRIPTION <i>(Brief scope, size, cost, etc.)</i> AND SPECIFIC ROLE Design and permit for this area a small "hybrid" gravity sewer system using shallow gravity lines, two standard lift stations and two small mini lift stations. Area N-3 was initially designed as a low pressure sewer system. Specific Role: Principal-in-Charge/EOR. Cost: \$3M <input checked="" type="checkbox"/> Check if project performed with current firm	2017	2017
e. (1) TITLE AND LOCATION <i>(City and State)</i> (3) BRIEF DESCRIPTION <i>(Brief scope, size, cost, etc.)</i> AND SPECIFIC ROLE <input type="checkbox"/> Check if project performed with current firm	PROFESSIONAL SERVICES	CONSTRUCTION <i>(If applicable)</i>

E. RESUMES OF KEY PERSONNEL PROPOSED FOR THIS CONTRACT

(Complete one Section E for each key person.)

12. NAME Dennis J. Croyle, P.E.	13. ROLE IN THIS CONTRACT Professional Engineer	14. YEARS EXPERIENCE	
		a. TOTAL 10	b. WITH CURRENT FIRM 6
15. FIRM NAME AND LOCATION <i>(City and State)</i> Giffels-Webster Engineers, Inc, Englewood, FL			
16. EDUCATION <i>(Degree and Specialization)</i> University of Florida - 2011, Bachelors of Science in Civil Engineering		17. CURRENT PROFESSIONAL REGISTRATION <i>(State and Discipline)</i> State of Florida - P.E. #82287	
18. OTHER PROFESSIONAL QUALIFICATIONS <i>(Publications, Organizations, Training, Awards, etc.)</i> Florida D.E.P. Stormwater Erosion & Sediment Inspector Florida Advanced MOT Training			

19. RELEVANT PROJECTS

(1) TITLE AND LOCATION <i>(City and State)</i>	(2) YEAR COMPLETED	
	PROFESSIONAL SERVICES	CONSTRUCTION <i>(If applicable)</i>
Englewood Water District - Area V9-B Vacuum Sewer Design, Englewood, Florida a. (3) BRIEF DESCRIPTION <i>(Brief scope, size, cost, etc.)</i> AND SPECIFIC ROLE <input checked="" type="checkbox"/> Check if project performed with current firm GWE was retained by the EWD to provide all the design and CEI services for the sewer expansion project that consisted of 260 connections involving approximately 25,000 feet of vacuum piping. Costs: \$2.2 M, Role: Designer	2014	2015
Charlotte County Utilities - East/West Spring Lake Vacuum Sewer and Force Main, Port Charlotte, Florida b. (3) BRIEF DESCRIPTION <i>(Brief scope, size, cost, etc.)</i> AND SPECIFIC ROLE <input checked="" type="checkbox"/> Check if project performed with current firm GWE was retained by Charlotte County Utilities to design and permit a new centralized vacuum sewer system and water main upgrades in existing developed neighborhoods. There is approximately 2,200 sewer connections for this poroject. Costs: \$15.8M, Role: Designer	2014	2015
Charlotte County Utilities – Midway Boulevard Widening, Phase 2, Port Charlotte, Florida c. (3) BRIEF DESCRIPTION <i>(Brief scope, size, cost, etc.)</i> AND SPECIFIC ROLE <input checked="" type="checkbox"/> Check if project performed with current firm GWE was retained by Charlotte County Utilities to provide Public Relation Services while the construction of the new road is underway. GWE provided CCU with a monthly assessment of resident's issues that were resolved daily. Costs: \$17.4M, Role: Public Relations	2015	2015
Englewood Water District - Area V9-C Vacuum Sewer Design, Englewood, Florida d. (3) BRIEF DESCRIPTION <i>(Brief scope, size, cost, etc.)</i> AND SPECIFIC ROLE <input checked="" type="checkbox"/> Check if project performed with current firm GWE was retained by the EWD to provide all the design and CEI services for the sewer expansion project that consisted of 260 connections involving approximately 25,000 feet of vacuum piping. Costs: \$4.5M, Role: Utility Designer	2015	2016
Sarasota County Public Works – Phillippi Creek Septic System Replacement Program – Area N-3, Sarasota, Florida e. (3) BRIEF DESCRIPTION <i>(Brief scope, size, cost, etc.)</i> AND SPECIFIC ROLE <input checked="" type="checkbox"/> Check if project performed with current firm GWE was retained to design and permit for this area a small "hybrid" gravity sewer system using shallow gravity lines, two standard lift stations and two small mini lift stations. Area N-3 was initially designed as a low pressure sewer system. Costs: \$3M, Role: Utility Designer	2014	2017

E. RESUMES OF KEY PERSONNEL PROPOSED FOR THIS CONTRACT

(Complete one Section E for each key person.)

12. NAME Andrew J. Wickerson, P.E.	13. ROLE IN THIS CONTRACT Professional Engineer	14. YEARS EXPERIENCE	
		a. TOTAL 18	b. WITH CURRENT FIRM 15
15. FIRM NAME AND LOCATION <i>(City and State)</i> Giffels-Webster Engineers, Inc., Englewood, FL			
16. EDUCATION <i>(Degree and Specialization)</i> BS in Computer Science - 1987 – U.S. Naval Academy MS in Civil Engineering - 1997 – Oregon State University		17. CURRENT PROFESSIONAL REGISTRATION <i>(State and Discipline)</i> Florida/Professional Engineer #58397 Also Registered Professional Engineer in Maryland	
18. OTHER PROFESSIONAL QUALIFICATIONS <i>(Publications, Organizations, Training, Awards, etc.)</i> Specialized experience in providing technical support for a full range of land development, site planning and civil eng. tasks associated with design, permitting and execution of commercial, residential and public construction projects.			

19. RELEVANT PROJECTS

(1) TITLE AND LOCATION <i>(City and State)</i>	(2) YEAR COMPLETED	
	PROFESSIONAL SERVICES	CONSTRUCTION <i>(If applicable)</i>
a. Cape Haze Reclaimed Main and Force Main, Cape Haze, Florida (3) BRIEF DESCRIPTION <i>(Brief scope, size, cost, etc.)</i> AND SPECIFIC ROLE <input checked="" type="checkbox"/> Check if project performed with current firm Reclaimed Water Main & Sewer Force Main. 16" reclaimed water main along Cape Haze Drive from Placida Rd. to the CCU Rotonda WRF for total distance of approx. 8,000 LF. 12" sewer force main along Cape Haze Dr. from Placida Rd. to the CCU Rotonda WRF for a total distance of approx. 9,750 LF. Costs: TBD (Estimated Cost \$1.9M), Utility Engineer	2020	2020
b. Charlotte County Utilities– Placida Road North (Cape Haze Dr. to Rotonda Blvd. West) (3) BRIEF DESCRIPTION <i>(Brief scope, size, cost, etc.)</i> AND SPECIFIC ROLE <input checked="" type="checkbox"/> Check if project performed with current firm Design of Reclaimed Water Main (RCW) & Potable Water Main; 14,600 LF of 16" RCW, 5,000 feet 12" RCW, and 3,500 LF 12" Potable water along Placida Rd. from Cape Haze Dr. to Rotonda Blvd. Construction Cost: 3.5M, Utility Engineer	2018	2018
c. Charlotte County Public Works – Placida Road South (Coral Creek Bridge to Cape Haze Drive) (3) BRIEF DESCRIPTION <i>(Brief scope, size, cost, etc.)</i> AND SPECIFIC ROLE <input checked="" type="checkbox"/> Check if project performed with current firm Design of Reclaimed Water Main (RCW) & Potable Water Main; 3,000 LF of 16" RCW, 10,400 LF 16" RCW, and 10,400 LF 10" Force main along Placida Rd. from Coral Creek Bridge to Cape Haze Dr. West. Construction Cost: 3.5M, Utility Engineer	2018	2018
d. (1) TITLE AND LOCATION <i>(City and State)</i> (3) BRIEF DESCRIPTION <i>(Brief scope, size, cost, etc.)</i> AND SPECIFIC ROLE <input type="checkbox"/> Check if project performed with current firm		
e. (1) TITLE AND LOCATION <i>(City and State)</i> (3) BRIEF DESCRIPTION <i>(Brief scope, size, cost, etc.)</i> AND SPECIFIC ROLE <input type="checkbox"/> Check if project performed with current firm		

E. RESUMES OF KEY PERSONNEL PROPOSED FOR THIS CONTRACT

(Complete one Section E for each key person.)

12. NAME Kevin Furniss	13. ROLE IN THIS CONTRACT Senior Designer	14. YEARS EXPERIENCE	
		a. TOTAL 31	b. WITH CURRENT FIRM 31
15. FIRM NAME AND LOCATION <i>(City and State)</i> Giffels Webster Engineers, Inc. Englewood, Florida			
16. EDUCATION <i>(Degree and Specialization)</i> 1986 Graduate – Lemon Bay High School, Englewood, FL and Courses through Manatee Community College and Charlotte County Vo-Tech		17. CURRENT PROFESSIONAL REGISTRATION <i>(State and Discipline)</i> N/A	
18. OTHER PROFESSIONAL QUALIFICATIONS <i>(Publications, Organizations, Training, Awards, etc.)</i> Drafting experience including mechanical, architectural drawings and extensive experience in preparation of as-built plans. Background education includes various computer course, AutoCAD, blueprint reading and architectural drawings.			

19. RELEVANT PROJECTS

(1) TITLE AND LOCATION <i>(City and State)</i>	(2) YEAR COMPLETED	
	PROFESSIONAL SERVICES	CONSTRUCTION <i>(If applicable)</i>
a. Charlotte County Public Works, Midway Boulevard Widening, Phase 2, Port Charlotte, FL (3) BRIEF DESCRIPTION <i>(Brief scope, size, cost, etc.)</i> AND SPECIFIC ROLE <input checked="" type="checkbox"/> Check if project performed with current firm GWE was retained by Charlotte County to provide engineering services for the Midway Boulevard Road Widening Project located in Port Charlotte. Gwe provided the preparation of final working drawings, large scale details and specs to obtain bids and permits for construction. Cost: \$26.5M Role: Senior Designer	2014	2018
b. Charlotte County Utilities - East/West Spring Lake Vacuum Sewer Station, Port Charlotte, Florida (3) BRIEF DESCRIPTION <i>(Brief scope, size, cost, etc.)</i> AND SPECIFIC ROLE <input checked="" type="checkbox"/> Check if project performed with current firm GWE was retained by Charlotte County Utilities to design and permit a new centralized vacuum sewer station which included water main upgrades in existing developed neighborhoods. There are approximately 2,200 sewer connections.	2018	2018
c. Sarasota County Public Works - Phillippi Creek Septis System Replacement Program - Area N-3, Sarasota, Florida (3) BRIEF DESCRIPTION <i>(Brief scope, size, cost, etc.)</i> AND SPECIFIC ROLE <input checked="" type="checkbox"/> Check if project performed with current firm GWE was retained to design and permit for this area a small "hybrid" gravity sewer system using gravity lines, two standard lift stations and two small mini lift stations. Area N-3 was initially designed as a low pressure sewer system. ROLE: Senior Designer Construction Costs: \$3M	2014	2017
d. Charlotte County Public Works, Placida Road (South) Recreational Trails and Intersection Improvements Placida, Florida (3) BRIEF DESCRIPTION <i>(Brief scope, size, cost, etc.)</i> AND SPECIFIC ROLE <input checked="" type="checkbox"/> Check if project performed with current firm GWE provided the design of a 10 foot wide path on Placida Road from Cape Haze Drive to the Boca Grande Causeway in Charlotte County. The total length of this shared use path was 1.5 miles. ROLE: Senior Designer Construction Costs: \$3.1M	2017	2018
e. Charlotte County Public Works, Placida Road (North) Recreational Trails and Intersection Improvements Placida, Florida (3) BRIEF DESCRIPTION <i>(Brief scope, size, cost, etc.)</i> AND SPECIFIC ROLE <input checked="" type="checkbox"/> Check if project performed with current firm GWE provided the design of a 10 foot wide multimodal pedestrain path (about 2 miles) along Placida Road, from Rotonda Boulevard West, south to Cape Haze Drive in Englewood. Included utility relocation and intersection improvements. ROLE: Senior Designer Construction Costs: \$1.9M	2017	2018

E. RESUMES OF KEY PERSONNEL PROPOSED FOR THIS CONTRACT

(Complete one Section E for each key person.)

12. NAME Thomas L. Shaw	13. ROLE IN THIS CONTRACT Senior Designer	14. YEARS EXPERIENCE	
		a. TOTAL 42	b. WITH CURRENT FIRM 19

15. FIRM NAME AND LOCATION *(City and State)*
Giffels-Webster Engineers, Inc., Englewood, Florida 34223

16. EDUCATION *(Degree and Specialization)*
Plans Review and Code Compliance
Design and Permitting

17. CURRENT PROFESSIONAL REGISTRATION *(State and Discipline)*
Florida Dept of Business & Professional Regulation
Standard Plans Examiner – No. PX1404
Standard Inspector – No. BN3348

18. OTHER PROFESSIONAL QUALIFICATIONS *(Publications, Organizations, Training, Awards, etc.)*

Mr. Shaw maintains his professional licenses by taking CEU courses through state approved Continuing Educational Program Courses. He has specialized training in Southern Building Code involving inspections, plan review, and various code application programs.

19. RELEVANT PROJECTS

(1) TITLE AND LOCATION <i>(City and State)</i>	(2) YEAR COMPLETED	
	PROFESSIONAL SERVICES	CONSTRUCTION <i>(If applicable)</i>
a. (3) BRIEF DESCRIPTION <i>(Brief scope, size, cost, etc.)</i> AND SPECIFIC ROLE GWE was retained by Sarasota County to design and permit a new centralized vacuum sewer system in existing developed neighborhoods. There were approximately 1,600 sewer connections 74,000 feet of vacuum piping installed. Costs: \$8.7M Role: Structural Designer	2008	2014
<input checked="" type="checkbox"/> Check if project performed with current firm		
b. (1) TITLE AND LOCATION <i>(City and State)</i> Martin County Utilities - North River Shores Vacuum Collection System, Stuart, Florida	(2) YEAR COMPLETED	
(3) BRIEF DESCRIPTION <i>(Brief scope, size, cost, etc.)</i> AND SPECIFIC ROLE GWE was retained to design a sewer system consisting of approximately 650 residential connections, was the second of three areas designated to receive a centralized vacuum sewer system (AIRVAC). Over 60% of all properties served are waterfront homes. Costs: \$2.5M Role: Structural Designer	PROFESSIONAL SERVICES 2010	CONSTRUCTION <i>(If applicable)</i> 2011
<input checked="" type="checkbox"/> Check if project performed with current firm		
c. (1) TITLE AND LOCATION <i>(City and State)</i> Charlotte County Utilities – Utility Adjustment/Relocation Design Midway Boulevard Widening, Phase 2, Port Charlotte, Florida	(2) YEAR COMPLETED	
(3) BRIEF DESCRIPTION <i>(Brief scope, size, cost, etc.)</i> AND SPECIFIC ROLE GWE was retained by Charlotte County Utilities to design and permit new potable water, reclaimed and wastewater facilities in the right-of-way project limits for the 2-mile roadway widening. Detailed utility adjustments, relocations, and new improvements were planned and designed with special attention to provide CCU with an efficient system. Costs: \$13.7M Role: Structural Designer	PROFESSIONAL SERVICES 2012	CONSTRUCTION <i>(If applicable)</i> 2015
<input checked="" type="checkbox"/> Check if project performed with current firm		
d. (1) TITLE AND LOCATION <i>(City and State)</i> Charlotte County Utilities - East/West Spring Lake Vacuum Sewer and Force Main, Port Charlotte, Florida	(2) YEAR COMPLETED	
(3) BRIEF DESCRIPTION <i>(Brief scope, size, cost, etc.)</i> AND SPECIFIC ROLE GWE was retained by Charlotte County Utilities to design and permit a new centralized vacuum sewer system and water main upgrades in existing developed neighborhoods. There is approximately 2,200 sewer connections for this project. Costs: \$15.8M Role: Structural Designer	PROFESSIONAL SERVICES 2014	CONSTRUCTION <i>(If applicable)</i> 2015
<input checked="" type="checkbox"/> Check if project performed with current firm		
e. (1) TITLE AND LOCATION <i>(City and State)</i> Sarasota County Phillippi Creek Septic System Replacement Program – Area N, Phase 2 Vacuum Collection System, Sarasota, Florida	(2) YEAR COMPLETED	
(3) BRIEF DESCRIPTION <i>(Brief scope, size, cost, etc.)</i> AND SPECIFIC ROLE Area N-2 was designed (in-house) and constructed in multiple phases which involved the planning and design of approximately 9 miles of vacuum mains, approximately 245 valve pits, water distribution lines, wastewater transmission systems and a vacuum pump station. Cost: \$5.9M Role: Structural Designer	PROFESSIONAL SERVICES 2008	CONSTRUCTION <i>(If applicable)</i> 2015
<input checked="" type="checkbox"/> Check if project performed with current firm		

E. RESUMES OF KEY PERSONNEL PROPOSED FOR THIS CONTRACT

(Complete one Section E for each key person.)

12. NAME Christopher V. Orren		13. ROLE IN THIS CONTRACT Designer/Draftsman		14. YEARS EXPERIENCE	
				a. TOTAL 34	b. WITH CURRENT FIRM 19
15. FIRM NAME AND LOCATION <i>(City and State)</i> Giffels-Webster Engineers, Inc., Englewood, Florida					
16. EDUCATION <i>(Degree and Specialization)</i> B.A. Degree in Space Sciences in Physics/Florida Institute of Technology/1985			17. CURRENT PROFESSIONAL REGISTRATION <i>(State and Discipline)</i> N/A		
18. OTHER PROFESSIONAL QUALIFICATIONS <i>(Publications, Organizations, Training, Awards, etc.)</i> Training in AutoCAD®, numerous industry software programs, Microsoft/Windows Programs, Mechanical Analysis Ordnance Engineering, and preparation of conceptual site plans, boundary, topographic sketches and descriptions.					

19. RELEVANT PROJECTS

	(1) TITLE AND LOCATION <i>(City and State)</i>	(2) YEAR COMPLETED	
		PROFESSIONAL SERVICES	CONSTRUCTION <i>(If applicable)</i>
a.	City of North Port, Hillsborough Boulevard Sidewalk Project, North Port, Florida	2015	2016
	(3) BRIEF DESCRIPTION <i>(Brief scope, size, cost, etc.)</i> AND SPECIFIC ROLE <input checked="" type="checkbox"/> Check if project performed with current firm This project was for the design of a proposed sidewalk (just over 1 mile) on Hillsborough Boulevard between Bamboo Drive and Warrington Boulevard. All work was to be within the existing right-of-way on the north side of the existing road. Construction Costs: \$269K Role: Designer		
b.	Sarasota County Government Brentwood Sidewalk Neighborhood Enhancement Project, Sarasota, Florida	2013	2014
	(3) BRIEF DESCRIPTION <i>(Brief scope, size, cost, etc.)</i> AND SPECIFIC ROLE <input checked="" type="checkbox"/> Check if project performed with current firm This project involved the design of 5 foot wide sidewalks (one side of road), in the Brentwood Elementary School area (approximately 3.4 miles of sidewalk.) Construction Costs: \$2.1M Role: Designer		
c.	Charlotte County Public Works, Placida Road, North Multimodal Path, Placida, Florida	2016	2018
	(3) BRIEF DESCRIPTION <i>(Brief scope, size, cost, etc.)</i> AND SPECIFIC ROLE <input checked="" type="checkbox"/> Check if project performed with current firm GWE provided the design for a 10'-wide multimodal pedestrian path (about 2 miles) along Placida Road, from Rotonda Boulevard West, south to Cape Haze Drive in Englewood in Charlotte County. Construction Cost: \$3.9M Role: Designer		
d.	City of Punta Gorda, Bal Harbor Boulevard Sidewalk Project, Punta Gorda, Florida	2011	2012
	(3) BRIEF DESCRIPTION <i>(Brief scope, size, cost, etc.)</i> AND SPECIFIC ROLE <input checked="" type="checkbox"/> Check if project performed with current firm GWE provided civil engineering design plans for a re-construction and replacement of sidewalks and driveways on Bal Harbor Boulevard. The required reconstruction provided an opportunity for GWE to design improvements to the existing swales and driveway crossings. Construction Cost: \$1.2M Role: Designer		
e.	Charlotte County Public Works, Placida Road, South Multimodal Path, Placida, Florida	2016	2018
	(3) BRIEF DESCRIPTION <i>(Brief scope, size, cost, etc.)</i> AND SPECIFIC ROLE <input checked="" type="checkbox"/> Check if project performed with current firm GWE provided the design of a 10 foot wide path on Placida Road from Cape Haze Drive to the Boca Grande Causeway in Charlotte County. The total length of this shared use path was 1.5 miles. Construction Cost - \$3.1M Role: Designer		

E. RESUMES OF KEY PERSONNEL PROPOSED FOR THIS CONTRACT

(Complete one Section E for each key person.)

12. NAME Randy Blackwell	13. ROLE IN THIS CONTRACT Construction Administrator	14. YEARS EXPERIENCE	
		a. TOTAL 33	b. WITH CURRENT FIRM 13
15. FIRM NAME AND LOCATION <i>(City and State)</i> Giffels-Webster Engineers, Inc., Englewood, Florida 34223			
16. EDUCATION <i>(Degree and Specialization)</i> Franklin Community College – Indiana - United States Marine Corps		17. CURRENT PROFESSIONAL REGISTRATION <i>(State and Discipline)</i> N/A	
18. OTHER PROFESSIONAL QUALIFICATIONS <i>(Publications, Organizations, Training, Awards, etc.)</i> Contract Manager/Project Administrator/Inspector for on-site observation and inspection of construction projects; background involving working with engineering, surveying and construction firms.			

19. RELEVANT PROJECTS

(1) TITLE AND LOCATION <i>(City and State)</i>	(2) YEAR COMPLETED	
	PROFESSIONAL SERVICES	CONSTRUCTION <i>(If applicable)</i>
Sarasota County Public Works - Phillippi Creek Septic System Replacement Program, Area N, Phases I, IA, & II, Sarasota, Florida (3) BRIEF DESCRIPTION <i>(Brief scope, size, cost, etc.)</i> AND SPECIFIC ROLE a. GWE was retained by Sarasota County to design and permit a new centralized vacuum sewer system in existing developed neighborhoods. There were approximately 1,600 sewer connections 74,000 feet of vacuum piping installed. Costs: \$8.7M Role: Contract Manager	2008	2014
<input checked="" type="checkbox"/> Check if project performed with current firm		
Martin County Utilities - North River Shores Vacuum Collection System, Stuart, Florida (3) BRIEF DESCRIPTION <i>(Brief scope, size, cost, etc.)</i> AND SPECIFIC ROLE b. GWE was retained to design a sewer system consisting of approximately 650 residential connections, was the second of three areas designated to receive a centralized vacuum sewer system (AIRVAC). Over 60% of all properties served are waterfront homes. Costs: \$2.5M Role: Contract Manager	2010	2011
<input checked="" type="checkbox"/> Check if project performed with current firm		
Charlotte County Utilities – Utility Adjustment/Relocation Design Midway Boulevard Widening, Phase 2, Port Charlotte, Florida (3) BRIEF DESCRIPTION <i>(Brief scope, size, cost, etc.)</i> AND SPECIFIC ROLE c. GWE was retained by Charlotte County Utilities to design and permit new potable water, reclaimed and wastewater facilities in the right-of-way project limits for the 2-mile roadway widening. Detailed utility adjustments, relocations, and new improvements were planned and designed with special attention to provide CCU with an efficient system. Costs: \$13.7M Role: Contract Manager	2012	2015
<input checked="" type="checkbox"/> Check if project performed with current firm		
Charlotte County Utilities - East/West Spring Lake Vacuum Sewer and Force Main, Port Charlotte, Florida (3) BRIEF DESCRIPTION <i>(Brief scope, size, cost, etc.)</i> AND SPECIFIC ROLE d. GWE was retained by Charlotte County Utilities to design and permit a new centralized vacuum sewer system and water main upgrades in existing developed neighborhoods. There will be approximately 2,200 sewer connections when construction of the project is completed. Costs: \$15.8M Role: Contract Manager	2014	2015
<input checked="" type="checkbox"/> Check if project performed with current firm		
Sarasota County Phillippi Creek Septic System Replacement Program – Area N, Phase 2 Vacuum Collection System, Sarasota, Florida (3) BRIEF DESCRIPTION <i>(Brief scope, size, cost, etc.)</i> AND SPECIFIC ROLE e. Area N-2 was designed (in-house) and constructed in multiple phases which involved the planning and design of approximately 9 miles of vacuum mains, approximately 245 valve pits, water distribution lines, wastewater transmission systems and a vacuum pump station. Cost: \$5.9M Role: Contract Manager	2008	2015
<input checked="" type="checkbox"/> Check if project performed with current firm		

TAB 4

**TEAM'S PREVIOUS EXPERIENCE/
PROFICIENCY IN SIMILAR PROJECTS**

**CITY OF NORTH PORT - RFP NO. 2020-58
PROFESSIONAL ENGINEERING SERVICES-CONTINUING SERVICES CONTRACT FOR
CITY OF NORTH PORT UTILITIES DEPARTMENT**

TAB 4: TEAM’S PREVIOUS EXPERIENCE/PROFICIENCY IN SIMILAR PROJECTS

Since the early 1980’s, GWE has designed hundreds of miles of water distribution, reuse lines and entire sewer systems in highly developed areas. We have designed both new and replacement pipelines in local roads and state highways. And we have designed these utility mains not only for local counties like Sarasota and Charlotte but across the state of Florida.

The following similar projects were designed by GWE, all with members of the same in-house team we are proposing for your future projects. All projects listed in this section were designed or built within the last few years.

Jonathan Cole was the Principal-in-Charge for all projects. Either Mr. Cole or Mr. Dennis Croyle, P.E., was the Engineer of Record. Moreover, the same key design personnel, including Mr. Kevin Furniss, and Mr. Chris Orren, that are proposed for your project, were also the same designers for these projects.

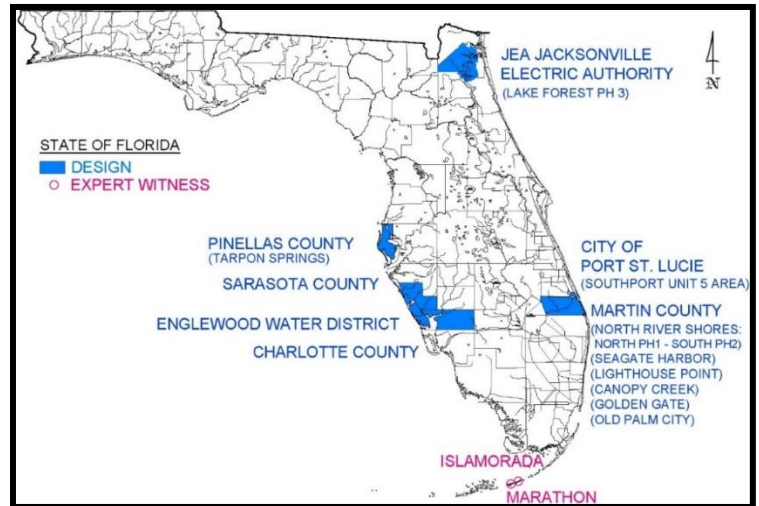

Some of the highlights for each project is contained in this section, followed by the required SF 330 forms.

North River Shores, Phase 2, Sewer Expansion - Stuart, Florida

Project Description/Nature of Work:

The North River Shores, Phase 2 Sewer Expansion project involves the design and construction of a centralized vacuum collection sewer system into a highly developed neighborhood located in Stuart, Florida. This project consists of approximately 24,000 feet (4.5 miles) of vacuum pipe, approximately 140 valve pits, a vacuum pump station, and force main serving approximately 300 ERC’s.

Year Completed: July 2019

Cost: Vacuum Station \$1.5M, Collection Area: \$4.5M

GWE Team: Jonathan H. Cole, P.E., Dennis Croyle, P.E., Tom Shaw, Randy Blackwell, Kevin Furniss, Chris Orren



Sarasota County Midnight Pass 10" and 16" Water Main

Project Description/Nature of Work:

The project work consists of the construction of approximately 1,000 linear feet of ten through sixteen (10-16) diameter ductile iron water main installed by direct bury methods **within FDOT rights of way** in Siesta Key, FL. The proposed water main will be replacing the existing asbestos cement water main infrastructure. The existing pipe will be abandoned and removed or grouted in accordance with the drawings. Water services will be re-connected to the proposed main.



Year Completed: November 2020

Cost: Consultant fee \$149,840, Construction Cost TBD

GWE Team: Dennis Croyle, P.E., Kevin Furniss, Chris Orren

Charlotte County Utilities 16" Reclaimed and 12" force main Cape Haze Drive

Project Description/Nature of Work:

Reclaimed Water Main & Sewer Force Main. 16" reclaimed water main along Cape Haze Drive from Placida Road to the CCU Rotonda WRF for a total distance of approximately 8,000 LF. 12" sewer force main along Cape Haze Drive from Placida Road to the CCU Rotonda WRF for a total distance of approximately 6,750 LF. Giffels-Webster Engineers, Inc. (GWE) serves as the Engineer-of-Record on this project, which was designed in-house.

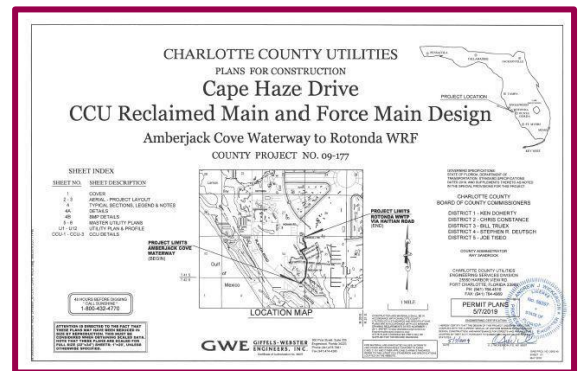

Year Completed: December 2020

Cost: Design fee \$170,000, Construction Cost \$2.1M

GWE Team: Andy Wickerson, P.E., Kevin Furniss, Chris Orren

Charlotte County Utilities Water mains, Reclaimed Mains and Sewer Mains Olean Blvd (US-41 to Easy Street)

Project Description/Nature of Work:

Provide sub consultant services regarding the Olean boulevard widening project including meeting with the county, review and submit an alternatives analysis report, provide graphics, documents and be present at the public meetings, prepare and present a power point presentation to the board of commissioners.

Potable Water Main & Reclaimed Water Main (US-41 to Easy Street)

- Potable water main: 795-LF (6") 2,315 LF (8") 7,140 LF (12") 1,653 LF (16")
- Reclaimed water main: 765-LF (6") 2,920 LF (8") 5,920 LF (12") 1,120 LF (16")

Sewer Force Main & Gravity Sewer (US-41 to Easy Street & additional offsite)

- Sewer force main: 85 LF (12") 110 LF (16") 4,560 LF (24")
- Gravity Sewer: 6,330 LF (8") 1,260 LF (10") 1,535 LF (12") & 38 manholes

Cost: Design Fee \$80,000, Construction Cost \$3.7M

Year Completed: June 2021

GWE Team: Jonathan H. Cole, P.E., Andy Wickerson, P.E., Kevin Furniss, Chris Orren

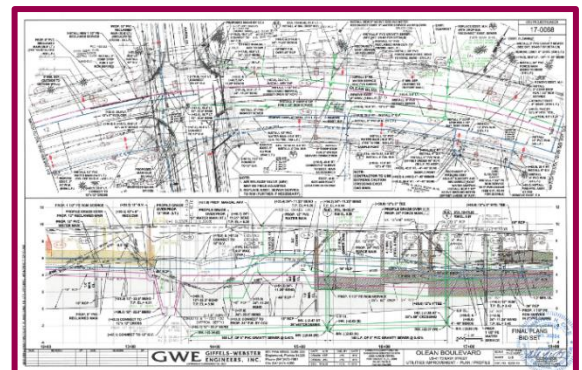

Placida Road Utility Mains (North and South)

Project Description/Nature of Work:

GWE provided the design for a 10'-wide multimodal pedestrian path (about 2 miles) along Placida Road, from Rotonda Boulevard West, south to Cape Haze Drive in Englewood in Charlotte County. Also, the design of a 10 foot wide path on Placida Road from Cape Haze Drive to the Boca Grande Causeway in Charlotte County. The total length of this shared use path was 1.5 miles. This project also included utility relocation and intersection improvements and was completed on time and within budget.

Cost: \$7.5M

Year Completed: 2017

GWE Team: Andy Wickerson, P.E., Kevin Furniss, Chris Orren

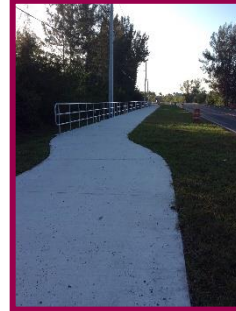

Bocilla Utilities Water Distribution Infrastructure Knight Island, FL

Project Description/Nature of Work:

Provide construction estimates of water expansion for the Bocilla Utilities Water Distribution Infrastructure along Placida Road and on Knight Island located in Charlotte County.

Unique Features:

- Knight Island is a Bridgeless Barrier Island
- 400 Potable Water Service Connections
- Water Systems Reproduction Cost valued at \$4.5 M
- Cost Valuation produced for FL PSC Utilities Rate Case
- PSC Rate Case for Conversion of Water Supply from an on-island RO Plant to an interconnect with EWD

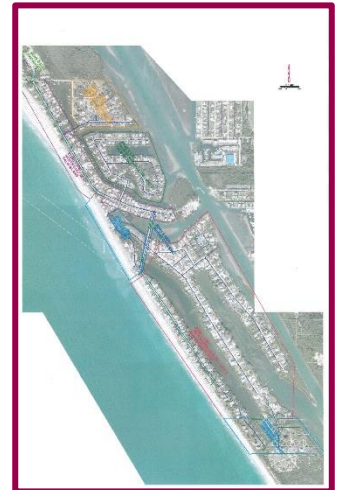

Cost: N/A - Master Plan/Study Only

Year Completed: 2016

GWE Team: Jonathan H. Cole, P.E., Andy Wickerson, P.E., Kevin Furniss, Chris Orren

Boca Vista Reuse Line (Connection to CCU on 771), Charlotte County, Florida

Project Description/Nature of Work:

Design of a 4" reclaimed water service line along Gasparilla Road (CR 771) to serve a two acre residential complex for irrigation of 2 acres and a demand of 8000 gpd. . Plans included directional drilling under 771 and tie in to a master meter and pump system.

Cost: \$50,000

Year Completed: June 2020

GWE Team Jonathan H. Cole, P.E., Chris Orren

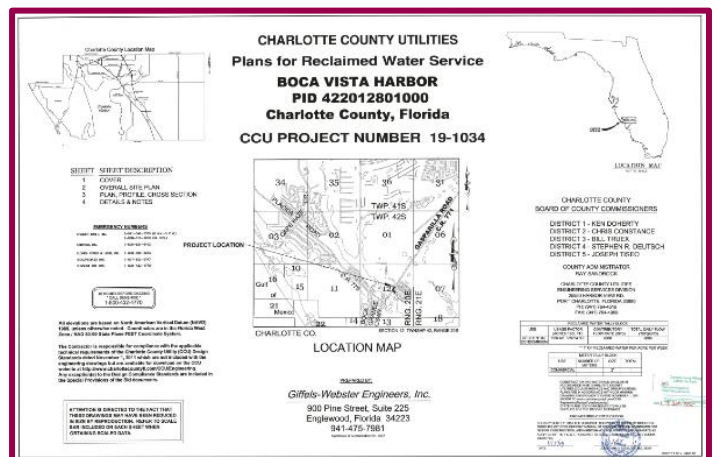

Charlotte County Government – East/West Spring Lake Wastewater Expansion, Port Charlotte, Florida

Project Description/Nature of Work:

The East/West Spring Lake Wastewater Expansion project involves the design and construction of a centralized vacuum collection sewer system into highly developed neighborhoods located in the Spring Lake subdivision. This project involves the planning and design of approximately 20 miles of vacuum, approximately 600 valve pits, water distribution lines, a vacuum pump station, and force main serving approximately 2200 ERCs. Giffels-Webster Engineers, Inc. (GWE) serves as the Engineer-of-Record on this project, which was designed in-house

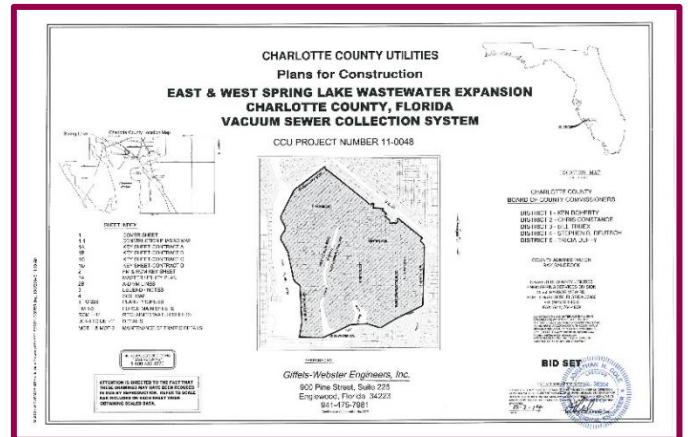

Cost: \$17.4M

Year Completed: July 2017

GWE Team: Jonathan H. Cole, P.E., Dennis Croyle, P.E., Kevin Furniss, Chris Orren

Phillippi Creek Septic System Replacement Program Area O & P, Sarasota, Florida

Project Description/Nature of Work:

This project involved the design and inspection services of a centralized vacuum sewer collection system, vacuum station, and water line replacement into a highly developed neighborhood located in Sarasota, Florida, between Clark Road, to the south, and Proctor Road to the north, and U.S. 41 to the west and Beneva Road to the east. This project involved the planning and design of approximately 12.9 miles of vacuum pipe, and 570 valve pits serving approximately 1,247 ERC's.

Cost: Collection System: \$6.4M, Vacuum Station: \$1M, Water Main: \$4M; Total: \$16.5M

Year Completed: 2017

GWE Team: Jonathan H. Cole, P.E., Andy Wickerson, P.E., Kevin Furniss, Chris Orren, Tom Shaw, Randy Blackwell



Southport Unit 5 Vacuum Sewer Design, Port St. Lucie, Florida

Project Description/Nature of Work:

The Southport Unit 5 Vacuum Sewer Design project involved the design of a centralized vacuum collection sewer system into a highly developed neighborhood located in Port St. Lucie, Florida. This project involved the planning and design of approximately 11,000 feet of vacuum pipe, 12 buffer tanks, a vacuum pump station, and force main serving approximately 427 ERC's

Cost: Vacuum Station \$1.5M, Collection Area \$2.5M

Year Completed: 2020

GWE Team: Jonathan H. Cole, P.E., Dennis Croyle, P.E., Kevin Furniss, Chris Orren, Tom Shaw



F. EXAMPLE PROJECTS WHICH BEST ILLUSTRATE PROPOSED TEAM'S QUALIFICATIONS FOR THIS CONTRACT <i>(Present as many projects as requested by the agency, or 10 projects, if not specified. Complete one Section F for each project.)</i>		20. EXAMPLE PROJECT KEY NUMBER 1
21. TITLE AND LOCATION <i>(City and State)</i> NORTH RIVER SHORES, PHASE 2 SEWER EXPANSION, STUART, FL	22. YEAR COMPLETED	
	PROFESSIONAL SERVICES 2019	CONSTRUCTION <i>(If applicable)</i> 2019

23. PROJECT OWNER'S INFORMATION

a. PROJECT OWNER Martin County Utilities	b. POINT OF CONTACT NAME Phil Keathley, Project Manager	c. POINT OF CONTACT TELEPHONE NUMBER 772-223-7977
---	--	--

24. BRIEF DESCRIPTION OF PROJECT AND RELEVANCE TO THIS CONTRACT *(Include scope, size, and cost)*

GWE was the Primary Designer for a vacuum collection sewer system into a highly developed neighborhood located in Stuart, Florida. The North River Shores, Phase 2 Sewer Expansion project included the design and construction of a 5,000 feet of force main of which 300 feet was with FDOT limited access right of way.

The scope of work included preparing design plans and a permit application in accordance with the FDOT Utility Accommodation Manual to begin the process. Working closely with the FDOT including coordination with Utility Companies (FPL, ATT, Comcast, FC Gas, and Ferrell Gas on 1-9-17 per the permit app) the work was successfully permitted.

GWE served as the Engineer-of-Record on this project, which was designed in-house.

Professional fees: \$1,093,395

Construction cost is \$1.5M for the vacuum station
\$4.5M for the collection system.

25. FIRMS FROM SECTION C INVOLVED WITH THIS PROJECT

a.	(1) FIRM NAME Giffels-Webster Engineers, Inc.	(2) FIRM LOCATION <i>(City and State)</i> Englewood, Florida	(3) ROLE EOR/CEI
b.	(1) FIRM NAME	(2) FIRM LOCATION <i>(City and State)</i>	(3) ROLE
c.	(1) FIRM NAME	(2) FIRM LOCATION <i>(City and State)</i>	(3) ROLE
d.	(1) FIRM NAME	(2) FIRM LOCATION <i>(City and State)</i>	(3) ROLE
e.	(1) FIRM NAME	(2) FIRM LOCATION <i>(City and State)</i>	(3) ROLE
f.	(1) FIRM NAME	(2) FIRM LOCATION <i>(City and State)</i>	(3) ROLE

F. EXAMPLE PROJECTS WHICH BEST ILLUSTRATE PROPOSED TEAM'S QUALIFICATIONS FOR THIS CONTRACT <i>(Present as many projects as requested by the agency, or 10 projects, if not specified. Complete one Section F for each project.)</i>		20. EXAMPLE PROJECT KEY NUMBER 2
21. TITLE AND LOCATION <i>(City and State)</i> MIDNIGHT PASS WATER MAIN , SARASOTA, FL	22. YEAR COMPLETED	
	PROFESSIONAL SERVICES 2018	CONSTRUCTION <i>(If applicable)</i> November 2020

23. PROJECT OWNER'S INFORMATION

a. PROJECT OWNER Sarasota County Public Works	b. POINT OF CONTACT NAME Nancy Brooking, Project Manger	c. POINT OF CONTACT TELEPHONE NUMBER 305-393-1306
---	---	---

24. BRIEF DESCRIPTION OF PROJECT AND RELEVANCE TO THIS CONTRACT *(Include scope, size, and cost)*

The project work consists of the construction of approximately 1,000 linear feet of ten through sixteen inch (10"-16") diameter ductile iron water main installed by direct bury methods within FDOT rights of way in Siesta Key, FL.

The primary purpose of the new water main will be to replace and up size the existing asbestos cement water main infrastructure. The existing pipe will be abandoned and removed or grouted in accordance with the drawings. Water services will be re-connected to the proposed main.

Professional Fees: \$145,840

Construction cost: To Be Determined

25. FIRMS FROM SECTION C INVOLVED WITH THIS PROJECT

a.	(1) FIRM NAME Giffels-Webster Engineers, Inc.	(2) FIRM LOCATION <i>(City and State)</i> Englewood, Florida	(3) ROLE EOR/CEI
b.	(1) FIRM NAME	(2) FIRM LOCATION <i>(City and State)</i>	(3) ROLE
c.	(1) FIRM NAME	(2) FIRM LOCATION <i>(City and State)</i>	(3) ROLE
d.	(1) FIRM NAME	(2) FIRM LOCATION <i>(City and State)</i>	(3) ROLE
e.	(1) FIRM NAME	(2) FIRM LOCATION <i>(City and State)</i>	(3) ROLE
f.	(1) FIRM NAME	(2) FIRM LOCATION <i>(City and State)</i>	(3) ROLE

F. EXAMPLE PROJECTS WHICH BEST ILLUSTRATE PROPOSED TEAM'S QUALIFICATIONS FOR THIS CONTRACT <i>(Present as many projects as requested by the agency, or 10 projects, if not specified. Complete one Section F for each project.)</i>		20. EXAMPLE PROJECT KEY NUMBER 3
21. TITLE AND LOCATION <i>(City and State)</i> CAPE HAZE RECLAIM AND FORCE MAIN, ENGLEWOOD, FL	22. YEAR COMPLETED PROFESSIONAL SERVICES DECEMBER 2020	CONSTRUCTION <i>(If applicable)</i> DECEMBER 2020

23. PROJECT OWNER'S INFORMATION

a. PROJECT OWNER Charlotte County Utilities	b. POINT OF CONTACT NAME Thomas Dunn, P.E.	c. POINT OF CONTACT TELEPHONE NUMBER 941-743-1378
---	--	---

24. BRIEF DESCRIPTION OF PROJECT AND RELEVANCE TO THIS CONTRACT *(Include scope, size, and cost)*

Reclaimed Water Main & Sewer Force Main. 16" reclaimed water main along Cape Haze Drive from Placida Road to the CCU Rotonda WRF for a total distance of approximately 8,000 LF. 12" sewer force main along Cape Haze Drive from Placida Road to the CCU Rotonda WRF for a total distance of approximately 6,750 LF. Giffels-Webster Engineers, Inc. (GWE) serves as the Engineer-of-Record on this project, which was designed in-house.

Professional fees: \$170K

Construction Cost: To Be Determined (estimated \$1.9M)

25. FIRMS FROM SECTION C INVOLVED WITH THIS PROJECT

a.	(1) FIRM NAME Giffels-Webster Engineers, Inc.	(2) FIRM LOCATION <i>(City and State)</i> Englewood, Florida	(3) ROLE EOR
b.	(1) FIRM NAME	(2) FIRM LOCATION <i>(City and State)</i>	(3) ROLE
c.	(1) FIRM NAME	(2) FIRM LOCATION <i>(City and State)</i>	(3) ROLE
d.	(1) FIRM NAME	(2) FIRM LOCATION <i>(City and State)</i>	(3) ROLE
e.	(1) FIRM NAME	(2) FIRM LOCATION <i>(City and State)</i>	(3) ROLE
f.	(1) FIRM NAME	(2) FIRM LOCATION <i>(City and State)</i>	(3) ROLE

F. EXAMPLE PROJECTS WHICH BEST ILLUSTRATE PROPOSED TEAM'S QUALIFICATIONS FOR THIS CONTRACT <i>(Present as many projects as requested by the agency, or 10 projects, if not specified. Complete one Section F for each project.)</i>		20. EXAMPLE PROJECT KEY NUMBER 4		
21. TITLE AND LOCATION <i>(City and State)</i> OLEAN BOULEVARD, PORT CHARLOTTE, FL	22. YEAR COMPLETED <table border="1"> <tr> <td>PROFESSIONAL SERVICES June 2021</td> <td>CONSTRUCTION <i>(If applicable)</i> June 2021</td> </tr> </table>		PROFESSIONAL SERVICES June 2021	CONSTRUCTION <i>(If applicable)</i> June 2021
PROFESSIONAL SERVICES June 2021	CONSTRUCTION <i>(If applicable)</i> June 2021			

23. PROJECT OWNER'S INFORMATION

a. PROJECT OWNER Charlotte County Public Works	b. POINT OF CONTACT NAME Jeff Keyser, Project Manager	c. POINT OF CONTACT TELEPHONE NUMBER 941-575-3644
--	---	---

24. BRIEF DESCRIPTION OF PROJECT AND RELEVANCE TO THIS CONTRACT *(Include scope, size, and cost)*

Provide sub consultant services regarding the Olean Boulevard widening project, including meeting with the county, review and submit an alternatives analysis report, provide graphics, documents and be present at the public meetings, prepare and present a power point presentation to the board of commissioners.

Potable Water Main & Reclaimed Water Main (US 41 to Easy Street)
 Potable Water Main: 795 lf (6"), 2,315 lf (8"), 7,140 lf (12"), 1,653 lf (16")
 Reclaimed Water Main: 765 lf (6"), 2,920 lf (8"), 5,920 lf (12"), 1,120 lf (16")

Sewer Force Main & Gravity Sewer (US 41 to Easy street & additional offsite)
 Sewer Force Main: 85 lf (12"), 110 lf (16"), 4,560 lf (24")
 Gravity Sewer: 6,330 lf (8"), 1,260 lf (10"), 1,535 lf (12") & 38 manholes

Design fee: \$80,000

Construction cost: \$3.7m (estimated)

25. FIRMS FROM SECTION C INVOLVED WITH THIS PROJECT

	(1) FIRM NAME	(2) FIRM LOCATION <i>(City and State)</i>	(3) ROLE
a.	Giffels-Webster Engineers, Inc.	Englewood, Florida	EOR (Utilities)
b.			
c.			
d.			
e.			
f.			

F. EXAMPLE PROJECTS WHICH BEST ILLUSTRATE PROPOSED TEAM'S QUALIFICATIONS FOR THIS CONTRACT <i>(Present as many projects as requested by the agency, or 10 projects, if not specified. Complete one Section F for each project.)</i>		20. EXAMPLE PROJECT KEY NUMBER 5
21. TITLE AND LOCATION <i>(City and State)</i> PLACIDA ROAD UTILITY MAINS (NORTH AND SOUTH), Englewood, FL	22. YEAR COMPLETED	
	PROFESSIONAL SERVICES 2018	CONSTRUCTION <i>(If applicable)</i> 2018

23. PROJECT OWNER'S INFORMATION

a. PROJECT OWNER Charlotte County Utilities	b. POINT OF CONTACT NAME Bruce R. Bullert, P.E.	c. POINT OF CONTACT TELEPHONE NUMBER 941-764-4509
--	--	--

24. BRIEF DESCRIPTION OF PROJECT AND RELEVANCE TO THIS CONTRACT *(Include scope, size, and cost)*

Reclaimed Water Main & Potable Water Main

- 16" reclaimed water main on Placida Road from the Cape Haze Drive to Coral Creek for a total of 17,600 LF, or 3.3 miles.
- 12" reclaimed water main along Rotonda Blvd West from Placida Road to Boundary Blvd, for approximately 5,000 feet.
- 12" potable water main along Placida Road for a distance of approximately 3,500 L.F. plus approximately 750 LF (12") on Rotonda Blvd West and 500 LF of 6" water main on Gasparilla Pines.
- 16" reclaimed water main on Placida Road from the Boca Grande Causeway intersection along Gasparilla Road, crossing Coral Creek (sub-aqueous) and tying into the existing reclaimed water main for a total distance of approximately 3,000 LF.
- 16" reclaimed water main along Placida Road from the Boca Grande Causeway intersection to Cape Haze Drive. The total length of this segment is approximately 10,400 LF or 2 miles.
- 10" force main along Placida Road from the Boca Grande Causeway intersection to Cape Haze Drive. The total length of the force main improvements is approximately 10,400 LF.

Design fee \$448,000

Construction costs \$6.3M

25. FIRMS FROM SECTION C INVOLVED WITH THIS PROJECT

a.	(1) FIRM NAME Giffels-Webster Engineers, Inc.	(2) FIRM LOCATION <i>(City and State)</i> Englewood, Florida	(3) ROLE EOR
b.	(1) FIRM NAME	(2) FIRM LOCATION <i>(City and State)</i>	(3) ROLE
c.	(1) FIRM NAME	(2) FIRM LOCATION <i>(City and State)</i>	(3) ROLE
d.	(1) FIRM NAME	(2) FIRM LOCATION <i>(City and State)</i>	(3) ROLE
e.	(1) FIRM NAME	(2) FIRM LOCATION <i>(City and State)</i>	(3) ROLE
f.	(1) FIRM NAME	(2) FIRM LOCATION <i>(City and State)</i>	(3) ROLE

F. EXAMPLE PROJECTS WHICH BEST ILLUSTRATE PROPOSED TEAM'S QUALIFICATIONS FOR THIS CONTRACT <i>(Present as many projects as requested by the agency, or 10 projects, if not specified. Complete one Section F for each project.)</i>		20. EXAMPLE PROJECT KEY NUMBER 6		
21. TITLE AND LOCATION <i>(City and State)</i> Bocilla Utilities Water Distribution Infrastructure, Englewood, Florida		22. YEAR COMPLETED <table border="1"> <tr> <td>PROFESSIONAL SERVICES 2016</td> <td>CONSTRUCTION <i>(If applicable)</i> N/A</td> </tr> </table>	PROFESSIONAL SERVICES 2016	CONSTRUCTION <i>(If applicable)</i> N/A
PROFESSIONAL SERVICES 2016	CONSTRUCTION <i>(If applicable)</i> N/A			

23. PROJECT OWNER'S INFORMATION

a. PROJECT OWNER Bocilla Utilities, Inc.	b. POINT OF CONTACT NAME Craig Noden, Project Manager	c. POINT OF CONTACT TELEPHONE NUMBER 941-769-0561
--	---	---

24. BRIEF DESCRIPTION OF PROJECT AND RELEVANCE TO THIS CONTRACT *(Include scope, size, and cost)*

Provide construction estimates of water expansion for the Bocilla Utilities Water Distribution Infrastructure along Placida Road and on Knight Island located in Charlotte County.

Unique Facts

- Knight Island is a bridgeless barrier island
- 400 Potable Water Service Connections
- Water Systems Reproduction Cost valued at \$4.5 M
- Cost Valuation produced for FL PSC Utilities Rate Case
- PSC Rate Case for Conversion of Water Supply from an on-island RO Plant to an interconnect with EWD

25. FIRMS FROM SECTION C INVOLVED WITH THIS PROJECT

a.	(1) FIRM NAME Giffels-Webster Engineers, Inc.	(2) FIRM LOCATION <i>(City and State)</i> Englewood, Florida	(3) ROLE Engineer
b.	(1) FIRM NAME	(2) FIRM LOCATION <i>(City and State)</i>	(3) ROLE
c.	(1) FIRM NAME	(2) FIRM LOCATION <i>(City and State)</i>	(3) ROLE
d.	(1) FIRM NAME	(2) FIRM LOCATION <i>(City and State)</i>	(3) ROLE
e.	(1) FIRM NAME	(2) FIRM LOCATION <i>(City and State)</i>	(3) ROLE
f.	(1) FIRM NAME	(2) FIRM LOCATION <i>(City and State)</i>	(3) ROLE

F. EXAMPLE PROJECTS WHICH BEST ILLUSTRATE PROPOSED TEAM'S QUALIFICATIONS FOR THIS CONTRACT <i>(Present as many projects as requested by the agency, or 10 projects, if not specified. Complete one Section F for each project.)</i>	20. EXAMPLE PROJECT KEY NUMBER 7
---	--

21. TITLE AND LOCATION <i>(City and State)</i> BOCA VISTA REUSE LINE, ENGLEWOOD, FLORIDA	22. YEAR COMPLETED	
	PROFESSIONAL SERVICES 2019	CONSTRUCTION <i>(If applicable)</i> 2020

23. PROJECT OWNER'S INFORMATION

a. PROJECT OWNER Whippo Company, Inc.	b. POINT OF CONTACT NAME Charlie Whippo, President	c. POINT OF CONTACT TELEPHONE NUMBER 941-468-3100
---	--	---

24. BRIEF DESCRIPTION OF PROJECT AND RELEVANCE TO THIS CONTRACT *(Include scope, size, and cost)*

Design of a 4" reclaimed water service line along Gasparilla Road (CR 771) to serve a two acre residential complex for irrigation of 2 acres and a demand of 8000 gpd. Plans included directional drilling under C.R. 771 and tie in to a master meter and pump system.

Cost: \$50,000

Year Completed: June 2020

GWE Team Jonathan H. Cole, P.E., Chris Orren

25. FIRMS FROM SECTION C INVOLVED WITH THIS PROJECT

a.	(1) FIRM NAME Giffels-Webster Engineers, Inc.	(2) FIRM LOCATION <i>(City and State)</i> Englewood, Florida	(3) ROLE EOR
b.	(1) FIRM NAME	(2) FIRM LOCATION <i>(City and State)</i>	(3) ROLE
c.	(1) FIRM NAME	(2) FIRM LOCATION <i>(City and State)</i>	(3) ROLE
d.	(1) FIRM NAME	(2) FIRM LOCATION <i>(City and State)</i>	(3) ROLE
e.	(1) FIRM NAME	(2) FIRM LOCATION <i>(City and State)</i>	(3) ROLE
f.	(1) FIRM NAME	(2) FIRM LOCATION <i>(City and State)</i>	(3) ROLE

F. EXAMPLE PROJECTS WHICH BEST ILLUSTRATE PROPOSED TEAM'S QUALIFICATIONS FOR THIS CONTRACT <i>(Present as many projects as requested by the agency, or 10 projects, if not specified. Complete one Section F for each project.)</i>		20. EXAMPLE PROJECT KEY NUMBER 8
21. TITLE AND LOCATION <i>(City and State)</i> EAST/WEST SPRING LAKE PILOT WASTEWATER PROGRAM, AREAS A, B AND C DESIGN, PORT CHARLOTTE, FL	22. YEAR COMPLETED PROFESSIONAL SERVICES 2015	CONSTRUCTION <i>(If applicable)</i> 2018

23. PROJECT OWNER'S INFORMATION

a. PROJECT OWNER Charlotte County Utilities	b. POINT OF CONTACT NAME Bruce R. Bullert, P.E.	c. POINT OF CONTACT TELEPHONE NUMBER 941-764-4509
---	---	---

24. BRIEF DESCRIPTION OF PROJECT AND RELEVANCE TO THIS CONTRACT *(Include scope, size, and cost)*

GWE was retained by Charlotte County Utilities as the Primary Designer to design and permit a new centralized vacuum sewer system and water main upgrades in existing developed neighborhoods known as "Spring Lake". The East/West Spring Lake Wastewater Expansion project involved the design and construction of a centralized vacuum collection sewer system into highly developed neighborhoods located in the Spring Lake subdivision in Port Charlotte. This project involved the planning and design of approximately 20 miles of vacuum, approximately 600 valve pits, water distribution lines, a vacuum pump station, and force main serving approximately 2,200 ERC's. GWE served as the Engineer-of-Record on this project, which was designed in-house.

This project was unique in that it was divided into three (3) projects and was constructed by three (3) contractors. In addition, the plans called for a phased construction in order to maintain traffic flow and detours from an adjacent road widening project and to minimize disruption for the residents. GWE also provided for the replacement and possible upsizing of the existing water main where the proposed vacuum main conflicts with existing CCU water mains. The requirements of the various utility services was recognized and properly coordinated during the project design. A 12" reclaimed water main was included in the design plans within the R-O-W. GWE prepared permit applications for the County's signature along with all data and drawing submittals by the agencies requiring permit submittals. GWE also provided assistance with Bid Phase services, as well as limited CEI services, assisting Charlotte County with the inspection techniques, project management and record drawing procedures.

Professional Fees: \$1,065,950
 Construction Cost \$15, 847,573

25. FIRMS FROM SECTION C INVOLVED WITH THIS PROJECT

a.	(1) FIRM NAME Giffels-Webster Engineers, Inc.	(2) FIRM LOCATION <i>(City and State)</i> Englewood, Florida	(3) ROLE EOR
b.	(1) FIRM NAME	(2) FIRM LOCATION <i>(City and State)</i>	(3) ROLE
c.	(1) FIRM NAME	(2) FIRM LOCATION <i>(City and State)</i>	(3) ROLE
d.	(1) FIRM NAME	(2) FIRM LOCATION <i>(City and State)</i>	(3) ROLE
e.	(1) FIRM NAME	(2) FIRM LOCATION <i>(City and State)</i>	(3) ROLE
f.	(1) FIRM NAME	(2) FIRM LOCATION <i>(City and State)</i>	(3) ROLE

F. EXAMPLE PROJECTS WHICH BEST ILLUSTRATE PROPOSED TEAM'S QUALIFICATIONS FOR THIS CONTRACT <i>(Present as many projects as requested by the agency, or 10 projects, if not specified. Complete one Section F for each project.)</i>		20. EXAMPLE PROJECT KEY NUMBER 9
21. TITLE AND LOCATION <i>(City and State)</i> Phillippi Creek Septic System Replacement Prog. Area O&P, Sarasota, FL	22. YEAR COMPLETED	
	PROFESSIONAL SERVICES 2017	CONSTRUCTION <i>(If applicable)</i> 2017

23. PROJECT OWNER'S INFORMATION

a. PROJECT OWNER	b. POINT OF CONTACT NAME	c. POINT OF CONTACT TELEPHONE NUMBER
Sarasota County Utilities	John J. Saputo, Project Manager	941-650-0022

24. BRIEF DESCRIPTION OF PROJECT AND RELEVANCE TO THIS CONTRACT *(Include scope, size, and cost)*

This project involved the design and inspection services of a centralized *vacuum sewer* collection system, vacuum station, and water line replacement into a highly developed neighborhood located in Sarasota, Florida, between Clark Road, to the south, and Proctor Road to the north, and U.S. 41 to the west and Beneva Road to the east. This project involved the planning and design of approximately 12.9 miles of vacuum pipe, and 570 valve pits serving approximately 1,247 ERC's.

Cost: Collection System: \$6.4M, Vacuum Station: \$1M,
 Water Main: \$4M; Total: \$16.5M

25. FIRMS FROM SECTION C INVOLVED WITH THIS PROJECT

	(1) FIRM NAME	(2) FIRM LOCATION <i>(City and State)</i>	(3) ROLE
a.	Giffels-Webster Engineers, Inc.	Englewood, Florida	EOR
b.			
c.			
d.			
e.			
f.			

F. EXAMPLE PROJECTS WHICH BEST ILLUSTRATE PROPOSED TEAM'S QUALIFICATIONS FOR THIS CONTRACT <i>(Present as many projects as requested by the agency, or 10 projects, if not specified. Complete one Section F for each project.)</i>		20. EXAMPLE PROJECT KEY NUMBER 10
21. TITLE AND LOCATION <i>(City and State)</i> SOUTHPORT SEWER EXPANSION, PORT ST. LUCIE, FLORIDA		22. YEAR COMPLETED PROFESSIONAL SERVICES 2017 CONSTRUCTION <i>(If applicable)</i> 2021

23. PROJECT OWNER'S INFORMATION

a. PROJECT OWNER City of Port St. Lucie	b. POINT OF CONTACT NAME Richard Schoenborn, P.E., Project Engineer	c. POINT OF CONTACT TELEPHONE NUMBER 772-873-6485
---	---	---

24. BRIEF DESCRIPTION OF PROJECT AND RELEVANCE TO THIS CONTRACT *(Include scope, size, and cost)*

The Southport Unit 5 Vacuum Sewer Design project involves the design of a centralized vacuum collection sewer system into a highly developed neighborhood located in Port St. Lucie, Florida that is currently served with gravity sewer. Buffer tanks to be installed at each gravity lift station.

This project involves the planning and design of approximately 11,000 feet of vacuum pipe, 12 buffer tanks, a vacuum pump station, and force main serving approximately 427 ERC's.

Unique Features:

This project is unique in that the vacuum station will complement the existing neighborhood. Moreover, it utilizes buffer tanks that will replace existing lift stations so that all of the primary gravity collection system can remain in place. The vacuum station will have a "Key West" look so that it blends in with its surroundings and looks more like a residential home, than a vacuum station.

Professional fees: \$499,835.00

Construction cost: (Estimated) Vacuum Station: \$1.5M, Collection Area: \$2.5M.

25. FIRMS FROM SECTION C INVOLVED WITH THIS PROJECT

a.	(1) FIRM NAME Giffels-Webster Engineers, Inc.	(2) FIRM LOCATION <i>(City and State)</i> Englewood, Florida	(3) ROLE EOR/CEI
b.	(1) FIRM NAME	(2) FIRM LOCATION <i>(City and State)</i>	(3) ROLE
c.	(1) FIRM NAME	(2) FIRM LOCATION <i>(City and State)</i>	(3) ROLE
d.	(1) FIRM NAME	(2) FIRM LOCATION <i>(City and State)</i>	(3) ROLE
e.	(1) FIRM NAME	(2) FIRM LOCATION <i>(City and State)</i>	(3) ROLE
f.	(1) FIRM NAME	(2) FIRM LOCATION <i>(City and State)</i>	(3) ROLE

TAB 5

**MANAGEMENT APPROACH/
PROJECT CONTROL**

**CITY OF NORTH PORT - RFP NO. 2020-58
PROFESSIONAL ENGINEERING SERVICES-CONTINUING SERVICES CONTRACT FOR
CITY OF NORTH PORT UTILITIES DEPARTMENT**

TAB 5: MANAGEMENT APPROACH/PROJECT CONTROL

One would think that the planning and design of a utility pipeline should be relatively easy. After all, it's just a bunch of pipes buried a few feet down into the dirt. If it's a pipe system for a brand new subdivision in wide open land with virtually no conflicts; indeed it *is* relatively easy.

Unfortunately, for City utility pipelines installed or replaced in an existing street network, it's not that simple. Now it becomes quite problematic because there are all sorts of conflicts that makes things far more challenging. Moreover, the Utility is working in areas that many times are controlled by others such as Public Works, or easements owned by others. In addition, other utilities have their systems in the same areas, so cooperation and coordination are paramount.

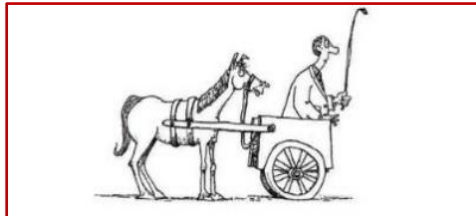

Installing new water, sewer and reuse mains into existing roads is a little like putting the *cart before the horse*. Utility lines are normally the deepest lines, so installing them *after* everything else is built is both disruptive and expensive.

Natural constraints such as canals, major roads, and future expansion plans, as well as political boundaries, needs to be integrated into the planning process.

We know because we have provided the planning, design, surveying, for many similar utility projects in the last five years including:

- New 12" water main and a 12" and 16" reclaimed main along Placida road for over 3 miles for Charlotte County Utilities
- New 12" force main and 16" reclaimed main, 8000 feet long along Cape Haze drive for Charlotte County Utilities
- New 6", 8", 12" and 16" water mains ; 6", 8", 12" and 16" reclaimed mains; 12" 16" and 24" force mains and new 8" ,10" and 12" gravity sewer along Olean Boulevard in Port Charlotte for CCU
- New septic to sewer expansion in North River Shores with miles of sewer collection and over 5000 feet of force main for Martin County

The planning and design of all these projects were successfully completed on time and within the budget constraints of the client. Additional projects and project details are contained in TAB 4.

For virtually all our utility projects, we use the following approach:

General Project Approach

Overall Project Definition: This task will define and verify the project limits. This task will also involve the investigation of existing infrastructure for opportunities to connect and utilize for cost savings.

Parcel Verification: A property identification process using sources such as the Property Appraiser’s Office, and other information obtained from the utility customer reports.

Preliminary Planning Effort: GWE will compile the collected data into a base map indicating existing facilities, property identification, pump station sites, preliminary line schematics, and potential conflicts.

Preliminary Financial Analysis: GWE prepares cost estimates based on the best available historical information and our large database of utility costs for similar projects.

Preliminary Design Report: Once accurate conceptual layouts and cost estimates are obtained, based on the project specifics, the final recommendations will be compiled in an abbreviated PDR.

Public Outreach Program: For larger projects, sometimes a “Public Relations Firm” on the design team is helpful. However, the majority of smaller projects may not require an independent firm. GWE has conducted numerous Public Outreach Programs for many utility installation projects. GWE maintains a *Toll Free Hot Line* (866-556-2200) for customer service.

Our programs can include:

- Neighborhood Notification Processes
- Conducting Public Meetings or assessment hearings
- Customer Service Complaint Resolution through our telephone Hot-Line Program

Utility Design and Plan Preparation

Surveying and Data Acquisition: Survey services will be directed by GWE, but subcontracted to RWA, Inc.

Construction Plans: Standard “plan–profile” sheets, where the existing utilities are plotted, along with the existing infrastructure, key elevations, and other design constraints. The pipeline system are placed on the plans, with special attention to any potential conflicts.

Value Engineering and QA/QC: GWE provides value engineering for numerous utility projects, both for in-house projects as well as serving as the value engineering/quality control reviewer to other engineering firms.

MOT Plans: GWE has in-house staff to produce certified Maintenance of Traffic (M.O.T.) plans. Our staff is certified by the ATSSA and FDOT for M.O.T. GWE has provided M.O.T. plans for many major construction projects.

Project Cost Estimates: GWE will prepare a final cost estimate based on the most current historic information and the final construction plans.

Bid Documents and Specifications: GWE will prepare a concise set of quantity takeoffs and bid documents that incorporate the technical details with the City’s standard documents, so a fair “unit price” bid is received.

Pre-Bid Meetings and Pre-Construction Meetings: The extra effort GWE puts forth at pre-bid meetings to educate the potential bidders, results in receiving multiple responsible bids that fall within the budgeted funds.

GWE Workload

We typically have one *utility* project under construction and two or three large projects in the design process. We have just completed the large Port St Lucie project. We also completed the design of the Martin County Golden Gate project and wrapping up the Old Palm City (60% design) project. Olean Boulevard and Cape Haze design are all complete and both are under construction.

We are currently wrapping up the City of North Port’s Master Sewer Plan and anticipate completion by mid-summer. We have also been selected by the City of Venice for the Bay Indies Project however; we have not received a contract yet.

The “bottom line” is, with only a couple active projects, we have ample manpower capacity to focus on future City of North Port utility projects and meet your project time schedules.

Available facilities, technological capabilities and resources

The GWE office has been established in Englewood for decades. It’s our main office and not just a branch, and a fully staffed engineering office with all the necessary computers, latest design software and equipment to provide the City with quality design utility plans. We also have ground-penetrating radar for locating existing potential conflicts and large databases of construction costs and details to draw from.

THE BOTTOM LINE FOR THE CITY OF NORTH PORT

When it comes to pipeline planning and design, GWE has “*been there and done that*”, making the right calls and providing a quality product at a reasonable cost, in a timely manner.

TAB 6

REFERENCES

**CITY OF NORTH PORT - RFP NO. 2020-58
PROFESSIONAL ENGINEERING SERVICES-CONTINUING SERVICES CONTRACT FOR
CITY OF NORTH PORT UTILITIES DEPARTMENT**

TAB 6: EXPERIENCES AND REFERENCES

In the past five years, GWE has participated in numerous similar projects for the planning and design of water, wastewater and reuse systems.

Englewood Water District
Keith Ledford, Jr., P.E.
Operational/Technical Support
Manager
201 Selma Avenue
Englewood, FL 34223
Phone: (941) 460-1020
Fax: (941) 460-1025
kledford@ewdfl.com

[Englewood Water District Vacuum Sewer System Project - Area V9-C, Englewood, Florida](#)

GWE was retained by the Englewood Water District (EWD) as the Primary Designer for a centralized vacuum sewer collection system, and water line replacement into a densely developed neighborhood located in Englewood, Florida. This project involved the design of approximately 5 miles of main line pipe, and 155 valve pits serving approximately 318 customers.

Project milestones:

Begin Design – November 7, 2014

End Design – August 15, 2015

Begin Construction - May 14, 2016

End construction - July 6, 2017

GWE Role: Primary Design and CEI

Key Personnel: Jonathan Cole, P.E. was the Principle/Project Manager. Dennis Croyle, P.E., Thomas Shaw and Randy Blackwell, all of which are still with the firm.

Costs: Consultant fees - \$346K. Construction Cost - \$3.9M

Sarasota County Public Works
John J. Saputo, IV,
Project Manager
1001 Sarasota Center Blvd
Sarasota, FL 34240
Phone: (941) 650-0022
Fax: (941) 861-0589
jsaputo@scgov.net

[Sarasota County Phillippi Creek Septic System Replacement Program - Area O & P, Sarasota, Florida](#)

GWE was retained by Sarasota County Public Works as the Primary Designer to design a centralized vacuum sewer collection system, vacuum station, and water line replacement into a highly developed neighborhood located in Sarasota, Florida. There were 1,247 connections and 570 valve pits.

Project Milestones:

Begin Design – January 20, 2009

End Design – January 30, 2012

Begin Construction - March 17, 2015

End construction - June 12, 2017

GWE Role: Primary Design and CEI

Key Personnel: Jonathan Cole, P.E., was the Principle/Project Manager and is still with the company. Steven Torchia, who is no longer with the company (retired), Thomas Shaw, and Randy Blackwell, both of whom are still with the firm.

Costs: Consultant fee was \$1.4M and the construction cost was \$16.5M.

Change orders: There were no change orders issued.

Sarasota County Public Works
Jaimol Charles, P.E.
Project Manager
1001 Sarasota Center Blvd
Sarasota, FL 34240
Phone: (941) 448-8991
Fax: (941) 861-0589
jcharles@scgov.net

[Sarasota County PCSSRP-Area N-3 Gravity Sewer Design, Sarasota, Florida](#)

GWE was retained as the Primary Designer to design a “hybrid” gravity sewer system. This project consists of four lift stations, 5,000 linear feet of force main and 60 manholes, serving approximately 225 connections into a highly developed neighborhood located in Sarasota, Florida.

Project Milestones:

Begin Design – June 17, 2014
End Design – April 22, 2016
Begin Construction – May 23, 2017
End construction – July, 2019

GWE Role: GWE served as the Engineer-of-Record on this project, which was designed in-house. CEI by others.

Key Personnel: Jonathan Cole, P.E., Principle and Dennis Croyle, P.E., Project Manager and is still with the firm.

Costs: Consultant fee was \$334K and the construction cost are estimated to be \$3.1M.

Change orders: None to date

Charlotte County Utilities
Bruce R. Bullert, P.E.
Engineering Services Manager
25550 Harborview Road, Suite 1
Port Charlotte, FL 33980
Phone: (941) 764-4509
Fax: (941) 764-4319
bruce.bullert@charlottecountyfl.gov

[Charlotte County Utilities - East/West Spring Lake Water Replacement, Sewer and Force Main, Contract B, Port Charlotte, Florida](#)

GWE was retained by Charlotte County Utilities as the Primary Designer to design and permit a new centralized vacuum sewer system and water main upgrades in existing developed neighborhoods known as “Spring Lake”. There are 1,086 sewer connections and 262 valve pits.

Project Milestones:

Begin Design – February 18, 2014
End Design – September 22, 2014
Begin Construction – May 8, 2015
End construction – December 15, 2016

GWE Role: GWE served as the Engineer-of-Record on this project, which was designed in-house. CEI by others.

Key Personnel: Jonathan Cole, P.E., was the Principle and Dennis Croyle, P.E., was the Project Manager and is still with the firm.

Costs: The consultant fee was \$480K and the construction cost was \$8M.

Change orders: There were no change orders issued.

Charlotte County Utilities
Bruce R. Bullert, P.E.
Engineering Services Manager
25550 Harborview Road, Suite 1
Port Charlotte, FL 33980
Phone: (941) 764-4509
Fax: (941) 764-4319
bruce.bullert@charlottecountyfl.gov

[Charlotte County Utilities - East/West Spring Lake Vacuum Sewer, Water Main upgrade and Force Main, Contract C, Port Charlotte, Florida](#)

GWE was retained by Charlotte County Utilities as the Primary Designer to design and permit a new centralized vacuum sewer system and water main upgrades in existing developed neighborhoods known as "Spring Lake". There are 809 sewer connections and 343 valve pits.

Project Milestones:

Begin Design - February 18, 2014
End Design – February 26, 2015
Begin Construction – May 12, 2015
End construction – December 10, 2016

GWE Role: GWE served as the Engineer-of-Record on this project, which was designed in-house. CEI by others.

Key Personnel: Jonathan Cole, P.E., was the Principle and Dennis Croyle, P.E., was the Project Manager and is still with the firm.

Costs: Consultant fee was \$373K and the construction cost was \$7.2 M.

Change orders: There were no change orders issued.

Charlotte County Utilities
Bruce R. Bullert, P.E.
Engineering Services Manager
25550 Harborview Road, Suite 1
Port Charlotte, FL 33980
Phone: (941) 764-4509
Fax: (941) 764-4319
bruce.bullert@charlottecountyfl.gov

[Charlotte County Utilities - East/West Spring Lake Vacuum Sewer and Force Main, Contract D, Port Charlotte, Florida](#)

GWE was retained by Charlotte County Utilities as the Primary Designer to design and permit a new centralized vacuum sewer system and water main upgrades in existing developed neighborhoods known as "Spring Lake". There are 381 sewer connections and 168 valve pits.

Project Milestones:

Begin Design – September 8, 2015
End Design – July 11, 2016
Begin Construction – January 24, 2017
End construction – June 27, 2018

GWE Role: GWE served as the Engineer-of-Record on this project, which was designed in-house. CEI by others.

Key Personnel: Jonathan Cole, P.E., was the Principle and Dennis Croyle, P.E., was the Project Manager and is still with the firm.

Cost: Consultant fee was \$266K and the construction cost was \$6.7M.

Martin County Utilities
Phil Keathley
Chief Project Manager
3473 SE Willoughby Blvd,
Ste. 102, Stuart, FL 34994
Phone: (772) 223-7977
Fax: (772) 221-1447
pkeathle@martin.fl.us

[Martin County Utilities, North River Shores - Phase 2, Sewer Expansion, Stuart, Florida](#)

GWE is the Primary Designer for a vacuum collection sewer system into a highly developed neighborhood located in Stuart, Florida. This project consisted of approximately 24,000 feet (4.5 miles) of vacuum pipe, approximately 140 valve pits, a vacuum pump station, and a force main serving approximately 250 connections.

Project Milestones:

Begin Design – March 11, 2016

End Design – February 16, 2017

Begin Construction – September 21, 2018

End construction – June, 2019 (anticipated)

GWE Role: GWE served as the Engineer-of-Record on this project and the CEI.

Key Personnel: Jonathan Cole, P.E., is the Principle, Dennis Croyle, P.E., and Randy Blackwell, CEI and are still with the firm.

Costs: Consultant fee was \$177K and the construction cost is \$1.5M for the vacuum station and \$4.5M for the collection system.

Change orders: There are no change orders issued to date.

TAB 7

LITIGATION AND INSURANCE

**CITY OF NORTH PORT - RFP NO. 2020-58
PROFESSIONAL ENGINEERING SERVICES- CONTINUING SERVICES CONTRACT FOR
CITY OF NORTH PORT UTILITIES DEPARTMENT**

TAB 7: LITIGATION AND INSURANCE

LITIGATION:

Have you been involved in litigation in the last five (5) years? If so, describe circumstances and outcome.

No

INSURANCE:

The proposer shall advise the amount of liability insurance they carry.

The amount of liability insurance Giffels-Webster Engineer's has is \$2 million.

TAB 8

ADDITIONAL INFORMATION

**CITY OF NORTH PORT - RFP NO. 2020-58
PROFESSIONAL ENGINEERING SERVICES-CONTINUING SERVICES CONTRACT FOR
CITY OF NORTH PORT UTILITIES DEPARTMENT**

TAB 8: ADDITIONAL INFORMATION

GWE Awards / Accomplishments / Recommendations:

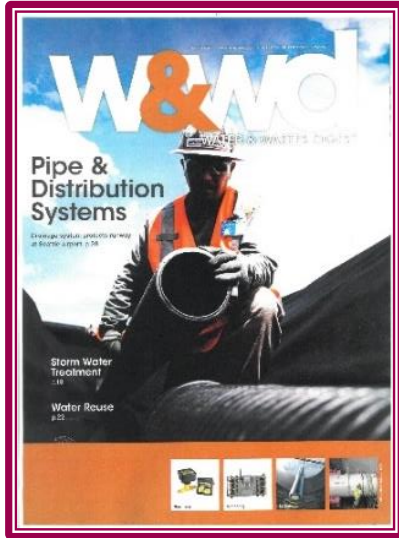

GWE has received awards and numerous letters of recommendation for design services for our quality of work on numerous types of projects.

Our designs for utility projects have been referenced in numerous publications, including *Public Works Magazine*, the October 2003 issue, and numerous other *AIRVAC, Inc.* Publications/literature.

In the March, 2017 issue of *“Water and Waste Digest”* (left), GWE is mentioned as looking into vacuum sewers to be an “affordable alternative” to gravity sewer designs. We have also received several letters of recommendations from different agencies over the years.

GWE has also received awards and numerous letters of recommendation for design services for our quality of work on numerous types of roadway and drainage projects.

In 2016, GWE received the American Public Works Association (APWA) **“Consultant of the Year”** award (stormwater category) for the U.S.-41 micro-tunnel project for the Charlotte County Public Works Department. (right)



Completed Elkcarn Waterway downstream U.S. 41, Port Charlotte, Florida. (left)

Charlotte County retained GWE, who investigated and recommended “micro-tunneling” as an alternate to open cutting for U.S. 41.

Charlotte County and the Florida Department of Transportation concurred on the innovative concept. Excellence in project design and construction resulted in successful completion of some of the largest micro-tunnel installations in the State of Florida.

The ultimate design included boring seven large diameter culverts ranging in size from 60” to 84” drilled over 150 feet, five feet below mean sea level under six lanes of traffic.

Also, the U.S. 41 Culverts and Weirs Project received National Attention in January 2016:



“I’m pleased to announce that American City and County Magazine featured Charlotte County Public Works Department’s U.S. 41 micro-tunnel project on the cover of its January issue...”

“The project, which employed a 96,000-pound, remotely controlled tunneling machine, earned the government-affairs trade publication’s Crown Communities Award.”

-Ray Sandrock, Charlotte County Administrator

GWE also received an award from APWA for the Sarasota County “Center Road Improvements Project” (right). The APWA recognized this project in its magazine as the 2008 Transportation Project of the Year.

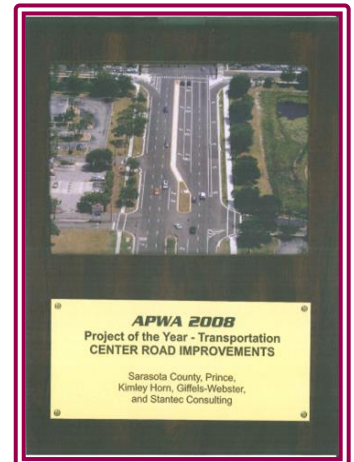

GWE was one of the recipients of the 2010-2011 Building of America Award (below) for our involvement in the City of Fort Myers “Downtown Utility Replacement & Streetscape Improvement Project” located in Fort Myers, Florida.



GWE was also recognized by the Englewood-Cape Haze area Chamber of Commerce with a long standing “20 Year Plus” Award. This award is given to companies that have been established members for over 20 years indicating dedication to the area. While this award does not tie to engineering, it does reflect the commitment GWE has in giving back to the community.

Repeat Business:

GWE prides itself with our professional working relationships with our many clients we have developed over the years. Our projects have time and again come in under or within budget, and we are very pleased to say that much of our business is repeat with long-standing local clients such as the residents, contractors, business entities, the Englewood Water District (EWD), and Sarasota, Manatee, Martin and Charlotte County Governments, as well as the Cities of Palmetto, Venice, and the City of Punta Gorda.

Over the decades, we have received many letters of recommendation including this very latest one from the Gasparilla Island Bridge Authority.



GASPARILLA ISLAND BRIDGE AUTHORITY

P.O. Box 1918 • Boca Grande, FL 33921-1918

www.giba.us

Phone: 941-697-2271 • Fax: 941-697-5629

June 19, 2020

To Whom It May Concern:

The Gasparilla Island Bridge Authority has had the pleasure to work with Giffels-Webster Engineers on various projects. Services provided have included the design/construction inspection services of our administration building, design/construction inspection services of the toll plaza roof replacement, design/construction inspection services of our roadway, and currently the design/construction inspection services for safety improvements including the addition of a sidewalk on our property.

The staff at Giffels-Webster Engineers is knowledgeable and dependable. When you reach out to the firm with a question, the response is always timely and professional. Our roadway is the only land access to Boca Grande, Florida so detailed planning and design is an absolute must. Giffels-Webster has proven to be an asset to our organization.

We look forward to continuing our relationship with Giffels- Webster Engineers and they come with our highest recommendation.

If you need any additional information, please feel free to contact me at the number listed above.

Sincerely,

Kathy Banson-Verrico

GIBA Executive Director

H. ADDITIONAL INFORMATION

30. PROVIDE ANY ADDITIONAL INFORMATION REQUESTED BY THE AGENCY. ATTACH ADDITIONAL SHEETS AS NEEDED.

GWE has operated a successful engineering business in Southwest Florida for over 30 years, bringing a solid working knowledge of county, state and federal requirements.

GWE has its primary office located on Pine Street in Englewood and currently employs 10 personnel. All key staff members proposed for this RFP have been employed at GWE for several years providing stability and forming the core of our experience.

GWE Awards / Accomplishments:

GWE has received awards and numerous letters of recommendation for design services for our quality of work on numerous types of projects and multimodal improvements.

Recently, GWE received the American Public Works Association (APWA) 2016 "Consultant of the Year" award (stormwater category) for the U.S. Hwy. 41 Micro-tunnel project for the Charlotte County Public Works Department.

Charlotte County retained GWE, who investigated and recommended "micro-tunneling" as an alternate to open cutting for U.S. Hwy. 41. The County and Florida Department of Transportation concurred on the innovative concept. Excellence in project design and construction resulted in successful completion of some of the largest micro-tunnel installations in the State of Florida. The ultimate design included boring seven large diameter culverts ranging in size from 60" to 84" drilled over 150 feet, five feet below mean sea level under six lanes of traffic.

"A project of this magnitude presents all kinds of challenges, particularly when it came to keeping U.S. 41 open to traffic during construction. Remarkably, all has gone according to plan." Jeff Keyser, County Project Manager

Also, the U.S. 41 Culverts and Weirs Project received National Attention in January 2016:

"I'm pleased to announce that American City and County Magazine featured Charlotte County Public Works Department's U.S. 41 micro-tunnel project on the cover of its January issue..." "The project, which employed a 96,000-pound, remotely controlled tunneling machine, earned the government-affairs trade publication's Crown Communities Award", stated Ray Sandrock, the Charlotte County Administrator.

GWE also received an award from American Public Works Association for the Sarasota County "Center Road Improvements Project". The APWA recognized this project in its magazine as the 2008 Transportation Project of the Year.

GWE was one of the recipients of the 2010-2011 Building of America Award for our involvement in the City of Fort Myers Downtown Utility Replacement & Streetscape Improvement Project located in Fort Myers, Florida.

GWE was also recognized by the Englewood-Cape Haze area Chamber of Commerce with a long standing "20 Year Plus" Award. This award is given to companies that have been established members for over 20 years indicating dedication to the area. While this award does not tie to engineering, it does reflect the commitment GWE has in giving back to the community.

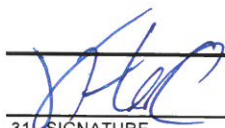

I. AUTHORIZED REPRESENTATIVE

The foregoing is a statement of facts.

31. SIGNATURE

32. DATE

7-17-20

33. NAME AND TITLE

Jonathan H. Cole, P.E., President

TAB 9

**SUBMISSION REQUIREMENTS AND
REQUIRED SUBMITTAL FORMS**

REQUEST FOR PROPOSAL NO. 2020-58
PROFESSIONAL ENGINEERING SERVICES-CONTINUING SERVICES CONTRACTS FOR
CITY OF NORTH PORT UTILITIES DEPARTMENT

- Lobbying Certification
- Conflict of Interest Form
- Disclosure Form (Consultant/Engineer/Architect)

- Scrutinized Business Certification Form

State Registration Requirements (<http://www.sunbiz.org/search.html>)

Copy of Registration, Attached

State required license for Prime Firm Only (Not sub-consultants)

SAMPLE INSURANCE CERTIFICATE: Demonstrate your firm's ability to comply with insurance requirements. Provide a previous certificate or other evidence listing the Insurance Companies names for both Professional Liability and General Liability and the dollar amounts of the coverage.

YES NO Sample Insurance Certificate is included with the submittal

MBE/WBE/VBE: If claiming Minority Business Enterprise/Women Business Enterprise/Veterans Business Enterprise, the Prime Firm (not sub-consultant) **shall be** certified as a Minority Business Enterprise by the State of Florida, Department of Management Services, Office of Supplier Diversity pursuant to Section 287.0943, Florida Statutes.

YES, CLAIMING MBE/WBE/VBE STATUS AS PRIME ONLY

YES, I'VE ATTACHED THE CERTIFICATE OF MBE/WBE/VBE STATUS FROM THE STATE OF FLORIDA AS OUTLINED SECTION 12.

NOT CLAIMING MBE/WBE/VBE

THIS PAGE MUST BE COMPLETED AND SUBMITTED WITH YOUR PROPOSAL

STATEMENT OF ORGANIZATION
(Information Sheet for Transactions and Conveyances Corporation Identification)

The following information will be provided to the City of North Port for incorporation in legal documents. It is, therefore, vital all information is accurate and complete. Please be certain all spelling, and capitalization is exactly as registered with the state or federal government.

Name of Respondent: Giffels-Webster Engineers, Inc.

DBA (if any): N/A

Type of Entity (Sole Proprietor, Corporation, LLC, LLP, Partnership, etc): Corporation

Business Address: 900 Pine Street, Suite 225, Englewood, FL 34223

Phone: 941-475-7981 **Fax:** 941-474-4285

E-Mail jcole@gweff.com

Print Name and Title of person authorized to bind: Jonathan H. Cole, P.E., President

Federal Identification Number: 38-2749086

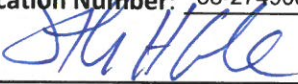
Signature: 

Respondent shall submit proof that it is authorized to do business in the State of Florida unless registration is not required by law.

(Please Check One)

Is this a Florida Corporation: Yes or No

If not a Florida Corporation,

In what state was it created: _____

Name as spelled in that State: _____

What kind of corporation is it: "For Profit" or "Not for Profit"

Is it in good standing: Yes or No

Authorized to transact business in Florida: Yes or No

State of Florida Department of State Certificate of Authority Document No.: _____

Does it use a registered fictitious name: Yes or No

THIS PAGE MUST BE SUBMITTED WITH PROPOSAL

REQUEST FOR PROPOSAL NO. 2020-58
PROFESSIONAL ENGINEERING SERVICES-CONTINUING SERVICES CONTRACTS FOR
CITY OF NORTH PORT UTILITIES DEPARTMENT

Names of Officers:

President: Jonathan H. Cole, P.E. **Secretary:** Dennis Croyle, P.E.

Vice President: Dennis Croyle, P.E. **Treasurer:** Jonathan H. Cole, P.E.

Director: _____ **Director:** _____

Other: _____ **Other:** _____

Name of Corporation (As used in Florida):

Giffels-Webster Engineers, Inc.

(Spelled exactly as it is registered with the state or federal government)

Corporate Address:

Post Office Box: _____
City, State Zip: _____
Street Address: 900 Pine Street, Suite 225
City, State, Zip: Englewood, FL 34223

STATE OF FLORIDA
COUNTY OF Charlotte

Sworn to (or affirmed) and subscribed before me by means of physical presence or remote notarization, this 17
day of July, 2020, by Jonathan H. Cole, P.E.

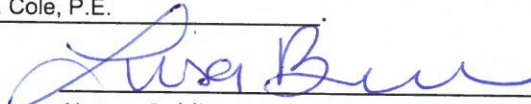

Notary Public - State of Florida



X Personally Known OR ___ Produced Identification
Type of Identification Produced _____

THIS PAGE MUST BE SUBMITTED WITH PROPOSAL

REQUEST FOR PROPOSAL NO. 2020-58
PROFESSIONAL ENGINEERING SERVICES-CONTINUING SERVICES CONTRACTS FOR
CITY OF NORTH PORT UTILITIES DEPARTMENT

REFERENCES/CLIENT LISTING

The firm shall provide a minimum of six (6) business related references for which they are currently providing or have provided within the last five (5) years, services similar to the scope of services required by this RFP. Of the six (6) references, please provide at least two (2) references for each of the following two disciplines: potable water treatment and wastewater treatment; and, provide at least one (1) reference for each of the following two disciplines: pipeline design and hydrogeology. If the firm has any indirect or direct potable reuse experience, please provide a reference. Attach additional sheets if necessary.

1. Business/Customer Name: Charlotte County Utilities Department

Name of Contact Person/Title: Bruce Bullert, P.E.

Telephone# 941-764-4509 Fax 941-861-0589 E-mail bruce.bullert@charlottecountyfl.gov

Address 25550 Harborview Road, Suite 1, Port Charlotte, FL 33980

Phone Number 941-764-4509 Discipline (circle): WTP; WWTF; pipeline; hydrogeo, potable reuse

Duration of Contract or business relationship 10+ Years

Type of Services Provided Water main, Sewer Main, Potable reuse design

2. Business/Customer Name: Martin County Utilities

Name of Contact Person/Title: Phil Keathley, Project Manager

Telephone# 772-223-7977 Fax 772-221-1447 E-mail pkeathle@martin.fl.us

Address 3473 SE Willoughby Blvd., Suite 102, Stuart, FL 34994

Phone Number 772-223-7977 Discipline (circle): WTP; WWTF; pipeline; hydrogeo, potable reuse

Duration of Contract or business relationship 10+ years

Type of Services Provided Sewer Design; Forcemain Design; Water Main Design; CEI Services

3. Business/Customer Name: Sarasota County Public Works

Name of Contact Person/Title: John J. Saputo, IV, Construction Administrator

Telephone# 941-650-0022 Fax 941-861-0589 E-mail jsaputo@scgov.net

Address 1001 Sarasota Center Blvd., Sarasota, FL 34240

Phone Number 941-650-0022 Discipline (circle): WTP; WWTF; pipeline; hydrogeo, potable reuse

Duration of Contract or business relationship 10+ Years

Type of Services Provided Sewer Design, Forcemain Design, Water Main Design, CEI Services

COMPANY NAME: Giffels-Webster Engineers, Inc.

SIGNATURE: 

THIS PAGE MUST BE SUBMITTED WITH PROPOSAL

REQUEST FOR PROPOSAL NO. 2020-58
PROFESSIONAL ENGINEERING SERVICES-CONTINUING SERVICES CONTRACTS FOR
CITY OF NORTH PORT UTILITIES DEPARTMENT

4. Business/Customer Name: Whippo Company

Name of Contact Person/Title: Charlie Whippo, President

Telephone# 941-468-3100 Fax n/a E-mail whippoco@gmail.com

Address 2800 Worth Avenue, Englewood, FL 34224

Phone Number 941-468-3100 Discipline (circle): WTP; WWTF; pipeline; hydrogeo; potable reuse

Duration of Contract or business relationship 10+ years

Type of Services Provided Pipeline, Potable Reuse

5. Business/Customer Name: Englewood Water District

Name of Contact Person/Title: Keith Ledford, Jr., P.E., Technical Support Manager

Telephone# 941-460-1020 Fax 941-460-1025 E-mail kledford@ewdfi.com

Address 201 Selma Avenue, Englewood, FL 34223

Phone Number 941-460-1020 Discipline (circle): WTP; WWTF; pipeline; hydrogeo; potable reuse

Duration of Contract or business relationship 10+ years

Type of Services Provided Pipeline, Potable Reuse

6. Business/Customer Name: Bocilla Utilities, Inc.

Name of Contact Person/Title: Craig Noden

Telephone# 941-769-0561 Fax 800-436-7113 E-mail craig@bocillautilities.com

Address 7025 Placida Rd., Unit 4, Englewood, FL 34224

Phone Number 941-769-0561 Discipline (circle): WTP; WWTF; pipeline; hydrogeo; potable reuse

Duration of Contract or business relationship 10+ years

Type of Services Provided Pipeline

COMPANY NAME: Giffels-Webster Engineers, Inc.

SIGNATURE: 

THIS PAGE MUST BE SUBMITTED WITH PROPOSAL

DRUG FREE WORKPLACE FORM

The undersigned Consultant in accordance with Florida Statute 287.087 hereby certifies that
Giffels-Webster Engineers, Inc. does:
(Company Name)

1. Publish a statement notifying employees that the unlawful manufacture, distribution, dispensing, possession, or use of a controlled substance is prohibited in the workplace and specifying the actions that will be taken against employees for violations of such prohibition.
2. Inform employees about the dangers of drug abuse in the workplace, the business's policy of maintaining a drug free workplace, any available drug counseling, rehabilitation, and employee assistance programs, and the penalties that may be imposed upon employees for drug abuse violations.
3. Give each employee engaged in providing the commodities or contractual services that are under bid a copy of the statement specified in subsection (1).
4. In the statement specified in subsection (1), notify the employees that, as a condition of working on the commodities or contractual services that are under bid, the employee will abide by the terms of the statement and will notify the employer of any conviction of, or plea of guilty or nolo contendere to, any violation of Chapter 893 or of any controlled substance law of the United States or any state, for a violation occurring in the workplace no later than five (5) days after such conviction.
5. Impose a sanction on, or require the satisfactory participation in a drug abuse assistance or rehabilitation program if such is available in the employee's community, by any employee who is so convicted.
6. Make a good faith effort to continue to maintain a drug free workplace through implementation of this section.

Check one:

- As the person authorized to sign this statement, I certify that this firm complies fully with above requirements.
- As the person authorized to sign this statement, this firm **does not** comply fully with the above requirements.



Offeror's Signature

July 17, 2020

Date

THIS PAGE MUST BE SUBMITTED WITH PROPOSAL

PUBLIC ENTITY CRIME INFORMATION

As provided by F.S. §287.133, a person or affiliate who has been placed on the convicted vendor list following a conviction for a public entity crime may not submit a bid on a contract to provide any goods or services to a public entity, may not submit a bid on a contract with a public entity for the construction or repair of a public building or public work, may not submit bids on leases of real property to a public entity, may not be awarded or perform work as a Contractor, Supplier, Subcontractor, or Consultant under a contract with any public entity, and may not transact business with any public entity in excess of the threshold amount provided in Section 287, for CATEGORY TWO for a period of 36 months from the date of being placed on the convicted vendor list.

I, Jonathan H. Cole, P.E., President, being an authorized representative of the Respondent,
Giffels-Webster Engineers, Inc., located at 900 Pine Street, Suite 225

City: Englewood State: FL Zip Code: 34223, have read and understand
the contents above. I further certify that Respondent is not disqualified from replying to this solicitation because of F.S.
§287.133.

Signature:  Date: 7/17/2020

Telephone #: 941-475-7981 Fax #: 941-474-4285

Federal ID #: 38-2749086

STATE OF FLORIDA
COUNTY OF Charlotte

Sworn to (or affirmed) and subscribed before me by means of physical presence or online notarization, this 17
day of July, 2020, by Jonathan H. Cole, P.E.

Notary Public - State of Florida



Personally Known OR Produced Identification
Type of Identification Produced _____

THIS PAGE MUST BE SUBMITTED WITH PROPOSAL

REQUEST FOR PROPOSAL NO. 2020-58
PROFESSIONAL ENGINEERING SERVICES-CONTINUING SERVICES CONTRACTS FOR
CITY OF NORTH PORT UTILITIES DEPARTMENT

NON-COLLUSIVE AFFIDAVIT

Before me, the undersigned authority, personally appeared:

Jonathan H. Cole, P.E. who, being first duly sworn, deposes and says that:

1. He/She is the Owner (Owner, Partner, Officer, Representative or Agent) of Giffels-Webster Engineers, Inc., the Respondent that has submitted the attached reply;
2. He/She is fully informed respecting the preparation and contents of the attached reply and of all pertinent circumstances respecting such reply;
3. Such reply is genuine and is not a collusive or sham reply;
4. Neither the said Respondent nor any of its officers, partners, owners, agents, representatives, employees or parties in interest, including this affiant, have in any way colluded, conspired, connived or agreed, directly or indirectly, with any other respondent, firm, or person to submit a collusive or sham reply in connection with the work for which the attached reply has been submitted; or have in any manner, directly or indirectly sought by agreement or collusion, or communication or conference with any respondent, firm, or person to fix the price or prices in the attached reply or of any other respondent, or to fix any overhead, profit, or cost elements of the reply price or the reply price of any other respondent, or to secure through any collusion, conspiracy, connivance, or unlawful agreement any advantage against (Recipient), or any person interested in the reply work.

Signed, sealed and delivered this 17 day of July, 2020.

By: [Signature]
Jonathan H. Cole, P.E.
(Printed Name)
President
(Title)

STATE OF FLORIDA
COUNTY OF Charlotte

Sworn to (or affirmed) and subscribed before me by means of physical presence or online notarization, this 17 day of July, 2020, by Jonathan H. Cole, P.E.

[Signature]
Notary Public - State of Florida



Personally Known OR Produced Identification
Type of Identification Produced _____

THIS PAGE MUST BE SUBMITTED WITH PROPOSAL

LOBBYING CERTIFICATION

"The undersigned hereby certifies, to the best of his or her knowledge and belief, that":

STATE OF Florida

COUNTY OF Charlotte

This 17 day July of ~~2017~~ 2020

Jonathan H. Cole, P.E., being first duly sworn, deposes and says that he or she is the authorized representative of Giffels-Wesbter Engineers, Inc. (Name of the contractor, firm or individual), and that the vendor and any of its agents agree to have no contact or communication with, or discuss any matter related in any way to any active City of North Port solicitation, with any City of North Port elected officials, officers, their appointees or their agents or any other staff or outside individuals working with the city in respect to this request other than the designated Procurement Official Contact and to abide by the restrictions outlined in the General Terms and Conditions of the Solicitation. Technical questions directed to the project manager, is prohibited. These persons shall not be lobbied, either individually or collectively, regarding any questions for bid, proposal, qualification and/or any other solicitations released by the city. To do so is grounds for immediate disqualification from the selection process. The selection process is not considered final until such a time as the Commission has made a final and conclusive determination.

(a) No City appropriated funds have been paid or will be paid, by or on behalf of the undersigned, to any person for influencing or attempting to influence either directly or indirectly an officer or employee of the City, City Commission in connection with the awarding of any City Contract.

(b) If any funds other than City appropriated funds have been paid or will be paid to any person for influencing or attempting to influence a member of City Commission or an officer or employee of the City in connection with this contract, the undersigned shall complete and submit Standard Form-L "Disclosure Form to Report Lobbying", in accordance with its instructions.

Signed, sealed and delivered this 17 day of July, 2020.

By: [Signature]

Jonathan H. Cole, P.E.
(Printed Name)
President

STATE OF FLORIDA
COUNTY OF Charlotte

Sworn to (or affirmed) and subscribed before me by means of physical presence and virtual notarization, this 17 day of July, 2020, by Jonathan H. Cole, P.E.

[Signature]
Notary Public - State of Florida

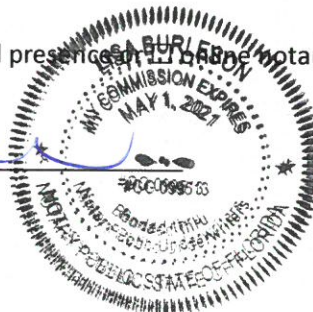

Personally Known OR Produced Identification
Type of Identification Produced _____

THIS PAGE MUST BE SUBMITTED WITH PROPOSAL

CONFLICT OF INTEREST FORM

F.S. §112.313 places limitations on public officers (including advisory board members) and employees' ability to contract with the City either directly or indirectly. Therefore, please indicate if the following applies:

PART I.

- I am an employee, public officer or advisory board member of the City
_____ (List Position Or Board)
- I am the spouse or child of an employee, public officer or advisory board member of the City
Name: _____
- An employee, public officer or advisory board member of the City, or their spouse or child, is an officer, partner, director, or proprietor of Respondent or has a material interest in Respondent. "Material interest" means direct or indirect ownership of more than 5 percent of the total assets or capital stock of any business entity. For the purposes of [§112.313], indirect ownership does not include ownership by a spouse or minor child.
Name: _____
- Respondent employs or contracts with an employee, public officer or advisory board member of the City
Name: _____
- None Of The Above

PART II:

Are you going to request an advisory board member waiver?

- I will request an advisory board member waiver under §112.313(12)
- I will NOT request an advisory board member waiver under §112.313(12)
- N/A

The City shall review any relationships which may be prohibited under the Florida Ethics Code and will disqualify any vendors whose conflicts are not waived or exempt.

COMPANY: Giffels-Webster Engineers, Inc.

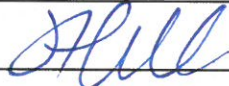
SIGNATURE: 

THIS PAGE MUST BE SUBMITTED WITH PROPOSAL

DISCLOSURE FORM

FOR

CONSULTANT/ENGINEER/ARCHITECT

Please select (only) one of the following three options:

Our firm has no actual, potential, or reasonably perceived, **financial*** or **other interest**** in the outcome of the project.

Our firm has a potential or reasonably perceived **financial*** or **other interest**** in the outcome of the project as described here: _____.

Our firm proposes to mitigate the potential or perceived conflict according to the following plan:
_____.

Our firm has an actual **financial*** or **other interest**** in the outcome of the project as described here:
_____.

***What does "financial interest" mean?**

If your firm, or employee of your firm working on the project (or a member of the employee's household), will/may be perceived to receive or lose private income depending on the government business choices based on your firm's findings and recommendations, this must be listed as a financial interest. An example would be ownership in physical assets affected by the government business choices related to this project. The possibility of contracting for further consulting services is not included in this definition and is not prohibited.

****What does "other interest" mean?**

If your firm, or employee of your firm working on the project (or a member of the employee's household), will/may be perceived to have political, legal or any other interests that will affect what goes into your firm's findings and recommendations, or will be/may be perceived to be affected by the government business choices related to this project, this must be listed as another interest.

BUSINESS NAME: Giffels-Webster Engineers, Inc.

NAME (PERSON AUTHORIZED TO BIND THE COMPANY): Jonathan H. Cole, P.E., President

SIGNATURE: _____

DATE: 7/17/2020

THIS PAGE MUST BE SUBMITTED WITH PROPOSAL

REQUEST FOR PROPOSAL NO. 2020-58
PROFESSIONAL ENGINEERING SERVICES-CONTINUING SERVICES CONTRACTS FOR
CITY OF NORTH PORT UTILITIES DEPARTMENT

Scrutinized Company Certification Form

Company Name: Giffels-Webster Engineers, Inc.

Authorized Representative Name and Title: Jonathan H. Cole, P.E., President

Address: 900 Pine Street, Suite 225 City: Englewood State: Florida ZIP: 34223

Phone Number: 941-475-7981 Email Address: jcole@gweffl.com

A company is ineligible to, and may not, bid on, submit a proposal for, or enter into or renew a contract with the City of North Port for goods or services of any amount if, at the time of bidding on, submitting a proposal for, or entering into or renewing such contract, the company is on the Scrutinized Companies that Boycott Israel List, created pursuant to Florida Statutes, section 215.4725, or is engaged in a boycott of Israel.

A company is ineligible to, and may not, bid on, submit a proposal for, or enter into or renew a contract with the City of North Port for goods or services of \$1 million or more if, at the time of bidding on, submitting a proposal for, or entering into or renewing such contract, the company is on the Scrutinized Companies with Activities in Sudan List, the Scrutinized Companies with Activities in the Iran Petroleum Energy Sector List, created pursuant to Florida Statutes, section 215.473, or with companies engaged in business operations in Cuba or Syria.

CHOOSE ONE OF THE FOLLOWING

- This bid, proposal, contract or contract renewal is for goods or services of less than \$1 million. As the person authorized to sign on behalf of the above-named company, and as required by Florida Statutes, section 287.135(5), I hereby certify that the above-named company is not participating in a boycott of Israel.
- This bid, proposal, contract or contract renewal is for goods or services of \$1 million or more. As the person authorized to sign on behalf of the above-named company, and as required by Florida Statutes, section 287.135(5), I hereby certify that the above-named company is not participating in a boycott of Israel, is not on the Scrutinized Companies with Activities in Sudan List or the Scrutinized Companies with Activities in the Iran Petroleum Energy Sector List, and it does not have business operations in Cuba or Syria.

I understand that pursuant to Florida Statutes, section 287.135, the submission of a false certification may result in the termination of the contract if one is entered into, and may subject the above-named company to civil penalties, attorney's fees and costs.

Certified By: 
AUTHORIZED REPRESENTATIVE SIGNATURE

Print Name and Title: Jonathan H. Cole, P.E., President

Date Certified: July 17, 2020

Solicitation/Contract/PO Number (Completed by Purchasing): 2020-58

THIS PAGE MUST BE SUBMITTED WITH PROPOSAL

END OF PART IV

State of Florida

Department of State

I certify from the records of this office that GIFFELS-WEBSTER ENGINEERS, INC. is a corporation organized under the laws of the State of Florida, filed on September 9, 1987.

The document number of this corporation is J91612.

I further certify that said corporation has paid all fees due this office through December 31, 2020, that its most recent annual report/uniform business report was filed on March 4, 2020, and that its status is active.

I further certify that said corporation has not filed Articles of Dissolution.

*Given under my hand and the
Great Seal of the State of Florida
at Tallahassee, the Capital, this
the Fourth day of March, 2020*



Randy R. Lee
Secretary of State

Tracking Number: 7135663578CC

To authenticate this certificate, visit the following site, enter this number, and then follow the instructions displayed.

<https://services.sunbiz.org/Filings/CertificateOfStatus/CertificateAuthentication>

[Previous On List](#) [Next On List](#) [Return to List](#)

Entity Name Search

No Events **No Name History**

Detail by Entity Name

Florida Profit Corporation

GIFFELS-WEBSTER ENGINEERS, INC.

Filing Information

Document Number	J91612
FEI/EIN Number	38-2749086
Date Filed	09/09/1987
State	FL
Status	ACTIVE

Principal Address

900 PINE STREET
SUITE # 225
ENGLEWOOD, FL 34223

Changed: 02/15/2012

Mailing Address

900 PINE STREET
SUITE # 225
ENGLEWOOD, FL 34223

Changed: 02/15/2012

Registered Agent Name & Address

COLE, JONATHAN H
900 PINE STREET
STE 225
ENGLEWOOD, FL 34223



RICK SCOTT, GOVERNOR

JONATHAN ZACHEM, SECRETARY



**STATE OF FLORIDA
DEPARTMENT OF BUSINESS AND PROFESSIONAL REGULATION**

BOARD OF PROFESSIONAL ENGINEERS

THE ENGINEERING BUSINESS HEREIN IS AUTHORIZED UNDER THE
PROVISIONS OF CHAPTER 471, FLORIDA STATUTES

GIFFELS-WEBSTER ENGINEERS, INC.

900 PINE STREET
SUITE 225
ENGLEWOOD FL 34223

LICENSE NUMBER: CA3607

EXPIRATION DATE: FEBRUARY 28, 2021

Always verify licenses online at MyFloridaLicense.com



Do not alter this document in any form.

This is your license. It is unlawful for anyone other than the licensee to use this document.



CERTIFICATE OF LIABILITY INSURANCE

DATE (MM/DD/YYYY)
12/19/2019

THIS CERTIFICATE IS ISSUED AS A MATTER OF INFORMATION ONLY AND CONFERS NO RIGHTS UPON THE CERTIFICATE HOLDER. THIS CERTIFICATE DOES NOT AFFIRMATIVELY OR NEGATIVELY AMEND, EXTEND OR ALTER THE COVERAGE AFFORDED BY THE POLICIES BELOW. THIS CERTIFICATE OF INSURANCE DOES NOT CONSTITUTE A CONTRACT BETWEEN THE ISSUING INSURER(S), AUTHORIZED REPRESENTATIVE OR PRODUCER, AND THE CERTIFICATE HOLDER.

IMPORTANT: If the certificate holder is an ADDITIONAL INSURED, the policy(ies) must have ADDITIONAL INSURED provisions or be endorsed. If SUBROGATION IS WAIVED, subject to the terms and conditions of the policy, certain policies may require an endorsement. A statement on this certificate does not confer rights to the certificate holder in lieu of such endorsement(s).

PRODUCER Hall & Company A/E Professional Liability Insurance Program, LLC 19660 10th Ave NE Poulsbo WA 98370	CONTACT NAME: Brittney Merrihew	
	PHONE (A/C, No, Ext): 360-626-2010	FAX (A/C, No): 360-626-2010
E-MAIL ADDRESS: bmerrihew@hallandcompany.com		
INSURER(S) AFFORDING COVERAGE		NAIC #
INSURER A: Underwriters at Lloyd's, London/AEGIS		
INSURER B:		
INSURER C:		
INSURER D:		
INSURER E:		
INSURER F:		

COVERAGES	CERTIFICATE NUMBER: 1552545163	REVISION NUMBER:
------------------	---------------------------------------	-------------------------

THIS IS TO CERTIFY THAT THE POLICIES OF INSURANCE LISTED BELOW HAVE BEEN ISSUED TO THE INSURED NAMED ABOVE FOR THE POLICY PERIOD INDICATED. NOTWITHSTANDING ANY REQUIREMENT, TERM OR CONDITION OF ANY CONTRACT OR OTHER DOCUMENT WITH RESPECT TO WHICH THIS CERTIFICATE MAY BE ISSUED OR MAY PERTAIN, THE INSURANCE AFFORDED BY THE POLICIES DESCRIBED HEREIN IS SUBJECT TO ALL THE TERMS, EXCLUSIONS AND CONDITIONS OF SUCH POLICIES. LIMITS SHOWN MAY HAVE BEEN REDUCED BY PAID CLAIMS.

INSR LTR	TYPE OF INSURANCE	ADDL INSD	SUBR WVD	POLICY NUMBER	POLICY EFF (MM/DD/YYYY)	POLICY EXP (MM/DD/YYYY)	LIMITS
	COMMERCIAL GENERAL LIABILITY <input type="checkbox"/> CLAIMS-MADE <input type="checkbox"/> OCCUR GEN'L AGGREGATE LIMIT APPLIES PER: <input type="checkbox"/> POLICY <input type="checkbox"/> PRO-JECT <input type="checkbox"/> LOC OTHER:						EACH OCCURRENCE \$ DAMAGE TO RENTED PREMISES (Ea occurrence) \$ MED EXP (Any one person) \$ PERSONAL & ADV INJURY \$ GENERAL AGGREGATE \$ PRODUCTS - COMP/OP AGG \$ \$
	AUTOMOBILE LIABILITY <input type="checkbox"/> ANY AUTO <input type="checkbox"/> OWNED AUTOS ONLY <input type="checkbox"/> SCHEDULED AUTOS <input type="checkbox"/> HIRED AUTOS ONLY <input type="checkbox"/> NON-OWNED AUTOS ONLY						COMBINED SINGLE LIMIT (Ea accident) \$ BODILY INJURY (Per person) \$ BODILY INJURY (Per accident) \$ PROPERTY DAMAGE (Per accident) \$ \$
	UMBRELLA LIAB <input type="checkbox"/> OCCUR EXCESS LIAB <input type="checkbox"/> CLAIMS-MADE DED <input type="checkbox"/> RETENTION \$						EACH OCCURRENCE \$ AGGREGATE \$ \$
	WORKERS COMPENSATION AND EMPLOYERS' LIABILITY ANY PROPRIETOR/PARTNER/EXECUTIVE OFFICER/MEMBER EXCLUDED? (Mandatory in NH) <input type="checkbox"/> Y <input checked="" type="checkbox"/> N If yes, describe under DESCRIPTION OF OPERATIONS below						<input type="checkbox"/> PER STATUTE <input type="checkbox"/> OTH-ER E.L. EACH ACCIDENT \$ E.L. DISEASE - EA EMPLOYEE \$ E.L. DISEASE - POLICY LIMIT \$
A	Professional Liab;Claims Made			1525/18U101119/133	12/13/2019	12/13/2020	Per Claim Aggregate \$2,000,000 \$2,000,000

DESCRIPTION OF OPERATIONS / LOCATIONS / VEHICLES (ACORD 101, Additional Remarks Schedule, may be attached if more space is required)
Additional Insured Status is not available on Professional Liability Policy.

CERTIFICATE HOLDER	CANCELLATION
	SHOULD ANY OF THE ABOVE DESCRIBED POLICIES BE CANCELLED BEFORE THE EXPIRATION DATE THEREOF, NOTICE WILL BE DELIVERED IN ACCORDANCE WITH THE POLICY PROVISIONS.
	AUTHORIZED REPRESENTATIVE

© 1988-2015 ACORD CORPORATION. All rights reserved.



CERTIFICATE OF LIABILITY INSURANCE

GIFFE-1

OP ID: KJ

DATE (MM/DD/YYYY)
09/18/2019

THIS CERTIFICATE IS ISSUED AS A MATTER OF INFORMATION ONLY AND CONFERS NO RIGHTS UPON THE CERTIFICATE HOLDER. THIS CERTIFICATE DOES NOT AFFIRMATIVELY OR NEGATIVELY AMEND, EXTEND OR ALTER THE COVERAGE AFFORDED BY THE POLICIES BELOW. THIS CERTIFICATE OF INSURANCE DOES NOT CONSTITUTE A CONTRACT BETWEEN THE ISSUING INSURER(S), AUTHORIZED REPRESENTATIVE OR PRODUCER, AND THE CERTIFICATE HOLDER.

IMPORTANT: If the certificate holder is an ADDITIONAL INSURED, the policy(ies) must be endorsed. If SUBROGATION IS WAIVED, subject to the terms and conditions of the policy, certain policies may require an endorsement. A statement on this certificate does not confer rights to the certificate holder in lieu of such endorsement(s).

PRODUCER Rowley Insurance Agency Inc. 262 S Indiana Ave. Englewood, FL 34223 M. Keith Rowley	CONTACT NAME: _____ PHONE (A/C, No, Ext): _____ FAX (A/C, No): _____ E-MAIL ADDRESS: _____																				
	<table border="1"> <tr> <th colspan="2">INSURER(S) AFFORDING COVERAGE</th> <th>NAIC #</th> </tr> <tr> <td>INSURER A : Allied Property & Casualty</td> <td></td> <td>42579</td> </tr> <tr> <td>INSURER B :</td> <td></td> <td></td> </tr> <tr> <td>INSURER C :</td> <td></td> <td></td> </tr> <tr> <td>INSURER D :</td> <td></td> <td></td> </tr> <tr> <td>INSURER E :</td> <td></td> <td></td> </tr> <tr> <td>INSURER F :</td> <td></td> <td></td> </tr> </table>	INSURER(S) AFFORDING COVERAGE		NAIC #	INSURER A : Allied Property & Casualty		42579	INSURER B :			INSURER C :			INSURER D :			INSURER E :			INSURER F :	
INSURER(S) AFFORDING COVERAGE		NAIC #																			
INSURER A : Allied Property & Casualty		42579																			
INSURER B :																					
INSURER C :																					
INSURER D :																					
INSURER E :																					
INSURER F :																					
INSURED Giffels-Webster Engineers, Inc 900 Pine St, Ste 225-228 Englewood, FL 34223																					

COVERAGES**CERTIFICATE NUMBER:****REVISION NUMBER:**

THIS IS TO CERTIFY THAT THE POLICIES OF INSURANCE LISTED BELOW HAVE BEEN ISSUED TO THE INSURED NAMED ABOVE FOR THE POLICY PERIOD INDICATED. NOTWITHSTANDING ANY REQUIREMENT, TERM OR CONDITION OF ANY CONTRACT OR OTHER DOCUMENT WITH RESPECT TO WHICH THIS CERTIFICATE MAY BE ISSUED OR MAY PERTAIN, THE INSURANCE AFFORDED BY THE POLICIES DESCRIBED HEREIN IS SUBJECT TO ALL THE TERMS, EXCLUSIONS AND CONDITIONS OF SUCH POLICIES. LIMITS SHOWN MAY HAVE BEEN REDUCED BY PAID CLAIMS.

INSR LTR	TYPE OF INSURANCE	ADDL INSR	SUBR WVD	POLICY NUMBER	POLICY EFF (MM/DD/YYYY)	POLICY EXP (MM/DD/YYYY)	LIMITS								
A	GENERAL LIABILITY <input type="checkbox"/> COMMERCIAL GENERAL LIABILITY <input type="checkbox"/> CLAIMS-MADE <input type="checkbox"/> OCCUR <input checked="" type="checkbox"/> Business Owners GEN'L AGGREGATE LIMIT APPLIES PER: <input type="checkbox"/> POLICY <input type="checkbox"/> PRO-JECT <input type="checkbox"/> LOC	X		ACPBPOZ5925681931	09/07/2019	09/07/2020	EACH OCCURRENCE \$ 1,000,000 DAMAGE TO RENTED PREMISES (Ea occurrence) \$ 300,000 MED EXP (Any one person) \$ 5,000 PERSONAL & ADV INJURY \$ 1,000,000 GENERAL AGGREGATE \$ 2,000,000 PRODUCTS - COMP/OP AGG \$ 2,000,000 \$								
A	AUTOMOBILE LIABILITY <input type="checkbox"/> ANY AUTO <input type="checkbox"/> ALL OWNED AUTOS <input checked="" type="checkbox"/> HIRED AUTOS <input checked="" type="checkbox"/> SCHEDULED AUTOS <input checked="" type="checkbox"/> NON-OWNED AUTOS			ACPBAPD5925681931	09/07/2019	09/07/2020	COMBINED SINGLE LIMIT (Ea accident) \$ 1,000,000 BODILY INJURY (Per person) \$ BODILY INJURY (Per accident) \$ PROPERTY DAMAGE (PER ACCIDENT) \$ \$								
A	<input checked="" type="checkbox"/> UMBRELLA LIAB <input checked="" type="checkbox"/> OCCUR <input type="checkbox"/> EXCESS LIAB <input type="checkbox"/> CLAIMS-MADE DED <input checked="" type="checkbox"/> RETENTION \$ NONE			ACPCAP5925681931	09/07/2019	09/07/2020	EACH OCCURRENCE \$ 5,000,000 AGGREGATE \$ \$								
A	WORKERS COMPENSATION AND EMPLOYERS' LIABILITY ANY PROPRIETOR/PARTNER/EXECUTIVE OFFICER/MEMBER EXCLUDED? (Mandatory in NH) <input type="checkbox"/> Y/N If yes, describe under DESCRIPTION OF OPERATIONS below		N/A	ACPWCP5925681931	09/07/2019	09/07/2020	<table border="1"> <tr> <td>WC STATUTORY LIMITS</td> <td>OTHER</td> </tr> <tr> <td>E.L. EACH ACCIDENT</td> <td>\$ 1,000,000</td> </tr> <tr> <td>E.L. DISEASE - EA EMPLOYEE</td> <td>\$ 1,000,000</td> </tr> <tr> <td>E.L. DISEASE - POLICY LIMIT</td> <td>\$ 1,000,000</td> </tr> </table>	WC STATUTORY LIMITS	OTHER	E.L. EACH ACCIDENT	\$ 1,000,000	E.L. DISEASE - EA EMPLOYEE	\$ 1,000,000	E.L. DISEASE - POLICY LIMIT	\$ 1,000,000
WC STATUTORY LIMITS	OTHER														
E.L. EACH ACCIDENT	\$ 1,000,000														
E.L. DISEASE - EA EMPLOYEE	\$ 1,000,000														
E.L. DISEASE - POLICY LIMIT	\$ 1,000,000														

DESCRIPTION OF OPERATIONS / LOCATIONS / VEHICLES (Attach ACORD 101, Additional Remarks Schedule, if more space is required)

Engineer

CERTIFICATE HOLDER**CANCELLATION**

City of North Port
 Finance Department
 Purchasing Division
 4970 City Hall Blvd
 North Port, FL 34286

SHOULD ANY OF THE ABOVE DESCRIBED POLICIES BE CANCELLED BEFORE THE EXPIRATION DATE THEREOF, NOTICE WILL BE DELIVERED IN ACCORDANCE WITH THE POLICY PROVISIONS.

AUTHORIZED REPRESENTATIVE

© 1988-2010 ACORD CORPORATION. All rights reserved.